

Geary Avenue: Option 2_Reconstruction

*Any future street modifications will require coordination with City of Toronto Transportation Services

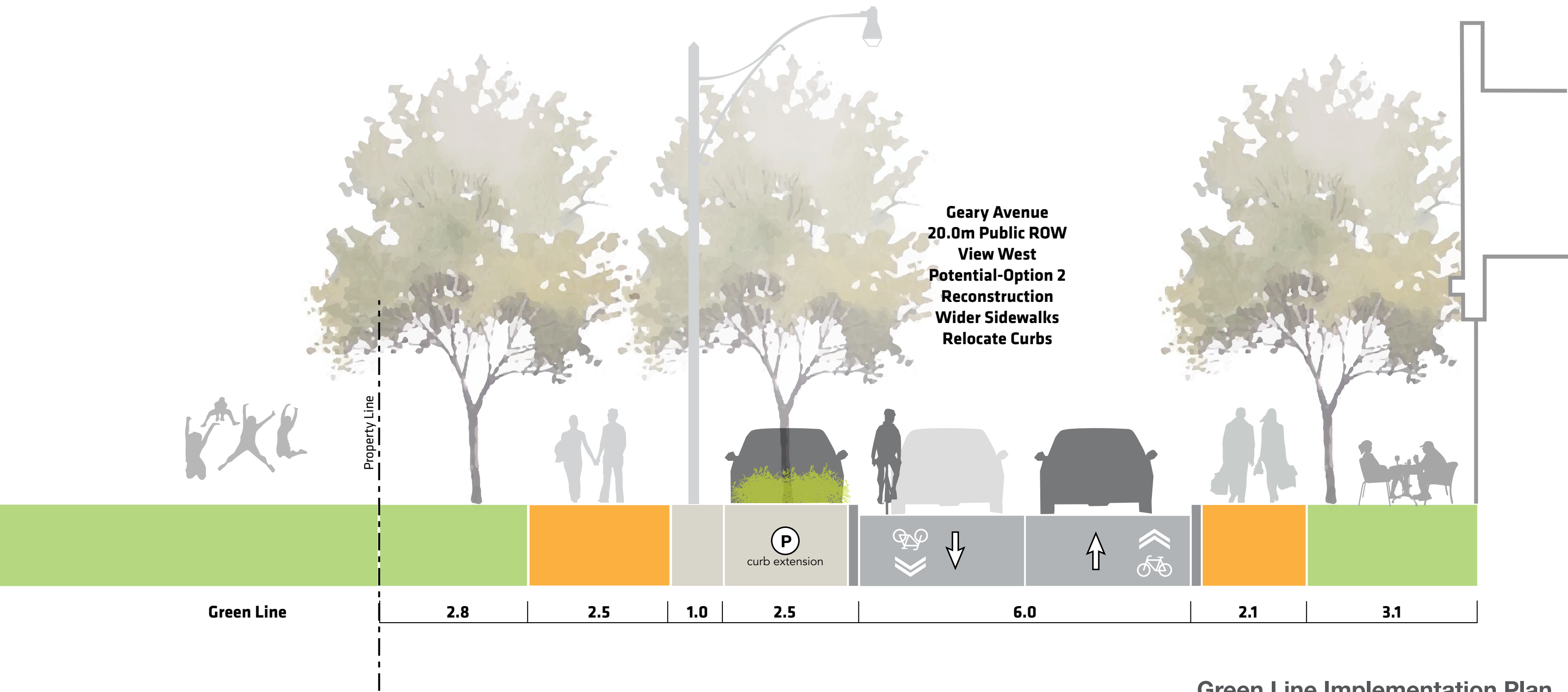

Geary Avenue: Options

*Any future street modifications will require coordination with City of Toronto Transportation Services

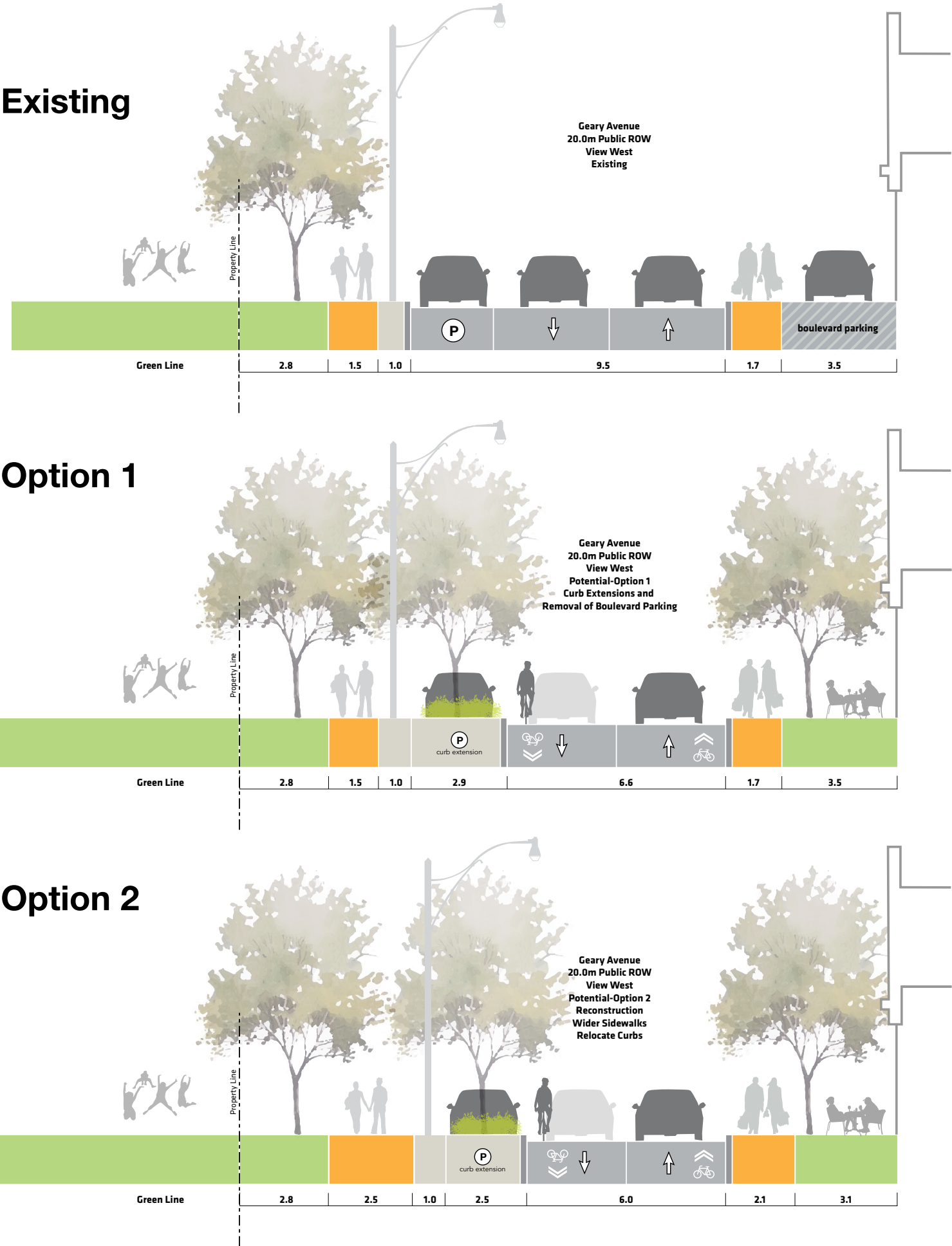

Bridgman



Bridgman: Existing

*Any future street modifications will require coordination with City of Toronto Transportation Services

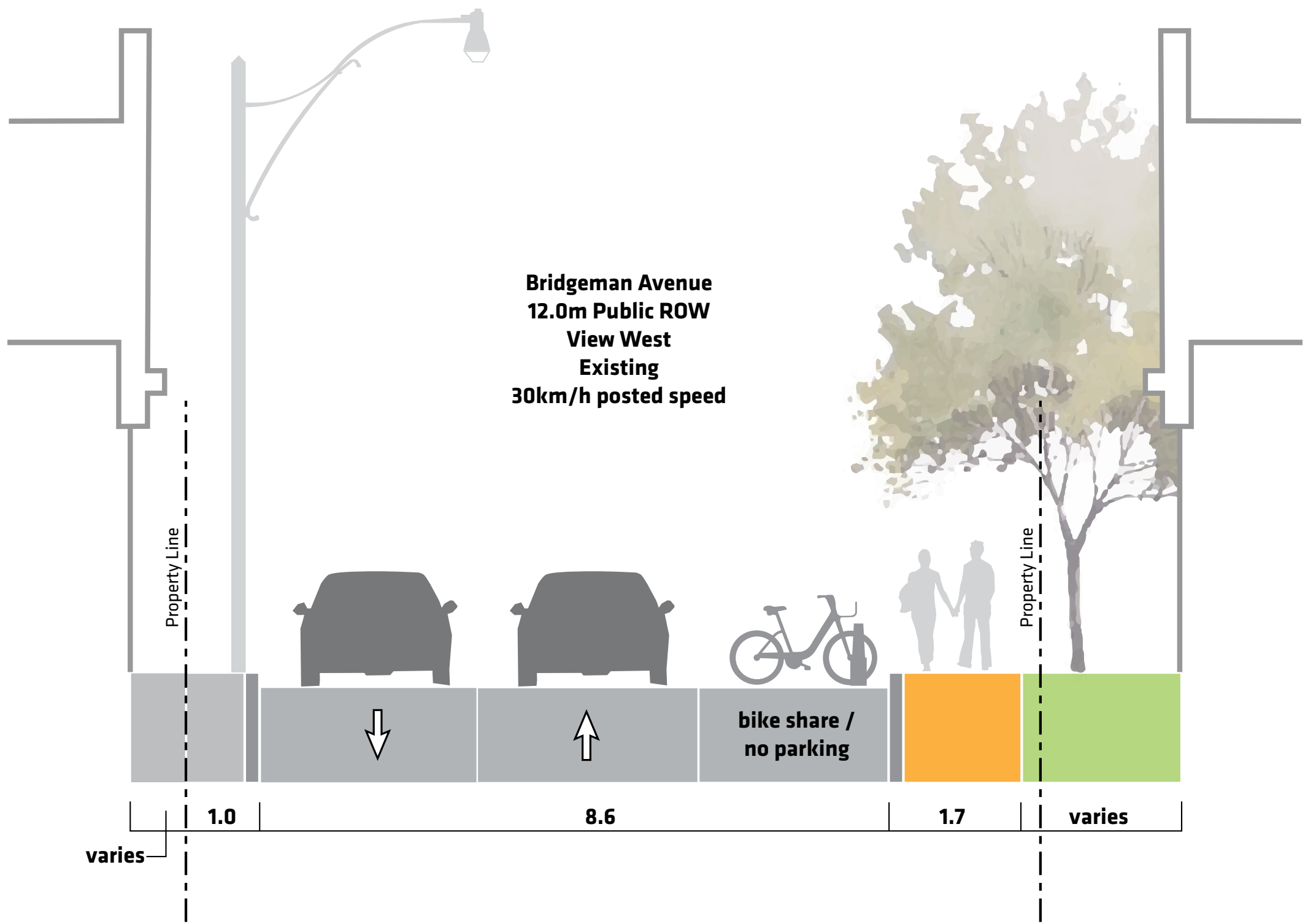

Bridgman: Option 1

*Any future street modifications will require coordination with City of Toronto Transportation Services

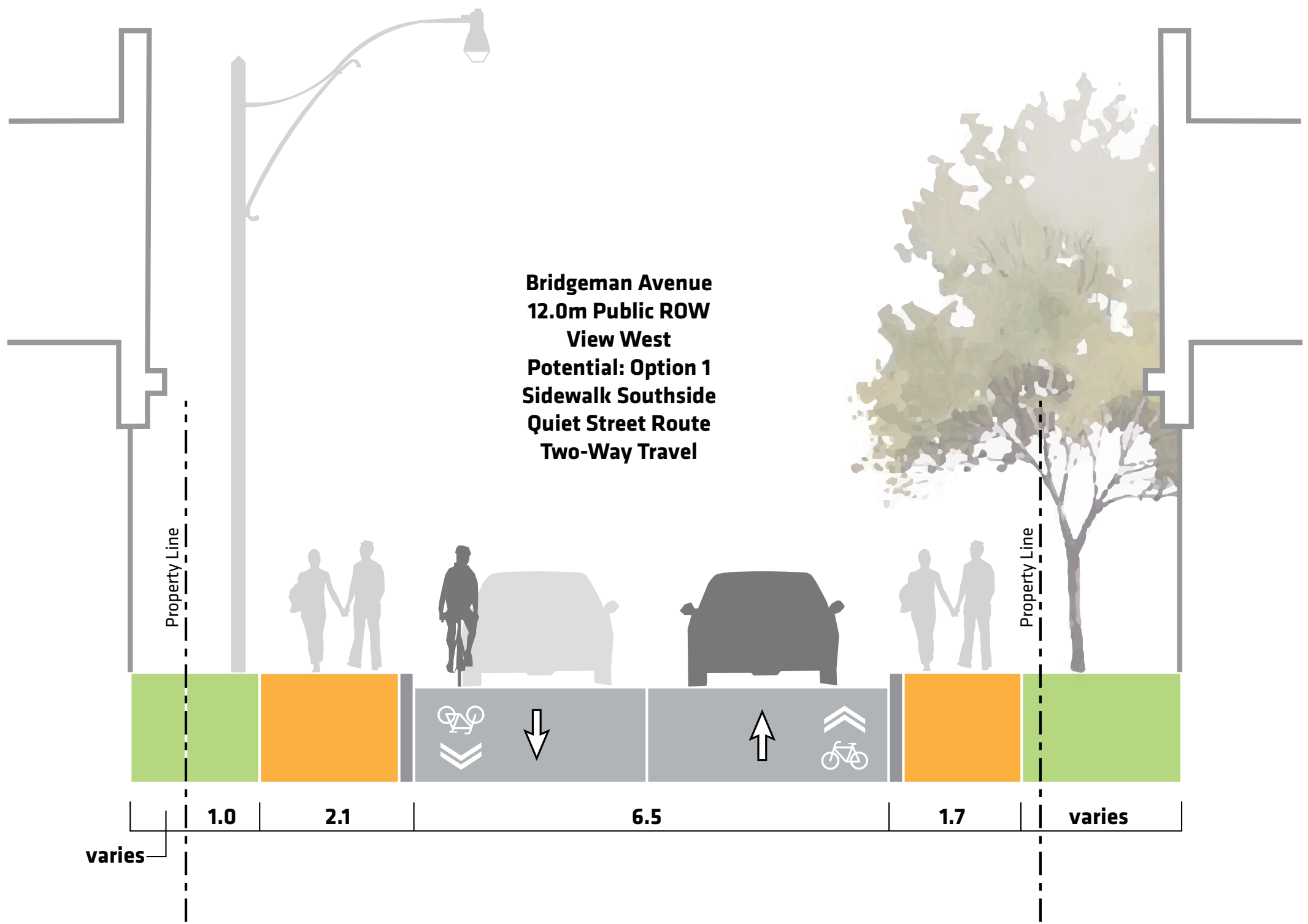

Bridgman: Option 2



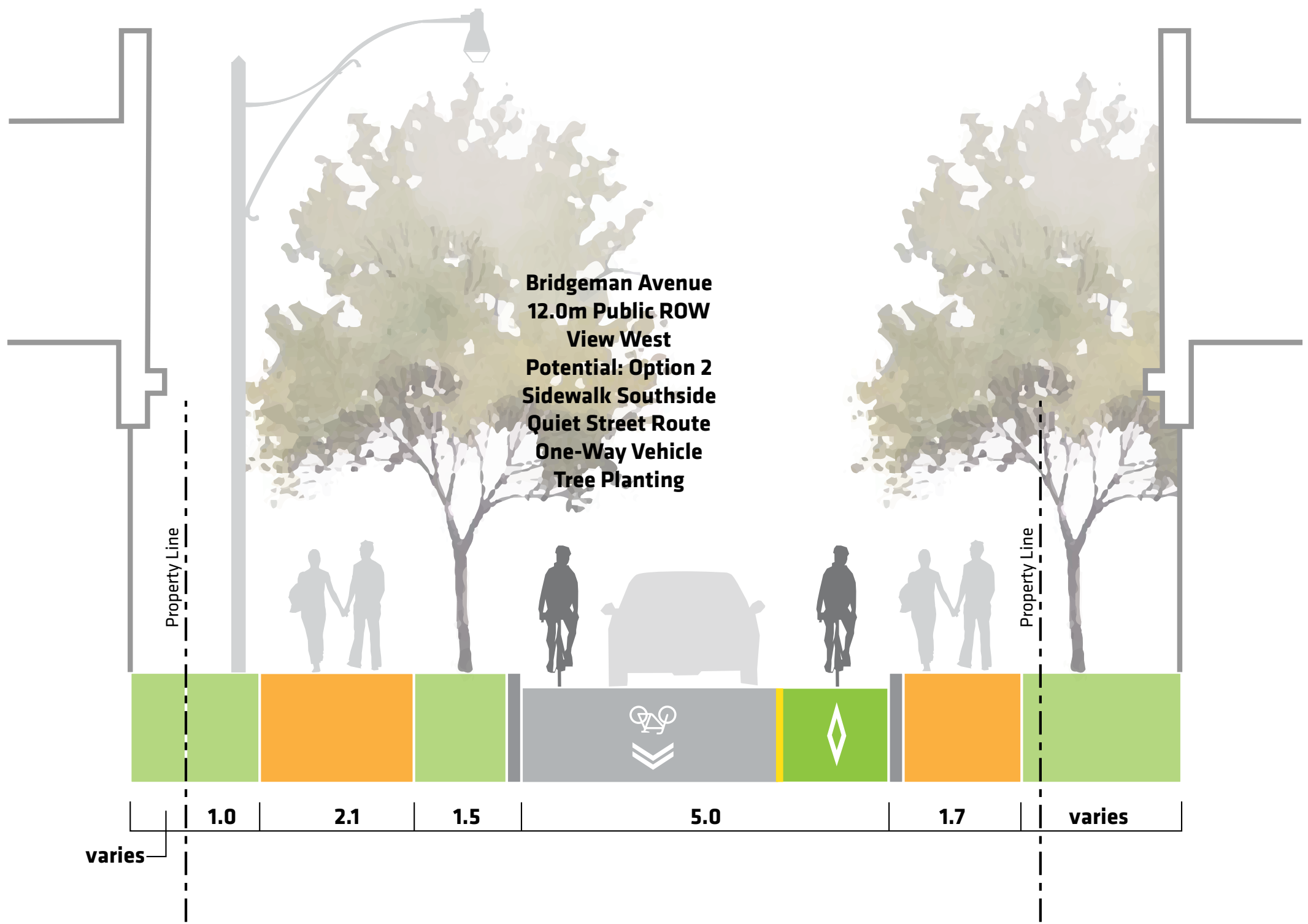

*Any future street modifications will require coordination with City of Toronto Transportation Services



Potential Park Programming



LEGEND

-  Proposed New PF+R Parks
-  Existing PF+R Parks
-  Parcels with License Agreements
-  Program Elements
-  TTC Station

SUMMARY

- 45** Number of Parcels Identified in the Study Area
- 16** Parcels with License Agreements

Dog Off Leash Areas (DOLA) and Community Gardens

Master Plan does not include them yet

Green Line is a constrained open space with competing uses and increasing demand

Separate City process for establishing need, location and design

Each new park and revitalized existing park will have its own process to determine programming and facilities

We want to hear from you tonight



Planting Strategy

Low Woody Planting



- *Cercis canadensis*
Redbud
- *Cornus alternifolia*
Pagoda Dogwood
- *Malus 'Pink Spires'*
Crabapple 'Pink Spires'
- *Amelanchier laevis*
Allegheny Serviceberry
- *Acer platanoides*
'Globosum' Globe Maple

Shrub Planting



- *Cornus racemosa*
Grey Dogwood
- *Rhus typhina*
Staghorn Sumac
- *Sambucus canadensis*
Elderberry
- *Diervilla lonicera*
Bush Honeysuckle
- *Physocarpus opulifolius*
Ninebark

Meadow Planting



- *Andropogon gerardii*
Big Bluestem
- *Elymus canadensis*
Canada Wild Rye Grass
- *Panicum virgatum*
Switchgrass
- *Schizachyrium scoparium*
Little bluestem
- *Sorghastrum nutans*
Indian grass

Perennial Planting



- *Asclepias incarnata*
Swamp Milkweed
- *Anemone canadensis*
Canada Anemone
- *Fragaria vesca*
Wild Strawberry
- *Monarda fistulosa*
Wild Bergamot
- *Rudbeckia laciniata*
Green-headed Coneflower

Public Art Strategy

Public art should reflect and reinforce the character of the Green Line

Public art will support identity and wayfinding, specifically at visual termini and special locations

All works will be within City public right-of-way, not in the Hydro Corridor



Master Plan and Site Specific Design Locations

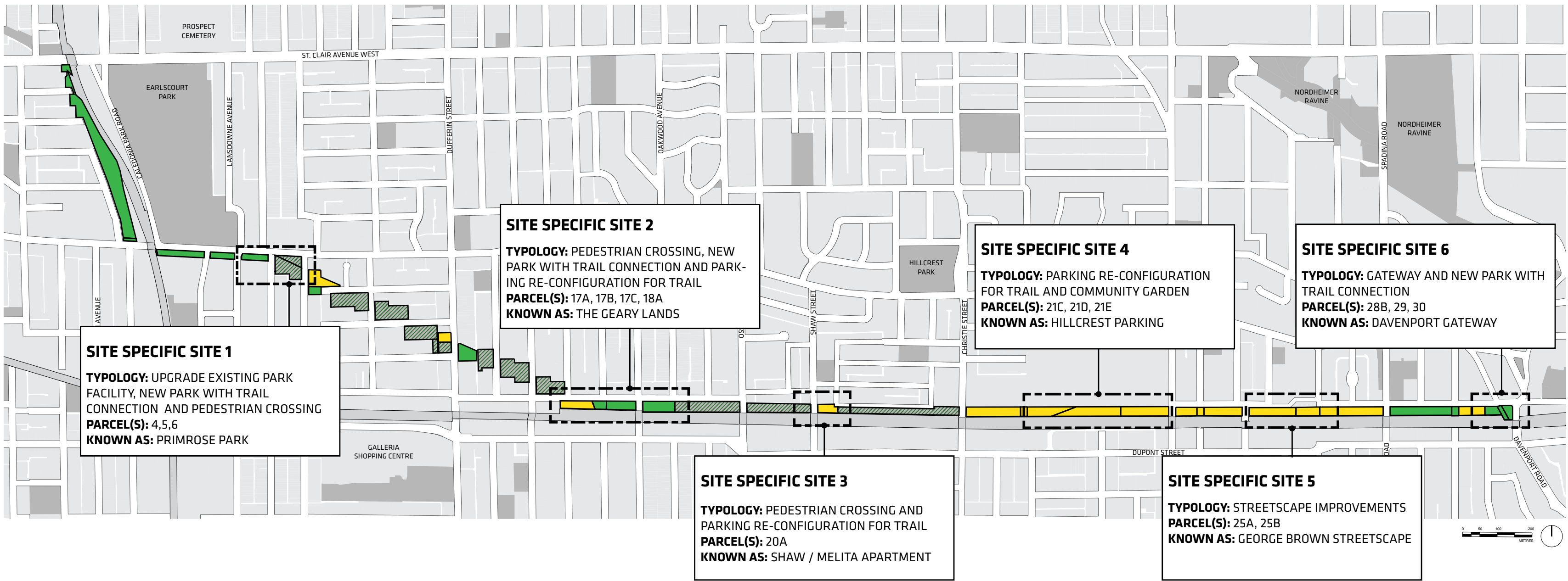

Site 1: Demonstration_Primrose + Davenport

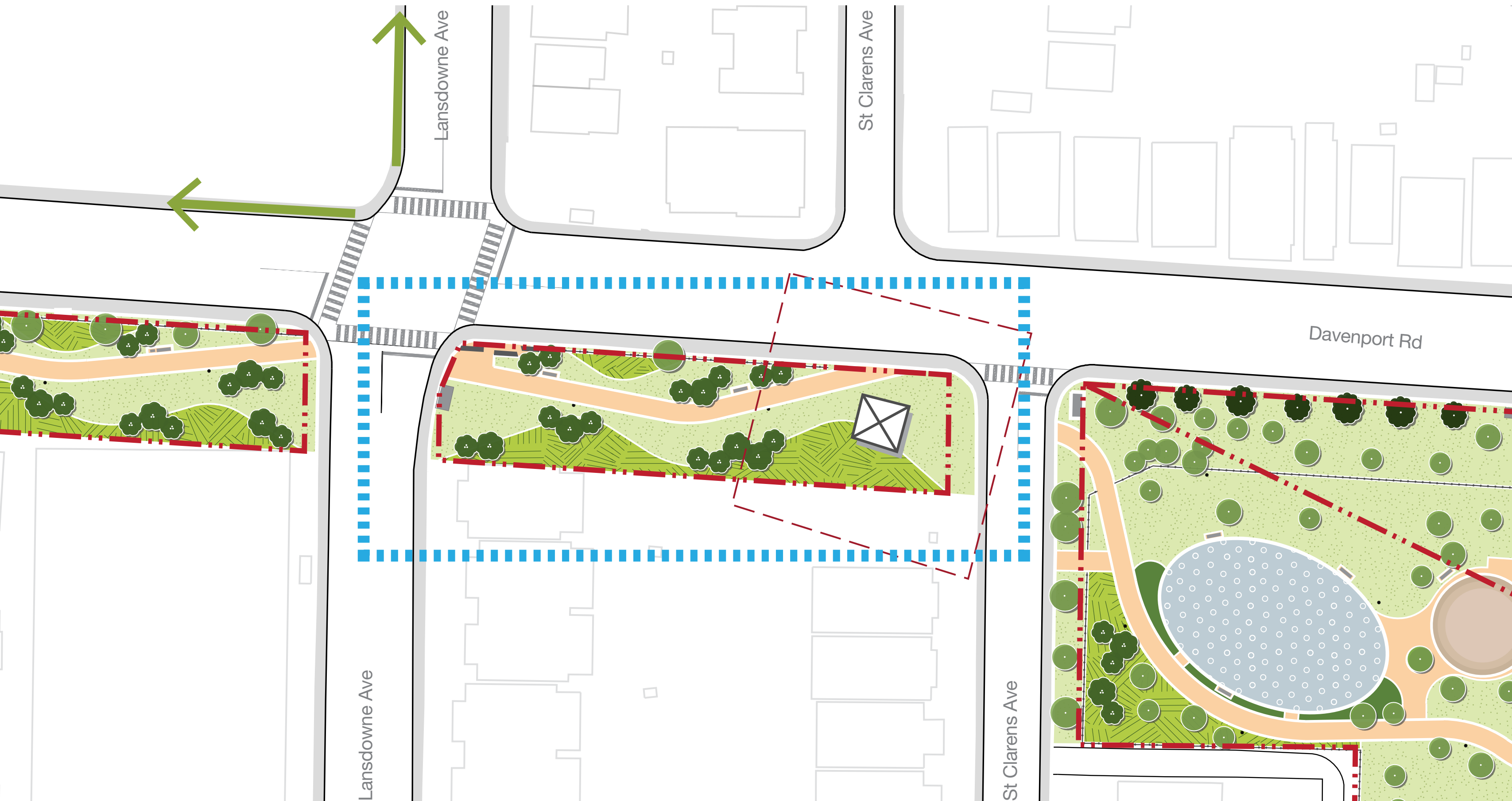

Site 1: Demonstration_Primrose + Davenport

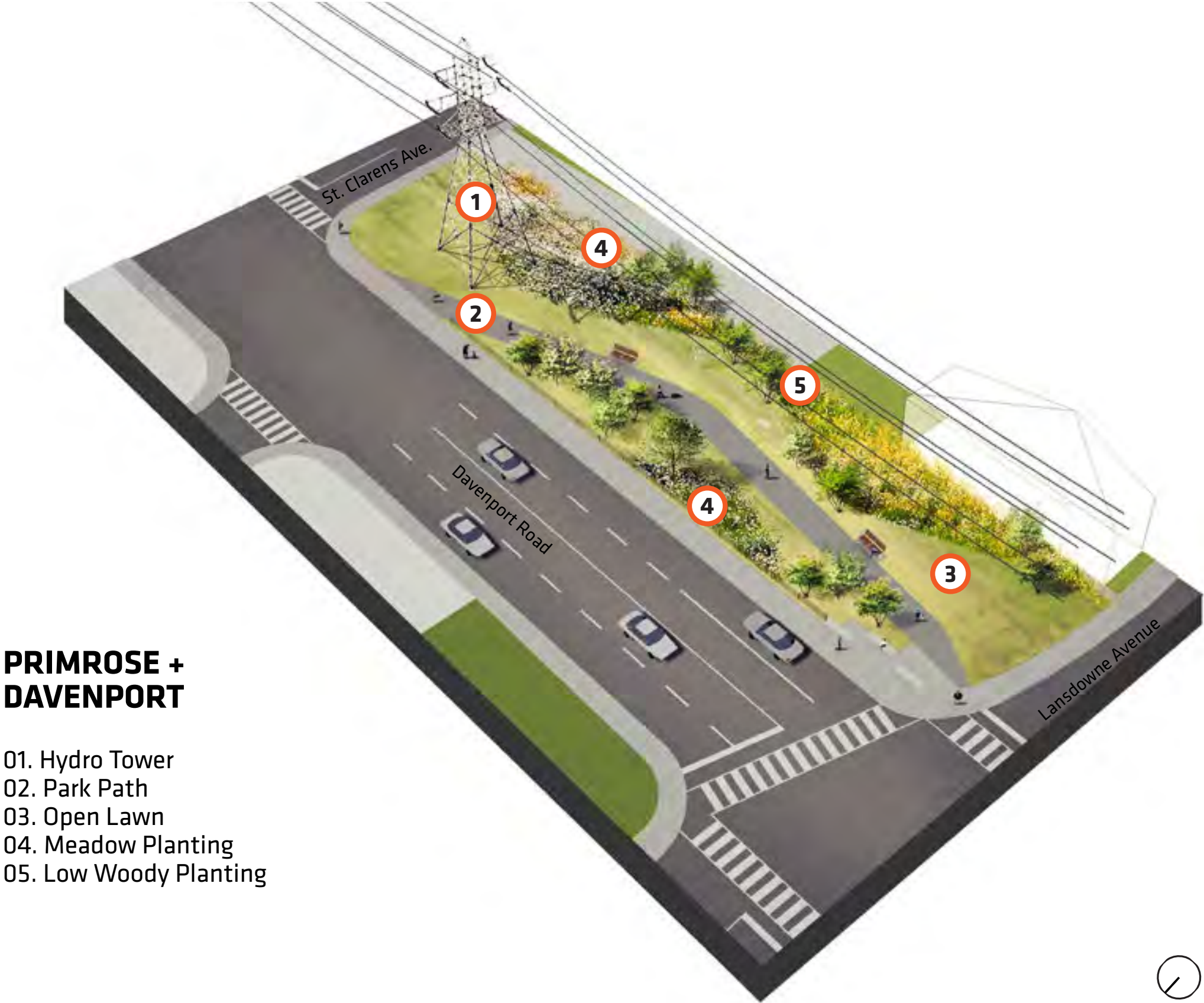

PRIMROSE + DAVENPORT

- 01. Hydro Tower
- 02. Park Path
- 03. Open Lawn
- 04. Meadow Planting
- 05. Low Woody Planting

Site 2: Demonstration_Geary Lands



Site 2: Demonstration_Geary Lands



GEARY LANDS (WEST OF DOVERCOURT)

- 01. Entrance (Type I)
- 02. Entrance (Type II)
- 03. Open Lawn
- 04. Park Path
- 05. Meadow Planting
- 06. Low Woody Planting
- 07. Roadway Narrowing
- 08. Parking Lane
- 09. Curb Extensions
- 10. Rail Corridor



Site 3: Demonstration_Shaw and Melita

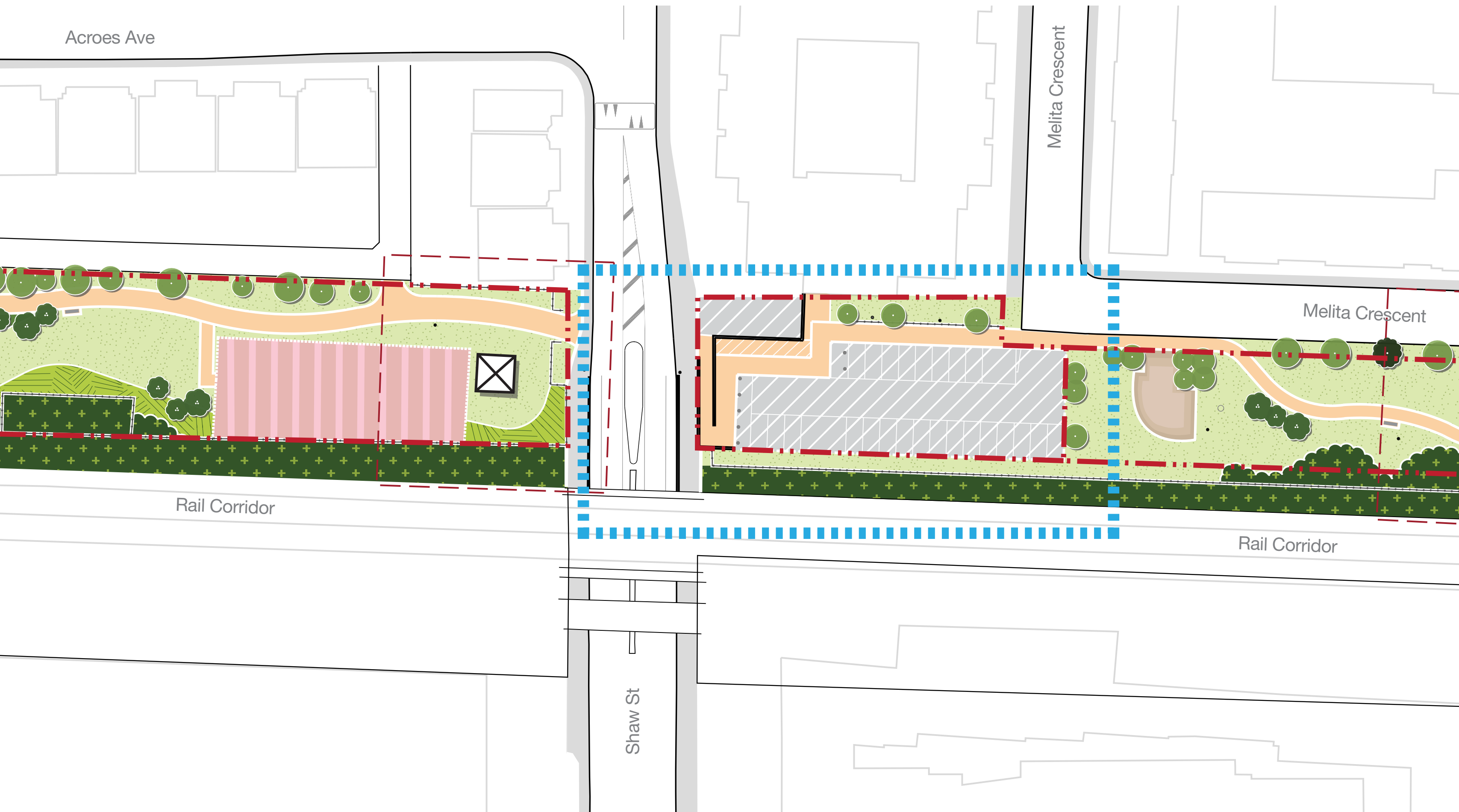

Site 3: Demonstration_Shaw and Melita

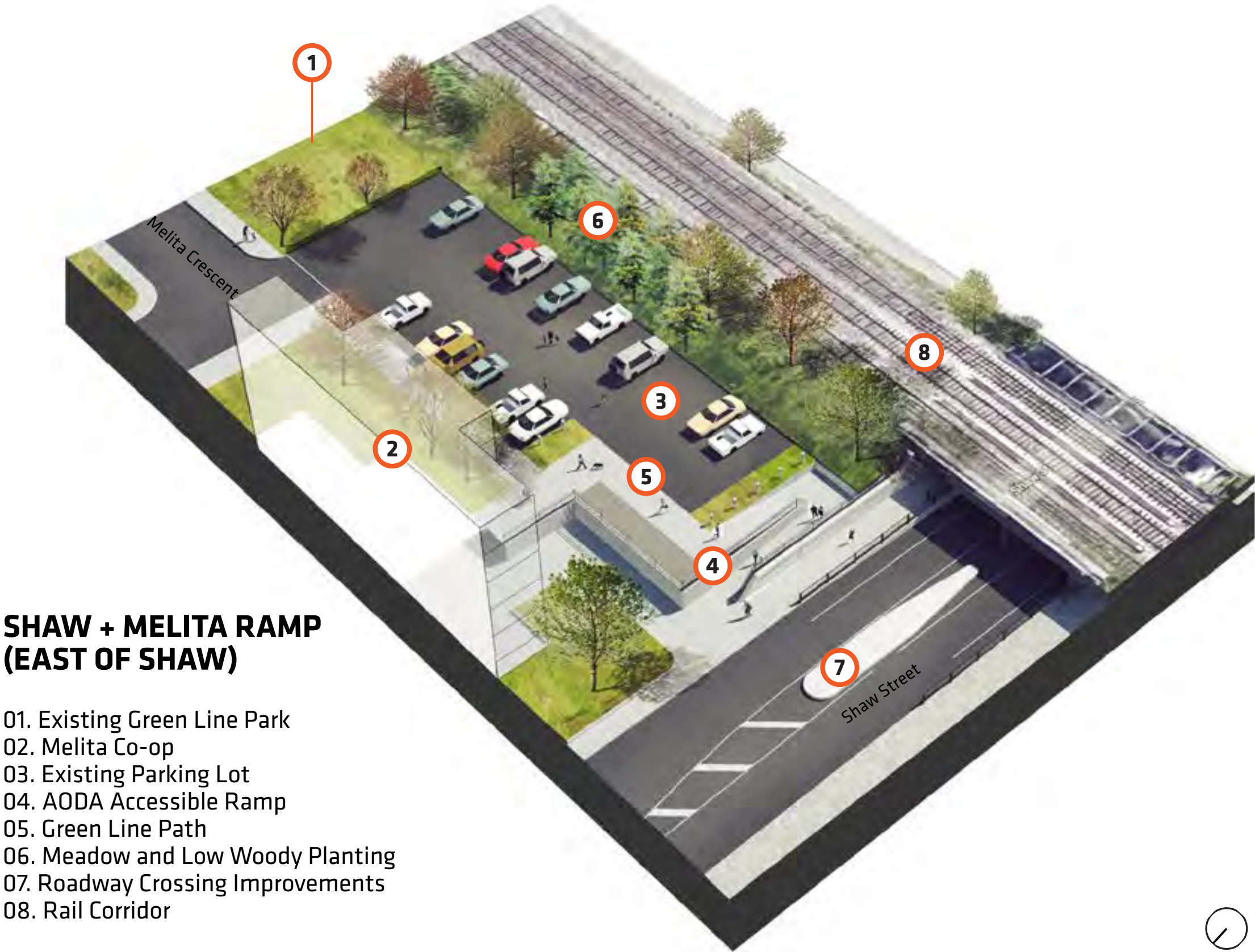

SHAW + MELITA RAMP (EAST OF SHAW)

- 01. Existing Green Line Park
- 02. Melita Co-op
- 03. Existing Parking Lot
- 04. AODA Accessible Ramp
- 05. Green Line Path
- 06. Meadow and Low Woody Planting
- 07. Roadway Crossing Improvements
- 08. Rail Corridor

Site 4: Demonstration_Hillcrest

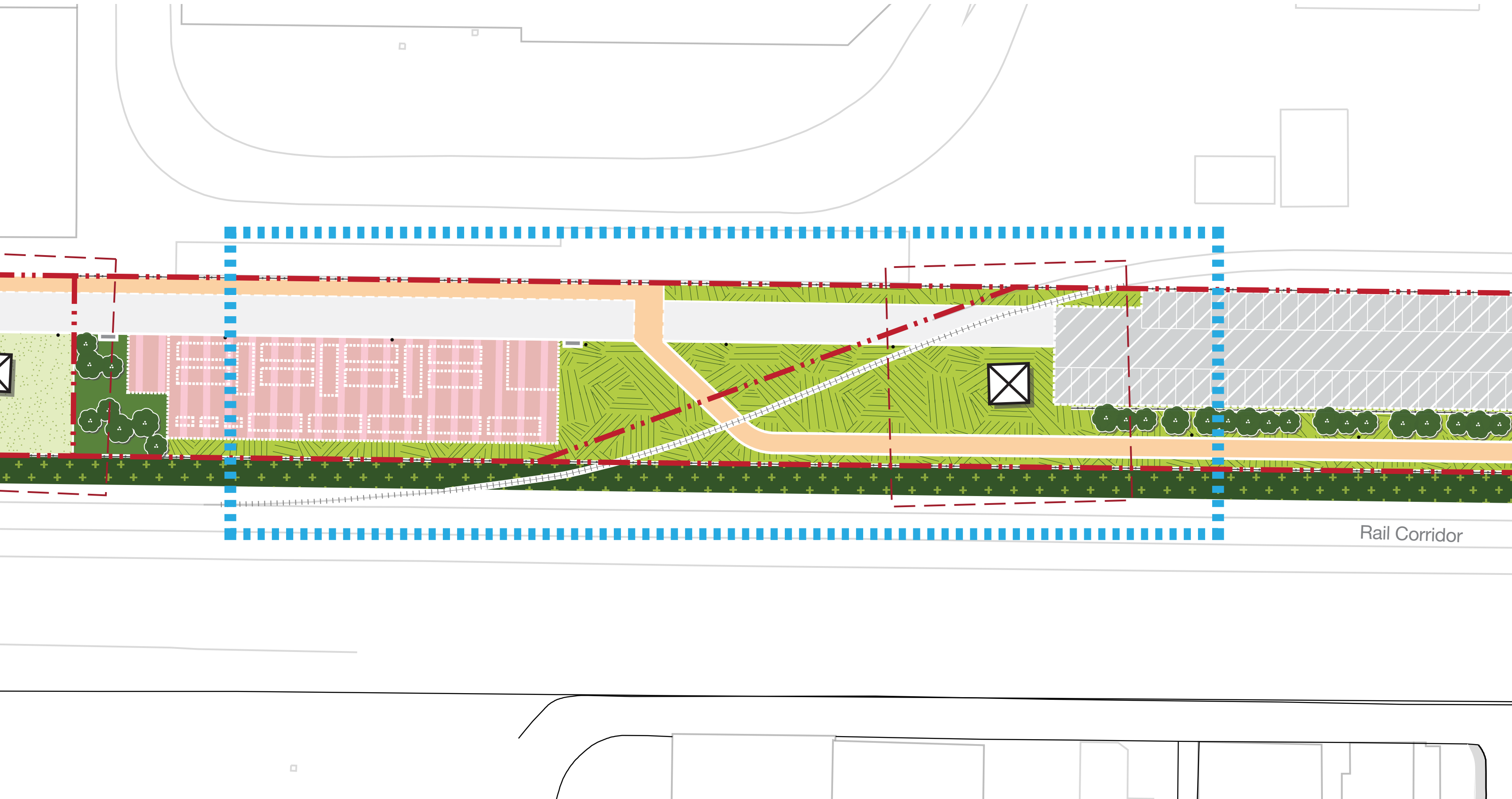

Site 4: Demonstration_Hillcrest

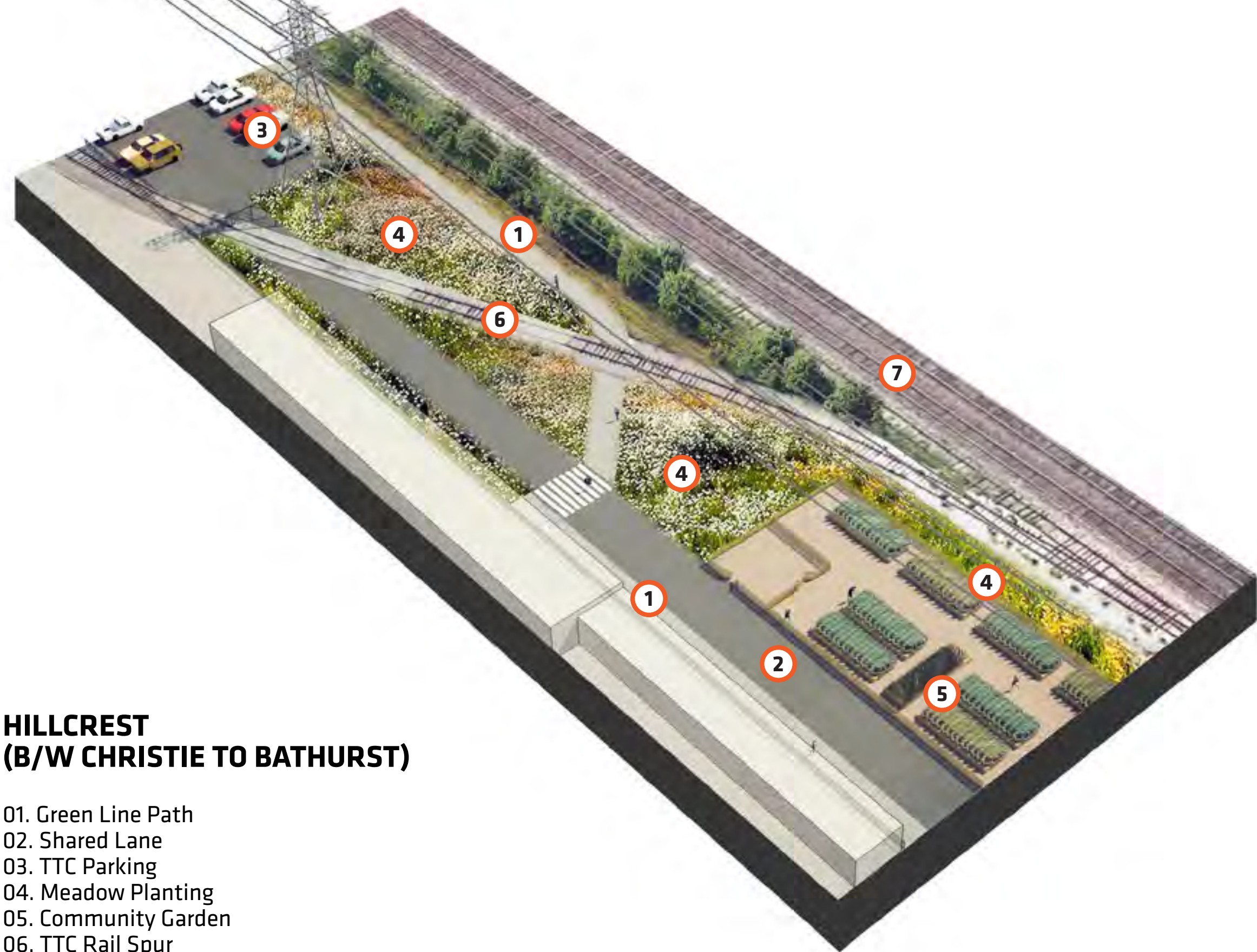

HILLCREST (B/W CHRISTIE TO BATHURST)

- 01. Green Line Path
- 02. Shared Lane
- 03. TTC Parking
- 04. Meadow Planting
- 05. Community Garden
- 06. TTC Rail Spur
- 07. Rail Corridor



Site 5: Demonstration_Bridgman

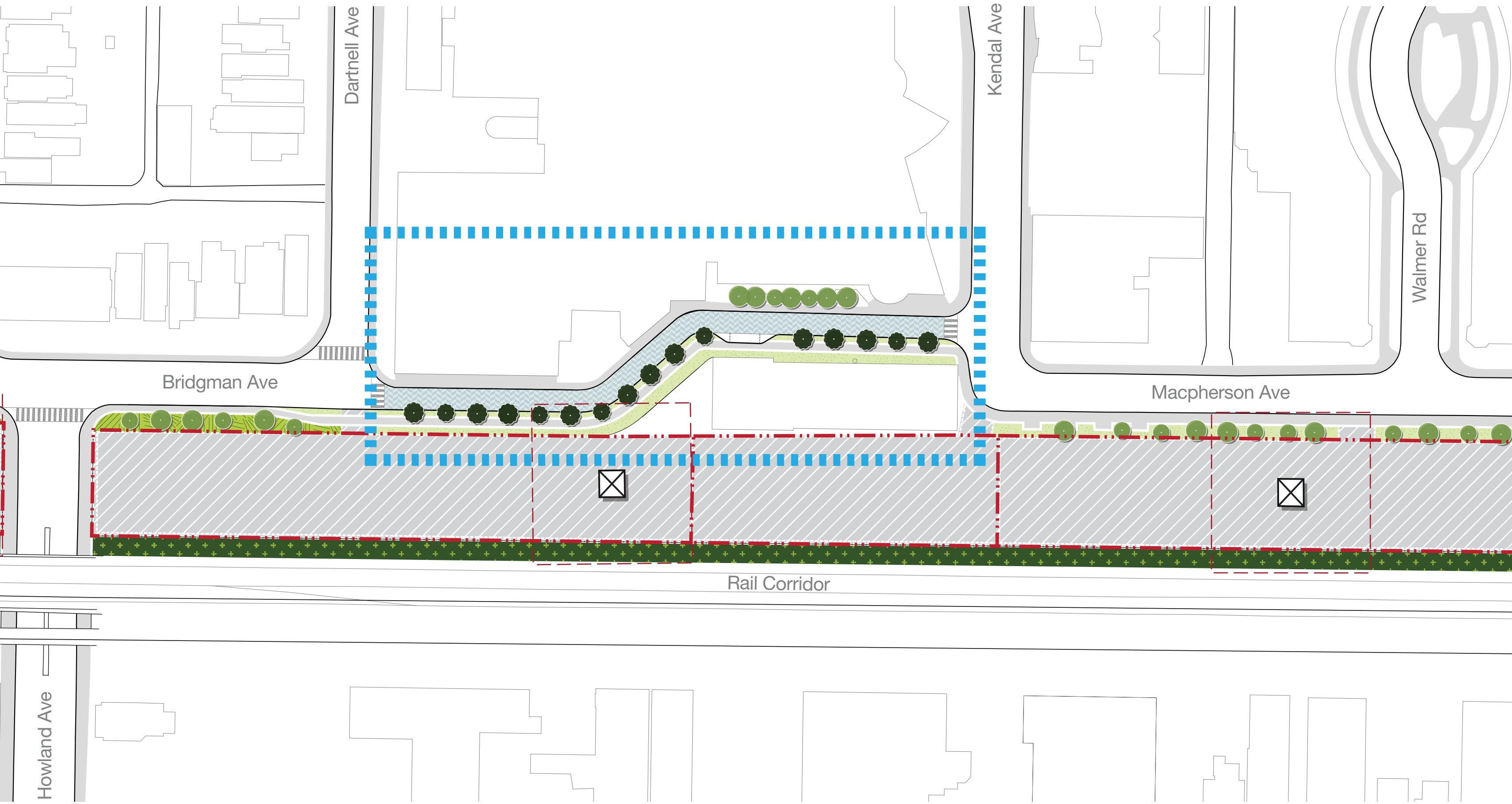

Site 5: Demonstration_Bridgman



BRIDGMAN (WEST OF MACPHERSON)

- 01. New Sidewalk
- 02. Tree Planting
- 03. One-Way Roadway (TBD)
- 04. Quiet Street Bike Route: Sharrow
- 05. Quiet Street Bike Route: Contraflow Bike Lane
- 06. Existing Planting
- 07. Julia West
- 08. George Brown College



Site 6: Demonstration_Lower Davenport



Site 6: Demonstration_Lower Davenport

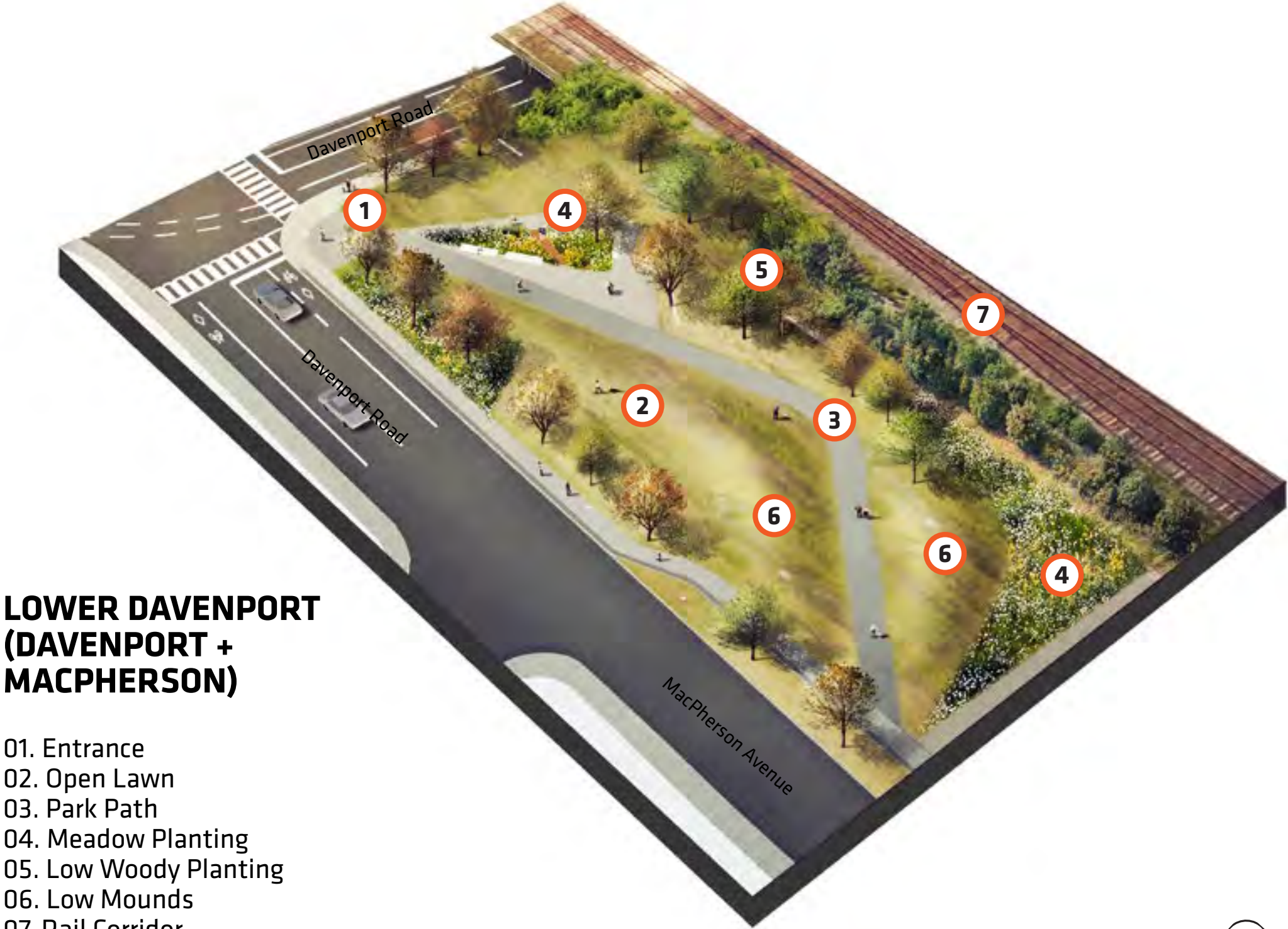

LOWER DAVENPORT (DAVENPORT + MACPHERSON)

- 01. Entrance
- 02. Open Lawn
- 03. Park Path
- 04. Meadow Planting
- 05. Low Woody Planting
- 06. Low Mounds
- 07. Rail Corridor

Green Line: Promise of a More Green Future



Questions for Feedback

1. What do you like best about the Green Line master plan?
2. Which would you rather see the City invest in first within the Green Line? Please pick one.
 - » Development of new parks
 - » Redevelopment of existing parks
 - » Other
3. Which of the existing parks should be redeveloped first?
4. Which of the available parcels is your highest priority for the City to develop as a park?
5. Do you have any comments on the master plan's proposed changes to the roadway and sidewalks at Geary Avenue or Bridgman Avenue?
6. How can the Green Line master plan be improved?

A photograph of a park area. In the foreground, there are green plants with yellow flowers. Behind them is a black metal fence. In the middle ground, there is a concrete wall with a mural of green grass and trees. Above the wall is a black metal fence. In the background, there are green trees, a large metal power line tower, and a cloudy sky. On the right side, there is a building and a large pipe.

FINI