

APPENDIX N

ALTERNATIVE DESIGN PLANS

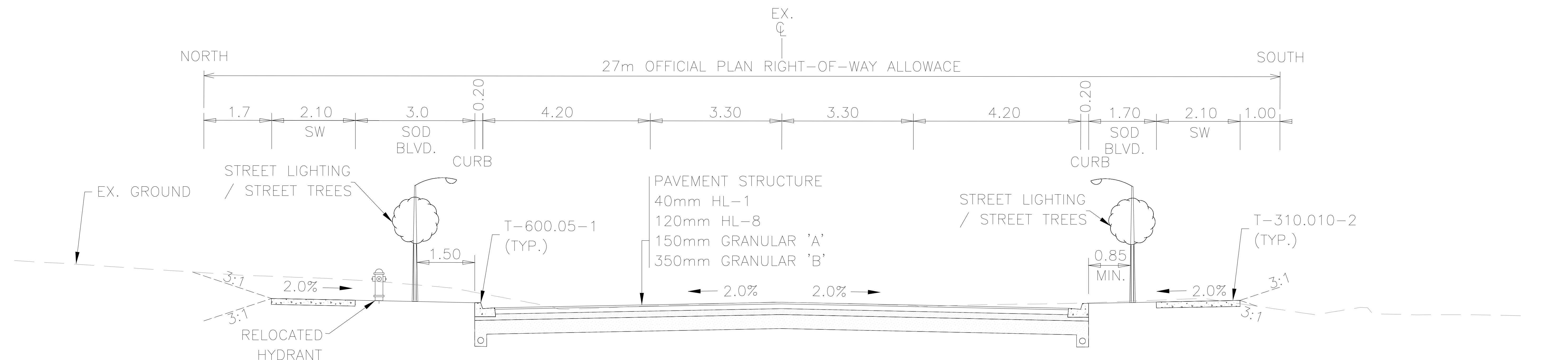

TYPICAL SECTION BETWEEN STA. 0+835 TO STA. 1+167
N.T.S.

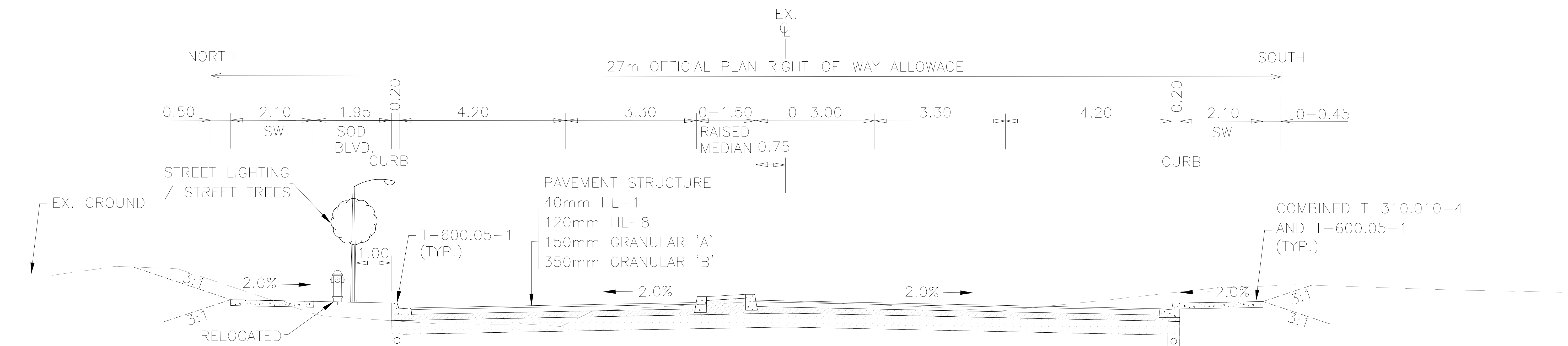

TYPICAL SECTION APPROACHING MARKHAM ROAD INTERSECTION
STA. 1+167 TO STA. 1+337
N.T.S.



MORRISON HERSHFIELD

PASSMORE AVENUE IMPROVEMENTS CLASS ENVIRONMENT ASSESSMENT

**DRAFT TYPICAL CROSS-SECTIONS - ALTERNATIVE 4-A - DUAL SIDEWALKS
WIDEN PASSMORE AVENUE TO 4 LANES (3.3m INSIDE LANES, 4.2m CURB LANES)**

SCALE
1:100

DATE
AUGUST 9 2017

SHEET No.
1 of 6

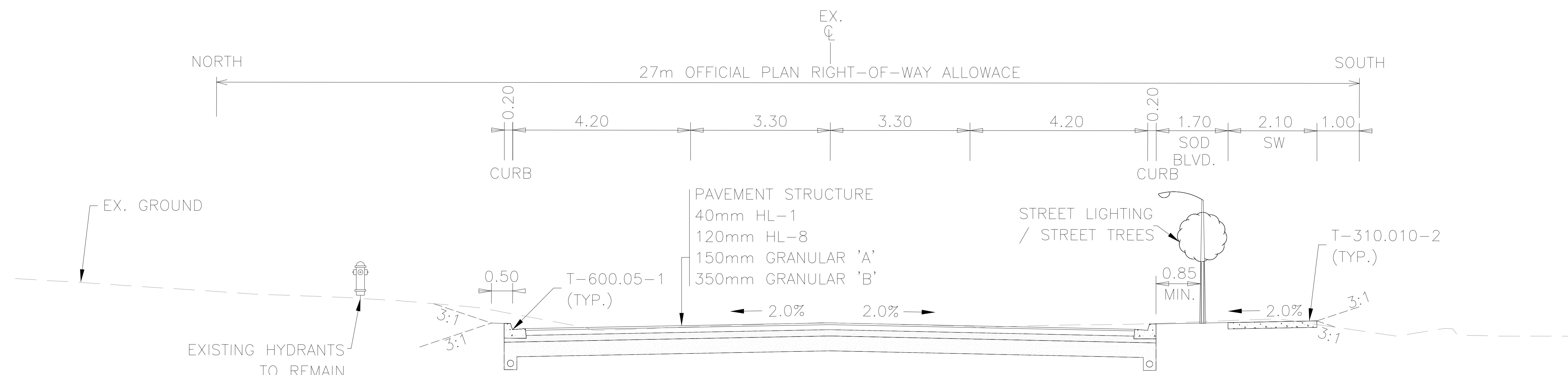

TYPICAL SECTION BETWEEN STA. 0+835 TO STA. 1+167
N.T.S.

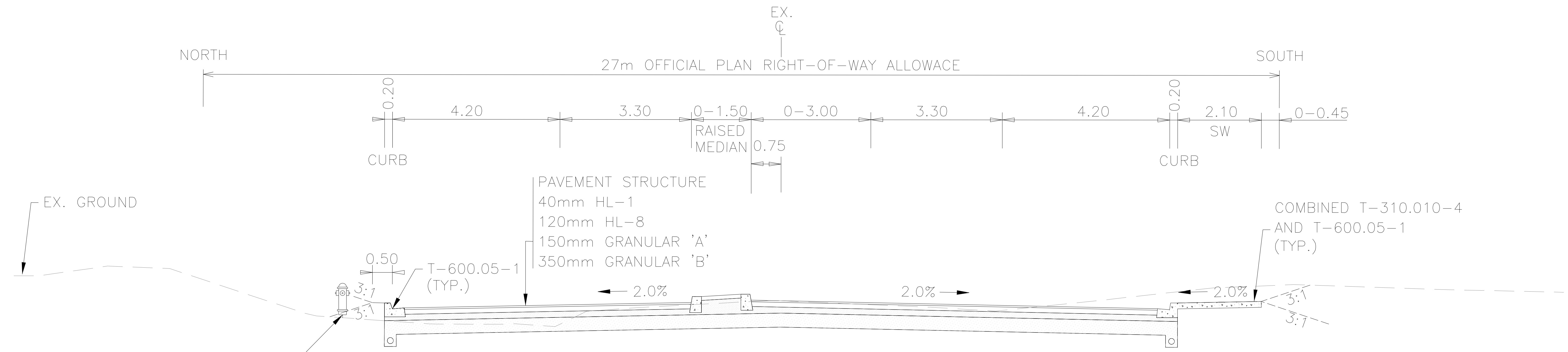

TYPICAL SECTION APPROACHING MARKHAM ROAD INTERSECTION
STA. 1+167 TO STA. 1+337
N.T.S.



MORRISON HERSHFIELD

PASSMORE AVENUE IMPROVEMENTS CLASS ENVIRONMENT ASSESSMENT

DRAFT TYPICAL CROSS-SECTIONS - ALTERNATIVE 4-A - NO NORTH SIDEWALK
WIDEN PASSMORE AVENUE TO 4 LANES (3.3m INSIDE LANES, 4.2m CURB LANES)

SCALE 1:100
DATE AUGUST 9 2017
SHEET No. 2 of 6

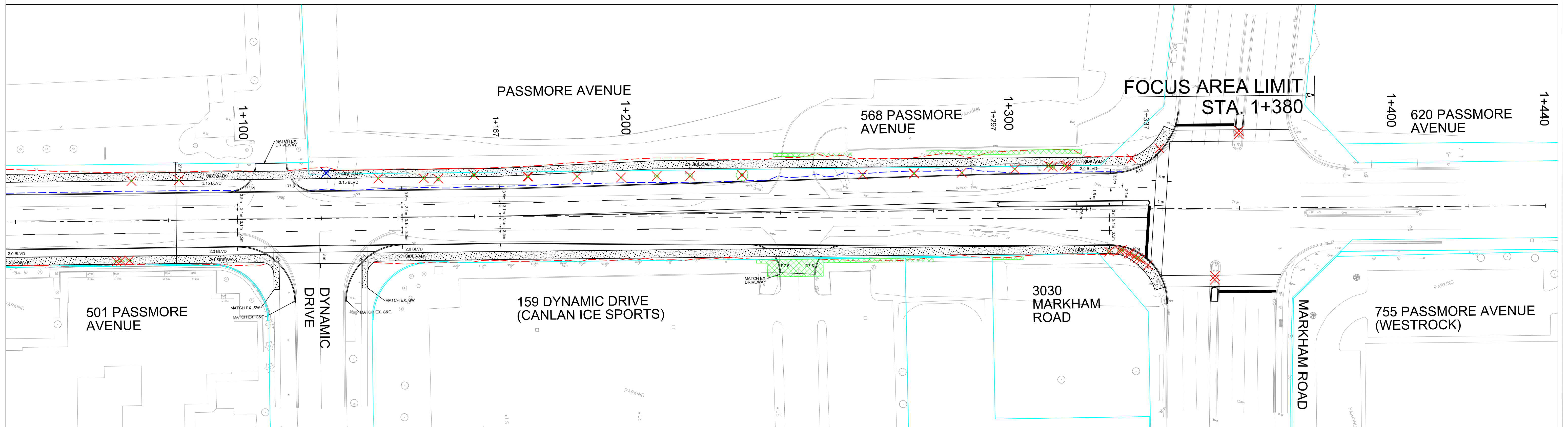
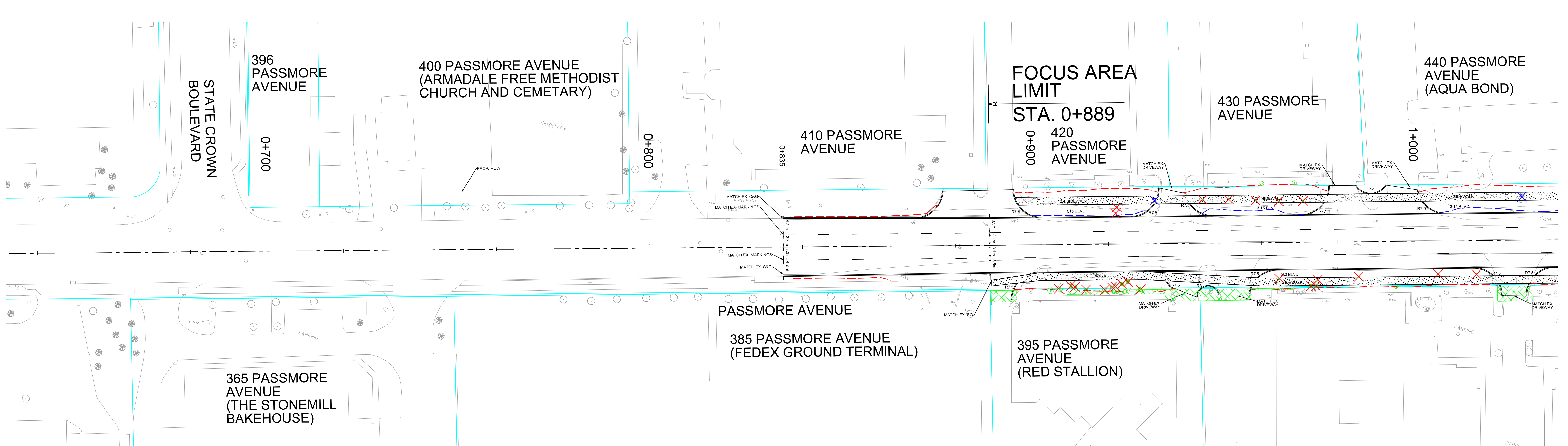

PASSMORE AVENUE ROAD WIDENING EA

ALTERNATIVE DESIGNS 4-B

IMPACT ASSESSMENT

LEGEND

PROP. ROW (JAN 2016)	---	TEMP. EASEMENT	[Green Hatched Box]
EX. ROW	---	IMPACTED FEATURE	[Red X]
LIMIT OF GRADING	---	IMPACTED HYDRANT	[Blue X]
LIMIT OF GRADING (NO NORTH SIDEWALK)	---		

SCALE	1:500
DATE	AUG 22 2017
SHEET No.	2 OF 3

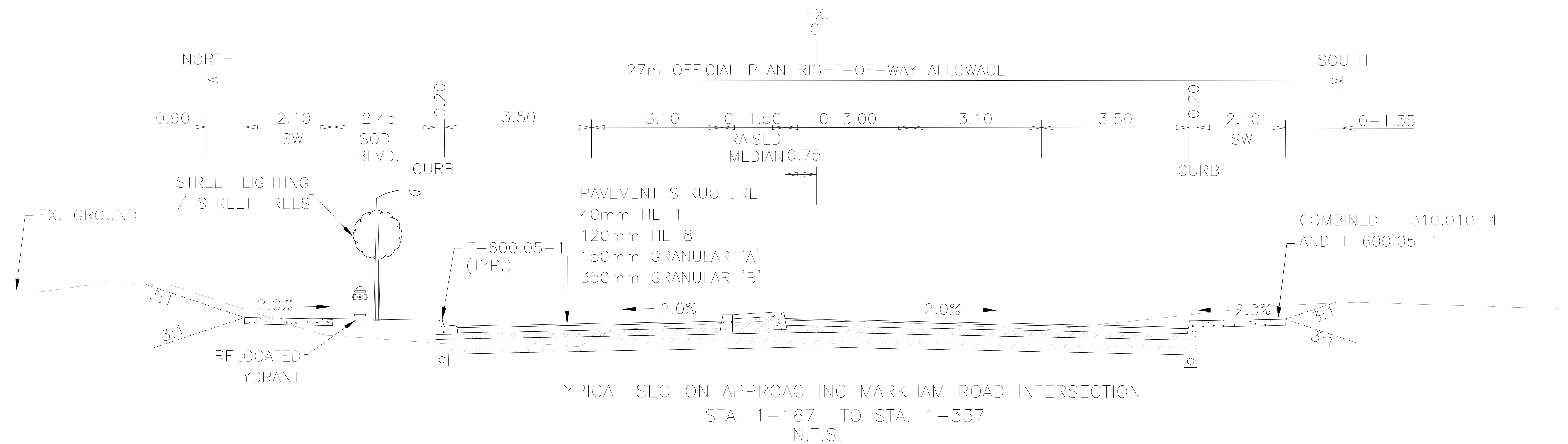
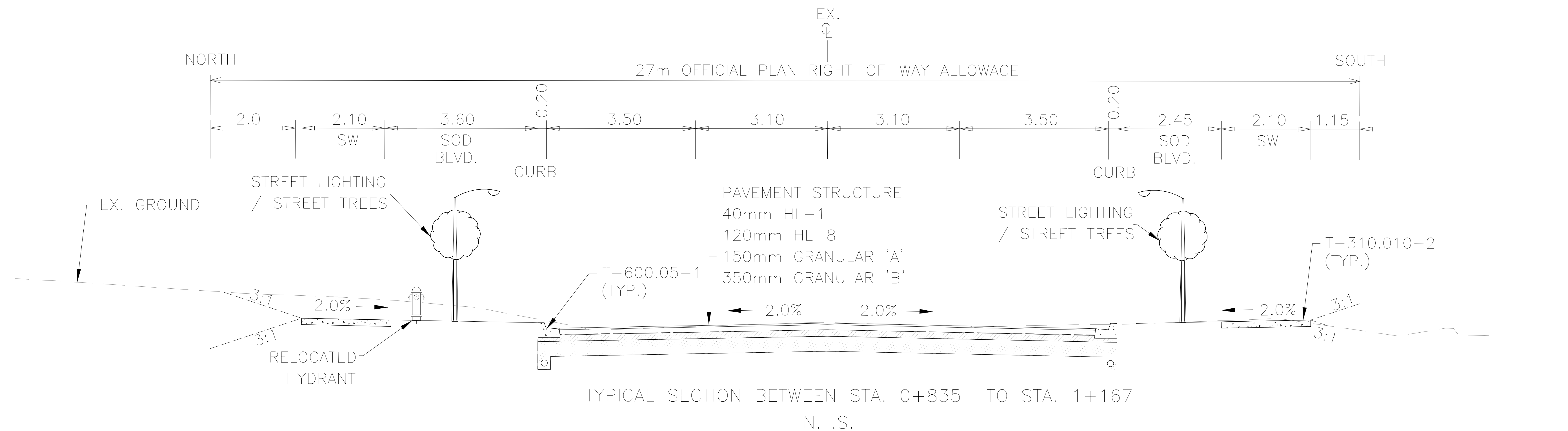

MORRISON HERSHFIELD

PASSMORE AVENUE IMPROVEMENTS CLASS ENVIRONMENT ASSESSMENT

**DRAFT TYPICAL CROSS-SECTIONS - ALTERNATIVES 4-B - DUAL SIDEWALKS
WIDEN PASSMORE AVENUE TO 4 LANES (3.10m INSIDE LANES, 3.50m CURB LANES)**

SCALE
1:100

DATE
AUGUST 9 2017

SHEET No.
3 of 6

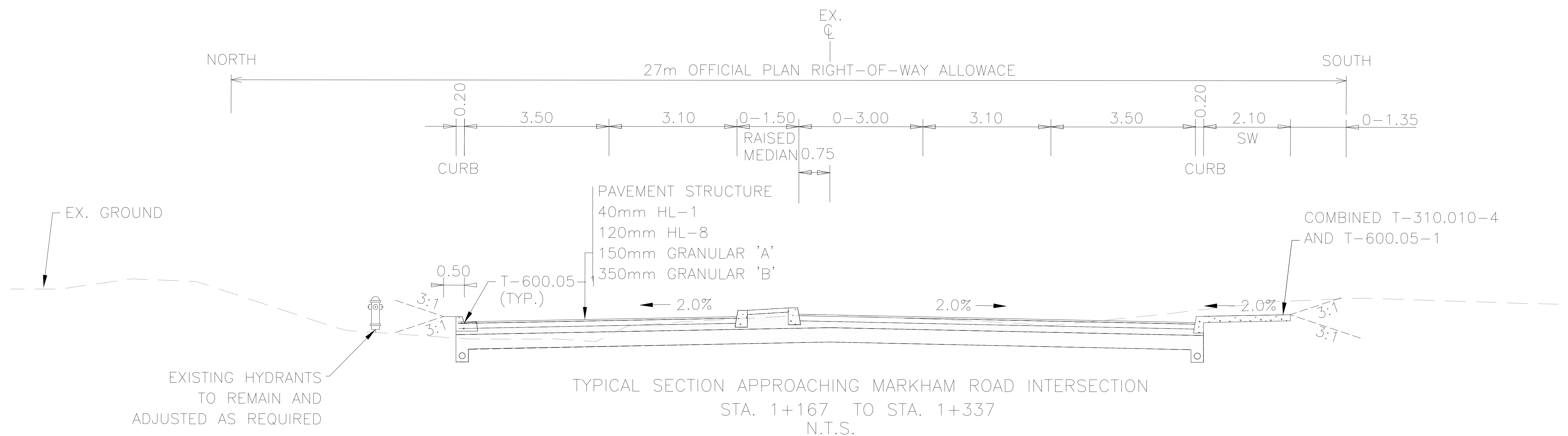
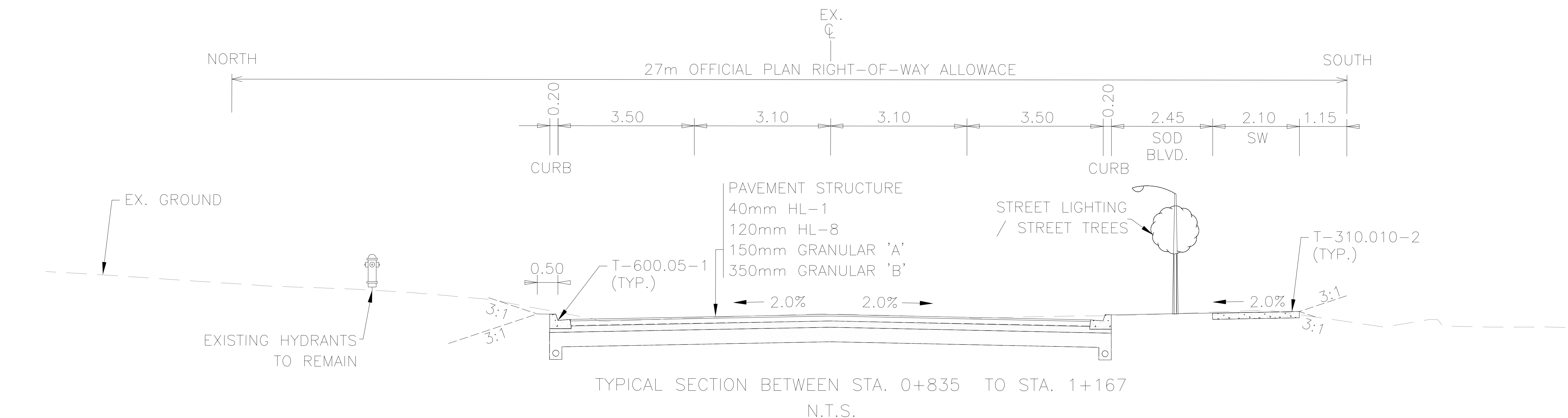

MORRISON HERSHFIELD

PASSMORE AVENUE IMPROVEMENTS CLASS ENVIRONMENT ASSESSMENT

**DRAFT TYPICAL CROSS-SECTIONS - ALTERNATIVES 4-B - NO NORTH SIDEWALK
WIDEN PASSMORE AVENUE TO 4 LANES (3.10m INSIDE LANES, 3.50m CURB LANES)**

SCALE
1:100

DATE
AUGUST 9 2017

SHEET No.
4 of 6

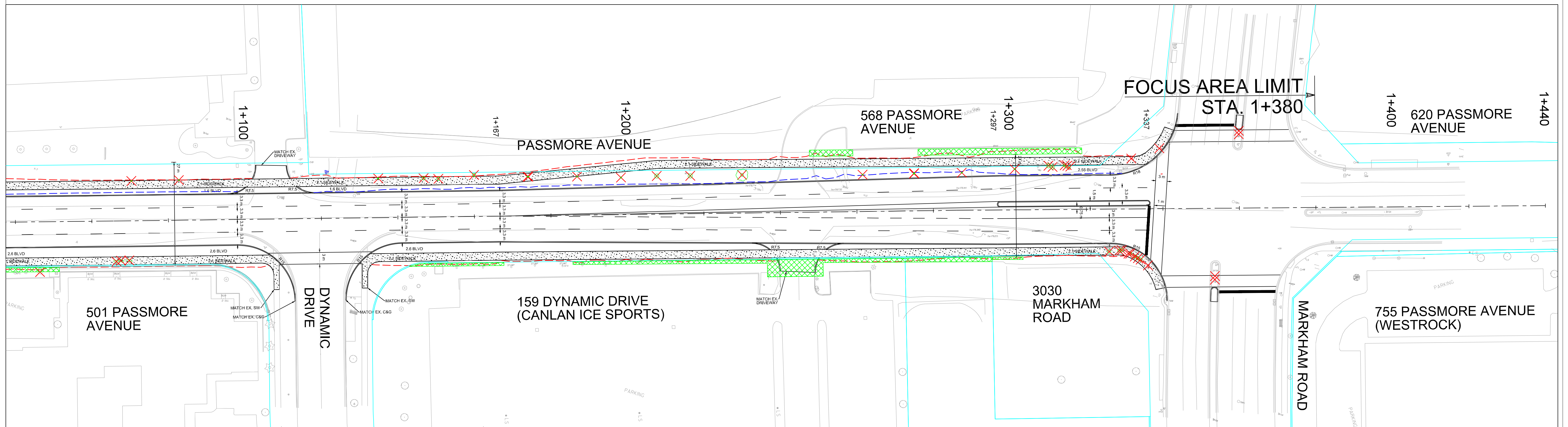
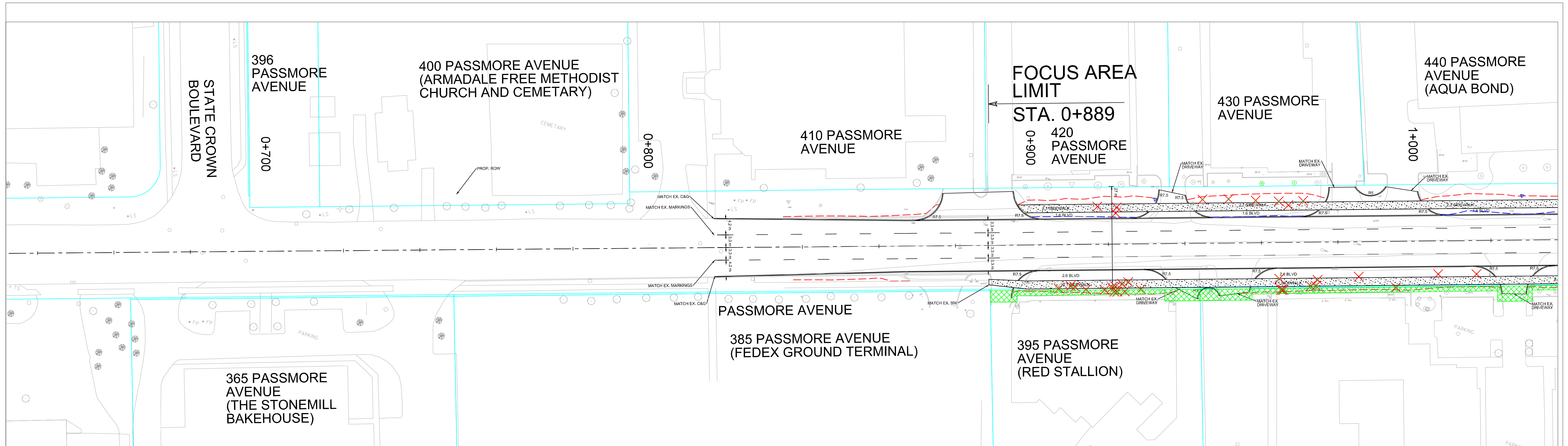

PASSMORE AVENUE ROAD WIDENING EA

ALTERNATIVE DESIGNS 4-C

IMPACT ASSESSMENT

LEGEND	
PROP. ROW (JAN 2016)	---
EX. ROW	---
LIMIT OF GRADING	---
LIMIT OF GRADING (NO NORTH SIDEWALK)	---
TEMP. EASEMENT	---
IMPACTED FEATURE	---
IMPACTED HYDRANT	---

SCALE	1:500
DATE	AUG 22 2017
SHEET No.	3 OF 3

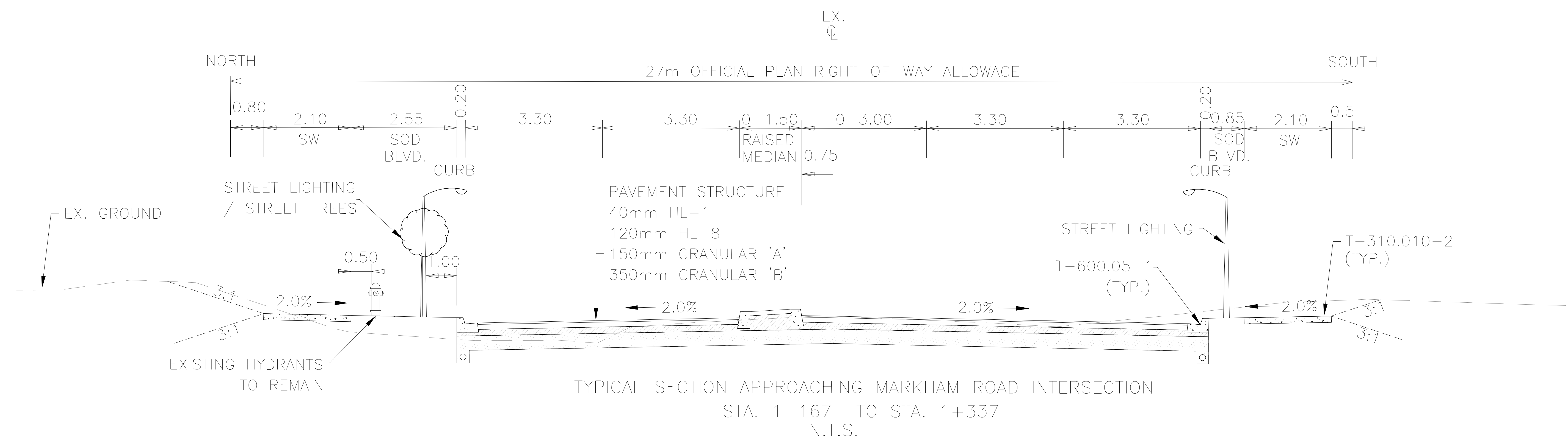
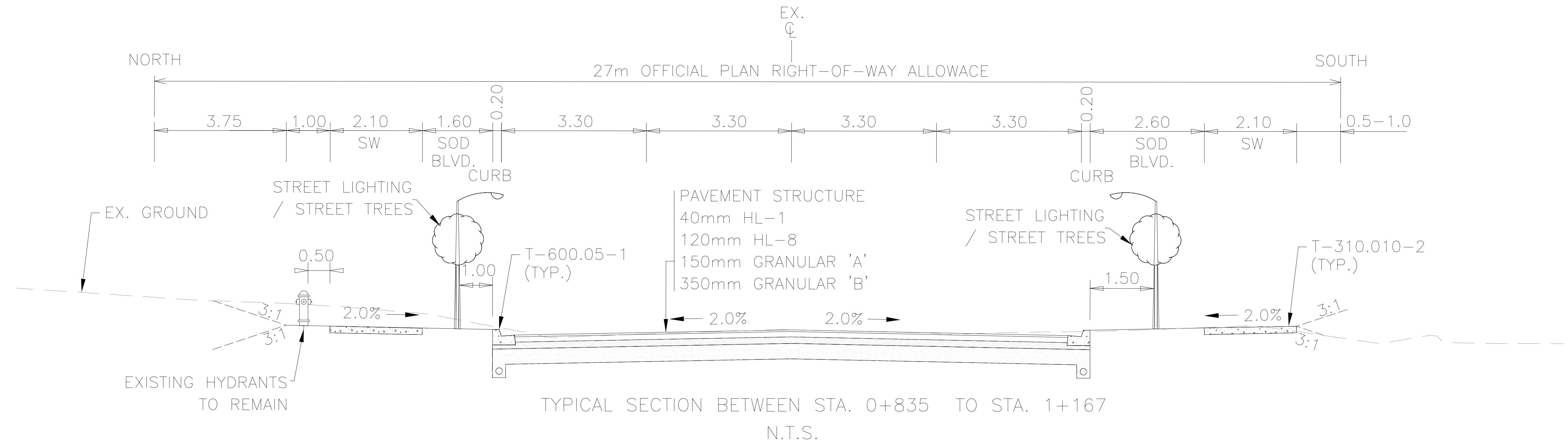

MORRISON HERSHFIELD

PASSMORE AVENUE IMPROVEMENTS CLASS ENVIRONMENT ASSESSMENT

DRAFT TYPICAL CROSS-SECTIONS - ALTERNATIVES 4-C - DUAL SIDEWALKS
WIDEN PASSMORE AVENUE TO 4 LANES (3.30m INSIDE LANES, 3.30m CURB LANES)

SCALE
1:100

DATE
AUGUST 9 2017

SHEET No.
5 of 6

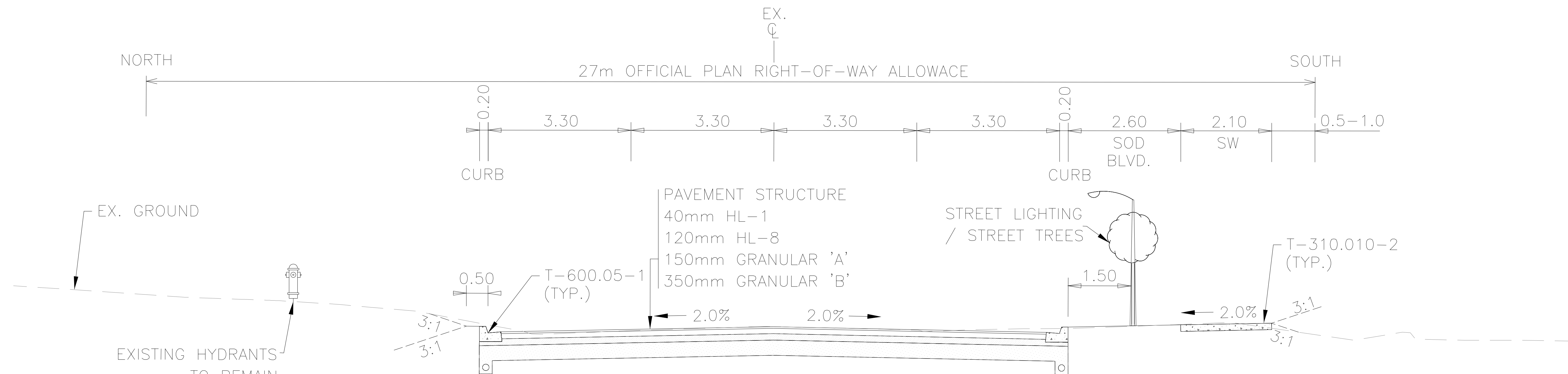

TYPICAL SECTION BETWEEN STA. 0+835 TO STA. 1+167
N.T.S.

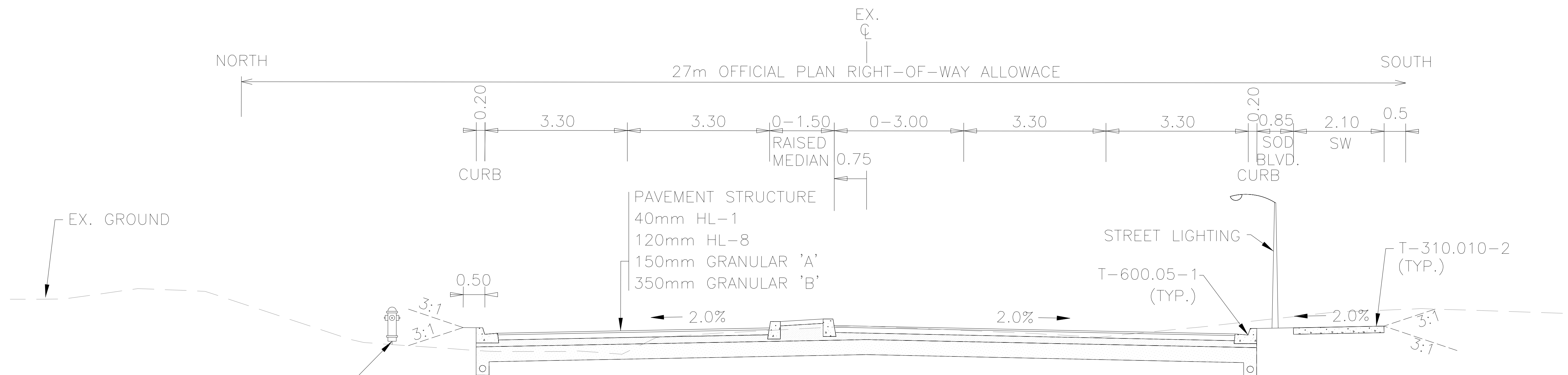

TYPICAL SECTION APPROACHING MARKHAM ROAD INTERSECTION
STA. 1+167 TO STA. 1+337
N.T.S.



MORRISON HERSHFIELD

PASSMORE AVENUE IMPROVEMENTS CLASS ENVIRONMENT ASSESSMENT

DRAFT TYPICAL CROSS-SECTIONS - ALTERNATIVES 4-C - NO NORTH SIDEWALK
WIDEN PASSMORE AVENUE TO 4 LANES (3.30m INSIDE LANES, 3.30m CURB LANES)

SCALE
1:100

DATE
AUGUST 9 2017

SHEET No.
6 of 6