

NOTE: JOINTS SHALL BE SKEWED TO ALLOW LEFT WHEEL OF VEHICLES TO STRIKE JOINT FIRST.

**PLAN**

EXPANSION JOINTS TO ISOLATE THE INTERSECTION (TYPICAL)

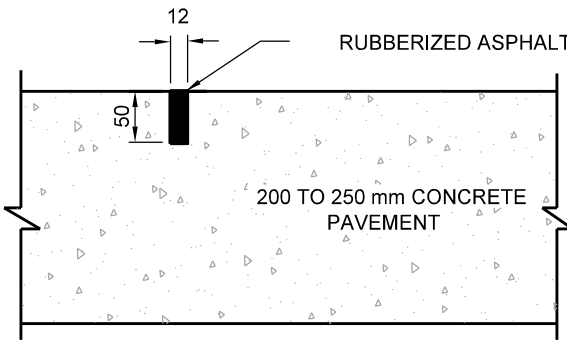

**CONTRACTION JOINT**

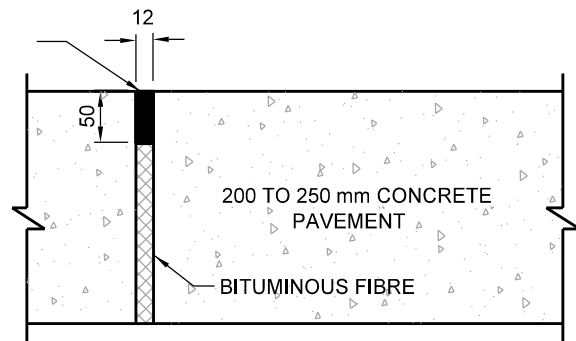

**EXPANSION JOINT**

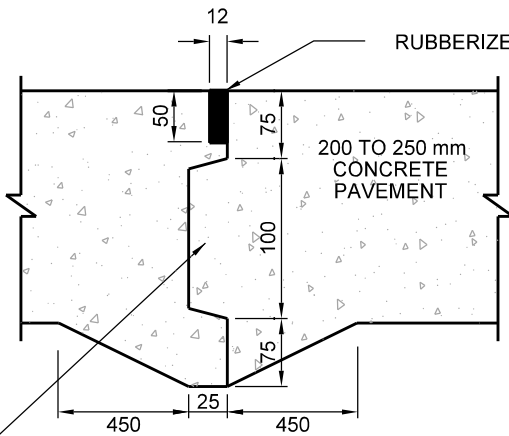

TONGUE SECTION OF JOINT SHALL BE CONSTRUCTED FIRST

**CONSTRUCTION JOINT**

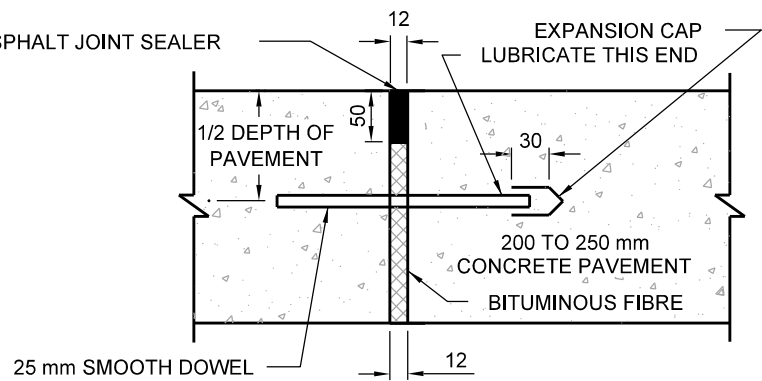

**TRANSVERSE CONTRACTION JOINT FOR ARTERIAL ROADS OR AS SPECIFIED**

**NOTES:**

1. PLACE STEEL MESH 100 x 100 @ 1.5 kg / m AROUND MAINTENANCE HOLES AND CATCHBASINS TO COVER AREA ENCLOSED BY 1.5 m FROM THE APPURTENANCE, AND BE CLEAR OF JOINTS BY 150 mm.
2. RECONSTRUCTION SHOULD BE CARRIED FURTHER TO THE NEXT JOINT.

All dimensions are in millimetres unless otherwise shown.



ENGINEERING & CONSTRUCTION SERVICES STANDARD DRAWING

**LOCATION AND DETAIL OF JOINTS FOR RIGID PAVEMENTS**

REV 1

NOV 2014

**T-216.02-3**

NTS

SHEET 1