

NOT MORE THAN 5 m BETWEEN LONGITUDINAL CONSTRUCTION OR CONTRACTION JOINTS.

NOTE: JOINTS SHALL BE SKEWED TO ALLOW LEFT WHEEL OF VEHICLES TO STRIKE JOINT FIRST.

### PLAN

EXPANSION JOINTS TO ISOLATE THE INTERSECTION (TYPICAL)

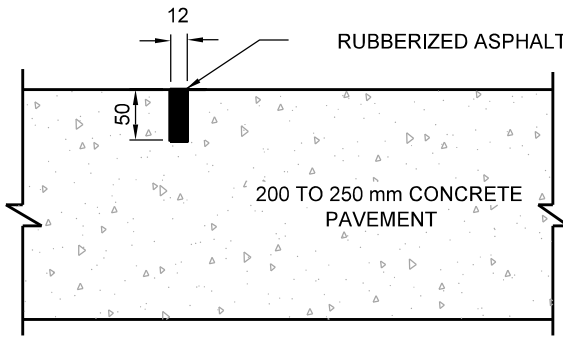

### CONTRACTION JOINT

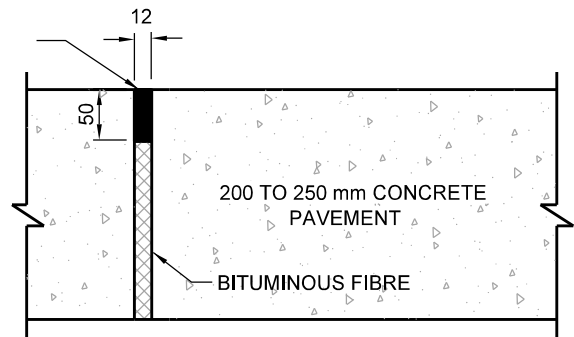

### EXPANSION JOINT

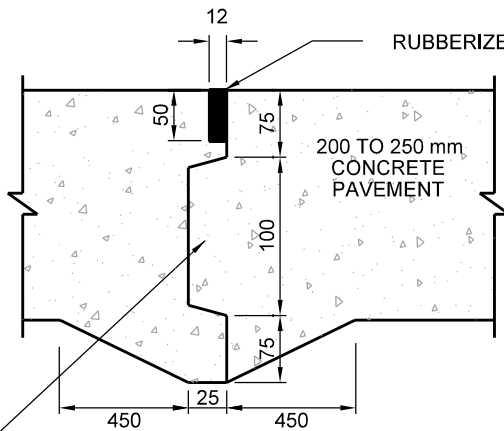

TONGUE SECTION OF JOINT SHALL BE CONSTRUCTED FIRST

### CONSTRUCTION JOINT

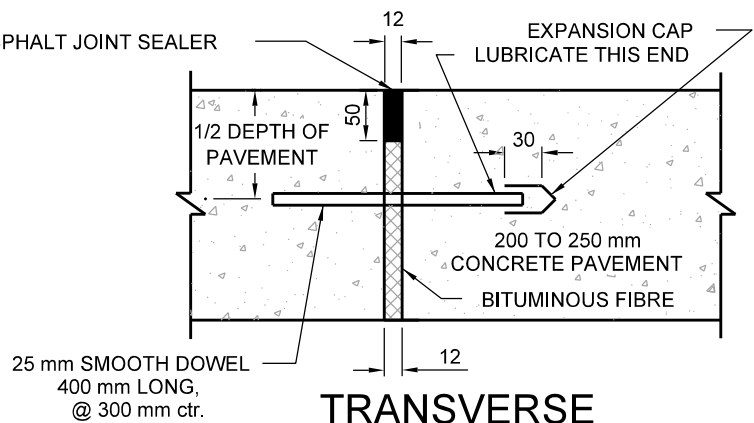

25 mm SMOOTH DOWEL  
400 mm LONG,  
@ 300 mm ctr.

### TRANSVERSE CONTRACTION JOINT FOR ARTERIAL ROADS OR AS SPECIFIED

#### NOTES:

1. PLACE STEEL MESH 102 x 102 @ 2.02 kg / m<sup>2</sup> AROUND MAINTENANCE HOLES AND CATCHBASINS TO COVER AREA ENCLOSED BY 1.5 m FROM THE APPURTENANCE, AND BE CLEAR OF JOINTS BY 150 mm.
2. RECONSTRUCTION SHOULD BE CARRIED FURTHER TO THE NEXT JOINT.

All dimensions are in millimetres unless otherwise shown.



ENGINEERING & CONSTRUCTION SERVICES STANDARD DRAWING

REV 2

SEP 2019

## LOCATION AND DETAIL OF JOINTS FOR RIGID PAVEMENTS

T-216.02-3

NTS

SHEET 1