

# Centennial Park Master Plan Update

## Youth Workshop

Engagement Summary Report

July 25, 2020



(Image of concept rendering for the Centennial Park Master Plan Update, July 2020)

Prepared by:



# Table of Contents

<b>1.0 What is the Centennial Park Master Plan Update</b>	3
Report Summary	3
Meeting Details	3
Meeting Overview	4
Meeting Objectives	6
Centennial Park Master Plan Update: Project Themes	7
<b>2.0 Anti-Black Racism, Inclusion, and Equity within Centennial Park</b>	8
<b>3.0 Indigenous Consultation and Cultural Competency Training</b>	9
<b>4.0 KEY TAKEAWAYS: Youth Workshop #2</b>	11
<b>5.0 Detailed Summary of Feedback</b>	12
Overview of Activities:	12
Activity 1: Site-Wide Concepts	13
Activity 2: Site-Specific Design	21
 Appendix A: Meeting Question and Answer Period	 30
Appendix B: Parks, Forestry, & Recreation Division's Response to Anti-Black Racism Question	 32
Appendix C: Scribble Boards for Site-Specific Design Concepts	33

## 1.0 What is the Centennial Park Master Plan Update

The City is working on a Master Plan Update for Centennial Park to guide infrastructure improvements and other changes over the next 20 years. The updated Master Plan will respond to programmatic needs as well as the realities of climate change by integrating a resilience lens (i.e., building and park operations, impacts of severe storms). The master planning process aims to engage a diverse set of users to better understand the different needs and preferences and better serve users of the park, including those from the local area and broader citywide users.

### Report Summary

The purpose of this report is to summarize the Youth Workshop for the Centennial Park Master Plan Update that was held on July 25, 2020. This report provides an overview of the meeting, including objectives, the four themes or “stories” of Centennial Park identified by the Project Team, the City’s response to anti-Black Racism within the Master Plan, an overview of Indigenous Cultural Competency Training and resources and a summary of key feedback and findings from the consultation event.

### Meeting Details

**When:** July 25, 2020, 1:30 - 3:30 PM

**Where:** Virtually on Zoom

**Attendees:**

Participants: 16 youth participants were in attendance.

Consultant Team: PMA Landscape Architects, the landscape architecture team  
PROCESS, Engagement team

City of Toronto: Casey Morris, Senior Project Coordinator, Parks Forestry & Recreation  
Daniel Fusca, Manager, Public Consultation, Parks Forestry & Recreation  
David O’Hara, Project Manager, Capital Construction Special Projects  
Pablo Muñoz, Senior Consultation Coordinator, Parks Forestry & Recreation  
Alex Lavasidis, Senior Consultation Coordinator, Parks Forestry & Recreation

## Meeting Overview

The virtual meeting took place over Zoom, see **Figure 1: Youth Workshop on Zoom.**

The meeting began with a general welcome and a land and anti-racism acknowledgement. Next, youth engaged in an interactive [Indigenous Cultural Training](#) led by Trina Moyan Bell.

Afterwards, the Design Team (PMA Landscape Architects) presented on what the Project Team has heard to date from stakeholders and the public since March 2020 and presented the emerging design concepts for the Master Plan Update. During the presentation, the Design team asked youth participants questions, in the Zoom chat box, regarding site-wide design concepts. Feedback collected during this meeting is included in the Detailed Summary of Feedback (see page 11). Throughout the presentation youth participants asked questions in the Zoom chat box. Answers to participants questions are included in **Appendix A: Meeting Question and Answer Period.**

After the presentation, youth participants were divided into breakout rooms where the Engagement Team (PROCESS) led an interactive activity on site-specific design ideas using Zoom and Scribble (**see Appendix C: Scribble Boards** for Site-Specific Design Concepts feedback details). For an example of the Scribble Boards see **Figure 1: Example Scribble Board from Activity #1.**

**Figure 1: Example Scribble Board from Activity #1.**



## ACTIVITY 1: THE POND

*Scribble! Check (✓) elements you prefer and mark (X) the elements you don't prefer at the pond area.*

5

### Low Impact



### High Activity

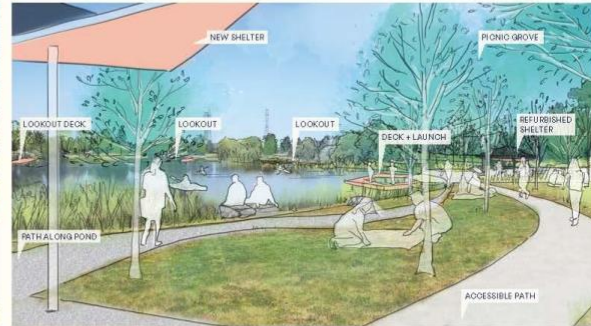

What kinds of activities would you like to do around the Pond?

(Image of blank Scribble board from Youth Workshop Activity 1, July 2020)

## Meeting Objectives

The objectives of the Youth Workshop were to:

- Provide an Indigenous Cultural Training about the land on which Centennial Park sits, see **Figure 2: Trina Moyan Bell's Indigenous Cultural Training**.
- Present what the Project Team has heard from the public and stakeholders since March 2020 and how this feedback has been incorporated into the design process and concept designs.
- Provide youth participants and opportunity to learn about the park planning and design process.
- Brainstorm ideas and get input site-specific design for Penny Pond, The Hill, The Heart of the Park.

**Figure 2: Trina Moyan Bell's Indigenous Cultural Training**

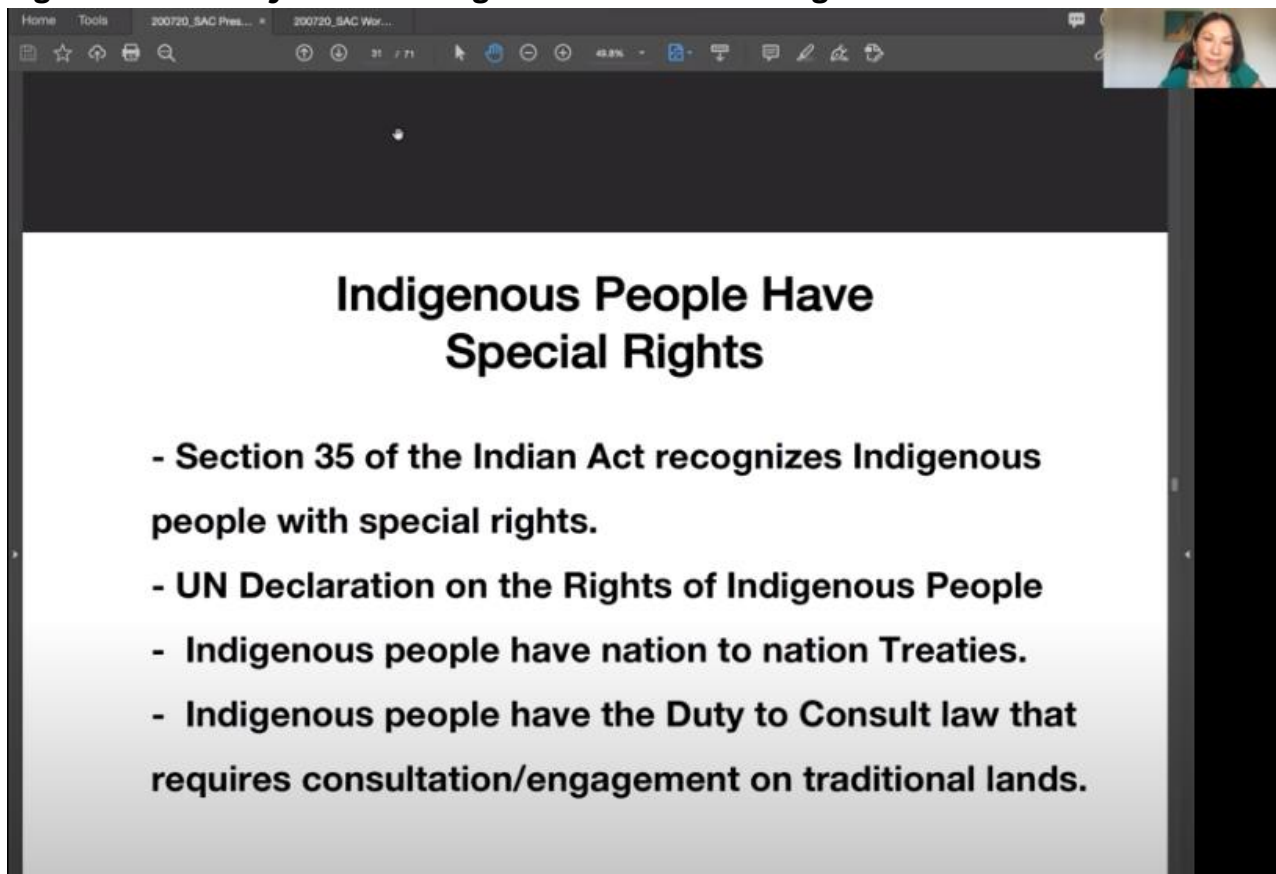

(Trina Moyan Bell's Indigenous Cultural Competency Training for youth participants, July 2020)

# Centennial Park Master Plan Update: Project Themes

The Project Team developed four ‘stories’ or themes that are used to organize the design work of the Master Plan Update. The four stories/ these are as follows:

**Water:** The water story at Centennial Park is about the entire cycle – how it lands on the site, moves through the site and is absorbed by the site. Water is not only a necessary resource, for all flora and fauna, but can also be a source of play, beauty and contemplation. Consider the annoying puddles when it rains, the wetlands that support interesting wildlife, the ponds with the weeping willows and the creeks that are both buried and above ground.

**Ecology:** The ecology story of Centennial Park is not just about the natural environment – the trees, the habitats, the birds and rabbits – it’s about the system that links all of these together, successfully or not. Ecology takes into consideration the balance between all species and the environment, including how to ameliorate human impacts and prepare for the changing climate.

**Movement:** The movement story of Centennial Park is about all the forms of transport to and through the site. It is also about equal access for all, regardless of the mode of transport; whether you can walk, bike, drive a car, take the bus, need to take breaks often or need a smooth surface to move on. Movement is about the experience as we walk through Centennial Park; the sublime views of nature and water; and whether we know where you are going or not.

**Culture:** The culture story is about everything that contributes to the way of life in Centennial Park. It is about sports fields and playgrounds, picnicking under the willows by the pond or visiting the Conservatory on a rainy day. It’s also about community, and how Centennial Park can create, maintain and enhance it.

## 2.0 Anti-Black Racism, Inclusion, and Equity within Centennial Park

In the month of June 2020, a Toronto By-law officer in Centennial Park engaged in behaviour that threatened Black park-goers and demonstrated anti-Black racism (see more information about the incident [here](#)). At the Youth Workshop, a youth resident asked what the City is doing in regard to the incident and what the City is doing to address anti-Black racism within Centennial Park, see **Appendix A: Meeting Question and Answer Period** for a detailed response to the youth's question. .

The City is taking this encounter seriously and an investigation is being conducted by an external investigator . The Parks, Forestry, & Recreation Division are also taking the encounter seriously and have provided a detailed response in **Appendix B: Parks, Forestry, & Recreation Division's Response to Anti-Black Racism Question**.



## 3.0 Indigenous Consultation and Cultural Competency Training

Trina Moyan Bell is *nehiyaw* (Plains Cree) and the Indigenous consultant working on the Centennial Park Master Plan Update. Trina is committed to including the histories and current realities of Indigenous peoples within urban planning projects. At the Youth Workshop, Trina provided an initial training for educated participants about the land on which Centennial Park sits on, Indigenous culture, and the impacts of colonialism on Indigenous peoples. Trina's presentation is available on the [Centennial Park Website](#). Indigenous consultation is also a part of the Centennial Park Master Plan Update Project.

The City and the Project Team encourages all Torontonians to continue their self-education about Indigenous history and present realities. Centennial Park Master Plan Update youth participants are encouraged to continue their self-education using the resources listed below. Trina has recommended purchasing resources via [Goodminds.com](#), which is a First Nations family-owned business, located on the Six Nations of the Grand River. Goodminds is a leading source for purchasing vetted First Nations, Métis, Inuit, and Native American culturally appropriate and culturally authentic resources and products.

### *Self-education Reading List:*

- 21 Things You May Not Know About the Indian Act: Helping Canadians Make Reconciliation with Indigenous Peoples a Reality  
By Bob Joseph
- Indigenous Writes: A Guide to First Nations, Métis and Inuit Issues in Canada  
By Chelsea Vowel
- A National Crime: The Canadian Government and the Residential School System – 1879 -1986  
By John S. Milloy
- The Inconvenient Indian: A Curious Account of Native People in North America  
By Thomas King
- The Meeting Place: Aboriginal Life in Toronto Native Canadian Centre of Toronto  
Edited by Frances Sanderson and Heather Howard Bobiwash

- Toronto Purchase Specific Claim: Arriving at an Agreement Available at: <http://mncfn.ca/wp-content/uploads/2017/04/MNCFN-Toronto-Purchase-Specific-Claim-Arriving-at-an-Agreement.pdf>
- Indigenous Relations: Working Effectively with Indigenous Peoples  
By Bob Joseph and Cynthia F. Joseph
- Lament for a First Nation: The Williams Treaties of Southern Ontario  
By Peggy J. Blai
- Michi Saagiig Nishnaabeg: This is our Territory  
By Gidigaa Migizi (Doug Williams)
- Our Voices: Indigeneity and Architecture  
By Rebecca Kiddle, Luugigyoo Patrick Stewart, and Kevin O'Brien
- Indigenous Peoples Atlas of Canada  
By Canadian Geographic
- Canada's Indigenous Constitution  
By John Borrows
- Indigenous Canada, a free 12-week online course offered by the University of Alberta that looks at key issues facing Indigenous peoples today. Available at: <https://www.coursera.org/learn/indigenous-canada?action=enroll&authType=google>

**Figure 3: Example of Reading Recommendation**

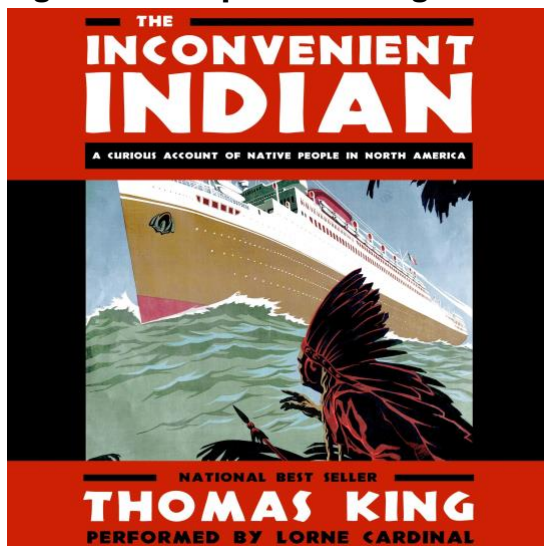

(Image of The Inconvenient Indian: A Curious Account of Native People in North America By Thomas King)

## 4.0 KEY TAKEAWAYS:

### Youth Workshop #2

The following section is a summary of key findings from the Centennial Park Master Plan Update's Youth Workshop. These key messages emerge from the Detailed Summary of Feedback (see page 12) and were the items reiterated often or were deemed important by most youth participants.

- **Address anti-Black racism** within the park through the design of the Master Plan Update as well as taking the initiative to address systemic issues of anti-Black racism within the City staff, departments, and structures.
- **Incorporate Indigenous art and culture** into the design was seen as an important element of the park's design. Participants wanted to see Indigenous representation as well as education of Indigenous peoples, culture, and art.
- **Implement safety measures** into the design to ensure all park users feel safe during all times of day. One suggestion was to incorporate emergency station posts throughout the park.
- **Include cultural and community infrastructure and programming** into the design of the park to provide other options than sports and active recreation for people to enjoy within parks.
- **Connect people to nature** by planting native plants, protecting at-risk species, creating land-stewardship opportunities, having educational programs and signage, and creating community gardens. Other suggestions included having edible trees and plans or creating a "butterfly way" or pollinator garden.
- **Repurpose Centennial Park Ski Centre** and invest in other uses for the hill. Youth suggested incorporating both cultural and fitness uses but placed emphasis on including cultural elements as they help build community.

## 5.0 Detailed Summary of Feedback

The following section overviews each of the activities and summarizes youths' feedback. Feedback from Activity #1 and Activity #2 is organized based on questions asked to the youth participants and discussion topics.

### Overview of Activities:

- **Activity #1: Site-Wide Concepts**

- Activity #1 took place during the presentation by the Design Team on and design concepts for the Master Plan.
- The goal for Activity #1 was to confirm and discuss site-wide conceptual ideas and options for Centennial Park.
- During the presentation, the youth participants were prompted with design questions, in the Zoom chat box, relating to site-wide design concepts for Centennial Parks Four Stories: Culture, Movement, Water, and Ecology.

- **Activity #2: Site-Specific Concepts**

- For Activity #2, youth participants were divided into breakout rooms where the Engagement Team led an interactive activity using Scribble<sup>1</sup> and Zoom.
- The goal of Activity #2 was to discuss site-specific design ideas and options for the Pond, the Hill, and the Centre of the Park.
- The Engagement Team prompted youth participants with questions regarding the site-specific areas. Youth participants provided feedback in a group discussion as well as through collaborative drawing and written text on Scribble boards that contained images of the design concepts for Centennial Park.

See below for participants feedback from Activity #1 and Activity #2.

---

<sup>1</sup> [Scribble](#) is a virtual tool that provides the ability to recreate the sense of being in an in-person meeting. Scribble allowed participants to collaboratively draw and provide feedback over images of concept designs for Centennial Park.

## Activity 1: Site-Wide Concepts

Feedback from Activity #1 is organized based on Centennial Park's Four Stories: Culture, Movement, Water and Ecology.

### **CULTURE**

Youth participants were asked for their feedback on five topics: Recreation, Play, New Structures, and Ideas for Art and Placemaking. The questions for each topic and feedback are summarized below:

#### ***Recreation:***

**Design question for youth participants (prompted in Zoom chat):**

- **Should all soccer fields be full size in Centennial Park?**

Youth participants answers/comments:

- Children/youth sized fields should be provided because many children play soccer either for recreational purposes or through a league.

#### ***Play:***

**Design question for youth participants (prompted in Zoom chat):**

- **What kind of playground do you think Centennial Park needs?**

Youth participants answers/comments:

- Participants liked the idea of having natural playgrounds that allow children to interact with nature. They also liked the idea of dispersed playgrounds and suggested including workout machines/installations near them.

#### ***Ideas for Art and Placemaking:***

**Design question for youth participants (prompted in Zoom chat):**

- **Do you think art should be in Centennial Park? Where should it be located?**

Youth participants answers/comments:

- Participants indicated that art should be included in the park and suggested that it incorporates natural and local art representing the lands on which Centennial Park sits. Participants also suggested including Indigenous art that provides education about Indigenous culture. One participant suggested having a mural displaying the different cultures within the area surrounding Centennial Park.

For the presented concept for Culture, see **Figure 4: Culture Concept**.

**Figure 4: Culture Concept**

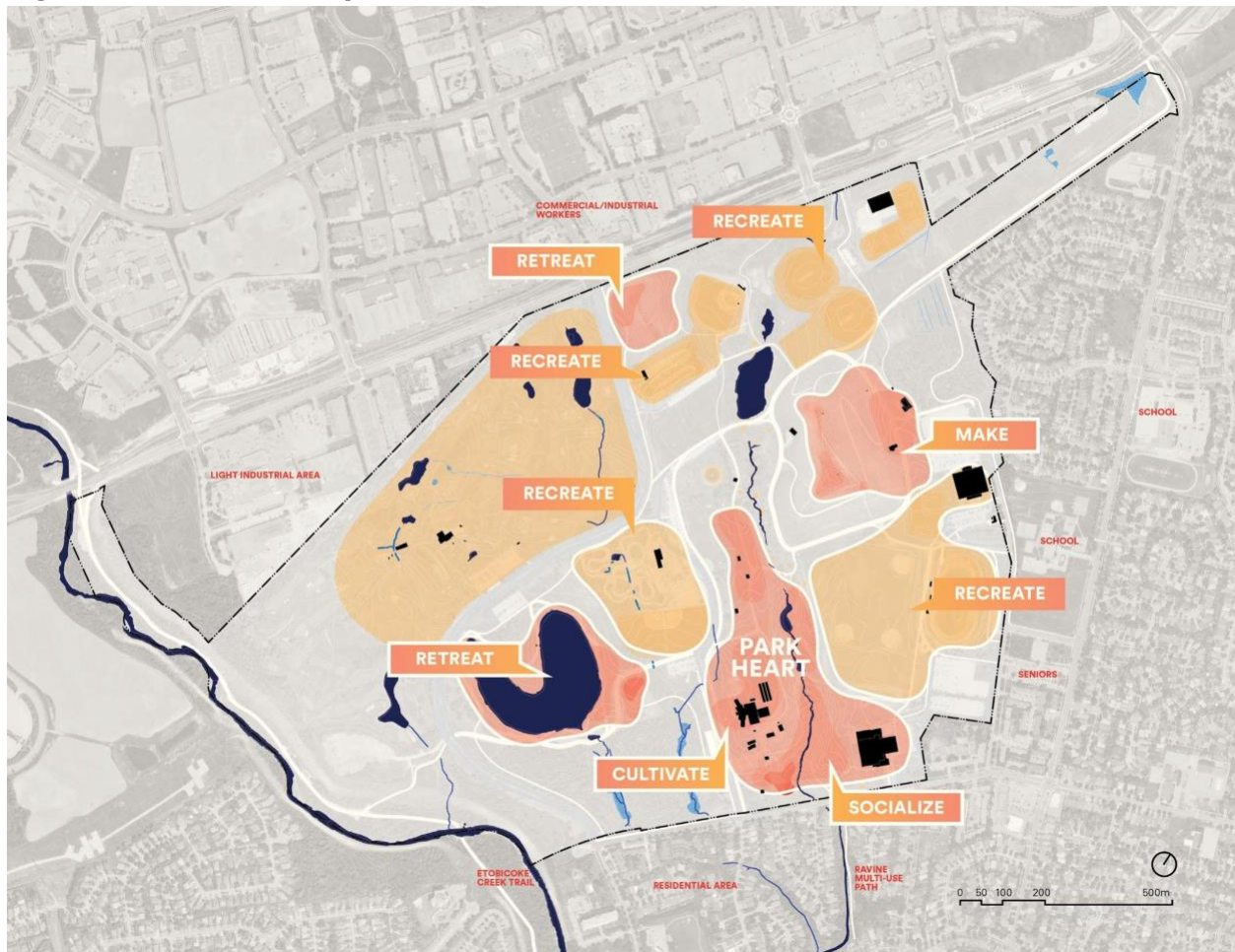

(Image of the Culture concept for the Master Plan Update over an aerial map of Centennial Park, July 2020)

## **MOVEMENT**

Youth participants were asked for their feedback on pedestrian and cycling pathways as well as gateways and signage. The questions for each topic and feedback are summarized below:

### ***Pedestrian and Cycling Pathways:***

#### **Design question for youth participants (prompted in Zoom chat):**

- **Are there additional pedestrian or cycling paths that you think should be included?**

Youth participants answers/comments:

- Pathways should be dispersed and well maintained throughout the park, including forested areas. Another suggestion was to create steps going up the hill to provide more access and accessibility.
- Incorporate seating into trails for added accessibility.
- Create accessible pathways and programs.
- Include solar powered signage and lighting.
- Youth participants indicated that other youth would be attracted to opportunities like biking in the forest. Participants also mentioned signage and lighting to be incorporated into the bike trails to increase sense of safety. Another suggestion was to create a “natural” BMX park within the forest.

### ***Gateways and Signage:***

#### **Design question for youth participants (prompted in Zoom chat):**

- **Where in Centennial Park do people get lost/confused?**

Youth participants answer/comments:

- Include directional signage as well as education signage about wildlife and plants along pathways.
- Implement emergency station posts and lighting to increase safety throughout the park.

For the presented concept for Movement, see **Figure 5: Movement Concept.**



**Figure 5: Movement Concept**

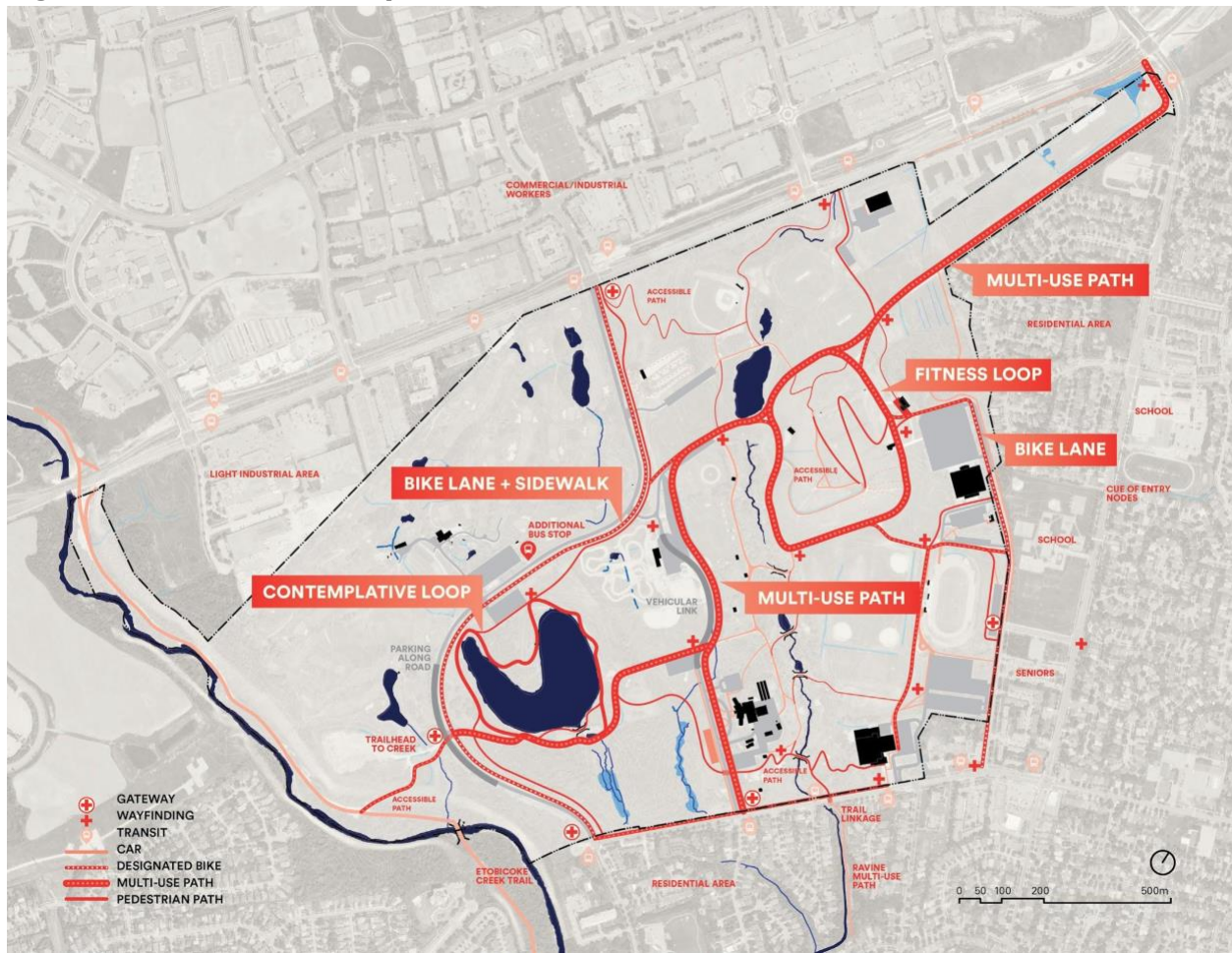

(Image of the Movement concept for the Master Plan Update over an aerial map of Centennial Park, July 2020)



## **WATER**

Youth participants were asked for their feedback on Edge Types. The question and feedback are summarized below.

### ***Edge Types:***

**Design question for youth participants (prompted in Zoom chat):**

- **Do you have a favourite water spot at Centennial Park that you'd like better access to?**

Youth participants answers/comments:

- Create educational opportunities for children to connect to water and learn about hydroelectricity and water ecosystems.

For the presented concept for Water, see **Figure 6: Water Concept**.

**Figure 6: Water Concept**

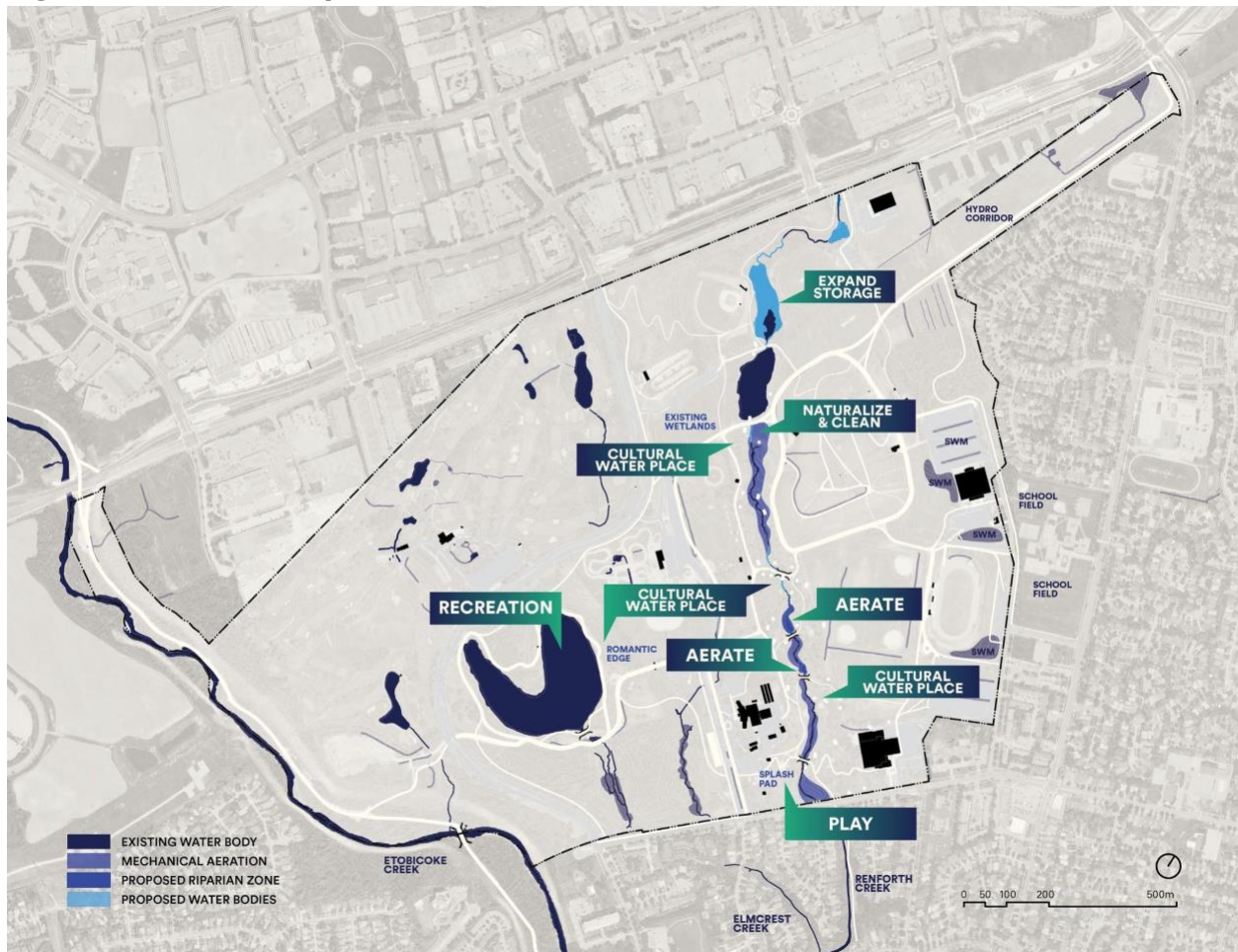

(Image of the Water concept for the Master Plan Update over an aerial map of Centennial Park, July 2020)

## **ECOLOGY**

Youth participants were asked for their feedback on Ecology and Tree cover. The question and feedback are summarized below.

### ***Ecology:***

#### **Design question for youth participants (prompted in Zoom chat):**

- **Where do you think Centennial Park lawns should be mowed and where do you think lawns can be meadows?**

#### **Youth participants answer/comments:**

- Include native plants throughout the park such as moss, mixed-cover plants, and pollinator plants.
- Create a “butterfly way” as well as pollinator gardens. Participants noted that a “butterfly way” provides a complementary learning opportunity to the conservatory. One example of this is the Butterflyway Project by the David Suzuki Foundation.
- Create a garden program that teaches children garden skills, and knowledge about plants, ecosystems and water systems. An example of this is a youth gardening program called Little Sprouts Garden run on the Toronto Islands in the Franklin Children's Garden.

### ***Tree Cover:***

#### **Design question for youth participants (prompted in Zoom chat):**

- **Does Centennial Park need more trees? Are there any spots that need them most?**

#### **Youth participants answer and comments:**

- Plant edible trees (e.g. serviceberry trees, apple trees, raspberry bushes) that provide fruit for park visitors and attract birds.

For the presented concept for Ecology, see **Figure 7: Ecology Concept**.

**Figure 7: Ecology Concept**



(Image of the Ecology concept for the Master Plan Update over an aerial map of Centennial Park, July 2020)

## Activity 2: Site-Specific Design

The goal of Activity #2 was to discuss site-specific design ideas and options for the Pond, the Hill, and the Centre of the Park. Feedback is organized based on three site-specific design ideas and options for the Pond, the Hill, and the Centre of the Park.

**\*Note to reader:** FEW indicates 0-2 responses; SOME indicates 3-6 responses, MANY indicates 7-10 responses.

### **THE POND**

#### **Design question for youth participants:**

- **Mark your preference on elements you prefer and elements you do not like at the Pond area.**

Youth participants answers/comments:

- Some participants liked the natural edge.
- Some participants liked the boardwalk, however one participant did not like the boardwalk and indicated that it may cause people to litter.
- Some participants liked the viewing deck.
- Some participants liked the water activities, however there were a few participants that did not like the water activities and mentioned that boats should not be permitted to maintain the park as a quiet area.

#### **Design question for youth participants:**

- **What kinds of activities would you like to do around the Pond?**

Youth participants answers/comments:

- Some participants liked the lookout deck.
- Some participants liked the lawn next to the pond while few participants liked the path along the pond. Participants also mentioned that they enjoy the naturalized pond-edge and for the design to incorporate more plantings along the pond edge.
- Few participants liked the viewing deck.
- Few participants liked the deck and launch design option and one participant did not like the deck and launch option.
- Few participants liked the accessible path.
- Few participants liked the new shelter and the refurbished shelter.
- Few participants liked boats on the water, especially if canoes are permitted.

**Design question for participants:**

- **Of the two plans, which one provides the experiences you would like by the pond? What other ideas are missing?**

Youth participants answers/comments:

- Some participants preferred the low-impact plan with no boats and maintaining the pond as a quiet place. One participant mentioned that the high-activity option was too busy.
- Few participants indicated that they enjoy the contemplative hill, natural play area, and spill away gardens in both designs.
- Few participants suggested fishing be permitted in the pond.
- Few participants suggested opportunities for educational experiences around the pond. One participant suggested having signs with information about plants and wildlife near the pond. They indicated that information about the environment fosters people to care for it.
- Few participants mentioned protecting at-risk species.
- Few participants mentioned having safety measures in place for activities around the pond. They also mentioned that safety at night should be considered and suggested having emergency station posts in place.

For an example of the Scribble activity, see **Figure 8: Pond Scribble Activity**



**Figure 8: Pond Scribble Activity**

6



## ACTIVITY 1: THE POND

*Scribble! Check (✓) elements you prefer and mark (X) the elements you don't prefer at the pond area.*

### Low Impact



### High Activity



Of the two plans, which one provides the experiences you would like by the pond?  
What other ideas are missing?

Fishing  
Education ✓

Species @Risk ED ✓

Safety ✓

(Image of youth feedback illustrated on the Scribble board for the Pond, July 2020)

## **THE HILL**

### **Design question for youth participants:**

- **Mark your preference on elements you prefer and elements you do not like for the Hill.**

#### **Youth participants answers/comments:**

- Many participants liked the sled run.
- Many participants liked the art lookout.
- Many participants like the amphitheatre.
- Many participants liked the plaza/market, however few participants did not.
- Some participants liked the skating trails.
- Few participants liked the ski hill.

### **Design question for youth participants:**

- **What would you like to do at the hill in warmer or winter months?**

#### **Youth participants answers/comments:**

- Some participants indicated they would use the fire pits and would like to have bonfires.
- Some participants indicated they would like to have coffee or hot chocolate available in the winter months.

### **Design question for youth participants:**

- **What elements of the ski hill resonate with you?**

#### **Youth participants answers/comments:**

- Some participants liked the flexible space.
- Some participants liked the lookout option as well as the art lookout option.
- Some participants liked the temporary installations.
- Some participants liked the amphitheatre.
- Some participants liked the plaza market.
- Few participants liked the skate trail.
- Few participants liked the senior area.
- Few participants liked the accessible path and indicated that accessibility should be a part of the hill design.
- Few participants liked the lighting and indicated that it should be incorporated into the Cultural Hub plan.



**Design question for youth participants:**

- **Of the two plans, which one has the type of uses you would like to see at the hill? What other ideas are missing?**

Youth participants answers/comments:

- Participants enjoyed elements of both plans, however some participants preferred the Cultural Hub option over the Fitness Hub option because they felt that culture helps build community. Participants mentioned that the design should not be focused just on fitness and include cultural elements.
- Some participants suggested a zipline on the hill.
- Some participants suggested a community garden.
- Some participants suggested including more seating options.
- Some participants indicated including opportunities for land stewardship within the design.
- Some participants suggested incorporating Indigenous art.
- Few participants suggested biking trails that are dispersed throughout the hill.
- Few participants suggested having food be available.
- Few participants suggested a greenhouse.
- Few participants suggested having fireworks at the park.

**Design question for youth participants:**

- **The City has to make a difficult decision to either invest in the Centennial Park Ski Centre or repurpose it for another use. What do you think of the idea of enhancing the Earl Bales Ski and Snowboard Centre and repurposing the Centennial Park Ski Centre (hill and chalet) for other year-round and seasonal activities?**

Youth participants answers/comments:

- Participants indicated that the ski hill should not be invested in and instead it should be repurposed for other uses.

For an example of the Scribble activity, see **Figure 9: Hill Scribble Activity**

Figure 9: Hill Scribble Activity

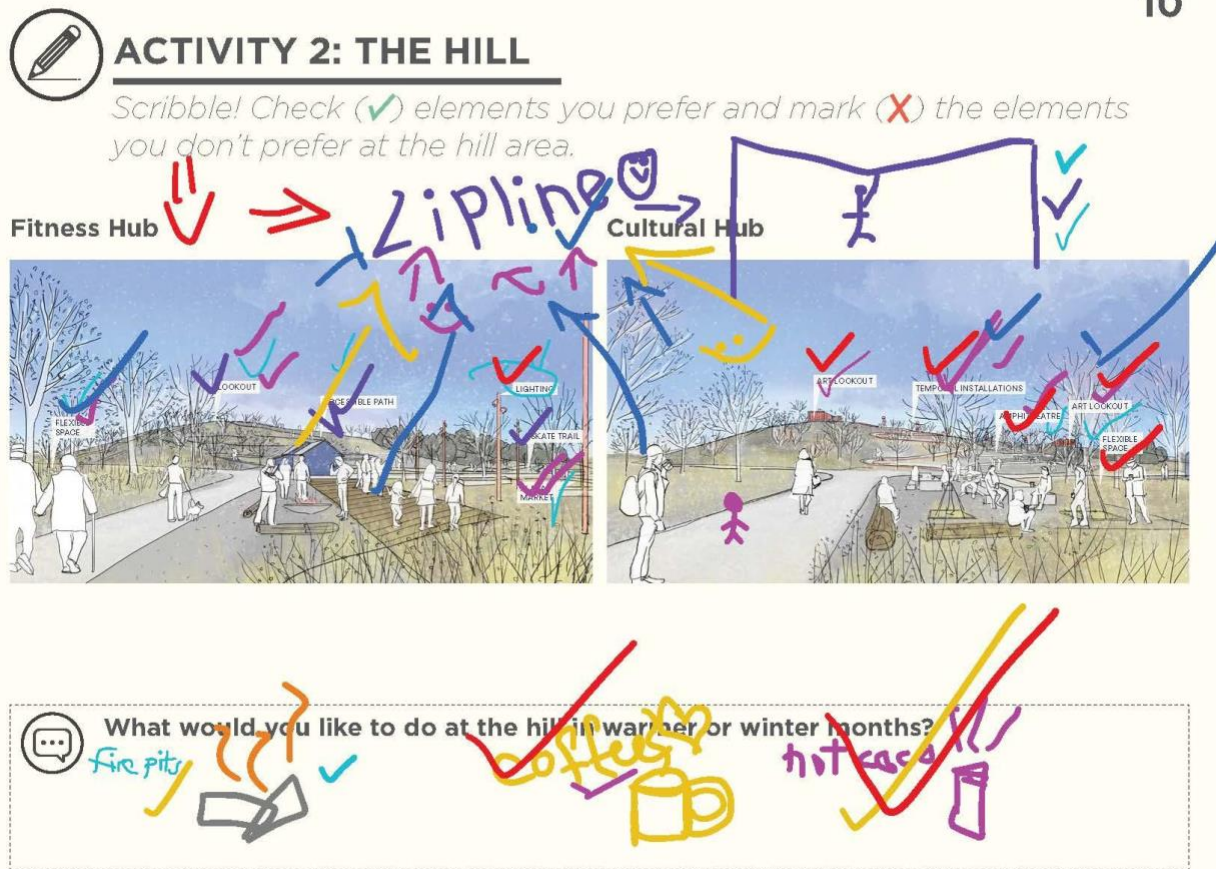

(Image of youth feedback illustrated on the Scribble board for the Hill, July 2020)

## **THE HEART OF THE PARK**

### **Design question for youth participants:**

- **Mark your preference on elements you prefer and elements you do not like for the Heart of the Park.**

### **Youth participants answers/comments:**

- Many participants liked the natural playground.
- Some participants liked water play option 1, however there were few participants who did not.
- Some participants liked the district playground, however there were few participants that did not.
- Some participants liked the formal playground.
- Some participants liked the amphitheatre.
- Few participants liked water play option 2 and one participant did not.

### **Design question for youth participants:**

- **What play elements would you like to see for the district playground?**

### **Youth participants answers/comments:**

- Some participants liked the sensory play.
- Some participants liked the natural play.
- Some participants liked the connection to the water channel and preferred the node/creek design. Some participants indicated that the connection to water should be natural. Participants also indicated that connectivity to the water should be accessible.
- Few participants liked the play structure, however there were also few participants that did not.

### **Design question for youth participants:**

- **What elements of the heart in the park resonate with you?**

### **Youth participants answers/comments:**

- Some participants liked the native showcase meadow.
- Some participants liked the community orchard and orchard walk.
- Few participants liked the community farm, however there were few participants that did not.
- Few participants liked the native arboretum
- Few participants liked the flowering tree walk

**Design question for youth participants:**

- **Thinking of this area being next to the Conservatory, neighbourhood and Olympium, which plan resonates with you most? What other ideas are missing?**

Youth participants answers/comments:

- Few participants indicated that the node/crate plan resonates most with them.
- Few participants suggested having play that is out of the ordinary
- Few participants indicated that lighting should be included to increase sense of safety.
- One participant suggested including a chess board
- One participant indicated that accessibility should be incorporated into the design and be considered for the district playground, formal playground and the natural playground.
- Participants mentioned that having culture creates a dynamic experience.

For an example of the Scribble activity, see **Figure 10: Heart of the Park Scribble Activity**

**Figure 10: Heart of the Park Scribble Activity**



### ACTIVITY 3: HEART OF THE PARK

*Scribble! Check (✓) elements you prefer and mark (✗) the elements you don't prefer at the hill area.*

14



(Image of youth feedback illustrated on the Scribble board for the Heart of the Park, July 2020)

## Appendix A: Meeting Question and Answer Period

The following section overviews youth participants questions that were asked during the presentation. See below for the questions and answers provided by the project team:

Question: What are the ways that the City and the Centennial Park Master Plan Update team are going to make sure Black people will be safe in these spaces? There have been many cases of anti-Blackness, most recently the two young women who were threatened by park staff. I love nature but how can Black people access it when they experience violence from City Staff in the park? Blackness has been highly policed and demonized and this needs to be addressed, especially with recent events.

Answer: The City needs to address anti-Black racism both from a policy perspective and internally within the City, including bylaw enforcement and within the Parks, Forestry and Recreation Division. The City needs to address the lack of diversity and representation in Parks Staff at all levels and departments.

From a design perspective, the current phase of the project is in the Master Planning phase, which is more general than specific. However, the following ways are how the Master Plan design can address racism and discrimination in the following ways:

1. Make sure the voices we are reaching out to, listening to and responding to in design are diverse in terms of race, culture, language, income, sexual orientation and gender. To address anti-black racism in the design this includes making a concerted effort to consult with Black communities on the design - both that currently use the park and may use in the future.
2. Design for equal access and inclusivity by either in response to consultation or broadening the breadth of programming outside of traditional ideas. For example reaching out to groups like the Black Farmers Collective to design for the physical framework that would allow their operation in Centennial Park. Another example is to be explicit that the park is for everyone - either through signage or art.
3. Make suggestions for programming changes or opportunities through the Master Plan phase. These should

include a greater diversity of programming that specifically make Black, Indigenous and other people of colour feel safe, welcome and that the park land belongs to them.

Question: What are the steps and actions the City is taking to address anti-Blackness in Centennial Park?

Answer: For a detailed response from the Parks, Forestry & Recreation Division, please see **Appendix B: Parks, Forestry, & Recreation Division's Response to Anti-Black Racism Question.**

Question: What type of boats would be permitted on the pond?

Answer: Non-motor boats including kayaks, canoes, or standing paddle boats would most likely be the types of boats permitted on the pond.

## **Appendix B: Parks, Forestry, & Recreation Division's Response to Anti-Black Racism Question**





**Parks, Forestry & Recreation**  
Janie Romoff, General Manager

**Metro Hall**  
24th fl., 55 John St.  
Toronto ON M5V 3C6

**Daniel Fusca**  
Manager Public Consultation  
Parks, Forestry & Recreation

**Tel:** 416.338.3020  
[Daniel.Fusca@toronto.ca](mailto:Daniel.Fusca@toronto.ca)  
toronto.ca

September 17, 2020

**Centennial Park Master Plan Update – Response to Question Received by Resident (September 2020)**

We wanted to reach out to thank you for your comment at the recent consultation session on the Centennial Park Master Plan. We apologize for the delay while we prepared this response. We want you to know that we have heard the concerns from Toronto's Black communities about safety in our parks, and specifically in Centennial Park.

We know that anti-Black racism has profound effects on people's lives and how they relate to public space. As a response to the concerns raised by the community during the consultation process for the Centennial Park Master Plan, we are exploring ways for City staff to better understand the systemic barriers that African, Caribbean and Black users of Centennial Park experience which affect their access to the park and their daily lives. This information will inform the design of the park's new master plan, as well as future park programming. Due to COVID restrictions, this consultation will be held online. We can share details of this consultation and opportunities to participate as they become available.

With respect to the incident you have referenced at Centennial Park, an investigation is being conducted by an external investigator, however it is not yet complete. This means that, unfortunately, we are not able to provide any comment at this time with regards to that specific incident.

While there is still much to do and learn, the City of Toronto is committed to addressing anti-Black racism. In consultation and collaboration with Black Torontonians and community groups, the City has developed an action plan for confronting anti-Black racism in Toronto. More information is available on the [City's website](#), and in the [Action Plan](#) itself, which details the actions we are taking to address anti-Black racism in our programs, services and spaces.

Parks, Forestry and Recreation is also currently working with the City's Confronting Anti-Black Racism team to develop specific actions that will help to address anti-Black racism in the design of our parks and recreation facilities.

Thank you again for raising this during the consultation session. If you would like to discuss further, please contact Pablo Munoz at [pablo.munoz@toronto.ca](mailto:pablo.munoz@toronto.ca). We hope you will consider attending future sessions.

Daniel Fusca

## **Appendix C: Scribble Boards for Site-Specific Design Concepts**



**MASTERPLAN 2020**

---

**PUBLIC WORKSHOP WORKBOOK**



# SITE SPECIFIC DESIGN IDEAS

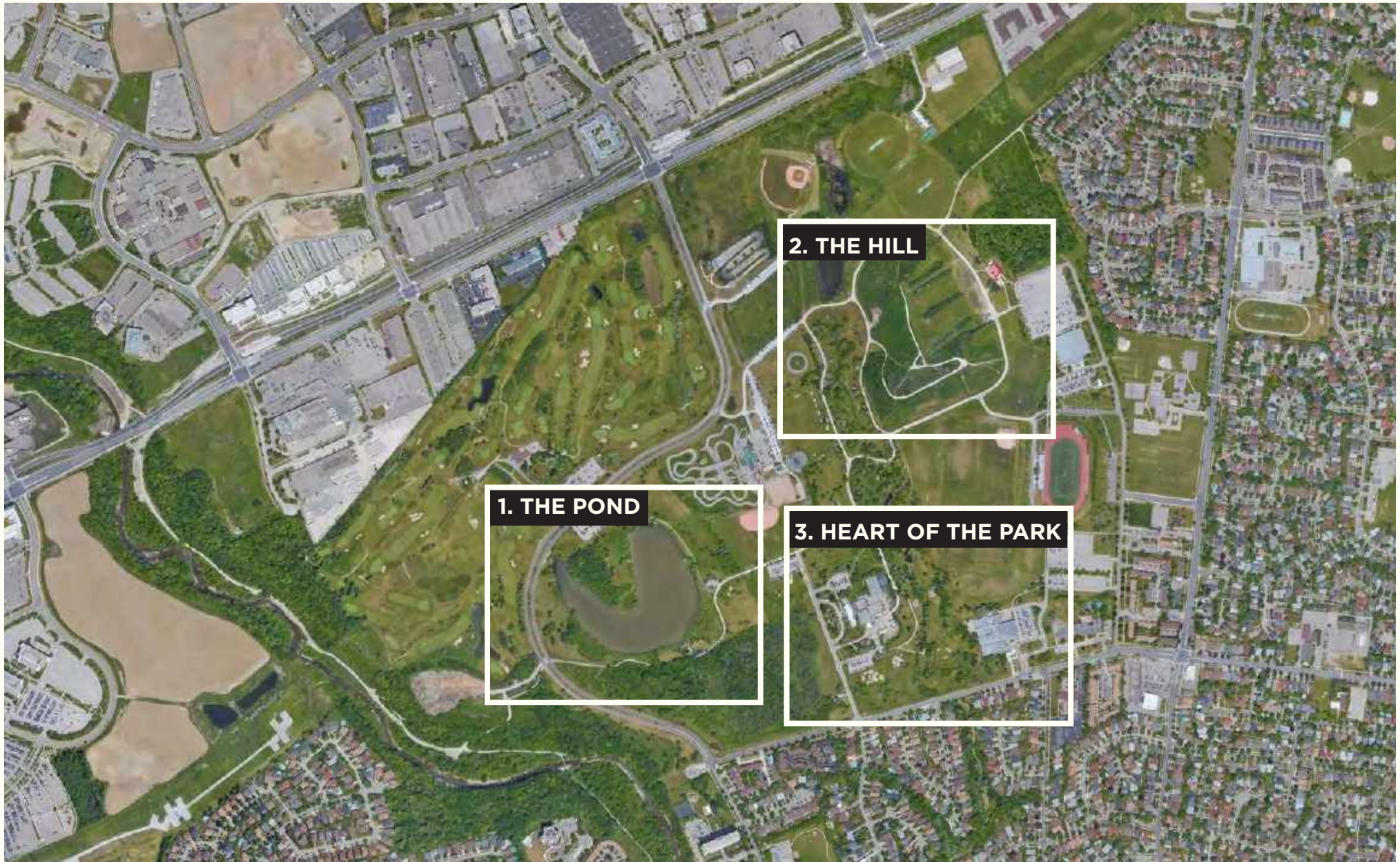



# THE POND

## LOW IMPACT

### LEGEND

- EXISTING WATER BODIES
- MOWN
- SCHEDULED MOW
- MEADOW
- TREE PLANTING
- FORESTATION (TREE AND UNDERSTORY)
- EXISTING TREES



EXISTING



PROPOSED



# THE POND

## HIGH ACTIVITY

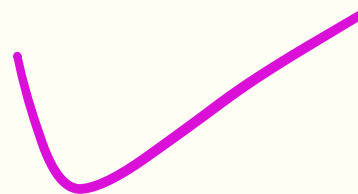



## ACTIVITY 1: THE POND

*Scribble! Mark your preference for the pond in the boxes below.*



NATURAL EDGE

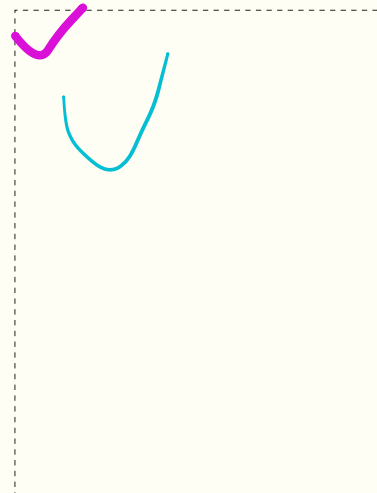

VIEWING DECK

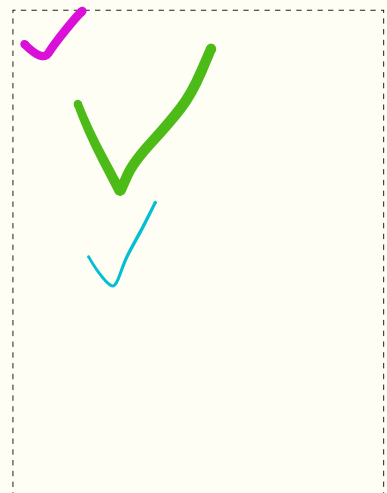

BOARDWALK

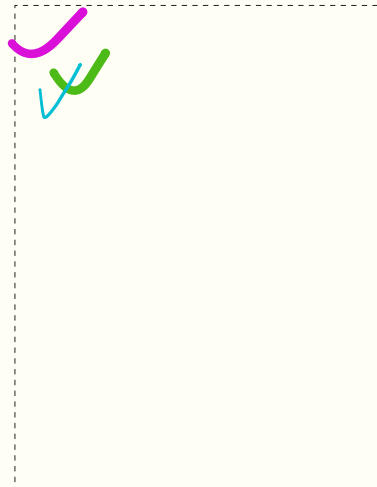

WATER ACTIVITIES

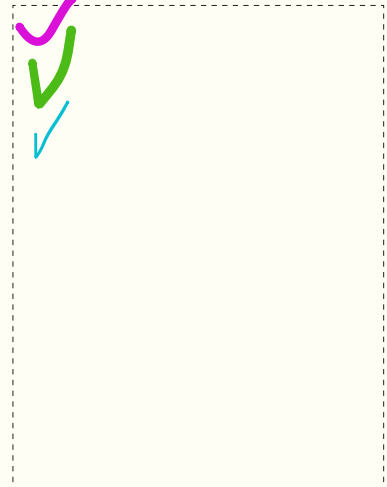

## ACTIVITY 1: THE POND

*Scribble! Mark your preference for the pond in the boxes below.*

♥ turtles



invites  
litter  
X



no  
boats  
great



## ACTIVITY 1: THE POND

Scribble! Check (✓) elements you prefer and mark (✗) the elements you don't prefer at the pond area.

Low Impact



NO

High Activity

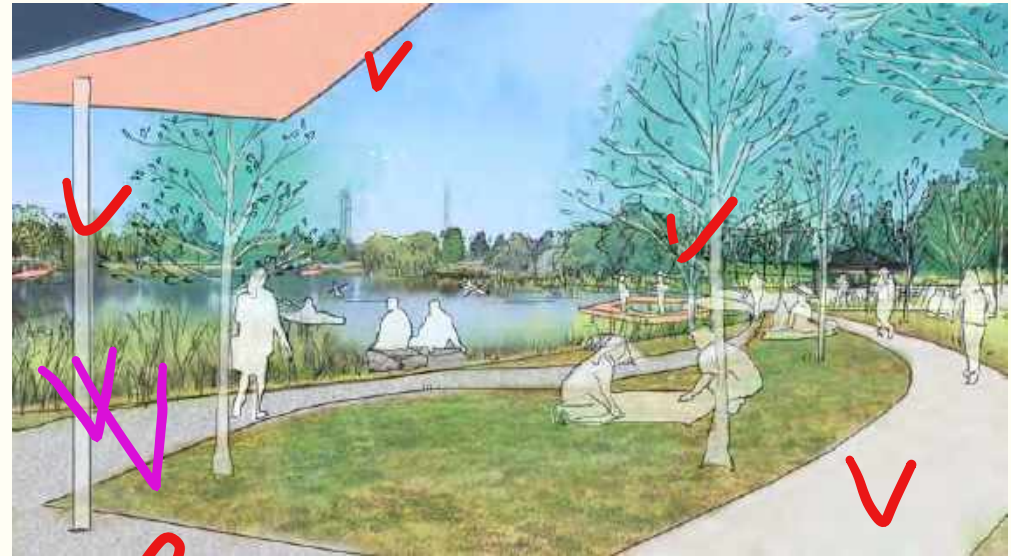

YES

What kinds of activities would you like to do around the Pond? *can have*

*Q: what type of boat?*

# ACTIVITY 1: THE POND

Scribble! Check ( ) elements you prefer and mark (X) the elements you don't prefer at the pond area.

Low Impact

High Activity

quiet

NO BOATS

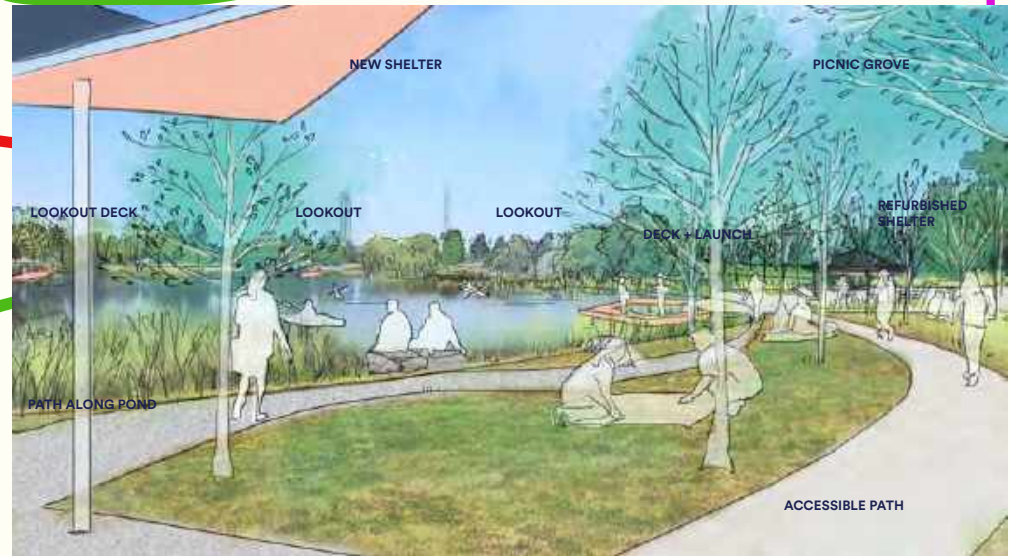

interaction + info = care  
signs about bees! plants!

What kinds of activities would you like to do around the Pond?

our space



## ACTIVITY 1: THE POND

*Scribble! Check ( ) elements you prefer and mark (X) the elements you don't prefer at the pond area.*

### Low Impact



### High Activity

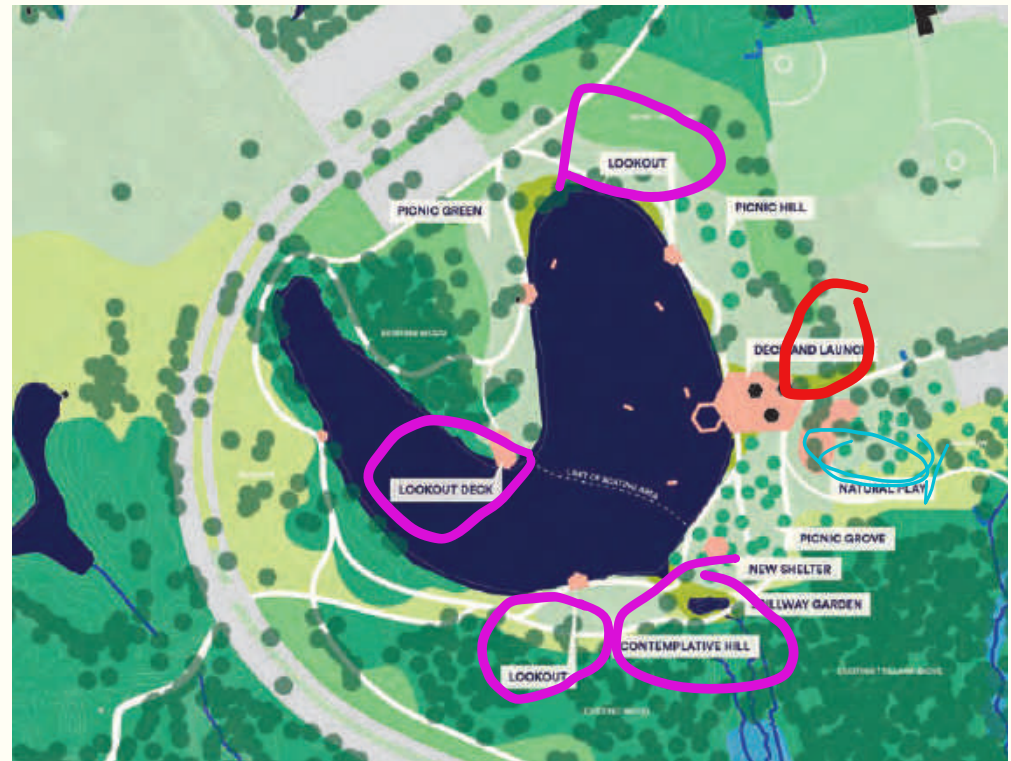

Of the two plans, which one provides the experiences you would like by the pond?  
What other ideas are missing?

Fishing  
Education ✓

Species @ Risk ED ✓

Safety ✓

## ACTIVITY 1: THE POND

*Scribble! Check ( ) elements you prefer and mark (X) the elements you don't prefer at the pond area.*

### Low Impact



### High Activity



Of the two plans, which one provides the experiences you would like by the pond?  
What other ideas are missing?



# THE HILL

## FITNESS HUB

Bike & tracks?



# i THE HILL FITNESS HUB

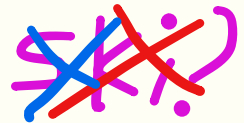

community garden  
greenhouses?  
food

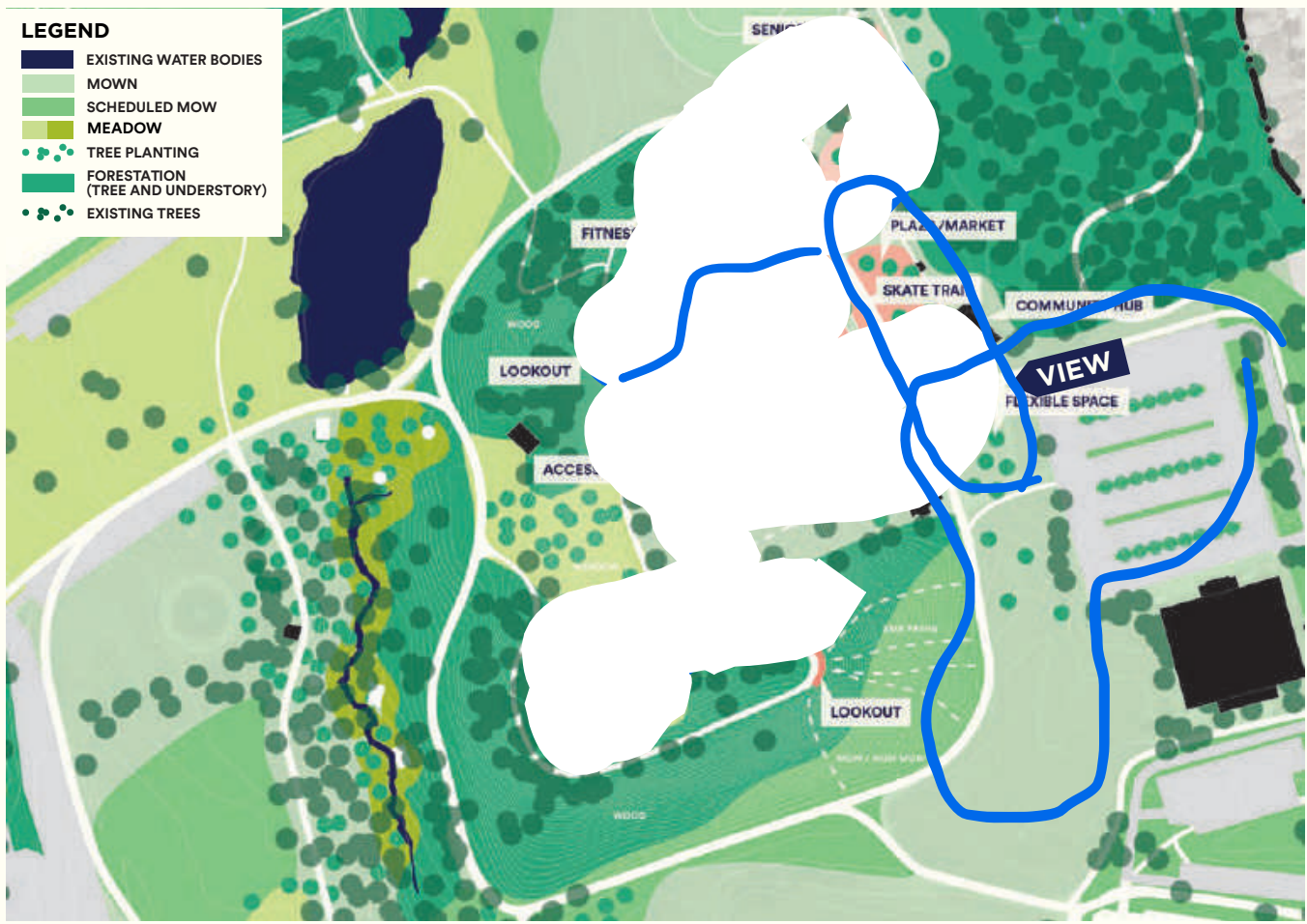



# THE HILL

## CULTURAL HUB

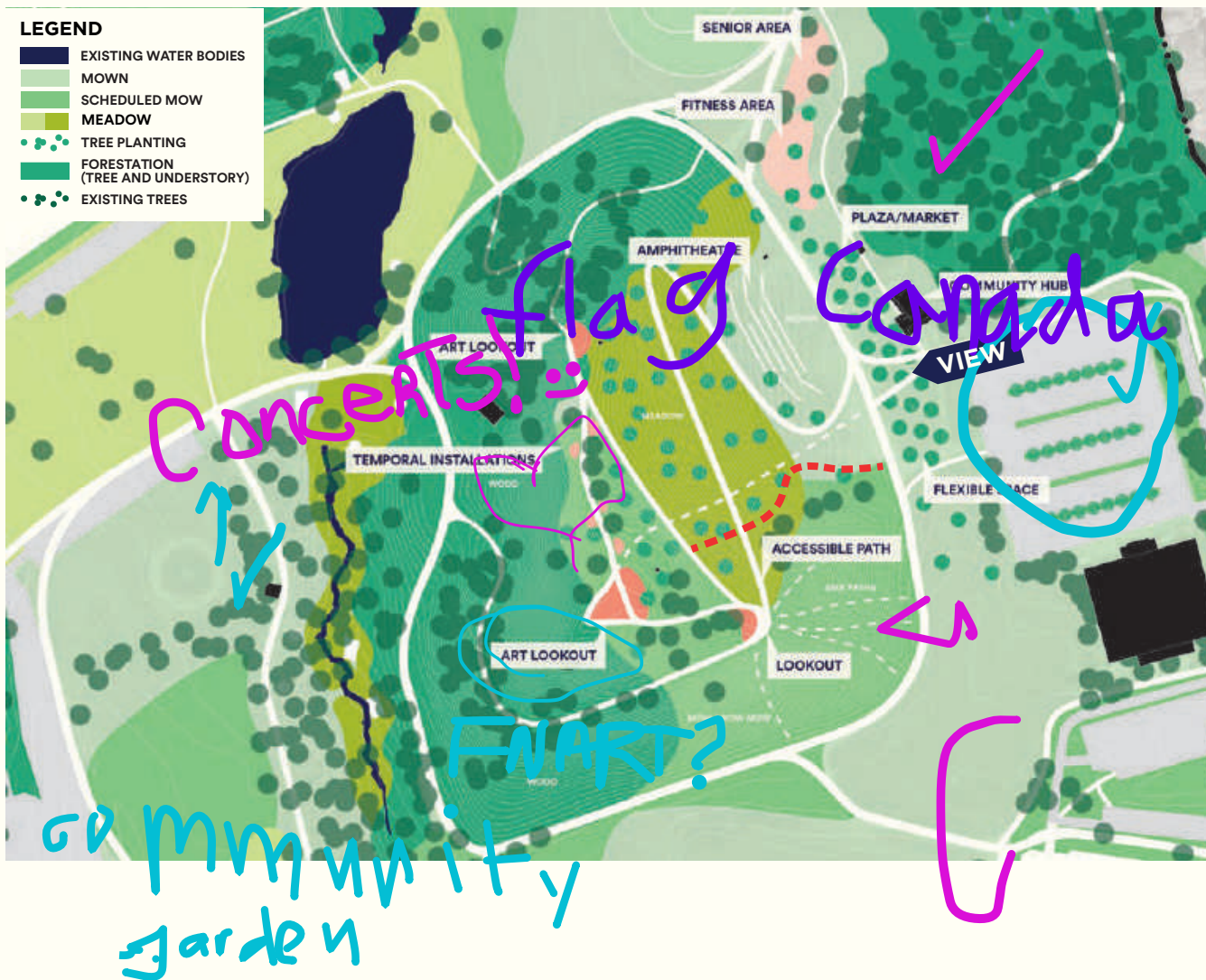



# i THE HILL CULTURAL HUB

✓  
✓  
✓  
stewardship of land

build  
community  
through  
culture

8





# THE HILL

## CULTURAL HUB

Middle xx

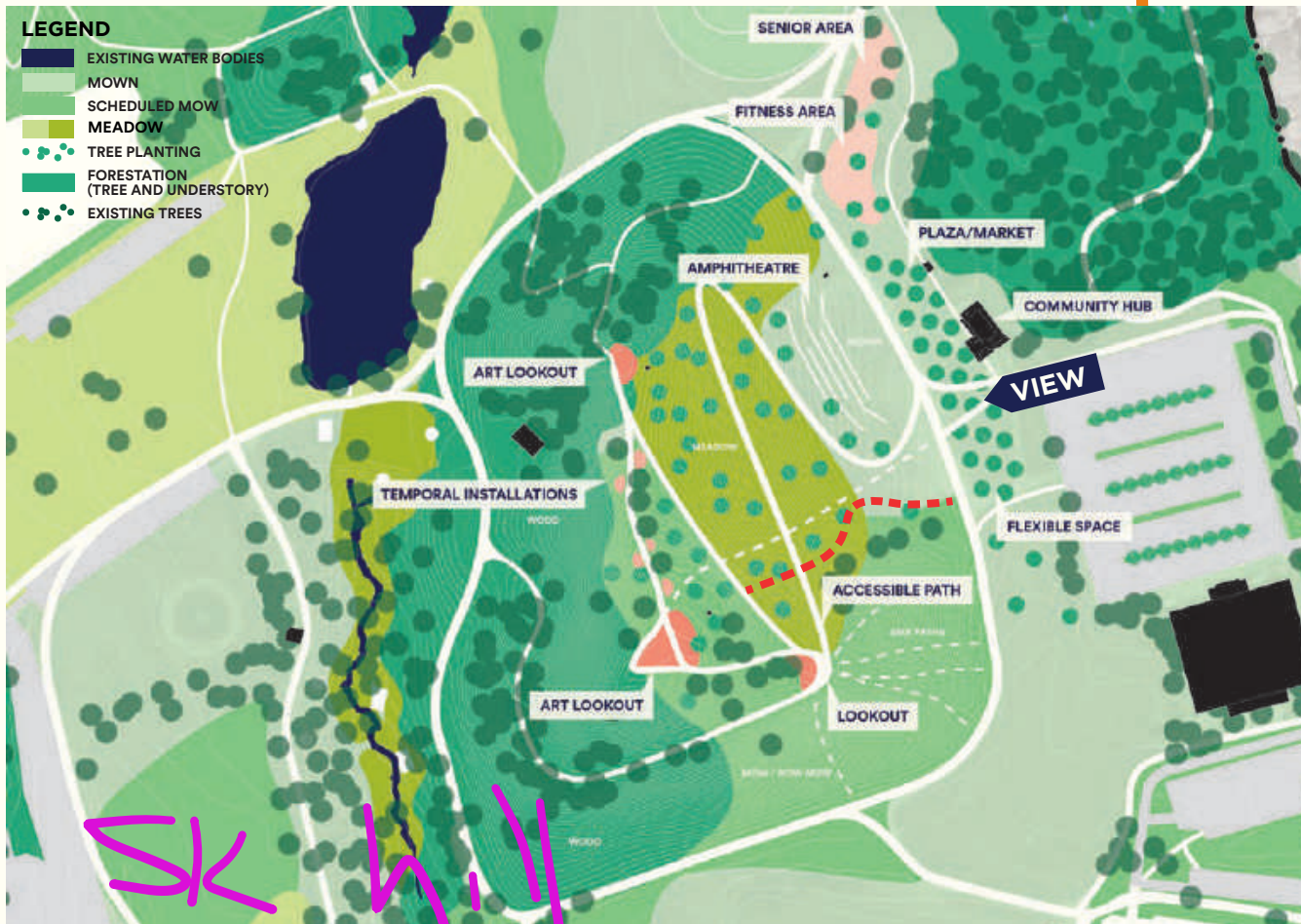

SK Hill  
Enhance X

Close

## ACTIVITY 2: THE HILL

*Scribble! Mark your preference at the hill in the boxes below.*

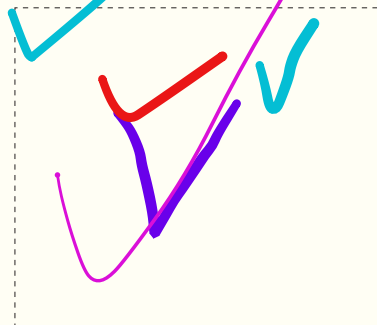
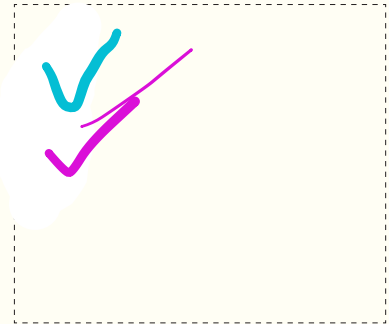
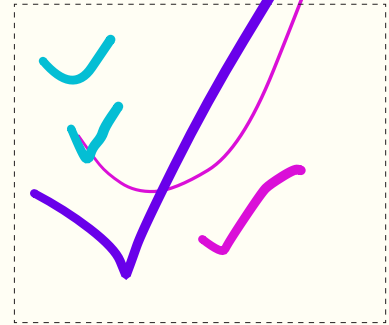



## ACTIVITY 2: THE HILL

*Scribble! Mark your preference at the hill in the boxes below.*

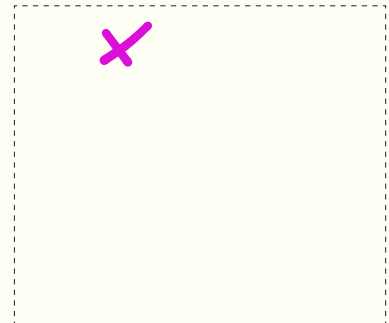
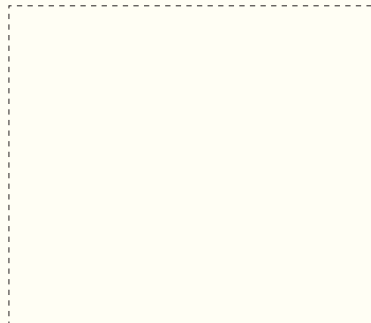
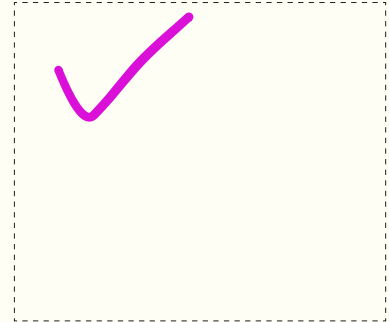
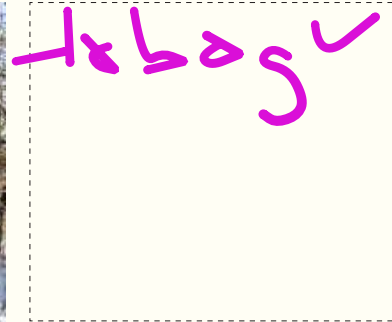
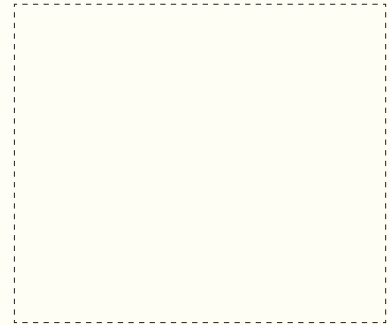
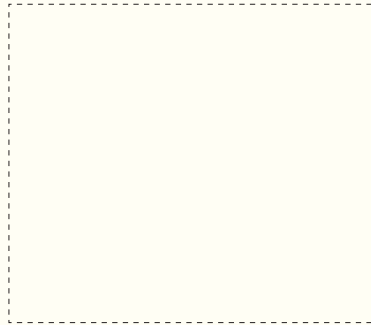

## ACTIVITY 2: THE HILL

Scribble! Mark your preference at the hill in the boxes below.

winter + summer activity  
mostly culture  
some fitness

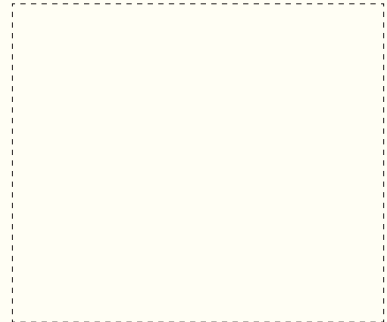
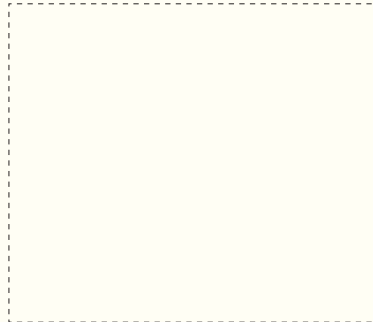
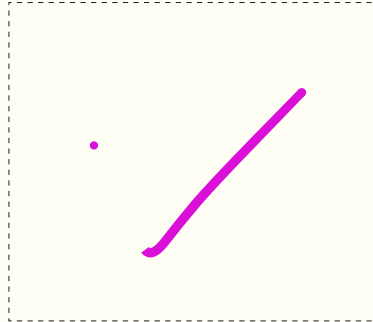
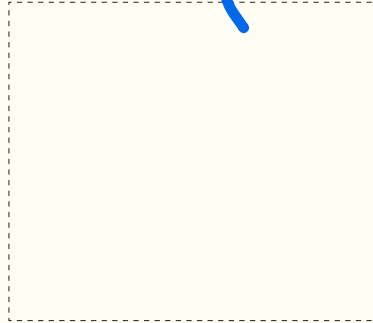



## ACTIVITY 2: THE HILL

Scribble! Check (✓) elements you prefer and mark (X) the elements you don't prefer at the hill area.

Fitness Hub

Cultural Hub

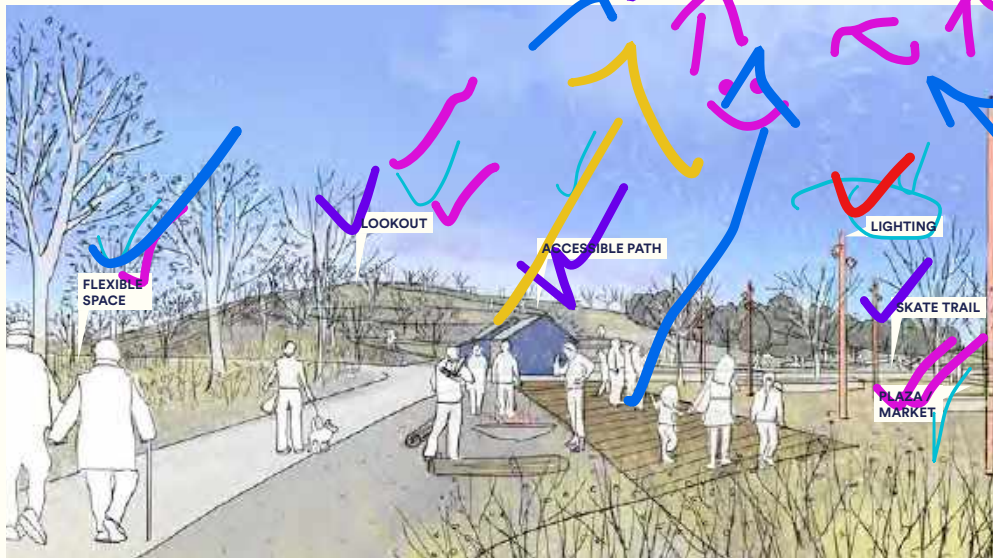

What would you like to do at the hill in warmer or winter months?

fire pits



coffee



hot cocoa





## ACTIVITY 2: THE HILL

Scribble! Check (✓) elements you prefer and mark (X) the elements you don't prefer at the hill area.

change how ppl  
view parks  
not just fitness  
community

### Fitness Hub



### Cultural Hub



accessibility



What would you like to do at the hill in warmer or winter months?



## ACTIVITY 2: THE HILL

*Scribble! Check ( ) elements you prefer and mark (X) the elements you don't prefer at the hill area.*

VIEWS

**Fitness Hub**



**Cultural Hub**

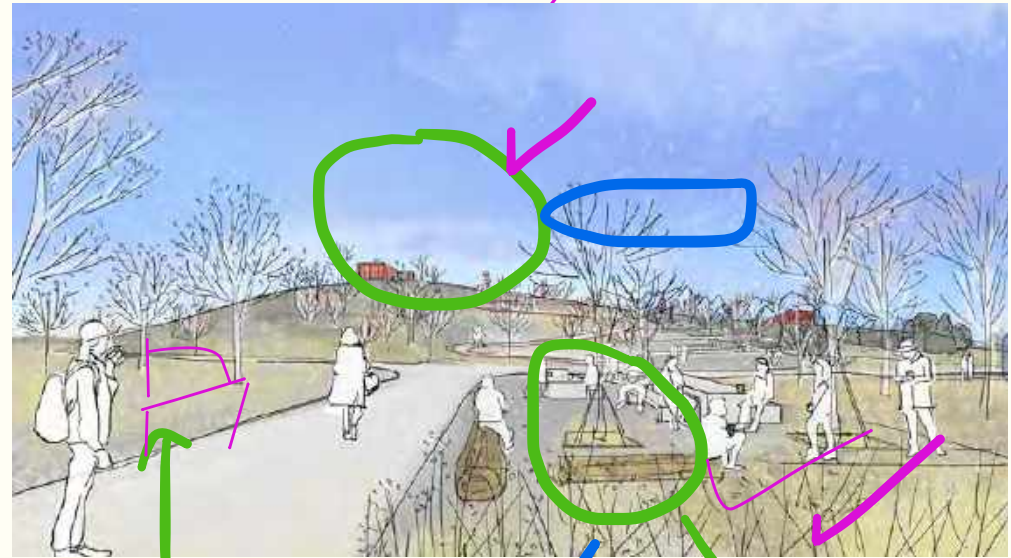

seating? ✓

bonfire? ✓

What would you like to do at the hill in warmer or winter months?



## ACTIVITY 2: THE HILL

*Scribble! Check ( ) elements you prefer and mark (X) the elements you don't prefer at the hill area.*

**Fitness Hub**



**Cultural Hub**

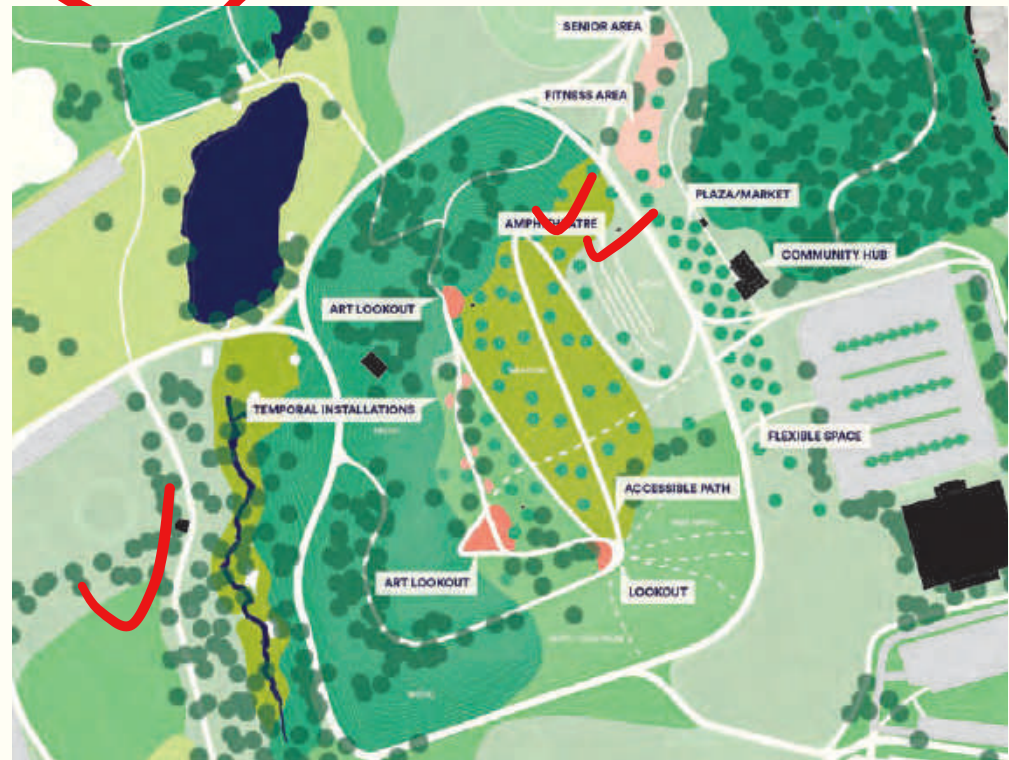

Of the two plans, which one has the type of uses you would like to see at the hill?  
What other ideas are missing?

## ACTIVITY 2: THE HILL

Scribble! Check ( ) elements you prefer and mark (X) the elements you don't prefer at the hill area.

L & O K O U S V

**Fitness Hub**



**Cultural Hub**



Of the two plans, which one has the type of uses you would like to see at the hill?  
What other ideas are missing?



## ACTIVITY 2: THE HILL

Scribble! Check ( ) elements you prefer and mark (X) the elements you don't prefer at the hill area.

Like this,

fireworks

Fitness Hub

Cultural Hub

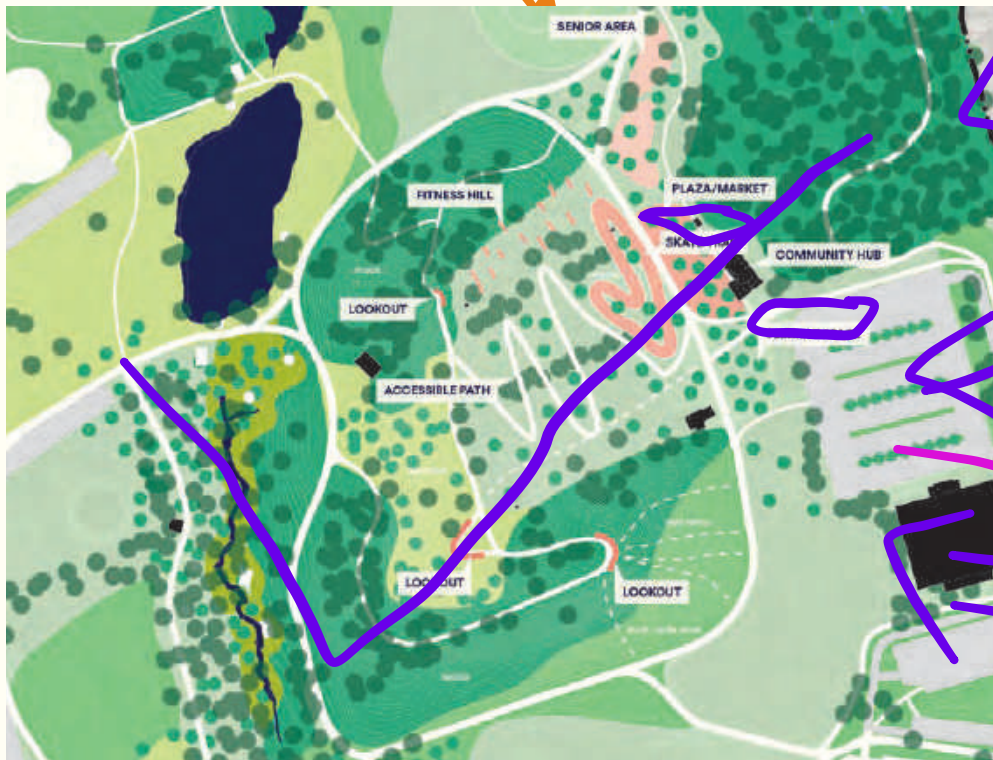

Of the two plans, which one has the type of uses you would like to see at the hill?  
What other ideas are missing?

combo ← RS, Indigenous art! ☺, dispersed  
comm. garden.



# THE HEART OF THE PARK

## NODE / CREEK

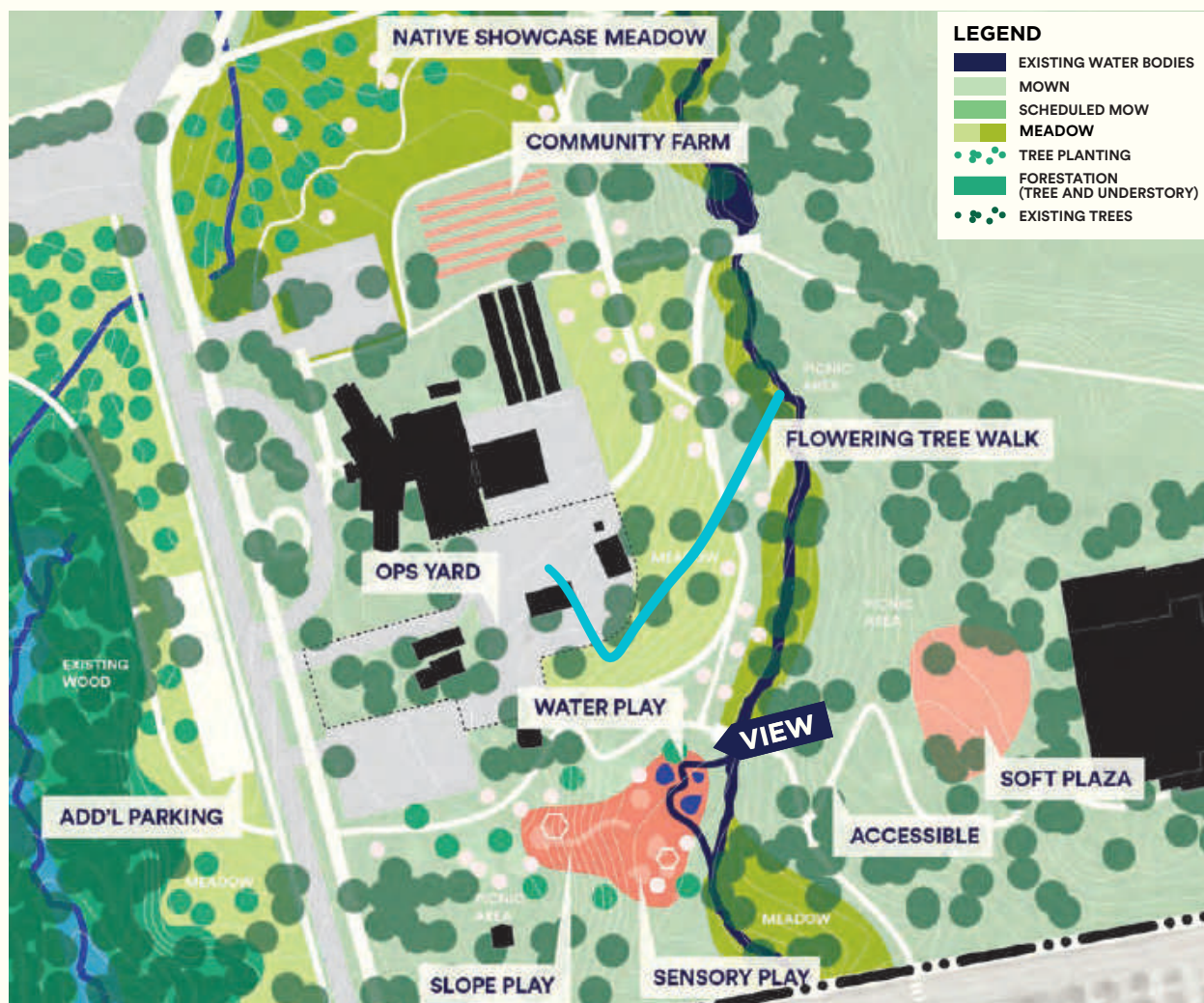



# THE HEART OF THE PARK

## NODE / CREEK

better water park pool splash pad

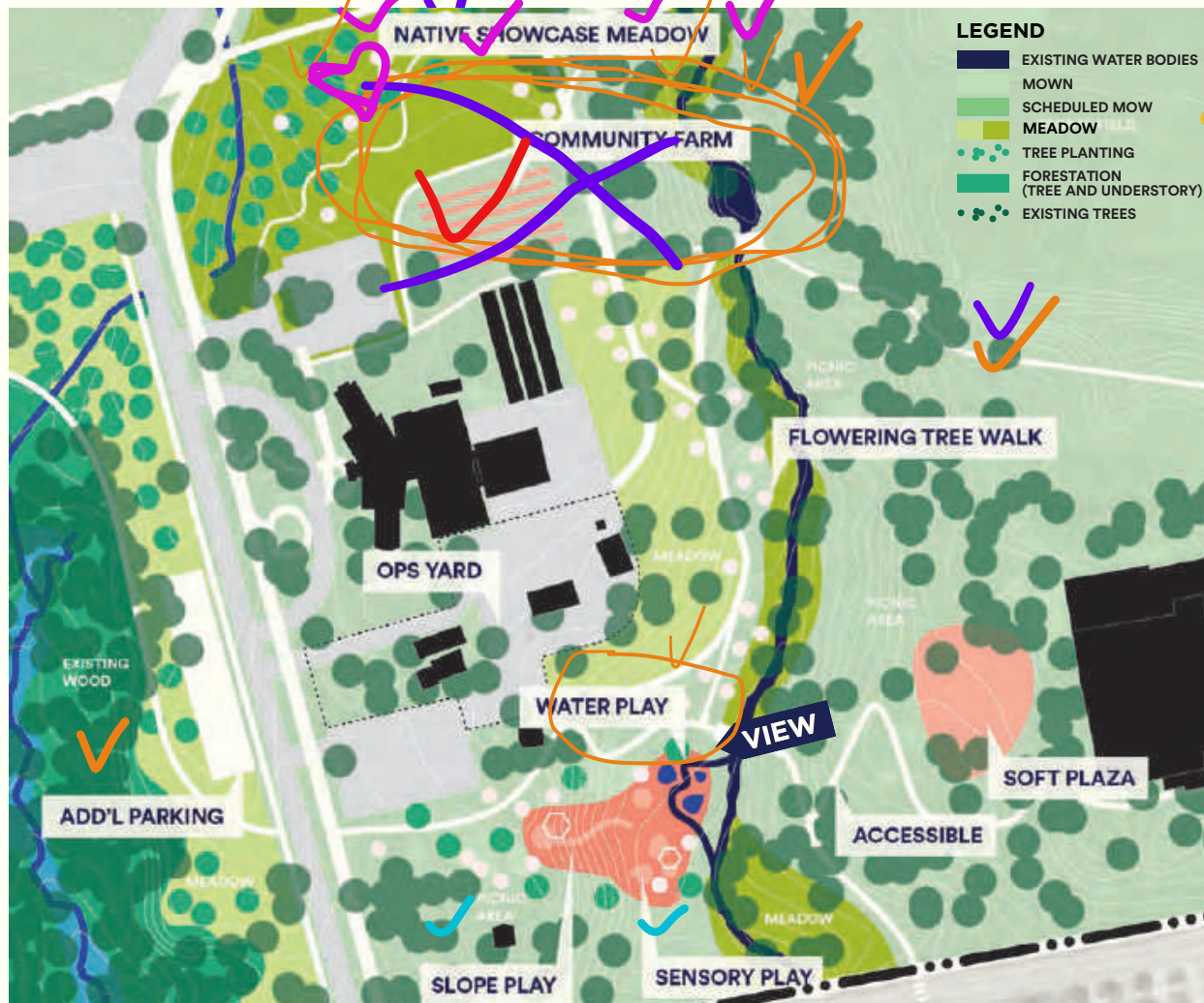



# THE HEART OF THE PARK

## NODE / CREEK

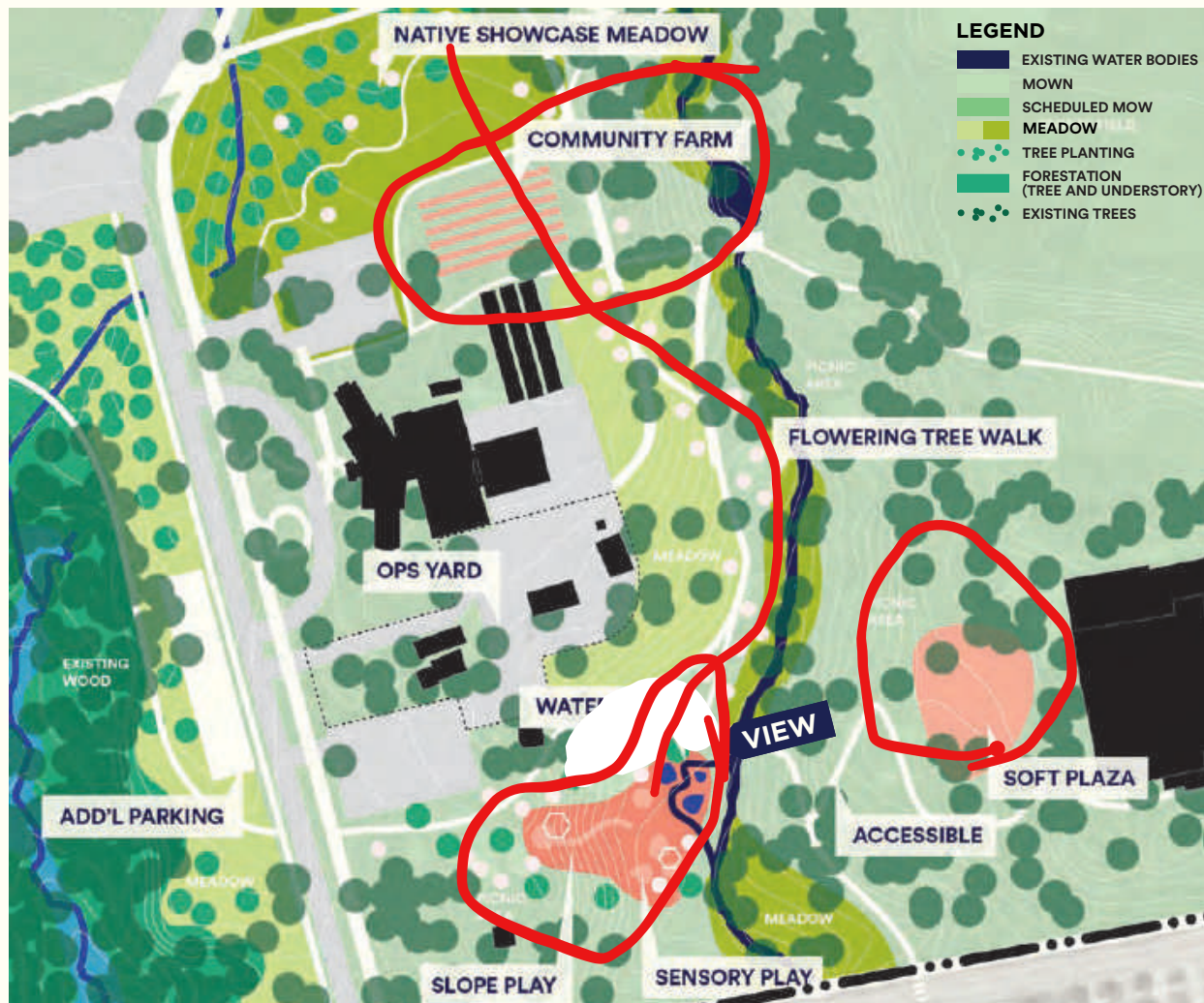



# THE HEART OF THE PARK

## PATH / AMPHITHEATRE

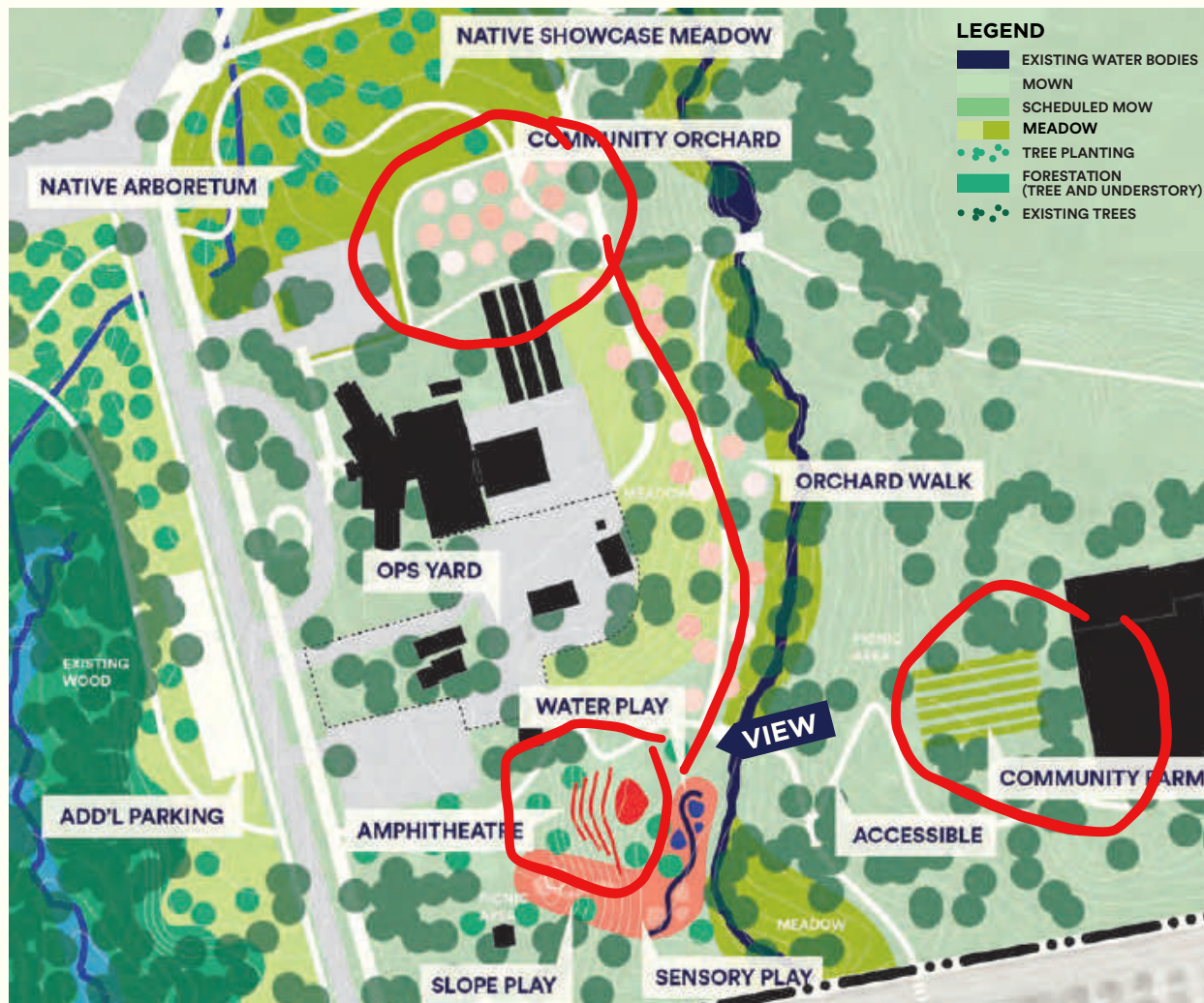



# THE HEART OF THE PARK

## PATH / AMPHITHEATRE

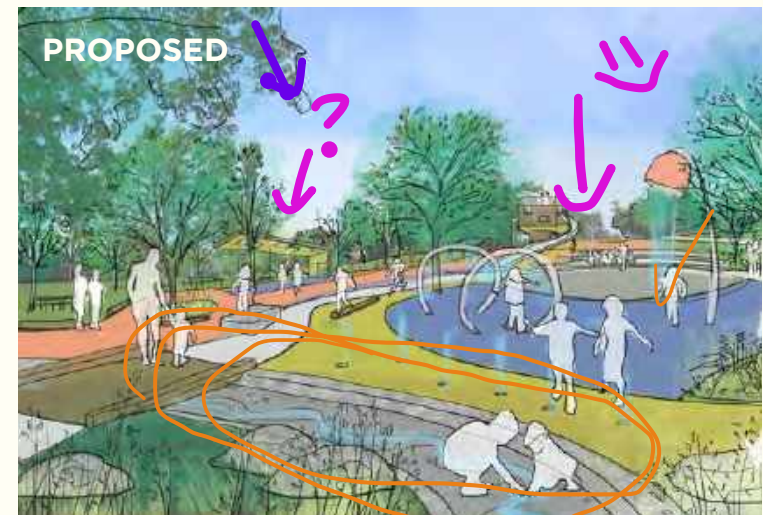
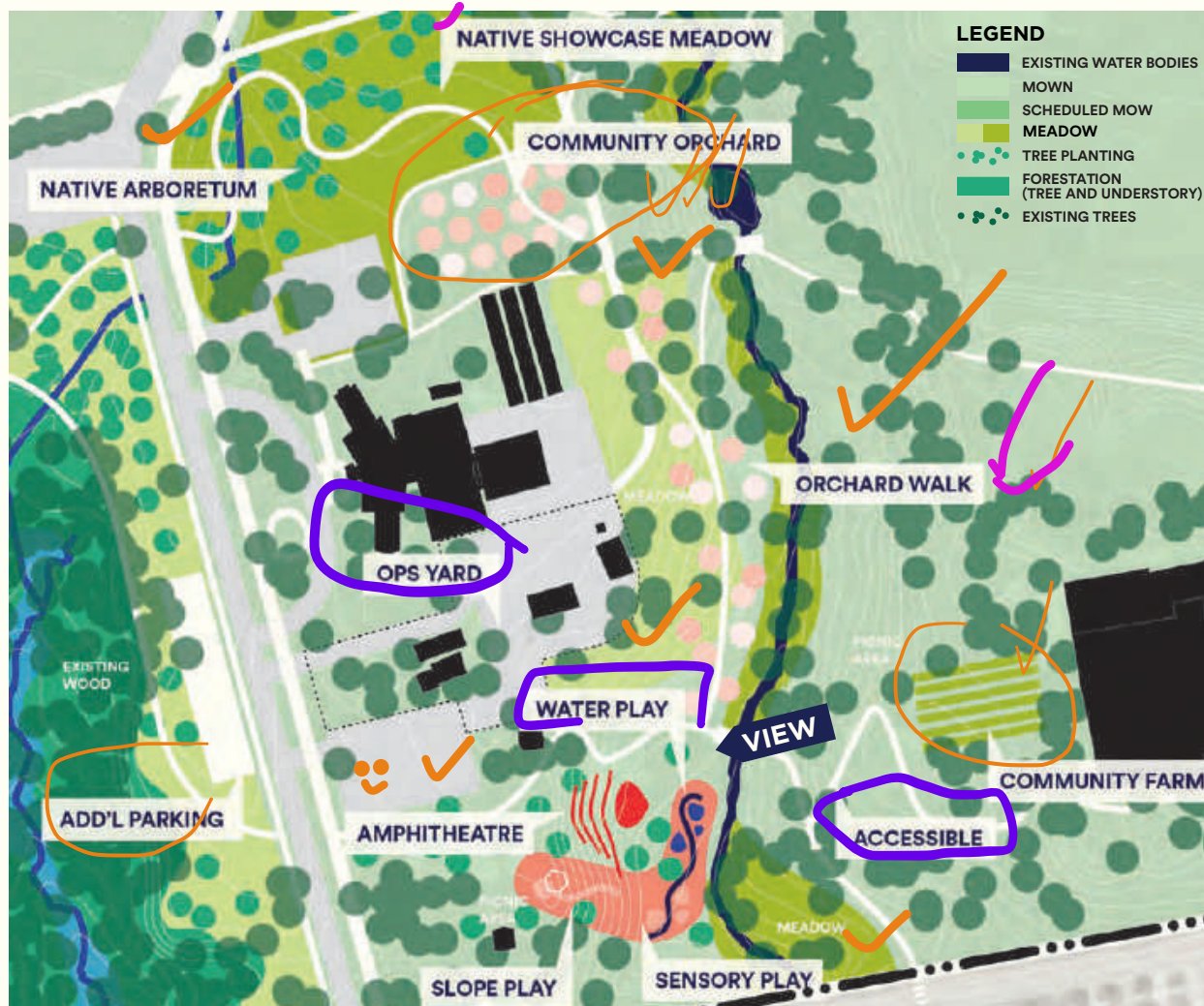



## ACTIVITY 3: HEART OF THE PARK

*Scribble! Check (✓) elements you prefer and mark (✗) the elements you don't prefer at the hill area.*

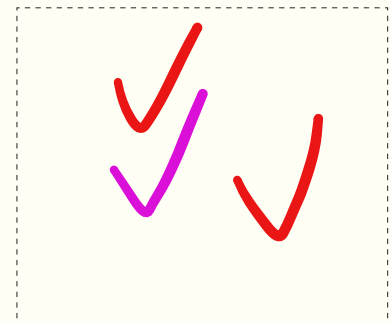
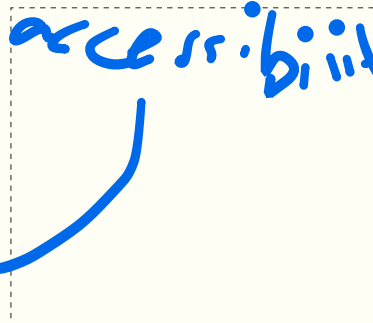
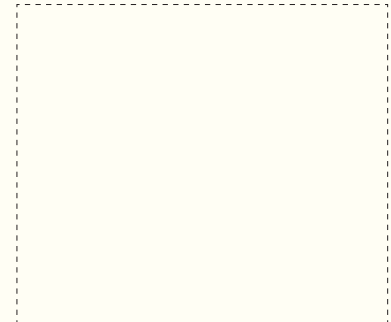
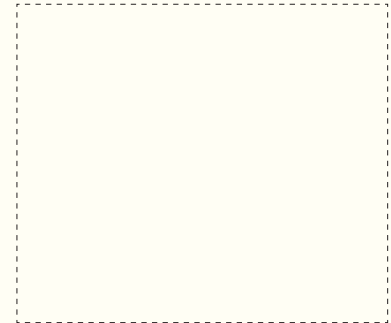
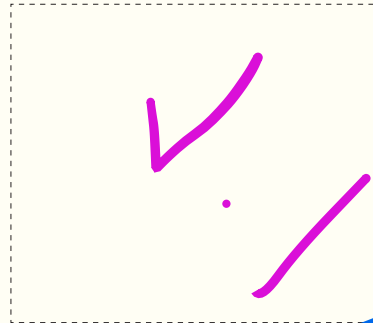

*accessibility?*

## ACTIVITY 3: HEART OF THE PARK

*Scribble! Check (✓) elements you prefer and mark (✗) the elements you don't prefer at the hill area.*

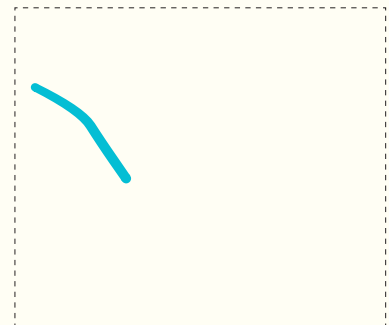
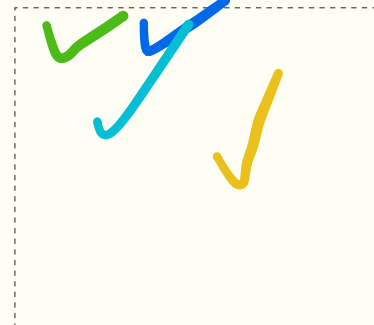
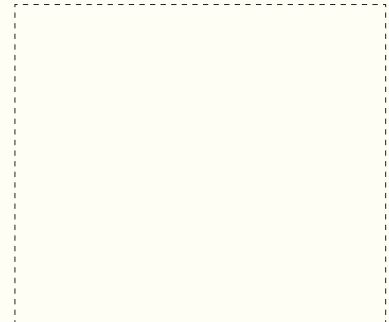
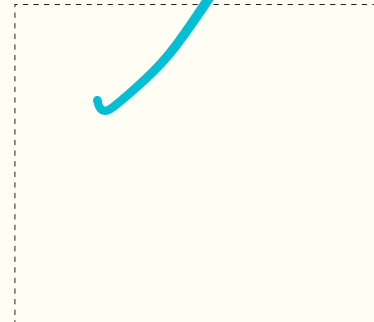
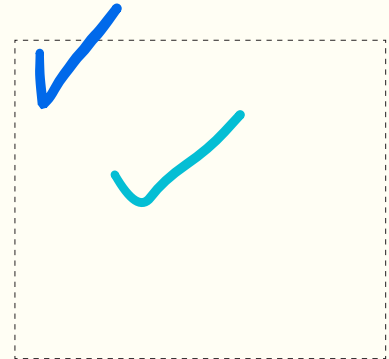
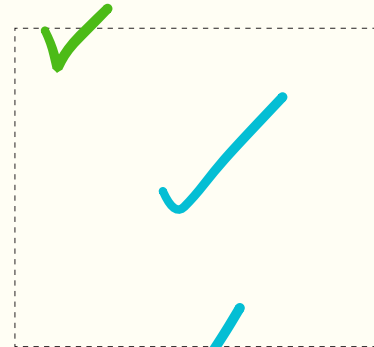



## ACTIVITY 3: HEART OF THE PARK

*Scribble! Check (✓) elements you prefer and mark (✗) the elements you don't prefer at the hill area.*



**NATURAL PLAYGROUND**

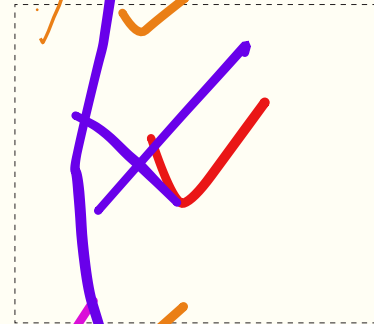

**FORMAL PLAYGROUND**

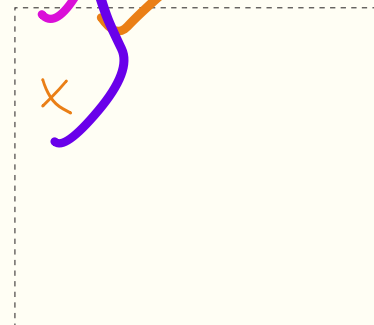
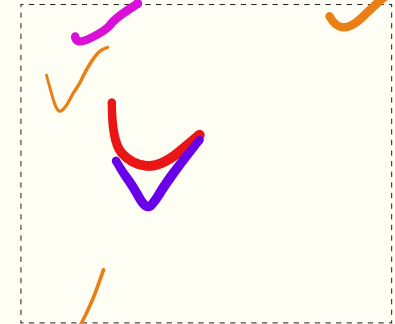

**AMPHITHEATRE**



## ACTIVITY 3: HEART OF THE PARK

Scribble! Check (✓) elements you prefer and mark (✗) the elements you don't prefer at the hill area.

Play = out of ordinary

Node / Creek

Path / Amphitheatre

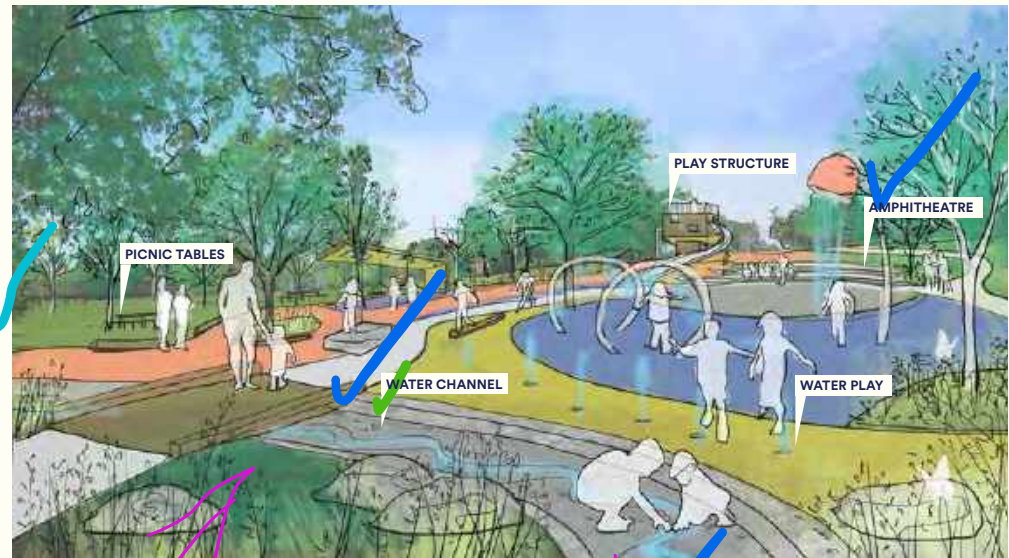

Large chess board

Natural ✓✓✓

What play elements would you like to see for the district playground?

Love it

Large ✓



## ACTIVITY 3: HEART OF THE PARK

Scribble! Check (✓) elements you prefer and mark (X) the elements you don't prefer at the hill area.

Node / Creek ✓

Path / Amphitheatre

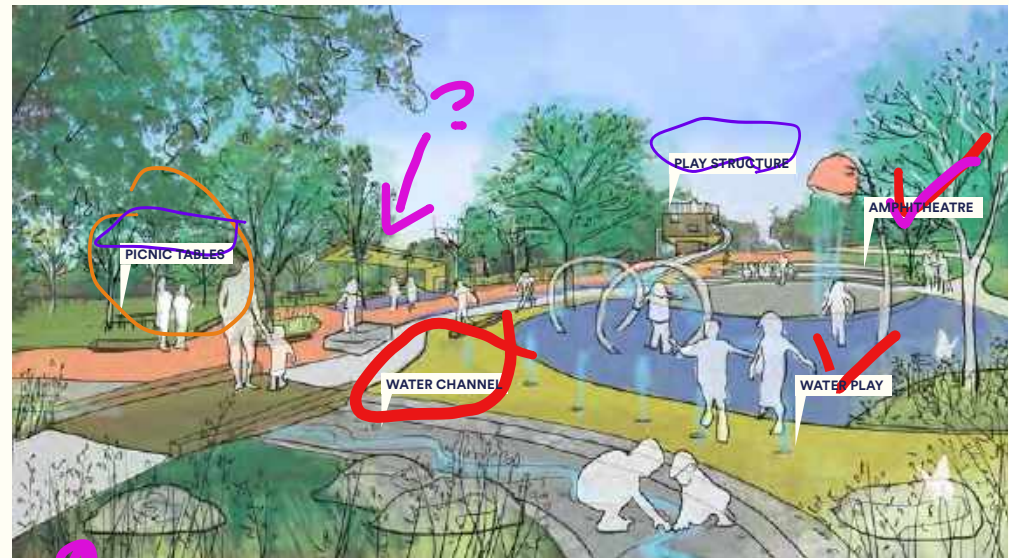

Like  
Connectivity but accessibility

What play elements would you like to see for the district playground?

## ACTIVITY 3: HEART OF THE PARK

*Scribble! Check ( ) elements you prefer and mark (X) the elements you don't prefer at the hill area.*

### Node / Creek

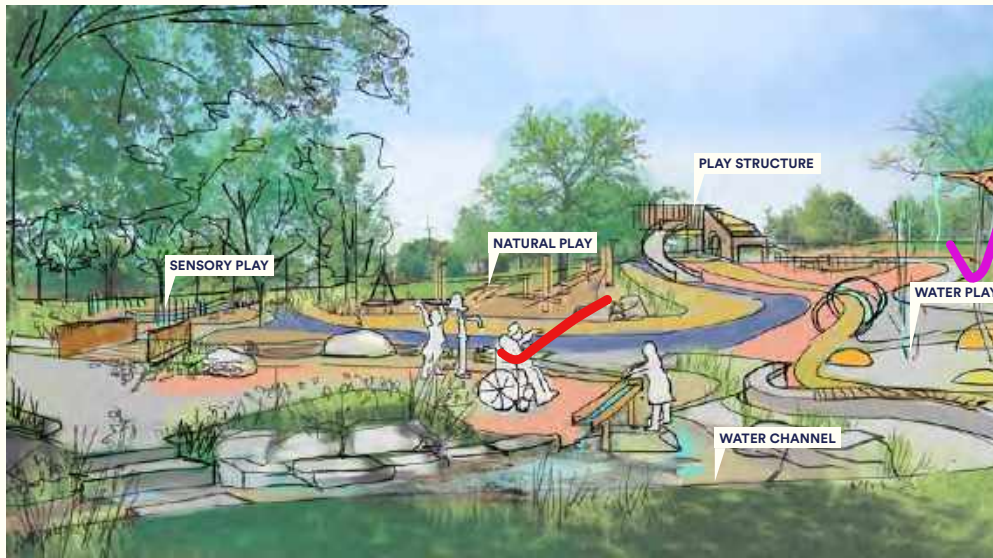

### Path / Amphitheatre



accessibility in playground

What play elements would you like to see for the district playground?

culture = dynamic



## ACTIVITY 3: HEART OF THE PARK

*Scribble! Check (✓) elements you prefer and mark (X) the elements you don't prefer at the hill area.*

### Node / Creek

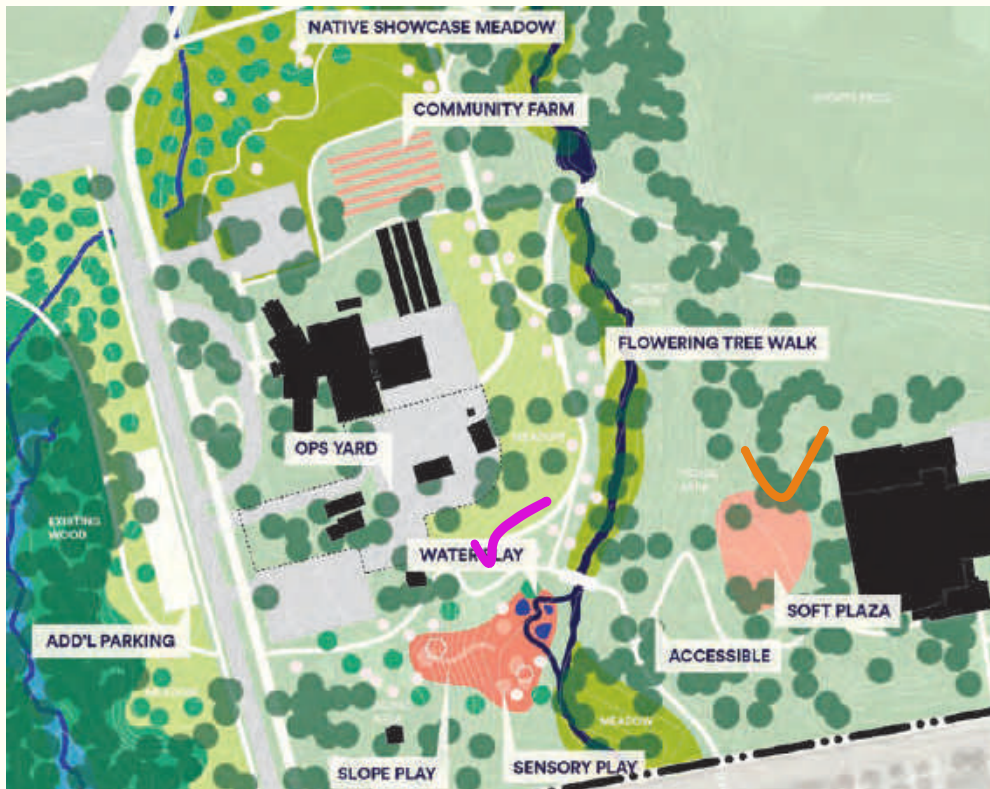

### Path / Amphitheatre

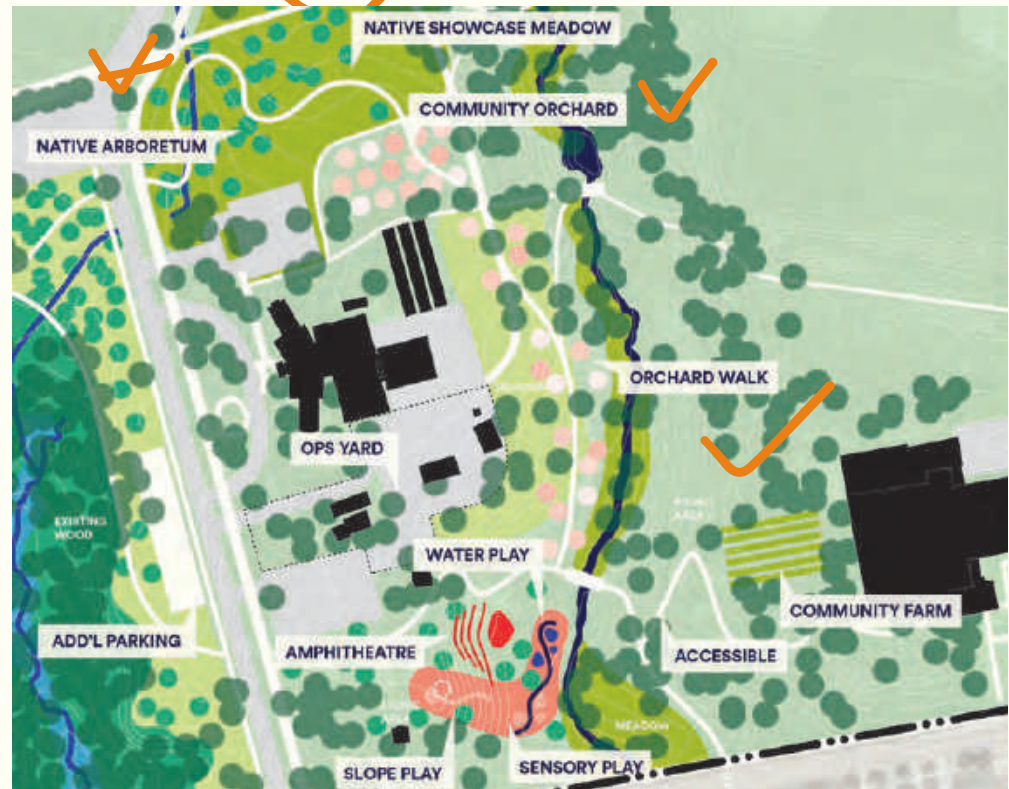

Thinking of this area being next to the Conservatory, neighbourhood and Olympium, which plan resonates with you most? What other ideas are missing?



## ACTIVITY 3: HEART OF THE PARK

Scribble! Check ( ) elements you prefer and mark (X) the elements you don't prefer at the hill area.

lighting → ~~fun~~ → bright Also Safety

Node / Creek

Path / Amphitheatre

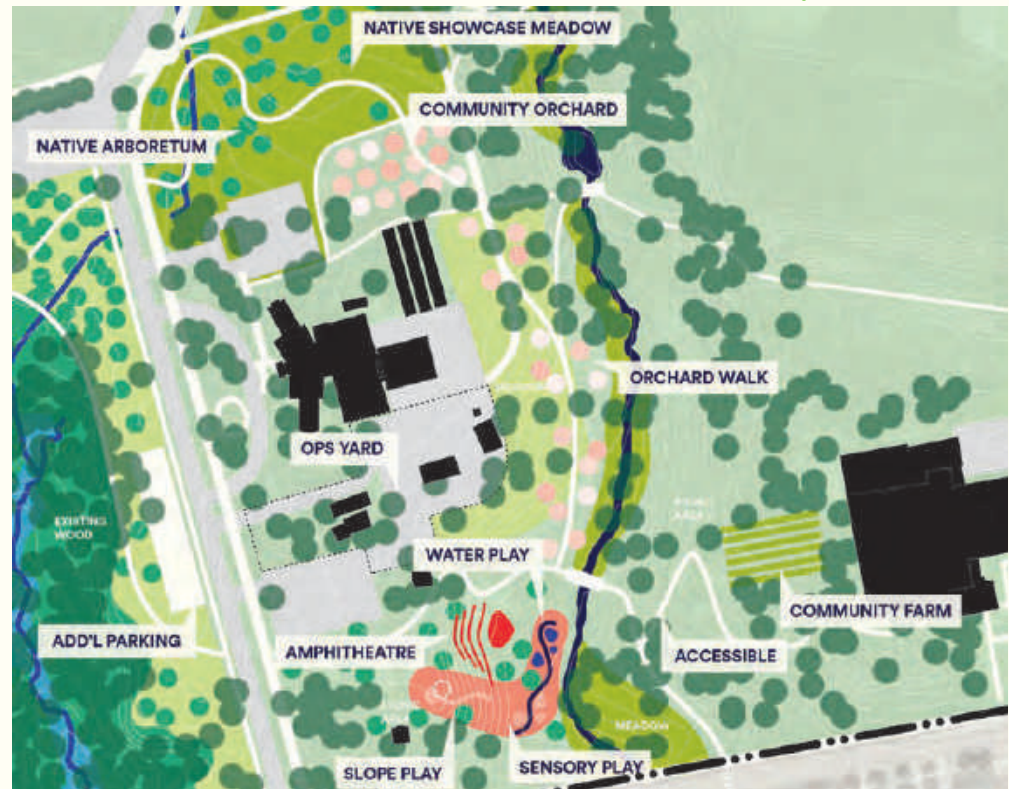
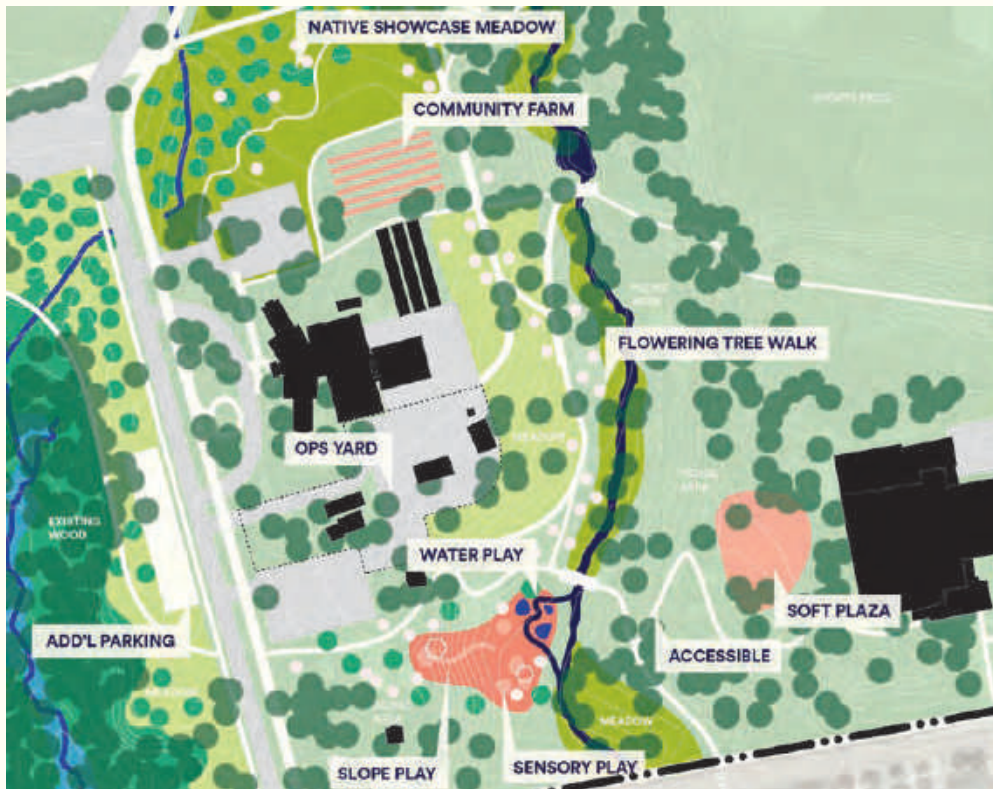

Thinking of this area being next to the Conservatory, neighbourhood and Olympium, which plan resonates with you most? What other ideas are missing?



## ACTIVITY 3: HEART OF THE PARK

*Scribble! Check ( ) elements you prefer and mark (X) the elements you don't prefer at the hill area.*



### Node / Creek

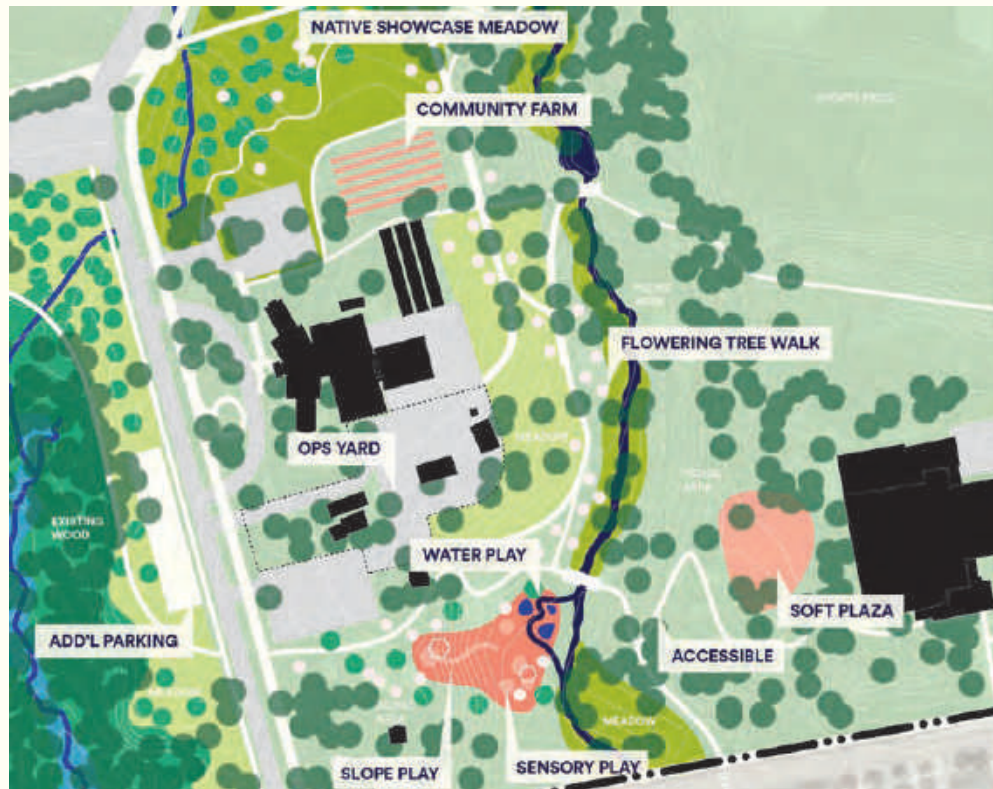

### Path / Amphitheatre

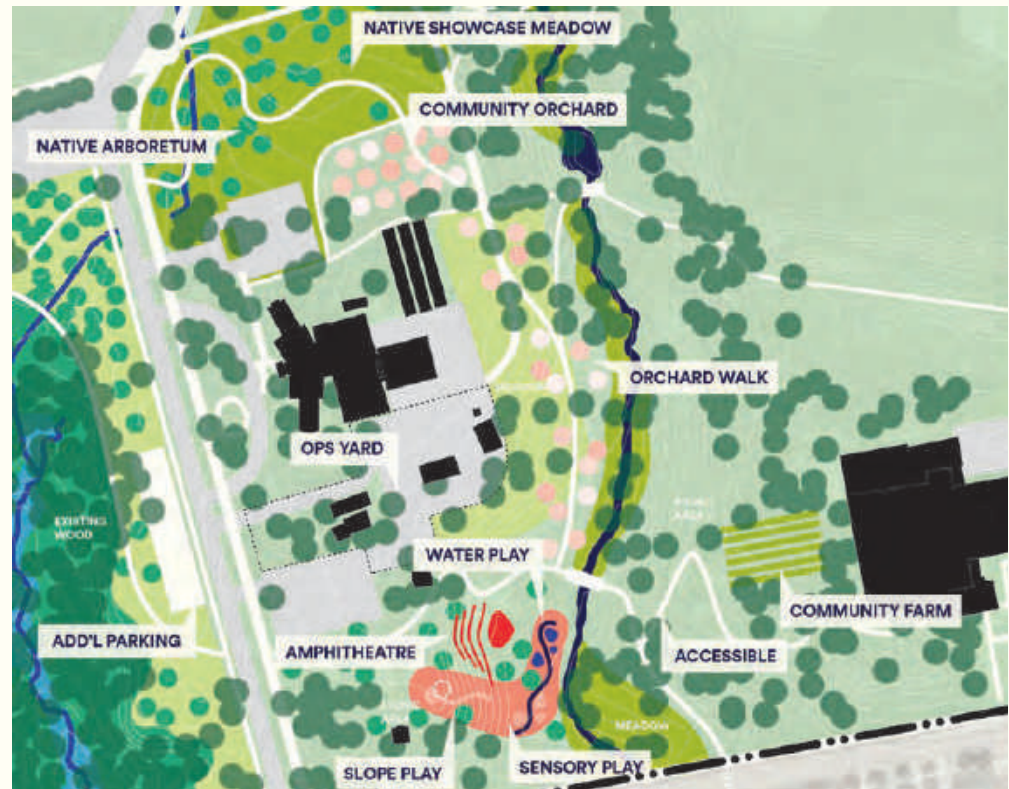

Thinking of this area being next to the Conservatory, neighbourhood and Olympium, which plan resonates with you most? What other ideas are missing?