

PLANS & DETAILS

PLANS

- L1 PLANTING PLAN
- L2 PLANTING PLAN
- L3 PLANTING PLAN
- L4 PLANTING PLAN
- L5 PLANTING PLAN
- L6 PLANTING PLAN
- LR1 ADAM'S CREEK RESTORATION PLAN

DETAILS

- LD1 DETAILS

PORT UNION ROAD RECONSTRUCTION
LAWRENCE AVE. E TO ISLAND RD.
CITY OF TORONTO

LANDSCAPE ARCHITECTURAL PLANS



REVISED PER UPDATED ROAD ALIGNMENT: JULY 14, 2021
USING BASE INFORMATION - CANDEVCON LIMITED, JULY 30, 2021

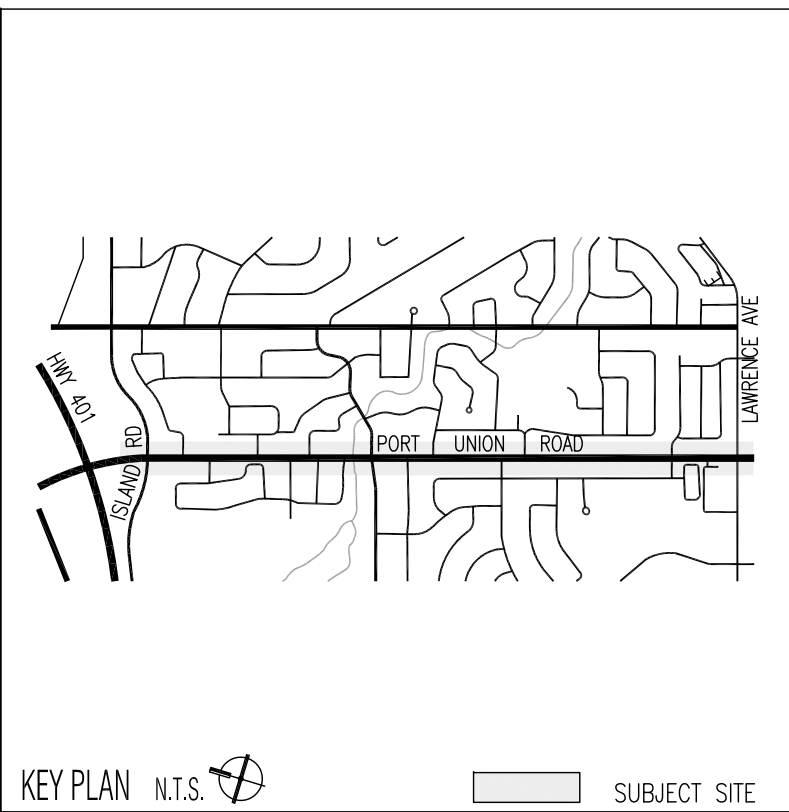

PREPARED FOR
CITY OF TORONTO

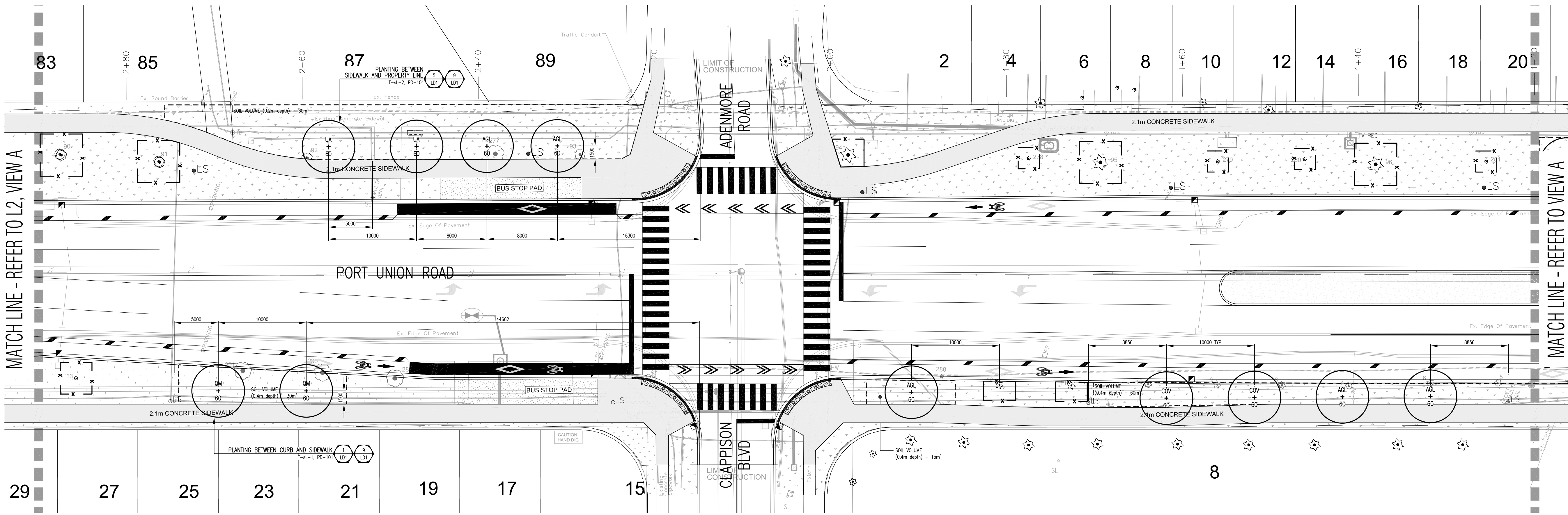
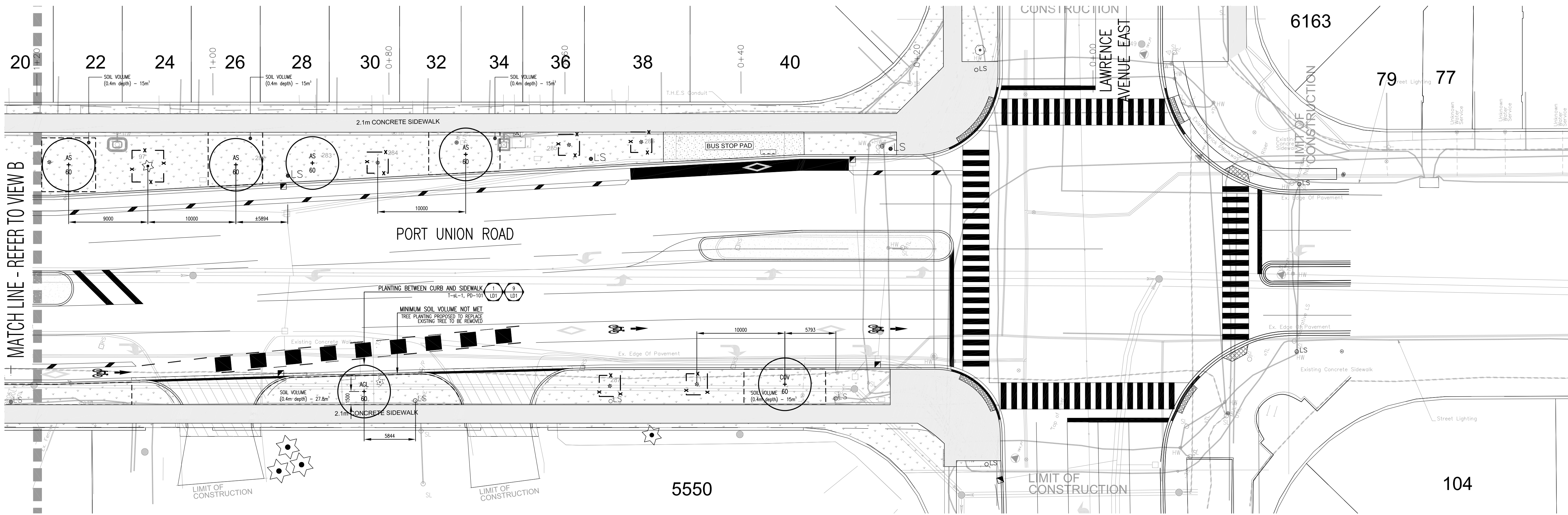

NOTE:
FOR TREE PRESERVATION, REMOVALS, AND PROPOSED PAVING WORKS,
REFER TO ENGINEERING DRAWINGS PREPARED BY CANDEVCON LTD.

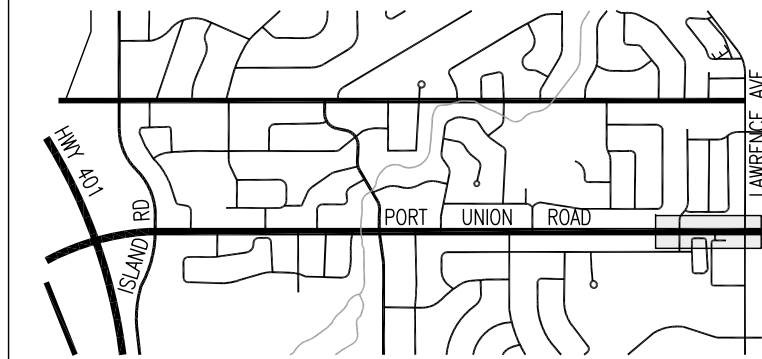

KEY PLAN N.T.S.

LEGEND

- x — x — TREE PROTECTION BARRIER (REFER TO ENGINEERING DRAWINGS PREPARED BY CANDEVCON LIMITED)
- — — PROPOSED SIDEWALK (REFER TO ENGINEERING DRAWINGS PREPARED BY CANDEVCON LIMITED)
- — — PROPOSED ASPHALT DRIVEWAY (REFER TO ENGINEERING DRAWINGS PREPARED BY CANDEVCON LIMITED)
- — — TOPSOIL AND SOD RESTORATION (REFER TO ENGINEERING DRAWINGS PREPARED BY CANDEVCON LIMITED)
- ⊙ EXISTING DECIDUOUS TREE TO BE PRESERVED
- ⊙ EXISTING CONIFEROUS TREE TO BE PRESERVED
- ⊙ EXISTING DECIDUOUS TREE TO BE REMOVED
- ⊙ EXISTING CONIFEROUS TREE TO BE REMOVED
- ⊕ DECIDUOUS TREE PLANTING
- ⊕ DETAIL NUMBER (REFER TO DETAIL SHEET LD1 FOR FULL PLANT LIST)

PLANT SUMMARY
REFER TO DETAIL SHEET LD1 FOR FULL PLANT LIST

KEY	BOTANICAL NAME	COMMON NAME
AGL60	Aesculus glabra	Ohio Buckeye
AH60	Aesculus hippocastanum	Horsechestnut
AS60	Acer saccharum	Sugar Maple
CO60	Celtis occidentalis	Hackberry
COV60	Carya ovata	Shagbark Hickory
GO60	Gymnocladus dioica	Kentucky Coffee Tree
LT60	Liriodendron tulipifera	Tulip Tree
QC60	Quercus coccinea	Scarlet Oak
QM60	Quercus macrocarpa	Bur Oak
QRU60	Quercus rubra	Red Oak
UA60	Ulmus americana 'Valley Forge'	Valley Forge Elm

Base Information
Base information received in digital format from Candevcon Limited, Project No. w17054, Drawings dated June 25, 2021 and received June 30, 2021.

6	Revised per Updated Road Alignment	MB	21 07 14
5	Revised per TRCA Comments	MB	21 06 30
4	Revised per City Comments	MB	21 05 20
3	90% Submission (Number 2)	MB	21 03 12
2	Revised 90% Submission	MB	18 04 24
No	Revision	By	Yr Mo Da

All drawings and designs are the property of Cosburn Nauboris Limited and may not be used or reproduced without permission. This drawing must not be scaled.

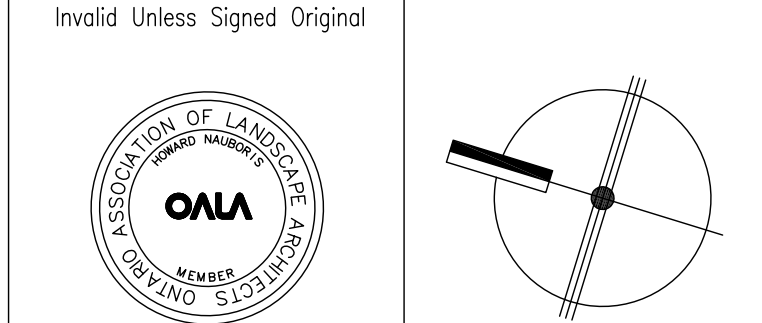

cosburn nauboris LTD
landscape architects
cosburnnauboris.ca

PORT UNION ROAD RECONSTRUCTION
LAWRENCE AVE. E TO ISLAND RD.
CITY OF TORONTO

PLANTING PLAN

Drawn by	MB	Scale	1:250
Checked by	HN	Plot Date	2021-07-14
Approved by	HN	Project	2230
			L1 Drawing No.

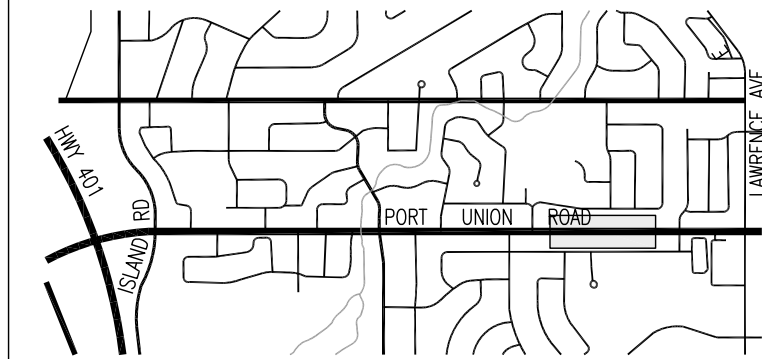
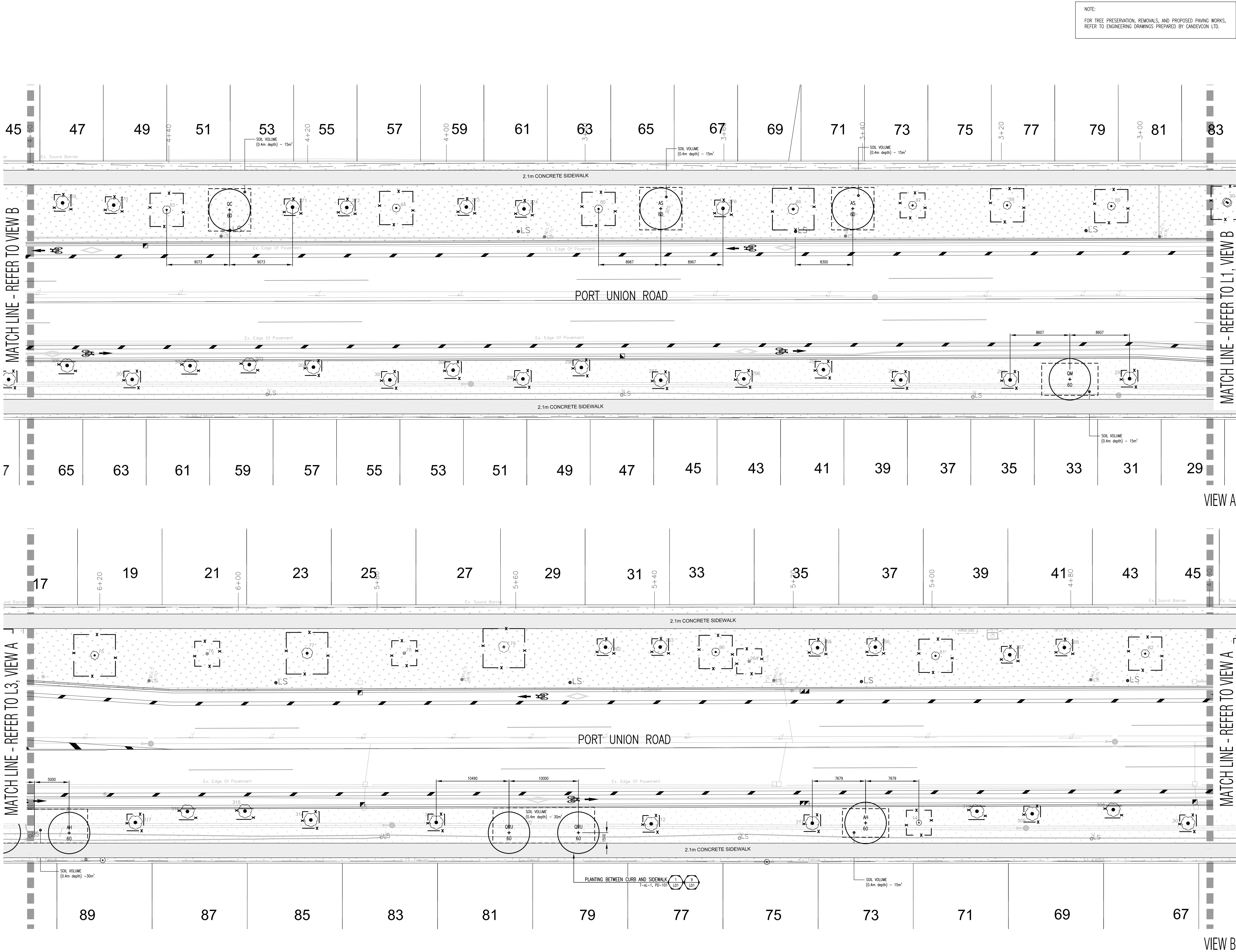

KEY PLAN N.T.S. SUBJECT SITE

- LEGEND
- TREE PROTECTION BARRIER (REFER TO ENGINEERING DRAWINGS PREPARED BY CANDEVCON LIMITED)
 - PROPOSED SIDEWALK (REFER TO ENGINEERING DRAWINGS PREPARED BY CANDEVCON LIMITED)
 - PROPOSED ASPHALT DRIVEWAY (REFER TO ENGINEERING DRAWINGS PREPARED BY CANDEVCON LIMITED)
 - TOPSOIL AND SOD RESTORATION (REFER TO ENGINEERING DRAWINGS PREPARED BY CANDEVCON LIMITED)
 - EXISTING DECIDUOUS TREE TO BE PRESERVED
 - EXISTING CONIFEROUS TREE TO BE PRESERVED
 - EXISTING DECIDUOUS TREE TO BE REMOVED
 - EXISTING CONIFEROUS TREE TO BE REMOVED
 - DECIDUOUS TREE PLANTING
 - DETAIL NUMBER
DRAWING NUMBER

PLANT SUMMARY

REFER TO DETAIL SHEET LD1 FOR FULL PLANT LIST

DECIDUOUS TREES		
KEY	BOTANICAL NAME	COMMON NAME
AQL60	Aesculus glabra	Ohio Buckeye
AH60	Aesculus hippocastanum	Horsechestnut
AS60	Acer saccharum	Sugar Maple
CO60	Celtis occidentalis	Hackberry
COV60	Carya ovata	Shagbark Hickory
GO60	Gymnocladus dioica	Kentucky Coffee Tree
LT60	Liriodendron tulipifera	Tulip Tree
QO60	Quercus coccinea	Scarlet Oak
QM60	Quercus macrocarpa	Bur Oak
QRU60	Quercus rubra	Red Oak
UA60	Ulmus americana 'Valley Forge'	Valley Forge Elm

Base Information
Base information received in digital format from Candevcon Limited, Project No. w17054, Drawings dated June 25, 2021 and received June 30, 2021.

6	Revised per Updated Road Alignment	MB	21 07 14
5	Revised per TRCA Comments	MB	21 06 30
4	Revised per City Comments	MB	21 05 20
3	90% Submission (Number 2)	MB	21 03 12
2	Revised 90% Submission	MB	18 04 24
No	Revision	By	Yr Mo Da

All drawings and designs are the property of Cosburn Nauboris Limited and may not be used or reproduced without permission. This drawing must not be scaled.

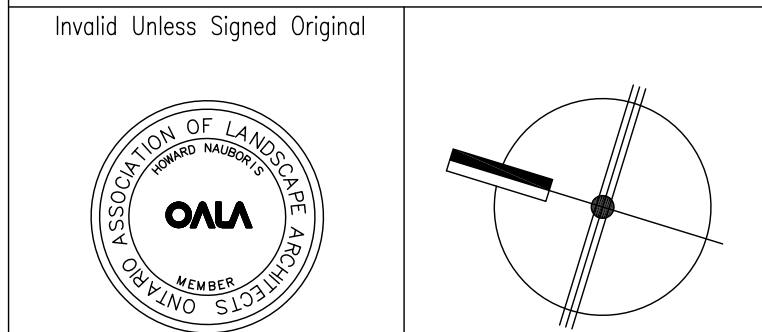

cosburn nauboris LTD
landscape architects
cosburnnauboris.ca

PORT UNION ROAD RECONSTRUCTION
LAWRENCE AVE. E TO ISLAND RD.
CITY OF TORONTO

PLANTING PLAN		
Drawn by	MB	Scale 1:250
Checked by	HN	Plot Date 2021-07-14
Approved by	HN	Project 2230
		L2 Drawing No.

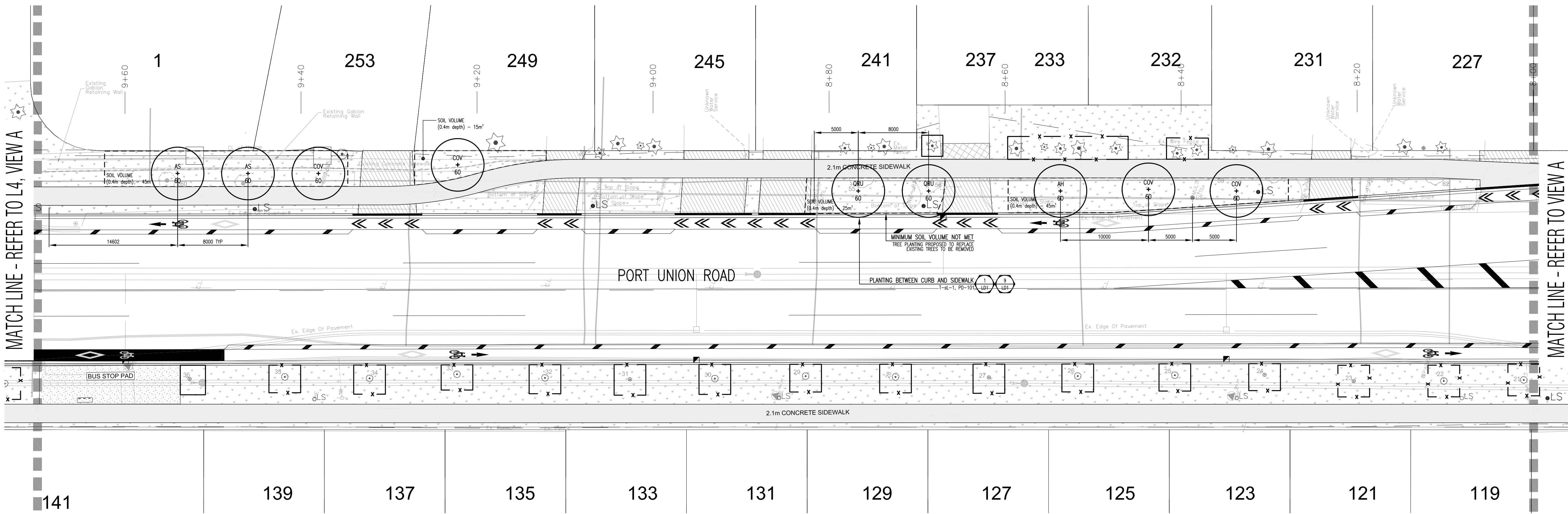
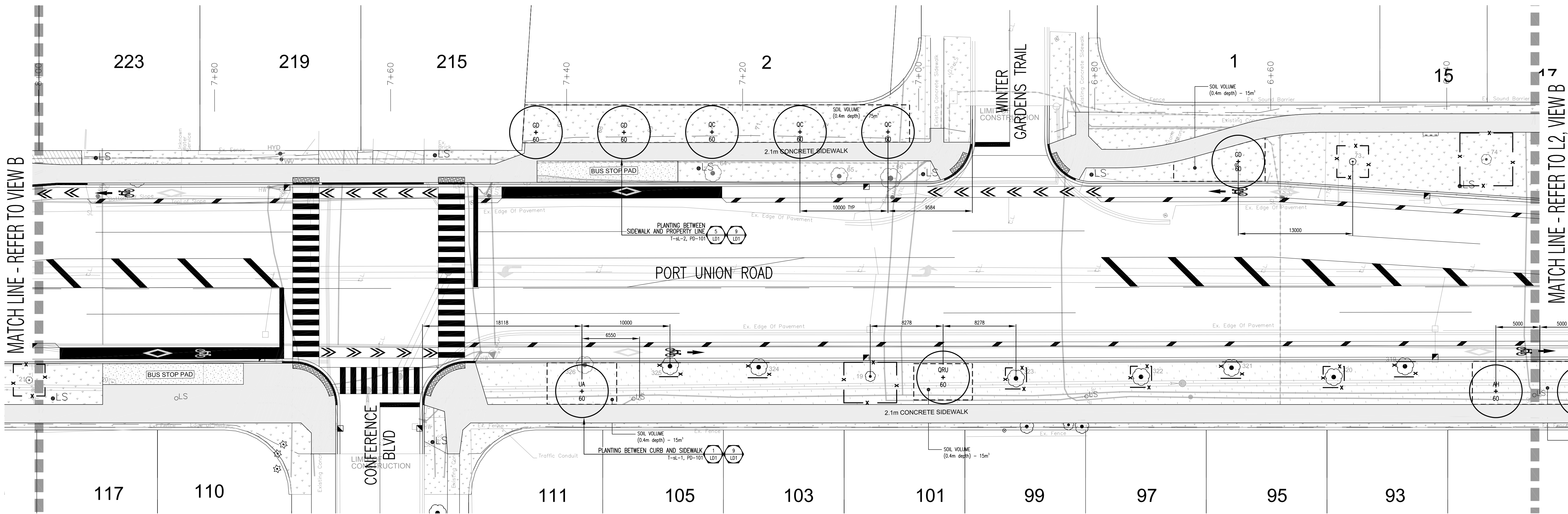

NOTE:
FOR TREE PRESERVATION, REMOVALS, AND PROPOSED PAVING WORKS,
REFER TO ENGINEERING DRAWINGS PREPARED BY CANDEVCON LTD.

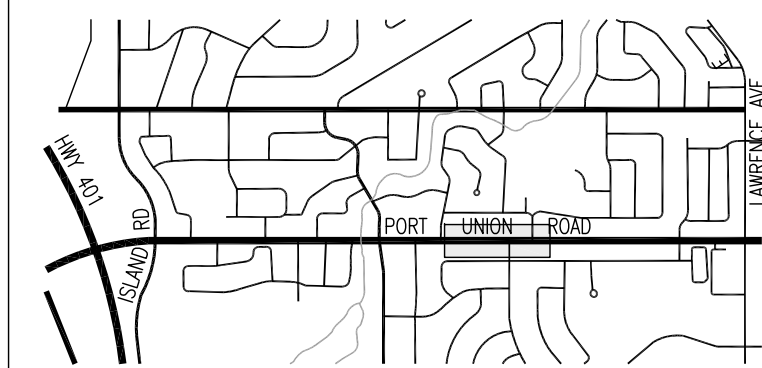

- LEGEND
- TREE PROTECTION BARRIER (REFER TO ENGINEERING DRAWINGS PREPARED BY CANDEVCON LIMITED)
 - PROPOSED SIDEWALK (REFER TO ENGINEERING DRAWINGS PREPARED BY CANDEVCON LIMITED)
 - PROPOSED ASPHALT DRIVEWAY (REFER TO ENGINEERING DRAWINGS PREPARED BY CANDEVCON LIMITED)
 - TOPSOIL AND SOD RESTORATION (REFER TO ENGINEERING DRAWINGS PREPARED BY CANDEVCON LIMITED)
 - EXISTING DECIDUOUS TREE TO BE PRESERVED
 - EXISTING CONIFEROUS TREE TO BE PRESERVED
 - EXISTING DECIDUOUS TREE TO BE REMOVED
 - EXISTING CONIFEROUS TREE TO BE REMOVED
 - DECIDUOUS TREE PLANTING
 - DETAIL NUMBER
 - DRAWING NUMBER

PLANT SUMMARY

REFER TO DETAIL SHEET LD1 FOR FULL PLANT LIST

DECIDUOUS TREES		
KEY	BOTANICAL NAME	COMMON NAME
AQL60	Aesculus glabra	Ohio Buckeye
AH60	Aesculus hippocastanum	Horsechestnut
AS60	Acer saccharum	Sugar Maple
CO60	Celtis occidentalis	Hackberry
COV60	Carya ovata	Shagbark Hickory
GO60	Gymnocladus dioica	Kentucky Coffee Tree
LT60	Liriodendron tulipifera	Tulip Tree
QO60	Quercus coccinea	Scarlet Oak
QM60	Quercus macrocarpa	Bur Oak
QRU60	Quercus rubra	Red Oak
UA60	Ulmus americana 'Valley Forge'	Valley Forge Elm

Base Information
Base information received in digital format from Candevcon Limited, Project No. w17054, Drawings dated June 25, 2021 and received June 30, 2021.

6	Revised per Updated Road Alignment	MB	21 07 14
5	Revised per TRCA Comments	MB	21 06 30
4	Revised per City Comments	MB	21 05 20
3	90% Submission (Number 2)	MB	21 03 12
2	Revised 90% Submission	MB	18 04 24
No	Revision	By	Yr Mo Da

All drawings and designs are the property of Cosburn Nauboris Limited and may not be used or reproduced without permission. This drawing must not be scaled.

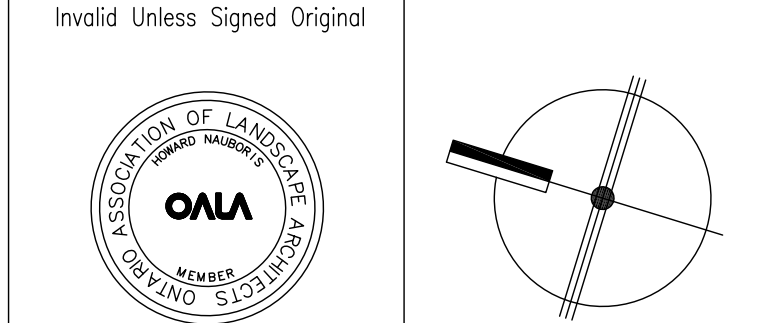

cosburn nauboris LTD
landscape architects
20 crown street dr. suite 2 markham, on l3r 9s9
1 905 940 4443
cosburnnauboris.ca

PORT UNION ROAD RECONSTRUCTION
LAWRENCE AVE. E TO ISLAND RD.
CITY OF TORONTO

PLANTING PLAN		
Drawn by	MB	Scale 1:250
Checked by	HN	Plot Date 2021-07-14
Approved by	HN	Project 2230
		L3 Drawing No.

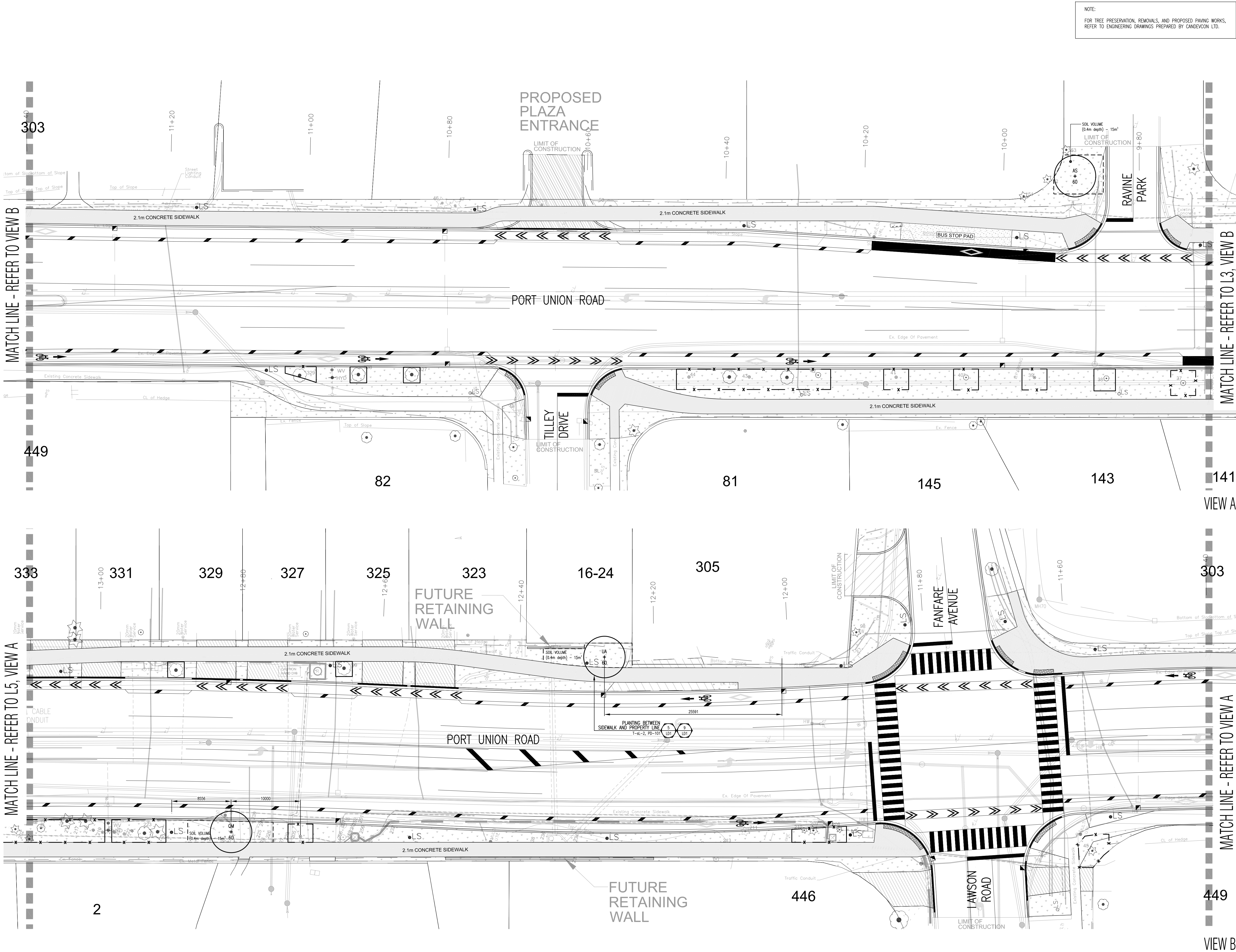

NOTE:
FOR TREE PRESERVATION, REMOVALS, AND PROPOSED PAVING WORKS,
REFER TO ENGINEERING DRAWINGS PREPARED BY CANDEVCON LTD.

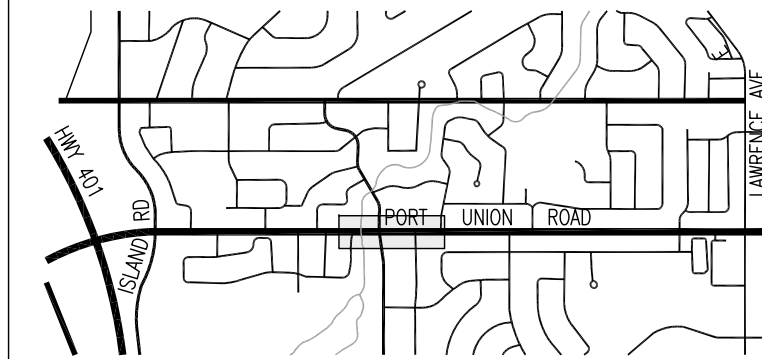

KEY PLAN N.T.S. SUBJECT SITE

- LEGEND
- x — x — TREE PROTECTION BARRIER (REFER TO ENGINEERING DRAWINGS PREPARED BY CANDEVCON LIMITED)
 - PROPOSED SIDEWALK (REFER TO ENGINEERING DRAWINGS PREPARED BY CANDEVCON LIMITED)
 - PROPOSED ASPHALT DRIVEWAY (REFER TO ENGINEERING DRAWINGS PREPARED BY CANDEVCON LIMITED)
 - TOPSOIL AND SOD RESTORATION (REFER TO ENGINEERING DRAWINGS PREPARED BY CANDEVCON LIMITED)
 - EXISTING DECIDUOUS TREE TO BE PRESERVED
 - EXISTING CONIFEROUS TREE TO BE PRESERVED
 - EXISTING DECIDUOUS TREE TO BE REMOVED
 - EXISTING CONIFEROUS TREE TO BE REMOVED
 - DECIDUOUS TREE PLANTING
 - DETAIL NUMBER DRAWING NUMBER

PLANT SUMMARY

REFER TO DETAIL SHEET LD1 FOR FULL PLANT LIST

DECIDUOUS TREES		
KEY	BOTANICAL NAME	COMMON NAME
AQL60	Aesculus glabra	Ohio Buckeye
AH60	Aesculus hippocastanum	Horsechestnut
AS60	Acer saccharum	Sugar Maple
CO60	Celtis occidentalis	Hackberry
COV60	Carya ovata	Shagbark Hickory
GO60	Gymnocladus dioica	Kentucky Coffee Tree
LT60	Liriodendron tulipifera	Tulip Tree
QC60	Quercus coccinea	Scarlet Oak
QM60	Quercus macrocarpa	Bur Oak
QRU60	Quercus rubra	Red Oak
UA60	Ulmus americana 'Valley Forge'	Valley Forge Elm

Base Information
Base information received in digital format from Candevcon Limited, Project No. w17054, Drawings dated June 25, 2021 and received June 30, 2021.

6	Revised per Updated Road Alignment	MB	21 07 14
5	Revised per TRCA Comments	MB	21 06 30
4	Revised per City Comments	MB	21 05 20
3	90% Submission (Number 2)	MB	21 03 12
2	Revised 90% Submission	MB	18 04 24
No	Revision	By	Yr Mo Da

All drawings and designs are the property of Cosburn Nauboris Limited and may not be used or reproduced without permission. This drawing must not be scaled.

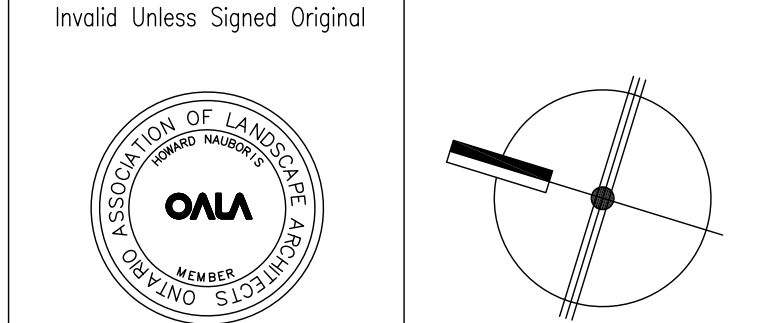

cosburn nauboris LTD
landscape architects
cosburnnauboris.ca

PORT UNION ROAD RECONSTRUCTION
LAWRENCE AVE. E TO ISLAND RD.
CITY OF TORONTO

PLANTING PLAN

Drawn by	MB	Scale	1:250
Checked by	HN	Plot Date	2021-07-14
Approved by	HN	Project	2230

L4
Drawing No.

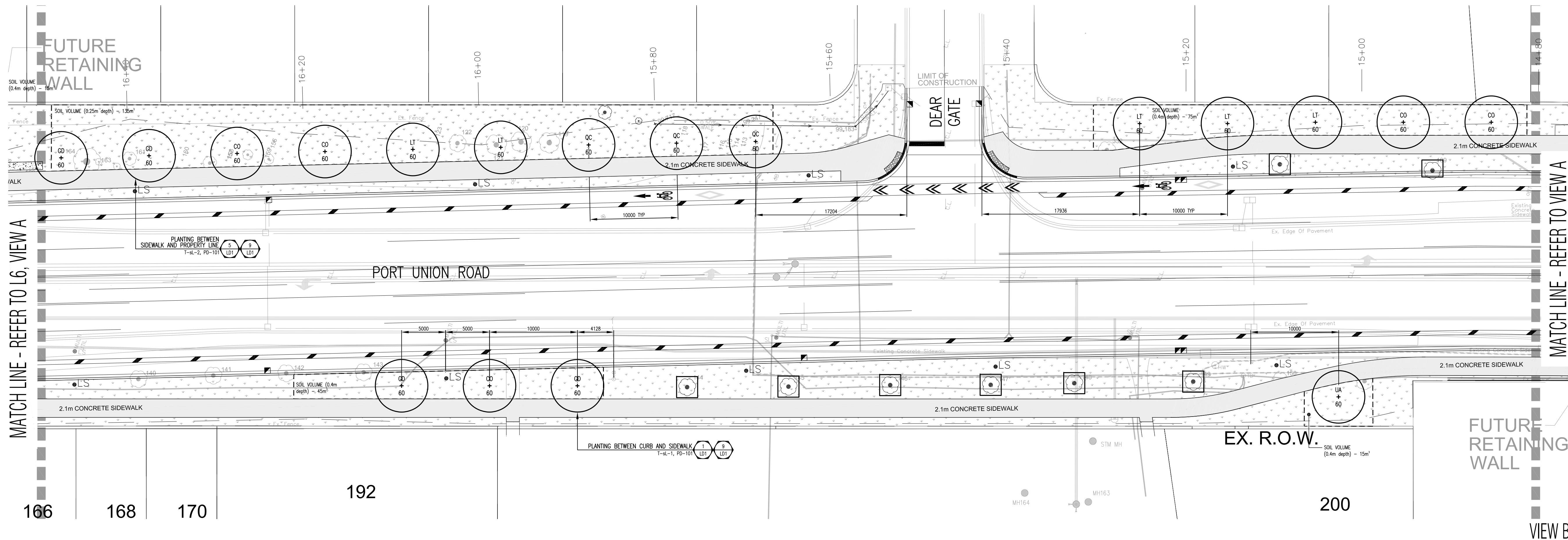
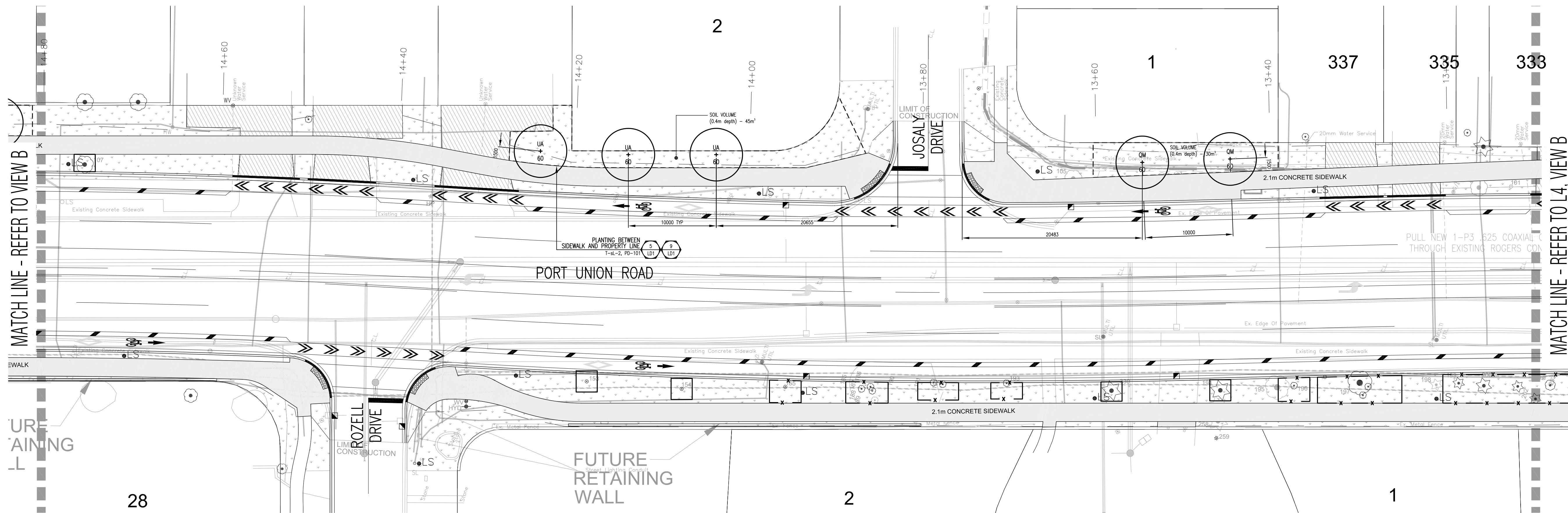

NOTE:
FOR TREE PRESERVATION, REMOVALS, AND PROPOSED PAVING WORKS,
REFER TO ENGINEERING DRAWINGS PREPARED BY CANDEVCON LTD.

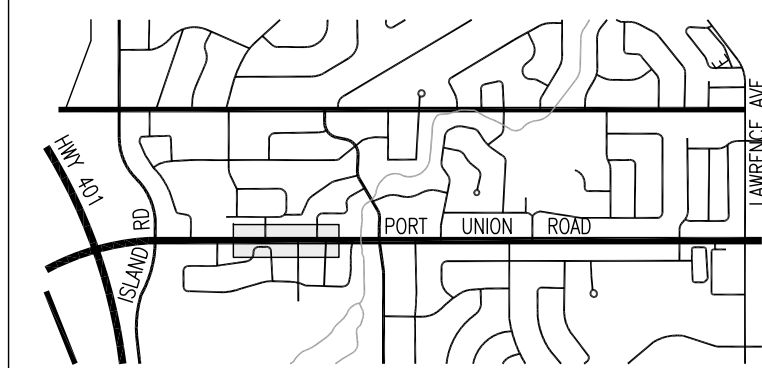

- LEGEND**
- x — x — TREE PROTECTION BARRIER (REFER TO ENGINEERING DRAWINGS PREPARED BY CANDEVCON LIMITED)
 - — — PROPOSED SIDEWALK (REFER TO ENGINEERING DRAWINGS PREPARED BY CANDEVCON LIMITED)
 - — — PROPOSED ASPHALT DRIVEWAY (REFER TO ENGINEERING DRAWINGS PREPARED BY CANDEVCON LIMITED)
 - — — TOPSOIL AND SOD RESTORATION (REFER TO ENGINEERING DRAWINGS PREPARED BY CANDEVCON LIMITED)
 - EXISTING CONIFEROUS TREE TO BE PRESERVED
 - EXISTING CONIFEROUS TREE TO BE REMOVED
 - EXISTING DECIDUOUS TREE TO BE PRESERVED
 - EXISTING DECIDUOUS TREE TO BE REMOVED
 - DECIDUOUS TREE PLANTING
 - DETAIL NUMBER
 - DRAWING NUMBER

PLANT SUMMARY

REFER TO DETAIL SHEET LD1 FOR FULL PLANT LIST

DECIDUOUS TREES		
KEY	BOTANICAL NAME	COMMON NAME
AQJ60	Aesculus glabra	Ohio Buckeye
AH60	Aesculus hippocastanum	Horsechestnut
AS60	Acer saccharum	Sugar Maple
CO60	Celtis occidentalis	Hackberry
COV60	Carya ovata	Shagbark Hickory
GO60	Gymnocladus dioica	Kentucky Coffee Tree
LT60	Liriodendron tulipifera	Tulip Tree
QC60	Quercus coccinea	Scarlet Oak
QM60	Quercus macrocarpa	Bur Oak
QRU60	Quercus rubra	Red Oak
UAB0	Ulmus americana 'Valley Forge'	Valley Forge Elm

Base Information
Base information received in digital format from Candevcon Limited, Project No. w17054, Drawings dated June 25, 2021 and received June 30, 2021.

6	Revised per Updated Road Alignment	MB	21 07 14
5	Revised per TRCA Comments	MB	21 06 30
4	Revised per City Comments	MB	21 05 20
3	90% Submission (Number 2)	MB	21 03 12
2	Revised 90% Submission	MB	18 04 24
No	Revision	By	Yr Mo Da

All drawings and designs are the property of Cosburn Nauboris Limited and may not be used or reproduced without permission. This drawing must not be scaled.

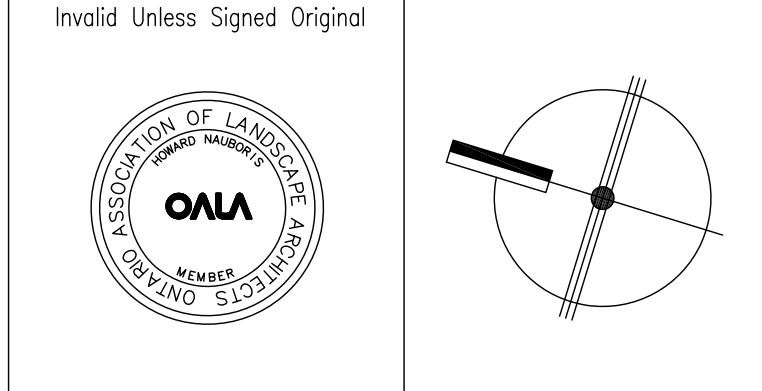

cosburn nauboris LTD
landscape architects
20 crown street dr. suite 2
markham, on L3R 9V9
1 905 940 4443
cosburnnauboris.ca

PORT UNION ROAD RECONSTRUCTION
LAWRENCE AVE. E TO ISLAND RD.
CITY OF TORONTO

PLANTING PLAN

Drawn by	MB	Scale	1:250
Checked by	HN	Plot Date	2021-07-14
Approved by	HN	Project	2230

L5
Drawing No.

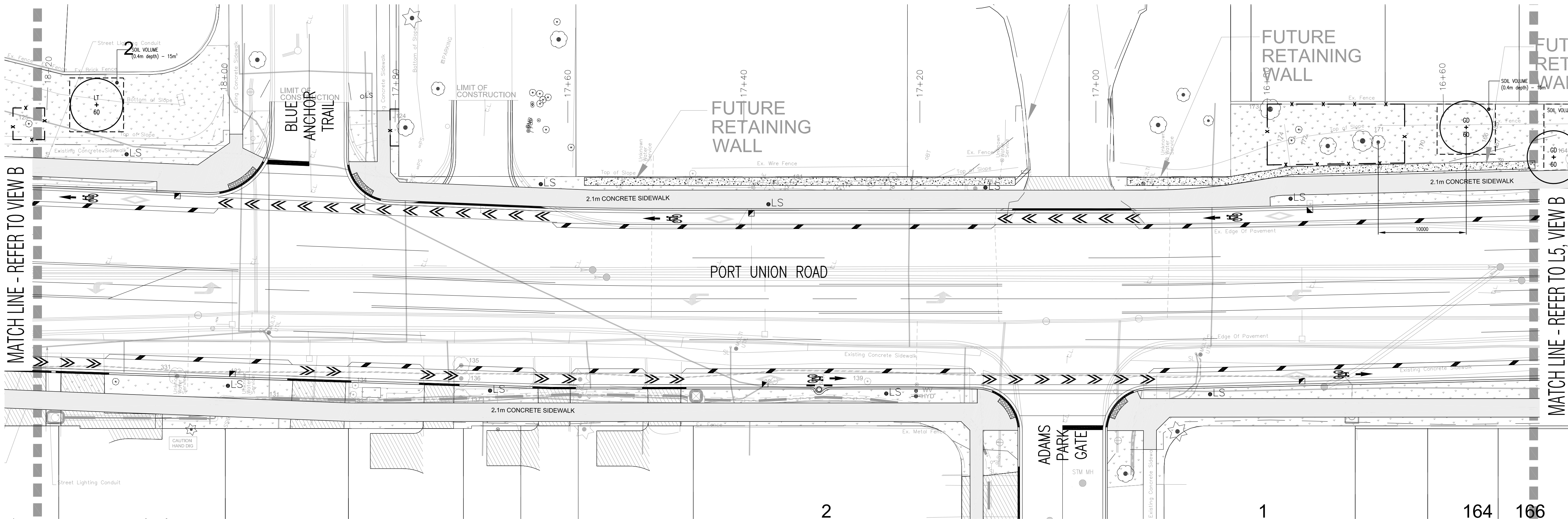

NOTE:
FOR TREE PRESERVATION, REMOVALS, AND PROPOSED PAVING WORKS,
REFER TO ENGINEERING DRAWINGS PREPARED BY CANDEVCON LTD.

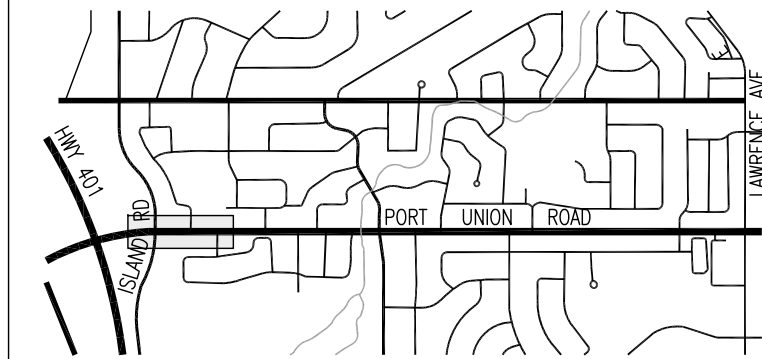

KEY PLAN N.T.S. SUBJECT SITE

LEGEND

- TREE PROTECTION BARRIER (REFER TO ENGINEERING DRAWINGS PREPARED BY CANDEVCON LIMITED)
- PROPOSED SIDEWALK (REFER TO ENGINEERING DRAWINGS PREPARED BY CANDEVCON LIMITED)
- PROPOSED ASPHALT DRIVEWAY (REFER TO ENGINEERING DRAWINGS PREPARED BY CANDEVCON LIMITED)
- TOPSOIL AND SOD RESTORATION (REFER TO ENGINEERING DRAWINGS PREPARED BY CANDEVCON LIMITED)
- EXISTING CONIFEROUS TREE TO BE PRESERVED
- EXISTING CONIFEROUS TREE TO BE REMOVED
- EXISTING CONIFEROUS TREE TO BE REMOVED
- DECIDUOUS TREE PLANTING
- DETAIL NUMBER DRAWING NUMBER

PLANT SUMMARY
REFER TO DETAIL SHEET LD1 FOR FULL PLANT LIST

KEY	BOTANICAL NAME	COMMON NAME
AQL60	Aesculus glabra	Ohio Buckeye
AH60	Aesculus hippocastanum	Horsechestnut
AS60	Acer saccharum	Sugar Maple
CO60	Celtis occidentalis	Hackberry
COV60	Corya ovata	Shagbark Hickory
GO60	Gymnocladus dioica	Kentucky Coffee Tree
LT60	Liriodendron tulipifera	Tulip Tree
QO60	Quercus coccinea	Scarlet Oak
QM60	Quercus macrocarpa	Bur Oak
QRU60	Quercus rubra	Red Oak
UAF60	Ulmus americana 'Valley Forge'	Valley Forge Elm

Base Information
Base information received in digital format from Candevcon Limited, Project No. w17054, Drawings dated June 25, 2021 and received June 30, 2021.

6	Revised per Updated Road Alignment	MB	21 07 14
5	Revised per TRCA Comments	MB	21 06 30
4	Revised per City Comments	MB	21 05 20
3	90% Submission (Number 2)	MB	21 03 12
2	Revised 90% Submission	MB	18 04 24
No	Revision	By	Yr Mo Da

All drawings and designs are the property of Cosburn Nauboris Limited and may not be used or reproduced without permission. This drawing must not be scaled.

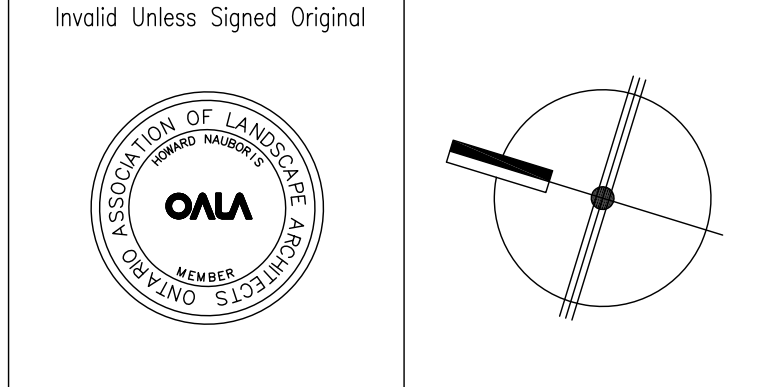

cosburn nauboris LTD
landscape architects
cosburnnauboris.ca

PORT UNION ROAD RECONSTRUCTION
LAWRENCE AVE. E TO ISLAND RD.
CITY OF TORONTO

PLANTING PLAN

Drawn by	MB	Scale	1:250
Checked by	HN	Plot Date	2021-07-14
Approved by	HN	Project	2230

L6
Drawing No.

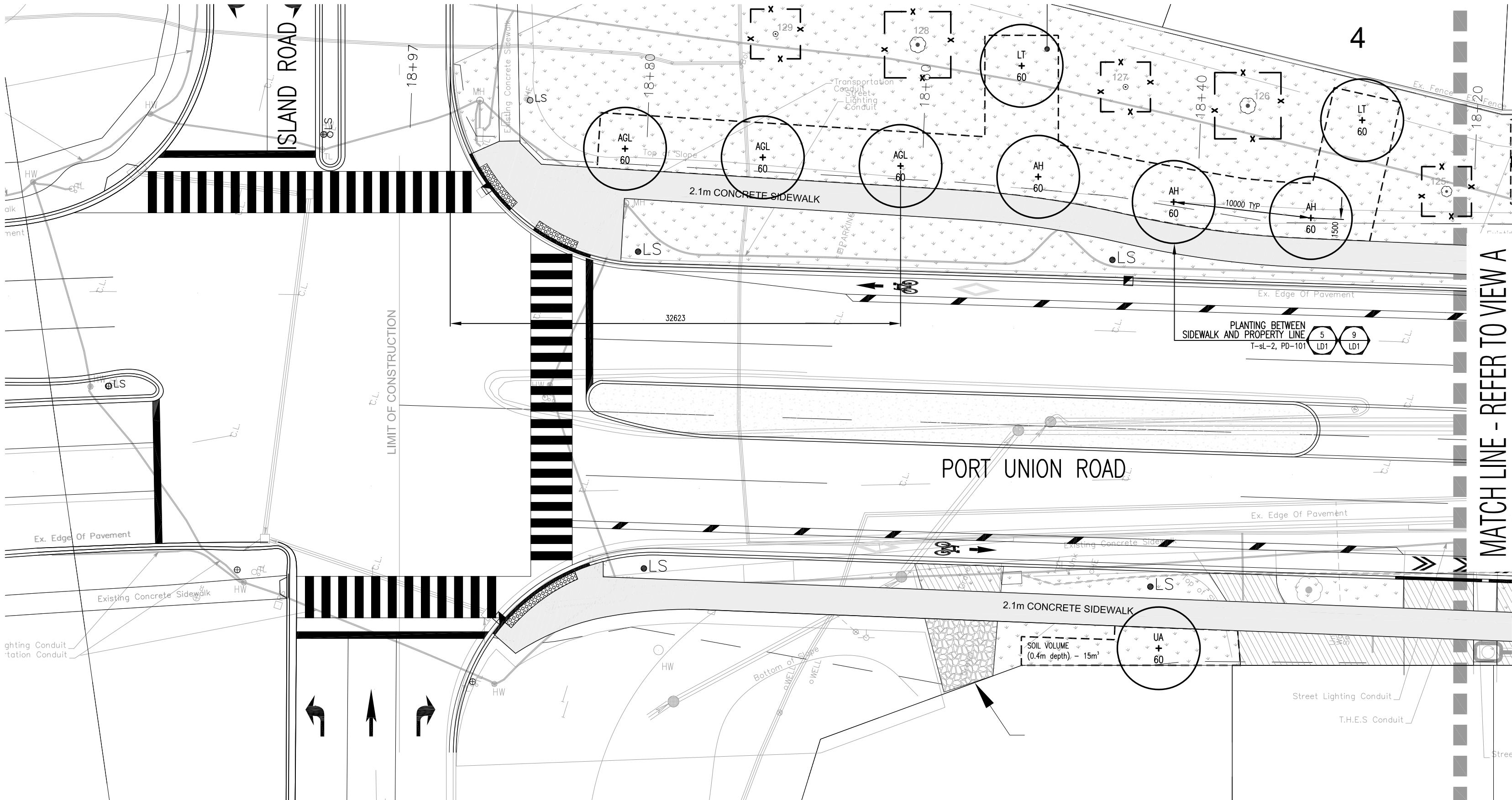

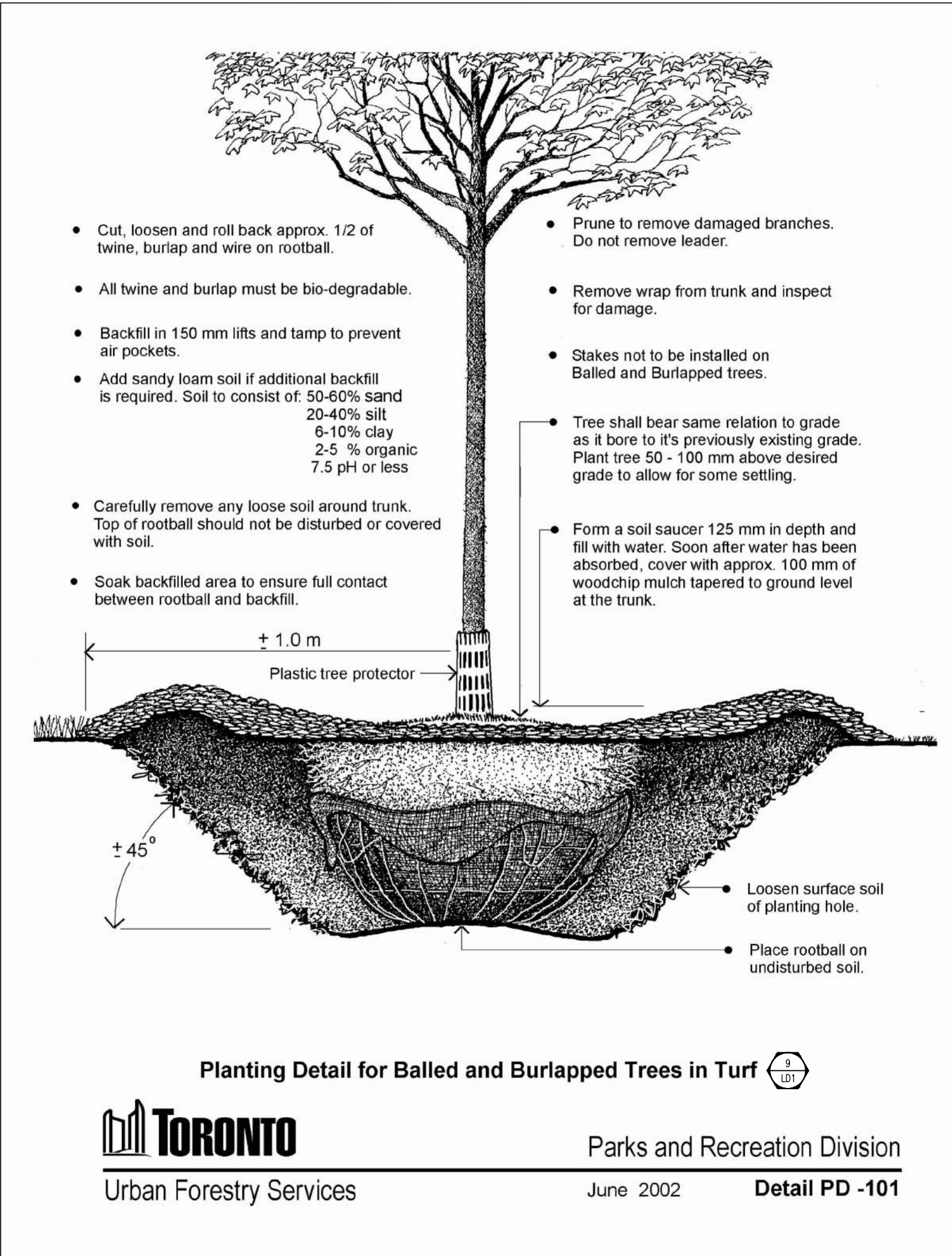
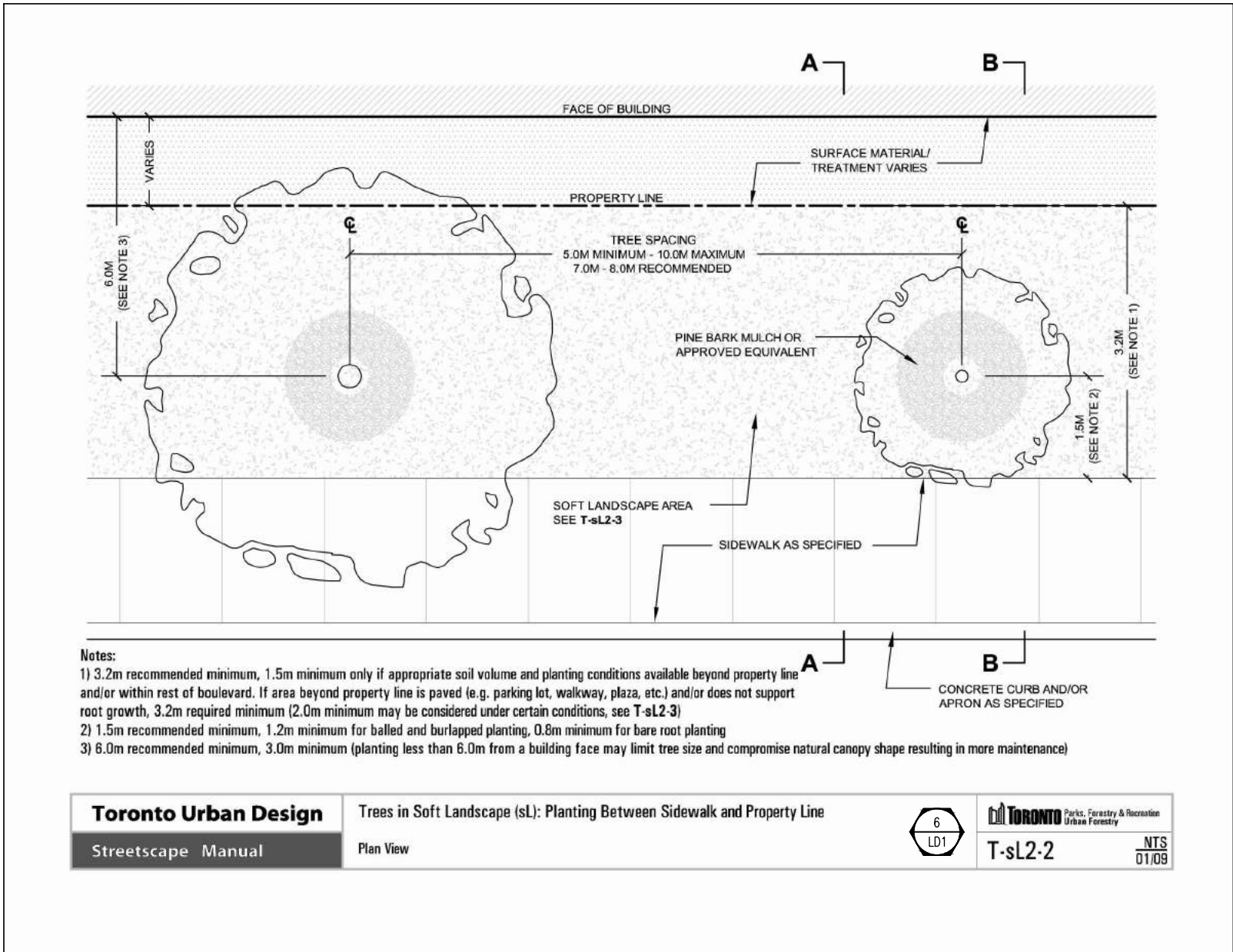
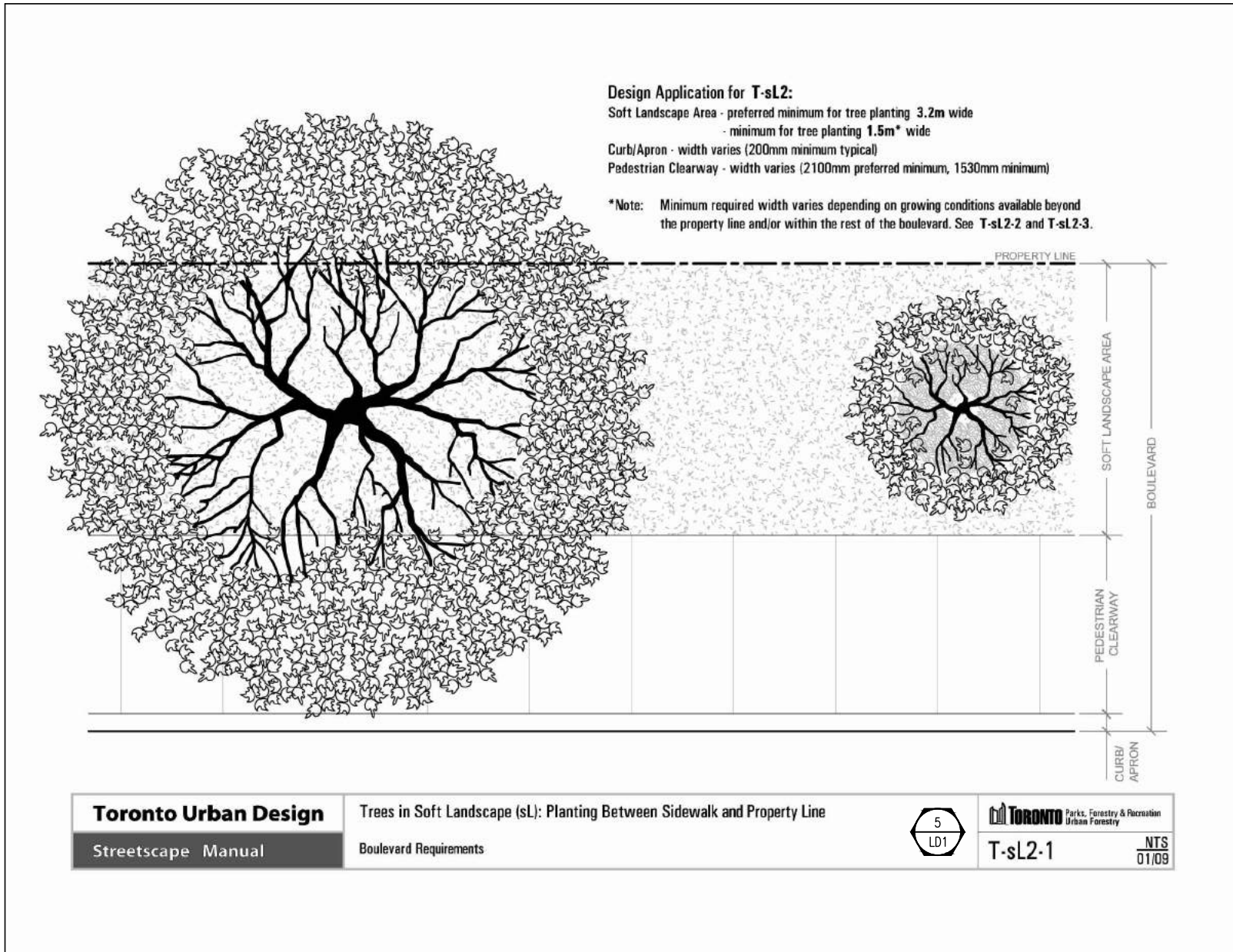
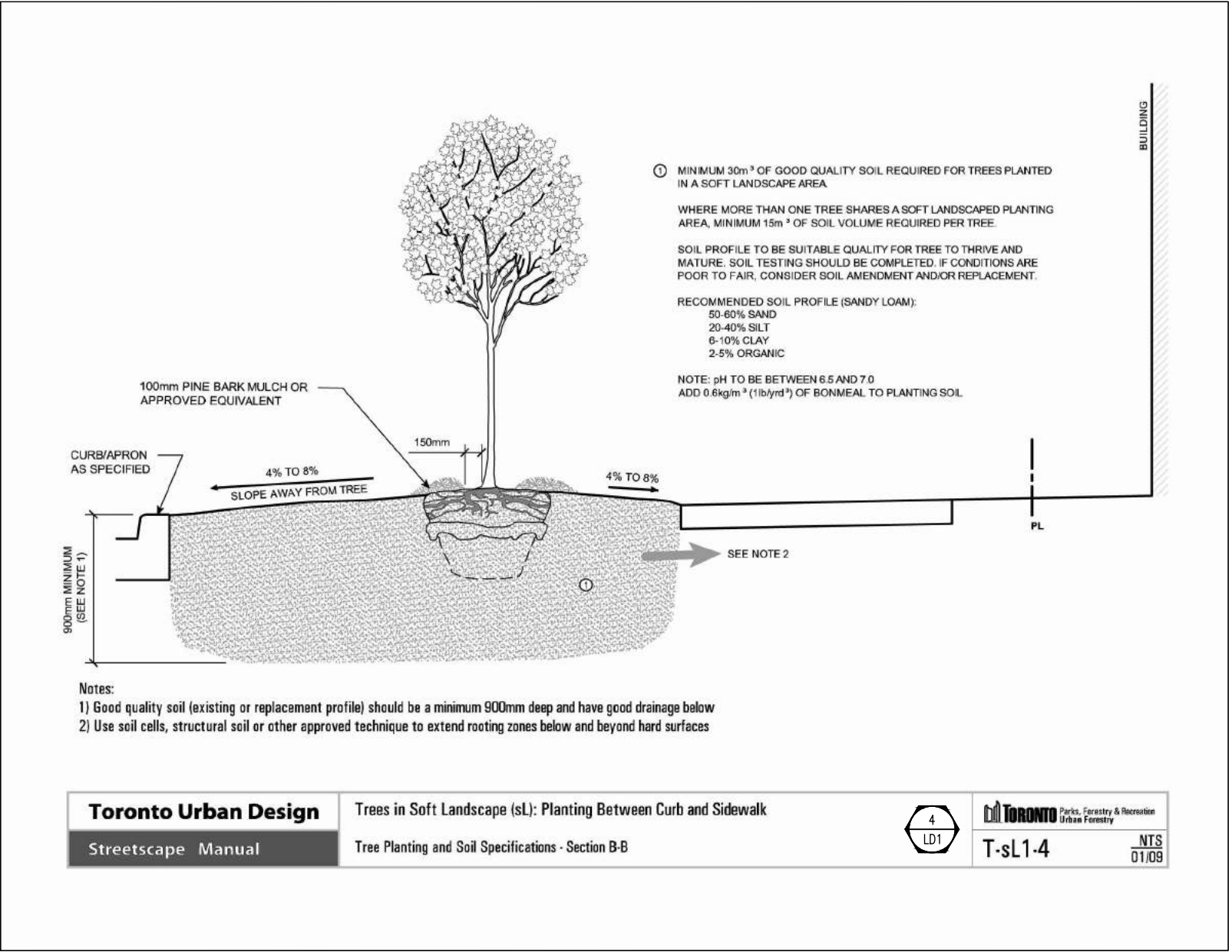
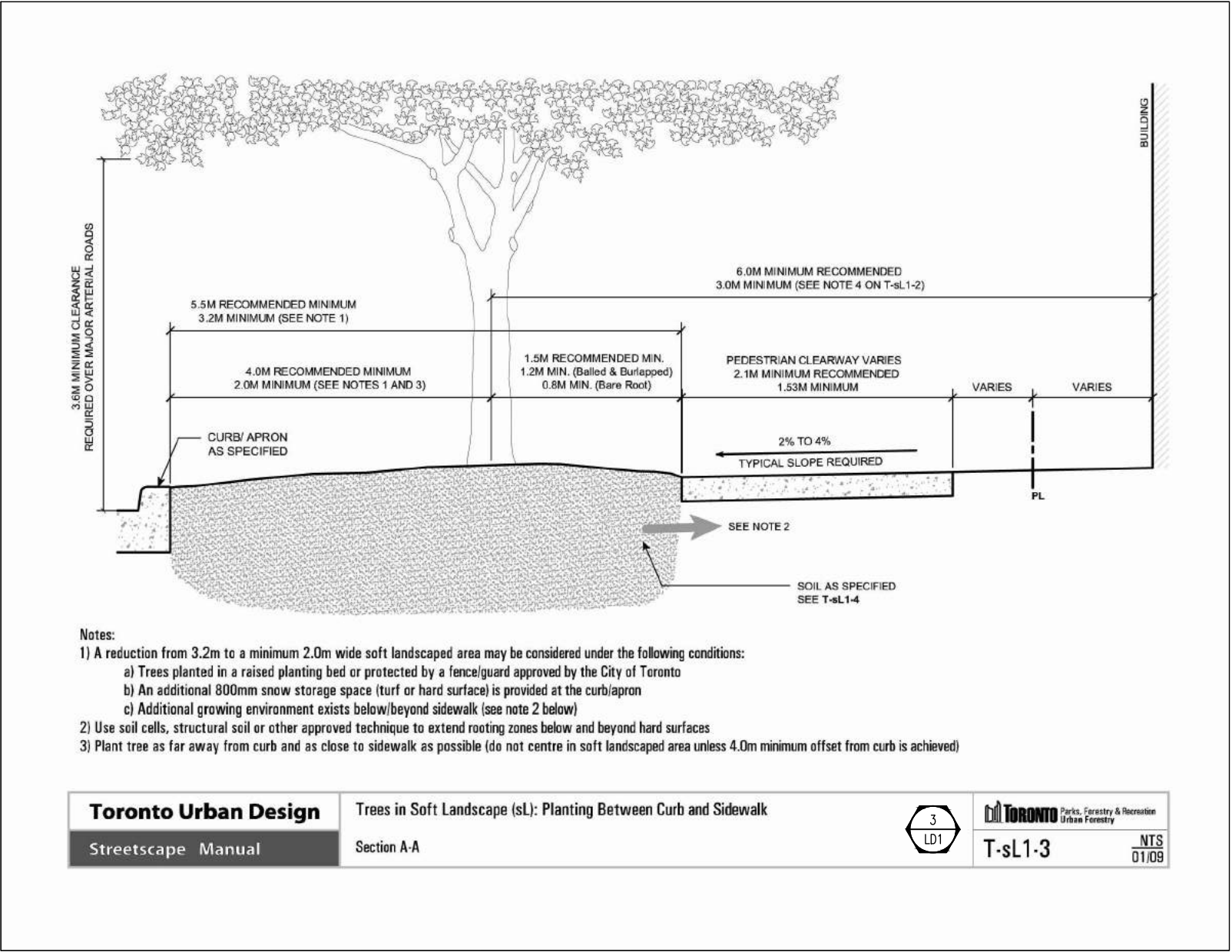
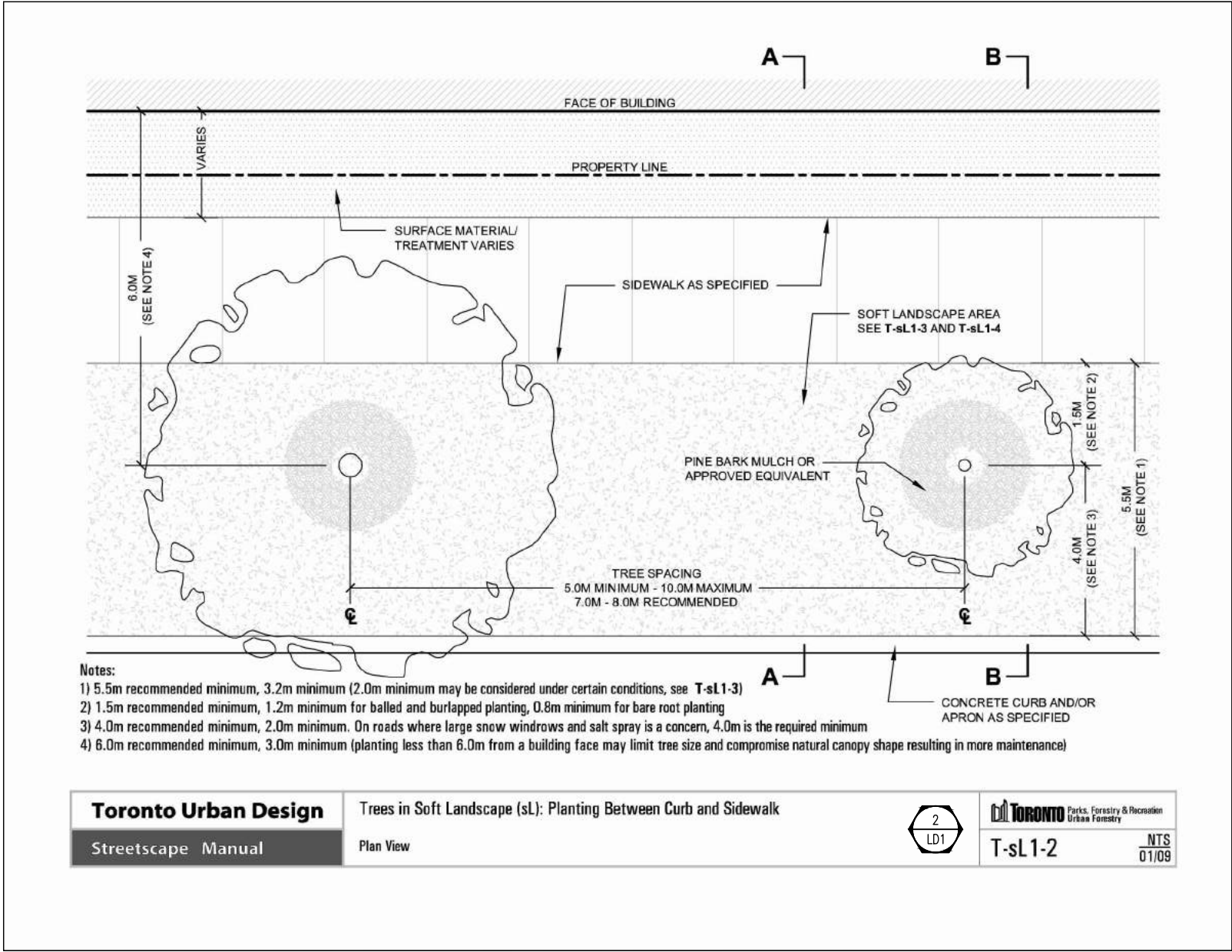
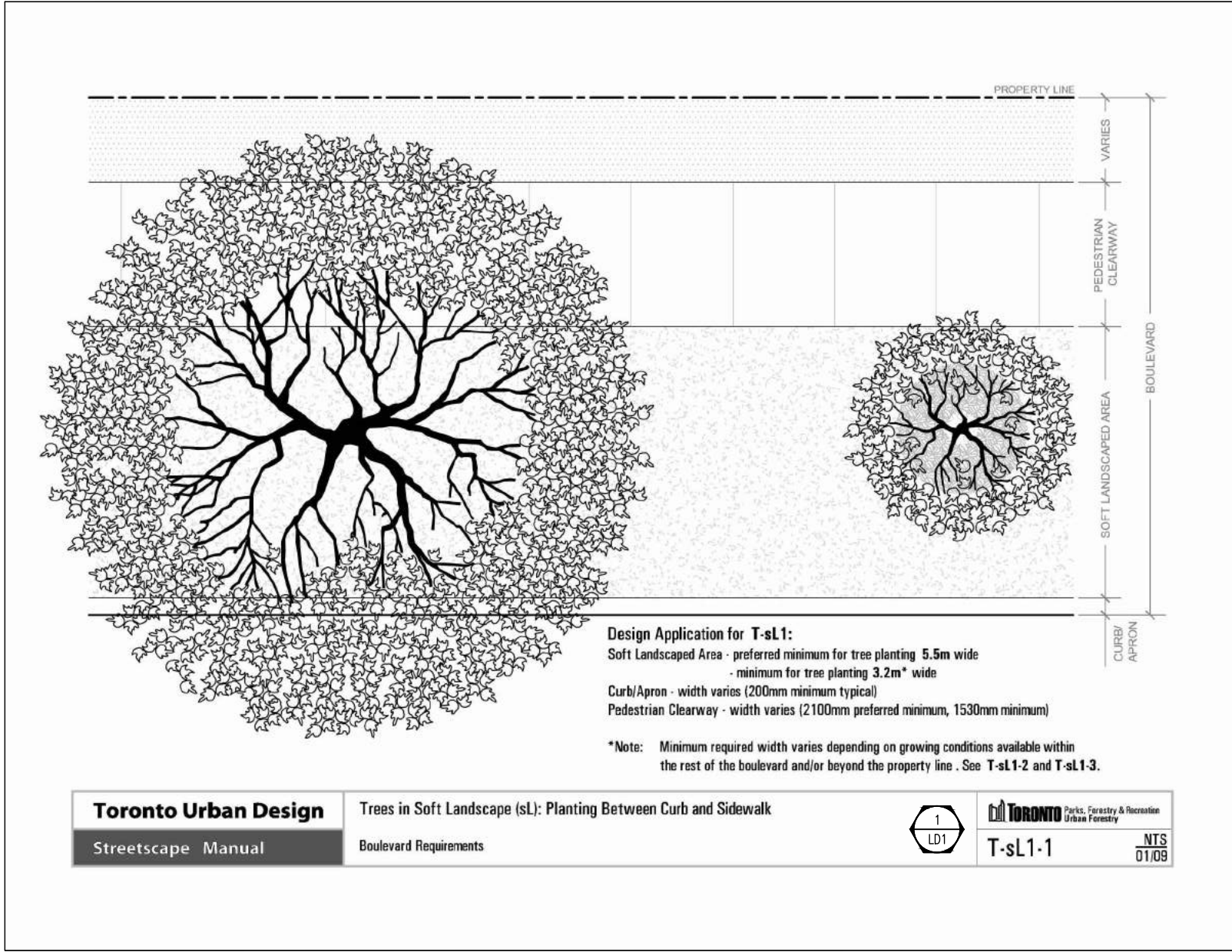

PLANT LIST

DECIDUOUS TREES

KEY	QTY.	BOTANICAL NAME	COMMON NAME	CAL. (mm)	HT. (cm)	SPREAD (cm)	ROOTS	REMARKS
AGL60	9	Aesculus glabra	Ohio Buckeye	60	-	-	WB	-
AH60	7	Aesculus hippocastanum	Horsechestnut	60	-	-	WB	-
AS60	9	Acer saccharum	Sugar Maple	60	-	-	WB	-
CO60	5	Celtis occidentalis	Hackberry	60	-	-	WB	-
CO60	7	Carya ovata	Shagbark Hickory	60	-	-	WB	-
GO60	8	Gymnocladus dioica	Kentucky Coffee Tree	60	-	-	WB	-
LT60	8	Liriodendron tulipifera	Tulip Tree	60	-	-	WB	-
QCO60	7	Quercus coccinea	Scarlet Oak	60	-	-	WB	-
QMO60	6	Quercus macrocarpa	Bur Oak	60	-	-	WB	-
QRI60	5	Quercus rubra	Red Oak	60	-	-	WB	-
UA60	9	Ulmus americana 'Valley Forge'	Valley Forge Elm	60	-	-	WB	-
80	TOTAL							

- NOTES:
- ALL TREES MUST BE PLANTED AS PER THE PLANS, APPROVED BY URBAN FORESTRY AND MUST ARRIVE ON SITE IN BALLED AND BURLAPPED CONDITION, WITH A MINIMUM CALIPER OF 60mm. EACH TREE SHALL HAVE THE BURLAP AND WIRE CAGE OPENED AND THE SOIL BRUSHED AWAY UNTIL THE FIRST PROPER ROOT IS FOUND INDICATING THE TOP OF THE REAL ROOT BALL. THE TREE IS TO THEN BE PLANTED WITH THIS LEVEL TO BE CONSIDERED THE TOP OF ROOT-BALL FOR ALL OTHER INSTRUCTIONS. ANY TREE FOUND PLANTED WITH THE FIRST PROPER ROOT MORE THAN 2.5cm BELOW PLANTING LEVEL WILL BE REJECTED AND REQUIRE REPLACEMENT OR REPLANTING AT THE CITY'S DISCRETION.
 - ANY STAKING OR TYING IS AT THE RISK OF THE CONTRACTOR AND MUST BE REMOVED WHEN THE CONTRACTOR'S WARRANTY IS COMPLETE, PRIOR TO ASSUMPTION BY THE CITY.
 - ALL TREES ARE TO BE WATERED AND MULCHED FOR TWO YEARS DURING THE REQUIRED TWO YEAR WARRANTY. ANY TREES IN A LOWER CONDITION RATING THAN "GOOD" WILL BE REJECTED AT OR BEFORE THE END OF THE WARRANTY PERIOD AND REQUIRE REPLACEMENT.

6	Revised per Updated Road Alignment	MB	21 07 14
5	Revised per TRCA Comments	MB	21 06 30
4	Revised per City Comments	MB	21 05 20
3	90% Submission (Number 2)	MB	21 03 12
2	Revised 90% Submission	MB	18 04 24

No Revision By Yr Mo Da

All drawings and designs are the property of Cosburn Nauboris Limited and may not be used or reproduced without permission. This drawing must not be scaled.

Invalid Unless Signed Original

ASSOCIATION OF LANDSCAPE ARCHITECTS
ALA
MEMBER

cosburn nauboris LTD
landscape architects
cosburnnauboris.ca

20 crown steel dr. suite 2
markham, on l5r 9g9
1 905 940 4443

PORT UNION ROAD RECONSTRUCTION
LAWRENCE AVE. E TO ISLAND RD.
CITY OF TORONTO

DETAILS		
Drawn by	MB	Scale AS SHOWN
Checked by	HN	Plot Date 2021-07-14
Approved by	HN	Project 2230
		LD1 Drawing No.