

St. James Town West Park Redesign

Community Workshop

July 27, 2021

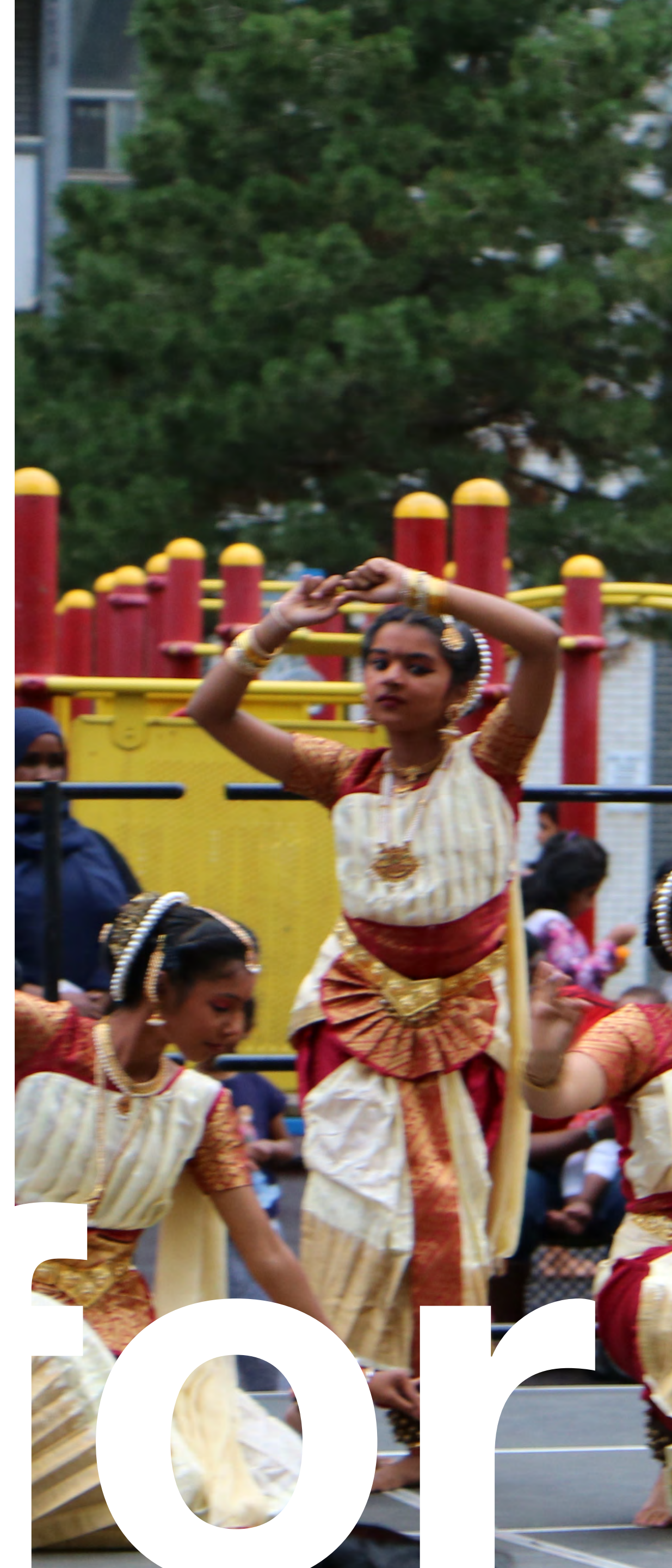

Park for All

Welcome

I'd like to begin by honouring the land that I'm on. We acknowledge the land we are meeting on is the traditional territory of many nations including the Mississaugas of the Credit, the Anishnabeg, the Chippewa, the Haudenosaunee and the Wendat peoples and is now home to many diverse First Nations, Inuit and Métis peoples. We also acknowledge that Toronto is covered by Treaty 13 with the Mississaugas of the Credit.

Zoom Controls and Troubleshooting



You can mute and unmute your microphone by clicking this button. You will be muted by the host during the presentation.

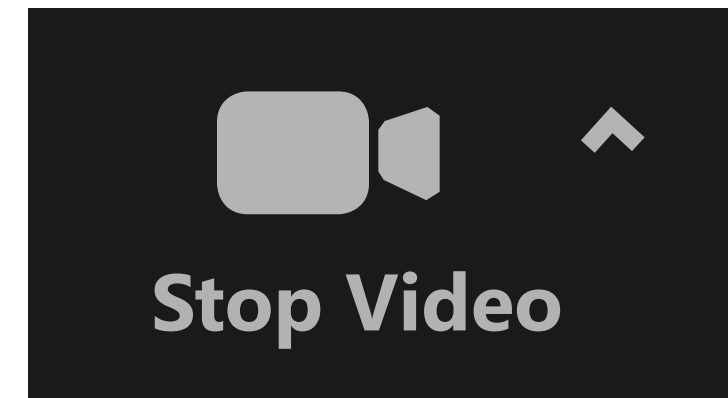

You can turn your video on or off by clicking this button.

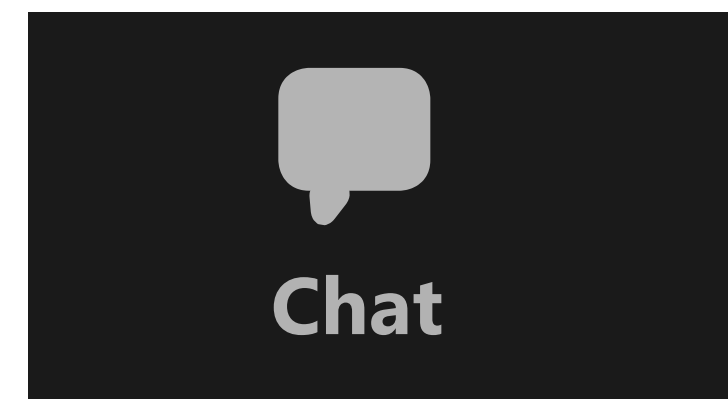

Using this button, you can chat. Please select 'Everyone' or if you have a specific issue, please select 'Host'.

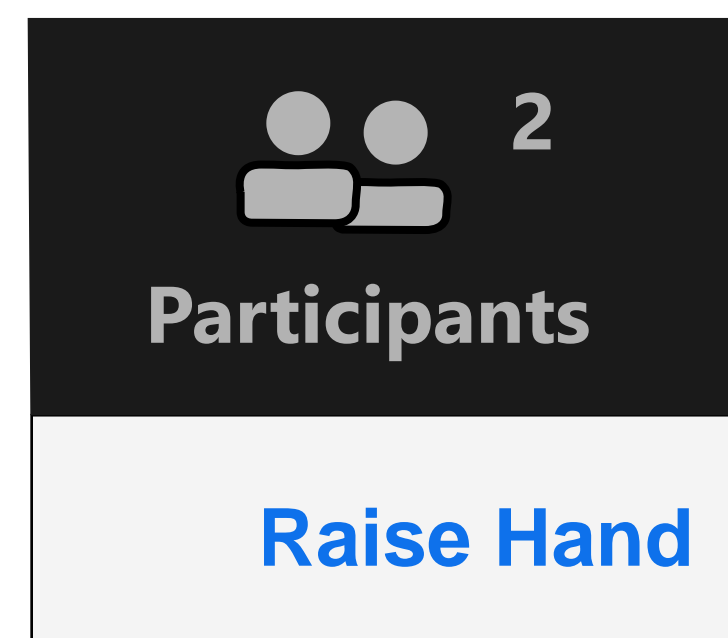

Use this button to raise your hand.
Open participants list, select 'raise hand'.
Remember to lower your hand once finished.

Meeting Purpose

Present and gather feedback on the Preferred design option for the redesign of St. James Town West Park.



Agenda

- 1. Team introductions**
- 2. Project Background and Context**
- 3. Preferred Design Option**
- 4. Small Group Discussions, Questions and Feedback**
- 5. Next Steps**

Team

City of Toronto

Laurel Christie – Senior Project Coordinator

Rajesh Sankat – Senior Public Consultation Coordinator

DTAH Design Team

Landscape Architects
James Roche
Elnaz Sanati

Artist

Rebecca Baird

Nbisiing Consulting Indigenous Engagement

Bob Goulais

LURA Public Engagement

Liz McHardy
Alexander Furneaux
Stella Zhou

Design and Consultation Process Flow Chart

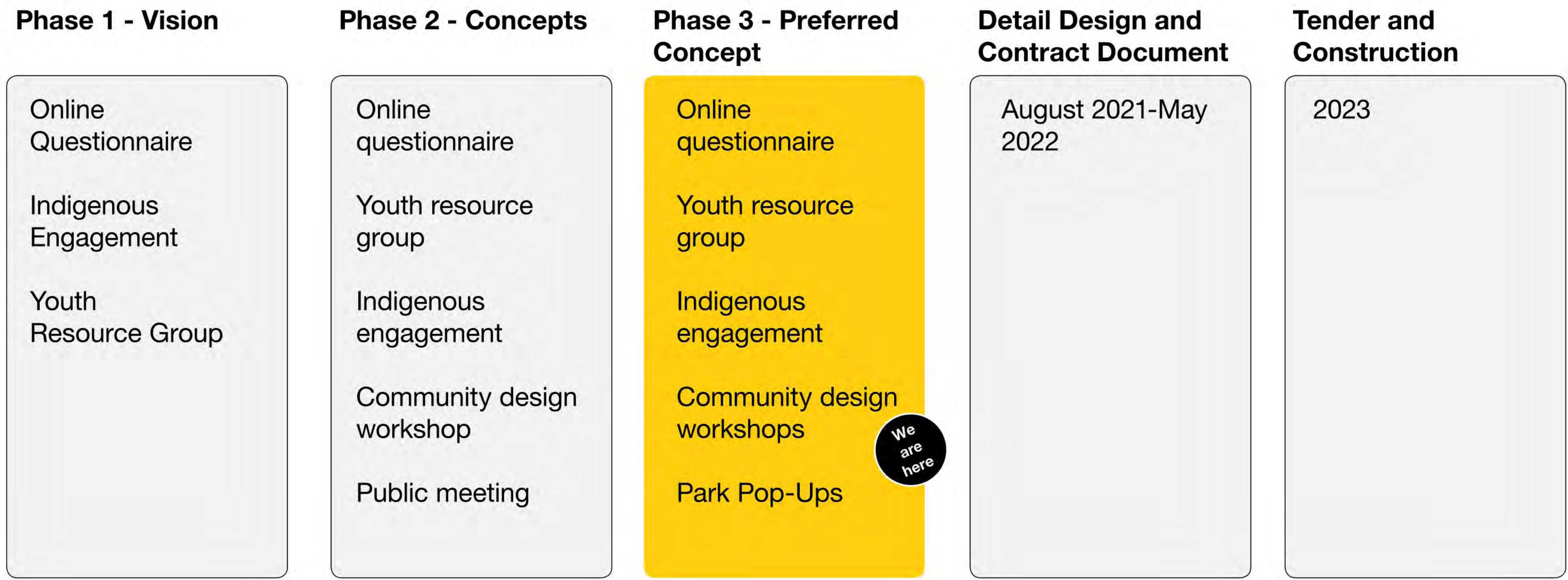

Background and Context

Context



Engagement Tactics



Engagement Tactics

	Project Webpage	Virtual Community Meeting	54
11835	Mailouts	Community Design Workshop	19
22+1	Posters	Youth Engagement	9+ 55
350	Community Ambassadors	Indigenous Sharing Meeting	11
30,000	Social Media	Online Survey & Email	220

Engagement Summary

Key Messages

- Creating a **balance of paved and green spaces** that meet community needs for a natural reprieve from the city and opportunities for community gathering.
- **Increasing the amount of trees and other vegetation.**
- Providing a variety of **seating opportunities.**
- Improving the **lighting** throughout the park.
- Design elements and opportunities that add **colour** to the park through park furniture and/or plantings.
- **Incorporating and integrating Indigenous place-keeping seamlessly into the overall design** of the park rather than calling-out specific areas or items that are disconnected from the rest of the park or feel as if they stand alone.

Participants also identified opportunities to improve some elements of the Concept Design Options, such as:

- Reassessing the configuration of the paths, and **prioritizing the most travelled pathways** for paving to help achieve a balance of hard surfaces and green spaces.
- Considering more **conventional play structures** (swings, climbing bars, etc...)

Engagement Summary

Park Element	Agreement with elements as shown in Option 1	Agreement with elements as shown in Option 2
The pathways would allow me to move easily to the places I want to travel to.	71%	82%
There is a sufficient amount of trees and plants included in this design.	68%	68%
Central open lawn [Option 1]/plaza [Option 2] provides a space to sit and enjoy the park.	66%	72%
I would visit this park to relax and enjoy nature.	63%	62%
There is a balance between paved surfaces and green space.	60%	63%
The amount of open space/lawn meets my/my household's needs.	59%	59%
There are sufficient seating options and places to sit.	59%	73%
The lighting options would make me feel safe.	57%	71%
There are sufficient opportunities to organize cultural or community events.	50%	74%
There are sufficient opportunities for play that meet my/my household's needs.	48%	59%

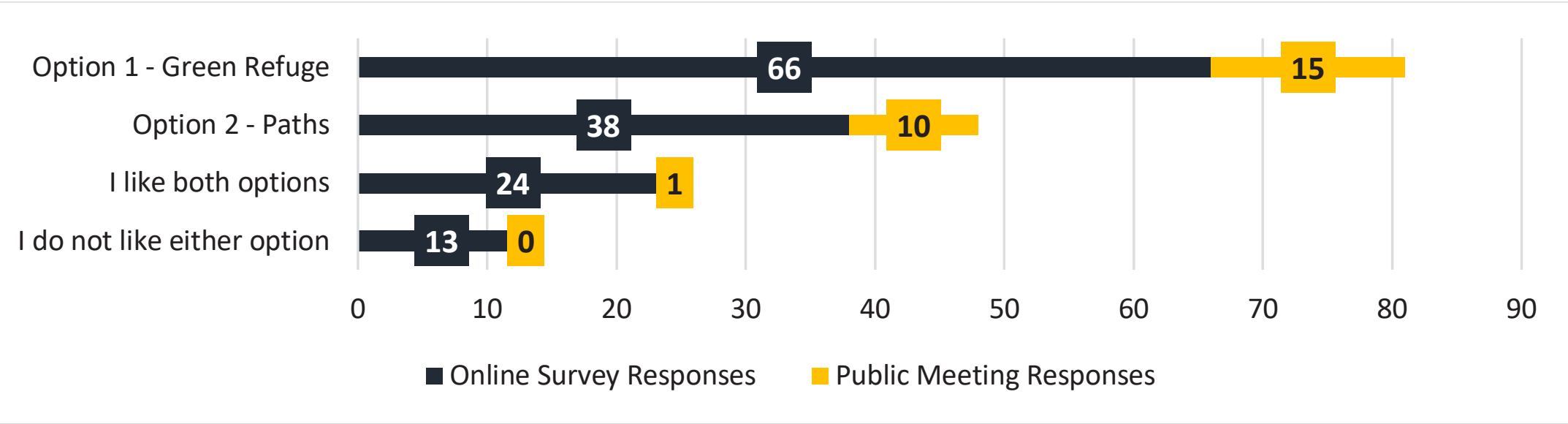

Preferred Concept Design

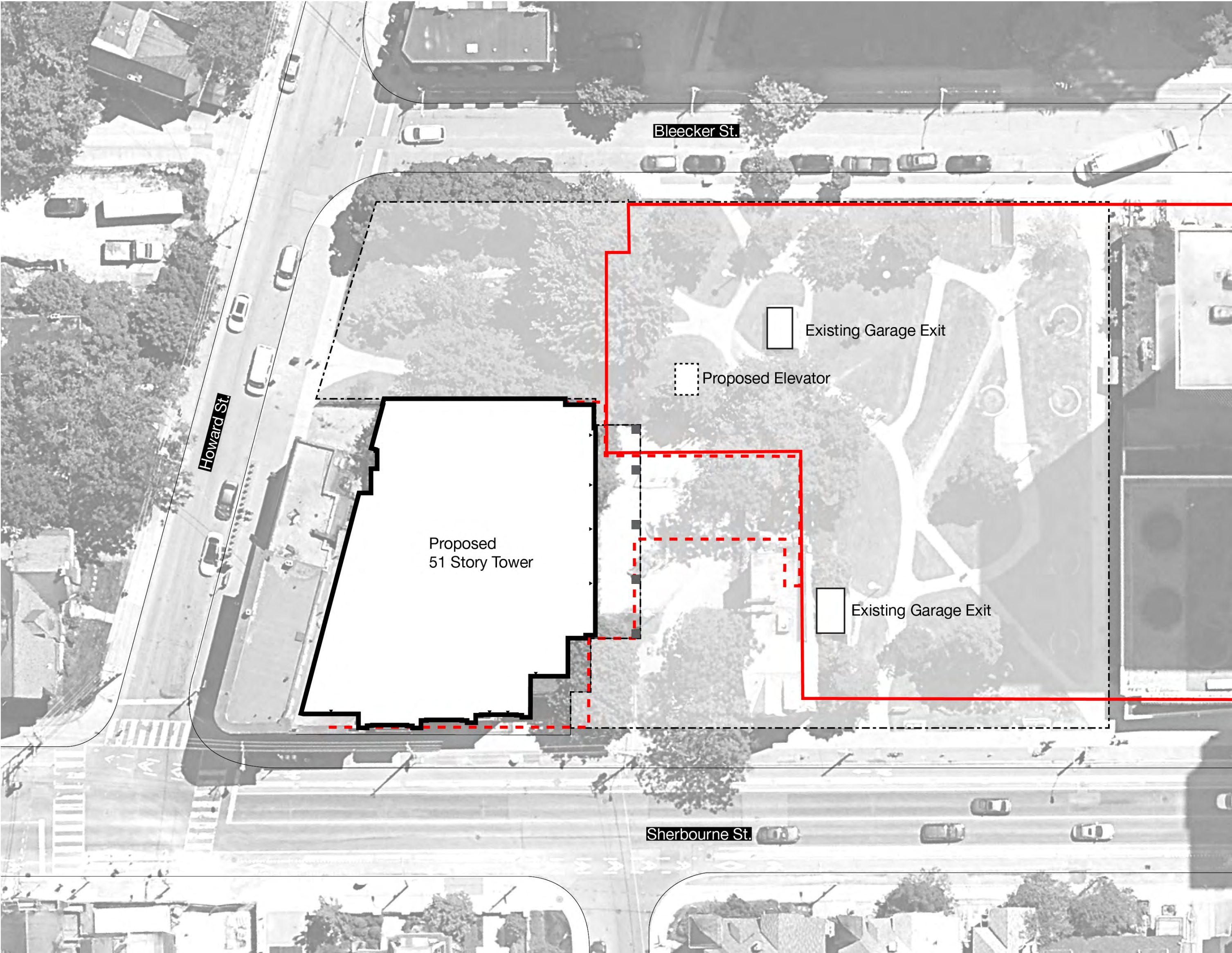

Preferred Design Option

- ① Existing Tree Canopy
- ② New Planting
- ③ Open Lawn
- ④ Raised Planter
- ⑤ Landform
- ⑥ Medicine Garden
- ⑦ Urban Plaza
- ⑧ Neighborhood Plaza
- ⑨ Playground
- ⑩ Skateboard Plaza
- ⑪ Wood Platform
- ⑫ Bench-Linear Seat
- ⑬ Projection Light
- ⑭ White Hawk Sculpture
- ⑮ Red Hawk Sculpture
- ⑯ Tile Art
- ⑰ Pavement Art
- ⑱ Artwork on Benches
- ⑲ Garage Exit Stairs
- ⑳ Drinking Fountain for People+Dogs



Indigenous Art

Entrance at Shebourne Street

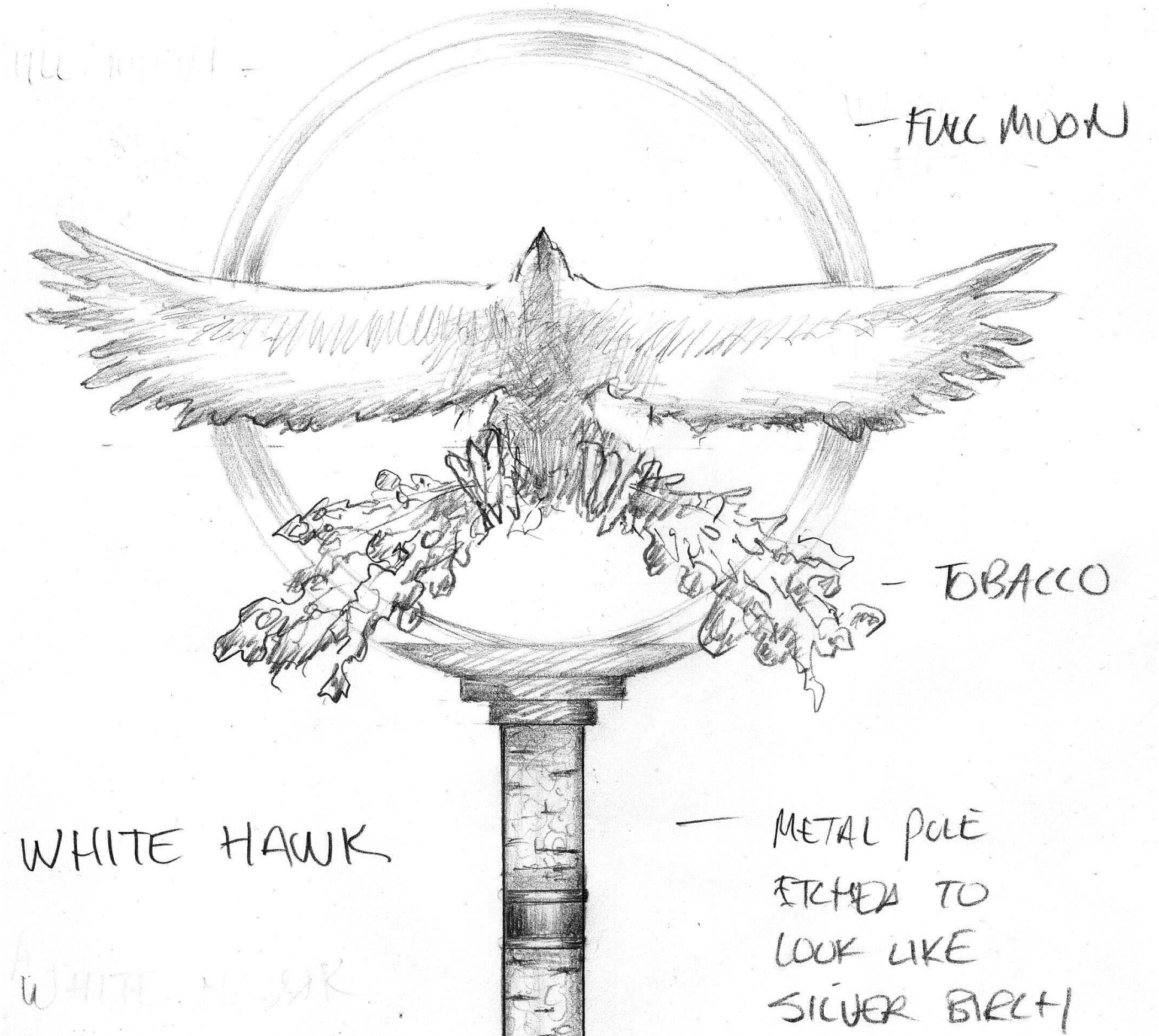

Indigenous Art

Entrance at Bleecker St.

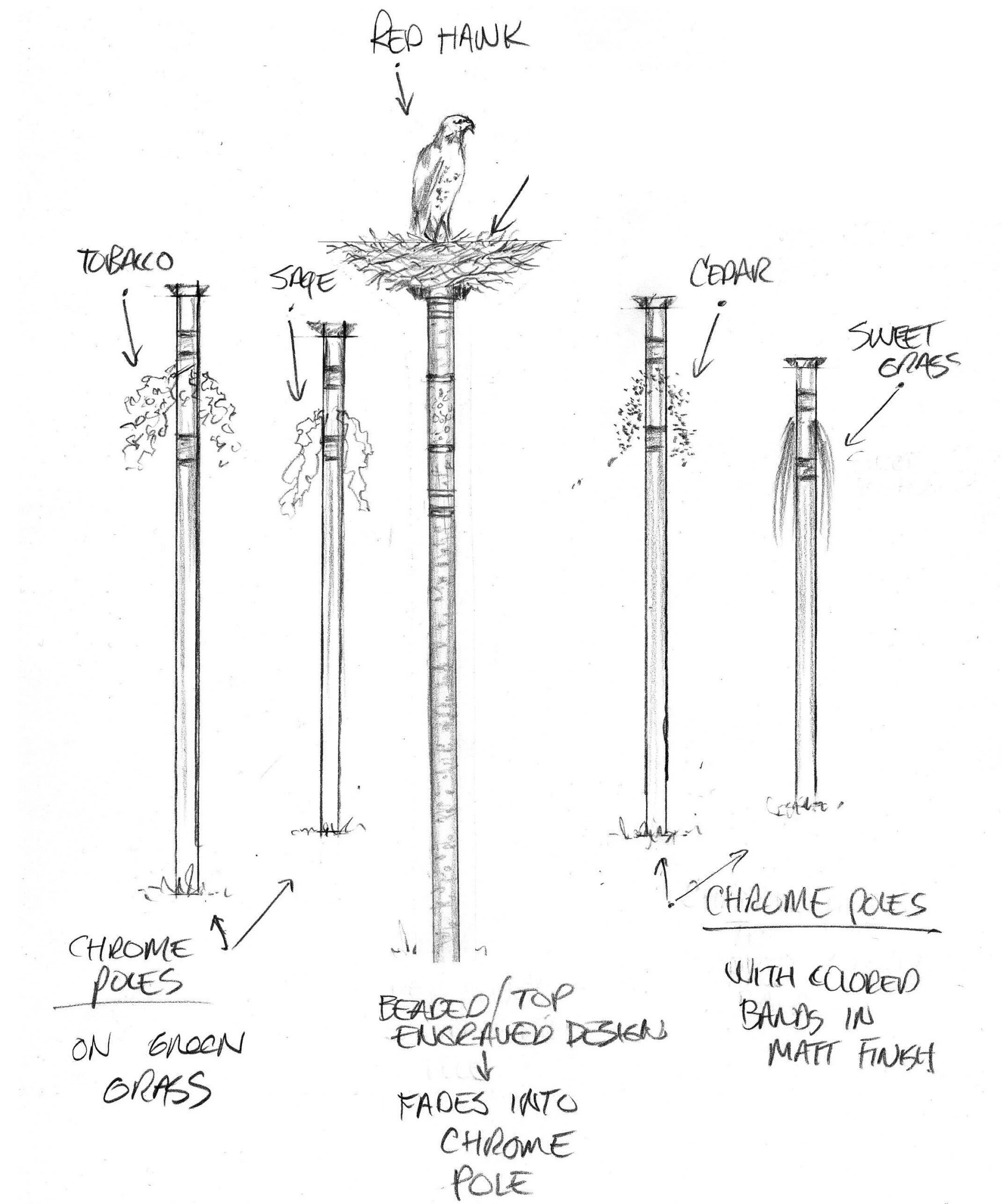

Indigenous Art

Entrance at Bleecker St.

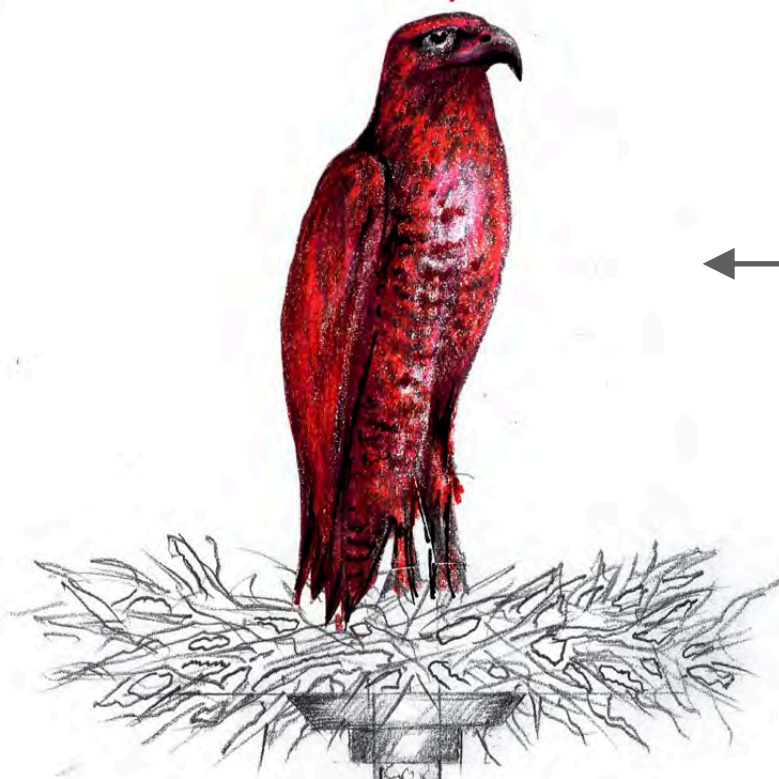

Red Hawk

Nest (Copper)

Silver Pole with Engraved Design



Indigenous Art

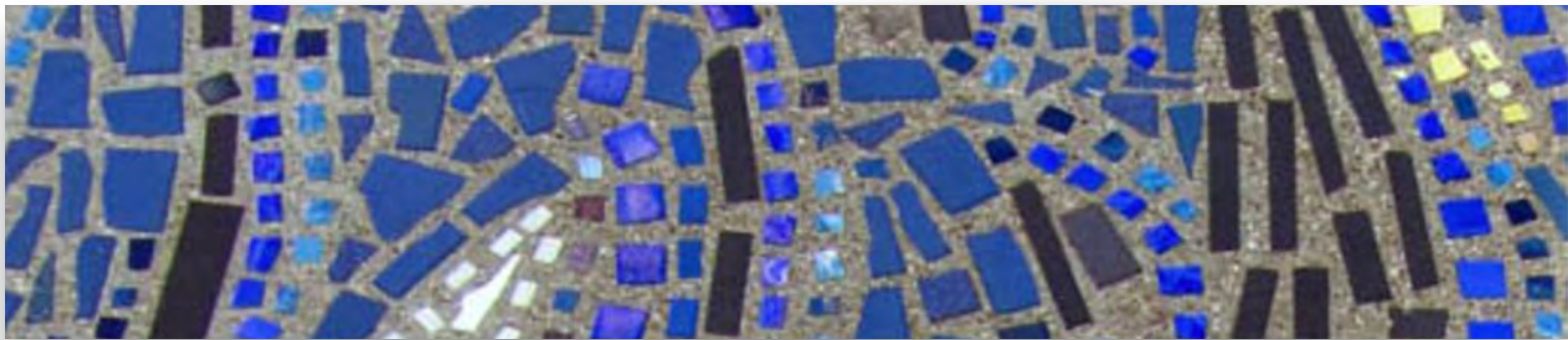
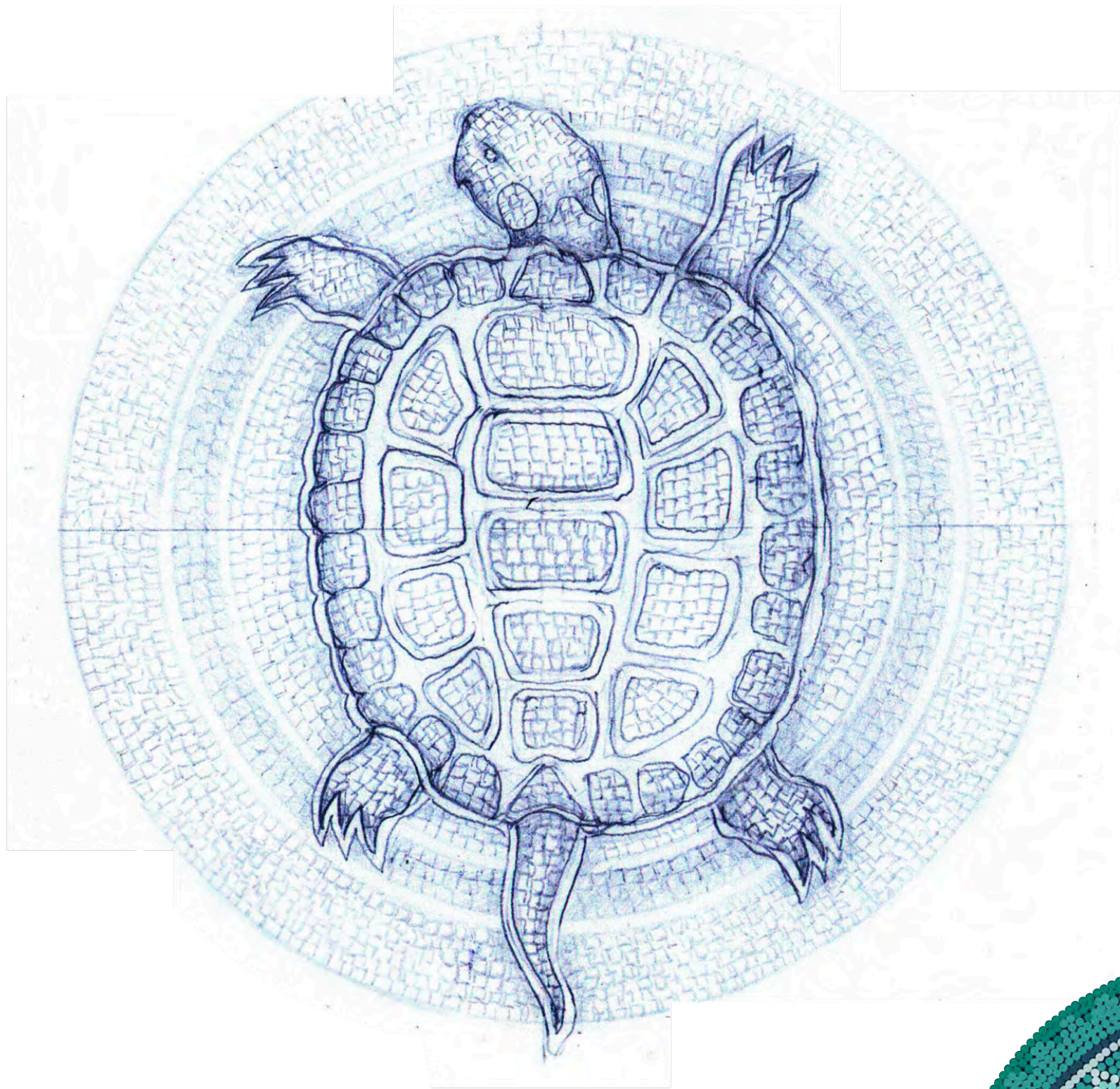

Indigenous Art

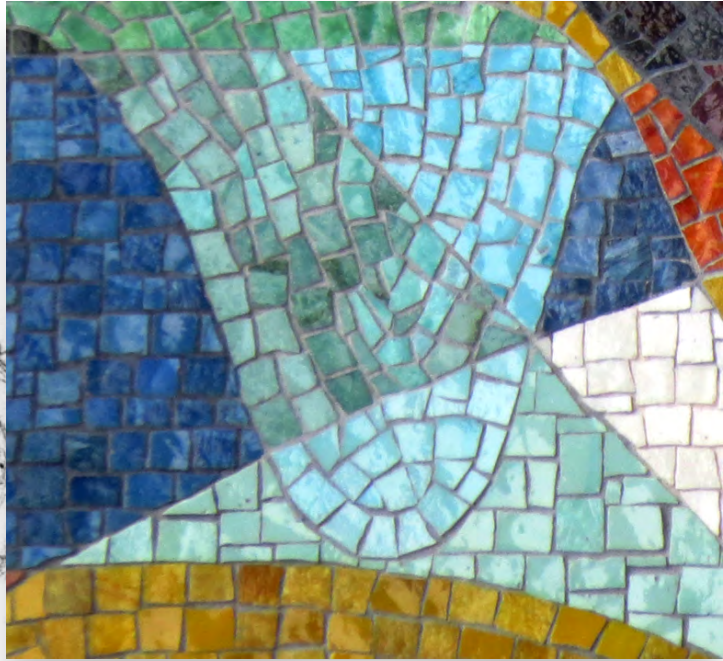

Colour Reference
For Pathway



Colour Cement: the actual
process to be used for
the pathway

Indigenous Art

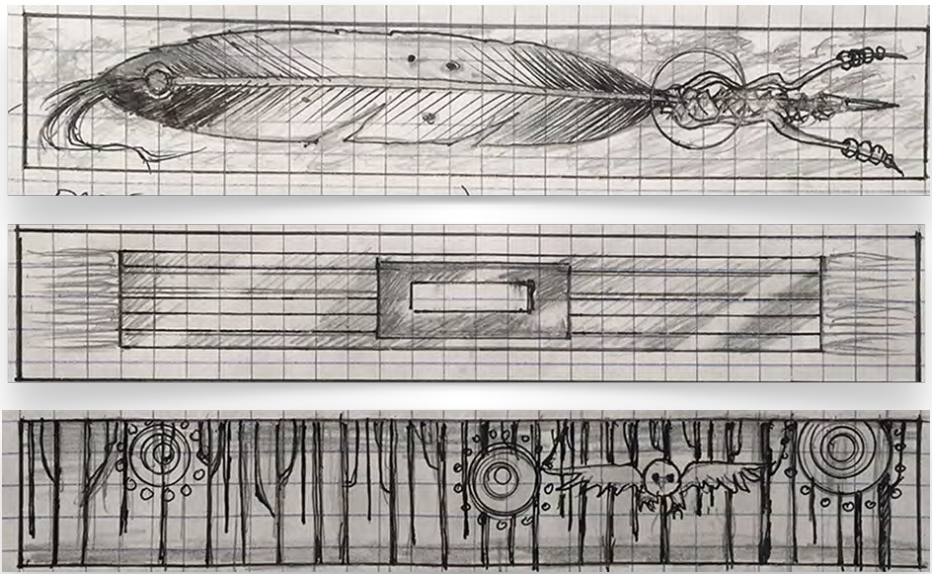
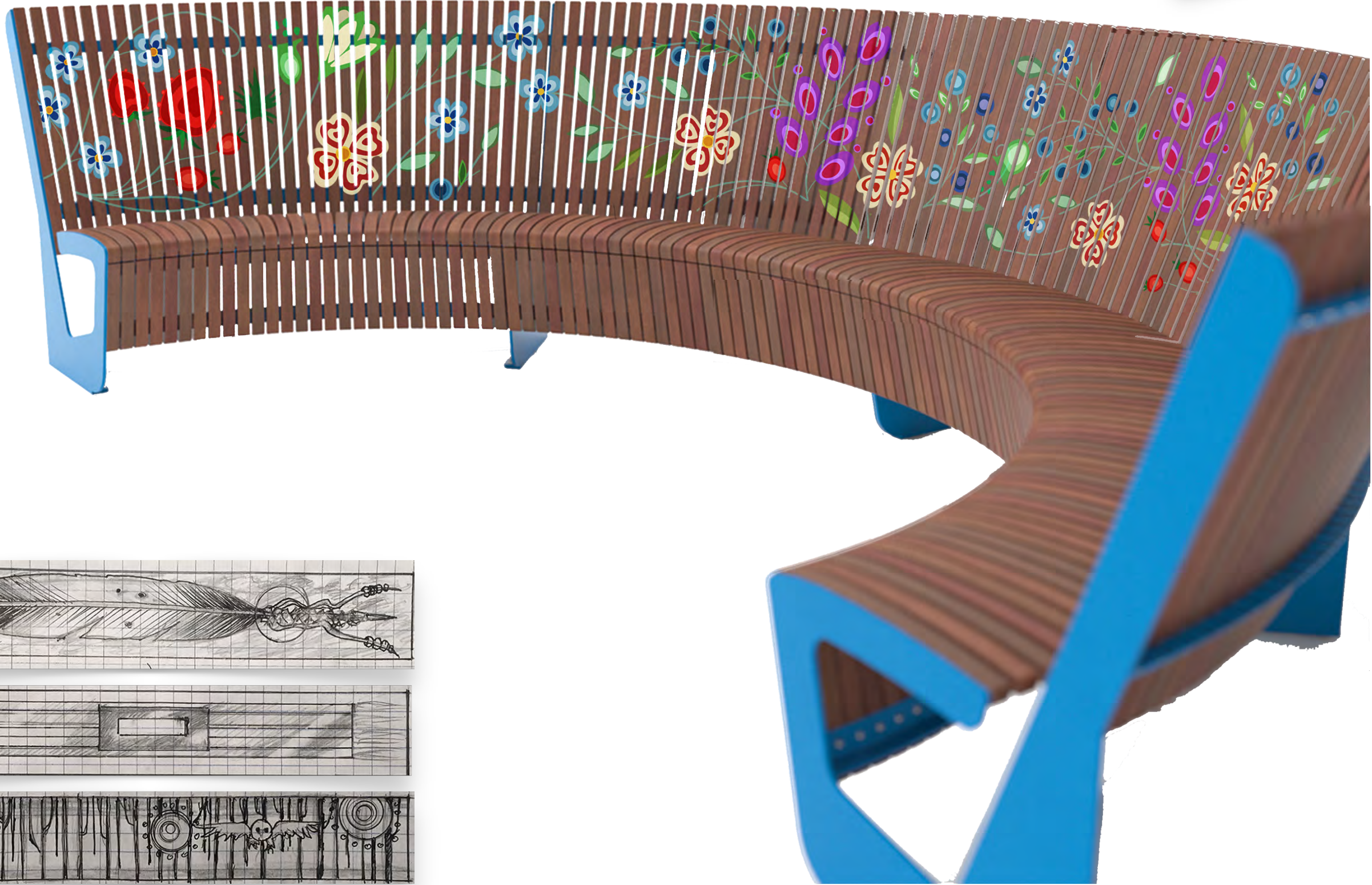







Planting

Planting

Canopy Trees

- American Elm Cultivars
- Common Hackberry
- Autumn Blaze Maple
- American Beech
- Red Oak
- Honey Locust
- Autumn Brilliance Serviceberry

- Native to Ontario
- Urban tolerant
- Graceful mature form
- Seasonal interest



Planting

Understories and Medicinal Plants



Planting

Landforms | Open Lawn



Play

Play

- Natural play equipment invites children to interact with natural materials and structures
- Suitable for junior and senior play
- Multi Purpose structures
- Inclusive



Play

Swing

- Natural joy!
- Balance and Coordination
- Spatial Awareness



Play

Spinner Plate

- Hand-eye coordination
- Motor skills
- Understanding of cause and effect



Play

Obstacle Course

- Climbing
- Rhythm and movements



Play

Theater and Music House

- Creative Play
- Logical Thinking
- Cross Body Coordination



Play

Play Surface

- Rubber Surfacing provides the highest degree of accessibility
- Easy to clean and maintain
- Ideal for themed graphics to add play value and color



Paving

Paving

Concrete Unit Pavers

- Contemporary look
- Modular component paving system
- 100mm thickness for increased interlocking effect.
- High resistance to freeze-thaw cycles



Site Furniture

Seating

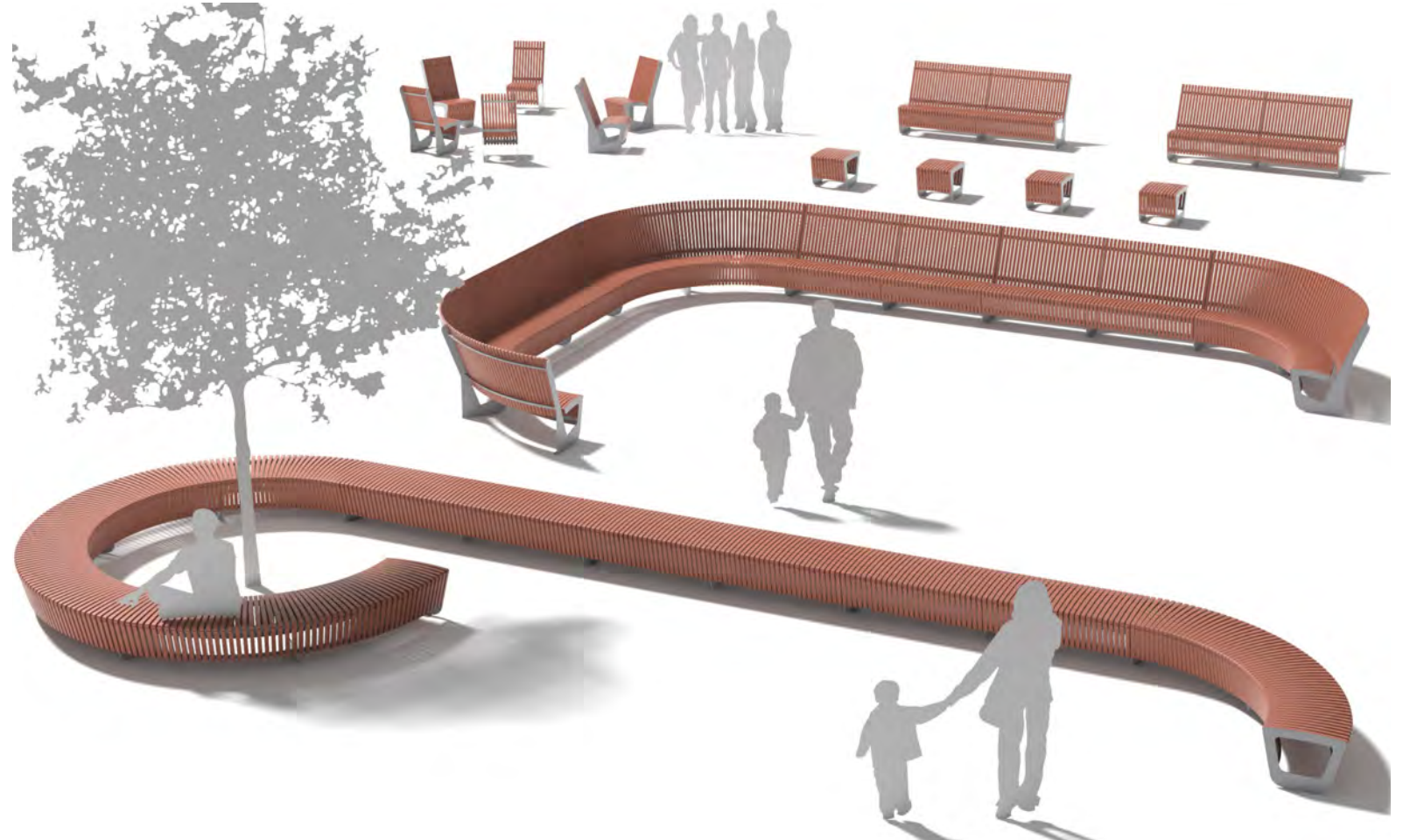
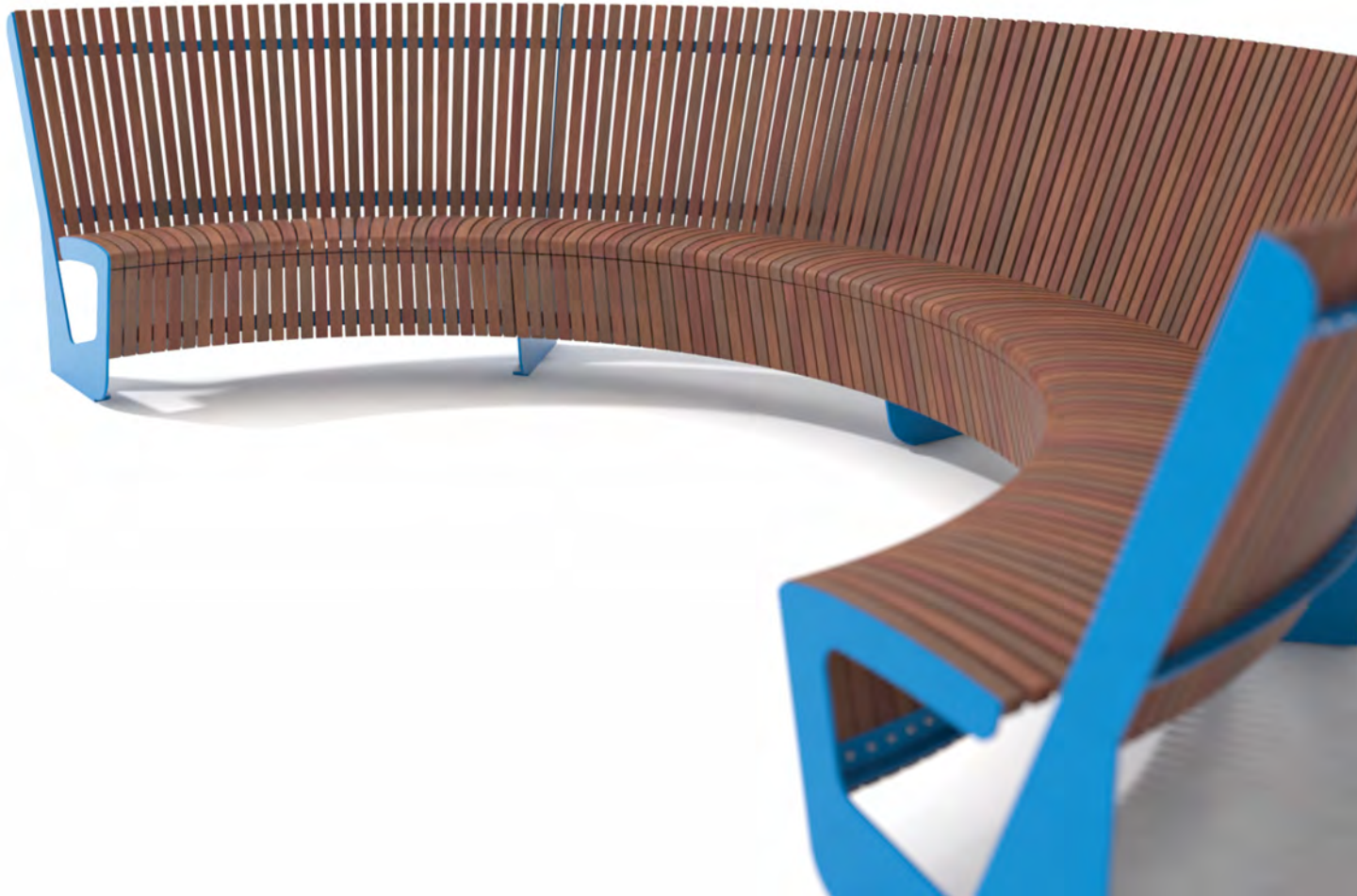

* Back/Armrest will be added on benches.

* Seats to be fastened on paving

* Tables/Chairs to be fastened on paving

Skateboard

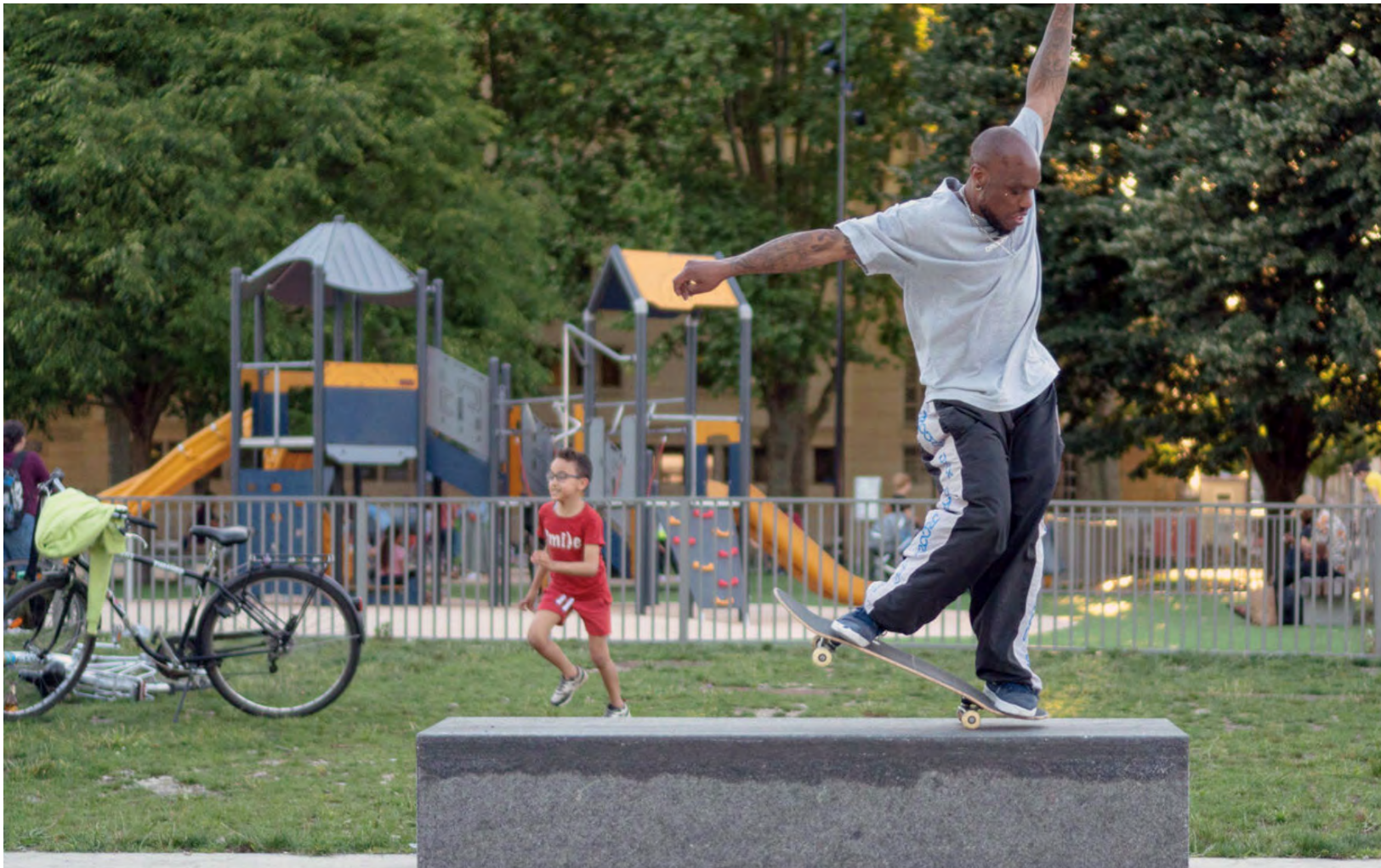

Lighting



Small Group Discussions

In a moment you will be prompted to join a breakout room to discuss the designs in detail with a facilitator. When prompted, please accept the invitation to join the breakout room.

When providing your feedback, consider:

- Does the preferred concept design accurately represent your vision for the future of St. James Town West Park?
Why or why not?
- What elements of the concept do you like?
- What elements of the concept could be refined or improved?

Next Steps

Visit www.toronto.ca/stjamestown

- Share your feedback through the online questionnaire until August 13, 2021
- Sign up for e-updates
- Access the presentation and meeting summary when available
- Pop-ups in the Park: Saturday July 31st (afternoon) and Wednesday August 4th (evening)

Email any additional comments to laurel.christie@toronto.ca by August 13, 2021

Thank you.

Questions and Discussion