



JURY REPORT



FOREWORD

Toronto is home to more than 2.8 million people from all walks of life. Our city added close to 25,000 new residents in 2020 (down from 45,500 in 2019) and during the same time, saw a 7.6 per cent decrease in employment, or almost 120,000 jobs, (down from a 3.1 per cent increase or almost 46,920 new jobs added in 2019) resulting primarily from the COVID-19 pandemic.

Urban design is critical to ensuring that this pace of growth and change results in long-term livability for everyone. Now more than ever before, we can use change to support the city's recovery and rebuild efforts, to make sure we have dynamic, comfortable and beautiful spaces for residents, workers and all others who experience the city.

When done well, urban design supports complete and successful communities – it aligns with goals around housing and mobility, poverty reduction and social equity, and ultimately positions us for an accessible, affordable and high quality of life for people in our city, now and in the future.

The City of Toronto continues its long-standing commitment to promoting and celebrating design excellence and hosts the Toronto Urban Design Awards every two years to recognize the significant contributions that architects, landscape architects, urban designers, artists, city builders and design students make to the appearance and livability of our city.

Since the 2019 awards presentation, Toronto has seen many new ideas. These include expanding housing options with the City's Housing Now program activating City-owned sites for the development of affordable housing within mixed-income, mixed-use, transit-oriented communities, its modular housing initiative, small site and large site redevelopment, transit-oriented communities, as well as major improvements to the public realm - all to meet the needs of our growing city. We continue to build and plan new options for moving throughout the city – pedestrian connectivity, cycling networks and transit enhancements, and new ideas for green spaces. There has also been the emergence of temporary patios to support the restaurant industry during the pandemic, and their impact on public life. These

are all indicators that support Toronto as one of the most liveable world cities. To maintain this enviable position, Toronto needs great urban design and our design community is creatively and passionately contributing to this mission.

This year, the City received an impressive 170 submissions in nine categories. When the jury met in May and June of this year, the members not only reviewed and deliberated on all aspects of the many submissions, but also visited the extensive short-list of projects. This ambitious task resulted in the selection of 11 projects to receive an Award of Excellence, 13 projects to receive an Award of Merit and two Special Jury Awards for Inspiring Infrastructure.

The Toronto Urban Design Awards is a collaborative city building initiative between the development and design community and the City of Toronto that is made possible through the generous support of sponsors and the efforts of a small team of City staff that works diligently to deliver the program. The team prepares promotional materials, reaches out to potential sponsors, compiles all the submissions, facilitates the jury process, prepares the Jury Report and organizes the awards presentation.

We would like to thank all of those involved – the teams of practitioners who delivered this year's excellent submissions, the jury of esteemed professionals who gave an extraordinary amount of their time and expertise, dedicated City staff, our generous sponsors, and Mayor Tory and City Council's continuous and long-standing support of design excellence. Your hard work and commitment to the promotion and celebration of exceptional urban design in Toronto is second to none.

Gregg Lintern

Chief Planner & Executive Director

Emilia Floro

Director Urban Design

City Planning
September 2021

City Planning

Emilia Floro

Director Urban Design

Kristina Reinders

Program Manager, Urban Design Programs and Strategies

Maaja Eichfuss-Clarke

Carl Novikoff

Juliana Azem

Peggy Lee

Sukey Yuen

Protocol Services

Jing Deng

Strategic Communications

Bruce Hawkins

Diane Morrison

TABLE OF CONTENTS

AWARD CATEGORIES	6
JURY STATEMENT	8
AWARD OF EXCELLENCE	10
Elements	
CF Toronto Eaton Centre Bridge	11
Private Buildings in Context — Low-Scale	
Montcrest School Redevelopment	13
Private Buildings in Context — Mid-Rise	
80 Atlantic	15
Private Buildings in Context — Tall	
Axis Condos	17
Public Buildings in Context	
Seneca College - Centre for Innovation Technology and Entrepreneurship	19
Small Open Spaces	
SQ2 POPS	21
University of Toronto Scarborough Valley Land Accessible Trail	23
Large Places and/or Neighbourhood Designs	
Centennial College Downsview Campus Centre for Aerospace and Aviation	25
Visions and Master Plans	
Bloor / Kipling & Islington Developments	27
The Meadoway	29
Student	
Power and Place	31

TABLE OF CONTENTS

AWARD OF MERIT	33
Elements	
Thermally Speaking	34
Private Buildings in Context — Low-Scale	
Proper TV	36
Private Buildings in Context — Mid-Rise	
West Block Est. 1928	38
Kingston&Co Condominiums	40
Private Buildings in Context — Tall	
The Massey Tower	42
Public Buildings in Context	
Ryerson University - Daphne Cockwell Health Sciences Complex	44
Canoe Landing Community Campus	46
Guildwood Station	48
Small Open Spaces	
St James Park - Park Improvements	50
Large Open Spaces and/or Neighbourhood Designs	
Garrison Crossing (Fort York Pedestrian and Cycle Bridges)	52
Yonge Sheppard Centre	54
Student	
xs spaces: a new laneway urbanism for Toronto	56
Embodied Energy: Living Lab	58
SPECIAL JURY AWARD FOR INSPIRING INFRASTRUCTURE	60
Storm Water Facility	61
Emergency Exit Buildings, Toronto York Spadina Subway Extension	63
2021 JURY MEMBERS	65

AWARD CATEGORIES

The City of Toronto accepted entries for the 2021 Urban Design Awards in the following categories:

ELEMENTS

A stand-alone object, public art installation, landscape element or small-scale piece of a building which contributes significantly to the quality of the public realm. Submissions may include, but are not limited to: benches, doorways, signage, canopies, porches or colonnades, gateways, light fixtures, walkways, stairways, barrier-free access, fences and works of art.

PRIVATE BUILDINGS IN CONTEXT

An individual building or a composition of buildings, that achieve(s) urban design excellence and is precedent-setting for a project of its type through its relationship to the public realm, pedestrian amenity, detailing and massing and the natural environment. Submissions should document and highlight how the project contributes to successful city building through its contextual relationship, design quality and measures of sustainable design. All types of buildings are eligible whether “landmark” or “background,” new construction or a restoration/transformation. Projects in both urban and suburban contexts will be considered. The Private Buildings in Context category consists of three subcategories that reflect a range of scales:

A. LOW-SCALE

A low-scale project is four storeys or less, notwithstanding its land use. Submissions may include, but are not limited to: multi-family residential uses such as low-rise apartments and townhouse developments; and retail, office, mixed-use or industrial facilities on main streets and arterials. Single-family dwellings (e.g. houses) are not eligible for entry.

B. MID-RISE

A mid-rise building is generally taller than four storeys, but no taller than the width of the adjacent street right-of-way (i.e. typically between five and 11 storeys). Submissions may include, but are not limited to: mixed-use “Avenue” buildings, small apartment/condo buildings, commercial and industrial buildings.

C. TALL

A tall building is generally taller than the width of the adjacent street right-of-way. A building that has both tall and mid-rise components should be entered in this category. Submissions may include, but are not limited to: residential or commercial buildings.

PUBLIC BUILDINGS IN CONTEXT

An individual building or a composition of buildings, with a primary function to serve the public and/or is largely accessible to the public. Public buildings are focal points for communities of various sizes, from small neighbourhoods to a national body. Submissions should demonstrate urban design and architectural excellence through a relationship to the public realm, pedestrian amenity, detailing and massing, the natural environment and sustainable design. In this category, all building scales are eligible (low-scale, mid-rise and tall), as well as new construction and restoration/transformation. Buildings in both urban and suburban contexts will be considered. Submissions may include, but are not limited to: education, health care, recreation, cultural, community and civic buildings.

AWARD CATEGORIES

SMALL OPEN SPACES

A small open space, generally related to and defined by adjacent buildings or natural/built elements, which provides an extension and addition to the public realm in an exemplary way. The small open space need not be publicly owned, but must be publicly accessible. Submissions may include, but are not limited to: courtyards, plazas, forecourts, gardens, trails, mews and small neighbourhood parks.

LARGE PLACES AND/OR NEIGHBOURHOOD DESIGNS

A design plan for a new or renovated large-scale area of the city. The project must be completed to such extent to allow the jury to clearly understand and evaluate the plan. The submissions in this category should state the existing conditions and demonstrate how City objectives for establishing a clear public structure of streets, parks, open spaces and building sites are met. The submission should also highlight major areas of innovation, particularly those related to infrastructure, environmental management and sustainable design, as well as provide evidence of community involvement and acceptance. Submissions may include, but are not limited to: large parks, area/ district plans, neighbourhood plans, subdivisions, industrial parks, campus plans and streetscapes. Both urban and suburban contexts will be considered.

VISIONS AND MASTER PLANS

Unexecuted visions for the city, studies and master plans of high inspirational value with the potential for significant impact on Toronto's development. Submissions in this category may include but are not limited to: theoretical and visionary projects, as well as any project fitting the description of Large Places or Neighbourhood Designs that are unbuilt.

STUDENT PROJECTS

Students in urban design, architecture, landscape architecture and other design programs are invited to submit theoretical or studio projects set in, or relating to Toronto. Students should co-ordinate with design studio professors/advisors to select projects that are suitable for submission.

SPECIAL JURY AWARD

Special jury award for inspiring infrastructure.

Note: The jury reserves the right not to present awards in every category. The jury also reserves the right to reallocate submissions into categories which they deem to be most appropriate.

JURY STATEMENT

With over 170 submissions, the Toronto Urban Design Awards for 2021 attracted a remarkable cross section of impressive projects from across our city. Design excellence was expressed in a range of scales from tiny TTC exit pavilions to kilometers long new parks located in electrical transmission corridors; from pedestrian bridges to condominium towers. Surprisingly, students submitted 52 projects, a record for the Toronto Urban Design Awards program. There is very good news: the quality of design represented by the projects bodes well for the present and future of our City's public realm.

From the designs, the jury observed the emergence of important themes: a subtle social imagination was expressed in the shared-use open spaces at Canoe Landing; commitment to high quality materials in the guardrails at the University of Toronto Scarborough Valley Land Accessible Trail; sensitivity to equity and accessibility by embracing indigenous storytelling at Seneca College Centre for Innovation Technology and Entrepreneurship; finely tuned approaches to regenerative design in the Embodied Energy Living Lab and the proposal for Power and Place; commitment to heritage in West Block Est. 1928, the CF Toronto Eaton Centre Bridge and The Massey Tower; the inspired inclusion of indigenous plantings and re-establishing urban forestry at Seneca College and the Meadoway.

In all cases, the particular success of the winners was elevating the public realm experience for Toronto residents. Each of the awarded projects is unmistakable: you will want to tell a friend or colleague "you must visit this new project: it shows how design excellence has permeated the whole city". But more importantly, the successful projects demonstrate the result of respectful, prolonged, and patient conversations with the correct goals in mind: improving the quality, inclusivity, and accessibility of the spaces around and between buildings - our public realm.

Jurors observed that some of the strongest projects found an economy of means - doing the most with very little - by talking to people who will be using it, including indigenous peoples. These projects had strong engagement, considered and powerful interventions that required less effort than would otherwise have been required. The evidence of these conversations is clear: it behooves us to listen and do more with less. The result is design excellence.

This year's submissions demonstrated that utilitarian project types and residual spaces such as transit exits, works of civil engineering and hydro electric corridors can be designed to elevate the public realm. Among the 2021 award winners was a sublime, sculptural and minimal Storm Water Facility pavilion, part of the City's immense investment in cleaning stormwater before it returns to Lake Ontario, and celebrating it with design excellence. The Meadoway, an underutilized hydro electric corridor that bisects the city, is brought back to life by using simple but powerful interventions: transitioning from mowed grass lawns to wild meadow pollinator species, introducing new trails and recreational areas, it represents a unique form of multi-stakeholder collaboration and includes the Toronto and Region Conservation Authority, the adjacent neighbourhoods, the City and philanthropy coming together to realize the vision. At the other end of the scale, tiny exit pavilions, part of the new Spadina Line extension, were the subject of dazzling material explorations. Each of the material palettes gave the opportunity for you to surrender to wonder and awe at so much attention in such an unexpected place, reminding that as the city grows, all spaces deserve creative design.

As the city grows, so too does the need for innovation in mid-rise and tall buildings. Axis Condo challenges and improves the typical tower and podium arrangement. The design skilfully

JURY STATEMENT

showed how to integrate tall building guidelines, respond to the scale of adjacent neighbourhoods, integrate townhomes, manage wind impacts and, with an economy of means, shape sculptural balconies that elegantly merge the podium with the tower.

Kingston&Co Condominiums is a midrise building on an avenue: with an innovative facade treatment it is both distinctive and harmonious with the adjacent low scale neighbourhood, as well as foreshadowing beautiful ways to end the era of all-glass facades. The innovations are not only aesthetic: they represent innovative city building.

Despite the climate emergency, submissions with innovative sustainable strategies for operational energy and embodied energy did not have a major presence among the submissions. There were notable exceptions: two of three student projects demonstrated innovative concepts for regenerative urbanism. In Power and Place, creation of electrical energy is conceived as a way to subsidize housing cost, bringing together sustainability and affordability. In Embodied Energy: Living Lab the student proposes a critical approach to both removal and addition of landscape treatments to ensure that the lowest embodied energy approaches are considered.

One project was truly exceptional. Jurors unanimously felt the the Seneca College Centre for Innovation Technology and Entrepreneurship was their overall favourite: it includes dramatic space making, indigenous storytelling, and it's combination of durable hardscape and softscape, city scaled front porch, presence of colour, and layered approach to planning made it an exemplar of city making.



| AWARD OF EXCELLENCE

CF Toronto Eaton Centre Bridge

15 Queen Street West

Jury Comment

A remarkable feat of architecture creates connectivity in a dense commercial zone. Instead of a utilitarian structure connecting busy commercial zones, this structure captured the public's imagination by achieving a sense of tactile and visual dynamism that enhanced the existing architecture. The overpass bridge serves as an intermediary for inhabitants to experience space while carefully filtering and framing views of the surrounding context forming novel vantage points.

Project Team

Architect: Zeidler Architecture in association with WilkinsonEyre

Structural Engineer: RJC Engineers

Mechanical Engineer: The Mitchell Partnership Inc.

Electrical Engineer: Mulvey and Banani International Inc.

Lighting: Mulvey and Banani International Inc. and Speirs + Major

Bridge Fabricator: seele Inc.

Heavy Lifting and Transport: Mammoet

Developer/Owner/Client

The Cadillac Fairview Corporation Limited

General Contractor

PCL Constructors Canada Inc. (Toronto)



AWARD OF EXCELLENCE ELEMENTS



Photo credit: James Brittain

Montcrest School Redevelopment

658 Broadview Avenue

Jury Comment

This school addition is gently nestled between a busy avenue, the ravine, and heritage properties. The new buildings enhance the existing fabric and proportion of the neighbourhood through the adaptive reuse of heritage structures and successfully navigating its environs. The project attracts activity by welcoming different ages and family groups to the neighbourhood. Site considerations include groundwater recharge using porous pavers and enhancement to the street experience by expanding the public realm and using strategic touches of vegetation.

Project Team

Architect: Montgomery Sisam Architects

Landscape Architect: PMA Landscape Architects

Structural Engineer: RJC Engineers

Mechanical Engineer: GPY + Associates

Electrical Engineer: Fortech Engineering

Civil Engineer: MMM Group

Heritage Consultant: Goldsmith Borgal & Company Ltd. Architects

Developer/Owner/Client

Montcrest School

General Contractor

Eastern Construction



[@montgomerysisam](https://www.instagram.com/montgomerysisam)

AWARD OF EXCELLENCE PRIVATE BUILDINGS IN CONTEXT — LOW-SCALE



Photo credit: Younes Bounhar (Doublespace Photography)

80 Atlantic

80 Atlantic Avenue

Jury Comment

This project incorporates masterful adaptive reuse, a commitment to high-quality materiality, high sustainability targets, and social gathering spaces that enhance the existing context. Through a carefully considered sense of proportion and curated circulation and experiences, each façade is executed with detail and attention. From the loading areas to the internal façades, the design enhances all the common spaces, including the central outdoor courtyard and the existing small park at the rear of the building. Movement in and around the buildings is welcoming and dramatic with exposed support structures that anchor and overlook the back of the site and the courtyard. The glass façade facing south creates a microclimate that extends the seasonal use of the lower courtyard while carefully layering overlooks from the street level that further animate the experience.

Project Team

Architect: BDP Quadrangle

Landscape Architect: Vertechs Design

Structural Engineer: Read Jones Christoffersen Ltd.

Mechanical and Electrical Engineer: Smith + Andersen

Civil Engineer: R.V. Anderson Associates Ltd.

Commissioning and Sustainability Consultant: RWDI Consulting Engineers and Scientists

Developer/Owner/Client

Hullmark and BentallGreenOak on behalf of Sun Life Financial

General Contractor

Eastern Construction



[@HullmarkTO](https://www.instagram.com/HullmarkTO)

AWARD OF EXCELLENCE PRIVATE BUILDINGS IN CONTEXT — MID-RISE



Photo credit: Doublespace Photography

Axis Condos

411 Church Street

Jury Comment

Innovation in balcony footprints, façade treatment, and the subversion of the standard podium results in a landmark tower with a striking street presence and visual identity. Each façade honours adjacent buildings using touches of colour and snippets of scale to respect and echo the context while generating its own profound expression. The townhouse entrances along the podium's edge are detailed sensitively and meet the street with micro gardens that give back a small but generous gesture toward the street. The tower's podium at the corner of Church and Wood enhances the street through the combination of architectural angles, canopy, and an innovative tower façade treatment that result in well-proportioned distances between residences and retail that face each other.

Project Team

Architect: IBI Group

Landscape Architect: Strybos Barron King

Structural Engineer: Jablonsky, Ast & Partners

Mechanical and Electrical Engineer: Able Engineering Inc.

Shoring: Isherwood Geotechnical Engineers

Developer/Owner/Client

Centrecourt

General Contractor

Centrecourt



AWARD OF EXCELLENCE PRIVATE BUILDINGS IN CONTEXT — TALL



Photo credit: David Xu

Seneca College - Centre for Innovation Technology and Entrepreneurship

1750 Finch Avenue East

Jury Comment

The layered façade of this striking new facility creates several modes of experience for passersby and inhabitants. The Finch façade is a monumental expression along a regional collector route; a storytelling colonnade and façade provide detail and engagement from nearby garden pathways; a welcoming entrance canopy and intimate views to interior narratives greet adjacent pedestrians. Excellence in site design includes onsite stormwater management, Indigenous landscaping that includes food-bearing plants, and a comfortable invitation to diverse activities and mobilities. The overwalk creates a sense of threshold between two courtyards. The reflective façade adjacent to the south courtyard creates a microclimate that extends its seasonal utility. Indigenous narratives are embedded thoughtfully; the project reflects a meaningful engagement process that has rediscovered principles of land stewardship and integration of indoor and outdoor experience throughout.

Project Team

Architect: Perkins&Will

Landscape Architect: Quinn Design Associates

Structural Engineer: RJC Engineers

Mechanical and Electrical Engineer: Smith + Andersen

Civil Engineer: MMM Group

Artist: Joseph Sagaj

Developer/Owner/Client

Seneca College

General Contractor

EllisDon

AWARD OF EXCELLENCE PUBLIC BUILDINGS IN CONTEXT



Photo credit: Doublespace Photography

SQ2 POPS

80 Vanauley Street

Jury Comment

This project initiates the potential for the future revitalization of Alexandra Park. It inverts the often problematic relationship between shared open spaces and housing by creating a highly visible and well-used central courtyard. Entry from the street is welcoming while also defining a semi-private threshold that clearly defines community space. High-quality and durable furnishings invite individual or group activities. A feeling of safety is achieved by maximizing overlooks, viewsheds, lighting, and thresholds to adjacent private townhouse yards. The landscape design reinforces and enhances the edges of the adjoining architecture throughout. The urban food garden and fruit trees are carefully configured for plenty of interest in a tight space and promises long-term durability with curb edges and elevated beds. The jury anticipates ongoing efforts to involve residents in nurturing the space.

Project Team

Architect: Teeple Architects (SQ2 Design Architect), Kirkor Architects and Planners (SQ2 Architect of Record)

Landscape Architect: Janet Rosenberg & Studio

Structural Engineer: Jablonsky Ast & Partners

Developer/Owner/Client

Tridel & Toronto Community Housing Corporation (TCHC)

General Contractor

Deltera (GC), Trinity Contracting and Landscaping



[@janetrosenbergstudio](https://www.instagram.com/janetrosenbergstudio)



[@JRStudio_news](https://twitter.com/JRStudio_news)

AWARD OF EXCELLENCE SMALL OPEN SPACES



Photo credit: Michael Muraz

University of Toronto Scarborough Valley Land Accessible Trail

1265 Military Trail

Jury Comment

This inspiring intervention into our invaluable ravine habitat brings the experience of nature into the lives of those with mobility issues and creates an experience of place that has universal impact. The counterpoint to adjacent architecture is dramatic and complementary. Sensitivity to existing natural landscape features creates a sinuous, organic experience with striking viewsheds. Materiality is of excellent quality and promises future durability. Amphitheatre space is well used and generously proportioned.

Project Team

Landscape Architect: Schollen & Company Inc.

Engineer: Entuitive Engineering

Ecologist: North-South Environmental Inc.

Geotechnical Engineer: GeoTerre Ltd.

Developer/Owner/Client

University of Toronto Scarborough Campus

General Contractor

Midome Construction Services Ltd.

AWARD OF EXCELLENCE SMALL OPEN SPACES



Centennial College Downsview Campus Centre for Aerospace and Aviation

65 Carl Hall Road

Jury Comment

The potential for transformation of the surrounding area is powerfully exemplified by this sensitive revitalization of a marginalized industrial campus. Adaptive reuse of existing buildings is successfully narrated to passersby, bringing together multiple types of existing buildings from different eras into a cohesive contemporary expression.

Moments of social gathering are provided in plazas between and around the buildings, with careful attention to all facades. Structuring the canopy above the glass creates a single glowing plane, a sheltering presence from below, and a clear gesture from the street.

Heritage small-pane glass reconstruction is especially powerful in the redeveloped envelopes. The new hangar expresses its structure behind a glazed façade that elevates and translates the language of existing buildings into an inspiring new addition.

Project Team

Architect: MJMA + Stantec

Structural Engineer: Blackwell Structural Engineers

Artist: MJMA (Graphic Design)

Heritage Consultant: ERA Architects

Signage Fabricator: Acumen Visual Group and PCL Graphics Ltd.

Developer/Owner/Client

Centennial College



AWARD OF EXCELLENCE LARGE PLACES AND/OR NEIGHBOURHOOD DESIGNS



Photo credit: Doublespace Photography

Bloor/Kipling & Islington Developments

Bloor Street & Kipling Avenue, Bloor Street & Islington Avenue

Jury Comment

Neighbourhood scale is carefully arranged to achieve thresholds and a sense of public/semi-public open spaces that are well proportioned and have a sense of overlook, intimacy, and safety for users. Scale of residential towers is successfully broken into textured massing to achieve human scale. Incorporating market-rate and affordable housing with select commercial elements and shared amenities promises a diverse and resilient neighbourhood. Microclimate, daylight, views to sky, and wind patterns are all sensitively and carefully considered. This redevelopment plan shows the potential of future mixed-use residential development to incorporate vibrant habitats in shared environments that help us thrive together.

Project Team

Architect: Henning Larsen Architects, Adamson Associates Architects

Landscape Architect: PLANT Architect

Engineer: BA Group

Developer/Owner/Client

CreateTO



[@plantarchitectinc](#) / [@adamsonaai](#) / [@henninglarsenarchitects](#)



[@plantarch](#) / [@HLArchitects](#)

AWARD OF EXCELLENCE VISIONS AND MASTER PLANS

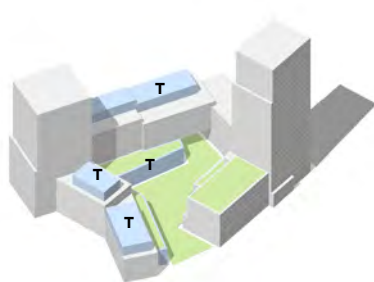

Proposed townhouses at Block 1

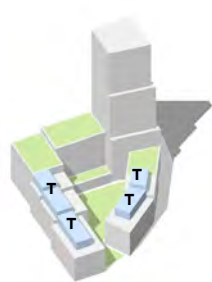

Proposed townhouses at Block 3

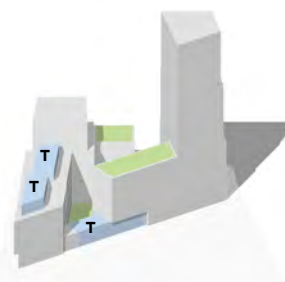

Proposed townhouses at Block 5



Proposed townhouses at Block 6

Image credit: Henning Larsen Architects, Plant Architect

The Meadoway

Gatineau Hydro Corridor

Jury Comment

This project redefines our understanding of public and recreational open space within the context of a large metropolis. By utilizing the under-used continuous hydro corridor that crosses the city, we can generate new civic and recreational amenities, and trails in spaces once considered off limits. Not only does this project add exponentially more park space to the city, but it also connects ravine ecosystems and wildlife habitats through pollinator and meadow grasses by replacing the carbon-intensive mowed lawns that sit under the pylons. This demonstration project is a model of building relationships between communities, utility companies, philanthropists and conservation authorities is both catalytic and precedent setting - This is the type of visionary project that puts Toronto on the map!

Project Team

Architect: Perkins&Will

Landscape Architect: Perkins&Will

Artist: FUTURE LANDSCAPES Design + Visualization

Developer/Owner/Client

Toronto and Region Conservation Authority



[@perkinswill_ont](https://www.instagram.com/perkinswill_ont)



[@perkinswill_ONT](https://twitter.com/perkinswill_ONT)



[@ideasandbuildings](https://www.facebook.com/ideasandbuildings)

AWARD OF EXCELLENCE VISIONS AND MASTER PLANS



Image credits: Perkins&Will, FUTURE LANDSCAPES Design + Visualization

Power and Place

Princess Margaret

Jury Comment

Affordable housing in concert with small-scale energy generation presents a revolutionary view of how a society could aspire to redistribute power: both energy and socio-economic agency. The proposal reverses the dynamics that currently underpin large-scale energy generation, where impacts are severe and differentially experienced, and subverts the embedded dynamic of wealth accumulation inherent in a centralized approach to energy distribution. A narrative of equity and resilience is represented by decentralization of energy generation and access. While perhaps aspirational at present, with capital investment and technological advances the proposal points to a different approach that envisions one possible future.

Project Team

Erik Roberson

Zakary Jacobi

Check Yiu Yo Yo Tang

AWARD OF EXCELLENCE STUDENT

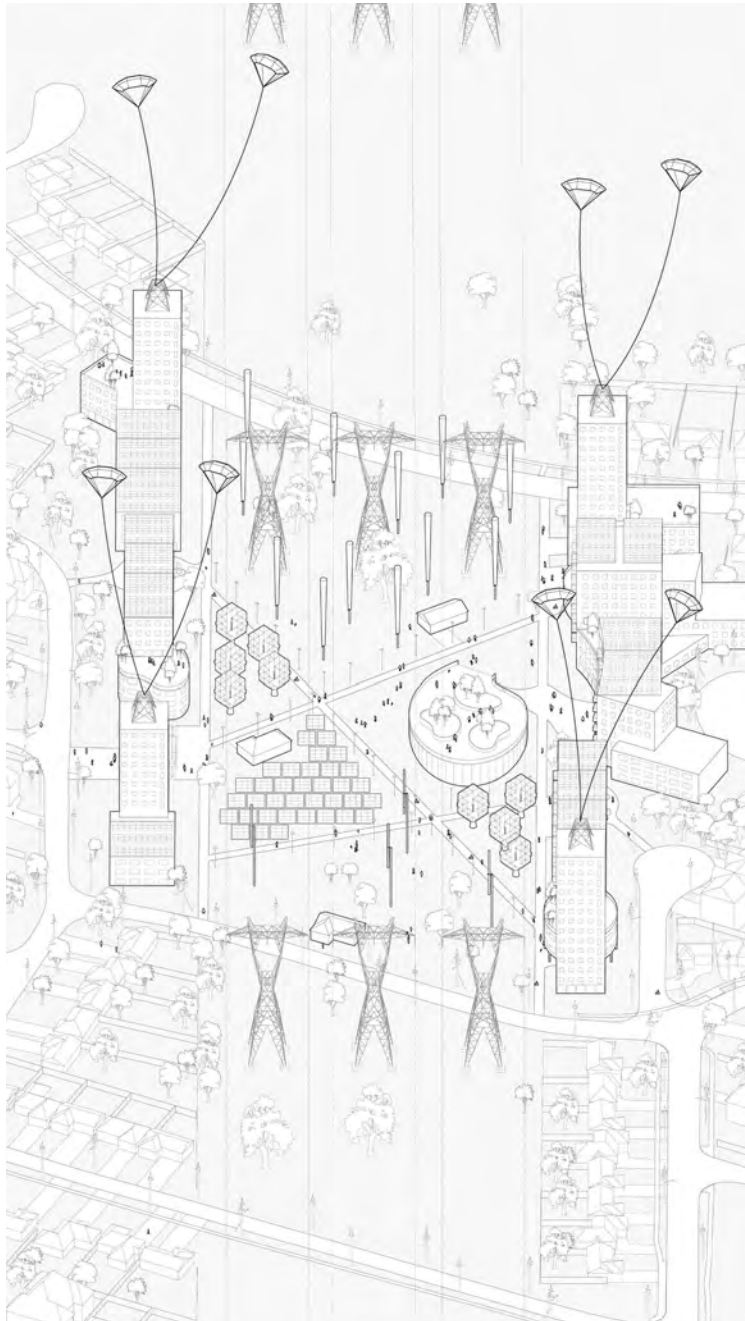

Image credit: Erik Roberson

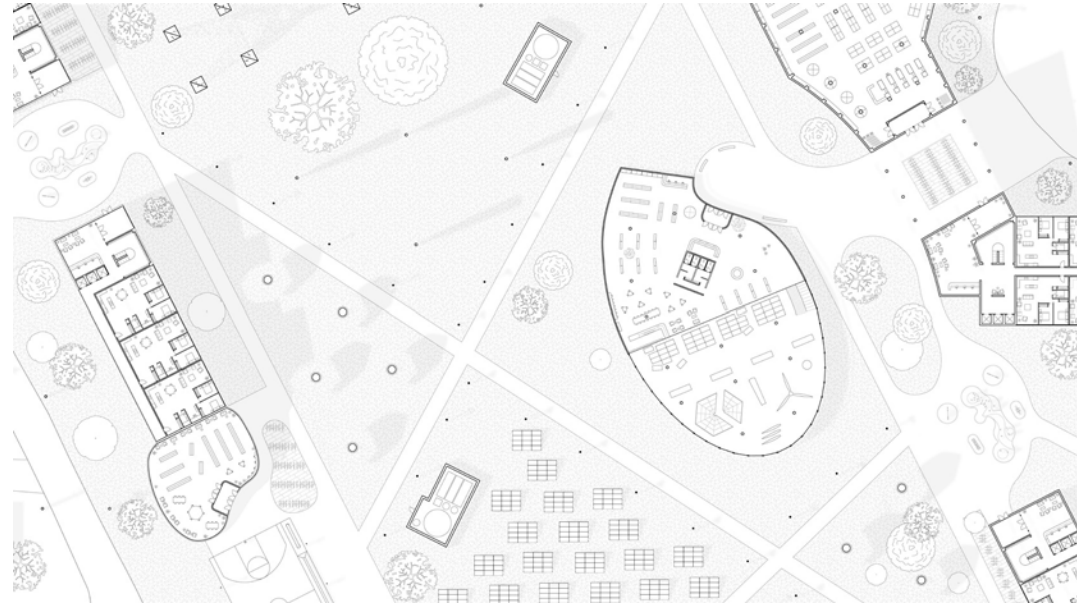

Image credit: Erik Roberson

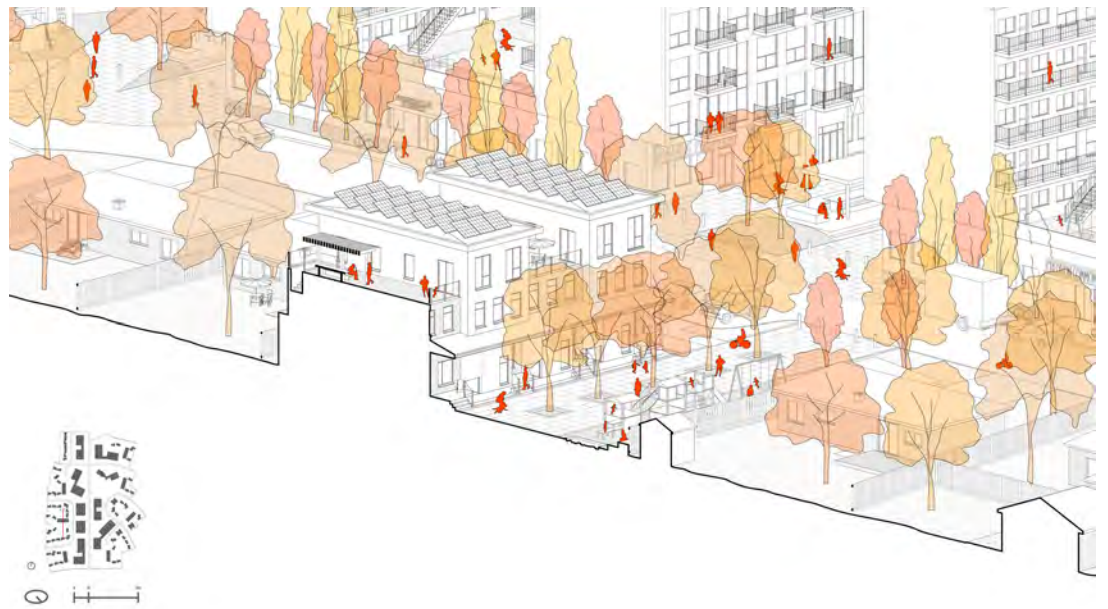

Image credit: Zakary Jacobi



| AWARD OF MERIT

Thermally Speaking

250 Fort York Boulevard

Jury Comment

Using an existing architectural canvas, this temporary exhibit invites an international audience to appreciate an underused place at the edge of the downtown core. The intervention animates a non-standard and under-utilized public zone, transforming it into an interactive experience. Crossing beneath the expressway is a psychological and nearly mythical barrier. This intervention achieves a difficult and significant reinterpretation of that anxious experience into an invitation and an engaging threshold by colourfully illuminating a significant corner of Toronto's history. The Jury passionately wished it were a permanent installation.

Project Team

Engineer: CITYLIGHTS TORONTO

Artist: LeuWebb Projects

Developer/Owner/Client

City of Toronto, Nuit Blanche



[@LEUWEBB PROJECTS](https://www.instagram.com/leuwebb_projects)

AWARD OF MERIT ELEMENTS



Photo credit: Doublespace Photography

Proper TV

772 Dovercourt Road

Jury Comment

A well considered intervention in a neighbourhood that benefits from the surprise of colour and delight. Transformative at a scale in keeping with the neighbourhood, this project strongly signals the potential for rejuvenation of the surrounding context. The program for adaptive reuse is admirable as the reinvestment supports small creative businesses.

Project Team

Architect: superkül

Landscape Architect: SJN + Associates Landscape Architects Inc.

Structural Engineer: Shoalts Engineering

Mechanical and Electrical Engineer: Sharma and Partner

Developer/Owner/Client

Proper TV

General Contractor

PCI Construction Group

 [@superkulararchitecture](https://www.instagram.com/superkulararchitecture)

 [@superkul](https://twitter.com/superkul)

 [@superkulararchitecture](https://www.facebook.com/superkulararchitecture)

AWARD OF MERIT PRIVATE BUILDINGS IN CONTEXT — LOW-SCALE



Photo credit: Tom Arban

West Block Est. 1928

500 Lakeshore Boulevard West

Jury Comment

Sitting on the edge of Lake Ontario's original shoreline, this impressive heritage restoration and adaptive reuse project will preserve one of Toronto's last remaining historical mercantile harbour warehouses for decades to come. Not only is the meticulous heritage façade revitalization a significant achievement, but the addition and sensitive choices in lighting and signage will enhance the street experience and honour the history of the site. The office intervention above steps back successfully and respects the proportions of the original building. Within the public realm, the extensive seating areas and planters and the canopies create a sense of scale and limit views to reveal the glory of the heritage building in an exciting way.

Project Team

Architect: architectsAlliance

Landscape Architect: NAK Design Strategies

Structural Engineer: RJC Engineers

LEED, Mechanical and Electrical Engineer: MCW Consultants

Heritage Consultant: ERA Architects

Heritage Contractor: Historic Restoration Inc.

Developer/Owner/Client

Wittington Properties Limited

ChoiceREIT

Capital Developments

General Contractor

EllisDon and Rochan Building Corporation

 [@_archalliance_](https://www.instagram.com/archalliance_)

 [@_archAlliance](https://twitter.com/archAlliance)

 [@ArchitectsAlliance](https://www.facebook.com/ArchitectsAlliance)

AWARD OF MERIT PRIVATE BUILDINGS IN CONTEXT — MID-RISE



Photo credit: Michael Muraz Photography

Kingston&Co Condominiums

1100 Kingston Road

Jury Comment

Careful attention to scale and proportion relates well to existing context, creating a successful intervention at a much larger scale compared to the adjacent low-rise neighbourhood. The recessed balconies and successful use of chamfering, gentle angles, and colour animate the opaque façade, reducing reliance on glazing and enhancing energy performance overall. Stepped massing maintains daylight and respects adjacent single-family homes, and a setback along the major thoroughfare allows for sittable planters and a hospitable canopy. Special care is shown with detailed shopfronts at introductory corners. This project represents an innovation in materiality and building typology that points to a bright future for mid-rise mixed-use residential development.

Project Team

Architect: Teeple Architects

Landscape Architect: Ferris + Associates

Structural Engineer: Blackwell

Mechanical & Electrical Engineer: Able Engineering

Developer/Owner/Client

TAS, main + main

General Contractor

Bird Construction



[@teeplearch](https://www.instagram.com/teeplearch)

AWARD OF MERIT PRIVATE BUILDINGS IN CONTEXT — MID-RISE



Photo credit: Scott Norsworthy

The Massey Tower

197 Yonge Street

Jury Comment

This complex urban intervention maintains the heritage character of a formerly vacant bank building. Significant collaboration between adjacent projects supports redevelopment of Massey Hall. The tower residence is carefully executed with an innovative and striking animated façade. Sensitive development of the parking structure adds to the character of street. The pedestrian laneway north of the new glass-fronted building at the ground plane is a difficult moment with possible safety concerns; however, the jury cannot assess the final impact of this pedestrian thoroughfare due to the ongoing construction at Massey Hall.

Project Team

Architect: Hariri Pontarini Architects

Landscape Architect: Janet Rosenberg & Studio

Structural Engineer: RJC Engineers

Mechanical and Electrical Engineer: Able Engineering

Traffic Consultant: BA Group

Heritage Consultant: ERA Architects

Developer/Owner/Client

MOD Developments

General Contractor

Tucker HiRise



[@hariripontariniarchitects](https://www.instagram.com/hariripontariniarchitects)

AWARD OF MERIT PRIVATE BUILDINGS IN CONTEXT — TALL



Photo credits: doublespace photography



Photo credits: Ben Rahn/A-Frame

Ryerson University - Daphne Cockwell Health Sciences Complex

288 Church Street

Jury Comment

This new development at a pivotal location within Ryerson's downtown campus achieves a layering of intensities in a thriving space. The parti amply demonstrates the intentions in contributing to the experience of urban context, punctuated by bold colour at offset intersections. This diagrammatic approach to context and urban space that surrounds the project is clearly expressed and successfully executed throughout. Seating along the street provides comfortable places to pause, canopies bring the building down to a human scale and provide shelter. Fenestration is used strategically for a feeling of secure overlook, for example next to exterior bicycle storage. Hospitable to the street on all sides, clear viewsheds create a feeling of safety even in laneways.

Project Team

Architect: Perkins&Will

Landscape Architect: DTAH

Structural Engineer: WSP

Mechanical Engineers: MCW, External Link

Electrical Engineer: Crossey

Civil Engineers: MMM Group, WSP

Developer/Owner/Client

Daphne Cockwell Health Sciences Complex

General Contractor

Eastern Construction Company Ltd.

AWARD OF MERIT PUBLIC BUILDINGS IN CONTEXT



Photo credits: Nikita Ovsyannikov



Photo credits: Tom Arban Photography

Canoe Landing Community Campus

45 Fort York Boulevard

Jury Comment

This innovative project is one of the few new multi-purpose community facilities in this dense part of the city. Its diverse uses bring together many types of people at different times of day, attesting to its success and need. Through layered, diverse, and flexible uses of space, varied configurations and amenities are encouraged. The large angled canopy weaves together disparate programs in a sensitive and considered way - it offers an urban gesture that strategically extends and protects the public realm near the entrances as it invites passersby and users to sit, pause, and gather. An existing trail system culminates in a vibrant mural and sittable edge along with an indigenous pollinator garden. The extensive green roofs, high sustainability goals, and renewable energy use are pivotal for our large civic buildings.

Project Team

Architect: ZAS Architects Inc.

Landscape Architect: The Planning Partnership

Engineer: WSP

Artist: Alexander Bacon, Que Rock

Developer/Owner/Client

City of Toronto, TCDSB, TDSB

General Contractor

Buttcon/Atlas



[@zasarchitects](https://www.instagram.com/zasarchitects)

AWARD OF MERIT PUBLIC BUILDINGS IN CONTEXT



Guildwood Station

4105 Kingston Road

Jury Comment

Sensitivity of design elevates what might have been a utilitarian suburban public transit station. Successful design elements such as a broad sheltering canopy, rich materiality, and precisely detailed monumental stairs contribute to an emboldened transit experience and memorable public realm. Pollinator gardens are visible from the clerestory level in the station and enrich the experience of the station landing. This intervention would have had even more impact if it had displayed an innovative approach to stormwater management, parking lot shade and revegetation. The potential represented here to create pleasant experiences along an everyday commute enhances potential ridership and points to a future that includes a rich experience of public transit throughout Toronto.

Project Team

Architect: RDHA

Landscape Architect: AElias +

Engineer: WSP

Developer/Owner/Client

Metrolinx

General Contractor

Kenaidan Contracting Ltd.

AWARD OF MERIT PUBLIC BUILDINGS IN CONTEXT



Photo credit: Bob Gundu

St. James Park-Park Improvements

120 King Street East

Jury Comment

A diversity of experience creates the sense of different outdoor rooms in the park, so that despite the small size there are many options for people to interact and use the spaces. Multiple generations are invited to enjoy the amenities in different ways. Gentle berms interject throughout to enhance the feeling of expansiveness in a small area. Several types of seating areas invite all walks of life, individuals, and groups to engage. Multiple subtle moves of high quality create a sense of belonging, while the sculptural pavilion creates a new landmark. While this emphasis on diversity was a strong point, it may also reduce the sense of cohesion to the design experience and seemed unresolved near the church parking lot.

Project Team

Landscape Architect: PMA Landscape Architects Inc.

Architect: RAW Architects - Pavillion

Engineer: MJS Consultants

Artist: Scott Eunson

Public Consultation: Jane Farrow

Custom Playground and Water-Play Area: Earthscape Play

Lighting Design: Marcel Dion

Developer/Owner/Client

City of Toronto

General Contractor

Pine Valley Corporation

Mopal Construction Limited



AWARD OF MERIT SMALL OPEN SPACES



Photo credit: Krista Jahnke Photography

Garrison Crossing (Fort York Pedestrian and Cycle Bridges)

10 Ordnance Street

Jury Comment

This crucial piece of infrastructure connects key areas of the city and is well used and accessible to people of multiple mobilities. The value to the city is high, achieving the remarkable feat of traversing two challenging railway corridors. The bridges and future park plantings are a fantastic amenity to people from this area and for those coming to enjoy the newly interlinked linear parkway system. Considered use of material and detail are evident from above and below the bridges, which maximize overlooks to city viewscales.

Project Team

Architect: DTAH

Landscape Architect: DTAH

Engineer: Pedelta Canada Inc.

Artist: Bridge Aesthetic Lead - Pedelta, DTAH

Heritage Consultant: Archaeological Services Inc.

Geotechnical and Environmental Lead: Golder

Lighting Designer: Mulvey & Banani Lighting Inc

Developer/Owner/Client

CreateTO on behalf of City Of Toronto

General Contractor

Dufferin Construction Company,

A division of CRH Canada Group Inc.

AWARD OF MERIT LARGE PLACES AND/OR NEIGHBOURHOOD DESIGNS



Photo credits: CreateTO

Yonge Sheppard Centre

4841 Yonge Street

Jury Comment

This large-scale urban design project transforms a city block from neglected split-level retail to a rejuvenated experience that includes excellent wayfinding, a daylight and welcoming main entry, and a high level of quality in the retail, office, and residential spaces throughout. Formerly inaccessible sunken concrete bulwarks along Yonge are replaced with an animated streetscape. This is a challenging and significant re-use undertaking that retains the embodied energy inherent in the existing structures. Connection to public transit creates a much-needed public amenity for the neighbourhood. Office towers are clearly expressed and flank the building, creating a balanced massing at street scale, while the residential development provides 24/7 presence. All façades are resolved and carefully executed.

Project Team

Architect: BDP Quadrangle

Structural Engineer: Entuitive

Mechanical Engineer: TMP Consulting Engineers

Electrical Engineer: Mulvey & Banani

Civil Engineer: Oden Detech Group Inc.

Lighting Design: Gottesman Associates

Developer/Owner/Client

RioCan and Kingsett Capital Inc.

General Contractor

PCL (General Contractor for the Project) SKYGRiD (Contractor for Daycare Component of Project)



[@bdpquadrangle](#)



[@BDPQuadrangle](#)



[@BDPQuadrangle](#)

AWARD OF MERIT LARGE PLACES AND/OR NEIGHBOURHOOD DESIGNS



Photo credits: Bob Gundu

xs spaces: a new laneway urbanism for Toronto

Robinson Place

Jury Comment

Current informal public use of laneways is formalized here into a fully pedestrian zone with associated activities. Focus on habitat revitalization, street furniture, and shared uses creates intimate zones of diverse activity. This proposal would require wide acceptance of alternative public/private and vehicular/pedestrian patterns in the urban area. The proposal presents the potential for interweaving individual households into a shared zone of community interaction. The interpersonal connection supported by this spatial reconfiguration presents a revolutionary view of how we interact as households, communities, and neighbourhoods.

Project Team

Declan Roberts

AWARD OF MERIT STUDENT



Image credit: Declan Roberts

Embodied Energy: Living Lab

Willcocks and Huron Street, University of Toronto St. George Campus

Jury Comment

This proposal adds the novel filter of embodied energy to the value perceived in the primary materials that compose a city. The revegetation of existing hardscape is explored by selective demolition and replacement with successional organic material. Urban forestry is supported with phased plantings, acknowledging the educational and exploratory aspects of habitat renewal. This powerful narrative undoes the perceived dualism of urban and forested spaces and instead proposes an aspirational model where the two are mutually supporting, coexisting in an ongoing process of mutual rediscovery.

Project Team

Madison Appleby
Agata Mrowzowski

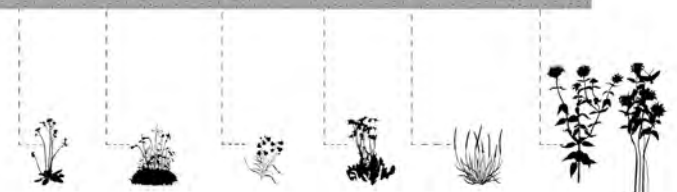

Image credit: Madison Appleby & Agata Mrowzowski



SPECIAL JURY AWARD FOR
INSPIRING INFRASTRUCTURE

Storm Water Facility

480 Lakeshore Boulevard East

Jury Comment

This sublime and sculptural form creates a strong presence at a prominent trailhead well-used by cyclists and celebrates a commitment to high performance in water quality. Viewed from the Gardiner it creates an enigmatic presence that inspires curiosity and perhaps a greater awareness of City of Toronto's water quality efforts. The skylight allows daylight into the service space and creates a moment of culmination for the simple and bold massing.

Project Team

Architect: gh3

Landscape Architect: gh3

Structural, Mechanical and Electrical Engineer: R.V. Anderson

Environmental: GHD

Developer/Owner/Client

Toronto Water, Waterfront Toronto

General Contractor

Graham Construction



[@gh3architects](https://www.instagram.com/gh3architects)



[@GH3architects](https://twitter.com/GH3architects)

AWARD OF EXCELLENCE SPECIAL JURY AWARD FOR INSPIRING INFRASTRUCTURE



Photo credit: Adrian Ozenik

Emergency Exit Buildings, Toronto York Spadina Subway Extension

EEB1: 2 Whitehorse Road, EEB2: 18 St. Regis Crescent, EEB3: 2 Toro Road

EEB4: 45 The Pond Road

Jury Comment

Gems in a landscape present poetic short stories that inspire curiosity about these egresses to public transit below. Arriving at the exit doors, the expression of these small spaces is fully realized at all sides.

Façade explorations are individually selected. Landscape is particularly well resolved at 45 The Pond Road, other interventions are surrounded by the standard sod.

Project Team

Architect: IBI Group

Landscape Architect: Scott Torrance

Engineer: HATCH

Material Supplier and Manufacturer: Masonry Contractor Limen Group

Developer/Owner/Client

Toronto Transit Commission

General Contractor

EEB1 to EEB3 by Aecon Buildings

EEB4 by OHL/FCC Joint Venture



AWARD OF EXCELLENCE SPECIAL JURY AWARD FOR INSPIRING INFRASTRUCTURE



Photo credit: Ben Rahn/A-Frame

2021 JURY MEMBERS



Michael Leckman, Jury Chair

MRAIC

Principal, Diamond Schmitt

Michael Leckman is a Principal with Diamond Schmitt. As founding member and Co-Chair of Toronto's Design Review Panel, he has shaped a critical debate on city planning. Michael has also contributed to the profession as guest critic and lecturer at schools of architecture across Canada, and speaker at industry conferences, including the CaGBC, the Urban Land Institute, and the OAA. He champions sustainable innovation, which has enabled new approaches to green building design. Michael is responsible for major academic and cultural projects across North America with aggressive sustainable design mandates, including LEED, Net Zero Energy, and the Living Building Challenge.



Fadi Masoud

Assistant Professor of Landscape Architecture and Urbanism

Director of the Centre for Landscape Research, University of Toronto

Fadi Masoud is an Assistant Professor of Landscape Architecture and Urbanism at the University of Toronto and the Director of the Centre for Landscape Research. His research, teaching, and design work focuses on the relationships between environmental systems, design, and instrumental planning policy tools. Masoud currently leads research projects on climate adaptive urban and landscape design, novel resilient urban codes, and the future of metropolitan public open space. Prior to joining the University of Toronto, Masoud held teaching and research appointments at Harvard University's Graduate School of Design and Massachusetts Institute of Technology Department of Urban Studies and Planning. Masoud trained and practiced as a planner, landscape architect, and urban designer. He is the editor of *Terra-Sorta-Firma: Reclaiming the Littoral Gradient*, an atlas of urbanism on reclaimed land (Actar 2021). Masoud currently sits on Waterfront Toronto's Design Review Panel and was a member of the City of Toronto's Urban Flooding's Working Group.

2021 JURY MEMBERS



Eladia Smoke | KaaSheGaaBaaWeak
MArch, OAA, OAQ, MAA, MRAIC, LEED®AP
Principal Architect, Smoke Architecture Inc.

KaaSheGaaBaaWeak | Eladia Smoke is Anishinaabekwe from Obishikokaang | Lac Seul First Nation, with family roots in Alderville First Nation, Winnipeg, and Toronto. Eladia has worked in architecture since 2002, founded Smoke Architecture as principal architect in 2014, teaches as a Master Lecturer at Laurentian's McEwen School of Architecture, and serves as a founding member of RAIC's Indigenous Task Force. Eladia represented Canada at the 2018 Venice Biennale Unceded exhibition as part of an international team of Indigenous designers and architects. Current professional work includes community-based and institutional projects working alongside Indigenous stakeholders, collaborating with First Nation communities, and listening closely to our Elders.



Jackie VanderVelde
OALA, AALA, MALA, SALA, APALA, CSLA, ASLA
Founder, Land Art Design Landscape Architect Inc.

With over 30 years of experience in landscape architecture, Jackie is the founder at Land Art Design Landscape Architects Inc., based in Toronto. Jackie has served on the Hamilton Design Review Panel and is currently on the Burlington Urban Design Panel.

She specializes in the design of multi-use developments, streetscapes, open spaces, and parks in the urban environment. She is committed to creating high quality, unique designs that build beautiful livable cities with moments of wonder and awe. Each project develops the best sustainable practices of LEED or Green Standards within the various municipalities. Having grown up on farms she is focused on expanding our natural environments in our cities, recognizing the physical and mental health and wellness benefits of time with nature. To that end, for each of her projects, she makes a donation to Grand Trees for the planting of native trees in the GTA.

SPONSORS

LEAD



GOLD

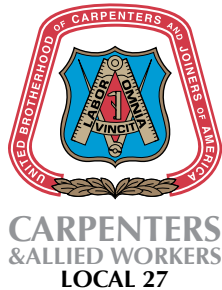

IN-KIND



toronto.ca/tuda

[@CityPlanTO](https://twitter.com/CityPlanTO)

