

Moss Park Park Improvements & John Innes Community Recreation Centre Replacement

Open House

June 20, 2022

5:30 – 8:00 PM



Land Acknowledgement

We acknowledge the land we are meeting on is the traditional territory of many nations including the Mississaugas of the Credit, the Anishnabeg, the Chippewa, the Haudenosaunee and the Wendat peoples and is now home to many diverse First Nations, Inuit and Métis peoples. We also acknowledge that Toronto is covered by Treaty 13 with the Mississaugas of the Credit.



Goals for this Meetin

- Provide an update on **Moss Park** park Improvements & **John Innes Community Recreation Centre Replacement** project
- Provide some background and context for the project
- Present draft principles and big moves



Agenda



Introductions



Project Background

Park Improvements

Community Recreation Centre Redesign

Engagement and what we have heard to date

(Questions of clarification)



Draft Principles and Big Moves

thank
you!

Next Steps + Adjourn



Project Team



Daniel Fusca, Manager, Public Consultation, Parks, Forestry & Recreation

Pablo Muñoz, Senior Public Consultation Coordinator, Parks, Forestry & Recreation

Suzanne Cooke-Wooland, CP Capital Lead, Parks, Forestry & Recreation

Nancy Chater, CP Capital Lead, Parks, Forestry & Recreation



Nadia Galati, Principal and Engagement Lead

Trina Moyan Bell
Indigenous Engagement Lead

Dr. Alex Abramovich
Strategic Advisor



David Leinster, Principal, Landscape Architecture

Jennifer Williamson,
Project Manager, Landscape Architecture



Brian Porter, Principal

Matthew Hickey,
Partner



Chris Burbidge,
Principal in Charge

Krista Clark,
Project Manager,

Viktors Jaunkalns,
Design Lead,



Project Background

Timeline and Context

Policies and Strategies



City Planning

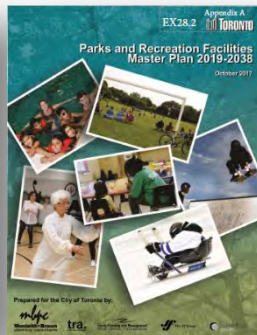

Parks and Facilities



Social Policies



Public Health
Overdose Prevention and
Response



Commitments
with Indigenous
Communities

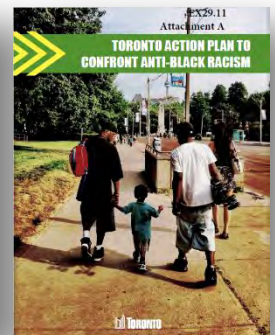

Commitments with
Black, African and
Caribbean
Communities

Project Timeline

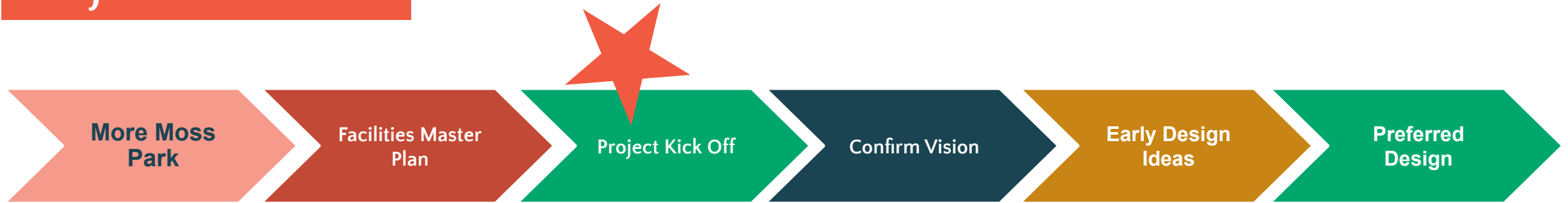

2015: Initial reimagining of Moss Park began as a partnership between the City of Toronto, The 519 and a philanthropic partner. Engagement and feasibility study conducted.

Report Released

Report included engagement with 2,500 people and a feasibility study. **Project deemed not feasible.**

2019: City Council adopts the implementation strategy for the Parks & **Recreation Facilities Master Plan** with amendments

TODAY: The City is analyzing what's been done to date, and is getting ready to listen and gather more local ideas and experiences. The project is led and funded by the Parks, Forestry and Recreation department within the City of Toronto.

Summer to Fall 2022
Confirm the community's visions

Fall 2022 – Spring 2023
Develop and present conceptual designs for feedback

Winter – Spring 2023
Finalize designs and approvals

Construction

Spring 2024
Procurement of construction services

Summer 2024 to Fall 2027
Construct community recreation centre

Spring 2027 to Fall 2029
Park construction

Project Context

2016: More Moss Park

Who

Partnership between The 519 and The City of Toronto

What

- Redevelop John Innes Community Recreation Centre
 - Social services co-located within the building
 - Proposed relocation of C.R.C.
 - Redevelop Moss Park Arena
- Improve the park space around them

Goals

Improve facilities, programs and services, and create new buildings and spaces that are welcoming, equitable and accessible for all.

NOTE: This project only reached the feasibility study and engagement phases.

2021: Moss Park Improvements & John Innes C.R.C. Redevelopment

Who

The City of Toronto Parks, Forestry and Recreation Division

What

- Redevelop John Innes Community Recreation Centre
 - Focus on recreation rather than social services
 - New building has a smaller footprint than 2016 feasibility study design, but a larger footprint than the current building
- Remodelling of exterior of Moss Park Arena
- Extensive improvements to Moss Park

Goals

Build on learnings from the More Moss Park process to improve facilities, programs and services, and to create new buildings and spaces that are welcoming, equitable and accessible for all.

Key Project Components

Major Park Improvements

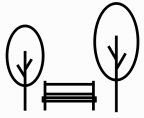

Extensive park improvements with passive and active recreation amenities



Supporting equity-deserving groups in park and recreation programs



Integrate Indigenous placekeeping elements

New Community Recreation Centre



Double gym



2 Pools



Multi-use community space

Upgrades to Arena



Exterior Upgrades

PUBLIC ENGAGEMENT: Every project component will be shaped by the public input collected through the process.

What is Open for Influence

What will be included:

COMMUNITY RECREATION CENTRE (C.R.C.)

- A 25-metre 6 lane lap pool
- A leisure/tot pool
- Community, multi-use space
- double gymnasium with a mezzanine running track
- Fitness studios
- Dance studio
- Common & administrative areas, including a large Lobby
- WIFI access throughout
- Gender-neutral washrooms and change rooms
- A green roof or rooftop community access – to be determined
- Service spaces

PARK

- Passive & Active Recreation Amenities including playground, splash pad, community gardens, walking paths, other features TBD such as tennis, basketball etc.
- Safety – sight lines, lighting, animation to create more eyes on the park
- Flexible, multi-use spaces for different activities
- Consider Food security & urban agriculture
- Indigenous Place-keeping elements
- Input from local Indigenous communities
- Enhance ecological and social sustainability and resilience of the park
- Broader connectivity to parks and public realm network

What we can collaborate on:

COMMUNITY RECREATION CENTRE (C.R.C.)

- Opportunities for the included program in the Community Recreation Centre, such as program interrelationships, flexibility of uses, and relationships to the park
- Community multi-purpose room(s) features and uses
- Lane pool features and uses
- Leisure/tot pool features and uses
- Rooftop features and uses
- Lobby features and uses
- Program adjacencies
- Opportunities for key safety features, such as sight lines, visibility, and views

PARK

- Opportunities for park improvements, including seating & gathering areas
- Opportunities for recreation amenities, such as playground, splash pad, community garden, walking paths, tennis, basketball, etc.
- Indigenous placekeeping (to be discussed with local Indigenous communities)
- Opportunities for key safety features, such as sight lines & lighting
- Selection of initiatives to support food security and urban agriculture
- Initiatives to support ecological & social sustainability & resilience of the park

Moss Park park improvements

Timeline

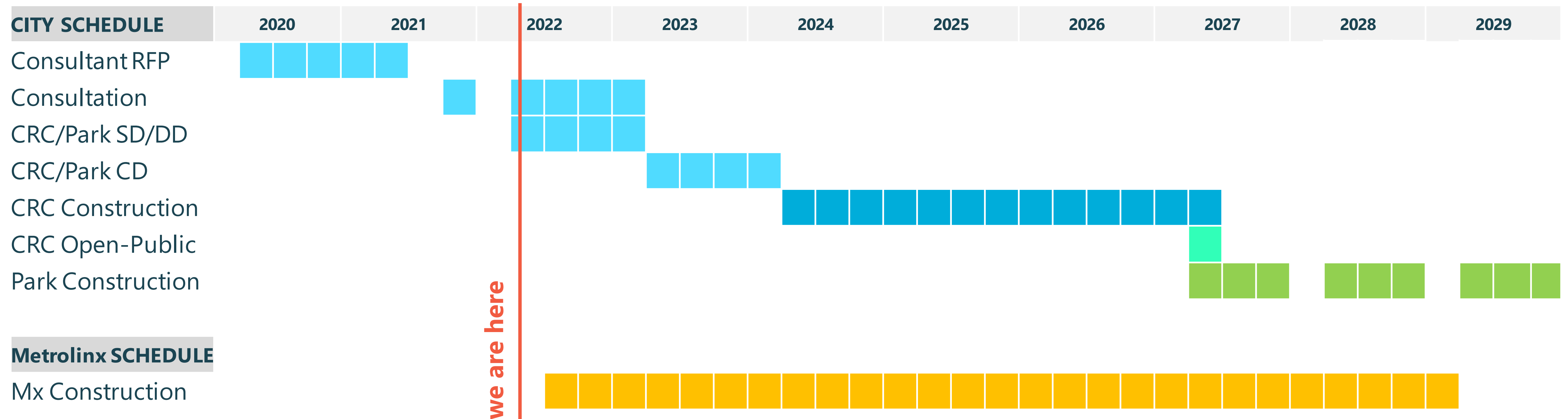

Staging Plan

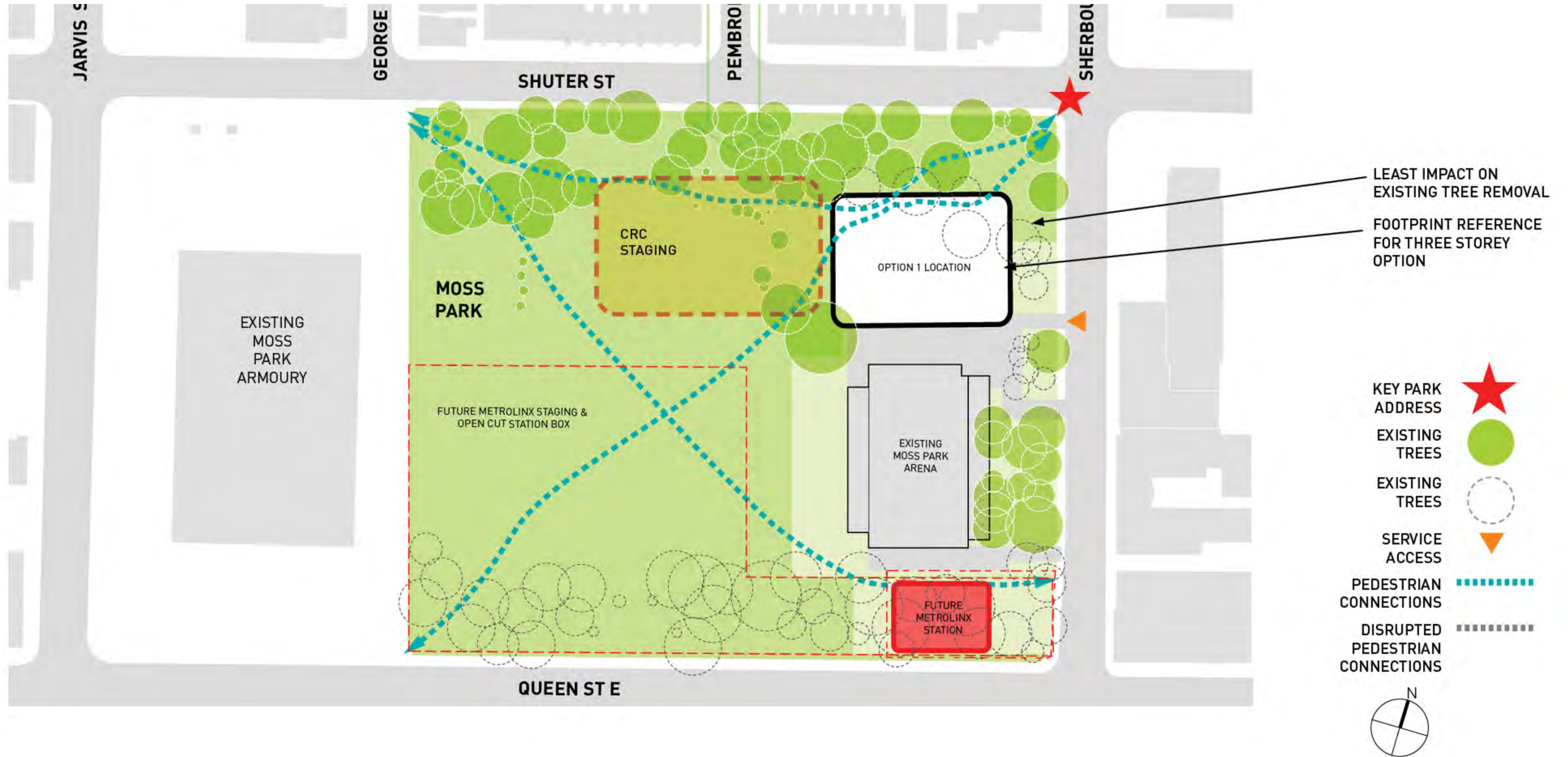

Site History

Indigenous History



Indigenous History

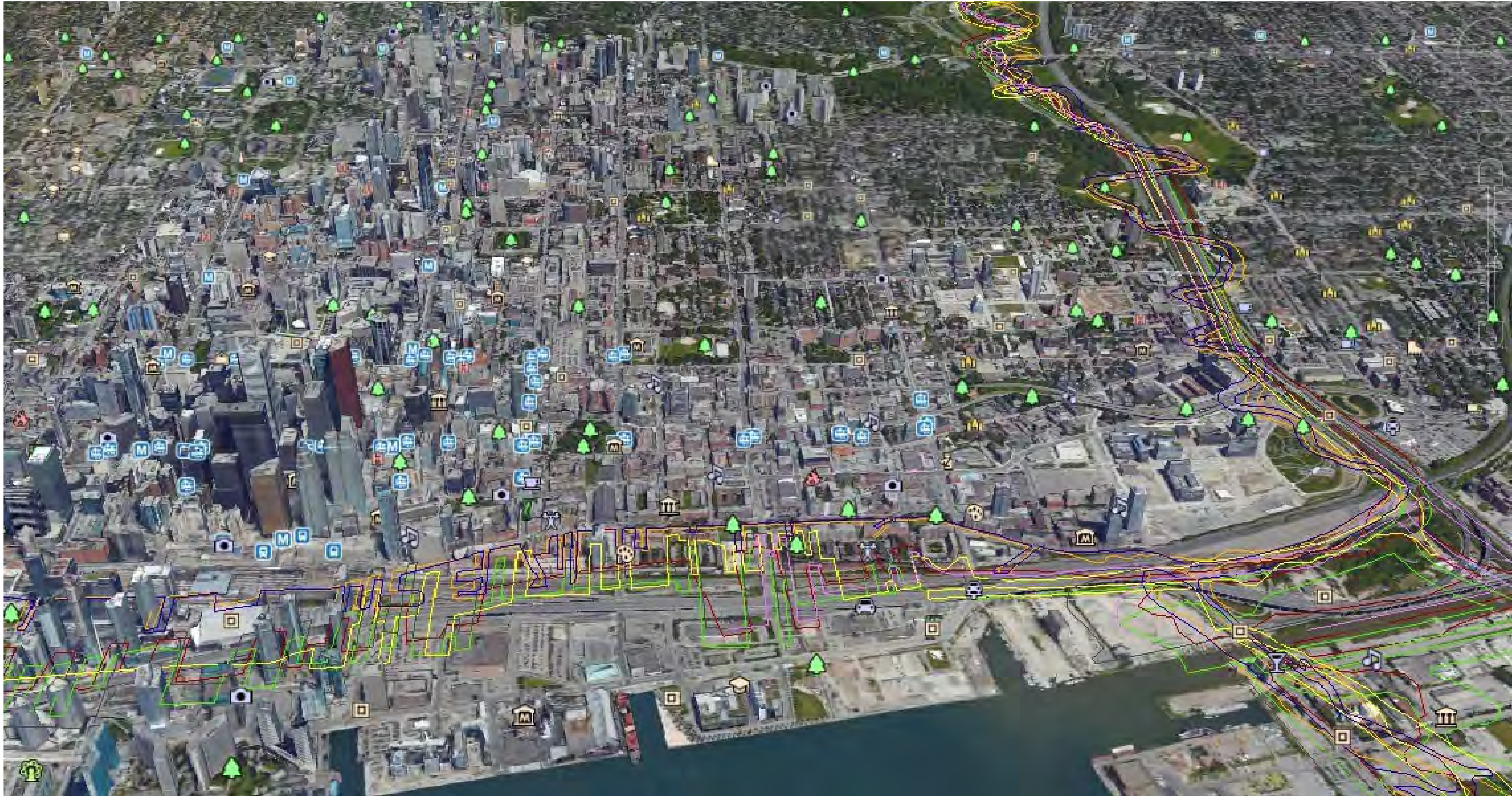

Contemporary Urban Indigenous

- Indigenous Anishnawbe Health Toronto
- Miziwi Biik
- Nishnawbe Homes Inc.
- Council Fire
- Toronto Aboriginal Support Services
- Native Canadian Centre Of Toronto
- Native Child And Family Services Toronto
- Ontario Federation Of Indigenous Peoples
- Aboriginal Business Resource Centre
- Aboriginal Legal Services
- Native Women's Resource Centre
- Ojibikaan Indigenous Cultural Centre
- First Nations House
- Metis Training Initiatives
- Wigwamen Housing
- Urban Indigenous Education Centre

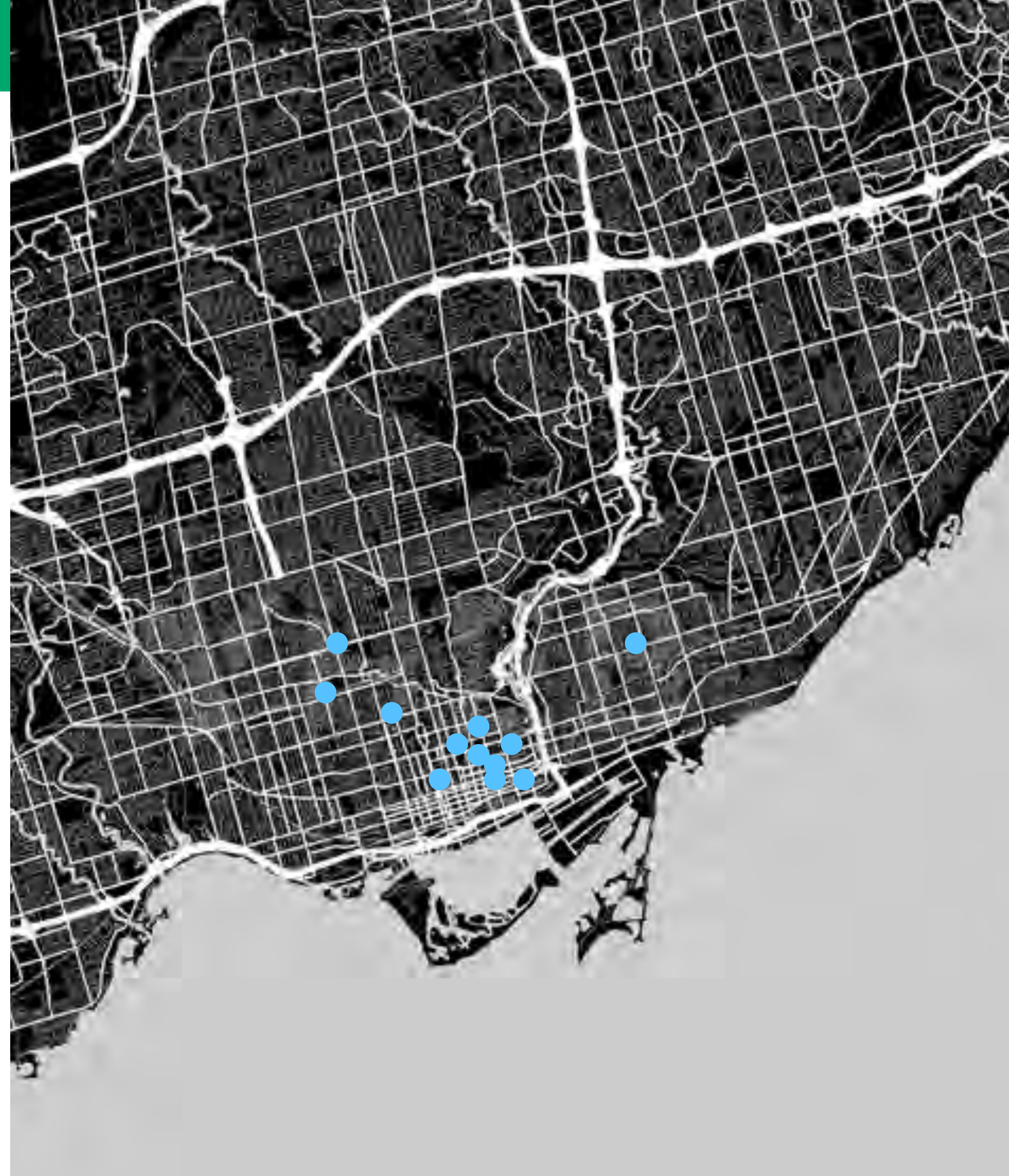

Post-Contact History



1842



1926



1931

Planning & Policy Context

Planning & Policy Context

DOWNTOWN PARKS & PUBLIC REALM PLAN (2018)

The Garden District

Revitalize the Garden District Park District by connecting the discrete parks, streetscapes and open spaces into a coherent whole including integrating and celebrating the area's heritage character and promoting community life.



CONCEPTUAL RENDERING



The Garden District, Proposed Concept

GARDEN DISTRICT HERITAGE CONSERVATION DISTRICT PLAN (2021)



- The relationship of Moss Park to the Garden District as its southern landscaped terminus connected to Allan Gardens shall be conserved
- Views along Pembroke Street looking northward from Moss Park to Allan Gardens and looking southward from Allan Gardens to Moss Park shall be conserved.
- The historic Moss Park Creek (its alignment and topography), First Nations land uses and the historic Moss Park Estate should be commemorated.

Metrolinx Project - Ontario Line (2022-2029)

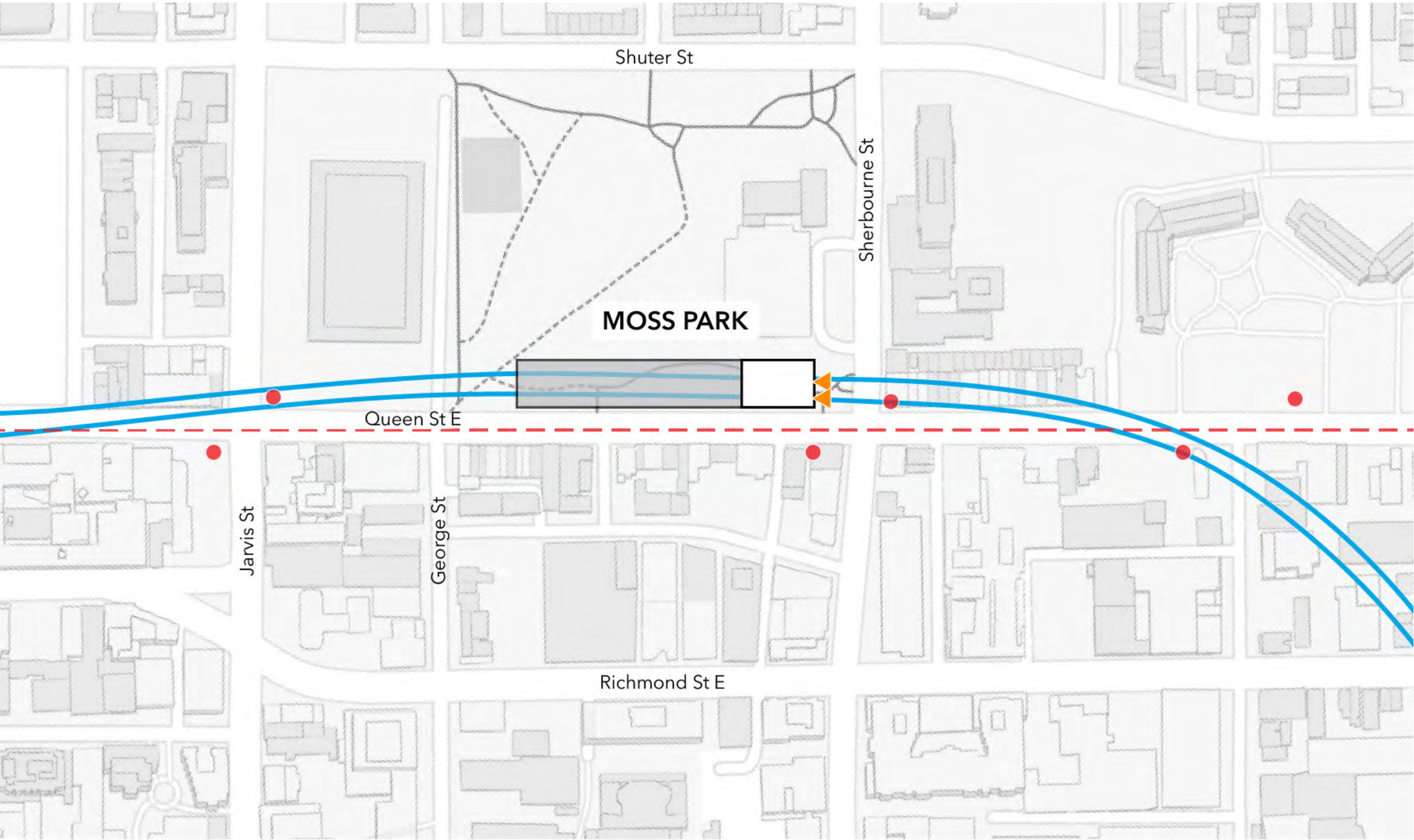

Moss Park Station

- Tunnelled
- - - Streetcar Line
- Streetcar Stop
- ▲ Station Entrance
- Station Building
- ▒ Underground Station Area

Note: Heritage attributes will be conserved where possible.

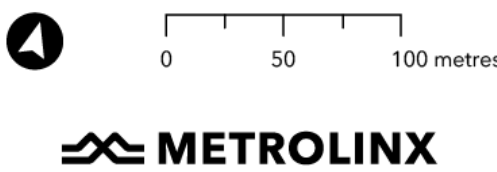

Reconciliation Action Plan (2022)



2022-2032 Reconciliation Action Plan



Re: AA12.5

Our Common Grounds

Incorporating Indigenous place-making in
Toronto's parks and public realm



Early Observations

Moss Park - Quick Facts

2.7
hectares
(6.7 acres)

175 x
200
metres



Map of Parks in the Area



Park Amenities in the Area

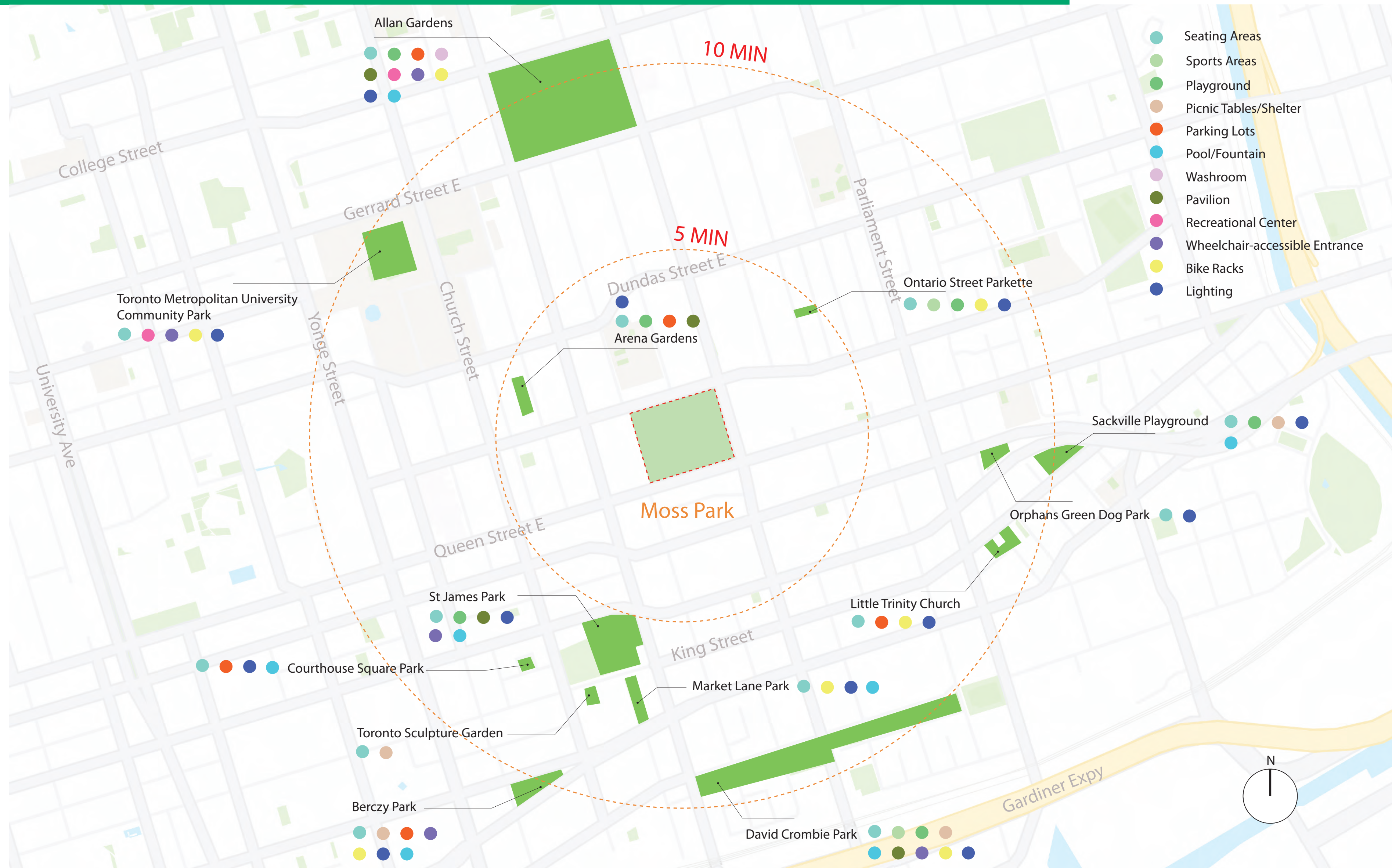

Off Leash Areas

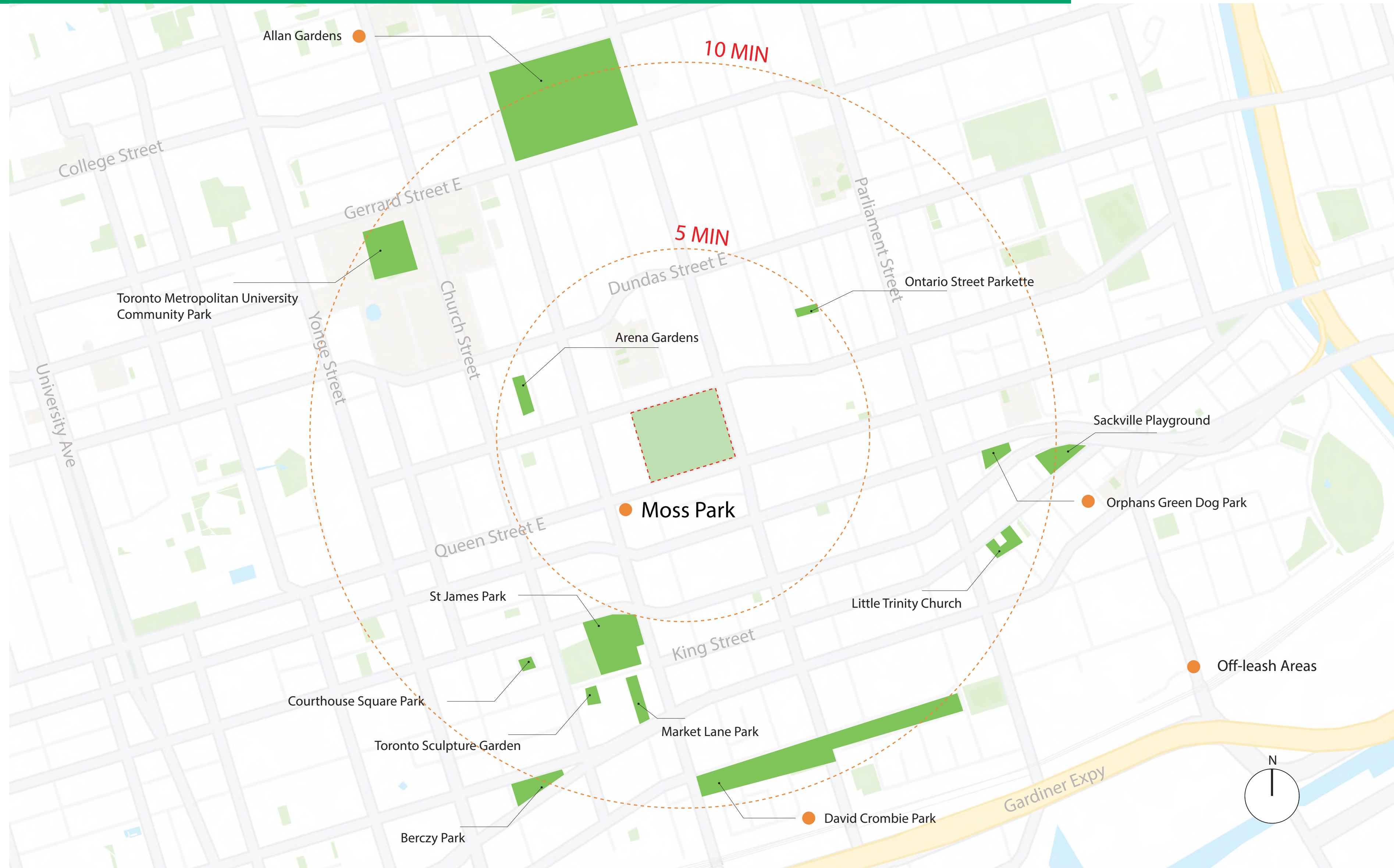

Community Gardens



Early Observations



- Entry feature at the corner of Shuter and Sherbourne



- Strong visual connection to residential edge



- Visual and physical connection to Pembroke Street green corridor



- Existing mature trees along Shuter Street

Important Considerations for One of the Big Moves in the Park

Potential Park Amenity Relationships

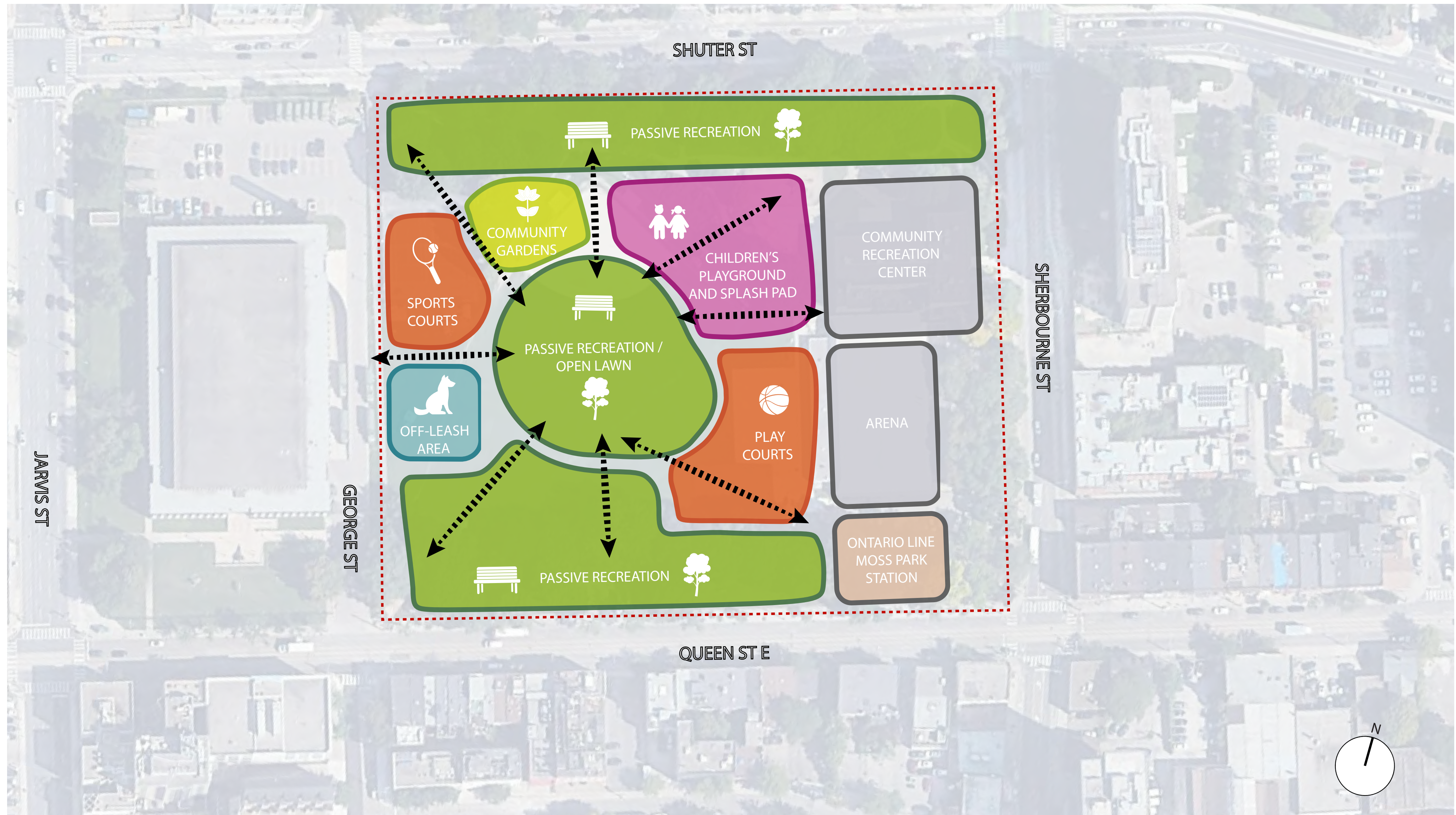

Potential Circulation

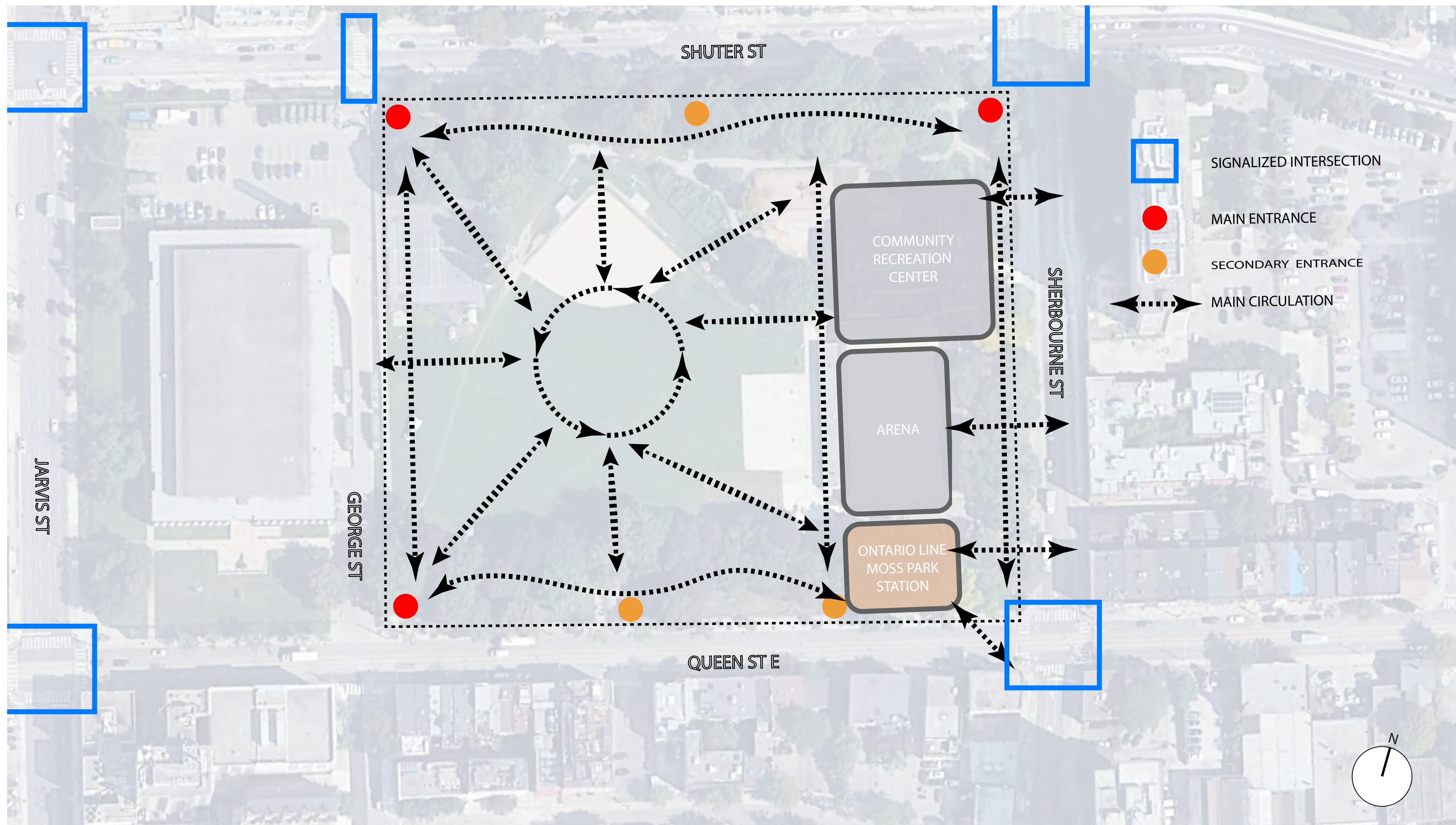

Baseball Diamond Relationships

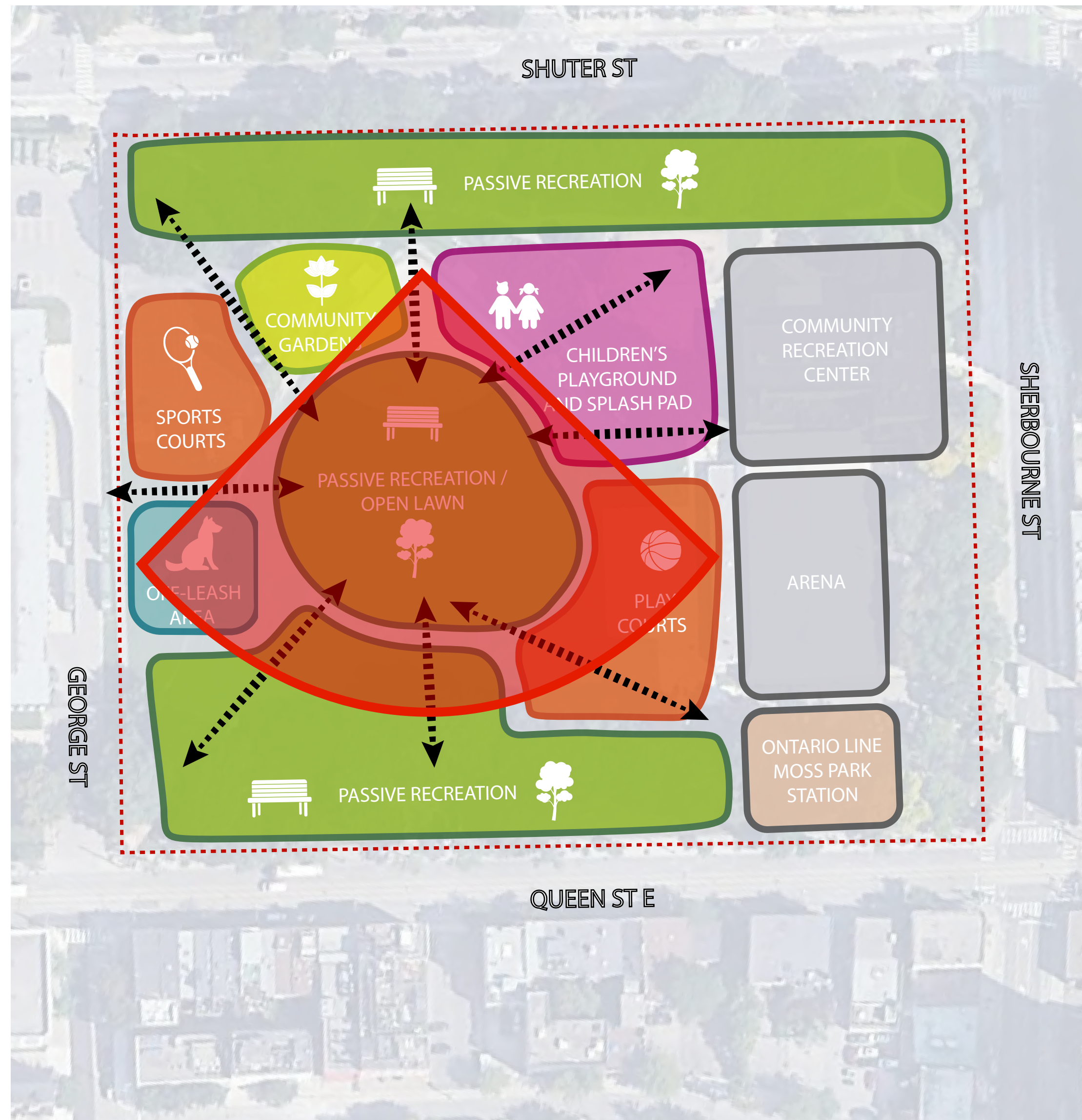

- The baseball field generated a mixed response during previous consultation
- Some local residents use it regularly, including a league organized by the City in partnership with local social service agencies
- Current permit users notes it is less than regulation size, and that they get interrupted by people walking through the park. They are considering playing elsewhere.
- We've heard that night time activation is valuable as a safety feature

Baseball Diamond Relationships

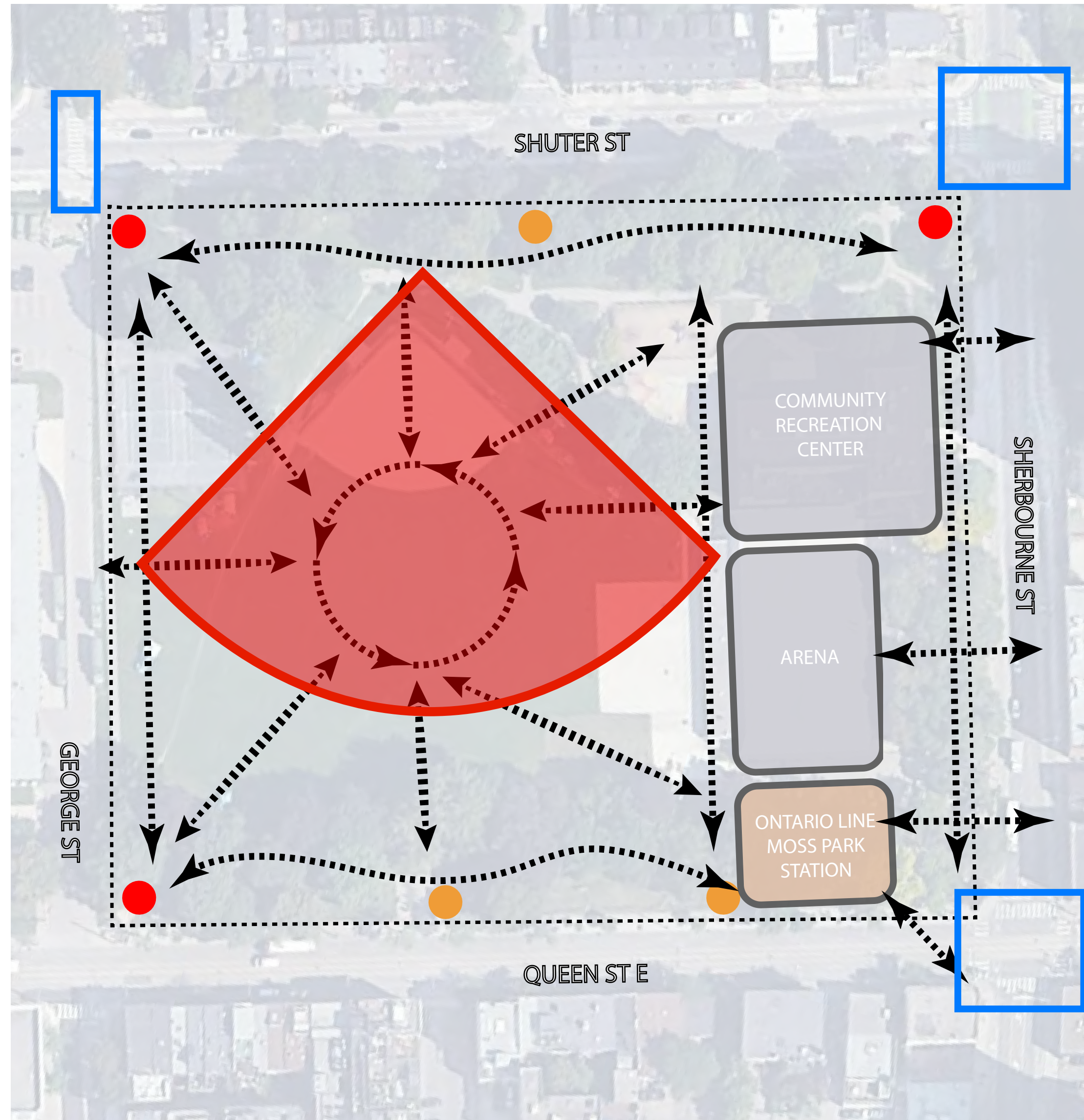

- The baseball field generated a mixed response during previous consultation
- Some local residents use it regularly, including a league organized by the City in partnership with local social service agencies
- Current permit users notes it is less than regulation size, and that they get interrupted by people walking through the park. They are considering playing elsewhere.
- We've heard that night time activation is valuable as a safety feature

John Innes Community Recreation Centre Replacement



DENIAL IS NOT POLICY

#ARCHITECTS DECLARE
#CLIMATEACTIONNOW
#NOTBUSINESSASUSUAL

DROP THE FACADE

#ARCHITECTS DECLARE
#CLIMATEACTIONNOW
#NOTBUSINESSASUSUAL

**This isn't POLITICS
It's SURVIVAL**

#ARCHITECTS DECLARE
#CLIMATEACTIONNOW
#NOTBUSINESSASUSUAL

**THIS ISN'T POLITICS
IT'S SURVIVAL**

**THERE IS NO
PLANET B**

NOT
AS USUAL

#ARCHITECTS DECLARE
#CLIMATEACTIONNOW

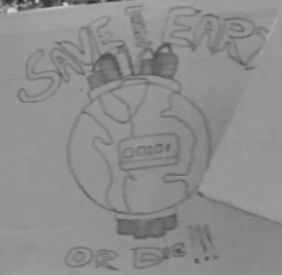
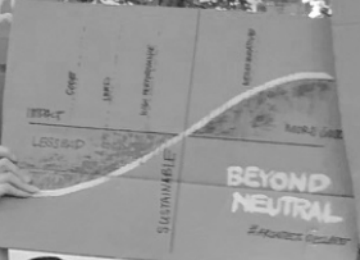

**WE NEED
CONCRETE**

#ARCHITECTS DECLARE
#CLIMATEACTIONNOW
#NOTBUSINESSASUSUAL

**DESIGN
like you
GIVE A DAMN**

**NOT BUSINESS AS
USUAL**

#ARCHITECTS DECLARE
#CLIMATEACTIONNOW

**WE NEED A
CONCRETE PLAN**

DROP THE FACADE

#ARCHITECTS DECLARE
#CLIMATEACTIONNOW
#NOTBUSINESSASUSUAL

**DESIGN LIKE
YOU
GIVE A DAMN**

#ARCHITECTS DECLARE
#CLIMATEACTIONNOW
#NOTBUSINESSASUSUAL

MJMA
ARCHITECTURE & DESIGN











BUILDING LOCATION

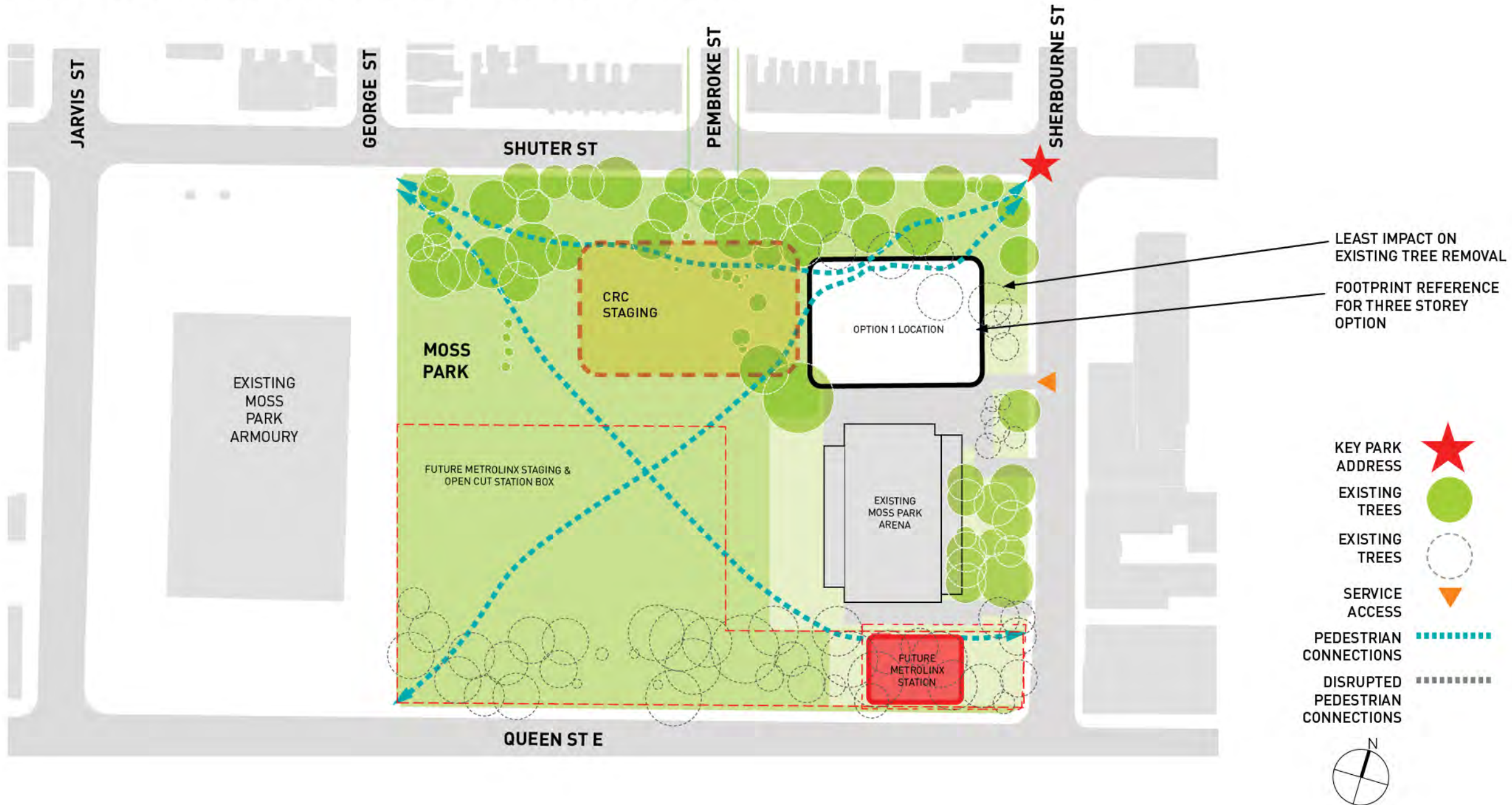

AQUATICS



ABOVE GROUND LEVEL
LOCATION



✓ GROUND
LEVEL

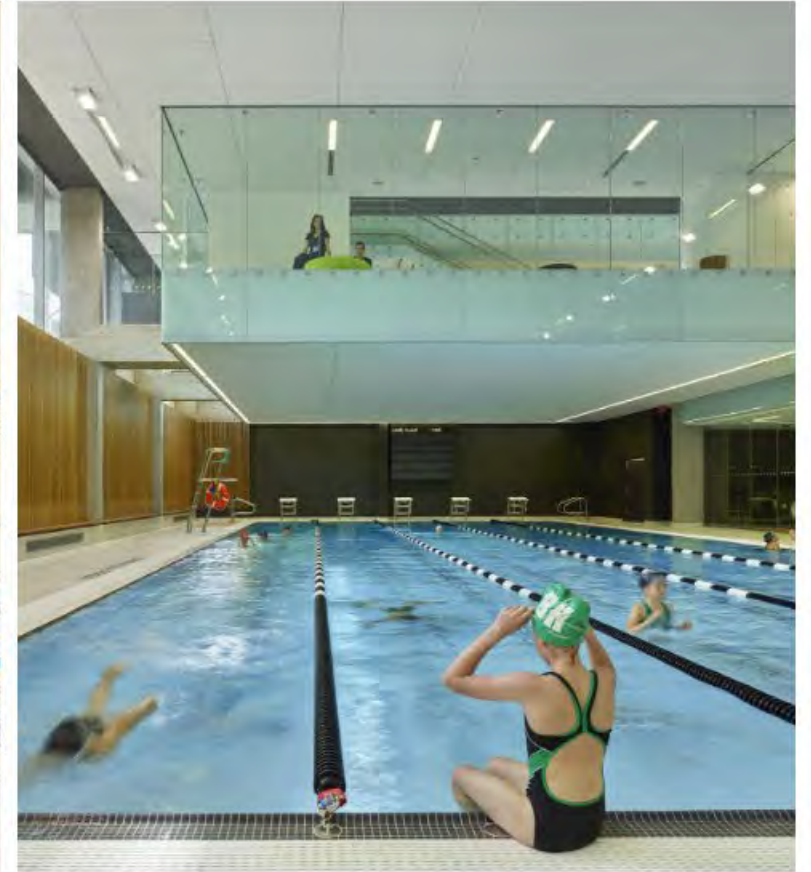

BELOW GROUND LEVEL
LOCATION

GYMNASIUM



✓ ABOVE GROUND LEVEL
LOCATION



GROUND
LEVEL

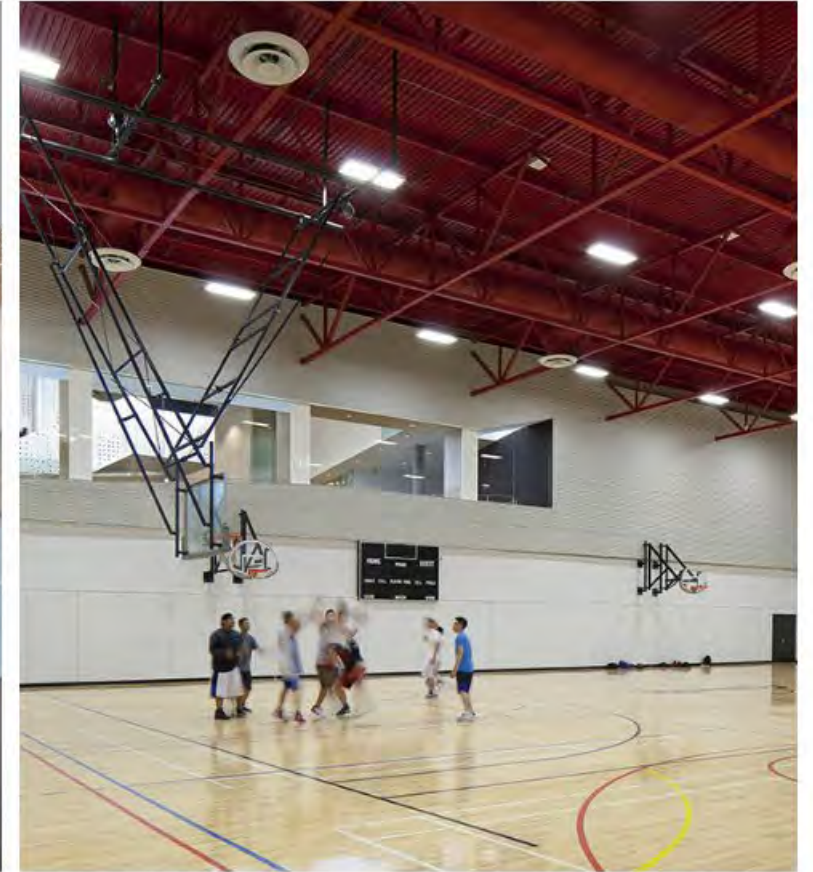

BELOW GROUND LEVEL
LOCATION

STACKED PROGRAM

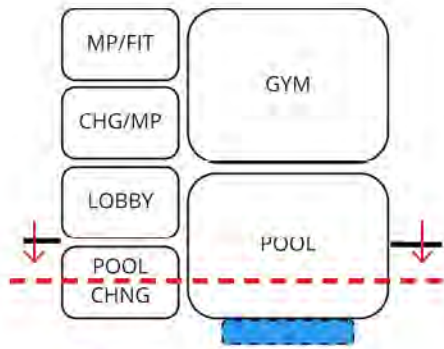

✓ **Option 1**
Revise to include Pool at grade or slightly below.

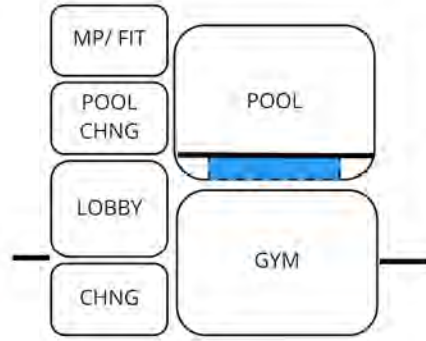

Option 2

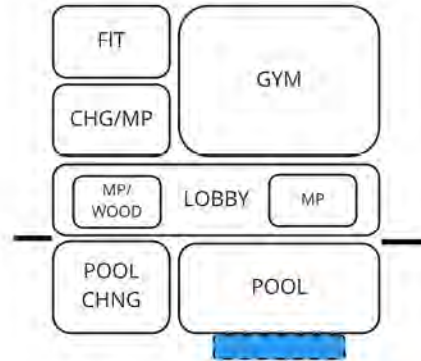

Option 3

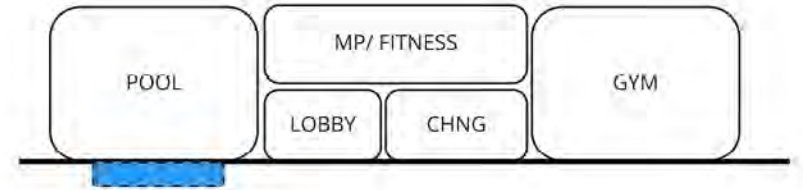

Option 4

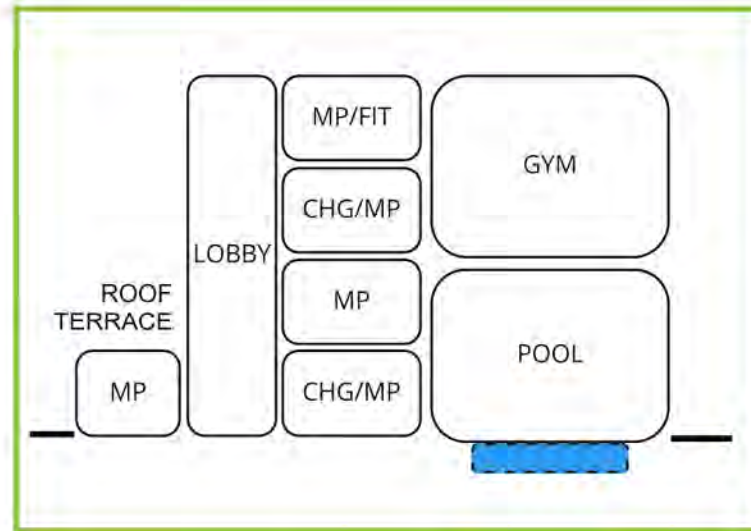

✓ **Option 1**
Revised
Pool & Multi-Purpose at Grade

AQUATIC FEATURES & PROGRAMMING



GYM & FITNESS PROGRAMMING

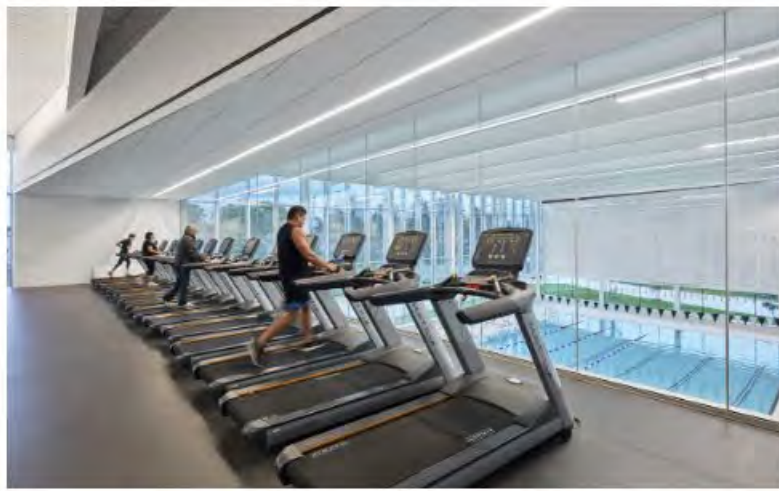

MULTIPURPOSE ROOM PROGRAMMING



What We've Heard to Date

Key Insights So Far

- Overall **enthusiasm** about facilities and park redevelopment.
- Interest in how the redevelopment can balance the needs of **local residents and regional users**.
- Concern about **disruption and displacement** of services during construction.
- **Food security** should be an important consideration and is an opportunity for community-building.
- Desire for a **more open and accessible** park and C.R.C. that is welcoming to everyone.
- Desire for more **flexible, multi-use spaces** for different activities.
- **Safety is a priority for everyone** including that of vulnerable populations such as those experiencing homelessness.
- Redevelopment must continue to include **Indigenous people and organizations** to shape the program design moving forward.
- **Current park users** should **feel welcome** and able to use the park and Community Recreation Centre in the future.
- **The engagement process needs to be proactive**, actively and regularly reaching out to public and stakeholders via email and other appropriate channels.
 - This includes reaching out to unhoused communities and Indigenous communities in appropriate ways.



What Will Make this Project Successful?

The Park and Community Recreation Centre will serve as a **gathering place** for an array of people, communities and experiences.

The project will be a success if the **diversity of community members** who use the Park and Community Recreation Centre today as well as future community members – feel interested, **welcome**, and **safe** to use these amenities in the future.



How People Will Shape the Project

How public, rights holders and stakeholders' participation and input will shape the future of Moss Park and the John Innes C.R.C.

Engagement Goals

1. Equity-focused, trauma-informed, and collaborative
2. Deliberative, transparent and creative
3. Communicative and grassroots
4. Digital and 'in-person'
5. Flexible and Open



Anticipated Public Engagement Timeline

1 SET THE STAGE

2021 to Summer 2022

Introduce the project, explain the process and lay the project groundwork.

Engagement Activities

- Stakeholder Interviews

2 CONFIRM THE VISION

Summer 2022

Revisit More Moss Park findings and explore how things have changed since 2015. Better understand evolving local issues and how the project can best support local needs. Confirm the project Vision, Principles, and Big Moves.

- Indigenous Engagement: May 2022 onwards
- Project Champion Meeting #1: June 13 2022
- Local Advisory Group (L.A.G.) Meeting #1: June 13 2022
- Public Meeting: June 20 2022
- L.A.G. Meeting #2: Aug. 2022
- Project Champions Meeting #2: Aug. 2022
- School Engagement: Sept./Oct. 2022
- Pop-ups: Sept./Oct. 2022

3 EARLY DESIGN IDEAS

Fall 2022 to Spring 2023

Use what we learn in Phase 2 to start developing ideas for park amenities and concepts for the new C.R.C. (i.e., entrance locations, etc.). Review ideas with community and revise ideas based on feedback.

- Project Champions Meeting #3: Oct. 2022
- LAG Meeting #3: Oct. 2022
- Indigenous Engagement: ongoing
- School Engagement: Jan./Feb. 2023
- Pop-ups: March/April 2023
- Public Open House: April 2023

4 FINAL DESIGN

Spring 2023

Work on plans and designs for Moss Park and the John Innes C.R.C.. Review ideas with the community and revise plans and designs based on feedback.

- Project Champions Meeting #4: March 2023
- LAG Meeting #4: March 2023
- Indigenous Engagement: ongoing
- Public Open House: May 2023

ONLINE ENGAGEMENT THROUGHOUT: Project website, online surveys, local communications campaign, project newsletters, etc.

Design will respond to what is learned through engagement

Set the Stage

Confirm the Vision

Early Design Ideas

Final Design

Moss Park Community

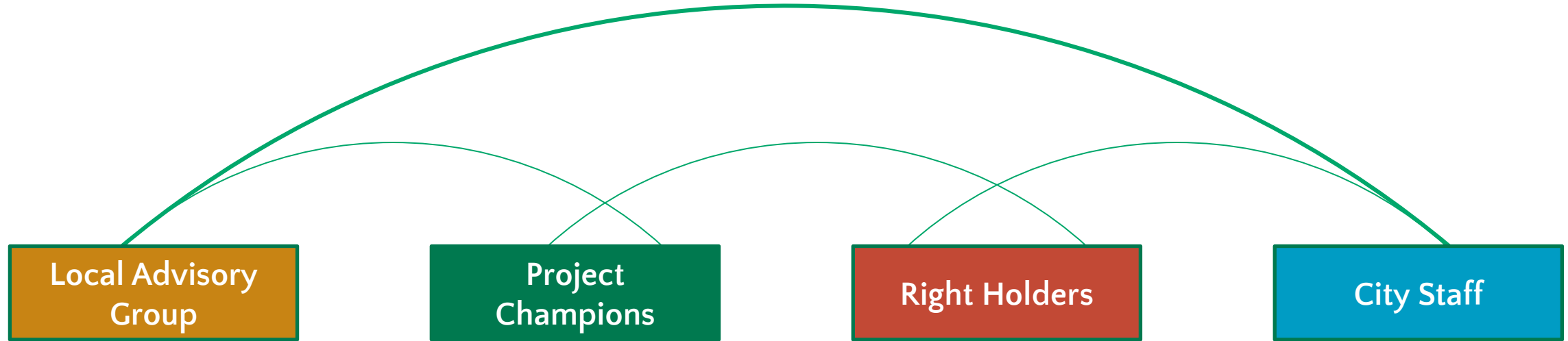

Local stakeholders including residents, members of nearby businesses, service providers, community groups and organizations operating within the vicinity of the park.

Champions are community leaders that will help us connect with communities who are often not included in formal planning processes for example, people experiencing homelessness, communities for whom English is not their first language, single parents and/or youth.

The project team will share project updates and consult with local right holders at every phase of the project.

City staff will advise the project, ensure that the ideas explored are feasible, as well as ensure that the project aligns with broader initiatives and strategies.

Local Advisory Group

Join the Project Team! (Applications Close May 20th)

Join the Local Advisory Group - Honoraria Available

The project team is looking for ten to twenty community members, including residents, small business owners, service providers and community groups to advise the project and share their expertise about their neighborhood. Members will be selected through a modified civic lottery to ensure the team is representative of the community.

Become a Project Champion - Paid Opportunity

Eight to ten community leaders, with strong relationships to Moss Park, will be selected to join the project as Champions. The champions will help engage and gather insights from communities who are often left out of consultation processes, including people experiencing homelessness, children and youth and immigrant and refugee communities.

Take part in a Design Mentorship - Honoraria Provided

Take part in a youth-led design project! 1 to 3 youth (13 - 18) community members will work with a youth artist on the project team to help develop an art or design component of the project. Youth Designers/Artists don't need to have professional experience, but should have a passion for art or design!

Apply before May 20th, 2022

To submit your application for any of these opportunities scan the QR code or visit:

[toronto.ca/Moss Park](https://toronto.ca/MossPark)



Contact

For more information about the project or applications, or if you require accessibility accommodations in order to participate, please contact:

Pablo Muñoz

Senior Public Consultation Coordinator

437.220.5975 | pablo.munoz@toronto.ca



Call 311



9,700+
invitations sent within
1 km of site



29,000
of people within 1 mile of
site who saw a social
media ad



58
Volunteers from the
community



17
People selected

RESIDENT MEMBERS (17)

Gender Identity

■ Male ■ Female ■ Non-Binary/Trans ■ 2 Spirit

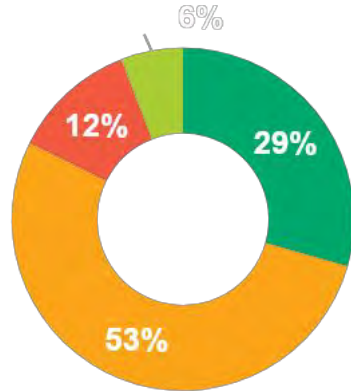

Racial Identity

■ Person of colour ■ White

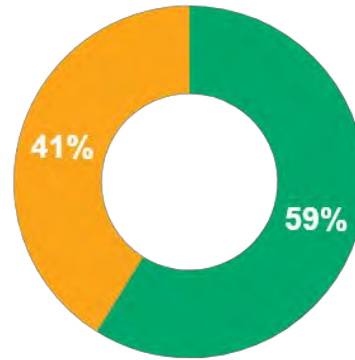

Age Ranges

■ 19-29 ■ 30-55 ■ 56+

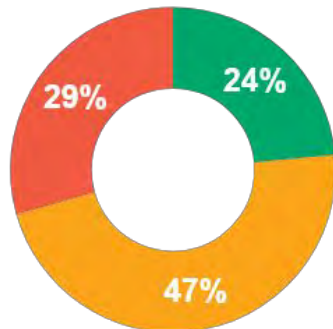

ORGANIZATIONS REPRESENTED

- Garden District Residents Association
- Sojourn House
- Building Roots
- Metrolinx Community Liaison Committee
- Walk Toronto

...and more organizations to be added soon.

Project Champions

- Project Champions are paid community leaders with strong relationships with Moss Park. The team of champions will help engage and consult park and community recreation centre users and gather their insights for the project.
- The goal of the champions is to connect with communities who are often not included in formal planning processes for example, people experiencing homelessness, communities for whom English is not their first language, single parents and/or youth.
- Currently there are 4 Project Champions, with more to be added in the coming weeks.

Indigenous Engagement

Trina's engagement process is grassroots, flexible, and rooted in relationship building. It will adapt as she learns more from those she speaks with. All conversations will be paid.

Local Service Providers & TASSC

Trina will start by speaking to local agencies and grassroots organizations providing services to Indigenous communities.

She will invite these agencies to join the Local Advisory Group (LAG), the Project Champions, or the Youth Designer / Artist role.

She will build relationships and ask these agencies to connect her with Local Indigenous residents with lived experience of the Park and area.

Local Residents

Trina will spend time in the Park and area, connecting with local Indigenous residents and facilitating one-on-one conversations about the Project.

Treaty holders

While Trina's process is ongoing, City of Toronto staff will consult treaty holders.

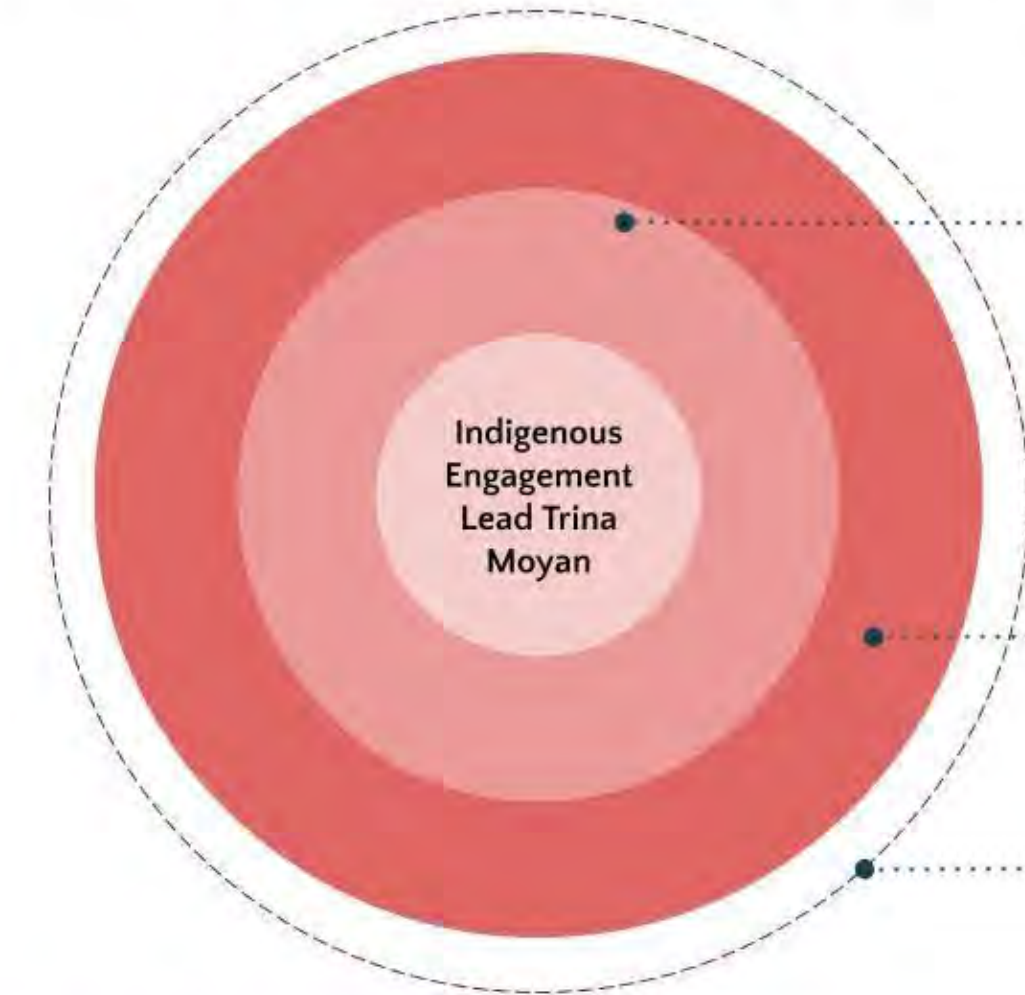

Design will respond to what is learned through engagement with Indigenous communities

Set the Stage

Confirm the Vision

Early Design Ideas

Final Design

Questions?

Draft Principles and Big Moves (breakout rooms)

Draft Design Principles

1. Ensure the design of the C.R.C. and park supports equity, belonging and inclusion.
2. Ensure the C.R.C. and Park are accessible to all.
3. Create a space that makes safety for all users a priority.
4. Design an open, permeable and transparent environment.
5. Maximize, enhance and improve green spaces.
6. Celebrate and share information about the Indigenous history and character of Moss Park.
7. Contribute to food security.
8. Be sustainable and carbon-neutral.



Preliminary Big Moves

1. **Maintain** a large area of open parkland with **frontages onto Queen and Shuter** by building the new C.R.C. along Sherbourne St, over the existing footprint.
2. **Establish a cohesive design language** between the C.R.C. and the Arena and a strong relationship between both buildings and the future Moss Park subway station.
3. Optimize opportunities **for rooftop access** to the new C.R.C.
4. Incorporate spaces for **prayer and ceremony**.
5. Ensure **washroom access from the outside** of the building.
6. Create a new **urban gateway** at Queen and Sherbourne.
7. Integrate **Indigenous placekeeping** throughout the park.
8. Establish a **renewed urban canopy of trees** on Queen Street to match the Shuter edge.
9. Maintain and enhance key **pedestrian pathways** and access points into the park.
10. **Maintain and enhance** existing permeable **park edges** and protect the existing urban canopy along Shuter Street.
11. **Maintain the strong Sherbourne St. urban built-edge** and enhance the relationship between the C.R.C./Arena/Park and Metrolinx Station with improved visual and physical connectivity and accessibility.
12. Remove the **baseball diamond** to accommodate a wider range of park uses.
13. **Add a fenced, dedicated dogs off leash area** to park to support growing number of residents with dogs in the intensifying neighbourhood, and to protect other park amenities and park users from conflicts with dogs.



Thank you!