

Moss Park park Improvements & John Innes Community Recreation Centre Replacement Project

SUMMARY REPORT: Public Meeting #2

October 20, 2022



Table of Contents

1.0 Introduction	4
1.1 Project Context	5
1.1.1 Project Goals	5
1.1.2 Key Project Components	8
1.1.3 Project Schedule	9
1.2 About this Report	9
1.2.1 Engagement Timeline	9
2.0 Engagement Overview	10
2.1 Engagement Objectives	10
2.1.1 Engagement Approach	10
3.0 What We Heard	11
3.1 Key Insights	11
3.2 Pre-Engagement Outcomes	12
3.3 Public Meeting #2 Summary	13
3.3.1 Public Meeting Participation	13
3.3.2 Summary of Feedback from Public Meeting #2	13
Appendix A: Design of the Community Recreation Centre and Facilities	16
Appendix B: Miscellaneous Comments & Questions	20

1.0 Introduction

The City of Toronto is leading a redesign of Moss Park and replacement of the 70-year-old John Innes Community Centre. The goal is for these spaces to serve the current and future needs of all of the diverse Moss Park community including vulnerable and equity-deserving populations in the area, the many new community members, and support the population growth in the area.

The redesigned Park and Community Recreation Centre will serve as a gathering place for an array of people, communities, and experiences.

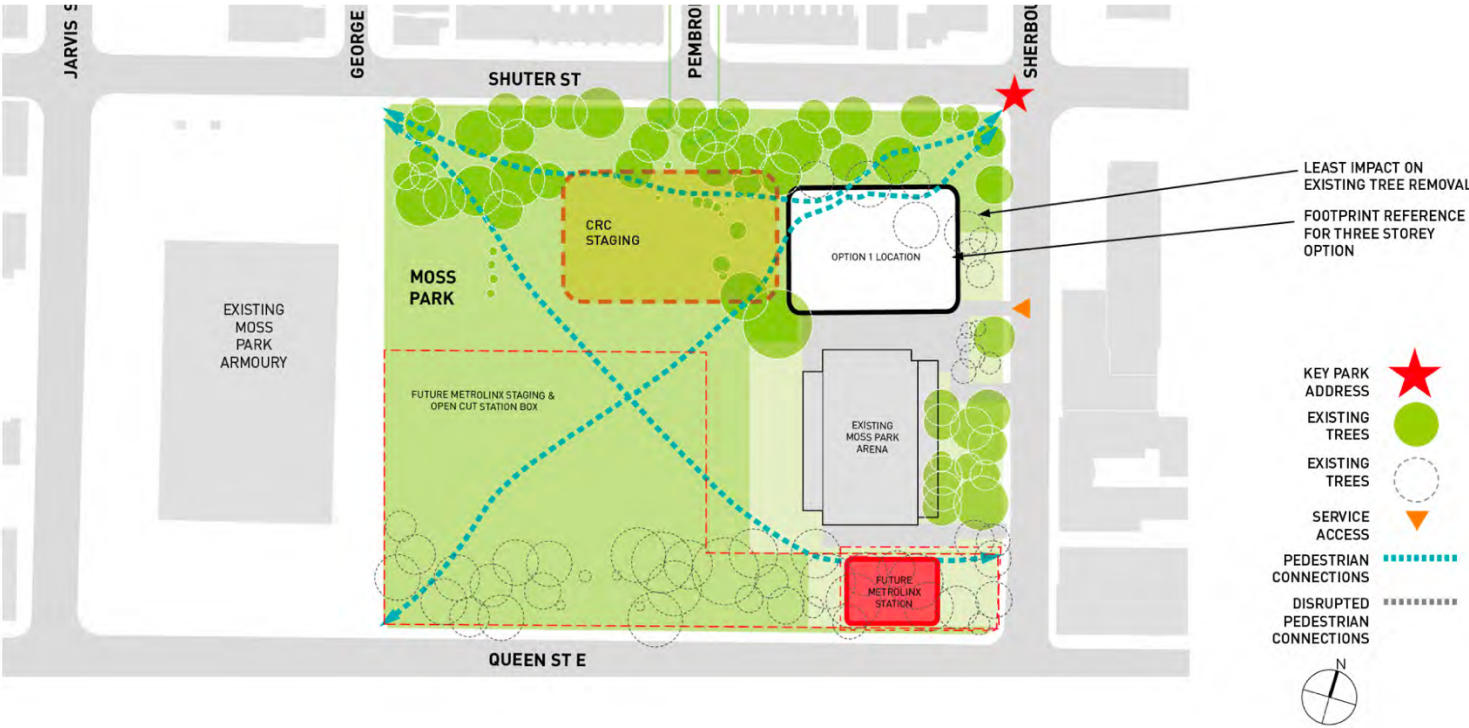

FIGURE 1: Map of the proposed location of the new Community Recreation Centre in Moss Park

1.1 Project Context

In 2015, the project *More Moss Park* aimed to redevelop the park and replace the community recreation centre with a new facility that centered LGBTQ2s+ communities and expanded the services offered. The project was a partnership between the 519 and the City of Toronto. In 2016 the project was deemed not feasible and it was determined that it would not move forward. The community and stakeholder engagement program for More Moss Park was extensive. The scope of the current *Moss Park Park* Improvements and John Innes Community Recreation Centre replacement project are different with the community recreation centre retaining a recreation mandate. However, the insights, knowledge and data gathered through the *More Moss Park* consultation and engagement laid the groundwork that this project will build on.

1.1.1 Project Goals

Launch a new initiative to replace the John Innes Community Recreation centre with a new Community Recreation Centre and make extensive improvements to the park through a consultation process that is informed by the insights of the *2015 More Moss Park* project, with the following key project goals:

1. Replace the John Innes Community Recreation Centre with a bigger facility that meets the standards set out in the City's Recreation Facilities Master Plan and that can better meet the community's needs.
2. Redesign the park to meet current and future needs.
3. Build on the park's long-standing role as a hub for the diverse communities and people of Moss Park.
4. Ground the project by honouring local communities and by building on the assets of the park and community and the experiences and goals of diverse park users.
5. Build on the input received from the previous *More Moss Park* community consultation process.
6. Deliver an accessible and welcome place for all members of the Moss Park and John Innes Community Recreation Centre community.
7. Work closely with the community throughout the project.

1.1.2 Key Project Components

Every project component will be shaped by public input collected throughout the process. The following is a detailed list of project components, features and opportunities for which the City wants to collaborate with the local community.

Major Park Improvements

- Extensive Park improvements with passive and active recreation amenities
- Support equity-deserving groups in park and recreations programs
- Integrate Indigenous placekeeping elements
 - Opportunities for park improvements, including walking, seating & gathering areas
 - Opportunities for recreation and park amenities, such as playground, splash pad, walking paths, tennis, basketball, dedicated dogs off leash area etc.
 - Indigenous placekeeping (to be identified with Rights Holders and local Indigenous communities)
 - Opportunities for key safety features, such as sight lines & lighting
 - Improve community gardens area in the park to align with initiatives to support food security and urban agriculture
 - Initiatives to support ecological & social sustainability & resilience of the park

New Community Recreation Centre

- Double gym
- 2 Pools
- Multi-use community space
 - Opportunities for the included program in the Community Recreation Centre, such as program interrelationships, flexibility of uses, and relationships to the park
 - Community multi-purpose room(s) features and uses
 - Lane pool features and uses
 - Leisure/tot pool features and uses
 - Rooftop features and uses
 - Lobby features and uses
 - Program adjacencies
 - Opportunities for key safety features, such as sight lines, visibility, and views

Upgrades to Arena

- Exterior Upgrades

CONFIRMED Design Principles

The following eight *Design Principles* serve as guidance to steer the vision of the project. They have been workshopped with public input and confirmed with the public throughout this Phase of the project.

DESIGN PRINCIPLE 1: Ensure the design of the Community Recreation Centre and park supports equity, belonging and inclusion.

DESIGN PRINCIPLE 2: Ensure the Community Recreation Centre and Park are accessible to all.

DESIGN PRINCIPLE 3: Create a space that makes safety for all users a priority.

DESIGN PRINCIPLE 4: Design an open, permeable, and transparent environment.

DESIGN PRINCIPLE 5: Maximize, enhance, and improve green spaces.

DESIGN PRINCIPLE 6: Celebrate and share information about the Indigenous history and character of Moss Park.

DESIGN PRINCIPLE 7: Contribute to food security.

DESIGN PRINCIPLE 8: Be sustainable and carbon neutral.

CONFIRMED Big Moves

The Project team compiled thirteen *Big Moves* that describe priority actions that the City intends to take. They have been workshopped with public input and confirmed with the public throughout this Phase of the project.

BIG MOVE 1: Maintain a large area of open parkland with frontages onto Queen and Shuter by building the new Community Recreation Centre along Sherbourne St., over the existing footprint.

BIG MOVE 2: Establish a strong and cohesive design language between the Community Recreation Centre and the Arena buildings as well as the public realm.

BIG MOVE 3: Optimize opportunities for rooftop access to the new Community Recreation Centre.

BIG MOVE 4: Incorporate spaces for prayer and ceremony in flexible spaces.

BIG MOVE 5: Ensure washroom access from the outside of the building.

BIG MOVE 6: Create pedestrian connectivity to the park, arena and the Community Recreation Centre from the new Moss Park station in anticipation of a large volume of new users.

BIG MOVE 7: Work with local indigenous partners and first nations to ensure that indigenous placekeeping, knowledge, ways of knowing are reflected in the process and design, park improvements and Community Recreation Centre redevelopment.

BIG MOVE 8: Establish a renewed urban canopy of trees on Queen to match the Shuter edge. Wood from trees removed during construction will be used in the project in various ways.

BIG MOVE 9: Maintain and enhance key pedestrian pathways and access points into the park with lighting and sightlines.

BIG MOVE 10: Maintain and enhance existing permeable park edges and protect the existing urban canopy along Shuter.

BIG MOVE 11: Maintain the strong Sherbourne urban built edge and enhance the relationship between the Community Recreation Centre/Arena/Park and Metrolinx Station with improved visual and physical connectivity and accessibility.

BIG MOVE 12: Remove the baseball diamond to accommodate a wider range of park uses.

BIG MOVE 13: Add a fenced, dedicated dogs off-leash area to the park to support the growing number of residents with dogs in the intensifying neighbourhood, and to protect other park amenities and park users from conflicts with dogs.

1.1.3 Project Schedule

- Spring 2021: Procurement of architect and landscape architect design services and community engagement consultant
- Spring/Summer 2022: Community engagement – Building on the Vision
- **Summer/Fall 2022: Community engagement – Early Design Ideas [*WE ARE HERE](#)**
- Winter/Spring 2023: Community Engagement – Preferred Design
- Spring 2024: Hire a construction team
- Summer 2024 to Fall 2027: Community Recreation Centre construction
- Spring 2025 to Fall 2027: Park construction

1.2 About this Report

This meeting summary report, prepared by PROCESS, summarizes the key findings that emerged during the second public meeting, held on October 20, 2022, as part of the Moss Park Park Improvements & John Innes Community Recreation Centre Replacement Project. This report summarizes the feedback and input collected from these engagement activities.

1.2.1 Engagement Timeline

The following is a list of upcoming public engagement activities (schedule is anticipated and subject to change as the project progresses):

Completed:

- Public Meeting #1: June 20, 2022

- Pop-ups throughout the park: Summer 2022
- Public Meeting #2: October 20, 2022

Upcoming:

- Public Meeting #3 - 2023

2.0 Engagement Overview

2.1 Engagement Objectives

The goal of this phase of engagement was to present early design ideas to the public. This includes the design of the aquatic facilities, the multi-purpose rooms and fitness-oriented spaces. Members of the public were also given an update on the pop-up engagement activities that were conducted over the summer. The project team wanted to have a better understanding of evolving local issues and how the project can best support local needs.

2.1.1 Engagement Approach

The engagement process was designed to reach and listen to the general public. The open house was hosted virtually on Webex.

A total of 30 members of the public participated in the open house.

Open House Structure: During the 2.5-hour virtual public meeting, the City of Toronto, PROCESS, The Planning Partnership, Two Row Architect and MJMA Architecture and Design guided participants through a presentation about the park improvements and new Community Recreation Centre as well as a facilitated discussion to garner feedback about the presentation.

Project context including the timeline for improvements to the park, site context, planning and policy context of the park. They then provided an overview of the important considerations for the park redevelopment which included a high-level overview of the Big Moves and the replacement of the John Innes Community Recreation Centre. Participants also heard about the Engagement Goals including protocols for Indigenous Engagement. Participants were then placed into breakout groups to have smaller group discussions about the Draft Design Principles and Big Moves.

3.0 What We Heard

The following section contains a summary of the feedback received during Public Meeting #2. See [Appendix A](#) and [Appendix B](#) for full documentation of comments and questions shared during the open house.

3.1 Key Insights

Key insights that have emerged from the Public Meeting are consolidated by the themes below.

Strong Community Advocacy

Members of the public shared that the new park and Community Recreation Centre should be representative of the surrounding community. Participants recognize that Moss Park and the John Innes Community Centre are currently significant community assets for those experiencing homelessness. There is a particular interest in how the redesigned Community Recreation Centre and park can be of service to those who experience homelessness.

The project team responded by sharing that service providers and individuals with lived experience have also been consulted in this process. Based on what they have heard through those consultations, outdoor access to washrooms and showers will be considered for the Community Recreation Centre. They further informed the community that the Community Recreation Centre will include a Housing and Supportive Services office, and will continue to engage with service providers and those with lived experience throughout the project.

Safety Concerns and Questions

Several members of the public brought up safety concerns. Some mentioned concerns regarding the amount of glass in the design and the potential for it breaking. Others mentioned sightlines and lighting, while others asked if there would be safety measures in the park after the recreation centre is closed.

The project team acknowledged the concerns raised by community members and emphasized that their primary objective is to create a safe public space. They stated that the design aims to minimize 'blind' corners to enhance safety. With regards to the use of glass, the team clarified that they are striving to achieve a balance between solid surfaces at the ground level to ensure privacy in swimming areas, and more glazing on higher levels. The team also reassured members that they have never experienced any

damage to property (eg. broken glass) in similar civic spaces, suggesting that such damage is less likely to occur in these types of facilities.

Programming

At the open house, accessible programming emerged as a popular topic of discussion. Members of the public wanted to confirm that the Community Recreation Centre will remain free of charge. In response, the project team reassured community members that the centre would indeed remain free.

The design team further elaborated that they would prioritize flexibility in the room designs, intending for the spaces to be multi-functional and able to address a wide range of community needs. This will include incorporating program rooms of varying sizes and designing for the broadest possible programming use.

The multi-purpose rooms' flexible design provided reassurance to the public that the Community Recreation Centre will be adaptable to the diverse and evolving needs of the community.

3.2 Pre-Engagement Outcomes

The City of Toronto engaged in multiple forms of public consultation before the open house, including a survey, a previous meeting, and ongoing engagement with the local Indigenous community and the project's Local Advisory and Project Champions. The input gathered from stakeholders indicated broad support for the proposed improvements to Moss Park and the John Innes Community Recreation Centre.

Some of the key areas of focus that emerged from these consultations include:

- An opportunity to educate the public about the pre-colonial history of Moss Park.
- Various ways to engage in recreational activities in the park, such as fitness equipment and a better hockey rink.
- The importance of active transportation and accommodating mobility devices and strollers in the planning process.
- Moss Park should prioritize an “eyes on the park” approach as a top concern by designing the park to encourage increased visibility and feelings of safety. However, excessive police surveillance could potentially diminish feelings of safety for racialized communities or those experiencing homelessness.
- People experiencing homelessness need to be a priority for this project.
- Programming needs to respond to the social context of the park. This would include providing programs for seniors.

- The idea of using Moss Park to increase food security.
- Sustainable and carbon-neutral initiatives at the new Park and Community Recreation Centre.
- Widely publicize the engagement process by incorporating more in-person promotion of community engagement events.
- Community members revealed a strong sense of advocacy among local residents who expressed a desire to be involved and consulted.

3.3 Public Meeting #2 Summary

3.3.1 Public Meeting Participation

WHEN: October 20, 2022, at 5:30 - 8:00 p.m.

WHERE: Virtually on Webex

ATTENDEES: 30 participants

PROJECT TEAM: City of Toronto – Parks, Forestry & Recreation Division
 PROCESS (Public and Stakeholder Engagement)
 The Planning Partnership (Landscape Architecture)
 Two Row Architect (Landscape Architecture & Indigenous Lens)
 MJMA (Community Recreation Centre Architecture & Design)

3.3.2 Summary of Feedback from Public Meeting #2

Safety

Safety is a continued topic of discussion during this Open House. The Moss Park improvements need to ensure that the park is safe for local residents, children and visitors. Participants wanted to learn more about the safety and security measures that will be implemented in the Community Recreation Centre and in the park.

“What sort of security features are being considered, like sightlines and lighting, in and outside of the facility?”

“You're talking about a lot of glass in windows. One of the realities post-COVID is, there's broken windows all over the city. It's actually quite alarming. I can see it

being a target for broken windows. I'm not sure if 'eyes on the street' is warranted or needed in the building."

Multi-purpose Rooms

There was a lot of discussion around the multi-purpose rooms and their functions. Participants were curious about how these flexible spaces can serve the wider Moss Park community and whether they can be used free of charge.

"Will there be opportunities for using sewing machines /sewing classes & social enterprise opportunities in general?"

"The meeting rooms are heavily used - these multi-purpose rooms look all the same size - any thought to vary the size to accommodate different size groups?"

"Will this building provide open programming for study spaces?"

Park Design

Community members raised concerns about the removal and replanting of trees in Moss Park, which is necessary to accommodate the design of the new Community Recreation Centre and the Metrolinx Station. There were also questions about parking and accessing the Community Recreation Centre by car.

"Will new trees be planted to replace the ones that have / will be removed?"

"I'm shocked that 56 trees will be removed along Queen Street. When you talk about how beautiful it is to see trees, there won't be any to see."

Appendix A

Design of the Community Recreation Centre and Facilities

PARTICIPANT QUESTION/COMMENT	PROJECT TEAM RESPONSE
I echo the emphasis on green space how important it is to the community; what opportunities have been explored to effectively use concrete footprint in place - (i.e. hockey rink use)? Combining spaces to maximize building footprint use and maintain green/ park space? What is the long-term plan for the ice rink since it is at the end of its life?	The ice rink is well used and well run and the Board wants to use it as long as possible. Arena Board is currently leasing space - facility will be up and running with a state of good repair program for the next 10 years but not sure what the long-term plans are.
No need for 10' deep end unless you're doing SCUBA certifications.	We're not ruling out SCUBA certifications but some depth allows for some diving.
Is the pool going to be free of charge like the actual one?	Yes, and all aquatic programming will continue to be free.
Where will the elevators be located?	(Pointed out on diagram.) Right next to the lobby/entrance and up to every floor and accessible.
What is a therapy bench?	A hydrotherapy bench – is a comfy bench. It will be in the leisure pool which is a warmer pool.
Therapy benches are good for stretching.	
Will there be opportunities for using sewing machines /sewing classes & social enterprise opportunities in general?	Yes, there are lots of opportunities and the City is open to working with staff to find the right activities the community wants to see. Programming is aimed to meet community needs. So if there is a need, we're happy to look into it—sewing, cooking, birthday parties. It is a free centre and we're happy to entertain ideas and work to make that happen.

PARTICIPANT QUESTION/COMMENT	PROJECT TEAM RESPONSE
	Design team trying to design as rooms with as much flexibility as possible. The rooms are intended to be multi-functional to address community needs.
Regent Park Aquatic Centre allows the multi-purpose rooms to be rented out for children's birthday parties - would love to see that at the Moss Park community centre.	Yes. It is a free centre. The City has discussed (and will continue to) the opportunities with the team. The City is open to all permits and all social events - birthdays, community kitchen events, community garden events, etc.
The meeting rooms are heavily used - these multi-purpose rooms look all the same size - any thought to vary the size to accommodate different size groups?	Yes, we're looking at a variety of program rooms of a variety of sizes, and designing for the widest possible programming use. The woodshop is a special purpose room (i.e. sawdust extraction) - that's specific to that one room but the rest are designed being thought of flexibility. Rooms that can move and adjust with dividers, and a community kitchen that can serve as an indoor and outdoor space which will be the largest of the program rooms.
Have you spoken to Regent Park Community Recreation Centre management about how difficult it is to manage and how much they dislike the two entrances (with a reception in the "rear") that are similar to what is getting proposed here?	We certainly understand the comment. The goal is always to try to make the safest public space - complete visibility, welcoming lobby where we can see both entrances, entrances to washrooms (indoor and outdoor) - trying to make sure there aren't any 'blind' corners where you can't see people. It makes for a more open and democratic feel in the lobby. Because it is such a short footprint the sightlines are good and clear visible lines.
What sort of security features are being considered, like sightlines and lighting, in and outside of the facility?	The City has a security division so there will be cameras at entrances but not in the pool/gym areas but in strategic public spaces like lobbies and entrances. The configuration between the existing arena and Community Recreation Centre will have a service courtyard in line with the existing wall so there aren't any hidden lines. There is as much openness to the park and building as possible, for more eyes on the street.
You're talking about a lot of glass in windows. One of the realities post-COVID is, there's	Inner city projects with the same concerns but the public participation and ownership

PARTICIPANT QUESTION/COMMENT	PROJECT TEAM RESPONSE
broken windows all over the city. It's actually quite alarming. I can see it being a target for broken windows. I'm not sure if "eyes on the street" is warranted or needed in the building.	is a high priority of people and we've seen protection of these spaces and less damage with these kinds of civic spaces and properties. We understand that but in our experience we're seeing good results with public ownership.
Broken windows - if they use some other materials for those places, metal not just glass maybe we will not see too much broken glass.	Thank you for the suggestion of other materials - use a variety of materials. It is a great suggestion. We are looking at a balance of solid surfaces at ground level and glass. Need to balance privacy during swimming and other events. As we go up in levels we want more glazing.
Visibility is only relevant when the centre is open. The problems occur after hours. How will that be addressed?	There will be improved lighting at night and day. It will be attractive for pedestrians and have nice even light throughout the park. There will be new circulation paths and programs (i.e. Dogs off-leash area). People using the space regularly is a natural way to limit behaviours the City does not want in the park (i.e. potential spaces for violence).
Libraries benefit the community, any plans to include one or something similar?	
FYI there are 3 libraries within 15 minutes walking distance from the park.	
Brand new library being built where the current south market is located - in front of Shoppers on Jarvis / Esplanade.	Thank you for your comments regarding libraries! They have been noted.
What other buildings are surrounded by shelters?	
How tall will the building be?	20 meters or so. The team is in concept design so have yet to go into structural spans, but looking at about 4-4.5 m/floor; overall 18-20 m to the roof, about 60 feet overall/4 storeys.
Will the gym have a climbing wall - similar to the ones at MLS Launchpad?	Waiting for the survey, this will help us understand how many people want a particular feature. We're still considering the best configuration for participation.
Is the MLSE climbing facility a trackwall that doesn't need a spotter?	

PARTICIPANT QUESTION/COMMENT	PROJECT TEAM RESPONSE
It's a trackwall. You may want to visit the MLSE Launchpad as it's at Jarvis and Dundas and could give you some good feedback on what works or doesn't for the community.	Thanks for the suggestion around the climbing wall!
Will this building provide open programming for study spaces? How will people access the building via car? Plans for underground parking? Shuter, Sherbourne and Queen are mostly single lane both ways with not much room to extend traffic lanes. How will this be planned out given the restriction of roadways?	The team knows that study spaces are in high demand. The team is looking to see how the public circulatory system, hallways/stairs could be enlarged so we understand how the floorplate of the building includes study space uses. As much as possible we are going to try to do this.
(In response to the last answer from panelists about TTC connected nature of site) Have you transported hockey gear on the TTC?	

Appendix B

Miscellaneous Comments & Questions

PARTICIPANT QUESTION/COMMENT	PROJECT TEAM RESPONSE
Will the presentation be available later?	Yes, we will be drafting a meeting summary which will include a copy of the presentation.
When will the slides be available to the public?	In the coming weeks. You will find all information posted to the project website .
I originally got interested in this project because of the larger Park programming. I was very interested in having a baseball swing there. At the time I attended, there was a discussion that evolved around the community to provide affordable housing. I think this is a wasted opportunity to provide much needed affordable housing, subsidized housing for regular waystation stations. This is exactly what the provincial planning documents adviser, should be done around the significant public investment in improving transit in the City. I would just really encourage this group to press building up or on top.	We'd like to clarify that the recommendation is to use the land for affordable housing. The space is designated for park land, important for the community.
Just to follow up on the previous comment - the response that the Official Plan designation is Park should not foreclose the opportunity for an OPA to permit residential uses on top of the community centre. The current programming looks great, but 4-stories on City-owned land is a tremendous lost opportunity. The City should be using its powers to amend the OP, build residential on top, and build subsidized housing. I would appreciate speaking to the representative from Planning who is consulting on this project.	Thank you for the follow up and addition to your comment. We'll be sure that they're noted and shared with the full project team and City.
There was a thought early on (6+ years ago) that this could be a home for gay/lesbian sports leagues. None of these spaces are big enough for league play. Has this idea been abandoned?	Originally <i>More Moss Park</i> was a partnership between the City and a donor. The project at the time was deemed not feasible. The City is using some of the learnings from that project as a basis, but it is now solely a City of Toronto PFR project. Once the Community Recreation Centre is officially built the PFR team will

PARTICIPANT QUESTION/COMMENT	PROJECT TEAM RESPONSE
	do another round of consultation to determine programming.
A substantial part of the population around the center is unhoused/homeless persons. How will this center cater to them? Their needs for sociality and facilities?	Hearing from service providers and those with lived experience - there is a need for access to washrooms and shower facilities from the outside. We're continuing to engage with service providers and those with lived experience throughout the project. Within the Community Recreation Centre, there is a space dedicated for Housing and Supportive Services.
I'm trying to understand exactly the footprint of the plan and how many trees are going to be affected.	The Arborist has done a full report of the site. Some trees have been designated a 'weed tree' (i.e., Norfolk Maple) that will be removed from Sherbourne. On Shuter side the majority of mature trees will remain, there will be some removals. The comprehensive arborist report contains an analysis of current conditions of trees and what has to be removed for various reasons. The grade in front of the Community Recreation Centre is being lowered and the current grading is so high (berm) - the grade in grade requires removal. That being said, the team is trying to keep as many trees as possible. Metrolinx is removing all trees along Queen St. E. to construct the Ontario Line.
I'm shocked that 56 trees will be removed along Queen Street. When you talk about how beautiful it is to see trees, there won't be any to see.	We try to maintain as many trees as possible. We hear you. Yes, some trees need to be removed to accommodate the new Community Recreation Centre because the new program requires a larger footprint. The architects are trying to make the footprint compact to preserve a large, open contiguous park space - as well as limit the number of tree removals.
Will new trees be planted to replace the ones that have / will be removed?	Yes, not all first planting new trees will be the same size - we will plant a variety of species and sizes. It will be an overall win for the community long-term. We acknowledge the removal in the short term-but believe the long-term will be better for all.

PARTICIPANT QUESTION/COMMENT	PROJECT TEAM RESPONSE
<p>Well, with all due respect, I have been living on Twitter for the last 10 years and I've seen what happens with replanted trees. Not one of them survives. Replanting is being done poorly.</p>	<p>We hear you, there is pain when we remove trees. They are not 'junk' trees. It is not the arborist on their own. They are just collecting the health and type of tree data for the City. The City feels that with a very robust replanting strategy - which the City will have - we will have a strong urban forest along Queen and will illustrate this in the park design plan in the early new year (January 2023).</p>
<p>Parents that use the playground feel very unsafe when the playground is far from the street.</p>	<p>There is no official plan for the park yet. The final locations are still being determined but PFR wants kids facilities as close to the building as possible but are not yet at determining the exact size and location just yet.</p>
<p>The city is one of the biggest landowners in the Moss Park/Sherbourne Corridor. TCHC owns several high-rise towers including many low-rise buildings and townhouses. The majority of these sites are prime for development for which further density can be added. I don't think the community centre is a lost opportunity considering there is so much more the city can (and should) focus on in the area.</p>	
<p>That's a fair point. I'm sure those other sites offer opportunities as well, but overall the City's opportunities are still very limited to build new affordable units. We need everything the City can build.</p>	
<p>Greenspace is a priority. Minimizing concrete in downtown.</p>	<p>Are you suggesting the community centre be above the arena?</p>
<p>How many panelists live in the area and have spent a few hours on Saturday/Sunday afternoons in front of John Innes? The question regarding if the panelists were from the area or if they had spent weekend afternoons at John Innes was to see if they understood the community and the area dynamics and how their proposals fit the neighbourhood The fear is they are "plopping" a generic Community Recreation Centre into the neighbourhood without knowing how it would actually suit the area.</p>	<p>We really want to hear from folks living in the community through Local Advisory Group, Project Champions, Pop-ups in the area, Youth Workshops, Indigenous Communities Workshop and public meetings like tonight to make sure we collect information ongoing/throughout the project.</p>

PARTICIPANT QUESTION/COMMENT	PROJECT TEAM RESPONSE
Perhaps going forward you can incorporate some slides with bullet points from those community partner feedback.	We did have a few slides around the community engagement and everything we have heard to date at the beginning of the presentation. All that information will be posted on the project website as well.
Please advertise community engagement sessions better around the neighbourhood I live blocks from the park and have not seen any info in or around my building.	