

# KENSINGTON MARKET

## SAFE STREETS

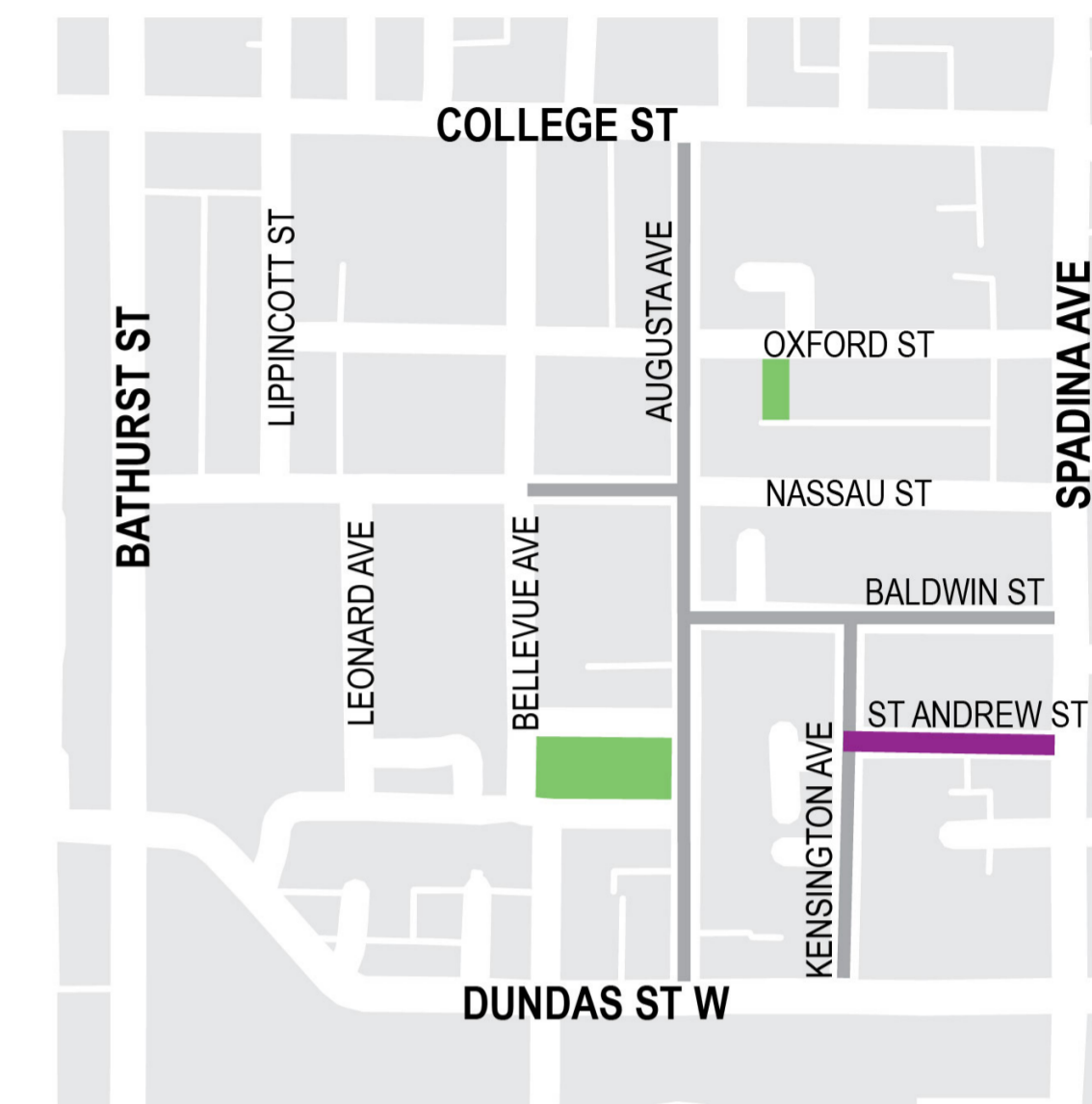

### St. Andrew Street Kensington Avenue to Spadina Avenue

#### LEGEND

- Existing fire hydrant
- Existing light pole
- Existing pole
- Proposed BIA pedestrian light pole
- Existing driveway and laneway accesses
- Occupied building frontage
- Tactile Walking Surface Indicators (TWSI) at crosswalks
- Existing trees
- New trees



- Proposed plan is representative.
- Information on this plan is based on Office Records, and is subject to field verifications.
- Not to Scale

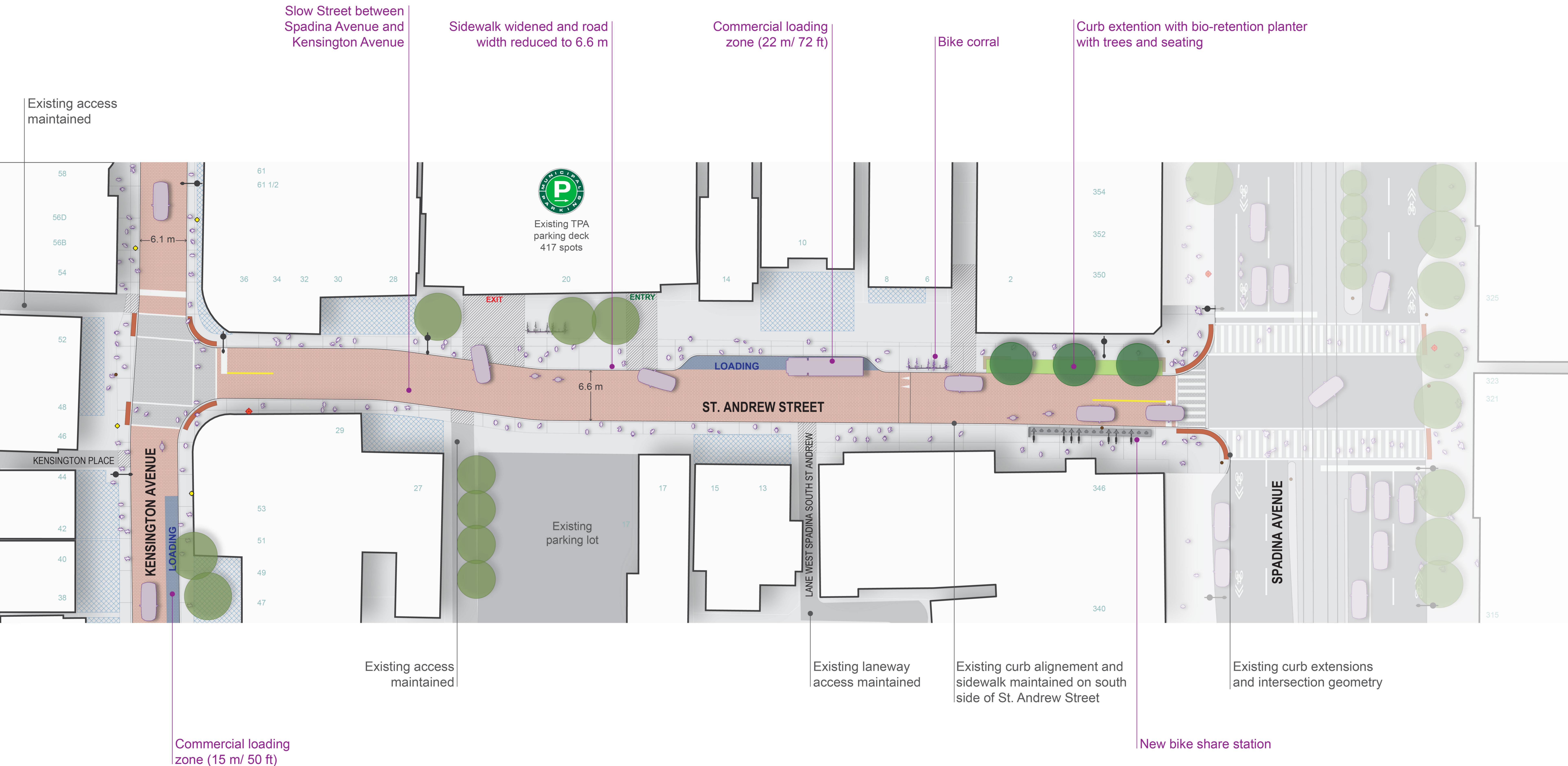

Slow Street between Spadina Avenue and Kensington Avenue

Sidewalk widened and road width reduced to 6.6 m

Commercial loading zone (22 m/ 72 ft)

Bike corral

Curb extension with bio-retention planter with trees and seating

Existing access maintained



Existing TPA parking deck  
417 spots

EXIT

ENTRY

LOADING

ST. ANDREW STREET

KENSINGTON AVENUE

LOADING

KENSINGTON PLACE

LANE WEST SPADINA SOUTH ST ANDREW

SPADINA AVENUE

Existing access maintained

Existing laneway access maintained

Existing curb alignment and sidewalk maintained on south side of St. Andrew Street

Existing curb extensions and intersection geometry

Commercial loading zone (15 m/ 50 ft)

New bike share station