

City of Toronto – Parks Development & Capital Projects

Moss Park

Park Improvements and John Innes Community Recreation Centre Replacement

Survey #3: Park Design Options Engagement Summary Report

May 10, 2023



Table of Contents

1.1 Project Context

1.1.1 Project Goals

1.1.2 Project Schedule

1.2 About this Report

1.2.1 Engagement Timeline

2.0 Engagement Overview

2.1 Engagement Objectives

2.1.1 Engagement Approach

3.0 What We Heard

3.1 Key Insights

3.2 Public Survey #3 Summary

3.2.1 Demographic Profile of Survey Respondents

3.2.2 Survey Responses

APPENDIX A

Survey Questions

APPENDIX B

Open-Ended Comments Log*

1.0 Introduction

Moss Park park improvement and the replacement of the 70-year-old John Innes Community Recreation Center will serve the evolving needs of the diverse community. This includes supporting vulnerable and equity-deserving populations in the local area and growing numbers of community residents by offering improved park amenities and recreational facilities.

The new and bigger facilities of the Community Recreation Centre and the park improvements will serve local communities by building on the assets of the park and community, in response to the needs of the diverse array of community members who enjoy the park and recreation amenities today.

This report builds on reports previously published, such as those for past surveys, open houses and advisory group meetings, all of which can be found on the project webpage.

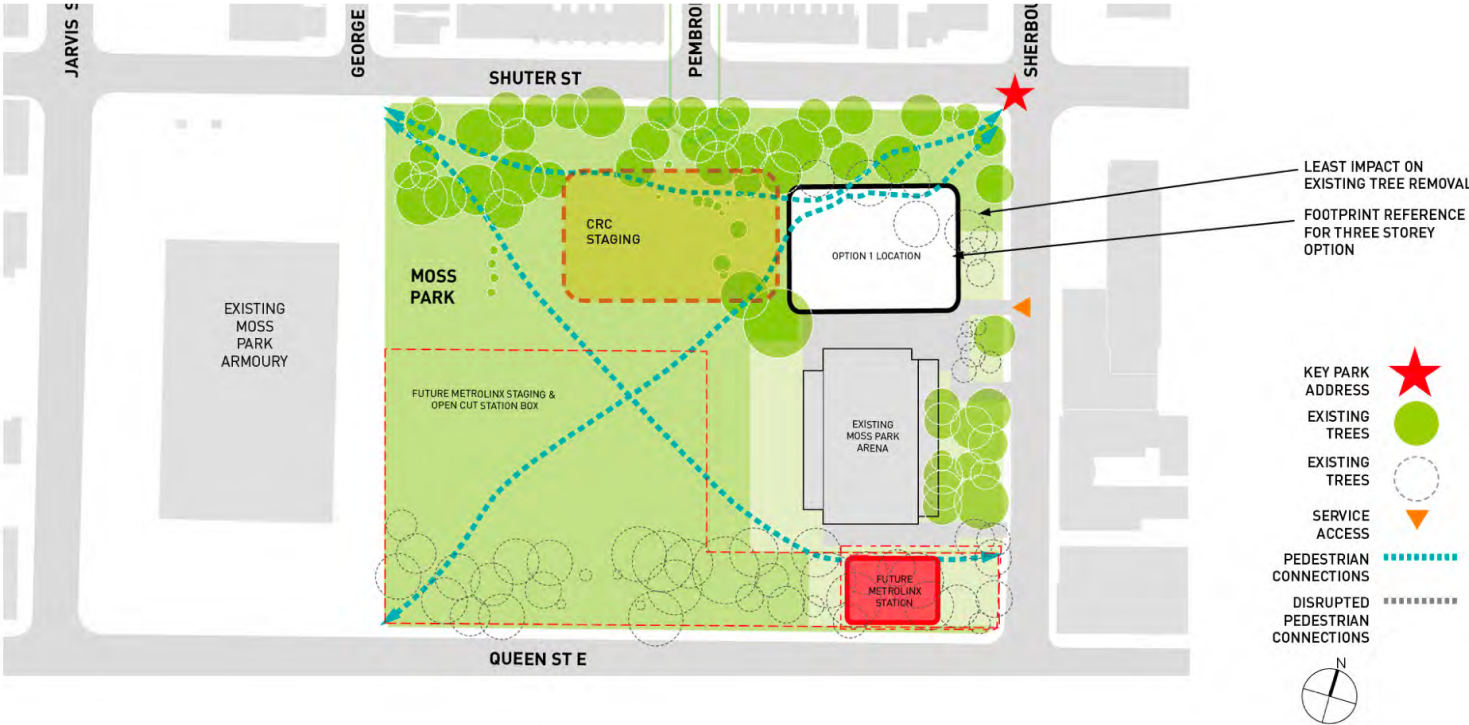

FIGURE 1: Map of the location of the new Community Recreation Centre in Moss Park

1.1 Project Context

In 2015, an initial reimagining of Moss Park began as a partnership between the City of Toronto, The 519, and a philanthropic partner. The project, titled *More Moss Park*, aimed to redevelop the park and replace the community recreation centre with a new facility that centered 2SLGBTQ+ communities and expanded the services offered. After a community and stakeholder engagement program and feasibility study, culminating in the *More Moss Park Report* in 2016, the project was deemed not feasible.

In 2019, City Council adopted the implementation strategy for the Parks & Recreation Facilities Master Plan with amendments. The plan made recommendations for the replacement of the John Innes Community Recreation Centre, facade improvements for the Moss Park Arena, as well as park improvements.

While the scope of the current Moss Park park improvements and John Innes Community Recreation Centre replacement project is now focused on park and recreation facilities for the community; the insights, knowledge and data gathered through the *More Moss Park* consultation and engagement laid valuable groundwork for this project.

1.2 Project Goals

Launch a new initiative to replace the John Innes Community Recreation Centre with a new Community Recreation Centre and make extensive improvements to the park through a consultation process that is informed by the insights of the *2015 More Moss Park* project, with the following key project goals:

1. Replace the John Innes CRC with a bigger facility that meets the standards set out in the City's Recreation Facilities Master Plan and that can better meet the community's needs.
2. Redesign the park to meet current and future needs.
3. Build on the park's long-standing role as a hub for the diverse communities and people of Moss Park.
4. Ground the project by honouring local communities and by building on the assets of the park and community and the experiences and goals of diverse park users.
5. Build on the input received from the previous *More Moss Park* community consultation process.
6. Deliver an accessible and welcoming place for all members of the Moss Park and John Innes CRC community.
7. Work closely with the community throughout the project.

1.3 Project Schedule

- Spring 2021: Procurement of architect and landscape architect design services and community engagement consultant
- Spring/Summer 2022: Community engagement – Building on the Vision
- ***WE ARE HERE - Summer/Fall 2022: Community engagement – Early Design Ideas**
- Winter/Spring 2023: Community Engagement – Preferred Design
- Spring 2024: Hire a construction team
- Summer 2024 to Fall 2027: Community Recreation Centre construction
- Spring 2025 to Fall 2027: Park construction

1.4 About this Report

This survey summary report, prepared by SAFFY, summarizes the key findings that emerged through Survey #3 - Park Design Options for Moss Park Park Improvements Project, as part of the Moss Park Improvements & John Innes Community Recreation Centre Replacement Project.

2.0 Engagement Overview

2.1 Engagement Objectives

The objective of this engagement phase was to provide the community with early design concept options for Moss Park Park improvements, which will be refined through community engagement. These designs were informed by data gathered during consultations that occurred earlier in 2022. The survey collected feedback from the public specifically related to features (such as pathways, community garden size, and off-leash dog areas), children's play areas, splash pads, seating, and the tennis court and pickleball areas. The results of this survey will be combined with information received from other consultation activities to continue to inform future planning and design decisions for the improvement of Moss Park Park.

2.2 Engagement Approach

This phase of the engagement process was designed to reach and listen to the general public. It included a public survey (hosted digitally on CheckMarket).

A total of **228** members of the public responded to the survey (open from March 21 - April 15, 2023).

Public Survey Dissemination: Survey #3 Park Design Options for Moss Park Park Improvements Project targeted residents of Toronto and those who visit the Moss Park or John Innes Community Recreation Centre. The survey link was shared through various channels, including at the public meeting, via email correspondence to a diverse range of stakeholders that the project team had already engaged with, and in-person through word of mouth during the Moss Park Pop-Up event held on April 15th.

Survey #3 Park Design Options for Moss Park Park Improvements Project was available online for three weeks (March 21 - April 15, 2023) following a public meeting that presented the three (3) concept design options for Moss Park Park. The purpose of the 10-15 minute survey was to collect public feedback on several features related to the Moss Park park Improvements. Specific feedback was collected on the following: pathways, community garden size, off-leash dog areas, children's play areas, splash pads, seating, and the tennis court and proposed pickleball area.

3.0 What We Heard

The following section contains a summary of the feedback received through the third public survey. See **Appendix A** for a full list of questions included in the public survey. **Appendix B** provides a summary of open-ended responses received.

3.1 Key Insights

Key insights that have emerged from the public survey are consolidated by the theme below.

Space for All Ages and Abilities

Respondents suggested that park spaces, including the playground, splash pad, and seating areas, should be designed to accommodate people of all ages. Several comments were made around the need to provide family-friendly spaces for children and caregivers who reside in the neighbourhood and rely on Moss Park for outdoor activities.

Seating preferences include comfortable places for older adults to sit, as well as people with physical disabilities or who use mobility devices.

Unhoused Community Members

Across all open-ended questions, participants raised concerns about how to share space with people who are unhoused, precariously housed or residing in shelters. In particular, people would like the playground and splash pad area to be separated from spaces where people might congregate or spend time resting on park furniture.

Safety

Some respondents shared that they do not feel safe in Moss Park due to anti-social and drug-related activities. They wish to see additional measures included in the design or programming to ensure all community members (including families and children) feel comfortable accessing the park.

Seasonality

A few participants wish to see additional consideration for winter use of the space including opportunities for skating and vegetation that will remain green during winter (e.g., coniferous trees). Several respondents expressed concerns that the splash pad can only be used for a few months a year and would prefer prioritization of the playground area instead, which may be used for more time each year.

3.2 Public Survey #3 Summary

The third public survey for the Moss Park Park Improvements & John Innes Community Recreation Centre Replacement Project focused on the aspects related pathways, the community garde, off-leash dog area, children's play areas, splash pads, seating, and the proposed tennis court and pickleball area. Below is a review of the responses by percentages. See [Appendix A](#) for full survey questions.

3.2.1 Demographic Profile of Survey Respondents

The majority of survey respondents (60%) were adults between the ages of 30-55, followed by youth or young adults between the ages of 19-29 (15%) and older adults and seniors aged 56-74 (14%). A small proportion (7%) of respondents were adults ages 65 to 74.

Racialized individuals and Indigenous people made up 35% while 11% had a preference not to disclose their race. The majority of respondents were white (58%).

43% of survey respondents were men, 40% were women, 4% were gender non-binary (including gender fluid, genderqueer, androgynous) and 2% identified as Two-Spirit. 38% of respondents identified as being Lesbian, Gay, Bisexual, Queer or Two-Spirited and 45% identified as heterosexual.

15% of respondents identify as having a visible or invisible disability. The majority of respondents (97%) reported that English was their preferred language.

3.2.2 Survey Responses

There were 228 survey participants. 221 (97%) completed the survey in full.

CONCEPT DESIGN PREFERENCES

Respondents were asked whether they were satisfied (agree or disagree) with specific elements across the three concept designs. Preferred Concept Design elements are indicated with bold text.

- I like the width of the pathways in this design (main paths will be wide enough to comfortably accommodate several people walking at the same time and people using mobility devices.)
 - Concept Design 1 (The Grid) - 76%
 - **Concept Design 2 (The Creek) - 87%**
 - Concept Design 3 (The Meander) - 86%

- I am satisfied with the access paths in the community garden area in this design
 - Concept Design 1 (The Grid) - 71%
 - Concept Design 2 (The Creek) - 84%
 - **Concept Design 3 (The Meander) - 85%**

- I like the size and layout of the Off-Leash Area in this design (general location of the Off-Leash Area is fixed to the south west corner of the park)
 - Concept Design 1 (The Grid) - 66%
 - **Concept Design 2 (The Creek) - 84%**
 - Concept Design 3 (The Meander) - 76%

- I am satisfied with the connections between the park and the neighbourhood in this design
 - Concept Design 1 (The Grid) - 60%
 - **Concept Design 2 (The Creek) - 89%**
 - Concept Design 3 (The Meander) - 82%

- I am satisfied with the size of the community garden in this design
 - Concept Design 1 (The Grid) - 61%
 - **Concept Design 2 (The Creek) - 78%**
 - Concept Design 3 (The Meander) - 73%

- I am satisfied with the location and form of the pathways in this design
 - Concept Design 1 (The Grid) - 43%
 - **Concept Design 2 (The Creek) - 85%**
 - Concept Design 3 (The Meander) - 76%

In general, respondents preferred Concept Design 2 (The Creek), though access paths in the community garden area in Concept Design 3 (The Meander) were slightly more preferred. Concept Design 2 and 3 received similar response rates overall, but especially for the width of pathways (87% and 86%, respectively) and access paths in the community garden area (84% and 85%, respectively).

Concept Design 1 was less preferred overall, with least satisfaction around the location and form of the pathways (43%), connections between the park and the neighbourhood (60%), the size of the community garden (61%).

PLAYGROUND DESIGN

Participants were asked which type of playground they prefer and which theme they would like to be reflected in the playground design, as well as whether they would like the playground or splash pad area to be larger.

Playground Type

- 57% - Natural material play equipment (such as wood, rope and stone)
- 45% - Combination of natural material and colourful traditional play equipment together
- 8% - Colourful, traditional metal play equipment (metal climbers and slides)

**Note that participants could select multiple options for the playground type.*

Playground Theme

- 54% - Buried Moss Creek theme
- 45% - Garden District theme
- 8% - I wish to suggest a theme

**Note that participants could select multiple options for the playground theme.*

A range of themes were suggested in the open-ended text box, including the following:

- Indigenous (4)
- Garden (2)
- No Theme/Normal Playground (2)
- Baseball (1)
- Inclusion (1)
- Fuzzy Moss (1)
- Jungle Oasis (1)
- Forest of Hope (1)
- Other - Should be residential use instead (2)
- Other - Should remain park encampment (1)

Playground Size

- 64% - I prefer the playground larger than the splash pad
- 28% - I prefer the playground and splash pad about the same size
- 10% - I prefer the splash pad larger than the playground

**Note that participants could select multiple options for the playground size.*

When asked to provide feedback on the playground and splash pad, participants provided varying opinions on the importance and necessity of having a splash pad in the park. Some respondents feel that a larger playground area should be prioritized instead, as it can be used year-round and is accessible to a wider range of ages.

Other suggestions included incorporating natural elements into the playground design, adding outdoor fitness equipment for adults, and providing ample seating for parents.

Summary of Comments on Playground Design:

- Playground can be used longer, splash pad use is limited by weather (8)
- Include natural play elements or playground structures (2)
- All ages design (e.g., for adults and for youth from newborns to teens) (2)
- Include picnic tables and seating for parents (2)
- Splash pad is not used often (2)
- Include a larger playground option in the Creek design (1)
- Prefer larger playground (1)
- Outdoor skating during winter (1)
- Prefer larger splash pad (1)
- Reduce park lighting at night (1)

- Outdoor fitness equipment for adults (1)
- Safety concerns (1)
- Include a traditional fountain (1)
- Make splash pad buttons easy to press/activate (1)
- Include creative play structures like St. James or St. Lawrence Parks (1)
- Include the largest playground and splash pads possible (1)
- Use simple materials that are easy to maintain and will last (1)
- Include a splash pad area for dogs(1)

PARK SEATING

Participants were asked which seating types they prefer.

- 78% - Comfortable benches with backs and armrests (armrest are required to meet Toronto Accessibility Design Guidelines)
- 66% - Standard size picnic tables
- 58% - Café tables and chairs (fixed in place)
- 47% - Lounger
- 26% - Large, communal picnic tables
- 18% - Individual armchairs

**Note that participants could select multiple options for the seat type.*

Feedback provided in the open-ended question about park seating acknowledged the importance of providing seating that is comfortable, ergonomic, and accessible for older adults and people with disabilities. Respondents recognize the need to prevent theft of park furniture and agree that seating and tables that are fixed in place will be beneficial.

Comments were divided between wanting to discourage loitering by people experiencing homelessness (e.g., no loungers, large benches or tables) and wanting to avoid the use of hostile architecture and welcome unhoused residents should they need a place to rest.

Summary of Comments on Park Seating:

- Avoid hostile architecture (6)
- Avoid seating that encourages sleeping (4)
- Benches with backrest (2)
- Provide multiple seating options (2)
- Concern that park furniture will be stolen if not fixed in place (2)
- Seating should be comfortable for everyone, including older adults (2)
- Ensure seating that is fixed in place has spaces for mobility devices (2)
- Provide seating that accommodates people with physical disabilities (2)
- Provide seating in both shaded and unshaded places (1)
- Provide well-designed seating (1)
- Make the space family-friendly (1)
- Include swivel chairs (1)
- Provide seating that accommodates people with larger bodies (1)
- Add tabletops with chess boards (1)
- Avoid large community tables (intimidating for small children) (1)
- Use seating that discourages sleeping near the playground and splash pad areas (1)
- Use surfaces that are easy to clean (1)

PICKLEBALL

Participants were asked whether they would like to have a pickleball court as a shared use court with tennis courts in the park.

- 54% - Yes
- 16% - No
- 30% - Not sure, I need more information about pickleball

The responses to the open-ended question about the possibility of shared pickleball and tennis courts in the park yielded mixed results. Some respondents were supportive of the idea, stating that the park could benefit from multi-purpose courts that could be used for different sports and activities. Others expressed that pickleball was growing in popularity (and tennis is declining in popularity) and provided an opportunity for a larger group of people to participate in a sport that was more inclusive than tennis.

Concerns about the space requirements for both sports, the need for court markings that would not compromise visibility or the integrity of the tennis court lines, and the noise levels associated with pickleball were also raised. A few respondents were hesitant and felt that pickleball may be a fad and were uncertain how long people would be interested in playing, whereas tennis has been popular for much longer. Some respondents mentioned that tennis courts were already in high demand during warmer months and adding another court would be ideal.

Summary of Comments on Pickleball:

- Concern about pickleball as a fad that will not last (4)
- Provide off-season use on courts (e.g., skating) (2)
- Pickleball will be accessible to and accommodate more people (2)
- Tennis use is declining (2)
- Pickleball use is increasing (2)
- Tennis courts are already too busy (2)
- Appreciate multi-purpose courts (1)
- Provide outdoor ping pong tables (1)
- Concern about overlapping court markings when playing tennis (1)
- Concern about noise related to pickleball (1)
- Keep courts clean of garbage (1)
- Tennis courts make the park more safe (1)
- Pickleball could bring leagues and community connections (1)
- Concern about compromising the use of the tennis courts (1)
- Prefer tennis courts only (1)
- Prefer pickleball courts only (1)
- Prefer other sport options like baseball or cricket (1)
- Tennis courts are used for other uses (e.g., dog training) (1)
- Provide use of courts for other activities (e.g., badminton, rollerblading) (1)
- Concerns about location (1)

GENERAL COMMENTS

The feedback provided by respondents highlights several recurring themes regarding necessary upgrades to the park. A common suggestion is to plant more mature trees and greenery, while ensuring that the park is well-maintained, clean, and safe for all users. Opinions vary regarding the off-leash dog area and requests for consideration of the needs of unhoused, precariously housed or residing in shelters, particularly in summer months.

Regarding park design, respondents suggest creating different elevations in the park, improving visibility of pathways, and addressing safety concerns in the surrounding area. Suggestions include including adequate garbage, seating, and maintaining public washrooms.

Summary of General Comments:

- Include more trees and plants (9)
- Include parking spaces (6)
- Concern about safety (4)
- Concern around people cutting through open green space and destroying grass (4)
- Include coniferous trees for greenery during winter (3)
- Include open field areas (e.g. soccer, cricket, baseball) (3)
- Prefer larger dogs off-leash area (2)
- Consider snow removal and use of salt (2)
- Include permeable pavement in design (2)
- Dislike inclusion of dogs off-leash area (2)
- Increase lighting at night (2)
- Safety concerns around sacred fire space (2)
- Dislike the removal of the baseball diamond (2)
- Dislike allotment garden approach; prefer community garden to be managed by John Innes (2)
- Prevent encampments from forming or people experiencing homelessness from congregating (2)
- Ensure trees do not shade the community garden (1)
- Include native edible plants to support food security (1)
- Acknowledge the presence of the armory (1)
- Pembroke Street should not be a focus of the design (1)
- Splash pad can be used to cool down in the summer (1)
- Ensure varied elevations within the park (1)
- Include plaza near Pembroke Street (1)
- Improve north-south connections through park (1)
- Ensure park can be maintained once built (1)
- Concern about size of dogs off-leash area (1)
- Concern about smell from dogs off-leash area (1)
- Concern about pickleball being an elitist sport (1)
- Dogs off-leash areas should be located in smaller parks (1)
- Consider removing community gardens (1)
- Include winter park uses (e.g., skating, sledding) (1)
- Seating should provide space to rest and sleep (1)
- Improve basketball courts (e.g., more hoops, rubber court surfacing) (1)
- Expand the community garden (1)
- Provide water access for the community garden (1)
- Provide dog waste bags (1)
- Consider separation of dogs off-leash area for larger or smaller dogs (1)
- Include plaza near subway station (1)
- Reduce lighting at night (1)

- Consider diverse park users (e.g., students, families, seniors, dog owners etc.) (1)
- Design Concepts 2 and 3 feel cluttered (1)
- Allude to “Garden District” and local heritage in design of park (1)
- Avoid overly formal/contemporary sculpture or art (1)
- Include garbage receptacles and needle disposal boxes (1)
- Concern about how public washrooms will be maintained (1)
- The Creek design may have bad sightlines (1)
- Ensure sacred fire space in the park (1)
- Consider surface materials on pathways to ensure accessibility long-term (1)
- Provide plenty of seating (1)
- Plant cherry blossom trees in the park (1)
- Include design features for diverse community members (e.g., cricket pitch, bake oven) (1)
- Consider open water feature in park alluding to creek (1)
- Preference for natural materials (1)
- Include educational plaques near trees (1)
- Include Indigenous art/sculpture (1)
- Ensure park remains safe for unhoused residents (1)
- Consider low-maintenance vegetation (1)
- Prioritize children’s use of the park (1)
- Improve shade lost by tree removals through shade structures (1)
- Include playground elements for children with physical disabilities (1)
- Move community garden closer to John Innes and reduce in size (1)
- Park design should include residential use (1)
- Include flat surface for activities like BMX bikes, skateboarding, rollerskating (1)
- Connect with pedestrian crossing at George Street (1)

APPENDIX A

Survey Questions

1. Concept Design 1 – The Grid

[Response options: Strongly agree/Agree/Disagree/Strongly disagree]

- I like the width of the pathways in this design (main paths will be wide enough to comfortably accommodate several people walking at the same time and people using mobility devices)
- I am satisfied with the access paths in the community garden area in this design
- I like the size and layout of the Off-Leash Area in this design (general location of the Off-Leash Area is fixed to the south west corner of the park)
- I am satisfied with the connections between the park and the neighbourhood in this design
- I am satisfied with the size of the community garden in this design
- I am satisfied with the location and form of the pathways in this design

2. Concept Design 2 - The Creek

[Response options: Strongly agree/Agree/Disagree/Strongly disagree]

- I like the width of the pathways in this design (main paths will be wide enough to comfortably accommodate several people walking at the same time and people using mobility devices)
- I am satisfied with the access paths in the community garden area in this design
- I like the size and layout of the Off-Leash Area in this design (general location of the Off-Leash Area is fixed to the south west corner of the park)
- I am satisfied with the connections between the park and the neighbourhood in this design
- I am satisfied with the size of the community garden in this design
- I am satisfied with the location and form of the pathways in this design

3. Concept Design 3 - The Meander

[Response options: Strongly agree/Agree/Disagree/Strongly disagree]

- I like the width of the pathways in this design (main paths will be wide enough to comfortably accommodate several people walking at the same time and people using mobility devices)
- I am satisfied with the access paths in the community garden area in this design
- I like the size and layout of the Off-Leash Area in this design (general location of the Off-Leash Area is fixed to the south west corner of the park)
- I am satisfied with the connections between the park and the neighbourhood in this design
- I am satisfied with the size of the community garden in this design
- I am satisfied with the location and form of the pathways in this design

4. What type of playground do you prefer? Select all that apply.

[Checkbox]

- Natural material play equipment (such as wood, rope and stone)
- Combination of natural material and colourful traditional play equipment together
- Colourful, traditional metal play equipment (metal climbers and slides)

5. The playground could be developed for the next stage of the design based on a theme which reflects a unique aspect of the Moss Park neighbourhood and the park's history. Which theme do you prefer for the playground?

[Checkbox]

- Buried Moss Creek theme
- Garden District theme
- I want to suggest a theme [open comment box]

6. Size of playground and splash pad areas.

[Checkbox]

- I prefer the playground larger than the splash pad
- I prefer the playground and splash pad about the same size
- I prefer the splash pad larger than the playground

7. Would you like to provide more feedback on the playground and splash pad?

[open comment box]

8. Which type of seating do you prefer?

[Most preferred/preferred/neutral/least preferred]

- Individual armchairs
- Large, communal picnic tables
- Lounger
- Café tables and chairs (fixed in place)
- Standard size picnic tables
- Comfortable benches with backs and armrests (armrest are required to meet Toronto Accessibility Design Guidelines)

9. Would you like to provide more feedback on park seating?

[open comment box]

10. Would you like to have a pickleball court as a shared use with tennis courts in the park?

[multiple choice]

- Yes
- No
- Not sure, I need more information about pickleball.

11. Would you like to provide more feedback about the joint use of the tennis court?

[open comment box]

12. Is there anything else you would like to share with us about any of these design options?

[open comment box]

APPENDIX B

Open-Ended Comments Log*

*As per the City's Human Rights and Anti-Discrimination policy, xenophobic, misogynist, homophobic, transphobic, anti-Indigenous, ableist, ageist or other forms of discriminatory, prejudicial, exclusionary or hateful comments or questions have been removed in this document.

Playground Theme

- baseball
- no syringes no broken glass no adults not supervising kids. fence around it.
- Moss. Fuzzy
- giant garden
- Children having outdoor fun theme
- Something Indigenous
- Indigenous Theme (7 grandfathers?)
- historic 19th century garden, floral richness and heritage to restore this part of town.
- Like a park but a jungle oasis , a park in the forest some interesting interplay between these ideas.
- Not sure.
- something relating to indigenous land-- if this is appropriate and done in consultation with indigenous communities.
- Everyone can play together- a focus on how different people of different cultures and social classes live in the neighbourhood and, how people with different physical abilities can use different equipment and all share the park
- An Indigenous theme created in partnership with the Indigenous stakeholders. Not sure if that is what the Buried Moss Park Creek theme is. If so, then that theme please. A playground colour scheme with orange would be a nice tribute to the lost indigenous identities and lives of students in the Residential School system.
- No theme, just make it a normal playground
- Reduce park size and sell surplus for hi-rise residential use
- Forest of hope

**One open-ended response omitted from this section.*

Playground and Splash Pad

- I think it's really important for kids, especially in a city as dense as ours, to learn and play in the most natural setting possible. Natural play areas open so many doors for imagination than typical steel play structures.
- Playground for children, adults can enjoy splash features too.
- If the Creek option 2 had a larger playground, similar to the Meander option 3, that would be nice.
- No
- Outdoor skating for winter
- Playground space is more important because it can be used year round. SplSh pad only for summer.
- splash pad is seasonal
- There is a lot of grass areas in the park for the children to play on therefore a larger Splash Pad would be great.
- Please remove the spot lights at night. I live across from the park and the light pollution makes it hard to sleep at night

- No preference
- Please also provide outdoor fitness equipment for adults.
- Refer to Ramsden Park design
- A -----tent encampment like the rest of Toronto parks. Additionally the city cannot maintain parks so who cares!
- The drug problem in the neighbourhood prohibits many families from using the playground. City needs to address this
- I often go past parks and note that the splash pads are underused while the playgrounds are busy.
- Make the beeper button hyper expressionable if that's a word, an easy button to press for splash pad
- Currently the splash pad is not in use. I propose we eliminate it or turn it into variable fountain feature.
- Should have no ---- encampment features.
- Creative structures like St. James / St. Lawrence park. Picnic tables for parents.
- The largest playground and splash pad possible.
- The splash pad is only used 4 months of the year. It makes sense to have a larger playground area than splashed.
- Since the splash pad is only used two months of the year, I question the necessity.
- The playground space should be of soft, natural element orientation working with the natural order of things so as to assist in the overall maintenance requirement by letting it age gracefully rather than simply breaking down and becoming unsightly and hazardous by the 20 year mark. The water play area should also make use of simple mechanical parts with basic at grade or slightly higher water jets and eliminating superfluous play toy that just get damaged or don't last.
- The splash pad is unusable for most of the year and you have a high density of families in condos and apartments. Please give us a bigger playground so our children have ample safe outdoor space to play in year round.
- Playground can be in use nearly all year.
- The Splash Pad will be largely inaccessible for the majority of months due to Canadian weather. Moreover, I envision potential problems with children who are barefoot and improperly disposed needles scattered on the splash pad.
- Fenced in with something for newborns- teens would be great.
- The playground has a long period of usefulness throughout the year whereas the splash pad can only be used for a 3-4 months
- Designated dog splash fountain would keep dogs out of the kids ones
- Lots of seating for parents and oriented facing inward away from traffic

**One open-ended response omitted from this section.*

Park Seating

- Benches with backrest in both shaded and non shaded locations
- Should be flexible and have multiple options
- Moss Park and Allen Gardens both have had inadequate seating for way too long and I believe it's reflection of the city attitude towards certain groups of people.
- loose furniture will get vandalized or stolen
- It will get stolen or used as a weapon if it's not fixed in place.
- Please choose objects with aged/infirm in mind. Supportive backs required.acks needed
- Please ensure that seating does not encourage people to sleep on the seating. This discourages others from using the park
- No
- No hostile architecture, please.
- Please use benches that are comfortable and ergonomic and don't have many armrests.

- A --- tent encampment like the rest of toronto parks. Additionally the city cannot maintain parks so who cares!
- queens park curved metal and oak/teak historic inspired is ideal to add heritage and quality -think formal Paris garden
- There are a lot of families in this neighbourhood both in TCH, rental and condos, the more family friendly we can make the park the better!ourhood ev
- You need to be careful as homeless people will sleep on loungers
- Fixed in place seating need to have space for accessibility devices.
- no hostile design
- I like the swivel chairs as an introvert. It has the option to turn away from people if I am not feeling them.
- Park seating should not accommodate overnight visitors.
- I wish the pictures were bigger.
- Large benches can become beds. If that's desired then they are great. If not, then don't use them.
- I think it should not encouraging loafing by the homeless. Everything should be optimized to make it impossible for it to be turned into a place for the homeless to squat on permanently, because then the park will become hostile to residents with children
- A variety of seating options is best allowing for coffee chats, board games and community gatherings. Traditional benches are good for accommodating solo users comfortably if they're waiting for something or some one.
- Picnic tables should be wheelchair accessible. Benches should be comfortable and not have hostile elements of design that prevent people from lying down. This country has failed to care for its most vulnerable and if there is no shelter space, the least we can offer is a comfortable bench.
- I would prefer park seating that is accessible to people with disabilities but that is also welcoming and people of larger sizes and then I housed population that frequents moss park and may use park seating for sleeping or shelter
- I hope that you can add chess board tops to encourage intelligent play as well.... also no grass too much water waste.... Environmentally responsible planting use purple thyme for instance as grass and cut down on maintenance
- Large community tables could become intimidating for small children
- Let's eliminate "unkind architecture " and make benches wide enough to accommodate people lying down and sleeping on them.
- To make sure there is accessible seating for individuals who are not able-bodied. The anti-homeless engineered seating should be placed closer to the children's play areas. But there should be homeless engineered seating arrangements provided, just further away from designated children's play areas. Re: Splash pad & used needles.
- Easy clean surfaces. Communal table might be attractive as encampment sleeping platform.

**Two open-ended responses omitted from this section.*

Pickleball

- I play tennis, and if the ground has any kind of design or stripes other than the traditional lines, it will make it difficult to see the ball when it bounces off the courts.
- Would it take up the same space or require more space to have both?
- provide cover for winter use or have another use during off season (winter) such as skating
- It would be great of vourts could be multipurpose to accomodate volleyball, pickleball, badminton, etc
- You should have told us more about it before asking. First I've heard of it.
- Can you add some outdoor ping pong tables?
- No
- Tennis is a dying sport. Courts should be repurposed in the winter
- Pickleball can use tennis courts, not the other way around. It also feels shortsighted to build a park around a trend rather than a hundred and fifty year old immensely popular sport.

- Pickleball is a loud sport so including this could be risky.
<https://www.youtube.com/watch?v=5bp-0aaXYsA>
- Pickle ball is a fad, this park won't be renovated for another 50 years
- YES! This is a great idea.
- Pickleball is growing rapidly tennis is in decline. Also the nature of the game and the size of the courts, more people can participate. I would suggest ALL Pickleball.
- A --- tent encampment like the rest of toronto parks. Additionally the city cannot maintain parks so who cares!
- Please keep courts clean of garbage. Thanks
- the tennis courts make the park more safe
- A sport that is growing in popularity and local leagues could create community links.
- The tennis courts are already highly in demand in the warmer months with people waiting. Adding another court would be ideal.
- Pickles should remain on sandwiches.
- As long as it doesn't compromise its tennis use...
- Pickelball is the latest craze these days. Not sure how long it will be though.
- No, keep it to just tennis please
- The sport is a passing fad I would prefer a baseball/disc/cricket. Things that the park has been used for in the present and past
- Idk anything about pickleball.
- I will never use either of these features. I mostly see people using tennis courts for other purposes like dog training.
- Pickleball will provide use to a larger group of people.
- Also allow for other activities like badminton or roller skating (that don't need changes to the court)
- lines are already long enough with just tennis.
- Location pinches pathway on west side

General Comments

- Want to propose something,for the Option 1 design, I notice that there are lots of #14 areas, scattered all over. Might you consider increasing the dog off-leash area southwards by removing the #14 area below it. You would still have 2 to 3 other #14 areas. In the short few months that I have been overlooking the park the most usage I see is from dog owners. I think it would be nice to give them that little bit of extra space as I often see the owners making their dogs run quite a long distance to play fetch.
- I prefer the one that plants the most trees back into the park. As well, these trees should be as mature as possible seeing as the loss of 60 mature trees and 18 more significantly impact the beauty of this park and will take years to replenish.
- The trees around the community garden should be planted in a way that does not shade the growing area in the community garden.
- where is the parking?
- native edible plants as part of the greenery to add to food security
- Pembroke being a central point of the design feels like a mistake. More acknowledgment of the armoury makes sense. Moss creek is exciting! Finding a balance between the city and nature is a worthy aim. Impoverished communities would appreciate the splash pad more than the playground for cooling off in the summer, due to lack of access to air conditioning, the community centre may become a warming centre so it should be a focus as well, like the community garden
- ensure the park has different elevations. Liked the first intintial design with bridge and varied elevations & pine trees to have green for winter
- There should not be a fence between the new and old old facilities as it creates a dead end and potential for for unsafe interactions. Also the Pembroke/Shuter intersection should have a more grand widened plaza to celebrate it's importance to Allan Gardens eg. seatings and planting

beds. Also, ensure north-south connections from George or Pembroke towards Queen read as stronger/more obvious pathways... currently the organic layouts get lost a bit in legibility.

- People will create their own access routes if they don't like what is provided, resulting in lawns and planting being trampled. Snow removal and salt use need to be considered.
- Just make sure if you build it that you maintain it. So frustrating to see lively new parks quickly slide into disrepair and you know this one will take a beating.
- I'm a single-issue voice from the community. Removing the baseball diamond and not replacing it is a big loss for the community, and any baseball/softball players on the east side. This is especially true for adult games that need slightly larger diamonds and those who don't have cars to drive to suburban fields.
- I am not sure I like the idea of having such a large section of all designs dedicated to an off leash area, I find it excessive, while I understand the need for it. My main concern is about ensuring proper maintenance to prevent funny smells from taking away the enjoyment of the park by other people.
- The designs are great and will fit well into the community. I am not sure what Pickle Ball sounds like an elitist sport for condo dwellers not taking into account the many people who live in apartments and inner city kids in this neighborhood.
- Parks are needed for people. Dog OLAs should be separated in smaller locations.
- Please be sure that there are no areas that are easy for predators to hide and attack people such as high bushes and low lighting should not be in the design. This park is well known for drug use so find a way to discourage this!
- Get rid of the community gardens the Existing ones are poorly maintained and attract rats and other unwanted wildlife
- what is the city's proposal regarding security in the park to maintain a safe childrens playground/splashpad?
- How is the city going to help address the issue of homelessness, crime and addiction in the area? Beautiful space, but if it continues to feel so unsafe, specially around late hours it doesn't feel like it truly would serve the community?
- Permeable softer permeable pavements would mitigate flooding and safer for children.
- Looks good!
- Looking forward to it
- Need to consider outpace in winter time. Outdoor skating pad or some small hill for sledding
- Safety around subway station and homeless shelter across street
- Seating should accommodate people who wish to lie down and rest in the park, especially since there is a lack of affordable housing in the city and we have many homeless neighbours.
- More trees please
- The basketball courts should have more than 2 hoops each, i.e. there should be more hoops on the sides of the court (vastly expands the max amount of players using the court), and the court should be surfaced with rubber, not asphalt. Rubber courts are much safer and a much better playing surface for players, and far easier on the joints. Adult recreational players have to limit their time on asphalt/concrete courts because the impacts from jumping are too hard on the joints. Concrete/asphalt courts also destroy basketball shoes and balls very quickly, and the cost of replacing shoes can add up quickly.
- I think the community garden should be as large as possible
- Would there be water access for the Community Garden. Say an Underground Hose from the Community Centre to the Garden. Would there be Dog Poop Bag Dispensers in the Dog Park & Would there be a Separation in the Dog Park between the Larger Dogs & the Smaller Dogs. If Larger Splash Pad area a Life Guard should be there for First Aid.
- A lot of people will likely cut through the park to get to the subway entrance, so there should be wide, diagonal paths through the park. Otherwise, people will cut through the centre lawn and compact the soil and wear out the grass. 'The Creek' does the best job of that. It would be nice if

the park could better take advantage of the future subway station entrance (and to coordinate design work with the subway entrance). A small plaza in the park near the entrance could allow for markets and a meeting place. There should be doors on the entrance both facing the park and facing east.

- I don't think there should be a ceremonial fire for safety concerns.
- Please remove the spotlights at night. The light pollution is disrupting sleep for residents around the park
- Thanks for the hard work
- I like the proposed designs. It's important to consider all users of the park - families with children, youths (from TMU and other post-secondary), young professionals (especially in the condos), adults, individuals being served by the neighbouring drop-in shelters, etc. It is quite a diverse group and the design options should cater to all. For example, individuals being serviced by the nearby shelters enjoy sitting by the trees during the summer, and can benefit from having outdoor exercise equipment that are not just for children. There are a lot of dog owners nearby, so the dog park is a good idea. The tennis court and basketball courts are very busy in non-winter seasons. Park benches are also well-utilized. This is a very busy park and should cater to all user groups.
- I find both Concept 2 and 3 unnecessarily fussy and cluttered
- No off-leash area please
- Over illuminate for night
- upgrades to Moss Park are much needed, and thanks for the consultation
- They are not fabulous but have potential. Refer to heritage, and formal floral gardens to make a grand statement that is worthy of the garden district. Refrain from excitedly weird sculptural contemporary austerity. Formal rows of trees, a fountain and lots of flowers.
- The design options must include lots of garbage receptacles and dare I say it, something for needles given the high number of addicted people in the Moss Park neighbourhood! I am also VERY concerned about the public washrooms which are absolutely essential but given the number of homeless folks, how will these washrooms be maintained? The Tim Hortons at the corner of Richmond and Sherbourne is experiencing a lot of issues with the facilities being used to sadly 'shoot up'.
- Please include as much trees as you can.
- The creek has inefficient paths with bad sightlines and a suboptimal use of space. Worst design by far
- There should be a sacred fire located in the park
- The curvilinear and freeflowing designs reflect the natural world better than a grid and are more conducive to wandering and slowing down.
- More greenery the better. There should be also almost greenery spaces with rocks so it can create a more 3D surrounding
- Nice that the city is investing in these changes
- Surface materials of pathways need to be seriously considered to ensure accessibility on opening day and for years to come. Locations for snow piling need to be identified.
- Pls pls provide seating galore
- Please plant cherry blossom trees to help soften the neighbourhood. Also winter greenery is also needed!
- No homeless camping.
- Yes, I was going to say that I hope you add at least a few coniferous trees. I know that they generally provide less shade, but it gives a bit of greenery and life to the space in the winter. I personally like white pines, I'd think of putting one in the middle of the grassy area since they apparently don't do well with salt. I suspect that's not an option, but really even if just a few of them could be like blue spruces or something, it might make a difference. I'm kind of tired of seeing 100% lifeless trees all winter.
- How about the connection of all 3 designs to the actual Moss Park community to the east (TCHC Housing)? More design features for this very diverse and marginalized community please. I suspect that members are not too enthused by tennis or pickleball. Maybe another sport

(cricket?). They also need more food-growing space over running space for dogs. Also, more space for cultural community events (a small space, barbecue or outdoor baking oven space, like in Thorncliffe Park). I am wishing for the sake of these neighbours that gentrification will be curtailed.

- No off leash dog park. St James is a mess and it's not even off leash but residents treat it as such
- The centre area will most likely turn into a thoroughfare so people can cross the park faster. Loss of baseball diamond and playing field is a shame
- Really like the old river design - I think that pipe should be exposed and have running water in the park...
- I want a soccer field
- Lots of green spaces and trees !!
- I like them all. Generally speaking, I prefer natural material - especially local hardwoods - and soft curves rather than harsh angles/lines. Just make sure it doesn't become a place for the homeless to just loaf around.
- Would like to see small pocket woodland planting vocabulary incorporated into the design with natural understory and minimal turf cover. This downtown core area simply does not have much greenspace access at all and tree canopy should be encouraged with plaque descriptions of what is trying to be achieved for the benefit of the users and neighbouring community. Explain the relevance of the plant community's and possible links to the sites history. Also, encourage soft, permeable access surfaces where feasible.
- The sculpture should be by a indigenous artist or there should be a sacred flame instead for the configurations that omit the flame.
- It seems that you have not considered a baseball, cricket or frisbee. I want large open air sports area that is more multiuse and has been used for that in the past.
- Width of sidewalks asked about very unclear since actual measurements not provided and no scale on drawings. Community garden should not be individual plots (so few plots given the size of community who will they go to?) should be managed with community centre. Also currently very shaded and the amount of shadowing on garden will be important.
- As far as I can tell none of these designs meet my primary requirement for Moss Park which is to make it safe and welcoming for the unhorsed population that currently makes up a large proportion of Moss Park visitors. I want Moss Park to remain a space where I housed residents feel welcomed and safe.
- 'The Grid' feels counter to typical walking patterns, especially once the subway station is operational – many desire paths are likely to form in absence of better options ('The Creek' seems much more in tune with this).
- the more healthy trees, the better
- My biggest priority is a bigger dog park (with wood-chips or grass, but NOT pebbles).
- Environmentally friendly planting.... instead of grass use purple thyme to cut down on water and maintenance.... planting of wildflowers that will come back every year.... don't cut the old trees if you can help it because the fauna that protects the trees takes twenty years to grow so you have to care for them for 20 years when you plant a new tree.... but the trees are the most important part of your plan.... also rooftop solar and heat/cool pump technology.... active and passive!
- Given the many objectives for a relatively small park, I do not believe that the allotment gardens are a good use of the available space. They serve the needs of a very small number of people from a relatively large community population (I think you suggested 20 plots). If a contribution to food security is deemed important for the community, then I believe a different approach is required. Possibly a different location for some type of community garden is more appropriate.
- Please make local children's use of the space a priority
- I favour Option 2 best, the more natural look and call back to the old Creek
- well lit, walking pathways
- I strongly dislike the grid option. Feels unnatural. The other two feel more inviting and feel like nature.

- Shade that has been lost by the removal of mature trees needs to be immediately replaced. Shade structures or awnings should be installed, even just for the first 5-10 years until the new trees can grow enough canopy to provide cooling shade
- The more dense the tree line the better. The more natural the path going through these trees the better. Make it an escape from the city and for it to seem like you are in real nature. Stay away from monoculture. Trees are nice and all but we need a diversity of plants for it to be a sustainable ecosystem. Check out plants that compliment the tree species you are planning to plant. There's multiple layers in a forest (big stuff including trees, middle layer with bushes, then undergrowth). They all work together and need each other.
- Super happy the park and CRC will be upgraded. However, the demand is also there for an upgraded arena, with seating and a larger ice surface, or a two pad facility.
- Each design should meet the higher end of the tree plantings and reduce the pavement as much as possible. The gardens should also be bigger. Additionally, there is a move towards removing all fire pits throughout the city, due to the lack of fire safety and the destruction people cause to the surrounding ecosystem by burning all the logs, sticks, etc that are needed for the ecosystem to thrive. I don't see this fire pit being used properly, especially due to the large homeless population in the area, so I foresee many potential problems. Please reconsider the firepit and consider adding more gardens.
- Designing a playground that includes structural play elements for children who are not able-bodied would be a wonderful consideration. I would also like to advocate for the inclusion of additional parking space for patrons of the arena.
- needs way more parking especially for when the arena is in use.
- There needs to be more parking for community centre and arena users.
- I don't like the grid concept, much prefer the two other designs that have a more natural flow
- Yes. Would be beneficial for those who work at, provide services, and assist with the recreational programs at both Moss Park Arena and John Innes Community Recreational Centre to have additional and expanded 'free' parking as these individuals have been a tremendous help in bringing a strong community to these facilities. Perhaps a tap card system or a code to enter the parking area could be provided and set up. Even parking somewhere in the back of the arena should be considered. Many travel a great distance and these individuals have made these facilities operate at a full-scale capacity which has been quite profitable for the city. Thanks.
- Must have larger & more parking spaces for Rec. Centre & Arena patrons. Possibly underground P parking?
- Adding more trees after such a loss is a start, perhaps opportunity to tree spade larger cal trees can be explored. Curvilinear seems the most fitting for desire lines. Just keep in mind cpted, it's a pretty uncomfortable area at night and in general
- I love design three. Two is also good. I dislike design 1. It is too linear and not creative at all
- Please provide more parking space around the arena
- The the community garden should be closer to Innes Centre and basketball courts and not as large
- Survey is designed only to support a park. We need to allow hi rise residential use combined with parks. We have many parks in the area. Adelaide/ Church to the south and Allen's Gardens to the north
- There needs to be a large space for frisbee , football, soccer etc Kids, students, adults do not need everything planned out for them. Wide open spaces in this are - for the amount of density happening now and in the near future is needed.
- A late suggestion, but a skatepark or flat concrete/ashalt surface would be good for multiuse (BMX bikes, skateboards, rollerskates)
- Best to connect with ped crossing at George. Lots of people crossing to catch streetcar at Queen Jarvis and will connect to subway entrance

**Six open-ended responses omitted from this section.*