

# Don Mills Community Recreation Centre

## SUMMARY REPORT:

## Public Meeting #1 + Public Survey #1

February 17, 2023



# Table of Contents

|  |                                     |
|--|-------------------------------------|
| <b>1.0 Introduction</b>                                      | 3                                   |
| 1.1 Project Context  | <b>Error! Bookmark not defined.</b> |
| 1.1.1 Project Scope  |                                     |
| 1.1.2 Key Project Components                                 |                                     |
| 1.1.3 Project Schedule                                       |                                     |
| 1.2 About this Report  | 6                                   |
| 1.2.1 Engagement Timeline                                    |                                     |
| <b>2.0 Engagement Overview</b>                               | 7                                   |
| 2.1 Engagement Objectives                                    | 8                                   |
| 2.1.1 Engagement Approach                                    |                                     |
| <b>3.0 What We Heard</b>                                     | 9                                   |
| 3.1 Key Insights   |                                     |
| 3.2 Public Meeting #1 Summary                                | 10                                  |
| 3.2.1 Public Meeting Participation                           |                                     |
| 3.2.2 Summary of Feedback from Public Meeting #1             |                                     |
| 3.3 Public Survey #1 Summary                                 | 13                                  |
| 3.3.1 Public Survey Participation                            |                                     |
| 3.3.2 Summary of Feedback from Public Survey #1              |                                     |
| <b>Appendix A</b>  | 17                                  |
| Public Meeting #1 Presentation                               |                                     |
| <b>Appendix B</b>  | 32                                  |
| December 15, 2022 - Public Meeting #1 Questions and Comments |                                     |
| <b>Appendix C</b>  | 35                                  |
| Community Advisory Committee Selection Process               |                                     |

# 1.0 Introduction

A new Community Recreation Centre (CRC) is coming to the Don Mills community, near the intersection of Eglinton Avenue East and Don Mills Road.

This large, integrated, and multi-component facility will offer the diverse and growing communities of the Don Mills Corridor and beyond a range of year-round programs and services. Located at the former Celestica Lands site at 844 Don Mills Rd., the new CRC will be next to a new large park and all within walking distance of a planned Eglinton Crosstown Light Rail Transit (ECLRT) station and is part of the ongoing implementation of the [Parks and Recreation Facilities Master Plan](#).

## 1.1 Project Context

### **Previous Community Engagement: Recreate Don Mills**

In early 2019, community and stakeholder engagements were conducted to determine the CRC location that would best meet community needs. Two location options were presented to the community.

The results indicated that locating a large 'one-stop' community recreation centre with arena, aquatics facilities, full gymnasium and multipurpose room uses at the former Celestica Lands (844 Don Mills Road) was preferable to two separate facilities.

Based on the outcomes of the 2019 community engagement and recommendations by City staff, City Council directed the City to [proceed with the Preferred Facility](#) on the former Celestica Lands site.

### 1.1.1 Project Scope

The community engagement and design process for the Don Mills CRC will consider only the amenities, programs and services within the CRC located on the former Celestica Lands.

Separate community engagement processes will be held for the design and programming of the one-hectare park next to the Don Mills CRC.

The proposed CRC will include:

- An indoor twin ice pad arena / multi-use indoor sports field
- A large indoor lap and leisure pool
- A double gymnasium
- Multi-use community and activity spaces

## 1.1.2 Key Project Components

### Draft Design Principles and Big Moves

The following seven *Design Principles* and three *Big Moves* serve as guidance to steer the vision of the project. They have been workshopped with input from City of Toronto recreation staff and will be confirmed with the public and Community Advisory Committee (CAC) throughout this Phase of the project.

**DESIGN PRINCIPLE 1:** Physically design spaces to support equitable access for all people, regardless of income, race, gender, ability, age, culture, housing status, religion, or spoken language, and to ensure all feel welcome, a sense of belonging, and do not experience barriers to participation or access.

**DESIGN PRINCIPLE 2:** Based on interest from the Mississaugas of the Credit First Nation (MCFN), complete adequate consultations with MCFN for each phase during the design process (i.e. Sharing/Learning Circles).

**DESIGN PRINCIPLE 3:** Incorporate ambitious Net-Zero emissions (energy) goals and environmentally- progressive design and processes throughout the construction and operations of the new Centre. Avoid implementing pool covers.

**DESIGN PRINCIPLE 4:** Ensure integration between the building and the park. Provide integration between indoor and outdoor spaces throughout the year, as weather permits.

**DESIGN PRINCIPLE 5:** Incorporate community meeting spaces and the ability to host local events (i.e. games night, fundraisers) in multipurpose and outdoor spaces whenever possible.

**DESIGN PRINCIPLE 6:** Avoid placing electrical panels in the storage rooms.

**DESIGN PRINCIPLE 7:** Consider best practices and successful design features from the Regent Park Aquatic Centre and Canoe Landing.

**BIG MOVE 1:** Connect the recreation centre to the larger site and park by providing integration between indoor and outdoor spaces to support recreation and community activities throughout the year, as weather permits.

**BIG MOVE 2:** Design to maintain and support the social and community-building activities of existing public spaces.

**BIG MOVE 3:** Build a targeted Net Zero Emissions/(Energy) Building, and avoid implementing pool covers.

### 1.1.3 Project Schedule

- Fall 2021: Hire a design team
- **WE ARE HERE - Summer 2022 to Summer 2023: Community engagement and design development**
- Winter to Fall 2023: Detailed design
- Spring 2024: Hire a construction team
- Summer 2024: Construction starts
- Winter 2027: Construction complete, Community Recreation Centre opens

## 1.2 About this Report

This meeting summary report, prepared by SAFFY, summarizes the key findings that emerged during the first public meeting for the Don Mills Community Recreation Centre project, held on December 15, 2022, as well as a public survey that was live from December 15, 2022 to February 5, 2023.

### 1.2.1 Engagement Timeline

The following is a list of upcoming public engagement activities (schedule is anticipated and subject to change as the project progresses):

- **Public Meeting #1: December 15, 2022 (COMPLETED)**
- **Public Survey #1: December 15, 2022 - February 5, 2023 (COMPLETED)**
- Public Meeting #2: Spring 2023
- Pop-Up Engagement #1: Spring 2023
- Public Survey #2: Spring 2023
- Public Meeting #3: Summer 2023
- Pop-Up Engagement #2: Summer 2023
- Public Survey #3: Summer 2023

## 2.0 Engagement Overview

### 2.1 Engagement Objectives

The goal of this phase of engagement was to provide an overview of the Don Mills Community Recreation Centre project, create a shared community vision for the Community Recreation Centre, and share ways for the public to get involved as the project progresses.

This phase of engagement includes the following activities:

1. Public Meeting (including interactive engagement activity)
2. Public Survey
3. Formation of a Community Advisory Committee (selection process described in Appendix C)

#### 2.1.1 Engagement Approach

**Public Meeting Structure:** During the 1.5-hour virtual public meeting, the City of Toronto, SAFFY, and MJMA Architecture & Design guided participants through a presentation about the new Community Recreation Centre (see Appendix A for presentation slide deck). The Project Team facilitated a discussion to answer initial questions about the project, before moving into a short engagement activity to gather preliminary feedback on the community's vision and preferred programs and activities for the new community recreation centre.

Project context including the timeline for the development of the Don Mills Community Recreation Centre, site context, and the future park that will accompany the centre. The project team provided an overview of the key project components that are confirmed to be included in the design of the community recreation centre, including a double gym, two pools, multi-use community and activity spaces, and an indoor twin ice pad. MJMA presented a series of case studies to inspire community members around potential design and programming opportunities.

The engagement activity utilized an online tool that allows participants to submit responses to a series of questions, which were then visualized on screen. Participants were asked the following questions:

1. *What are some key words you would use to describe the vision you'd like to see incorporated into the new Don Mills Community Recreation Centre?*
2. *What are some key words you would use to describe the feelings that you hope community members experience after visiting the new Don Mills Community*

### *Recreation Centre?*

3. *Which programs and activities have you enjoyed in other community centres and would like to see at the new Don Mills Community Recreation Centre?*

**Public Survey Structure:** The public survey was advertised on the Don Mills Community Recreation Centre project webpage, social media and project signage between December 15, 2022 and February 5, 2023. The survey asked the same questions that were presented during the public meeting, listed above, in addition to an open-ended question for general comments. This survey collected demographic information of participants.

**Formation of a Community Advisory Committee:** A Community Advisory Committee has been established (see Appendix C for detailed selection process). The purpose of this committee is to help guide the design of the new Don Mills Community Recreation Centre, helping to ensure that the project meets community needs.

The first Community Advisory Committee meeting will take place on February 1st, 2023. Members will participate in an exercise to compile results from the public meeting engagement activity and public survey responses to co-create a vision statement for the new Don Mills Community Recreation Centre. The vision statement will be referenced throughout the various phases of the project to ensure that the design and programming options meet community needs.

A summary report for the Public Survey #1 and Community Advisory Committee Meeting #1 (including results of the vision statement exercise) will be posted on the project webpage once complete.



## 3.0 What We Heard

The following section contains a summary of the feedback received during Public Meeting #1. See Appendix B for full documentation of comments and questions shared during the open house.

### 3.1 Key Insights

Key insights that have emerged from Public Meeting #1 and Public Survey #1 are consolidated by the themes below.

#### **COMMUNITY**

During the public meeting and public survey, participants shared their desire to have the Don Mills Community Recreation Centre become a space for all members of the community, with conversations centred around inclusivity and connection. In addition to suggestions for programming and amenities, participants expressed that the space should also function as a community hub or gathering space.

#### **DESIGN CONSIDERATIONS**

Although preliminary design concepts were not shared at this meeting or through the survey, participants were keen to provide recommendations on the design of the Don Mills Community Recreation Centre, with a preference for ensuring plenty of natural light and for sustainability to be considered in the design. Participants would like physical accessibility and clear signage included in design considerations.

#### **HEALTH AND FITNESS**

Participants provided a range of suggestions for programming, spaces and amenities they wish to see at the Don Mills Community Recreation Centre, and envision health and fitness drawing community members to the space. There was mention of culturally-appropriate programs like cricket, as well as programming that catered to key demographic groups like youth, seniors and people with disabilities.

## **3.2 Public Meeting #1 Summary**

### **3.2.1 Public Meeting Participation**

WHEN: December 15, 2022, at 5:30 - 7:00 p.m.

WHERE: Virtually on Webex

ATTENDEES: 30 participants

PROJECT TEAM: City of Toronto – Parks, Forestry & Recreation Division  
SAFFY (Public and Stakeholder Engagement)  
MJMA (CRC Architecture & Design)

### **3.2.2 Summary of Feedback from Public Meeting #1**

#### **General Comments**

In general, participants were eager to ask questions and provide initial insight into the design and programming opportunities for the Don Mills Community Recreation Centre. During the question and answer session, and throughout the remainder of the meeting, participants asked questions using the chat function on Webex. The project team was unable to answer all of the participants' questions and will work to address frequently asked questions on the project webpage and in future communications.

#### **Logistics**

Participants had questions around the logistics of Don Mills Community Recreation Centre's design and construction, including the process leading up to the first public meeting. Participants asked how the design team was selected, how long construction is anticipated to take and when the centre will open its doors. These questions were addressed by the project team and are listed in Appendix B.

#### **Sustainability**

Questions and comments about how the Don Mills Community Recreation Centre might incorporate sustainable design elements were common during the meeting. In particular, participants asked whether waste heat from the ice rink might be used to heat the aquatics facilities and whether the building would achieve LEED certification.

## Engagement Activity

Responses on the interactive engagement activity launched during the public meeting were generally centred around three themes: *inclusivity*, *design*, and *connection*. Participants also provided a range of programming suggestions, listed in the table below.

### Inclusivity

Participants frequently used the words *inclusive* and *accessible* to describe the vision they'd like to see incorporated into the new Don Mills Community Recreation Centre. Words and phrases such as "*community space for all*," "*includes all generations*," and "*all ages*" indicated participants' preference to create a space where inclusion is prioritized.

When asked which words they would use to describe the feelings they hope community members would experience while at the centre, similar words like "*safe*," "*welcome*," "*embraced*," and "*accepted*" were most common.

### Design

Participants often referenced design elements when asked to share keywords for the vision and feelings they hope to see incorporated into the Don Mills Community Recreation Centre. For example, "*modern*," "*natural light*," "*first class design/architecture*" and "*functional*" were shared.

### Connection

A range of keywords were shared that indicate respondents preference for the Don Mills Community Centre to facilitate community connection. These include "*neighbourhood hub*," "*community oriented*," "*hang out*," "*social*," and "*togetherness*."

## Programming Options

The following list details the programming options suggested by participants during the engagement activity.

### **Programming Categories**

- Seniors (6)
- Youth (3)
- Women's only programs (3)
- Baby and parent programs (2)
- Intergenerational (2)
- Special needs programs (2)
- Culturally diverse (1)
- Drop-in sports (1)
- People with disabilities (1)

### **Activities**

- Cooking classes (3)
- Visual art (3)
- Pottery (2)
- Knitting/crafting (2)
- Music (2)
- Senior social activities (1)
- Social activities (1)
- Conferences (1)

### **Ice Rinks**

- Hockey (2)
- Hockey year-round (2)
- Ice skating (1)
- Public ice skating (1)
- Skating rink (1)

### **Sports Areas**

- Basketball (3)
- Cricket (2)
- Ball hockey (1)
- Pickleball (1)
- Soccer (1)

### **Multi-Purpose Spaces**

- Meditation room (2)
- Multi-faith room (1)
- Community kitchen (1)
- Library (1)
- Quiet study rooms (1)
- Kids birthday parties (1)
- Community theatre (1)
- Community groups (1)
- Mental health programs (1)
- STEM classes for youth (1)
- Homework club (1)
- ESL tutoring (1)
- Childcare (1)

### **Fitness Areas**

- Walking/running track (7)
- Yoga (5)
- Tai Chi (2)
- Dance (2)
- Pilates (1)
- Functional fitness (1)
- Gymnastics (1)
- Gym (1)
- Line dancing (1)

## 3.3 Public Survey #1 Summary

### 3.3.1 Public Survey Participation

|               |  |
|---------------|--|
| WHEN:         | December 15, 2022 to February 5, 2023  |
| WHERE:        | Hosted on CheckMarket and advertised on the project webpage, social media and project signage between December 15, 2022 and February 5, 2023 |
| RESPONSES:    | 280 responses - 261 respondents completed the survey in full   |
| PROJECT TEAM: | City of Toronto – Parks, Forestry & Recreation Division<br>SAFFY (Public and Stakeholder Engagement)<br>MJMA (CRC Architecture & Design)     |

### 3.3.2 Summary of Feedback from Public Survey #1

#### **Inclusivity**

Survey responses for the new Don Mills Community Recreation Centre featured themes of inclusivity, particularly when respondents were asked about their vision for the CRC and the feelings they hope community members experience after they visit.

“Inclusive” was one of the most frequently used words within the survey responses along with “welcoming,” pointing to the importance of the centre providing safe spaces for community members to access.

Many respondents noted the desire for programs offered in different languages, and for some gender-specific programming. Within many of the responses that featured inclusivity were other notes on providing programs for all age groups, providing a welcoming space for diverse members of the community, and a safe and clean facility that is well-staffed, engaging, and easy to use.

#### **Accessibility**

A recurring theme for the vision of the new Don Mills Community Recreation Centre is accessibility for all ages and abilities. Accessibility issues such as parking and street access were mentioned, as well as the importance of the centre being fully wheelchair and stroller accessible.

Parking for both cars and bikes surfaced as an important feature especially with regard to seniors and older adults within the community needing low-cost parking options, as some respondents noted that walking or TTC is not a viable option for them.

Accessibility and the desire for a modern and clean space with clear signage that is easy to use were often paired together in survey responses. Comments around accessibility included economic considerations and the preference for the centre to be affordable for all community members.

### **Health and Fitness**

Respondents to the survey noted the importance of the Community Recreation Centre acting as a component of a healthy lifestyle for community members. Within the theme of health, respondents expressed the desire for a variety of fitness equipment and spaces, classes, activities, and wellness programming. “Health” was also featured as a key word when respondents were asked how community members should feel after visiting the new CRC.

Responses around preferred programming options included in the survey are listed in Table 2 below, many of which discuss the health and fitness amenities, activities and spaces respondents wish to see in the space.

### **Outdoor Spaces**

Survey respondents noted that they would like to see outdoor amenities such as a walking and running track, outdoor shuffleboard courts, well-landscaped gardens, a playground, and outdoor modular seating areas. Many survey respondents expressed the desire for outdoor areas to be available for both leisure and exercise.

While this reflects the responses received from the survey on the Don Mills Community Recreation Centre, the design and programming of the outdoor spaces are not within the scope of the current engagement process. Members of the community are aware of the park that is planned to be built adjacent to the centre, and are eager to begin to shape that project in tandem with the CRC.

### **Programming**

Respondents would like to see a diversity of programming and offerings, including daycare options, arts and culture classes/programs, fitness and exercise options, including a pool, full gym, weightlifting rooms, dance classes, skating rink, and ping pong tables.

Many respondents expressed the need and preference for age-diverse programming that is dedicated for children, teens, young adults, and seniors. Respondents noted that programs should be offered on both a drop-in and pre-registration basis.

Several respondents also expressed the desire for multi-purpose rooms that could be booked out for different ad hoc community uses. Library programs and reading areas were also frequently mentioned.

### **Cleanliness**

Respondents would like to see cleanliness prioritized for the new Don Mills Community Recreation Centre with most responses focusing on clean bathrooms, change rooms,

and showers, while other respondents noted the desire for well-maintained and clean outdoor spaces with garbage cans that are cleaned frequently.

### **Change Room Clarification**

Several survey respondents requested clarification of the design and availability of the CRC's change rooms. They expressed the desire for separate gendered change rooms, as well as a universal family change room.

### **Programming Options**

The following list details the programming options suggested by participants throughout the survey.

#### **Programming Categories**

- Seniors (18)
- Youth (11)
- Intergenerational (9)
- Culture (8)
- Baby and parental programs (7)
- Drop-in sports (7)
- Daycare (6)
- Special needs programming (2)
- People with disabilities (2)
- Women's only programs (1)

#### **Activities**

- Cooking classes (28)
- Visual art (20)
- Community groups (15)
- Adult learning (14)
- Interest classes (12)
- Social activities (10)
- Knitting/crafting (8)
- Indoor playground (5)
- Pottery (4)
- Senior social activities (4)
- Kids birthday parties (3)
- ESL tutoring (3)
- Health (3)
- Language classes (3)
- Music (2)
- Community theatre (2)
- STEM classes for youth (2)
- Homework club (2)

#### **Fitness Areas**

- Fitness general (50)
- Walking/running track (34)
- Yoga (32)
- Dance (29)
- Gym (21)
- Martial arts (14)
- Weight lifting (11)
- Sauna (6)
- Pilates (5)
- Gymnastics (3)
- Line dancing (3)
- Spin (3)
- Aerobics (1)

#### **Sports**

- Pickleball (24)
- Basketball (22)
- Volleyball (16)
- Tennis (16)
- Badminton (9)
- Soccer (9)
- Cricket (7)
- Ball hockey (7)
- Table tennis (6)
- Curling (4)
- Frisbee (4)
- Intramural sports (3)
- Bocce (1)

**Aquatics Programs**

- Swimming (120)
- Aquafit (11)
- Lane swimming (6)
- Swimming lessons (6)
- Water aerobics (1)
- Therapeutic pool (1)

**Ice Rinks**

- Ice skating (42)
- Hockey (18)
- Skating rink (10)
- Hockey year-round (4)
- Public ice skating (4)

**Multi-Purpose Spaces**

- Library (19)
- Mixed-use areas (9)
- Meeting rooms (5)
- Meditation room (5)
- Makerspaces (4)
- Multi-faith room (1)
- Community kitchen (2)
- Quiet study rooms (2)

**Outdoor**

- Splash pad (12)
- Playground (6)
- Common outdoor areas (4)
- Garden (3)
- Walking paths (2)
- Soccer field (1)
- Shuffleboard (1)

**Other**

- Music (14)
- Cafe (9)
- Games room (7)
- Camps (5)
- Chess (2)
- Film/Photography (2)
- Don Mills history (1)
- Tool libraries (1)
- Wi-Fi (1)



# Appendix A

## Public Meeting #1 Presentation

### Don Mills Community Recreation Centre

Public Kick-Off Meeting

December 15, 2022



### Land Acknowledgement

We acknowledge the land we are meeting on is the traditional territory of many nations including the Mississaugas of the Credit, the Anishnabeg, the Chippewa, the Haudenosaunee and the Wendat peoples and is now home to many diverse First Nations, Inuit and Métis peoples. We also acknowledge that Toronto is covered by Treaty 13 with the Mississaugas of the Credit.



## Recording Notice

Please note that we will be recording the presentation portion of this meeting to host on the Don Mills Community Recreation Centre project web page.

The Q&A portion and breakout rooms will not be recorded.



## Closed Captioning

Automatic Closed Captioning is available.



On the bottom left of your screen, click the “CC” icon to turn on closed captioning.



## How To Participate



1. To prevent members from talking over each other in this virtual space, please click the Raise-Hand icon to indicate that you would like to speak.

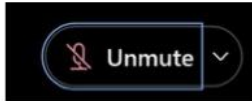

1. Once called on, please click the mute/unmute button to speak. If you are *only* connected by phone, dial \*6 to unmute.

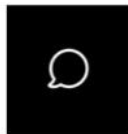

1. Alternatively, you can participate by typing into the chat. Click the chat icon to open the chat box and send your message to "Everyone".

## Webex Audio Trouble?

1. At the bottom of the screen, click the **More Options** button or the **arrow beside the Mute** button.
2. Click **Switch Audio**
3. Use the **Call me at** function
  - a) Enter your phone number
  - b) Webex will call your phone

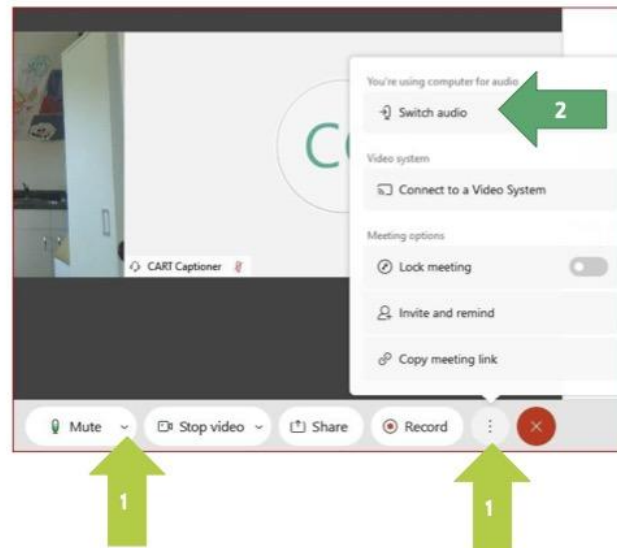

## Meeting Agenda



Welcome and introductions



Project overview



Questions & Break Out Activity



Next Steps



Adjourn



## Goals for this Meeting

- Provide an overview of the **Don Mills Community Recreation Centre** project
- Create a shared community vision for the CRC
- Share ways to get involved as we move forward



## Project Team



**Daniel Fusca**, Manager, Public Consultation; Parks, Forestry & Recreation

**Elijah Bawuah**, Senior Consultant  
– Public Engagement; Parks, Forestry & Recreation

**Ashley Wilson**, Senior Project Coordinator; Parks, Forestry & Recreation



**Nadia Galati**, Principal and Engagement Lead

**Casey Hinton**, Senior Strategist

**Stephanie Stanov**, Strategist + Planner

**Jo Delos Reyes**, Strategist + Planner

**Ridge Road Consultant**, Indigenous Engagement Lead



**Robert Allen**, Partner

**Matt Lamers**, Project Architect

**Haleh Chodsimaab**, Project Manager

**Melanie Taylor**, Communication and Engagement Specialist



9

## Engagement and Communications Overview



10



# Don Mills Community Recreation Centre Project Background



11

## Project Background

**Location:** 844 Don Mills Road, at the northwest corner of Eglinton Avenue East and Don Mills Road.

- The site is part of a multi-phase mixed-use redevelopment is being marketed as a new community called Crosstown.

**Size:** 150,000 sq ft total

### Opportunities:

- Introduce new programming and community amenities to a growing population
- CRC can support indoor and outdoor programming, using the adjacent park

**Architect:** MJMA

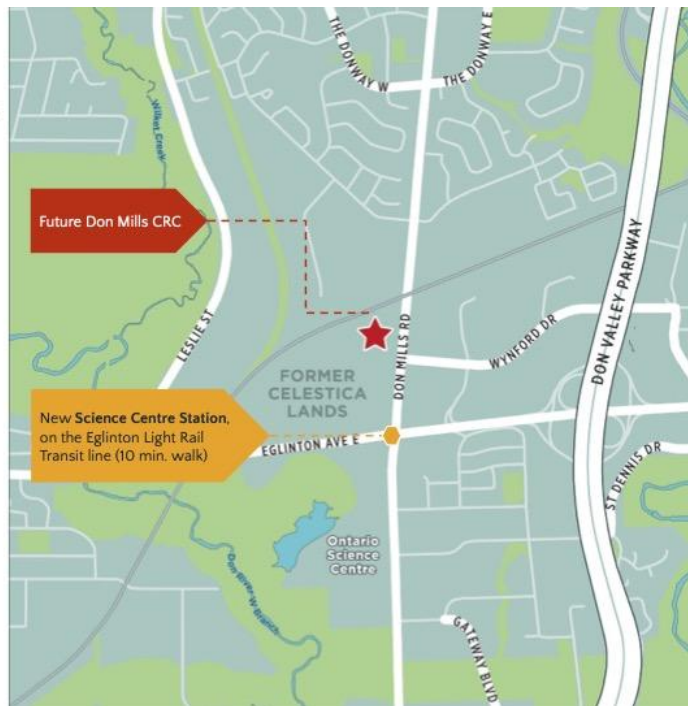

## Don Mills CRC– Site Plan



## Site Plan

- Allow the building to “open up” on 3 sides:
  - physical connection of indoor/outdoor spaces along the park
  - + visual connections to animate sidewalks on Moriyama Dr and Don Mills Rd
- Collect back of house and vehicular functions towards the north along Mike Palmateer Rd, adjacent to CPR tracks

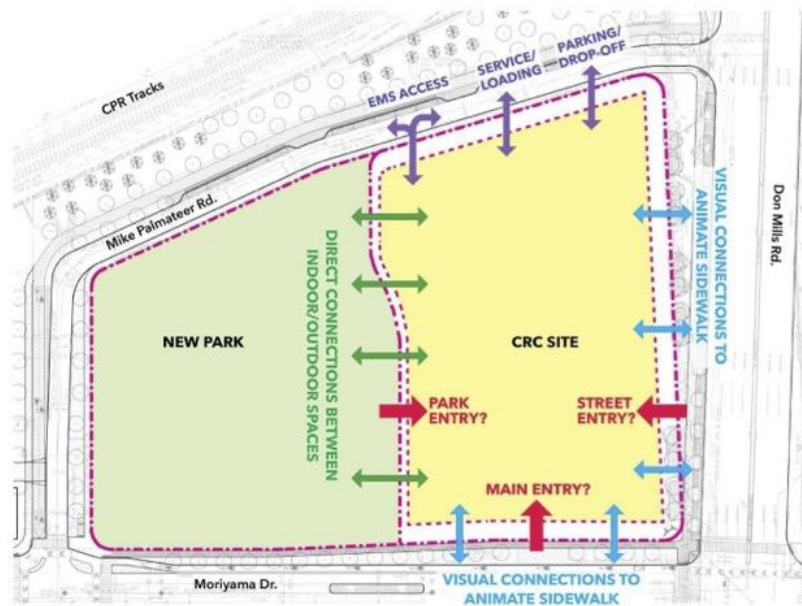

## Key Project Components

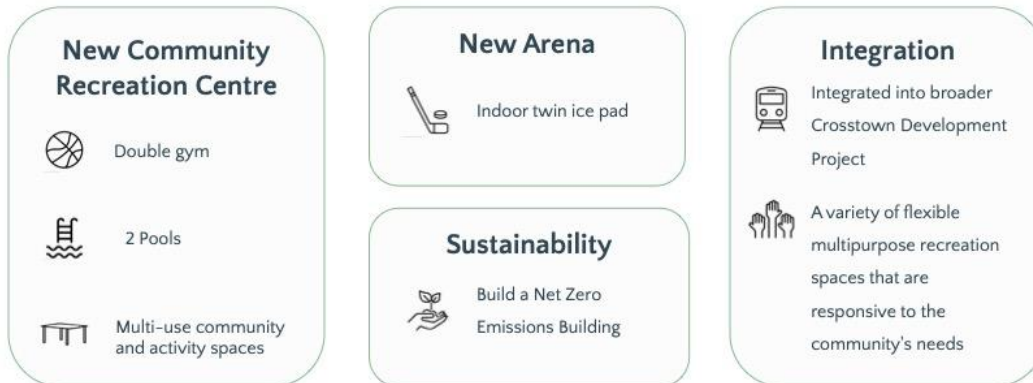

**PUBLIC ENGAGEMENT:** Every project component will be shaped by the public input collected through the process.



15

## What is Open for Influence

| What will be included:  | What we can collaborate on:   |
|---|---|
| <ul style="list-style-type: none"> <li>• Ground floor lobby and administration area</li> <li>• Two arenas</li> <li>• Team rooms</li> <li>• Swimming pools, aquatic storage, staff and universal change rooms</li> <li>• A double gymnasium and walking track</li> <li>• Fitness studio, flex fitness/dance room, and change rooms</li> <li>• Multi-purpose and activity rooms</li> <li>• Kitchen</li> <li>• Emergency vehicle bay and crew rest area</li> </ul> | <ul style="list-style-type: none"> <li>• Opportunities for the included program in the Community Recreation Centre, such as program interrelationships, flexibility of uses, and relationships to the park</li> <li>• Community multi-purpose room(s) features and uses</li> <li>• Lane pool features and uses</li> <li>• Leisure features and uses</li> <li>• Lobby features and uses</li> <li>• Program adjacencies</li> <li>• Opportunities for key safety features, such as sight lines, visibility, and views</li> </ul> |



16



## What Will Make this Project Successful?

The Community Recreation Centre will serve as a **gathering place** for an array of people, communities and experiences.

The project will be a success if the **diversity of community members** who use the Community Recreation Centre today as well as future community members – feel interested, **welcome**, and **safe** to use these amenities in the future.

### Engagement Principles

**Parks are for everyone!** Our engagement process should reflect this.

**Build on the work** that's already been done.

Our engagement process should be **flexible and iterative**.

The best engagement process is a **defensible** one.

### Project Precedents

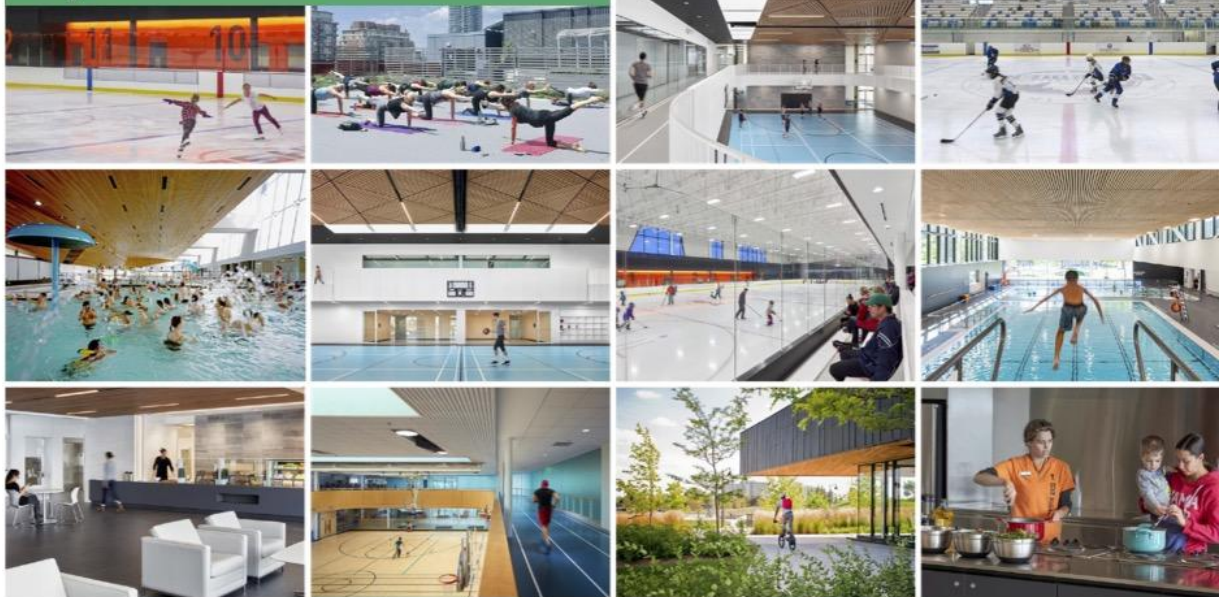

## Case Study #1

### Western North York Community Centre

- 'Create Your Place': An engagement process was carried out to ensure that the building design was reflective of the values and aspirations of the community.
- The feedback collected during this engagement process helped refine and inform the design of both indoor and outdoor spaces of the new Community Centre.



## Case Study #2

### Bostwick Community Centre, YMCA & Library

- The public engagement process revealed community needs, aspirations, and concerns that informed how recreation and gathering spaces were designed and programmed.
- Open houses sparked conversations that led to a collaborative design process and resulted in a facility that the entire community could enjoy.



# Opportunities to get involved



21

## Engagement Opportunities



22

## Community Advisory Committee (CAC)

Join the Community Advisory Committee to help co-create project elements as we imagine this new CRC!

Apply by Sunday, December 18th. Link to application shared in chat + available online on City of Toronto's Don Mills Community Recreation Centre project webpage.

Honoraria and financial support available to ensure that there is equity of access to this extracurricular activity.

Selected via an **Adapted Civic Lottery model**. The lottery will be based on **neighbourhood census data** regarding Age, Gender, and Race demographics

# Questions?



## How To Participate



1. To prevent members from talking over each other in this virtual space, please click the Raise-Hand icon to indicate that you would like to speak.

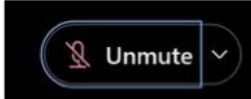

1. Once called on, please click the mute/unmute button to speak. If you are *only* connected by phone, dial \*6 to unmute.



1. Alternatively, you can participate by typing into the chat. Click the chat icon to open the chat box and send your message to "Everyone".

## Breakout rooms: Creating a community vision

## Creating a Community Vision Statement

### Breakout Room Activity:

1. Enter breakout room
2. Join the Mentimeter activity
3. Add your words
4. See the word cloud grow in real time!

To join Slido, visit [www.menti.com](https://www.menti.com) on your phone or web browser.

**Enter the code on the screen** to see tonight's activity.

What are some **key words** you would use to **describe the vision** you'd like to see incorporated into the new Don Mills Community Recreation Centre?

What are some **key words** you would use to **describe the feelings** that you hope community members experience after visiting the new Don Mills Community Recreation Centre?

Which **programs and activities** have you enjoyed in other community centres and would like to see at the new Don Mills Community Recreation Centre?



27

## Next Steps



35

## Next Steps

Visit [www.toronto.ca/DonMillsCRC](http://www.toronto.ca/DonMillsCRC) to complete the **survey**,  
apply for the **Community Advisory Committee** and learn more.



29  
29

Thank you!



30

# Appendix B

## December 15, 2022 - Public Meeting #1 Questions and Comments

**Note:** Participant questions and comments, and project team responses, are not verbatim.

| PARTICIPANT QUESTION/COMMENT  | PROJECT TEAM RESPONSE  |
|---|--|
| How many community advisory group meetings will there be? How often?  | There will be a meeting time in the new year and a total of 4-6 throughout the project.  |
| Will there be community consultation when you are ready to do programming of activities?  | Programming will be discussed. There will be more conversation closer to when the facility opens.  |
| How long will it take to build the centre?  | <p>The design and community engagement process will happen in parallel. It is a lengthy and complex process considering the size and scale.</p> <p>The project has to follow a rigid process, in terms of approving variances and the approval process can be lengthy. This is factored into the timeline.</p> |
| Why is construction not starting until 2024?  | See above response.  |
| Will there be a gap between Don Mills Civitan Arena closure and this set of rinks?  | The City will try to keep the arena open for as long as possible so there is no gap between facilities.  |
| Why does the catchment area for the advisory committee not include all of Don Mills, as well as areas to the south of Eglinton? | There is a 3km catchment area around the facility, in accordance with the Parks & Recreation Facilities Master Plan, which is a council approved document. We are working within those guidelines.   |
| I'd be happy to help design the park. Do I need to apply for that now or can I just apply to help design the park another time? | <p>The current engagement process is only for the design and programming of the Community Recreation Centre.</p> <p>Park consultation will happen later on. There will be a separate RFP that will go out to develop the park.</p>   |



| PARTICIPANT QUESTION/COMMENT  | PROJECT TEAM RESPONSE  |
|---|--|
| At an earlier meeting there was mention of a Therapeutic Pool. Do you have any updates on that?   | There will be an aquatic center, but specifics are still to be determined.   |
| Think this will be amazing for this community.  |  |
| How was the architecture firm selected?   | There was an RFP process, through which consultants are vetted and approved.   |
| Will the roof of the community recreation centre be open for use?   | This is a possibility. Green roofs need to happen as part of a commitment to sustainability, so access may be possible.  |
| What design stage are we at currently?  | We are still very early on in the process and there is still a lot of time to shape the building. The community will have opportunities to share what they wish to see in the building in the initial phases. After initial community feedback is gathered, it will go through a design process. |
| <p>I like the idea of the running track.</p> <p>There have been previous meetings and consultations. Specifically, one great idea was for the inclusion of coliseum seating for the ice rinks. Any thoughts?</p> <p>Secondly, will the increase in construction costs be reflected in the budget?</p> <p>The inclusion of EMS is new - will they be chipping in for their space in the community recreation centre?</p> <p>Will the design standards be the same as other new community recreation centres?</p> |  |
| Separate from this community recreation centre, does the City have plans to revitalize the Dennis Timbrell Centre? Or is this meant to also serve the Flemington Park community? That CRC is less than 3km away from this new one, as I understand. Would they be in the  | This is something in the long term capital plan, but not part of this project.   |

| PARTICIPANT QUESTION/COMMENT  | PROJECT TEAM RESPONSE  |
|---|--|
| catchment?  |  |
| Can the TTC route 162 bus from Lawrence Station be extended to the Science Centre station in order to link the entire community with this community recreation centre, and be made free of charge for local use? The Donway bus route 162 has served Don Mills for decades. |  |
| Were design proposals included in the selection of the architecture firm?   |  |
| A community garden roof might be more useful, as the soil may be too shallow for large trees on the roof.   |  |
| Is the idea to use waste heat from cooling the rink to heat the swimming pool still being considered?   | <p>Heat recovery strategies from the ice rink is an option.</p> <p>Energy consumption of the building is quite high so it will be an interesting process to find ways to make it net zero. There is a possibility to explore how the pool and ice rink can be used to make this building net zero.</p> |
| Can the building be designed to minimize or not shadow large trees that should be preserved all around the community recreation centre?   |  |
| Keys for the 844 site were handed to Aspen Ridge on May 1st, 2019. Apart from COVID delays, why has it taken so long to get to this stage?  |  |
| Will ice rinks be available for use year-round?   |  |
| <p>A greenhouse on part of the roof for a year-round community garden would be great.</p> <p>A winter-ready greenhouse to grow tomatoes and fresh vegetables on the roof. We have a shortage of community garden space too.</p>   |  |

# Appendix C

## Community Advisory Committee Selection Process

The application to apply to the Don Mills Community Recreation Centre Community Advisory Committee was hosted on the project webpage from November 24th until December 18th, 2022. The application process was communicated to participants at the December 15th public meeting and was open to community members and organizations within a 3km radius of the future site.

A total of 168 applications were received from community members and 13 applications were received from community organizations. There were 26 positions available to community members and 10 positions available to community organizations.

The application data was cleaned up to remove:

- Incomplete applications
- Duplicate applications
- Applications with postal codes beyond the 3km catchment area

Local community demographics were analyzed to determine the composition of the community member representatives for the Community Advisory Committee. The average between the Don Mills, Flemingdon Park and Thorncliffe Park communities were used to set eligibility parameters. For example, 56% of residents of Don Mills, 63.2% of Flemingdon Park and 62.8% of Thorncliffe Park were born outside of Canada, averaging out to 60.7%. Therefore, the target was for 60.7% (or 15-16 of 26 community members) to be immigrants, newcomers or refugees. This process was repeated for the following demographic categories: housing type (i.e., homeowner versus renter), seniors, youth, visible minorities, and gender.

Given that information on disability was not available, the Project Team reviewed applicant data. 9.4% of eligible respondents identified as having a disability. As such, the target was for 9-10 of community members to identify as having a disability.

The Project Team entered these parameters into a civic lottery tool ([Panelot](#)) along with anonymized applicant data. Selected applicants were randomly selected in order to match set parameters and as a result, are as representative of community composition as possible.

For local community organizations, 8 of the 13 applications were eligible for the Community Advisory Committee and as a result, were invited to participate.