

CURB TRANSITION,
SEE STD T-310.030-19 (TYP)

GUTTER TO TERMINATE
AT BOTTOM OF RAMP (TYP)

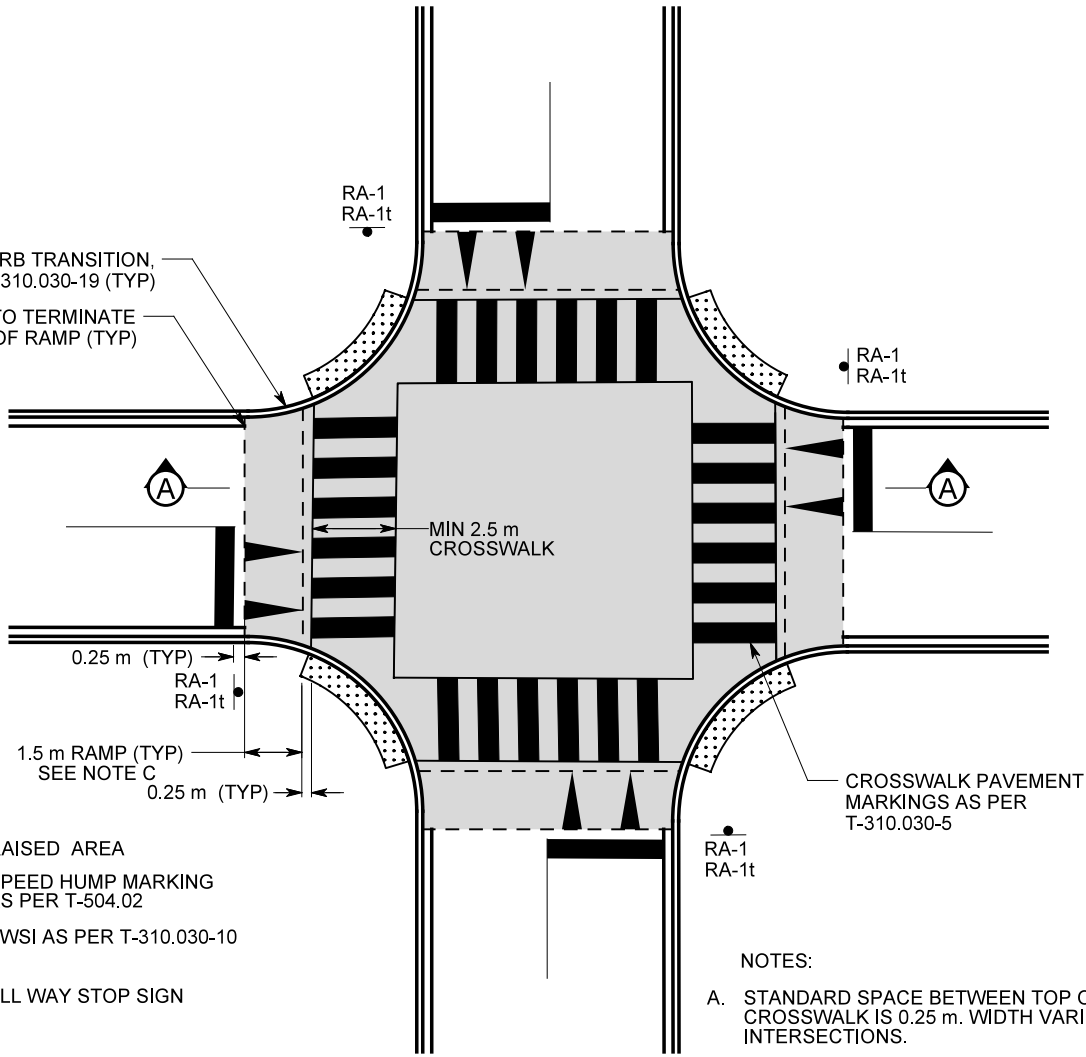

LEGEND

- RAISED AREA
- SPEED HUMP MARKING AS PER T-504.02
- TWSI AS PER T-310.030-10
- ALL WAY STOP SIGN

NOTES:

- A. STANDARD SPACE BETWEEN TOP OF RAMP AND CROSSWALK IS 0.25 m. WIDTH VARIES FOR SKEWED INTERSECTIONS.
- B. REFER TO CITY OF TORONTO-PAVEMENT STRUCTURAL DESIGN MATRIX.
- C. REFER TO STD T-310.030-20 FOR RAMP SLOPES.

PLAN

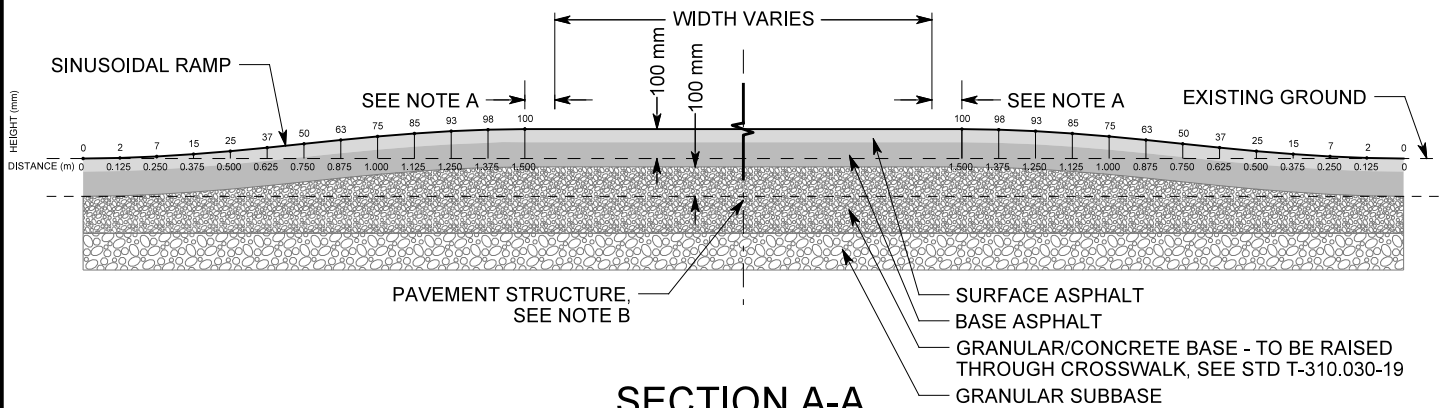

SECTION A-A



ENGINEERING & CONSTRUCTION SERVICES STANDARD DRAWING

REV 1 SEPT 2023

RAISED FOUR-WAY INTERSECTION

T-310.030-13

NTS SHEET 1