

# Key Change #3

## Reduce the Scale of the Therme Building

The Revised Proposal demonstrates significant efforts to reduce the overall massing required for the Therme building while continuing to enable a major visitor destination that can be enjoyed by visitors from Toronto, Ontario and around the world.

Building section illustrating the proposed massing compared to the 2022 submission

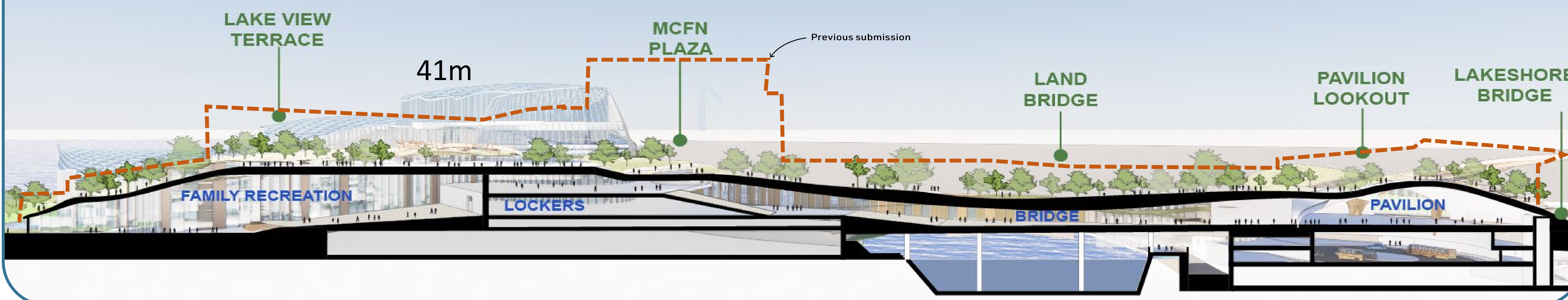

### Responding to Your Input

**We Heard:** Why is the building so large?

**Design Response:** The built form has been redesigned to:

- Reduce the scale of Therme by 25%
- Reduce the main building height by 5-15m
- Reduce the entrance pavilion height by 14% from 26 metres to 23 metres.

**We Heard:** The public space on the waterfront is too narrow

**Design Response:** The waterfront open space is now within a significantly wider building setback from the shore.

Building section illustrating the reduced height and setbacks from the Megastructures

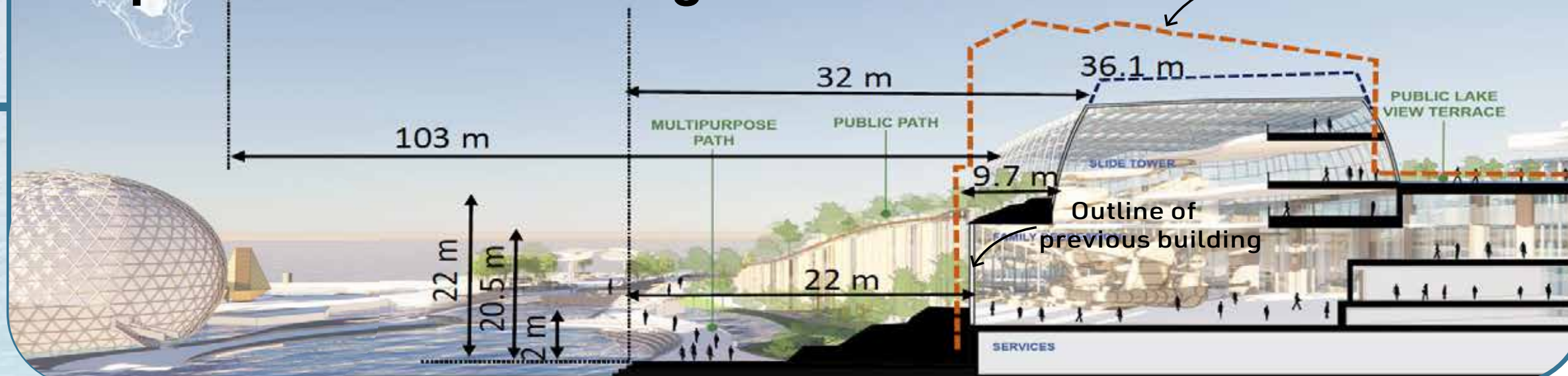

Building section - north facade

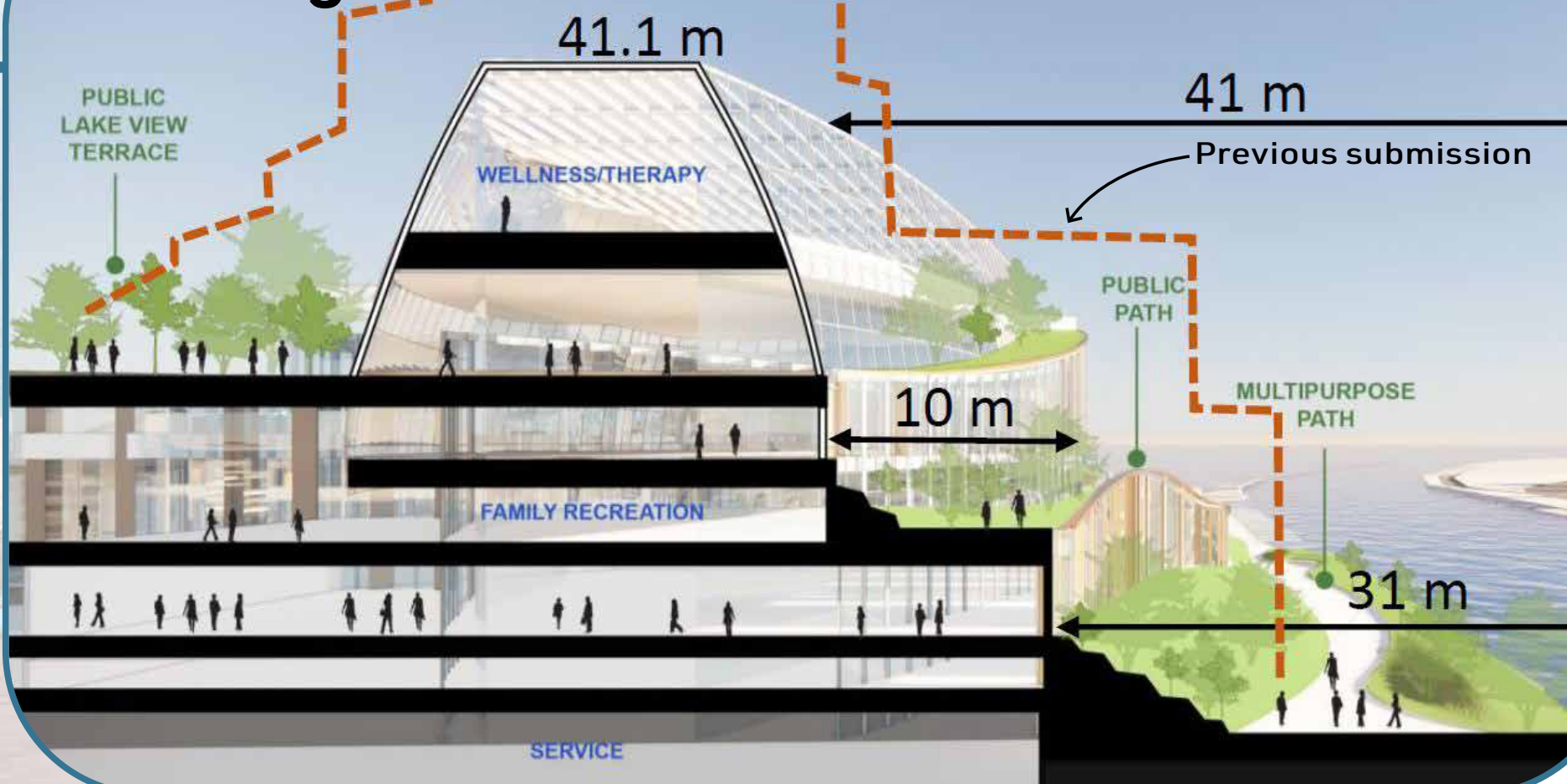

Building section through the land bridge

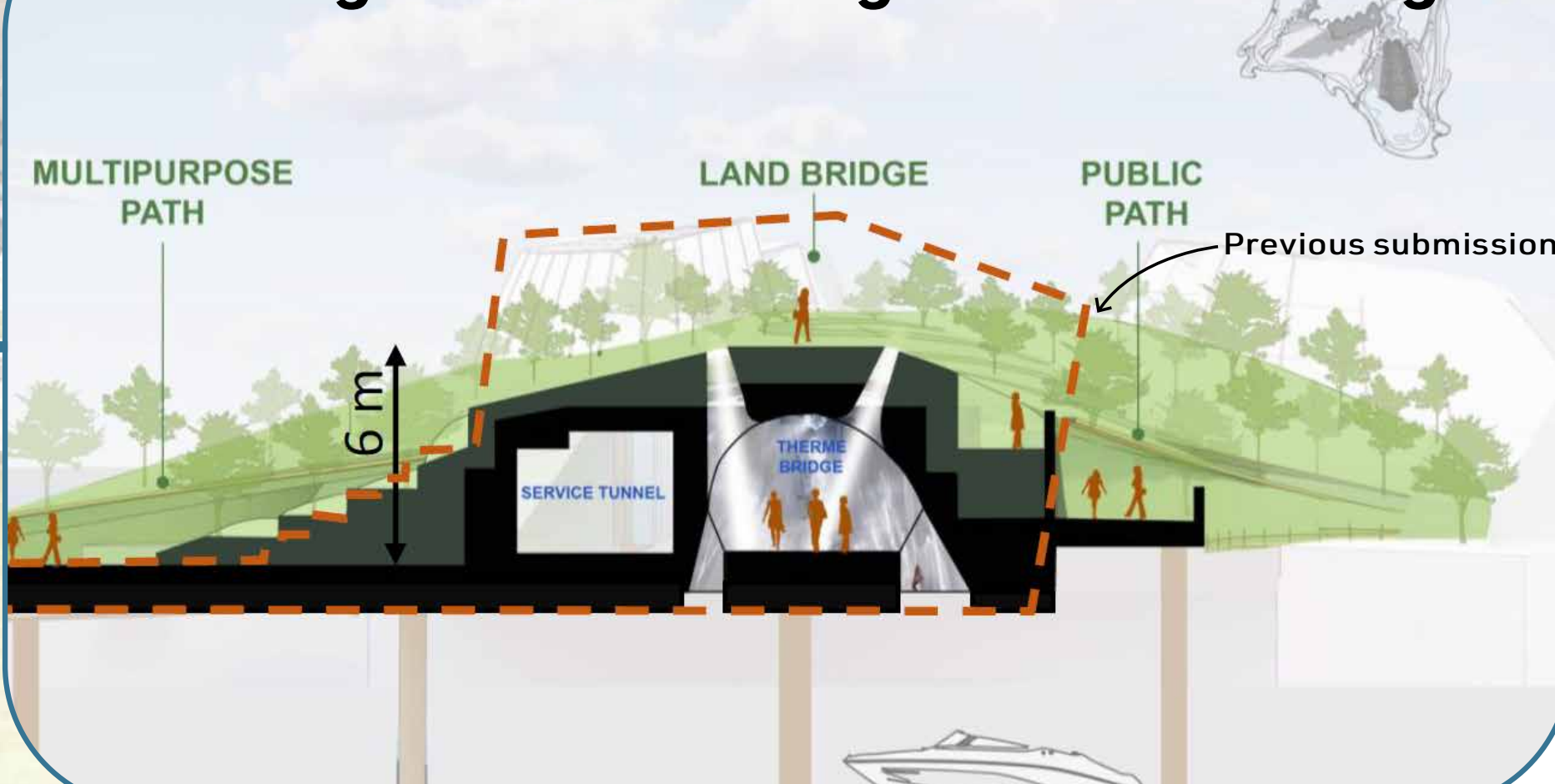

### Key Statistics

↓25% Reduction in Building Volume

↓~5-10m Reduction in Building Height

The Revised Proposal breaks up the Therme buildings into a partially submerged campus of buildings, separated by public paths on the upper levels. This integrates public space and circulation above and between the ticketed areas.

The entrance to the West Island has been revised to focus on welcoming public visitors to the Site. Reducing the built form mass and height while increasing guiding vegetation and native planting create an open and inviting plaza for all visitors.

PREVIOUS SUBMISSION



# Key Change #4

## Better Connection to the City with Improved Mobility Options

The Revised Proposal promotes a more sustainable modal split by increasing transit mobility through the implementation of shuttle access to Exhibition GO. Total on-site car parking spaces have been reduced while bike parking spaces have been increased.

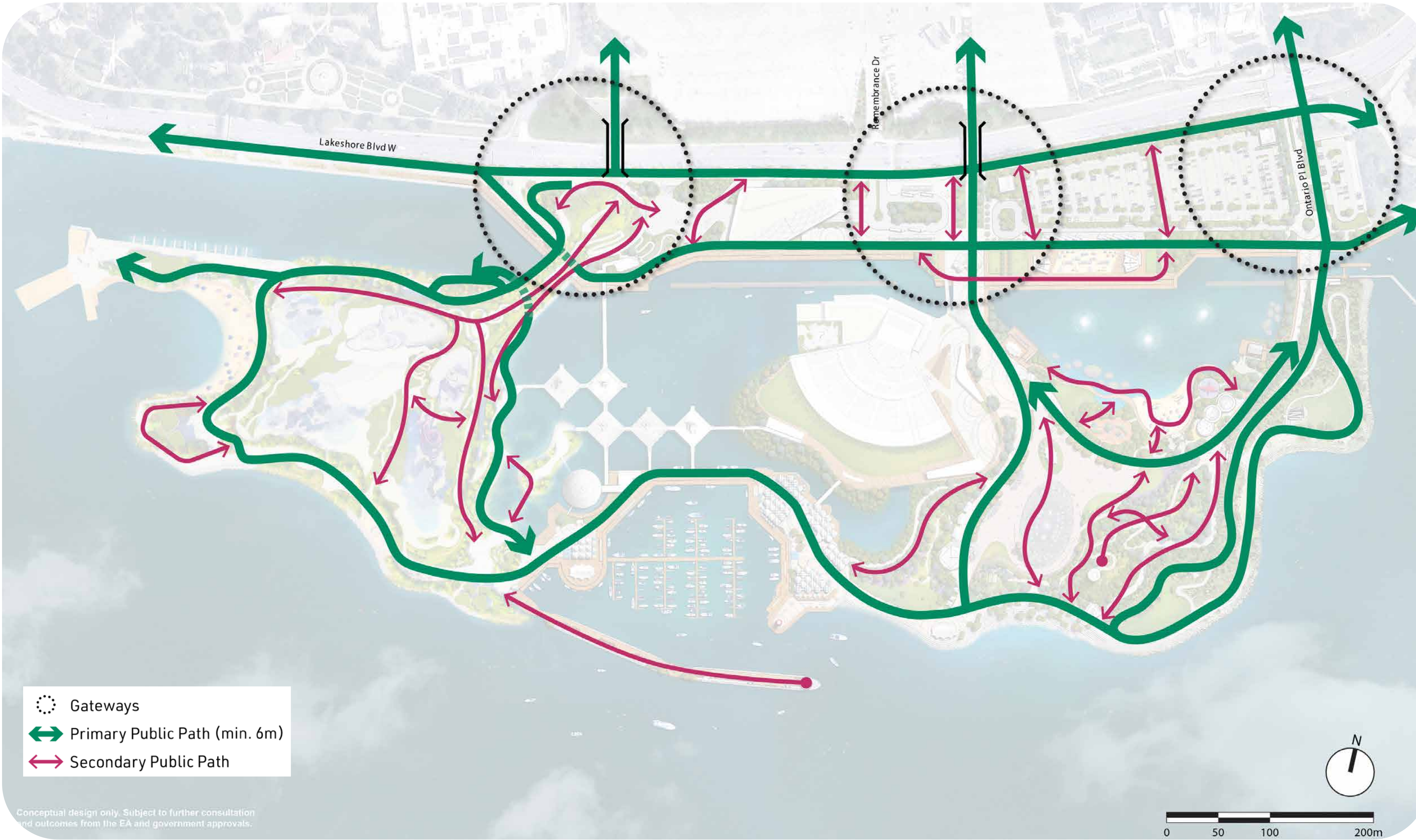

### Key Statistics

- ↓ **225** Reduction in Vehicle parking spaces
- ↑ **577** Increase in bike parking spaces

### Responding to Your Input

**We Heard:** There is too much focus on car access and parking

**Design Response:** The proposed parking structure is reduced by 226 parking spots.

The improved bike access strategy includes 950 bike parking spaces.

Metrolix is designing a shuttle that directly connects to Exhibition GO and Ontario Line Station.

### MODAL SPLIT

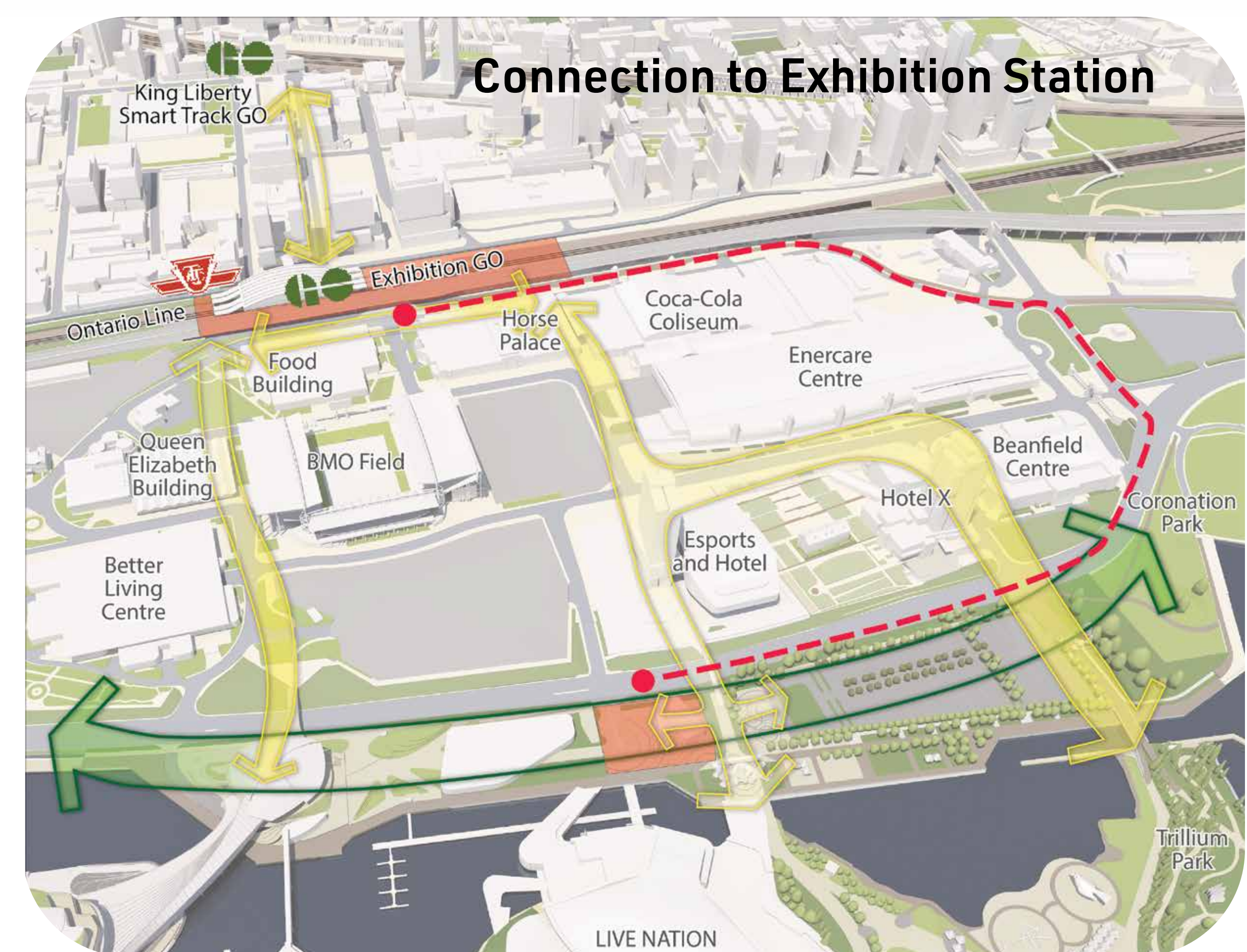
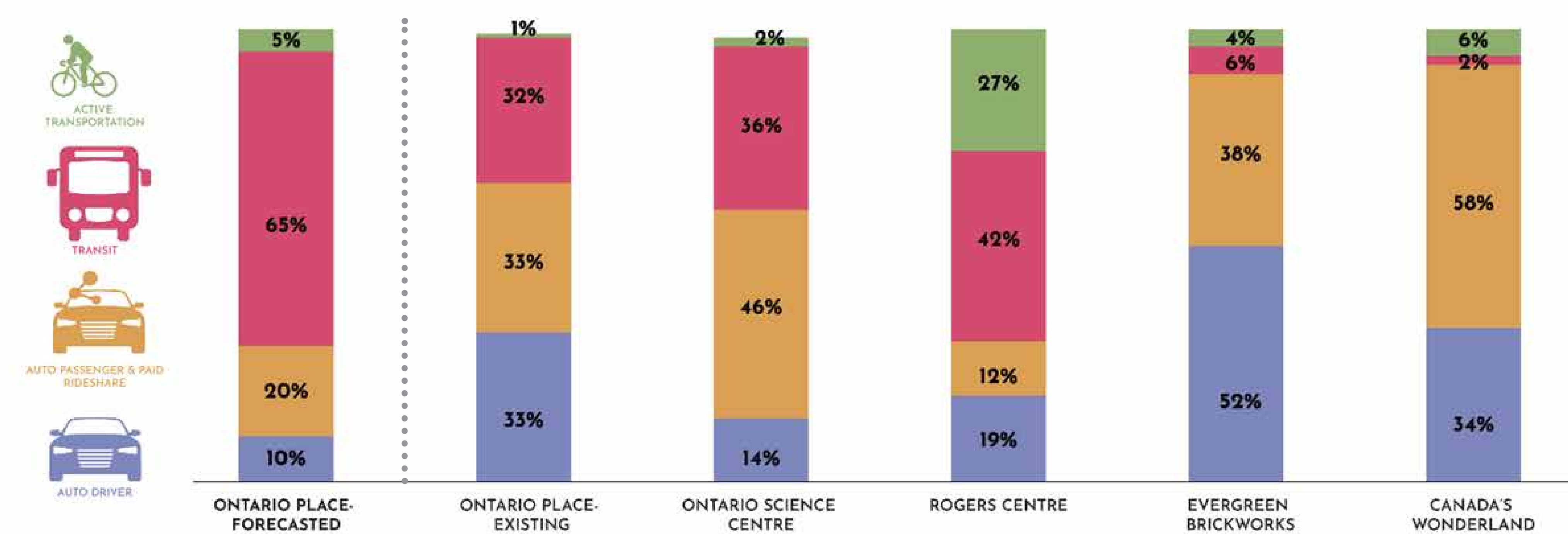

# Key Change #5

## Create more Waterfront Programming

The revised proposal includes more food and beverage areas across the site and increased investment for Indigenous ceremony space, green space and activity zones.

**Responding to Your Input**

**We Heard:** We want spaces to swim/play/rest/be in nature/paddle, etc.

**Design Response:** The public realm strategy has been improved with more public space and amenities accessible to members of the public.

**We Heard:** We want more options for food and beverage on the waterfront.

**Design Response:** The revised waterfront promenade and marina village provides more options for food and beverage.



West Headland 1



Public Beach 2



MCFN Fire Pits 3



Marina Cafe 4



The Forum 5



Adventure Play 6



Brigantine Cove 7



- Waterfront Program
  - Food and Beverage Location
  - Mobile and Seasonal Food and Beverage Location
  - Public Washrooms
- Scale 1:750  
0m 25m 50m 100m  
North

August, 2023  
Conceptual design only.  
Subject to further consultation and outcomes from the EA and government approval processes.

# Revised Proposal

## Public Realm: East Island & Mainland

The majority of Ontario Place will be publicly accessible with various programming and activities to animate the site. The public realm on the East Island and Mainland will include:

- New and improved green space and continuous public waterfront access
- Food and Beverage opportunities
- Enhanced biodiversity, tree canopy and habitat types
- Accessible environment achieved through inclusive design
- Preserved and enhanced cultural and natural heritage
- An iconic year round experience for all Ontarians



New Public Connections to the Shore



Waterfront Trail and Land to Water Rock Pier

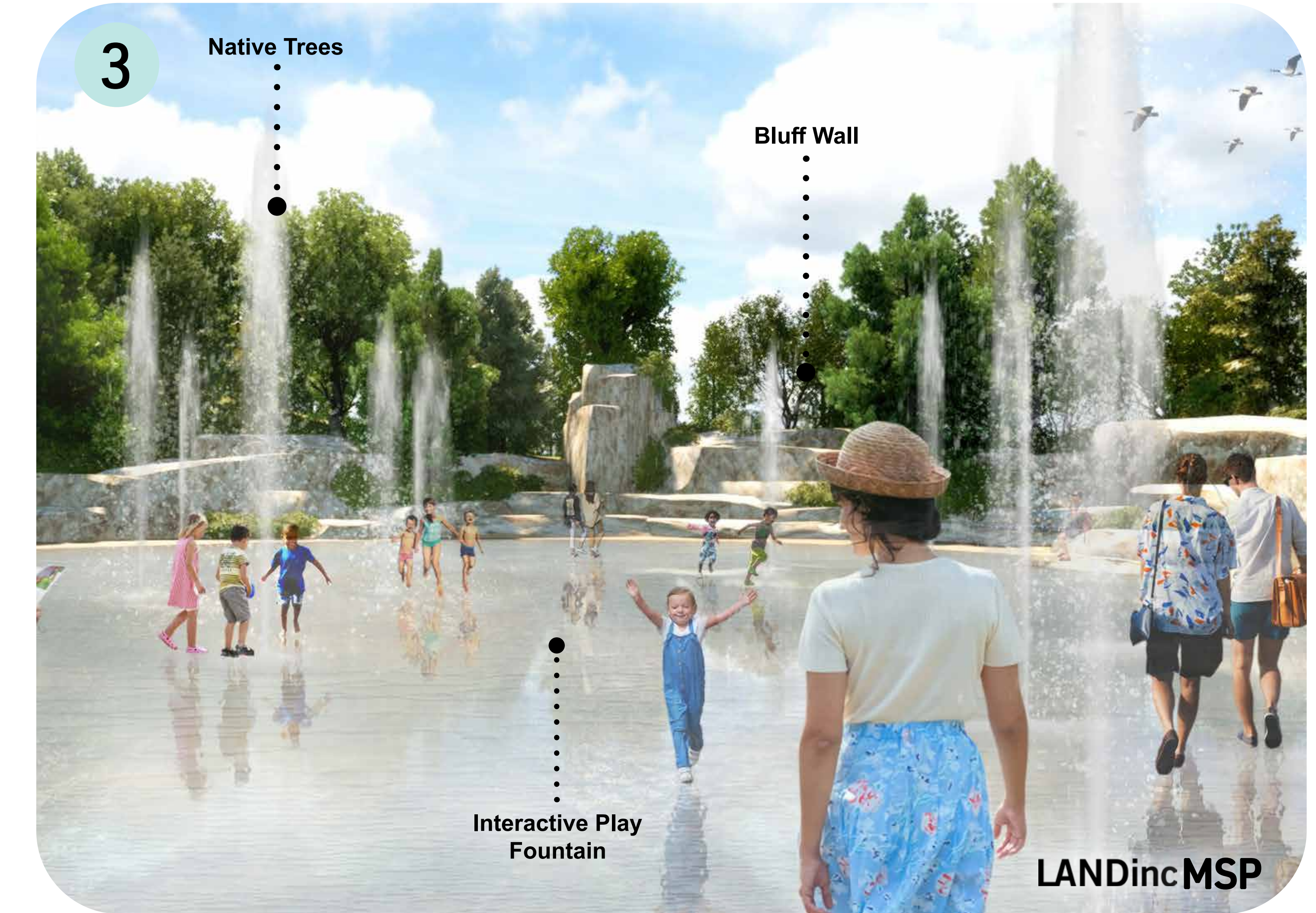

Proposed Forum Play Fountain with iconic interactive jets for all ages



Brigantine Cove beach



Brigantine Cove boardwalk



Mainland Promenade and boardwalk

# Revised Proposal

## Public Realm: West Island

The Revised Proposal includes more public realm on the West Island than currently exists today.

The shoreline public realm is 12.5 acres and the public rooftop adds an additional 3.4 acres of space to create an elevated park experience resulting in an increased amount of public realm on the west island.



West Island Aerial View



West Headland



West Headland



East Headland



East Headland



Rooftop Public Path



Rooftop Public Path



Public Beach



Sky Park Plaza

# Revised Proposal

## West Island Built Form

The Therme facility offers a year-round recreational destination while providing improvements to the West Island public realm. The building has been designed to integrate with the surrounding landscape, creating a series of rolling hills next to the water's edge.



Welcome Pavilion from Ontario Place



Ontario Place Entrance Looking Southwest



Ontario Place Entrance from Lake Shore Blvd



West Island & Megastructures Looking Northwest

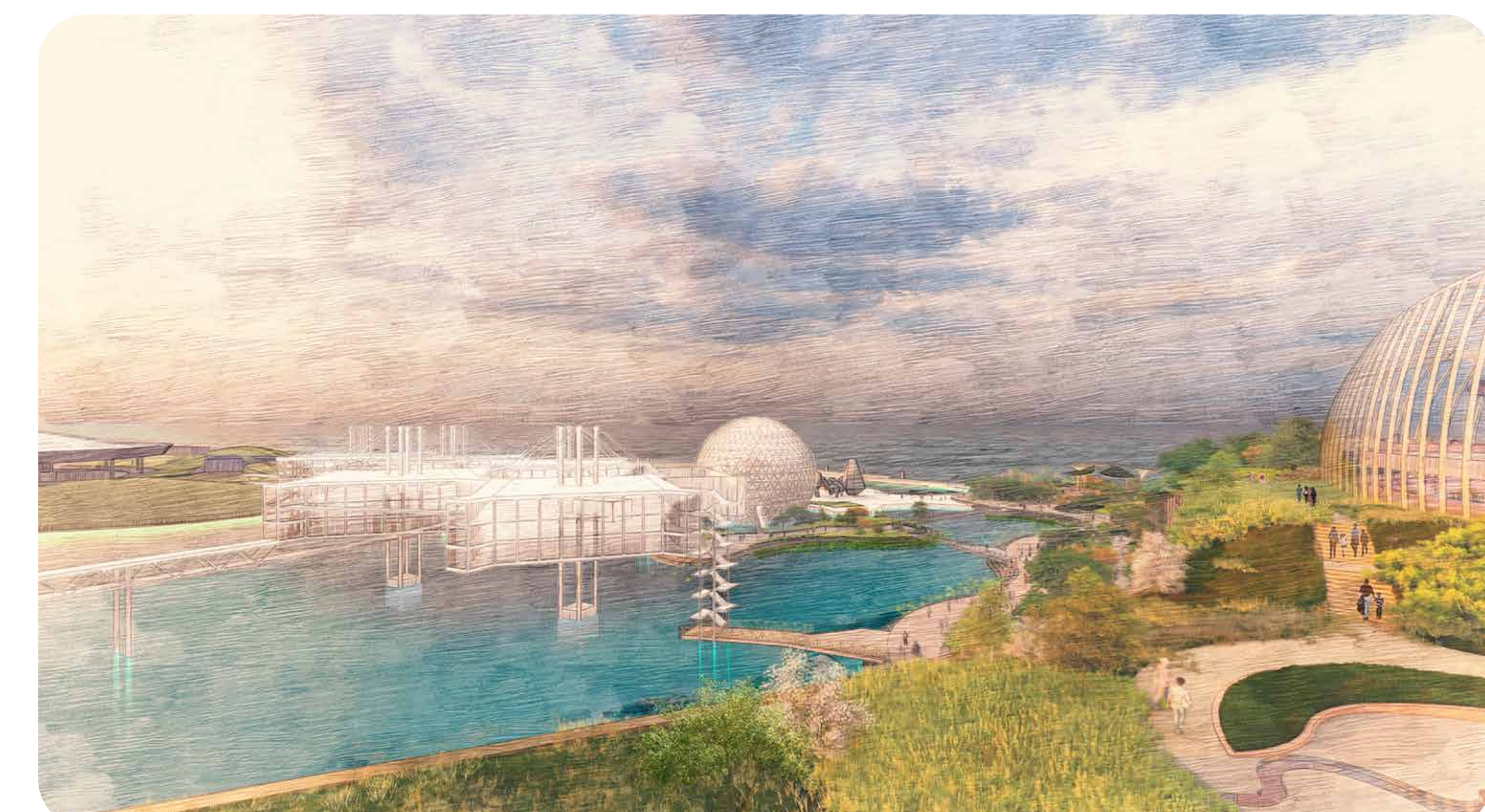

Rooftop Public Space Vista of Megastructures

# Revised Proposal

## Therme Programming

The Therme facility on the West Island offers water recreation and wellness programming in a major new attraction in Ontario Place. The scale of the facility enables an affordable recreational experience for all, and year-round activation of the site.

### Number of Daily Guests



Indoor Pool and Waterslides

### Family Recreation

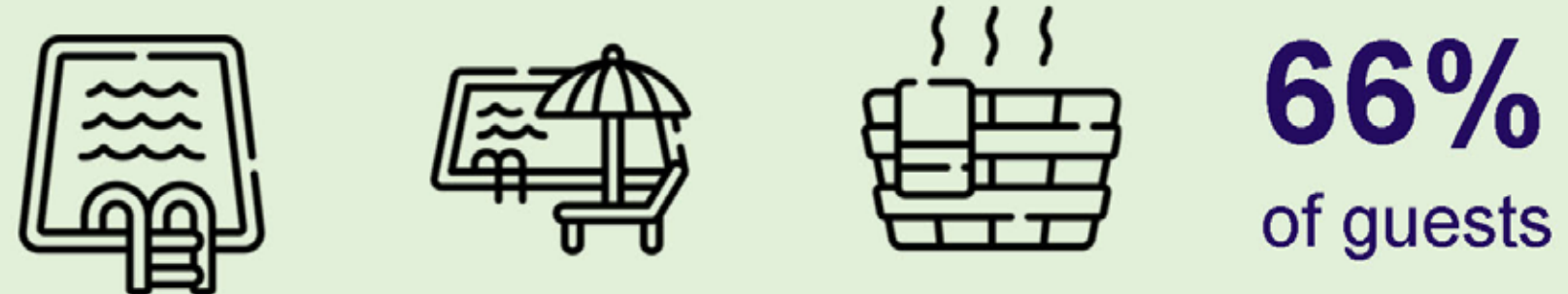

- Indoor/Outdoor Pools
- Waterslides
- Wave Pool
- Children's Play
- Water Based Exercise Classes
- Lounge Chairs
- Healthy Food & Beverage
- Mineral Baths
- Steam Rooms
- +16 Zone

### Wellness



- Indoor/Outdoor Pools
- Healthy Food & Beverage
- Exercise Classes
- Lounge Chairs
- Mineral Baths
- Themed Saunas
- Steam Rooms
- Personal Care Services

### Therapy



- Indoor/Outdoor Pools
- Healthy Food & Beverage
- Exercise Classes
- Lounge Chairs
- Mineral Baths
- Steam Rooms
- Personal Care Services



Therapy Indoor Pool



Interior of Therme Entrance