

Six Points Park District Plan & Two New Parks

CAC Meeting #3:

October 18, 2023 – 6:00 PM

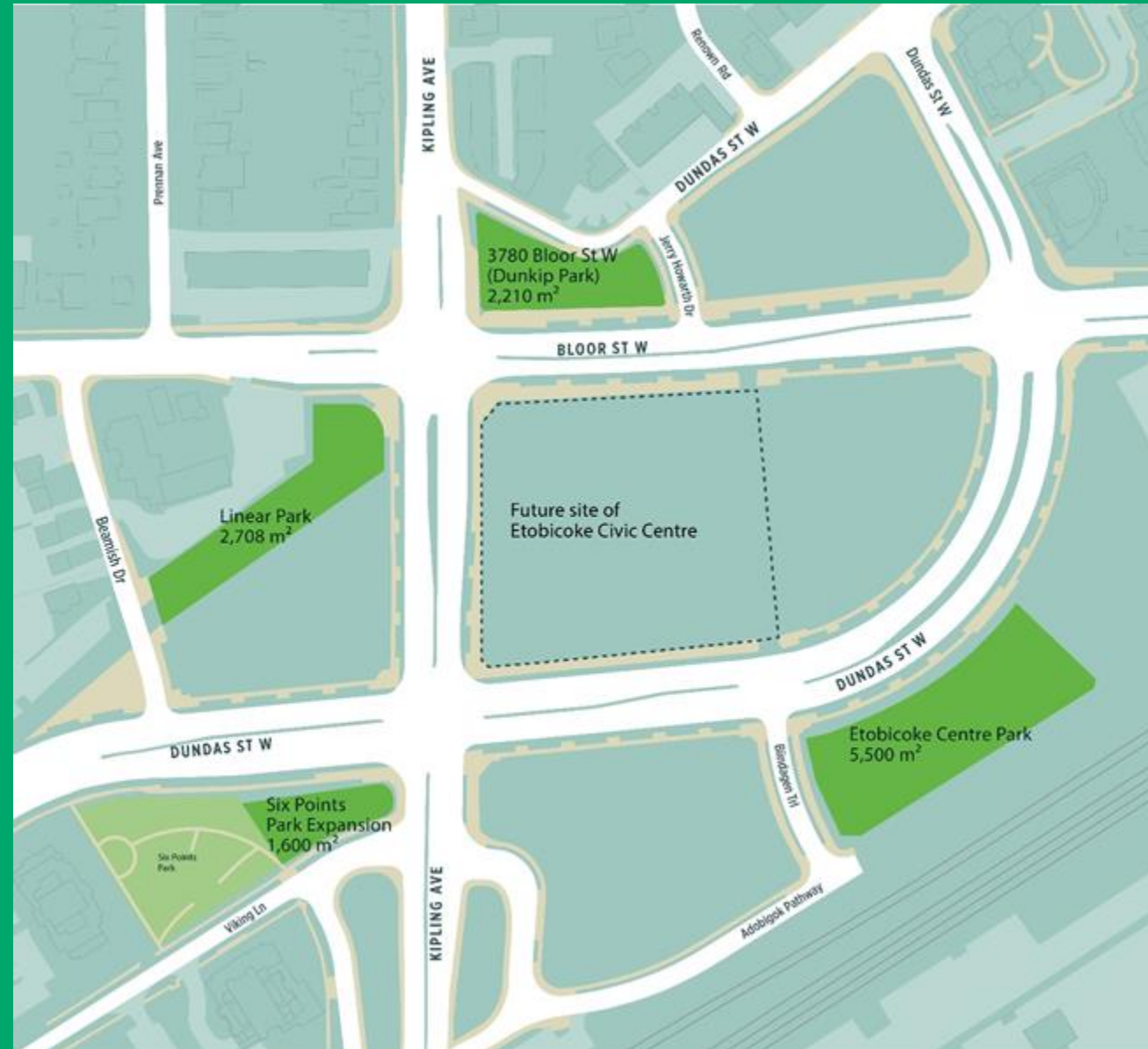

Meeting Agenda



Welcome & Introductions



Project Timeline



Final Vision Statement & Guiding Principles



What We Found



What We Heard



Design Approach: Park District Plan



Draft Park District Plan & Discussion



Preliminary Concept Options for Two Parks & Discussion

Project Team

City of
Toronto
Parks,
Forestry and
Recreation

Lara Herald – Senior Project Coordinator - Parks, Forestry and Recreation

Eli Bawuah – Senior Consultation Coordinator - Parks, Forestry and Recreation

Design
Consultant
PLANT
Architect Inc.

Mary Tremain – Engagement Lead, Partner/PLANT Architect

Eric Klaver – LA Design Lead, Senior Landscape Architect, Partner/PLANT Architect

Zeynep Benk – Landscape Architect/Project Manager

Tanya Pande – Landscape Designer

Carl Valdez – Landscape Designer

Site Context



Project Timeline

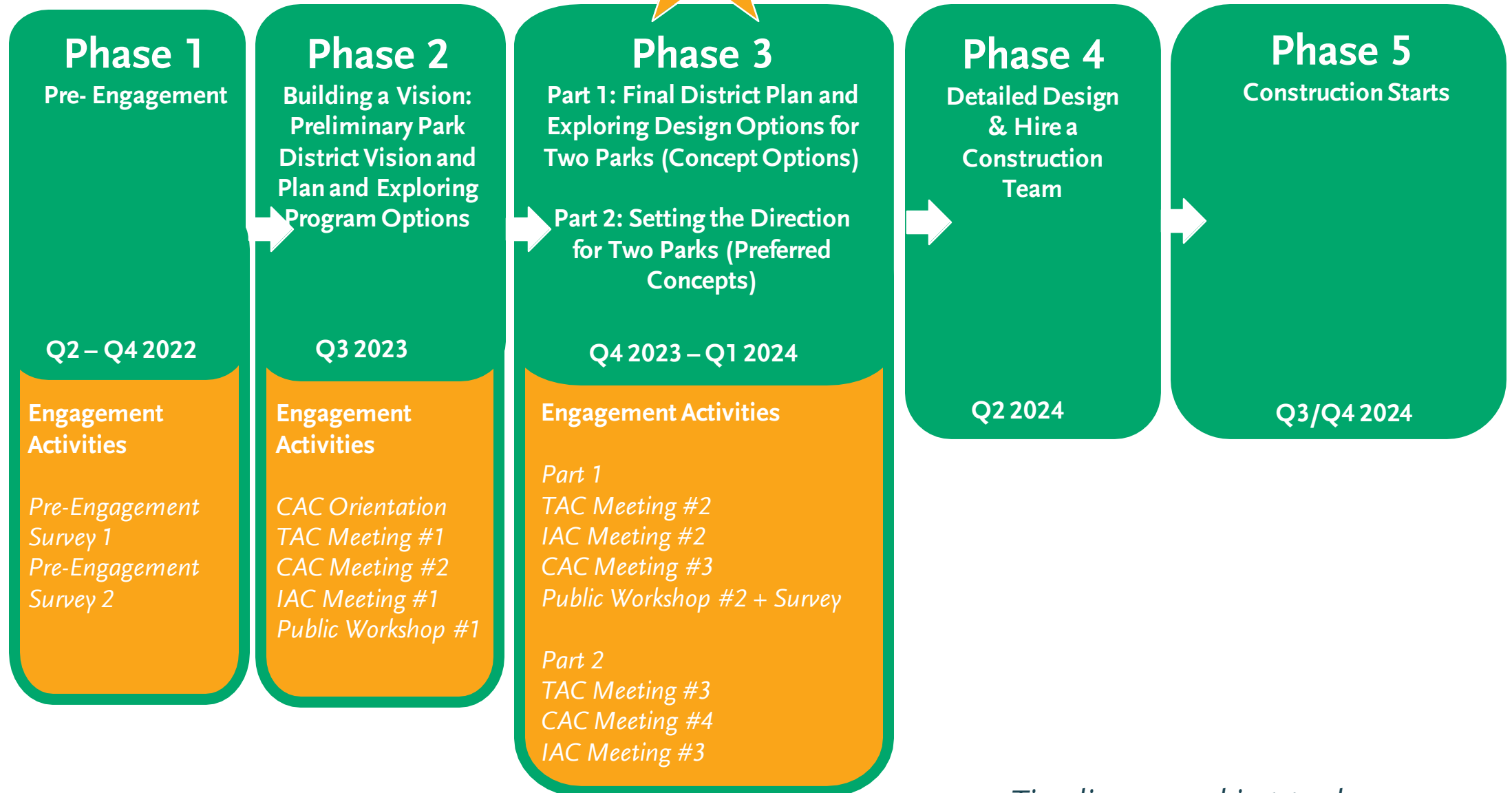

Design Process



SITE PROGRAM

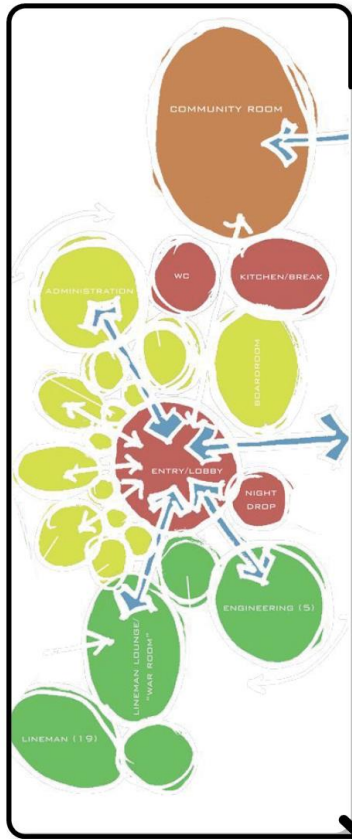

VISIONING

DRAFT DESIGNS



EXPLORING OPTIONS / SETTING THE DIRECTION

PREFERRED DESIGNS



DESIGN DEVELOPMENT

CONSTRUCTION DOCUMENTS

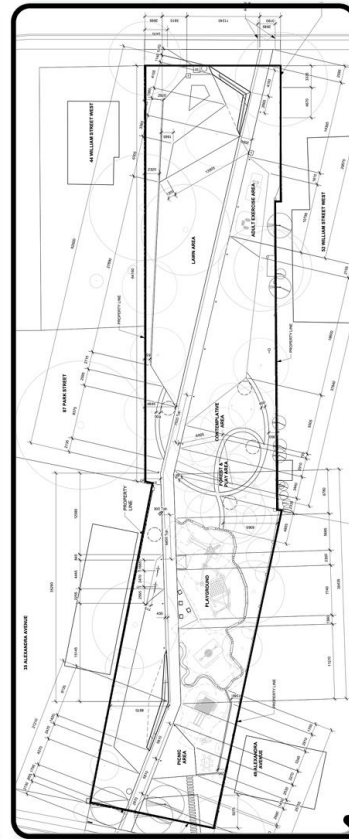

BIDDING

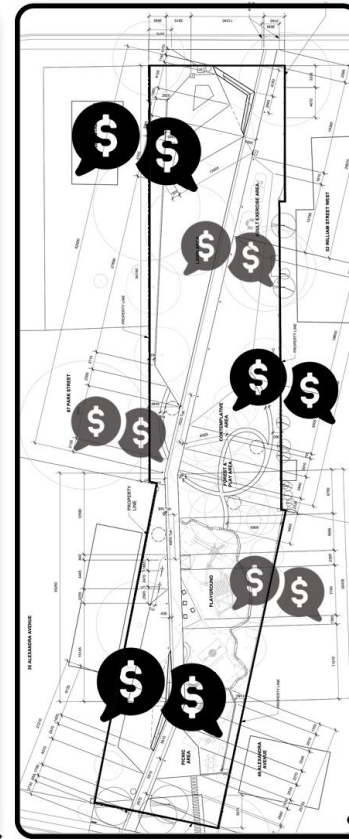

PROCUREMENT & CONSTRUCTION

CONSTRUCTION

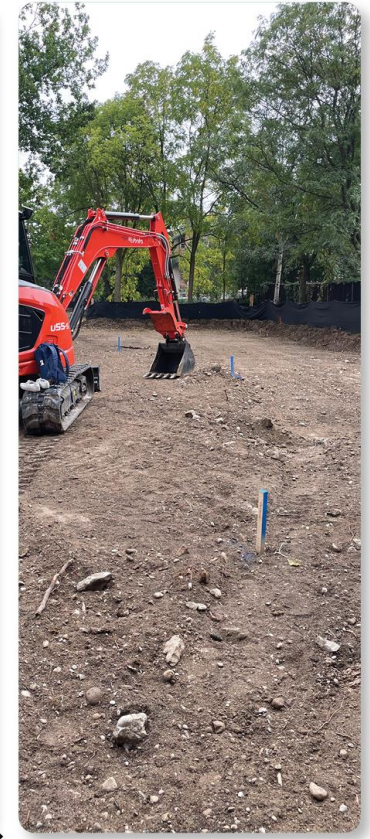

Vision Statement & Guiding Principles

Vision Statement

*A **Vision Statement** is a succinct declaration outlining a project's future goals, values, and direction, guiding the design with purpose and inspiration.*

The Six Points Park District will serve as an inclusive green haven, capturing the community's essence as a place that honours local heritage, embraces cultural experiences, and fosters collective aspirations for the future. This new park district will be the result of thoughtful collaboration with local community members and careful application of accessibility design standards and will provide comfortable safe spaces for the community to gather and connect. By incorporating sustainable design and Indigenous placekeeping and placemaking, the Six Points Park District will blossom into a network of vibrant green spaces where diverse groups of all ages can convene, enjoy the outdoors, forge connections, and flourish year-round.

Guiding Principles

A Guiding Principle is a fundamental concept that informs design, balancing human needs with sustainable considerations to create functional and aesthetically pleasing spaces.

Multi-Generational & Multi-Cultural

- Create park spaces that are intergenerational and inclusive.
- Provide a balance of programming and amenities across the park network that cater to the existing and upcoming neighborhood and people of all demographics.
- Reflect and celebrate the neighborhood's unique character and explore interventions that pay homage to the area's heritage and evolution over time.

Diverse Park Spaces

- Create spaces that accommodate different scales, with different configurations and amenities to accommodate active, passive, and flexible recreation opportunities.
- Incorporate large and small gathering spaces, intimate spaces, and peripheral spaces.

Integrate Ecology

- Incorporate planting zones that support biodiversity, stormwater management, air pollution, and heat island mitigation.
- Align with Indigenous values by using sustainable practices, native plants, and involving communities in long-term stewardship.
- Introduce trees and planting to provide plenty of shade and to benefit the psychological well-being of individuals.

Community

- Create a diversity of park types and community spaces with strong distinctive characteristics appropriate for each parks' unique location within this emerging neighbourhood.
- Incorporate placekeeping elements that recognize and reconnect to the origins of the land and the narratives that honour Indigenous belonging and Indigenous place.
- Ensure the four parks are well-connected to each other and to other green spaces near-by.
- Create a strong network of parks that work together as a whole.

Accessibility, Comfort & Safety

- Prioritize parks that are accessible and comfortable for people of all ages, abilities, and impairment.
- Provide park spaces that feel safe for all people, are well-lit, and well-maintained.
- Provide safe and easy connections to parks that consider existing and planned circulation routes, patterns, and desire lines.
- Buffer park edges that are adjacent to busy roads to improve safety and comfort, enhance park spaces, and mitigate noise from rail and roads.

What We Found

Current Programs: Gaps & Opportunities

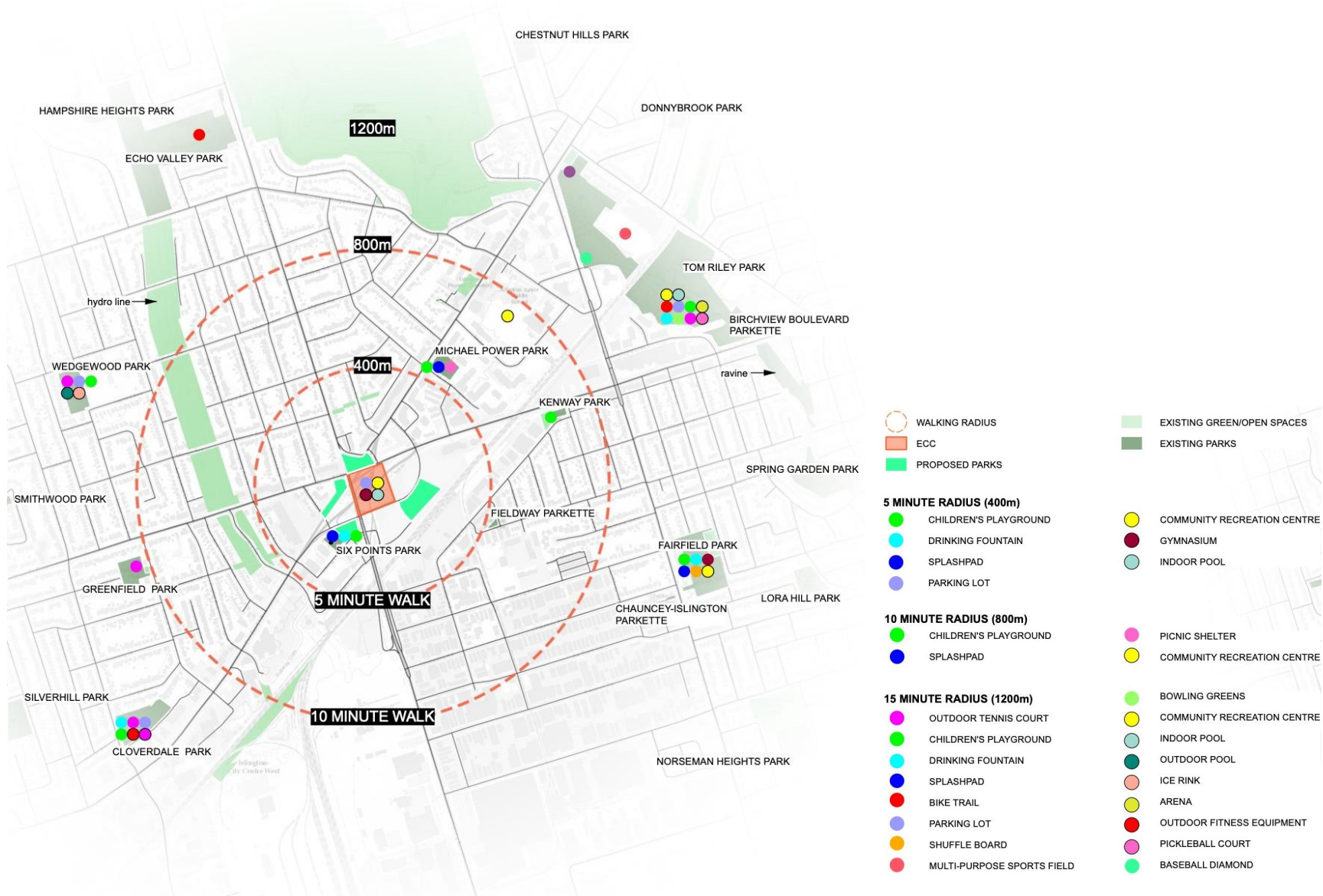

What We Found:

- The area is short of green spaces and parks within a 5-minute neighborhood walking radius.
- Analysis for the area show that some programs are absent from the area and should be considered. These programs include an outdoor basketball court, a skate park or skate spot, and an outdoor artificial ice rink.

Site Analysis Summary

Circulation & Nodes

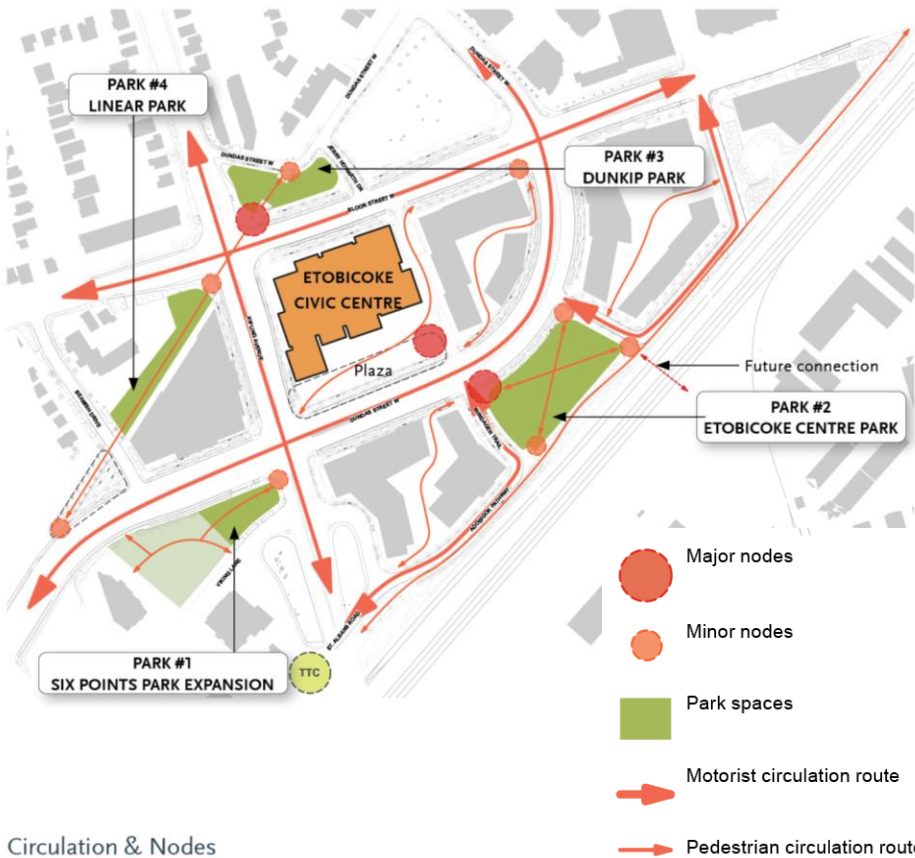

Circulation & Nodes

Urban Edge



Cycling Infrastructure

What We Found:

- All four parks are well-connected to motorist, pedestrian, and cycling routes.
- Urban edges create an opportunity for social interaction.
- Protected or buffered areas create opportunities for active recreation.
- Noise in the parks can be managed with buffer zones by sound masking or by introducing programs that are themselves noisy.
- There is a visual link between Dunkip Park & Linear Park across the intersection (along the Dundas Street historical alignment.)

Future Planned Area Development

Block 01 – 26 Floors



Etobicoke Civic Centre – 16 Floors



Potential Future OLA
At Pinnacle Etobicoke
5415 Dundas St W
9 Towers – 25 to 43 Floors



3825 Bloor Street West
4 Towers – 25 to 45 Floors



Block 03 – 30 Floors

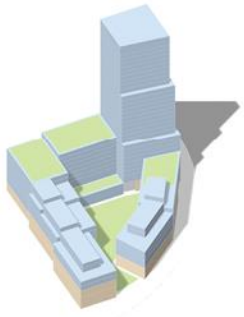

Block 05 – 28 Floors

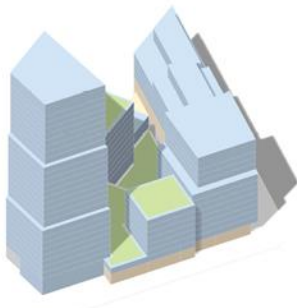

Block 06 – 39 Floors



Block 07 – 33 Floors

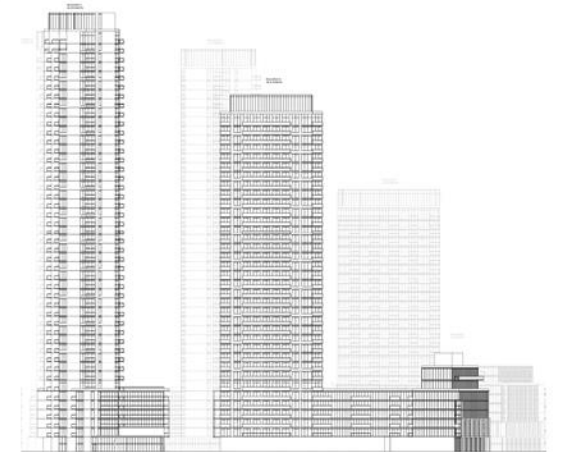
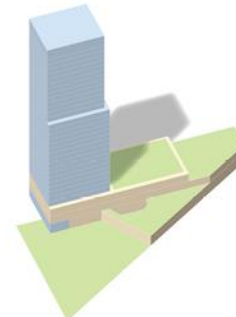

Park Typologies & Green Space Network

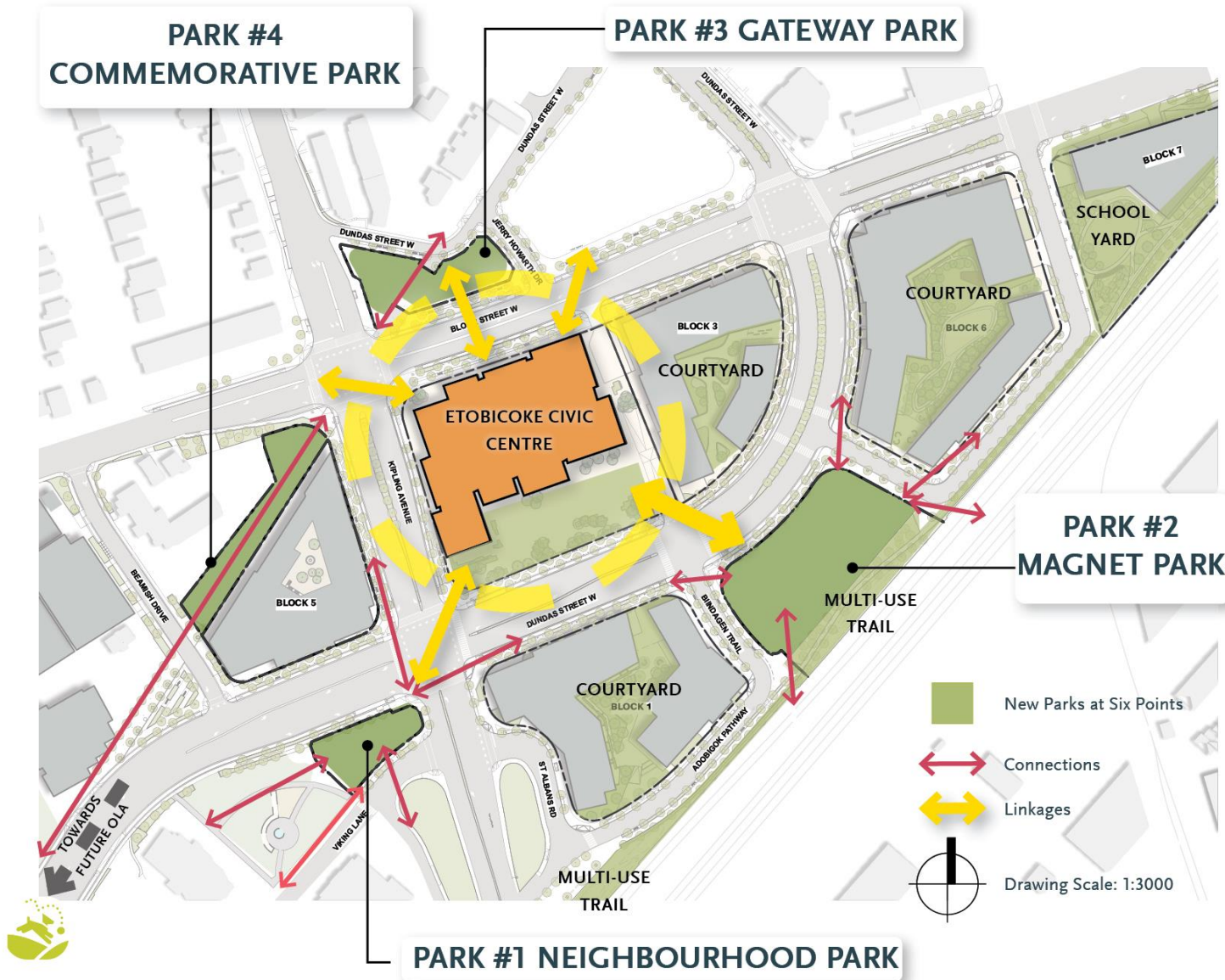

PARK #1 Neighbourhood Park

An intimate park with an exposed eastern edge, tucked into the established neighbourhood.

PARK #2 Magnet Park

A centrally located destination park facing the new Civic Centre with busy street edges on all four sides can provide a spill-over space from the Civic Centre plaza.

PARK #3 Gateway Park

A connector park that makes links to surrounding nearby communities. (East to Islington BIA, West along Bloor Street, North and South to Wards 2 & 3 respectively). Together the park and Civic Centre define the precinct entry

PARK #4 Commemorative Park

This park commemorates the historic Dundas Street alignment and will include design elements that accentuate movement along the historic path.

What We Heard

CAC Meeting #1 & #2 – What We Heard

Accessibility and Inclusivity:

- Prioritize accessibility for all ages and abilities.
- Design inclusive spaces with amenities and seating options.
- Multi-generational and cater to diverse demographics including seniors, families, and individuals with disabilities.
- Ensure bike lanes and wheelchair paths are clearly indicated for those using walkers/ wheelchairs.
- Consider connectivity to future potential pedestrian bridge over the rail tracks.

Green Space and Outdoor Amenities:

- Increase green spaces for gatherings and relief from concrete.
- Introduce amenities for families, youth, seniors, and pets.
- If the existing tree has a lifespan of 15 years, plan ahead with that in mind.

Community Engagement and Cultural Improvement:

- Include public art and provide space for gathering, events and ceremonies.
- Incorporate space for neighbours to meet up, have ceremonies, and create a community
- Celebrate neighborhood's character and heritage.

Safety and Functionality:

- Separate vehicles from pedestrians, incorporate berms between the two areas for buffer.
- Getting to these parks would be very dangerous, thus, ensure safe access to the parks, traffic calming are in place all year round.
- Traffic incidents at the south side of Kipling and Dundas call for buffer at that corner.

CAC Meeting #1 & #2 – What We Heard

Park Design Amenities:

- OLA at Six Points Park Expansion would be a good combination with the existing amenities.
- Horticultural / community garden, water fountain, or a woodlot can be incorporated in Dunkip Park.
- Multi-sports court and multi-purpose lawn are great for Etobicoke Centre Park that can cater to young adults and teenagers free of cost.
- Include stage / amphitheatre area.
- Dogs off-leash (OLA) areas are usually fenced and therefore reduce the amount of open space available for people.
- Keep and utilize mature trees to help create an "oasis" or green space that blocks out nearby traffic noise.
- Incorporate outdoor exercise equipment.
- Incorporate amenities like BBQ stations, fire pits, smoking areas, games tables, golf / putting green, and staff meeting room.
- Include skateboarding and other youth program options in the Park District Plan.

General Feedback:

- Year-round activity for Etobicoke Centre.
- Emphasized importance of accessibility and proposed RHFAC certification.
- Suggested following Ontario, Toronto, and specialty groups' accessibility recommendations.
- Recommended application for Canadian Tire Jumpstart Inclusive Play Spaces program.

What We Heard To-Date Summary

Accessibility

"Ensure bike lanes and wheelchair paths are clearly indicated for those using walkers/ wheelchairs."

Community

"Integrate spaces where neighbours can gather, hold ceremonies, and foster a sense of community."

Multi-Generation Use

"hoping to see the multigenerational spaces that would allow persons to meet and engage and where community building can be encouraged."

Safety

"User's safety and accessibility should be a high priority."

Inclusivity

"Ideal location for a skate spot or basketball court, tailored to the preferences of young adults and teenagers, without any associated fees."

Green Space

"Need more places for people to go for walks and enjoy nature, without much noise. It would be nice to make spaces for adults to relax after work."

Balance of Activities

"Some of the parks could be dedicated to louder, active recreation opportunities, while other parks could be dedicated to quiet, nature contemplation, and passive recreation."

Recreational Use

"Neighbourhood has children, so activities like skateboarding, basketball, ping pong, and fitness amenities would be appreciated."

Buffer Zones

"Nature buffering street noise so it doesn't feel like you're on the street"

Common Themes

Passive & Quieter
Activities

Active Recreation

Intimate Spaces

Large Gathering Spaces

Varied Seating Options

Dedicated Biking &
Walking

Noise / Traffic Protection

Dense Planting

Abundant Tree
Shade

Native / Cultural Gardens

Horticultural / Pollinator
Gardens

Multi-Purpose
Lawns

Summary and Programs

SITE	WHAT WE FOUND	WHAT WE HEARD	PROGRAMS
 <p>PARK #1 SIX POINTS PARK EXPANSION</p> <p>1,600 m²</p>	<ul style="list-style-type: none"> • Small site area. • Connected to established neighbourhood. • Slopes to north edge. • Noisy site, exposed to busy roads. 	<ul style="list-style-type: none"> • Incorporate quieter options since it is so close to housing. • Avoid basketball and skateboarding. • Incorporate trees, shaded seating areas, and noise buffering planting. • Small dogs off-leash area is a strong desire but concern about animal waste. • Incorporate simple outdoor fitness equipment. • More play space. • Less concrete, more green space. • Community garden, nature and quiet spaces, less concrete. 	<ul style="list-style-type: none"> • Passive & quieter activities • Noise / traffic protection • Variety of seating / gathering options • Ample green space • Existing tree preservation • Dogs off-leash area
 <p>PARK #2 ETOBICOKE CENTRE PARK</p> <p>5,500 m²</p>	<ul style="list-style-type: none"> • Centrally located in the neighbourhood. • Permeable edges with entrances at all corners. • Gradual & gentle topographical changes. • Large park site suitable for active recreation. 	<ul style="list-style-type: none"> • Best suited to active sports. • Accommodate overflow from Civic Centre. • Incorporate nature-based play and a certified accessible plan area. • Incorporate sports activities like tennis, pickle ball, basketball, baseball etc. • Pavilion or sweat lodge for elders to conduct workshops and work with Indigenous teachings. • BBQ stations to serve condo residents. • Incorporate public washrooms. • Strong desire for green space and trees, less concrete. • Buffer to noisy edges. • Activities for teens and youth. 	<ul style="list-style-type: none"> • Active recreation • Passive recreation • Shade structure • Commemorative art • Variety of seating / gathering options • Abundant tree shade • Noise / traffic protection • Public amenities like washroom • Play areas like nature-based playground • Bike share
 <p>PARK #3 DUNKIP PARK</p> <p>2,210 m²</p>	<ul style="list-style-type: none"> • 'Island' site with roads on four sides. • Historic and Commemorative entrances already in place. • Situated in immediate vicinity of ECC. • Existing tree serves as visual anchor. • Edges largely unscreened, exposed to traffic 	<ul style="list-style-type: none"> • Incorporate horticultural garden or pollinator garden. • Desire for passive green space. • Incorporate seating for people waiting or having lunch. • Incorporate buffer to traffic and noise. • Incorporate elements that represent the Indigenous community from Etobicoke. 	<ul style="list-style-type: none"> • Passive recreation • Indigenous / cultural garden • Indigenous community representation • Variety of seating options • Noise and traffic protection. • Historic marker interpretation • Existing tree preservation
 <p>PARK #4 LINEAR PARK</p> <p>2,708 m²</p>	<ul style="list-style-type: none"> • Park is aligned along historical and commemorative path and desire line. • Variations in slope from steep to gentle. • Enhanced by a band of shade trees. • Adjacent parking lot, future development and potential expansion area. 	<ul style="list-style-type: none"> • Promenade would be a great opportunity. • Biking would be ideal, incorporate bike share. • Skate spot will be ideal at this location. • Incorporate elements that represent the Indigenous community from Etobicoke. • Provide green space and shade. • Indigenous language signage (all parks). 	<ul style="list-style-type: none"> • Abundant tree Shade • Dedicated walking and biking lanes • Seating / gathering area • Indigenous-focused mural art • Skate spot • Bike share

Design Approach: Park District Plan

Program Types

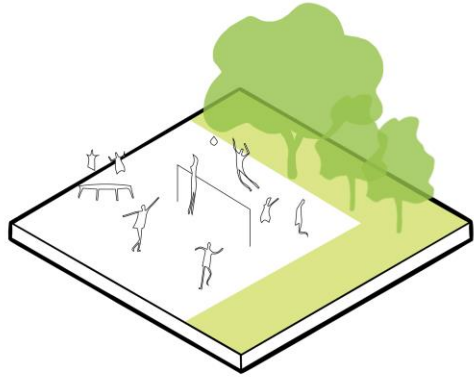

Active / Programmed

Refers to areas within a landscape that are intentionally designed and designated for specific recreational activities, such as basketball, skate spot, etc.

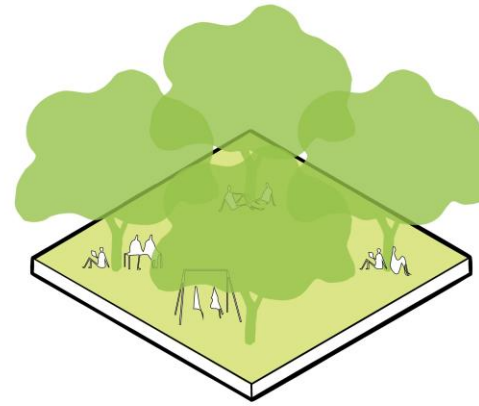



Passive / Informal

Refers to areas designed for leisure activities, such as reading and relaxation, as well as multi-use spaces accommodating both active and passive pursuits.

Program Types



-  PASSIVE / INFORMAL
-  ACTIVE / PROGRAMMED

Landscape Functions

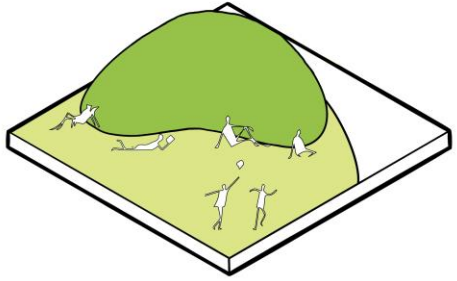

Buffer

Refers to the shape, structure, and arrangement of plants within a planting strategy. This involves selecting plants based on their shapes and sizes to achieve specific aesthetic and functional goals, such as creating focal points, providing screening, or defining boundaries.

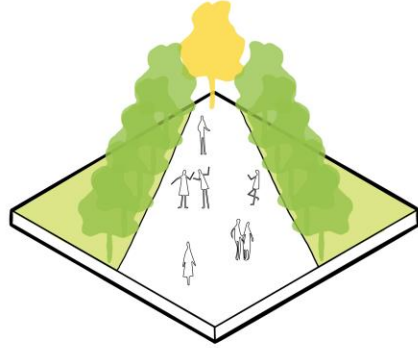

Frame

Landscape forms intentionally placed to visually frame or highlight specific focal points or views within the park.

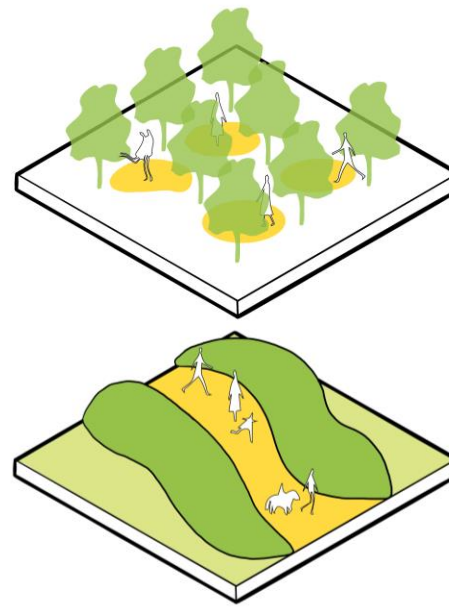

Channel/Filter

Landscape forms strategically placed to guide movement, offering both functional guidance and aesthetic enhancements to the pedestrian experience.

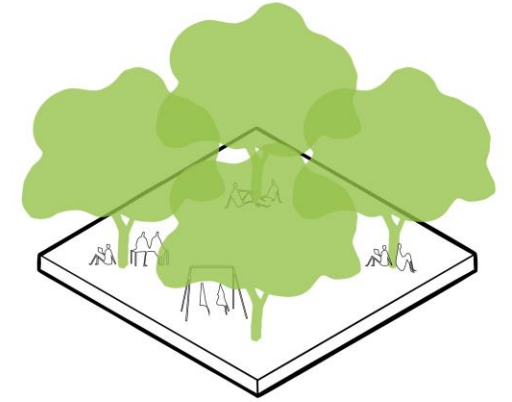





Canopy

Landscape forms strategically placed to create shelter overhead, to filter light, provide partial protection from wind and sun, and to provide shade.

Landscape Functions



-  Buffer
-  Frame
-  Channel
-  Filter

Placemaking / Placekeeping

Placemaking/Placekeeping elements can be woven into the park's design to embody the cultural and artistic traditions of the district, to encourage a deeper, more contemplative engagement with the landscape, and to honour Indigenous heritage.

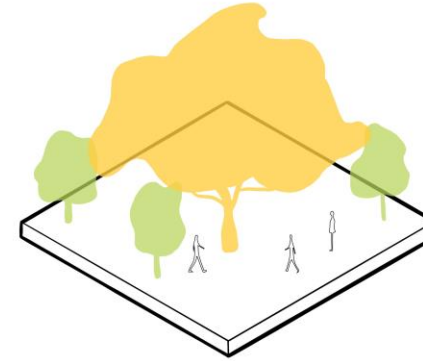
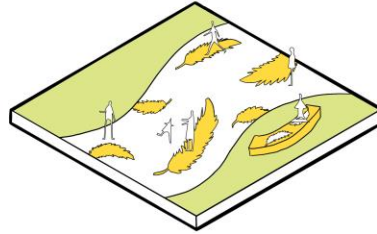
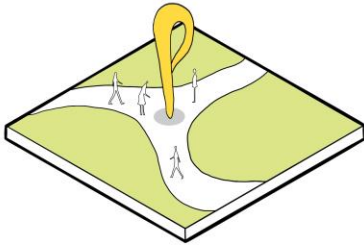
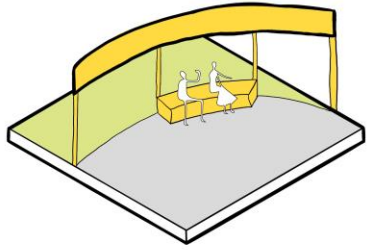

Structures

Encompass symbolic structural elements celebrating cultural heritage, recognizable design features unifying districts, art installations as striking focal points, and embedded art discreetly unveiling cultural elements during park exploration.



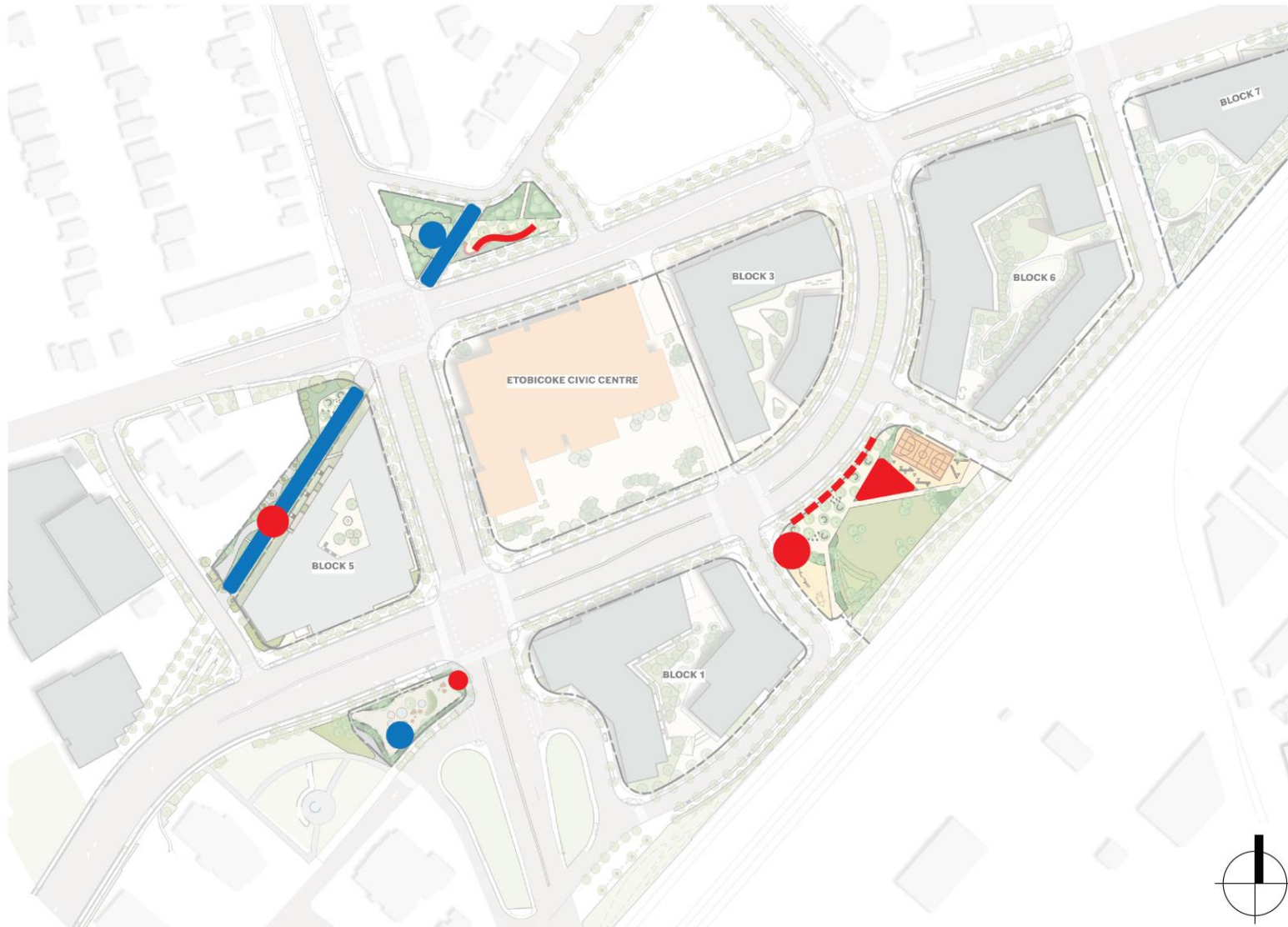

Existing Landmark

Existing Landmark" refers to a pre-existing feature within a landscape that holds significant visual, cultural, historical, or functional value; often serving as a focal point and contributing to the overall aesthetics and character of the landscape.

Placemaking / Placekeeping



STRUCTURES

-  Pavillion
-  Screen
-  Feature Bench
-  Art Element (not part of public art program)

EXISTING LANDMARKS

-  Old Tree
-  Old Dundas Street

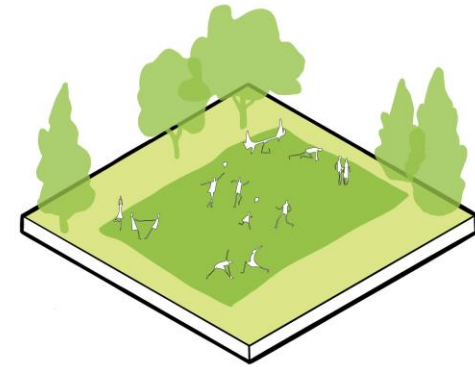
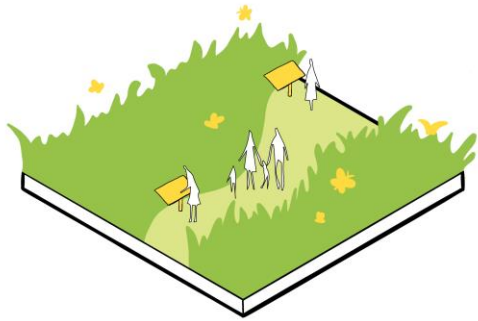

Ecological

Refers to environmentally responsible strategies that harmonize with local ecosystems using native plants, promoting biodiversity, implementing sustainable practices to support wildlife, conserve resources, and improve soil health. This approach not only acts as an educational catalyst but also leverages educational tools like informative signage to heighten awareness about ecology.

Cultural



Refers to a shared space where community members collectively grow plants of cultural, historical, or symbolic significance, fostering stewardship and celebrating traditions.

Recreational

Refers to the strategic design of spaces, such as large multi-purpose lawns, intended to provide areas for leisure, sports, and various recreational activities within the park.

Greening



-  Ecological
-  Cultural
-  Recreational

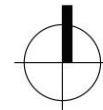

Spatial Diversity

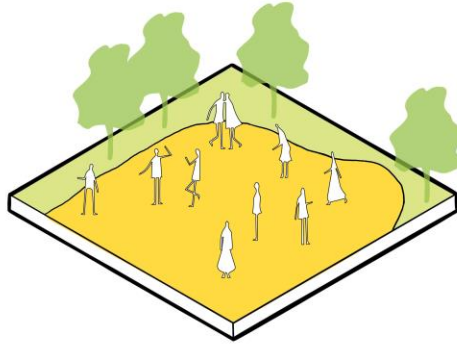

Large Gathering Space

Sizable area in the park designed to comfortably accommodate gatherings, events, and activities involving a large group of people.

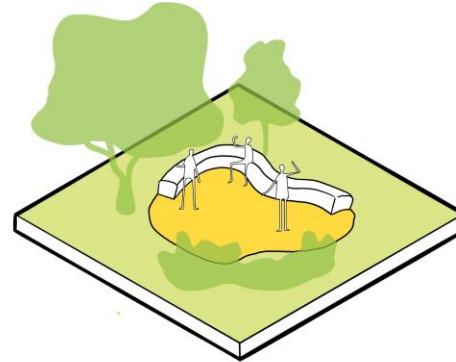

Small Gathering Space

Compact areas designed for small numbers of people, for relaxation, contemplation, or for privacy, solitude, and a sense of seclusion.

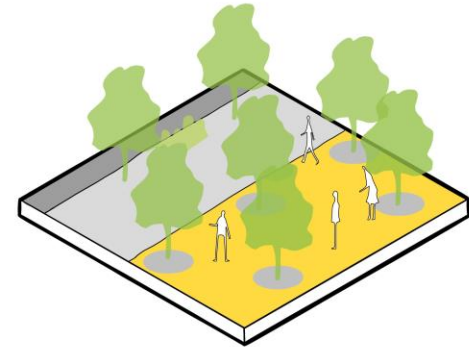

Peripheral Space

Areas located at the edges or boundaries of the site, serving as transitional zones between the park and its adjacent streetscape.

Spatial Diversity



- Large Gathering Spaces
- Large Gathering (POPS)
- Small Gathering Spaces
- Small Gathering (POPS)
- Peripheral Spaces

Walking Routes

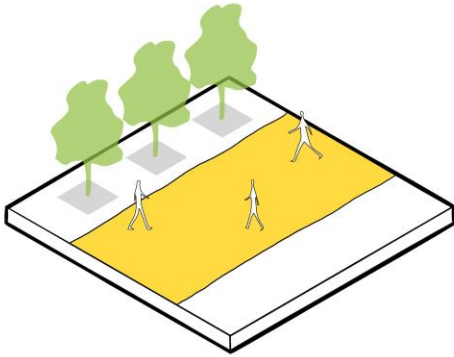

Major Path

Prominent and well-defined accessible route facilitating movement and circulation through the space.

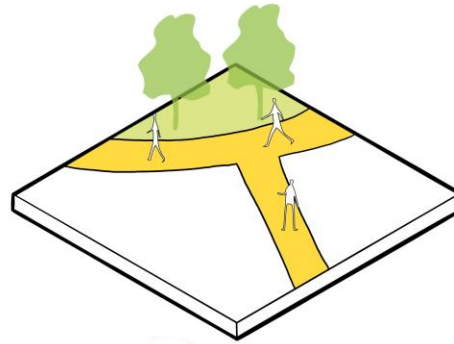

Minor Path

Smaller, less prominent accessible route that provides secondary circulation.

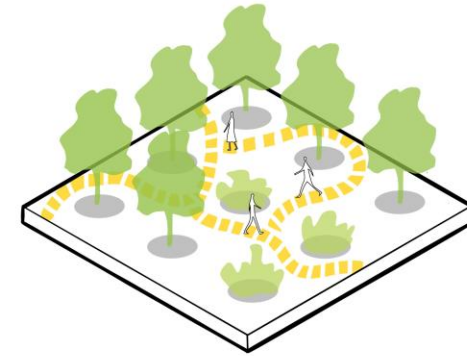

Meandering Movement

Informal winding routes that create a relaxed and scenic experience through park.

Walking Routes

Major, Minor, Meandering

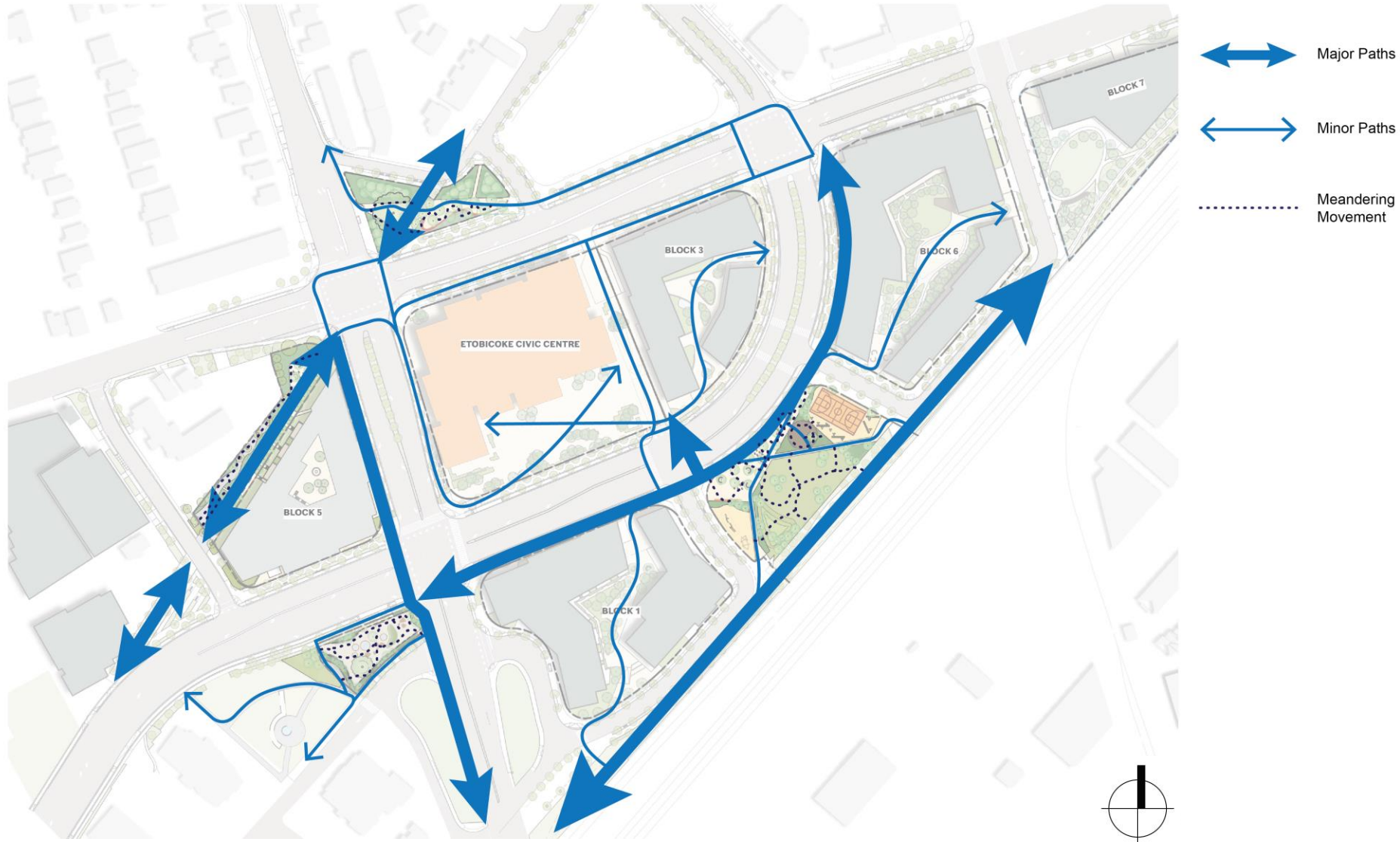

Draft Park District Plan

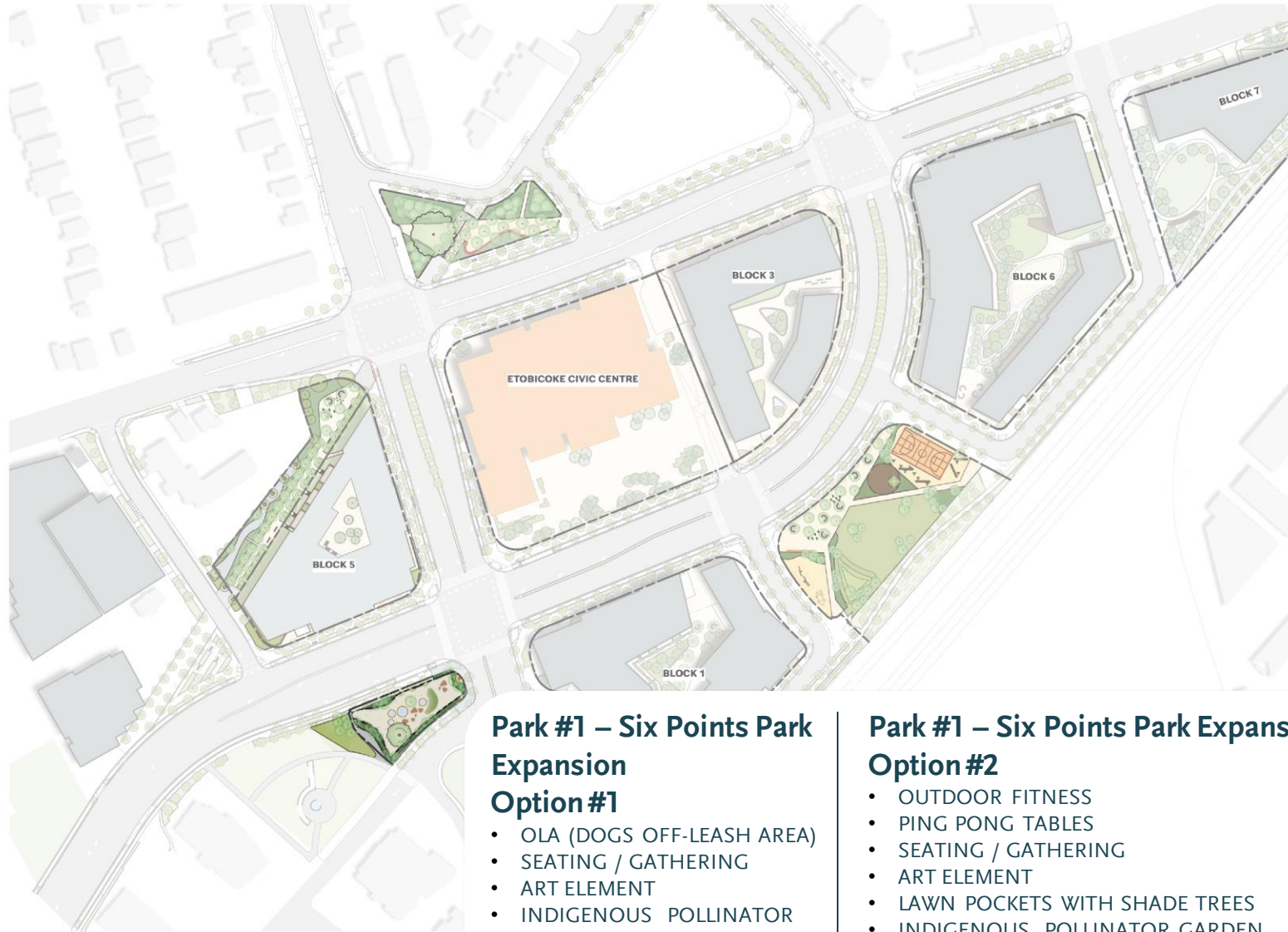

*A **Park District Plan** is a strategic plan that outlines the design, layout, and development of public park(s) within a specific area, considering community needs, sustainability, and recreational features.*

Park #1 – Six Points Park Expansion Option #1

- OLA (DOGS OFF-LEASH AREA)
- SEATING / GATHERING
- ART ELEMENT
- INDIGENOUS POLLINATOR GARDEN
- INDIGENOUS INTERPRETIVE SIGNAGE

Park #1 – Six Points Park Expansion Option #2

- OUTDOOR FITNESS
- PING PONG TABLES
- SEATING / GATHERING
- ART ELEMENT
- LAWN POCKETS WITH SHADE TREES
- INDIGENOUS POLLINATOR GARDEN
- INDIGENOUS INTERPRETIVE SIGNAGE
- HORTICULTURAL PLANTING
- PICNIC AREA

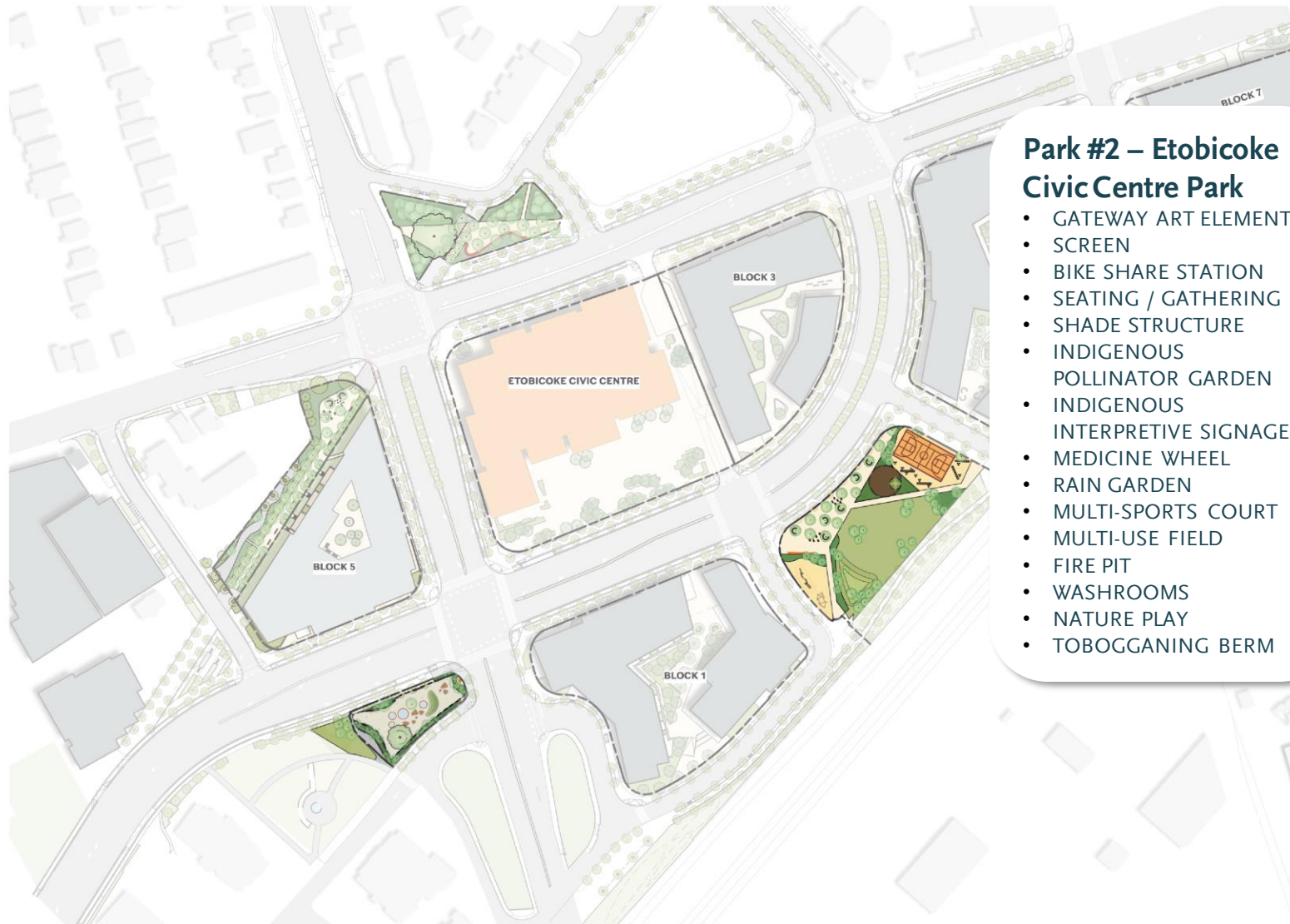

Park #2 – Etobicoke Civic Centre Park

- GATEWAY ART ELEMENT
- SCREEN
- BIKE SHARE STATION
- SEATING / GATHERING
- SHADE STRUCTURE
- INDIGENOUS POLLINATOR GARDEN
- INDIGENOUS INTERPRETIVE SIGNAGE
- MEDICINE WHEEL
- RAIN GARDEN
- MULTI-SPORTS COURT
- MULTI-USE FIELD
- FIRE PIT
- WASHROOMS
- NATURE PLAY
- TOBOGGANING BERM

*A **Park District Plan** is a strategic plan that outlines the design, layout, and development of public park(s) within a specific area, considering community needs, sustainability, and recreational features.*

Draft Park District Plan

Park #3 – Dunkip Park Option #1 & Option #2

- HERITAGE ART INTERPRETATION
- INDIGENOUS POLLINATOR GARDEN
- INDIGENOUS INTERPRETIVE SIGNAGE
- HORTICULTURAL PLANTING
- SEATING / GATHERING
- SKATEABLE BENCHES / SKATE SPOT



*A **Park District Plan** is a strategic plan that outlines the design, layout, and development of public park(s) within a specific area, considering community needs, sustainability, and recreational features.*

Draft Park District Plan

Park #4 – Linear Park

- BIKE SHARE STATION
- CHESS TABLES
- HERITAGE ART INTERPRETATION
- INDIGENOUS-FOCUSED MURAL
- INDIGENOUS POLLINATOR GARDEN
- INDIGENOUS INTERPRETIVE SIGNAGE
- HORTICULTURAL PLANTING
- SEATING / GATHERING
- MULTI-USE TRAIL
- OUTDOOR FITNESS



*A **Park District Plan** is a strategic plan that outlines the design, layout, and development of public park(s) within a specific area, considering community needs, sustainability, and recreational features.*

Draft Park District Plan

Park #4 – Linear Park

- BIKE SHARE STATION
- CHESS TABLES
- HERITAGE ART INTERPRETATION
- INDIGENOUS-FOCUSED MURAL
- INDIGENOUS POLLINATOR GARDEN
- INDIGENOUS INTERPRETIVE SIGNAGE
- HORTICULTURAL PLANTING
- SEATING / GATHERING
- MULTI-USE TRAIL
- OUTDOOR FITNESS

Park #3 – Dunkip Park

Option #1 & Option #2

- HERITAGE ART INTERPRETATION
- INDIGENOUS POLLINATOR GARDEN
- INDIGENOUS INTERPRETIVE SIGNAGE
- HORTICULTURAL PLANTING
- SEATING / GATHERING
- SKATEABLE BENCHES / SKATE SPOT

Park #2 – Etobicoke Civic Centre Park

- GATEWAY ART ELEMENT
- SCREEN
- BIKE SHARE STATION
- SEATING / GATHERING
- SHADE STRUCTURE
- INDIGENOUS POLLINATOR GARDEN
- INDIGENOUS INTERPRETIVE SIGNAGE
- MEDICINE WHEEL
- RAIN GARDEN
- MULTI-SPORTS COURT
- MULTI-USE FIELD
- FIRE PIT
- WASHROOMS
- NATURE PLAY
- TOBOGGANING BERM

Park #1 – Six Points Park Expansion

Option #1

- OLA (DOGS OFF-LEASH AREA)
- SEATING / GATHERING
- ART ELEMENT
- INDIGENOUS POLLINATOR GARDEN
- INDIGENOUS INTERPRETIVE SIGNAGE

Park #1 – Six Points Park Expansion

Option #2

- OUTDOOR FITNESS
- PING PONG TABLES
- SEATING / GATHERING
- ART ELEMENT
- LAWN POCKETS WITH SHADE TREES
- INDIGENOUS POLLINATOR GARDEN
- INDIGENOUS INTERPRETIVE SIGNAGE
- HORTICULTURAL PLANTING
- PICNIC AREA

A Park District Plan is a strategic plan that outlines the design, layout, and development of public park(s) within a specific area, considering community needs, sustainability, and recreational features.

Discussion

Preliminary Concept Options For Two Parks



Six Points Park Expansion (Neighbourhood Park)

Option 1 – Small OLA

Small off-leash area (OLA) with play features.
 Seating pockets at perimeter.
 Feature bench near entry.
 Planting buffers for noise/ traffic protection.
 Maintains existing tree and incorporates shade trees.



Option 1 – Small OLA

Perspective View



Option 2 – Green Oasis

Passive & quieter activities
 Outdoor fitness, ping-pong and picnicking.
 Abundant green spaces, including buffer for noise/ traffic protection.
 Variety of seating/gathering options.
 Meadow for nature connection
 Potential community pollinator garden zone

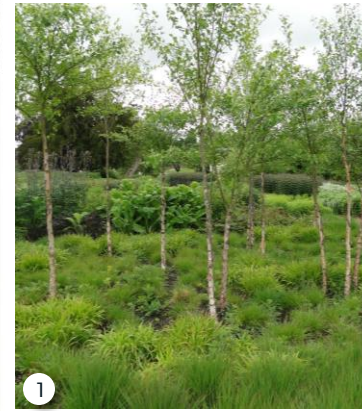

Option 2 – Green Oasis

Perspective View





Dunkip Park (Gateway Park)

Option 1 – Linear Plaza

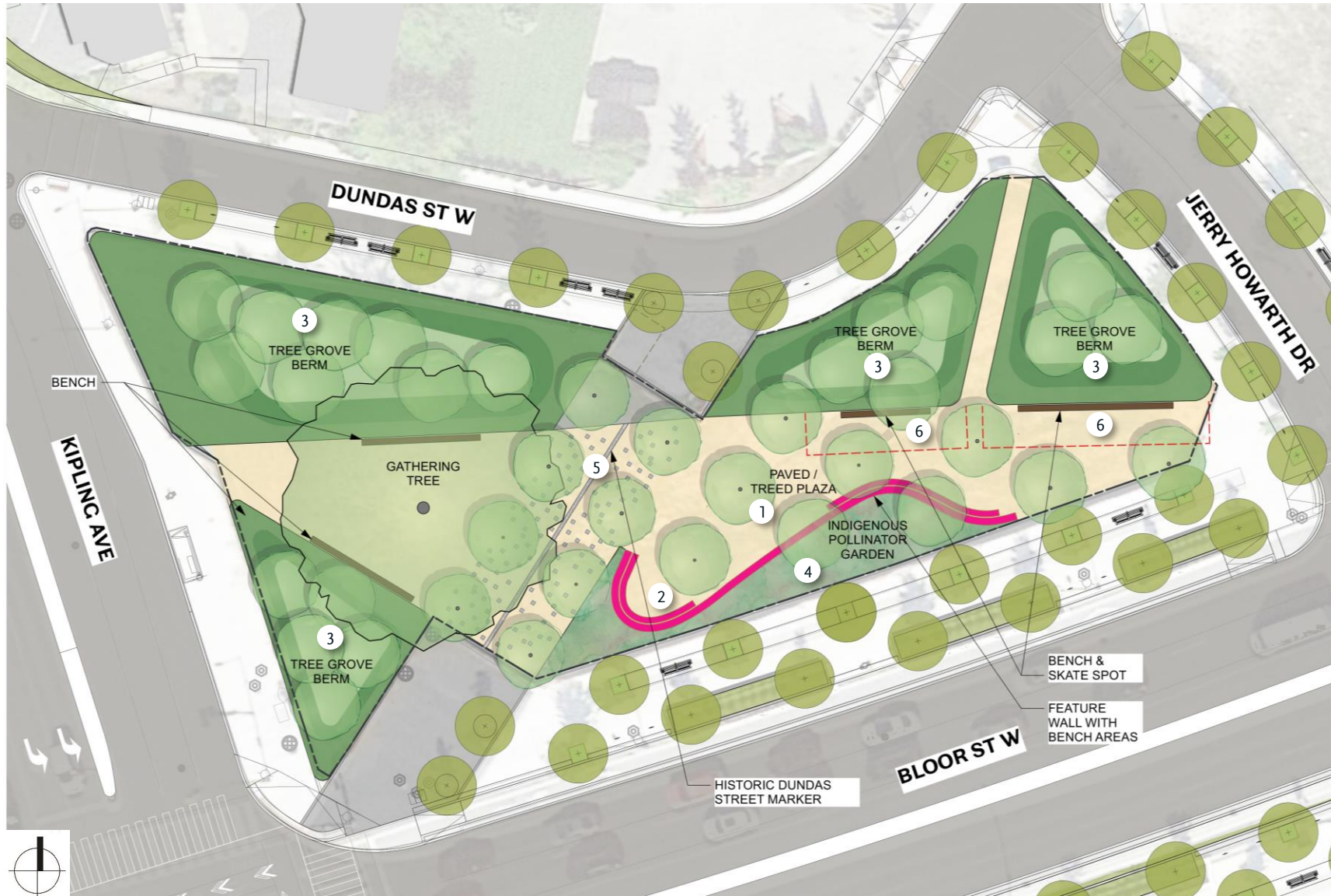

Passive uses.
 Linear plaza with existing gathering tree focal point.
 Treed plaza defined by distinct paving and seating at edges.
 Tree grove berms for noise and traffic protection on three sides.
 Curved, visually striking feature wall/bench.
 Indigenous pollinator garden facing Bloor.
 Embedded interpretative marker and paving pattern defines former Dundas St.

Option 1 – Linear Plaza

Perspective View



Option 2 – Two Gathering Trees



*Passive uses.
Two separate gathering spaces with two focal point trees.
Tree groves buffer noise and traffic on all sides.
Angular, visually striking feature wall with benches facing each gathering tree.
Indigenous pollinator garden framing east entry.
Embedded interpretative marker and paving pattern defines former Dundas St.*

Option 2 – Two Gathering Trees

Perspective View



**Any final questions or comments
on anything we've covered
today?**

Thank you!

Appendix

What We Heard

Community Engagement

Community Engagement Phase 1A: Pre-Engagement was **led and completed by City Staff**. This phase of the community engagement process started in summer 2022. The following were completed:

- Online Park District Thought Exchange visioning activity – November 2022
- Online park amenities visioning survey – June 2022

Community Engagement Phase 1B: Background Review, Site Investigations and Analysis is complete.

Community Engagement Phase 2A: Draft District Vision and Plan and Preliminary Park Options will be **led by PLANT with support from Saffy**.

This phase includes:

- Community Advisory Committee (CAC) meeting #1 (Complete)
- Community Advisory Committee (CAC) meeting #2 (Complete)
- Indigenous Advisory Circle (IAC) meeting #1 (Complete)
- Public Workshop – Draft District Plan and preliminary programming options (Complete)

TAC Meeting #1 – What We Heard

Accessibility and Inclusivity:

- Ensure wheelchair accessibility, including on-street accessible parking spots with easy access to paved trails and seating areas.

Green Space and Outdoor Amenities:

- Prioritize noise mitigation as a key element for enhancing park comfort.

Park Design Amenities:

- Recommend not utilizing small park space for OLA to maintain high standards; if OLA standards can't be met, consider alternative programming.
- Plan for bike parking at park entrances to encourage walking and reduce bike traffic on lawns.

Cultural Improvements

- Clarify responsibility for operating, funding, and maintaining the Westwood sign in the long term.
- Acknowledge the historical land-water connection at general slopes, which represents the former Lake Iroquois shoreline.
- Extend the historical alignment pavement material through the linear park.

General Feedback

- Minimize disruptions to existing infrastructure during park development.
- Coordinate with Toronto Water to clarify the integration and servicing of these parcels.
- Assess cumulative shadow and wind impacts from neighboring developments on park locations for programmatic spaces.
- Allow for maintenance vehicle parking.

IAC #1 – What We Heard

Accessibility and Inclusivity:

- Lack of vehicular parking makes parks inaccessible.
- Embrace all ages and provide a natural design materials approach.

Green Space and Outdoor Amenities:

- Include community gardens
- Incorporate Indigenous plantings with informative signage about their uses.
- Incorporate rain gardens

Park Design Amenities:

- Consider adding public washrooms.
- Incorporate OLA.
- Ensure each park complements what neighboring parks lack.
- Engage an Indigenous designer for certain placekeeping elements, where appropriate.

Indigenous Placekeeping & Community Development:

- Integrate Indigenous art design elements into benches and park features.
- Incorporate marker trees for wayfinding; Dunkip Park could have one pointing towards the Humber River.
- Feature Indigenous placekeeping at each park, highlighting resilience, history, technological innovations, and societal contributions.
- Explore the theme of Toronto's lost rivers to connect all the parks.
- Create a medicine wheel walk at Etobicoke Center Park.
- Identify someone to complete a ceremony at Six Points Park District to re-Indigenize the land.

Public Meeting #1 – What We Heard

Accessibility and Inclusivity:

- Incorporate activities for all age groups and all abilities.

Green Space and Outdoor Amenities:

- Create green spaces with trees and seating that can be easily maintained.
- Use vegetation as a noise and traffic buffer.
- Incorporate community garden in response to high demand.

Park Design Amenities:

- Careful consideration to how amenities are distributed between four parks to ensure programmatic elements are complementary.
- Allocate certain parks for louder, active activities and other parks for quieter, passive activities.
- Include a modest-sized off-leash area, addressing the absence of nearby options.
- Incorporate horticulture garden where appropriate along with plenty of walking space.
- Incorporate sports courts, fitness amenities, opportunities for nature-based play across parks.

Community Engagement and Cultural Improvement:

- Incorporate Indigenous placenames and ceremonial spaces.
- Include art or landscape features that convey the area's history.

Safety and Functionality:

- Address concerns about noise impact from adjacent buildings, traffic, and active recreation within the parks.
- Consider the comfort of park users in both hot and cold weather conditions.

Preliminary Program Options

Opportunities & Constraints



1
Constraint – The Park is currently focused on children’s play, and with limited space available, it will be a challenge to make the expansion area intergenerational.



2
Opportunity – Softened urban edge with streetscape that attracts and navigates people to the site.



3
Opportunity – Protected edges of the park are surrounded by an established neighbourhood.

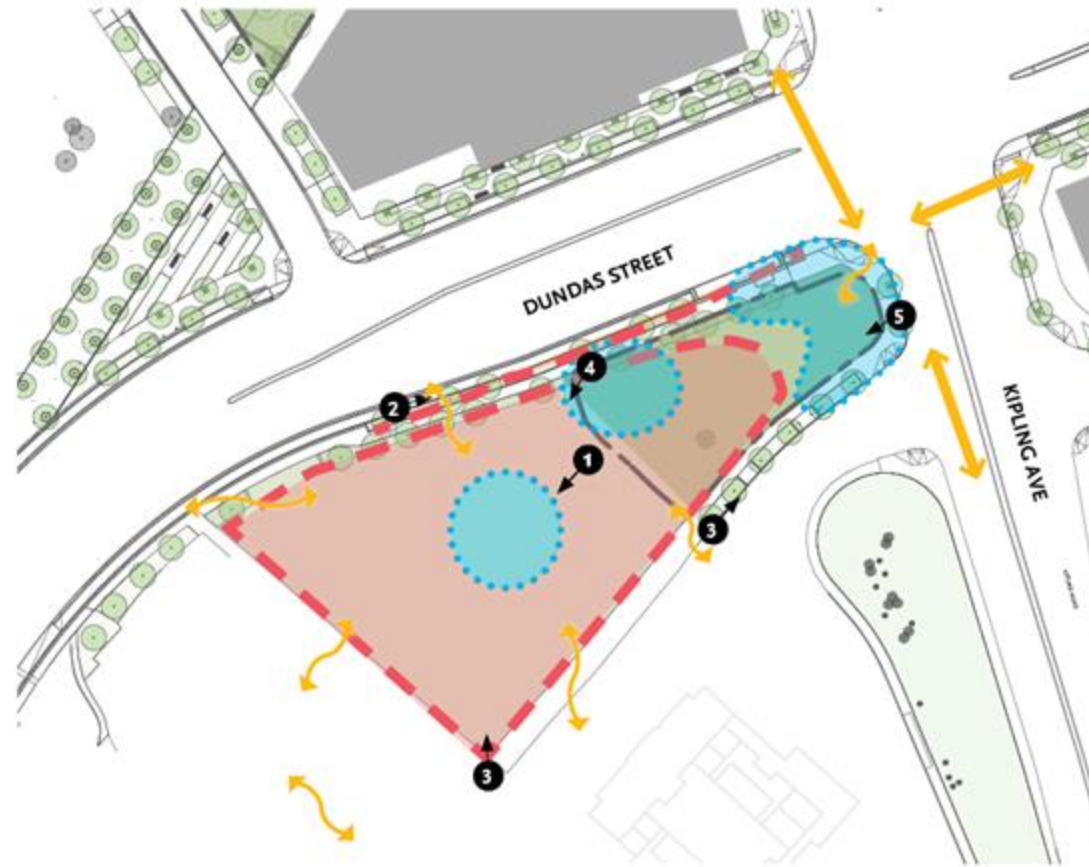

○ Opportunities
 ○ Constraints
 ↔ Formal Flow
 ↪ Filtered Flow
 Drawing Scale: 1:2000



4
Constraint – There is a slope to the site making it a challenge to make the park accessible for all.



5
Constraint – This is an exposed & noisy “peninsula” site with traffic on three sides, including a bus route at the south.

Primary Focus: Neighbourhood Park



Drawing Scale: 1:1000

PLAY

SPORTS ACTIVITIES
ACTIVE PLAY & RECREATION
ENTERTAINMENT
INTERACTIVE
FITNESS

→

WALKING
SMALL DOG OFF-LEASH
BASKETBALL HALF-COURT
SKATE SPOT
INTERACTIVE ART

GATHER

SITTING & LOUNGING
CONVERSATIONS
INTERACTIONS
FOOD PRODUCTION

→

PARK GATEWAY
SEATING
PING-PONG
ART INSTALLATION

NATURE

PROTECTION
WATER MANAGEMENT
BUFFER ZONES
NOISE REDUCTION
EDUCATION & LEARNING

→

PLANTED AREAS
PLANTING BUFFERS
PLANTED BERMS
SHADE/TREE GROVES
COMMUNITY GARDEN

Preliminary Program Fits: Neighbourhood Park

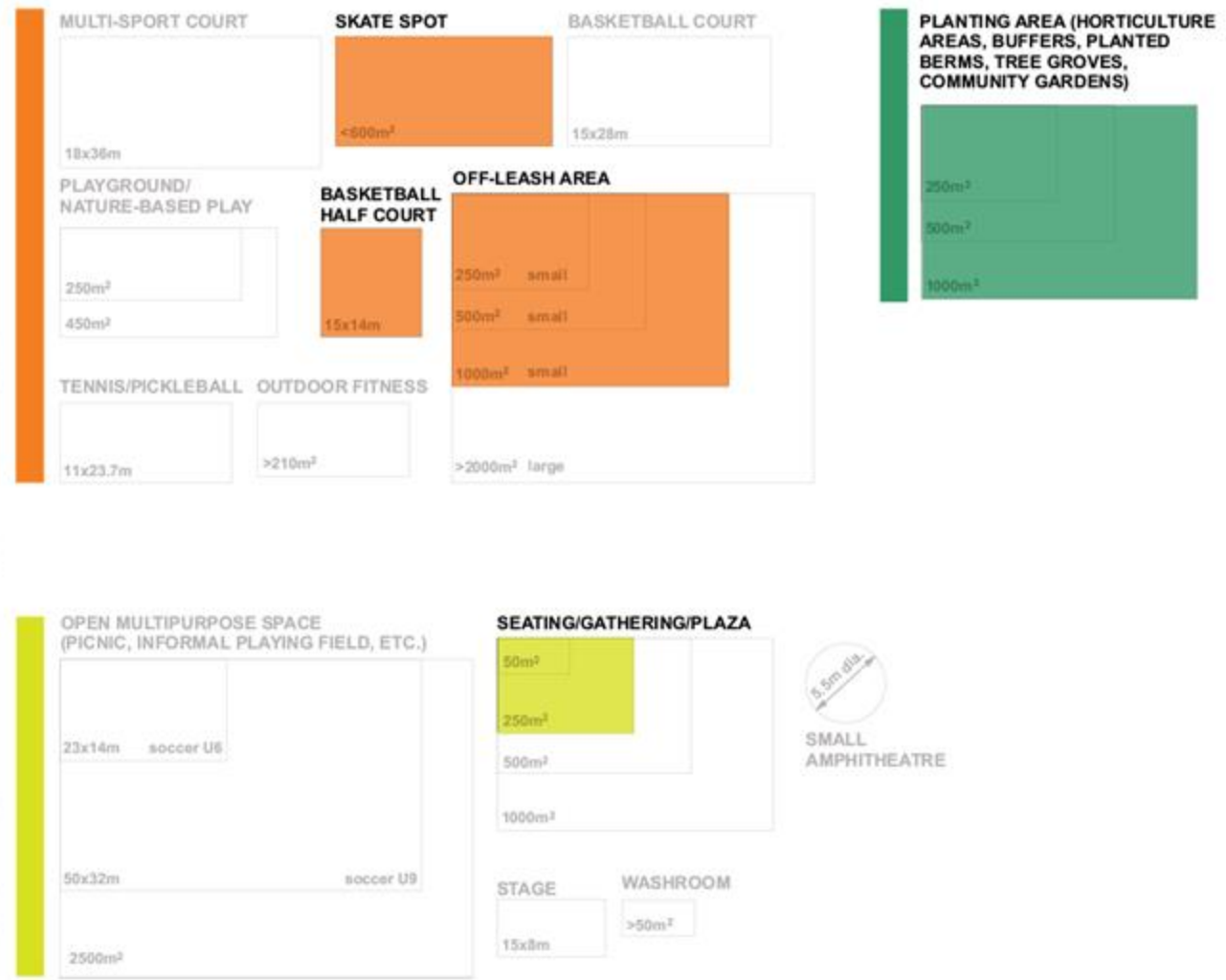

Drawing Scale: 1:1000

Opportunities & Constraints



1 Opportunity – Softened urban edge with streetscape that attracts and navigates people along the edge of the site.



2 Opportunity – Corner oriented towards Etobicoke Civic Centre providing a park gateway opportunity.



3 Opportunity – Gentle slope to the south accommodates active recreation and sports, and orients the site southwards.

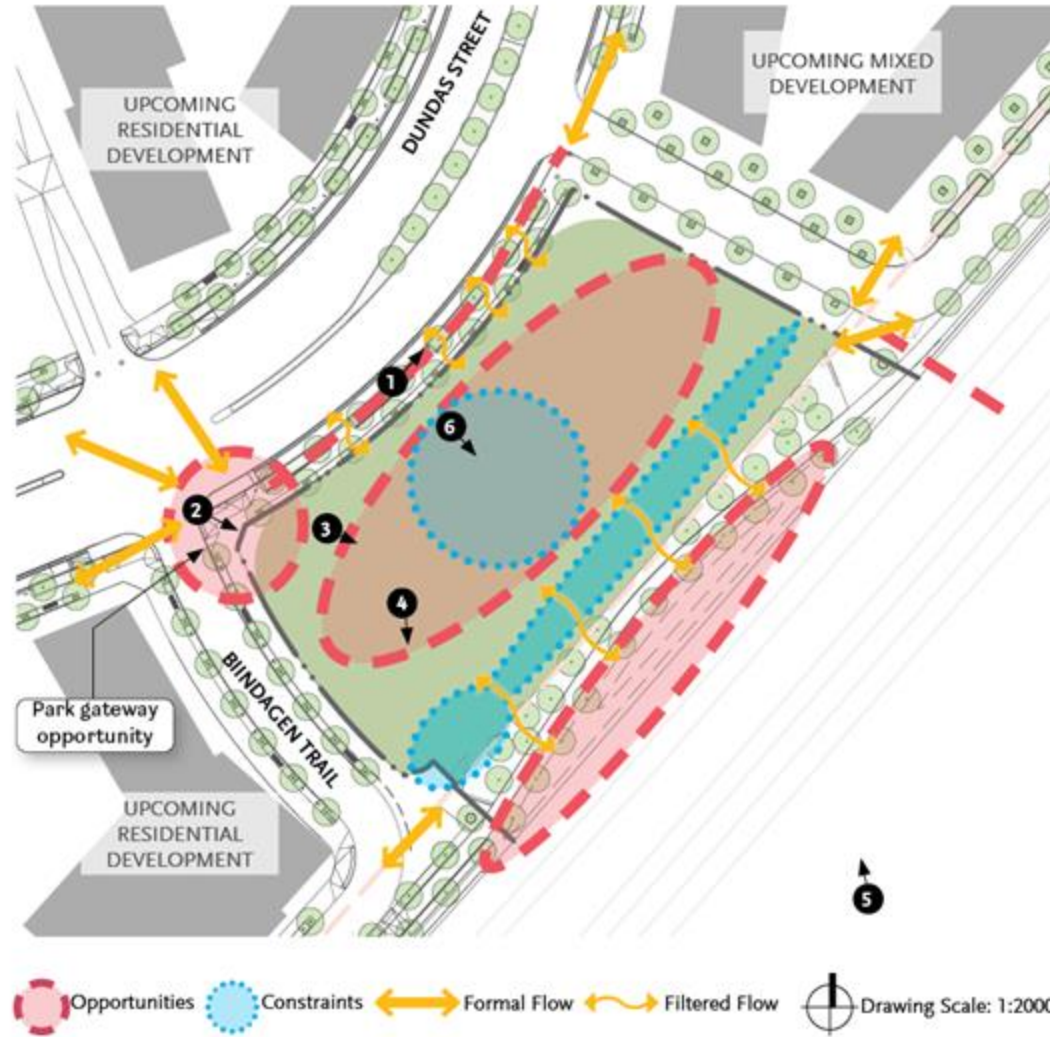

4 Constraint – Adjacency to rail tracks creates a higher noise condition at the south edge, requiring screening / buffering of sound.



5 Opportunity – Potential future bridge connection at south east corner would connect the site from all four sides.



6 Constraint – Site is exposed and south-sloping and provides plenty of tree shade/shade structure.

Primary Focus: Magnet Park



Drawing Scale: 1:1000

PLAY

SPORTS ACTIVITIES
ACTIVE PLAY & RECREATION
ENTERTAINMENT
INTERACTIVE
FITNESS



PLAYGROUND
OUTDOOR FITNESS
SKATE SPOT
DOG OFF-LEASH
WALKING
INTERACTIVE ART

GATHER

SHOWS & PERFORMANCES
SITTING & LOUNGING
CONVERSATIONS
SOCIAL EVENTS
INTERACTIONS
CASUAL GAMES



PLAZA/SHADE/TREE GROVES
PARK GATEWAY
STAGE / SHADE STRUCTURE
WASHROOMS
SEATING
PICNIC LAWN/PLAY FIELD
PING-PONG
FIRE PIT
ART INSTALLATIONS

NATURE

PROTECTION
WATER MANAGEMENT
BUFFER ZONES
NOISE REDUCTION
EDUCATION & LEARNING
FOOD PRODUCTION



SHADE/TREE GROVES
RAIN GARDEN
COMMUNITY GARDEN
HORTICULTURAL PLANTING
PLANTING BUFFERS

Preliminary Program Fits: Magnet Park

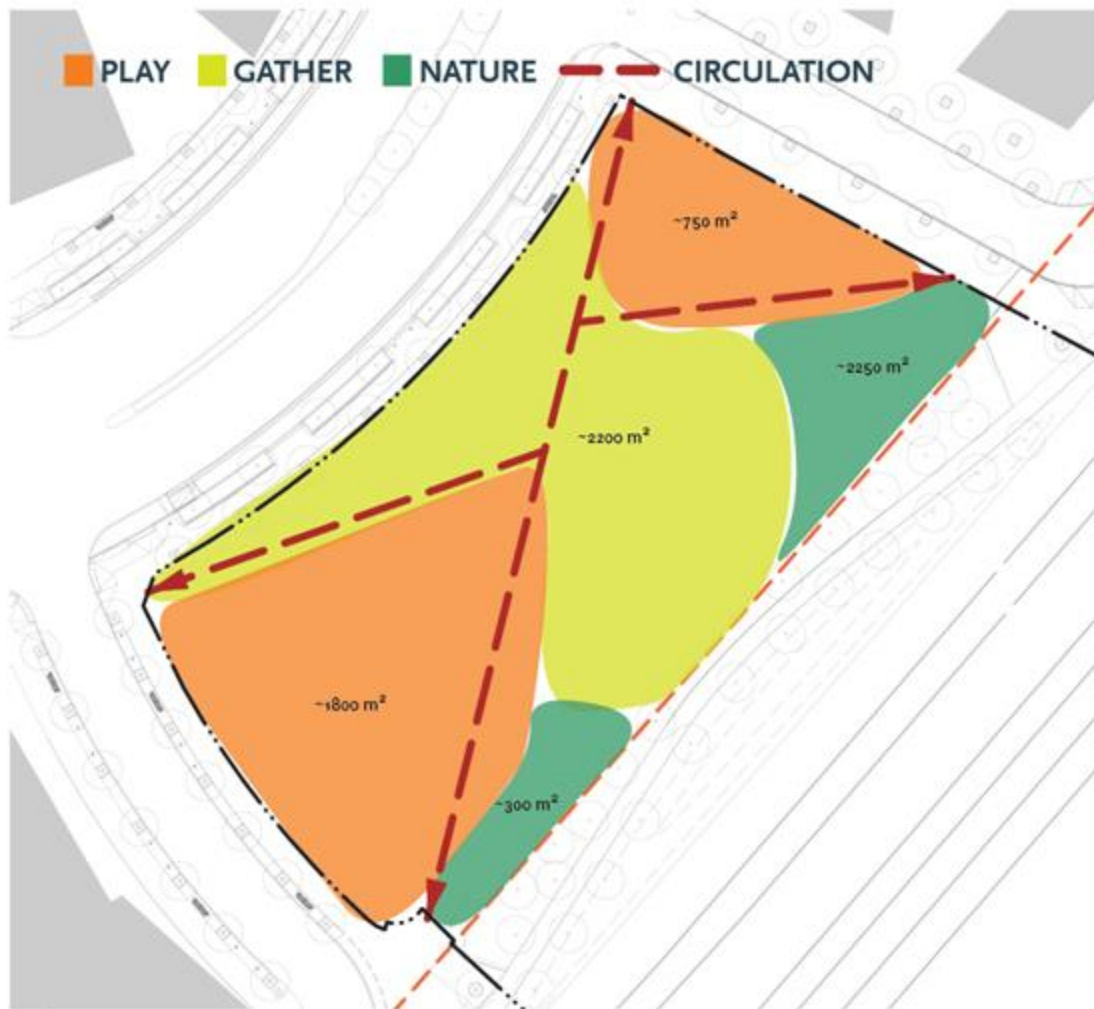

Drawing Scale: 1:1000



Opportunities & Constraints



1 Opportunity – Commemorative historic Dundas St. entrance to the park creates a path connection opportunity.



2 Opportunity – Mature tree is focal point of site. Gentle slopes to the east and west allow for protected activities on both sides.

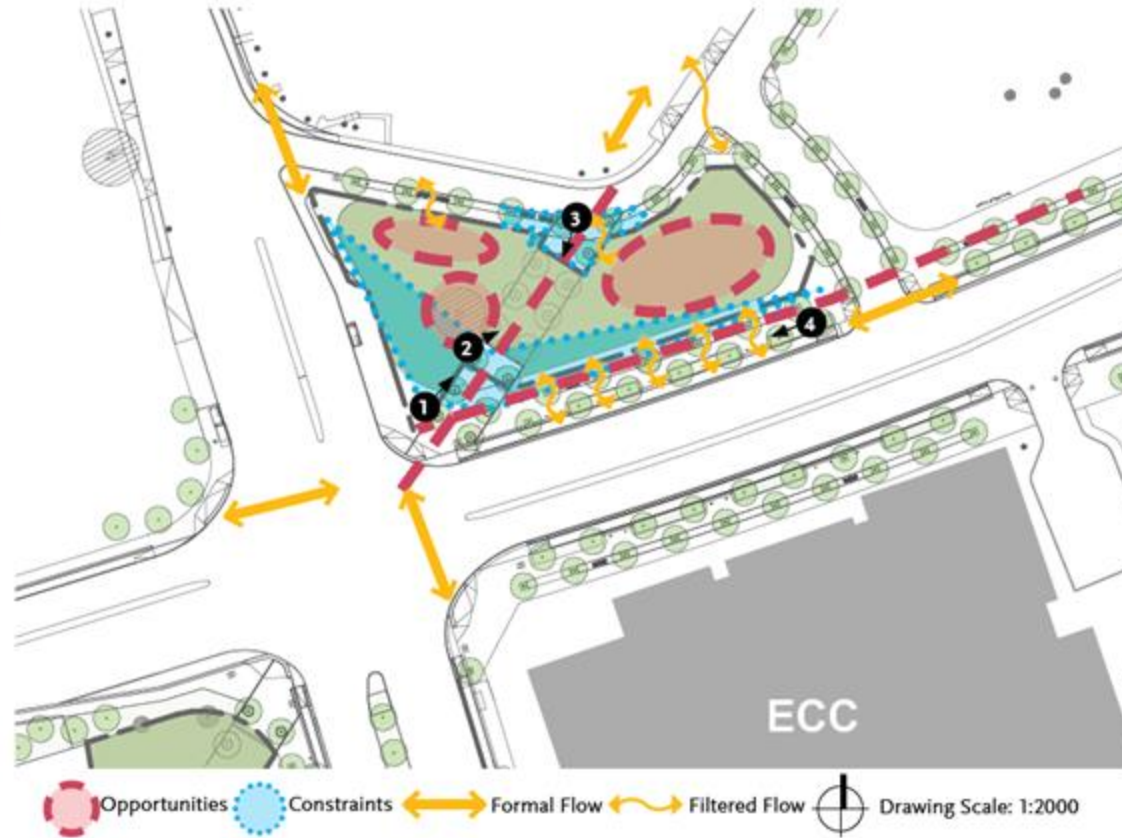

3 Constraint – Exposed park edges need protection from traffic on all sides.



4 Opportunity – Softened urban south edge with streetscape attracts and navigates people to the site from Etobicoke Civic Centre.

Primary Focus: Gateway Park



Drawing Scale: 1:1000

PLAY

ACTIVE PLAY & RECREATION
INTERACTIVE
FITNESS



SKATE SPOT
WALKING
INTERACTIVE ART

GATHER

SITTING & LOUNGING
CONVERSATIONS
INTERACTIONS



PLAZA / TREES
BERMS / MOUNDS / PLANTINGS
HERITAGE INTERPRETATION
SEATING / GATHERING SPACE
SMALL STRUCTURE / SHELTER
PARK GATEWAY
FEATURE BENCH
ART INSTALLATIONS

NATURE

PROTECTION
WATER MANAGEMENT
BUFFER ZONES
NOISE REDUCTION
EDUCATION & LEARNING



PLANTED AREAS
PLANTING BUFFERS
PLANTED BERMS
SHADE/TREE GROVES

Preliminary Program Fits: Gateway Park

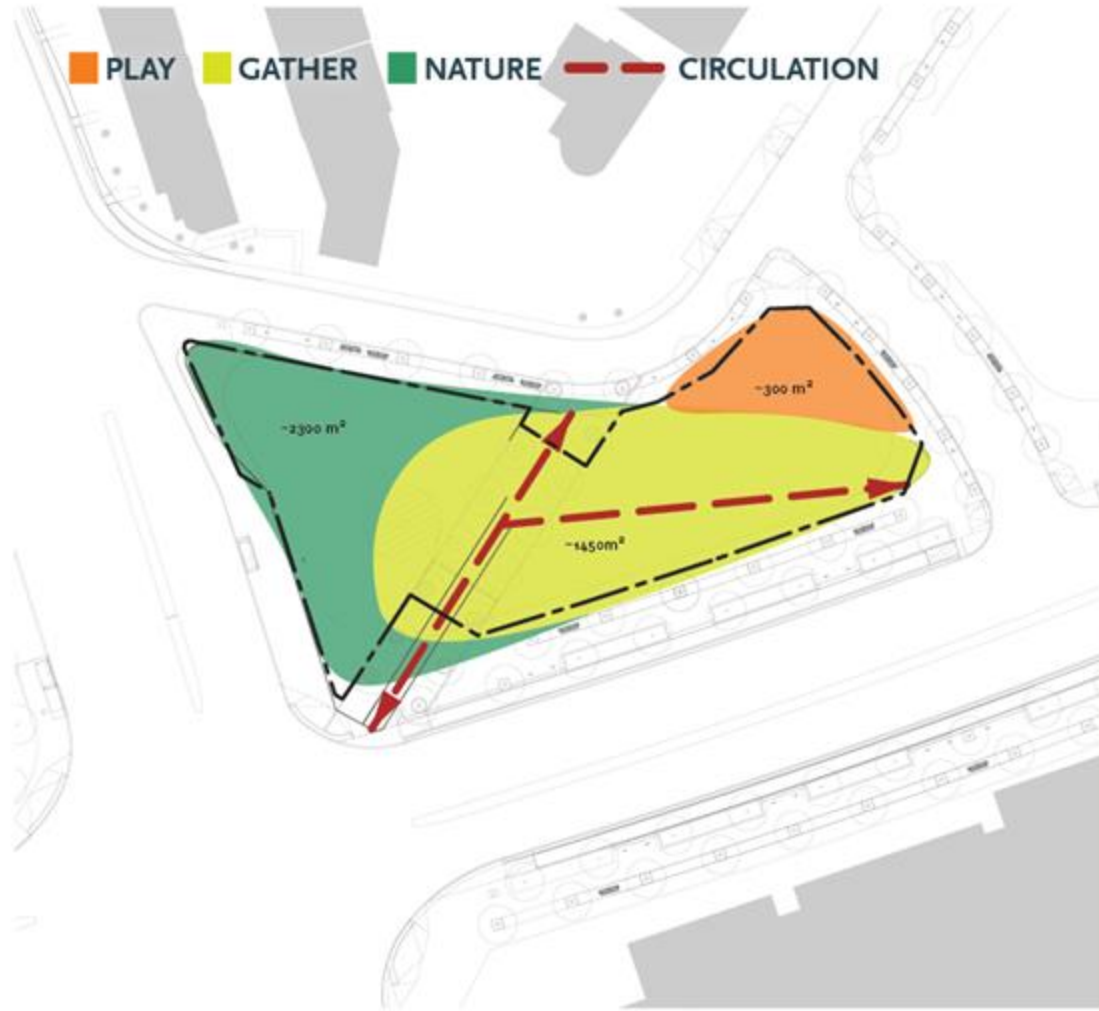

■ PLAY
 ■ GATHER
 ■ NATURE
 - - - CIRCULATION

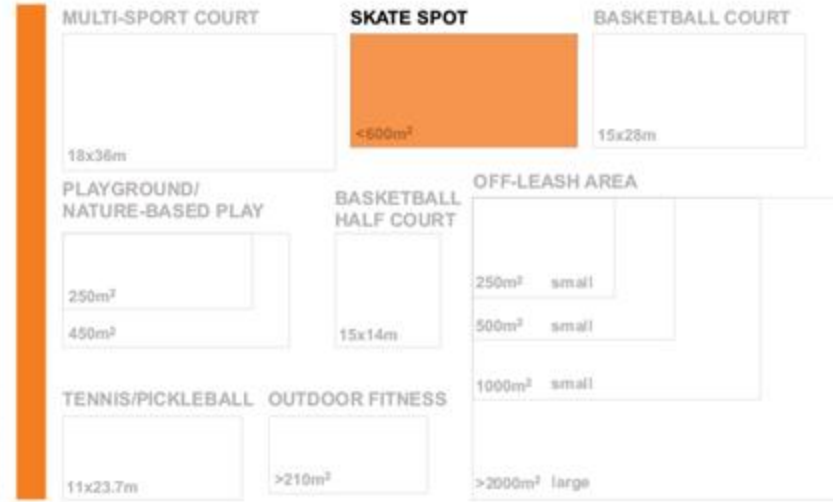

Drawing Scale: 1:1000

Opportunities & Constraints



1 Constraint – Steep slope on south east of site requires retaining wall to accommodate some programs.



2 Opportunity – Commemorative historic Dundas St. path through site with gentle slope is also a desire line.



3 Constraint – Tree planting on the north west portion of site limits park to programs which can be accommodated in a narrow or linear way .

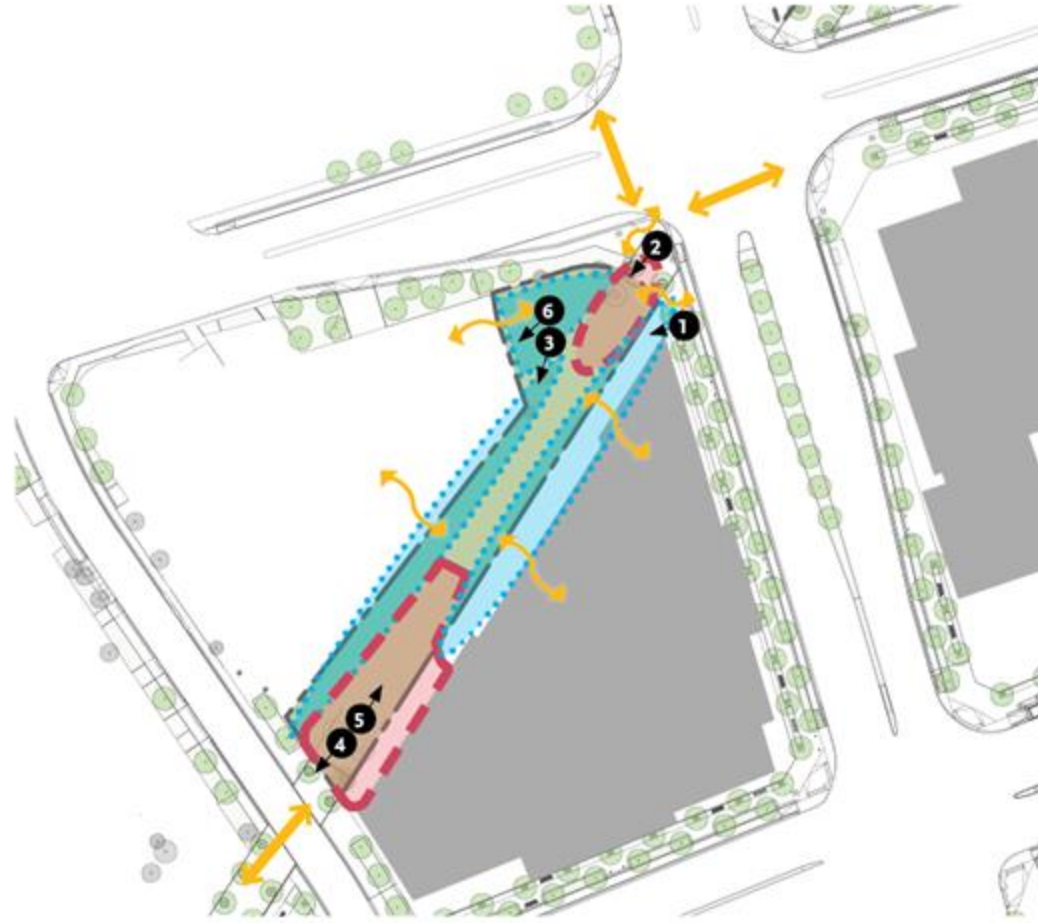

■ Opportunities
 ● Constraints
 → Formal Flow
 ~ Filtered Flow
 Drawing Scale: 1:2000



4 Opportunity – Commemorative historic Dundas St. entrance to the park creates a path connection opportunity.



5 Opportunity – Gentle slope creates opportunity for more active programs along the path on the south-west section of the site



6 Constraint – Adjacency to parking lot with higher noise condition, requires screening / buffering from noise and for pedestrian safety.

Primary Focus: Commemorative Park



Drawing Scale: 1:1000

PLAY

ACTIVE PLAY & RECREATION
INTERACTIVE
FITNESS



OUTDOOR FITNESS
SKATE SPOT
SMALL DOG OFF-LEASH
WALKING & BIKING
INTERACTIVE ART

GATHER

SITTING & LOUNGING
CONVERSATIONS
INTERACTIONS
COMMEMORATION
CASUAL GAMES



TREED PROMENADE
PLAZA / SEATING
SOCIAL / GATHERING SPACES
COMMEMORATIVE FEATURES
HERITAGE INTERPRETATION
CHESS TABLES
PARK GATEWAY
SERIAL ART INSTALLATIONS

NATURE

PROTECTION
WATER MANAGEMENT
BUFFER ZONES
NOISE REDUCTION



HORTICULTURAL PLANTING
PLANTING BUFFERS
PLANTED BERMS
SHADE/TREE GROVES
TREE-LINED PATH

Preliminary Program Fits: Commemorative Park

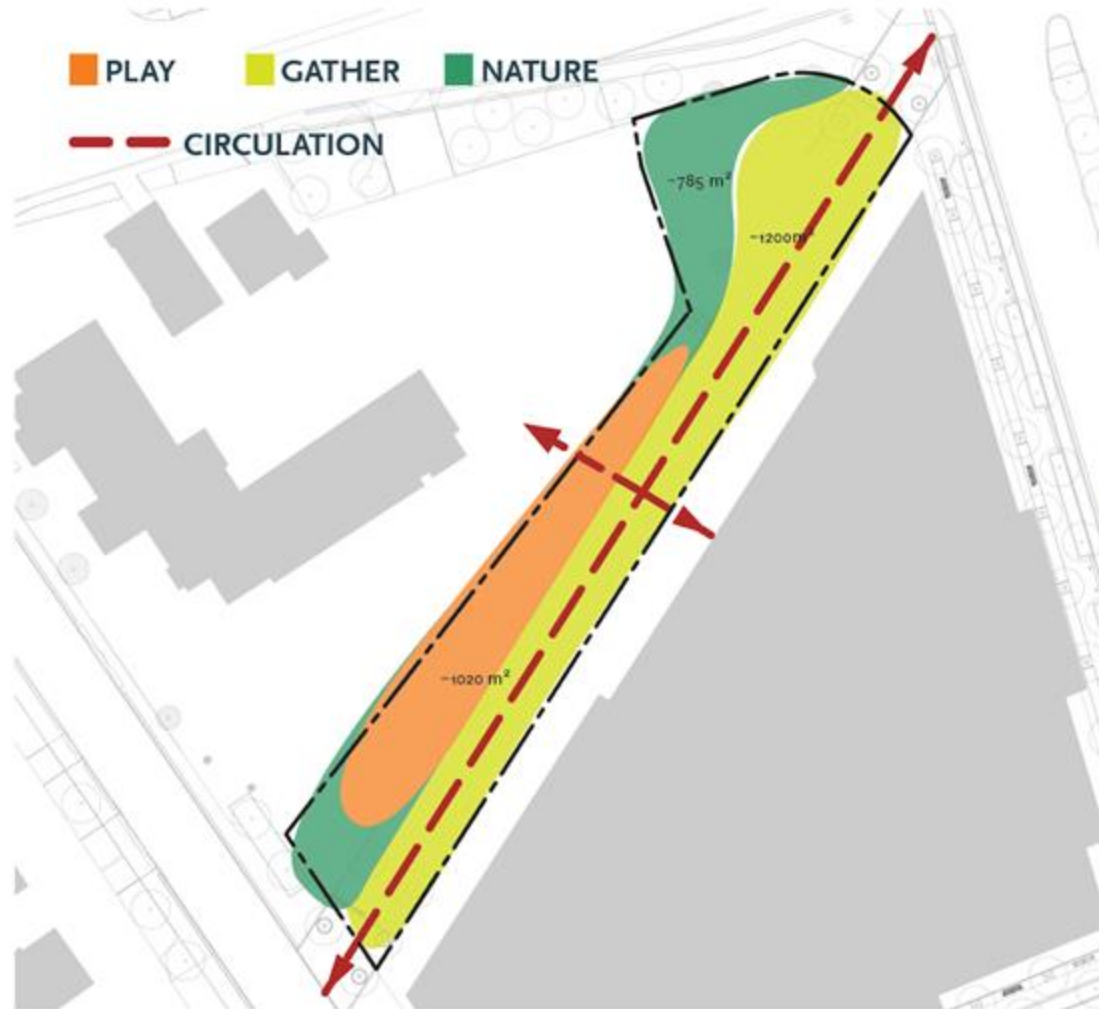

Drawing Scale: 1:1000

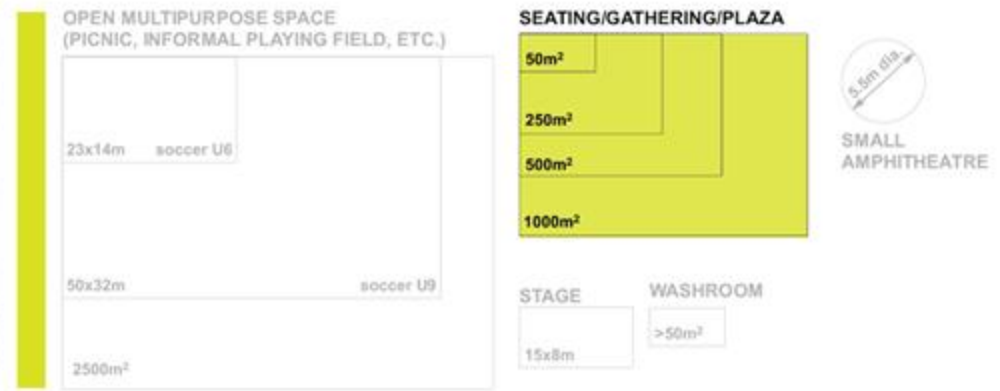
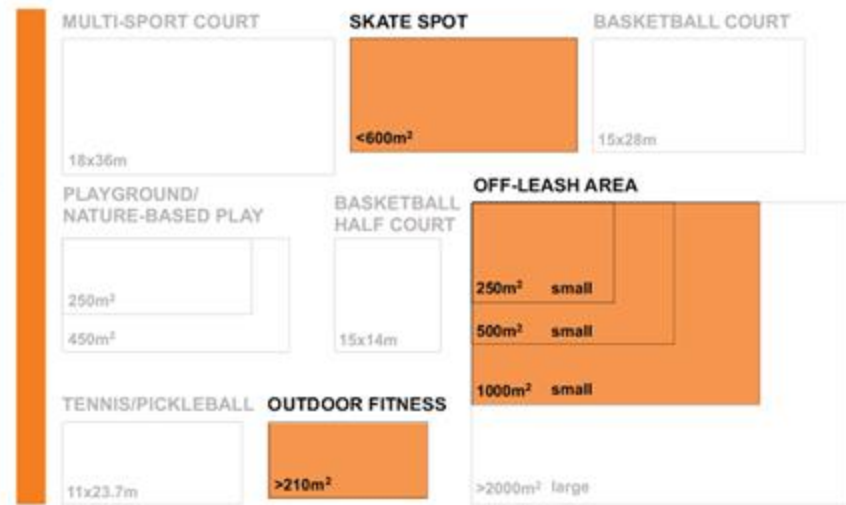

Design Approach: District Plan Additional Diagrams

Spatial Relationship

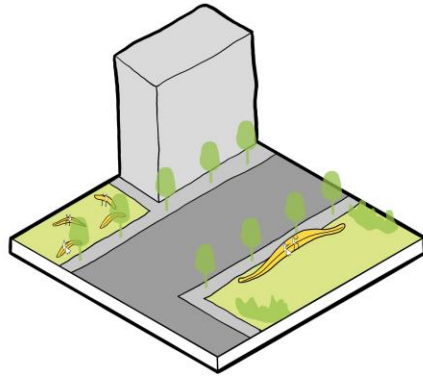

Neighbourhood Linkage

Refers to intentional connections that are created across the park district. These connections can be physical spaces, visual sightlines, and/or functional transitions that enhance usability and coherence.

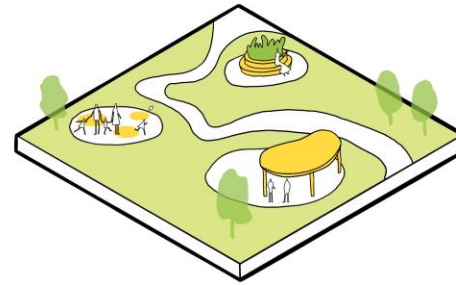

Park Interior Linkage

Refers to the arrangement of areas that allow navigation through an engaging experience involving carefully planned transitions, focal points, functional zones, and sensory elements to create an experience moving through the park.

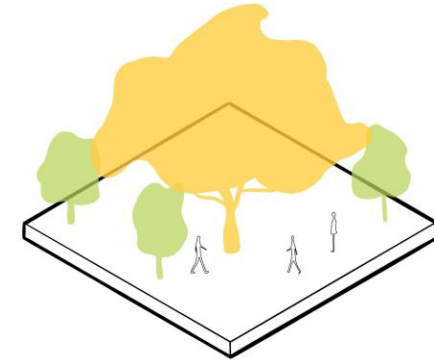



Park Focal Points

Refers to easily visible and contrasting features that stand out within the park, capturing attention and serving as a visual center of interest.

Spatial Relationship

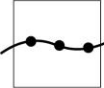

-  Neighbourhood Linkages
-  Park Interior Linkages
-  Focal Points Within the Park