

New Parks at 10 Ordinance St. & 801 Wellington St. W.

Community Advisory Committee Meeting #4

February 22, 2024
6:00pm-8:00pm



We would like to begin by honouring the land that we are on. We acknowledge the land we are meeting on is the traditional territory of many nations including the Mississaugas of the Credit, the Anishnabeg, the Chippewa, the Haudenosaunee and the Wendat peoples and is now home to many diverse First Nations, Inuit and Métis peoples. We also acknowledge that Toronto is covered by Treaty 13 with the Mississaugas of the Credit.

Agenda

6:00 pm	Welcome
6:10 pm	Project Updates
6:20 pm	Questions of Clarification
6:25 pm	Refined Vision and Design Principles
6:35 pm	Preferred Design Concept
7:00 pm	Discussion
7:45 pm	Next Steps and Wrap Up
8:00 pm	Adjourn

The purpose of this meeting is to:

- Review what we've heard and how its impacted design direction.
- Present the preferred concept for Ordnance and Wellington Parks.
- Discuss and gather feedback about the preferred concept in advance of the upcoming Public Open House.

Project Timeline and Engagement Process

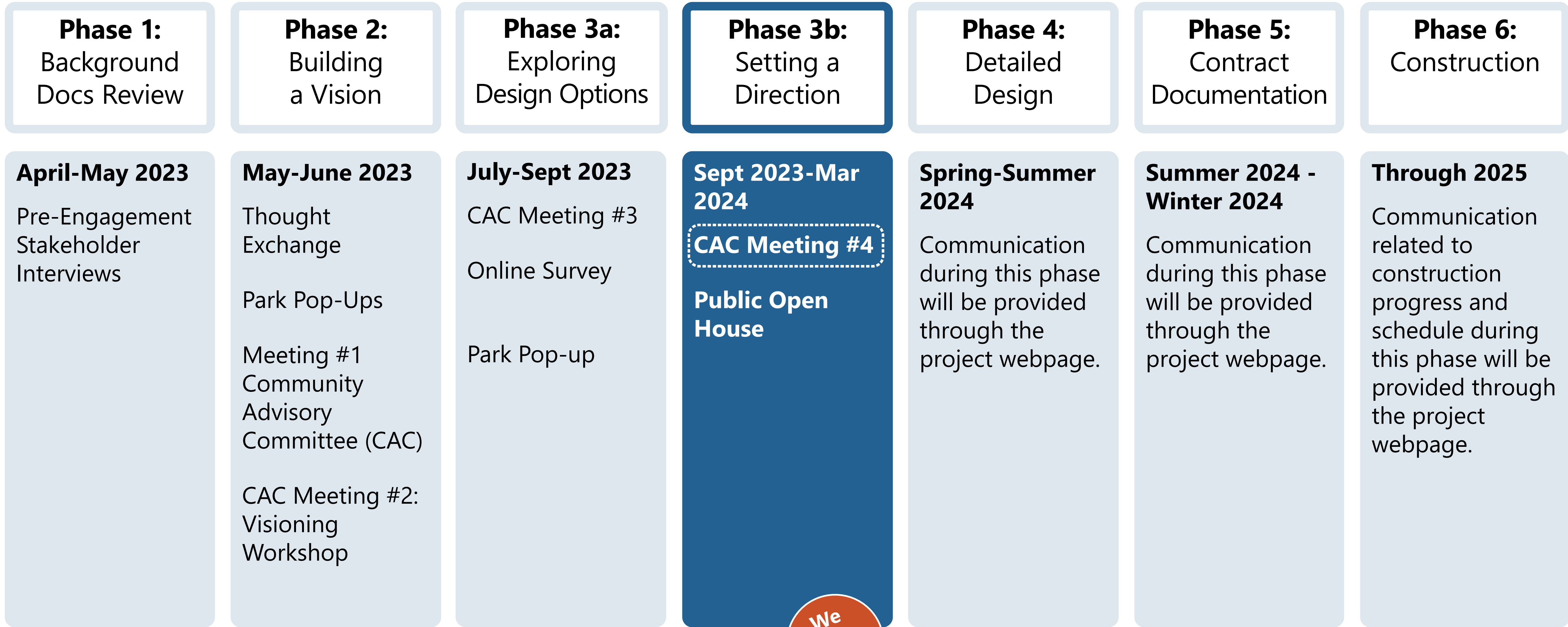

We are here

What has happened since the last time we met:

- Indigenous Engagement Process
- Site survey & Coordination with Metrolinx
- Public Art Coordination
- Feasibility Studies (Community Garden & Washroom Pavillion)
- **Questions of Clarification?**

Public Art Concept

Selected Artists: Steele & Tomczak

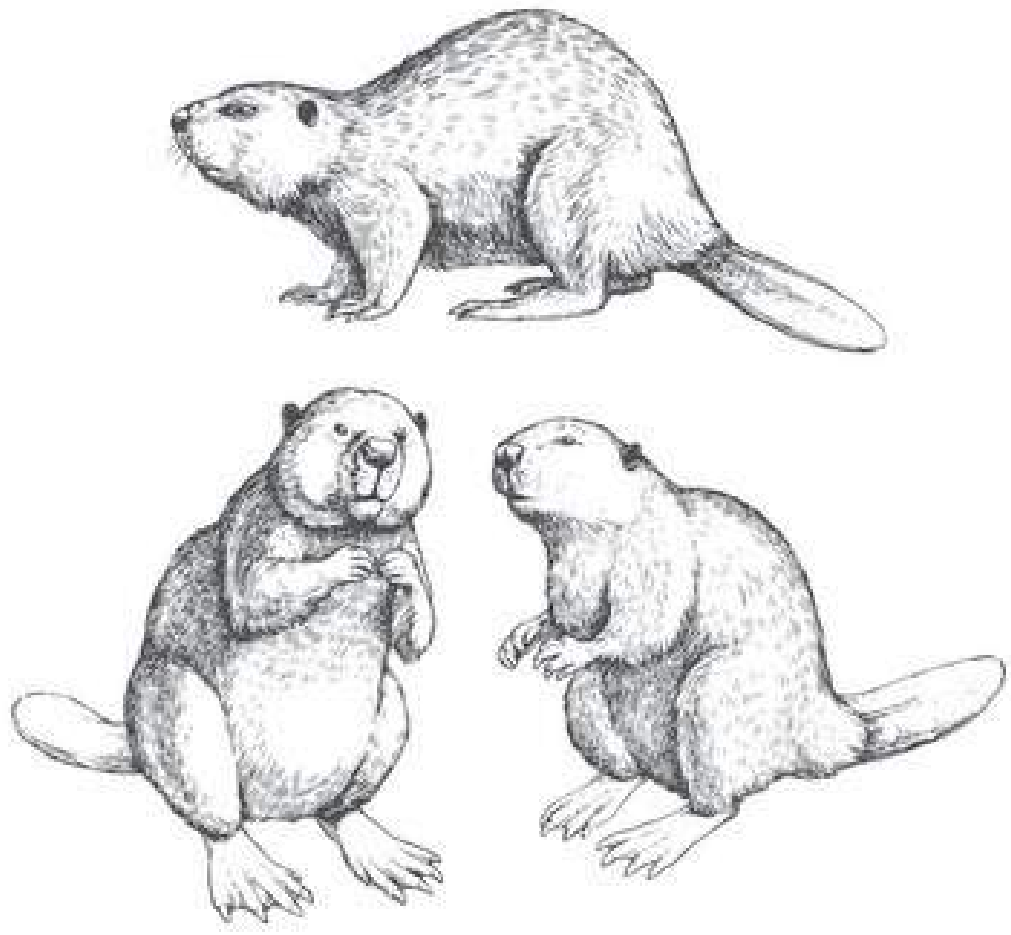

Feasibility Study: Potential Washroom Pavillion

We explored options for locating a 4 seasons washroom on site, and concluded that the washroom is best located along Wellington, which has good visibility from the street, and can be used by people in South Stanley park as well.



Potential Washroom Pavillion Location

Feasibility Study: Potential Future Community Garden

We explored locations for a potential future relocated Garrison Flats Community Garden. If the garden is required to be moved, there is room for it in this location.

PFR can provide servicing to this site and grade it to be suitable for a garden in the future. All further discussion about moving the garden will be between the Housing Secretariat and the Garrison Flats Community Garden group.



Potential Future Community Garden Space

Refined Vision & Design Principles

What We've Heard

Phase 3a: Online Survey

We heard from **802** respondents on their thoughts and concerns to inform the park's vision statement and design.

78% of respondents liked the vision statement. The following are comments and concerns sorted by theme:

- **Ecological Design** – promote ecological restoration, biodiversity, safe space for urban wildlife, and green spaces.
- **Amenities** – prioritize diversity, inclusivity, accessibility, functionality, relaxation, and sociability within the park.
- **Connections** – emphasize the importance of wayfinding using accessible signage and connectivity with other parks.
- **Dynamic & Playful** – attach meaningfulness and realism to this vision by prioritizing functionality and relaxation.
- **Dogs** – ensure safety, maintenance, order, and cleanliness by enforcing animal by-laws.
- **Wording** – use more contextual, realistic, and specific language to achieve relatability.

Additional thoughts include participant suggestions such as incorporating a multicultural and unique park identity, preserving views, emphasizing natural landscaping, and promoting a healthy urban ecology close connections with nature.

What We've Heard

Phase 3a: Community Pop-Ups

We heard from **255** community members to gather feedback on the draft vision and design concepts (“big moves”).

Participants expressed a desire for:

- **A clean and simple design.**
- **An abundance of green and natural elements** – e.g., colorful vegetation, meadows, and wildlife habitat.
- Inclusivity to a diverse range of visitors and residents to the area – including children.
- **The protection of views.**
- **Accessible and diverse seating options and paths with shade protection from weather conditions** – e.g., picnic table and amphitheater-style seating.
- **A flexible design that supports sociability and community gathering creatively** – e.g., community garden and public art displays.

Phase 3a: CAC Meeting 3

CAC members (individuals and organizational members of the community) provided feedback about the community's priorities.

Many resonated with the draft vision statement and the draft design principles.

Feedback regarding the draft vision statement and design principles included:

- **Simplify and shorten** the overall design, as well as the vision statement and principles.
- **Utilize visualizations** such as images and diagrams to resonate with the community.
- **Ensure a more balanced mix of hard and soft scaping elements** – particularly to include greenery and less pathways.
- **Include a cohesive mix between both active spaces as well as pockets of secluded quiet areas.**
- **Increase the diversity of vegetation and tree species.**
- **Incorporate a children's play area and a water feature.**
- **Cater more toward the local community** as opposed to visitors and tourists.
- **Emphasize multiple forms of street furniture** such as lighting, signage, flexible seating, and drinking fountains.

Vision Statement

Ordnance and Wellington parks will provide a unique urban oasis with spectacular views of the City skyline, and new enhanced connections to the adjacent community and broader open space network.

Together the parks will provide a balance between green, ecological design; restful open spaces; and the creation of a dynamic, playful public realm.

Design Principles

The design of the parks will:



1. Establish a **Distinct Identity** for the Parks



2. Protect and Enhance **Key Views**



3. Strengthen Site **Topography and Landform**

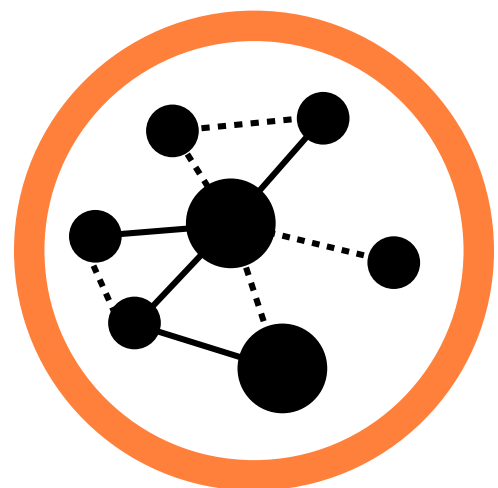

4. Improve **Connections** in the Parks and to the Community



5. Enhance **Site Ecology**



6. Create **Safe and Inclusive** Parks for All Ages and All Abilities



7. Contribute to Public Health through **Sustainable and Resilient** Design



8. Reflect the **Natural and Cultural Heritage** of the Site

Preferred Design Concept

Preferred Concept

The preferred concept for the new parks at Ordnance and Wellington includes sculpted landform features to create distinct outdoor spaces, creating balance between active and passive experiences and emphasizing the unique expansive views toward the City skyline.

The open lawns, naturalized meadows, and shrub/perennial plantings provide a range of landscape types and habitats for urban wildlife. Native canopy trees are planted in arrangements that frame views, and provide shade and seasonal colour and texture.

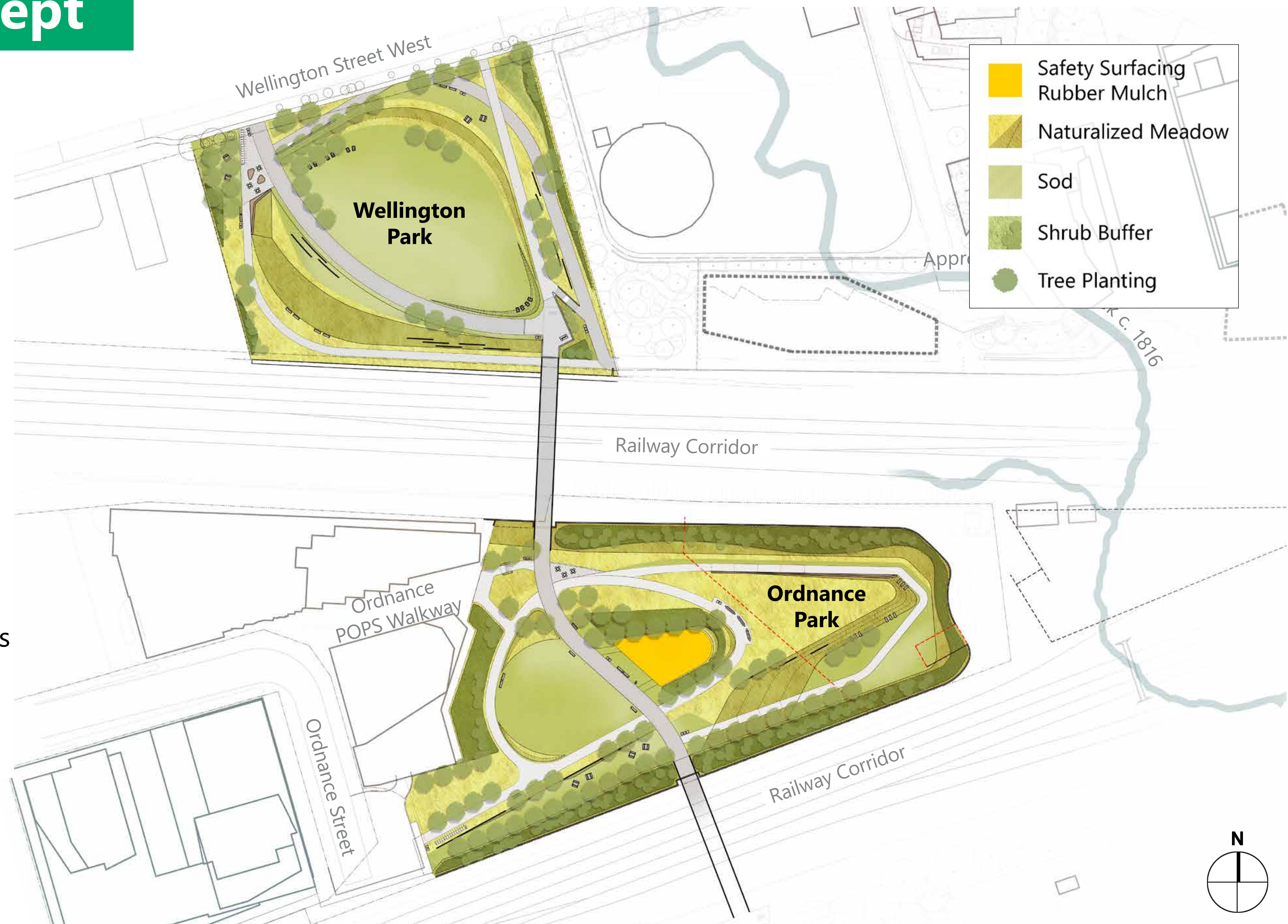

Preferred Concept

Wellington Park

Through careful manipulation of topography, the preferred concept for Wellington Park, improves overall circulation within the park and to adjacent public spaces, providing new flexible programmable space while preserving existing uses.

The park features an upper plateau with an open lawn, framed by a curving berm. The topography of the plateau and berm also define the lower park, which features a linear rain garden and native pollinator meadows, spaces for more intimate and reflective experiences.



Cross-section A-A' through Wellington Park

Preferred Concept

Wellington Park - Circulation Hierarchy

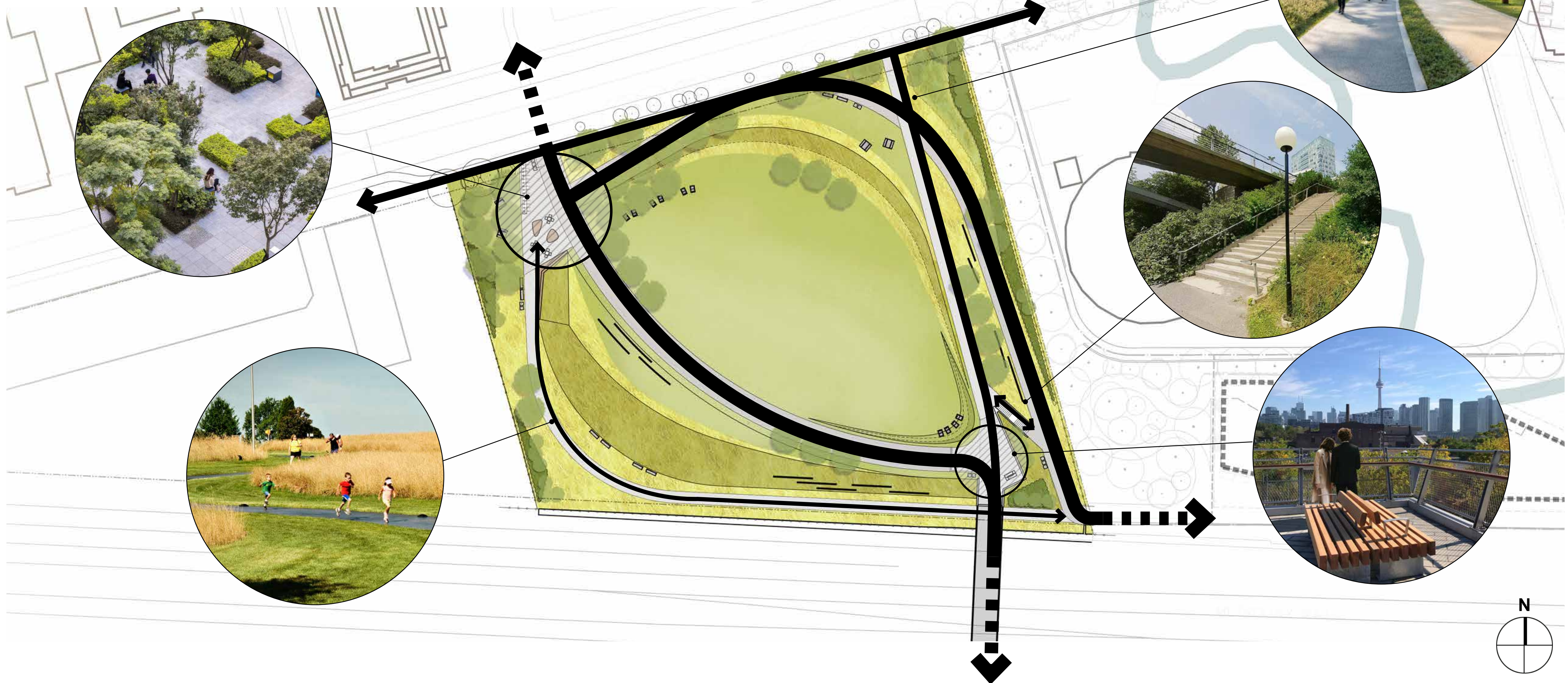

Preferred Concept

Wellington Park - Upper Plateau

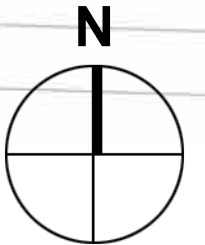

Preferred Concept

Wellington Park - Lower Meadow

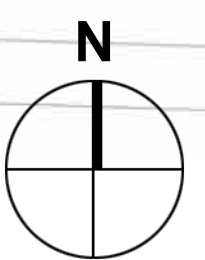

Preferred Concept

Wellington Park- Slopes

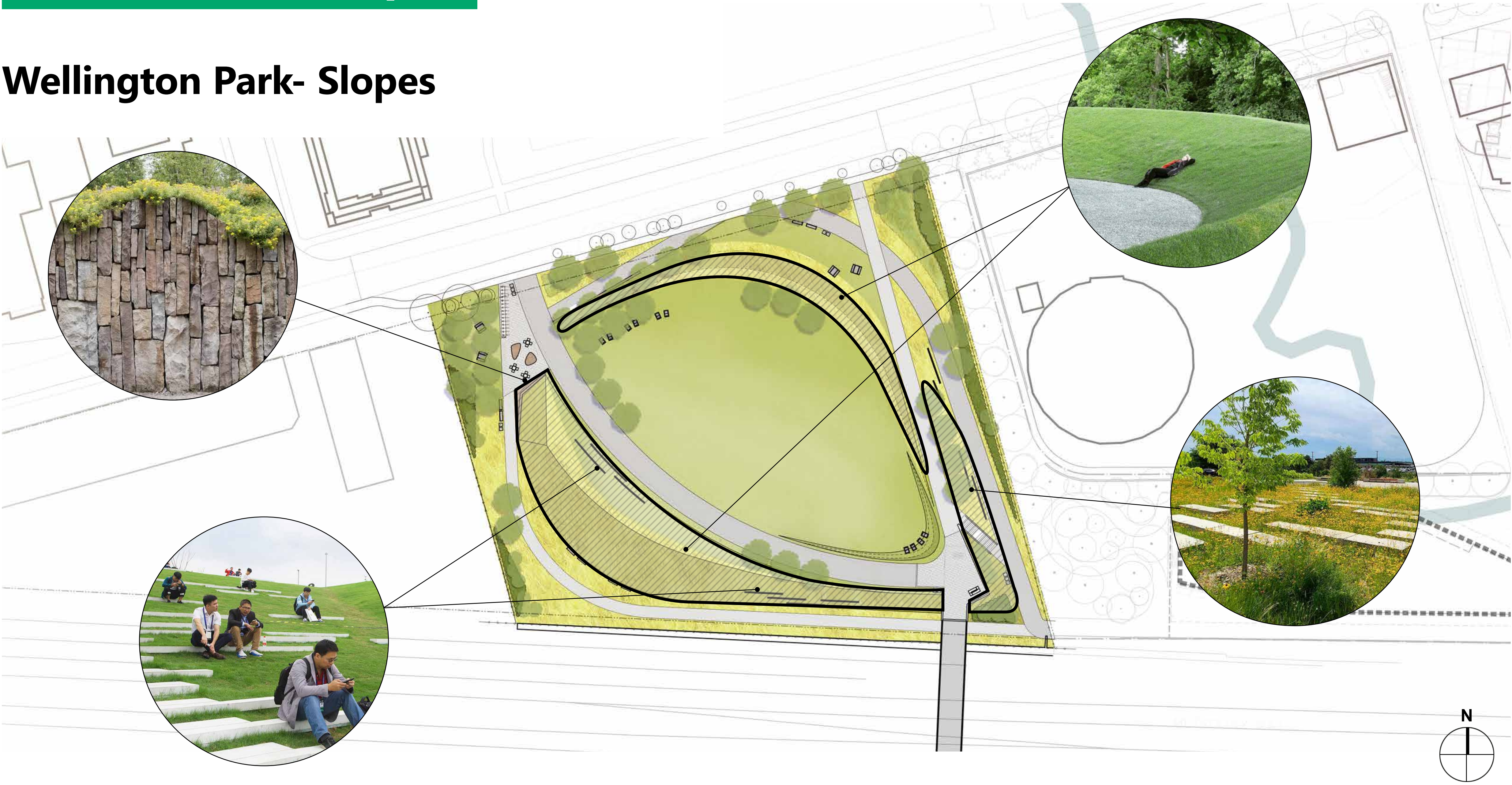

Preferred Concept

Wellington Park - Looking South from Wellington Street



Preferred Concept

Wellington Park - Looking North toward Wellington Street



Preferred Concept

Ordnance Park

The preferred concept for Ordnance Park, builds on the existing topography of the site, creating a peninsula that rises over the rail corridor to provide unique views to the City skyline.

The upper plateau features a flexible open lawn and a children's play area, framed by gentle berms and large-scale swings looking out over an upland meadow. The upper plateau slopes down to the lower plateau to provide an intimate experience at the eastern tip of the peninsula, allowing visitors to overlook the railways and planted slopes of the park.



Cross-section B-B' through Ordnance Park

Preferred Concept

Ordnance Park - - Circulation Hierarchy

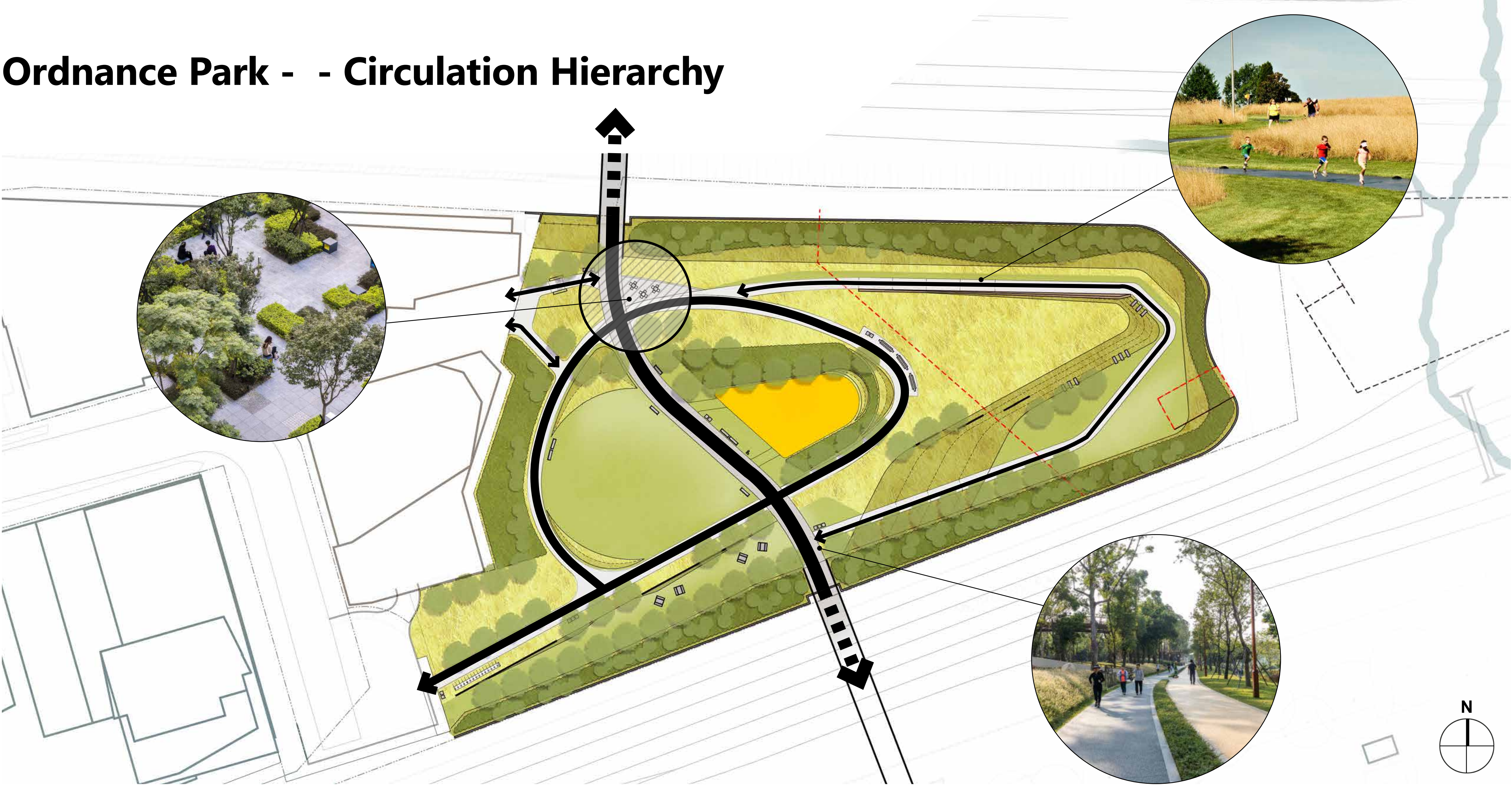

Preferred Concept

Ordnance Park - Upper Plateau

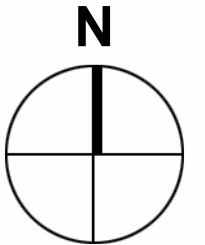
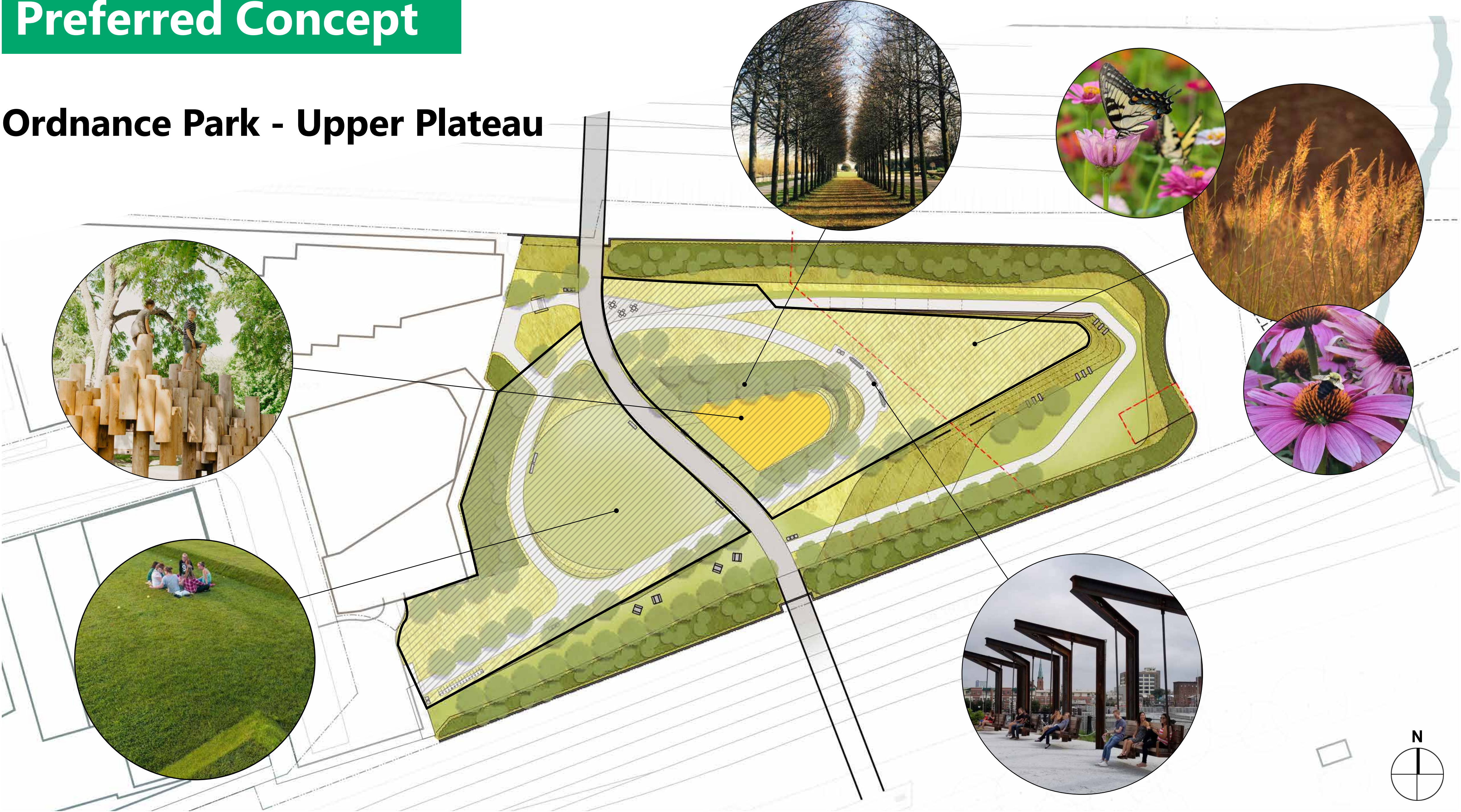

Preferred Concept

Ordnance Park - Lower Plateau

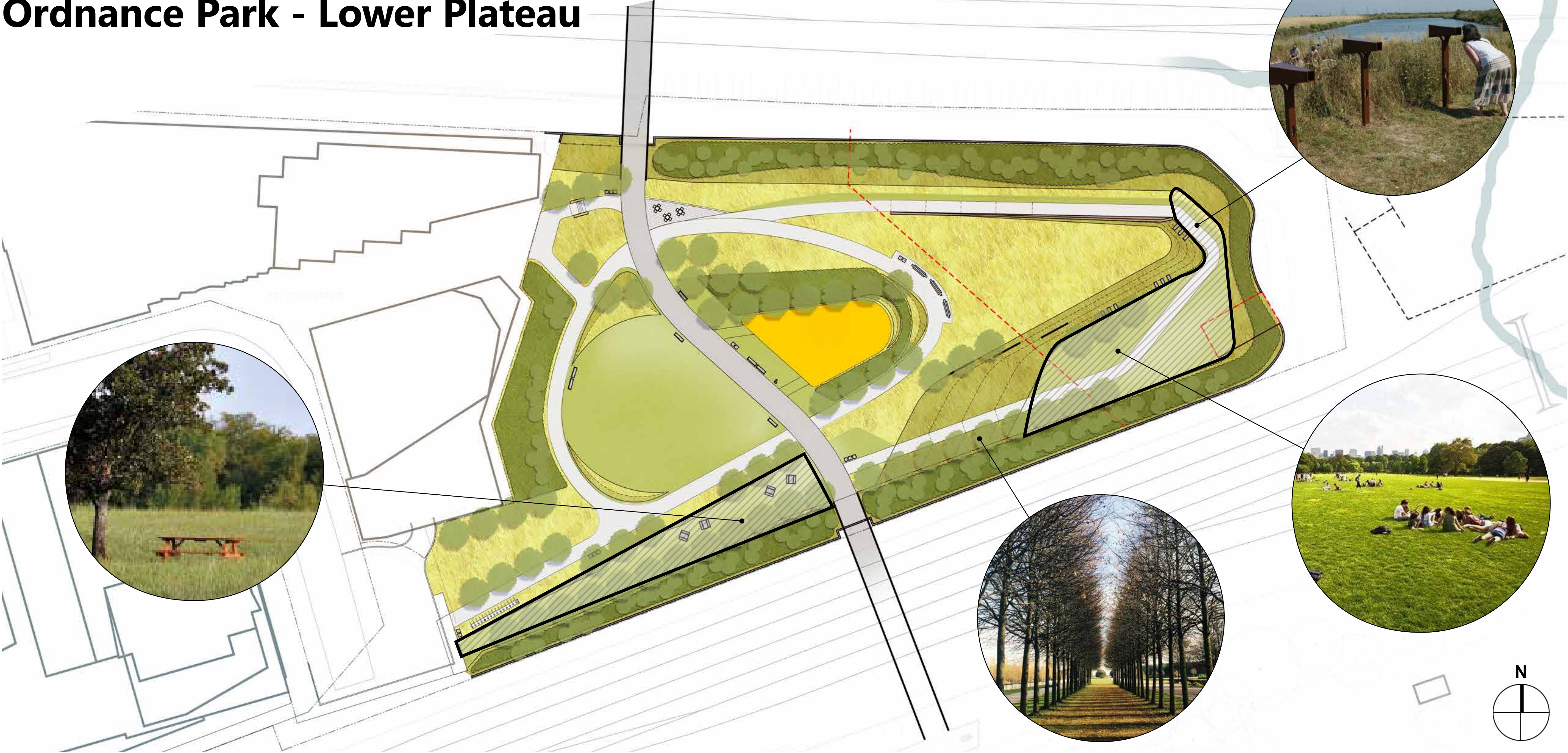

Preferred Concept

Ordnance Park - Slopes

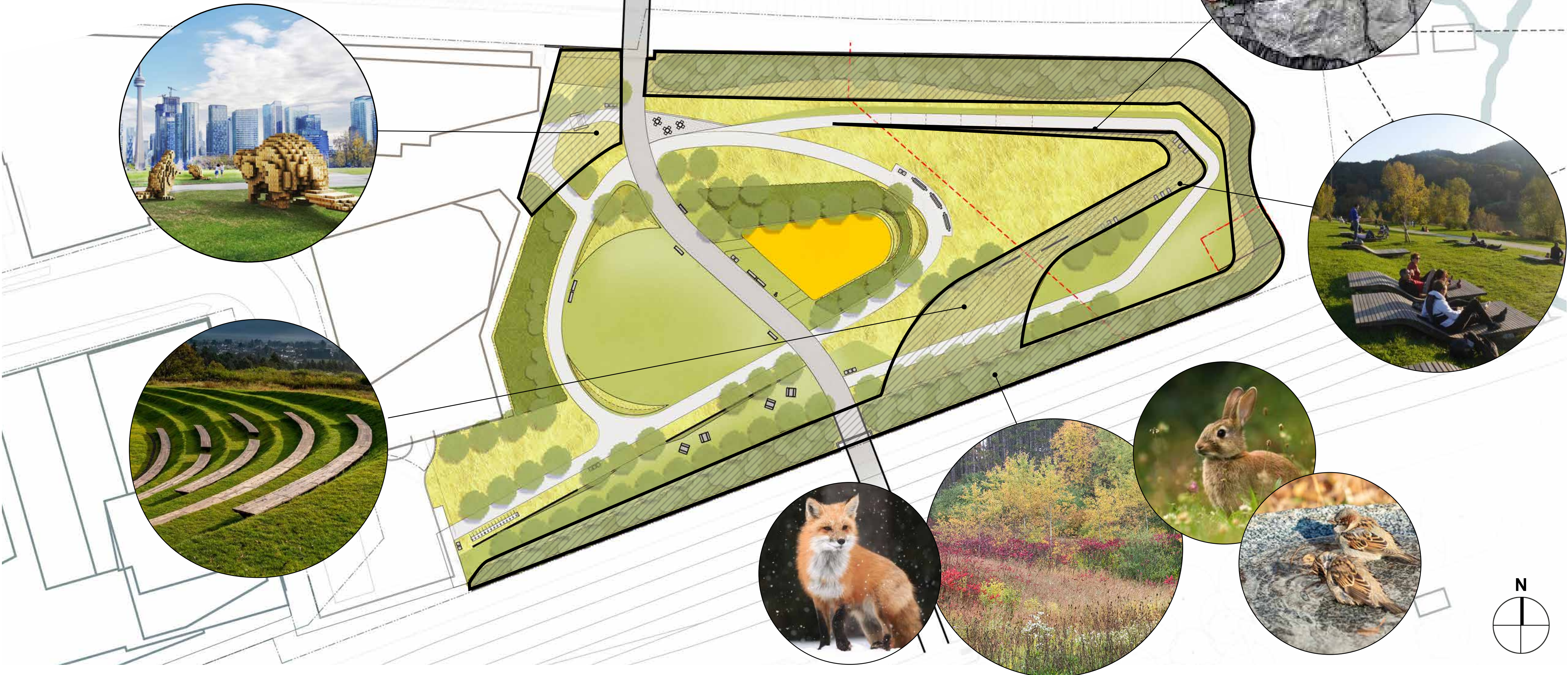

Preferred Concept

Ordnance Park - Looking West toward Strachan Avenue



Preferred Concept

Ordnance Park - Looking East toward Downtown Toronto



Preferred Concept

Ordnance Park - Looking East from Ordnance Street POPS



Preferred Concept

Ordnance Park - Looking East toward Downtown Toronto



Questions and Discussion

What's Next?

The next steps in the project:

- The Design team will make refinements to the preferred concept based on CAC and IAC feedback.
- **A Public Open House will be held on March 27, 2024**, along with an **online survey**, to gather feedback from the public on the preferred concept.
- Detailed design and technical review by City will be ongoing through 2024.
- The Design Team will continue to coordinate with Metrolinx and other adjacent development projects.
- **Start of Construction targeted for early 2025!**
- Watch for continued project updates on the City website.



Thank you!