

WARD 9 - DAVENPORT

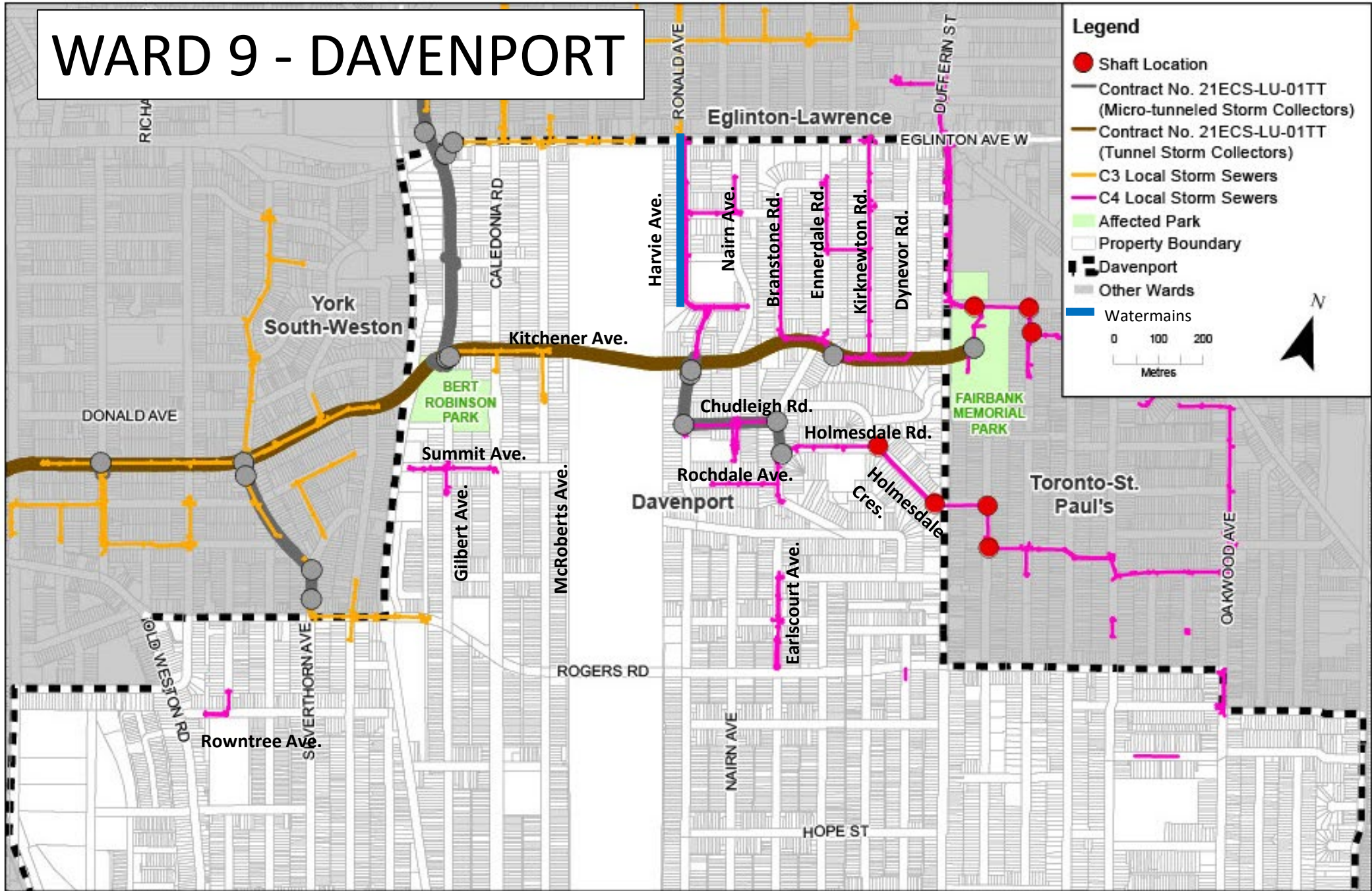

Ward Specific Information for Ward 9

Contracts 3 and 4:

- Total 16 km length of new storm sewers and 9km length of various other drainage pipes and watermains.
- 8.7km length of new sewers in Ward 9
- 0.7 km length of bundled watermain replacement in Ward 9
- Project will provide flooding protection to about **2,000 homes** in Ward 9

Sewer Size	Approximate Length
300-525mm	3,350.0 m
600-900mm	850.0 m
975-1350mm	780.0 m
1500+mm	580.0 m
Catch basin and misc. piping	1,150.0 m
Contract 2 sewers (Completed)	1,990.0 m

Parking Impacts for Ward 9

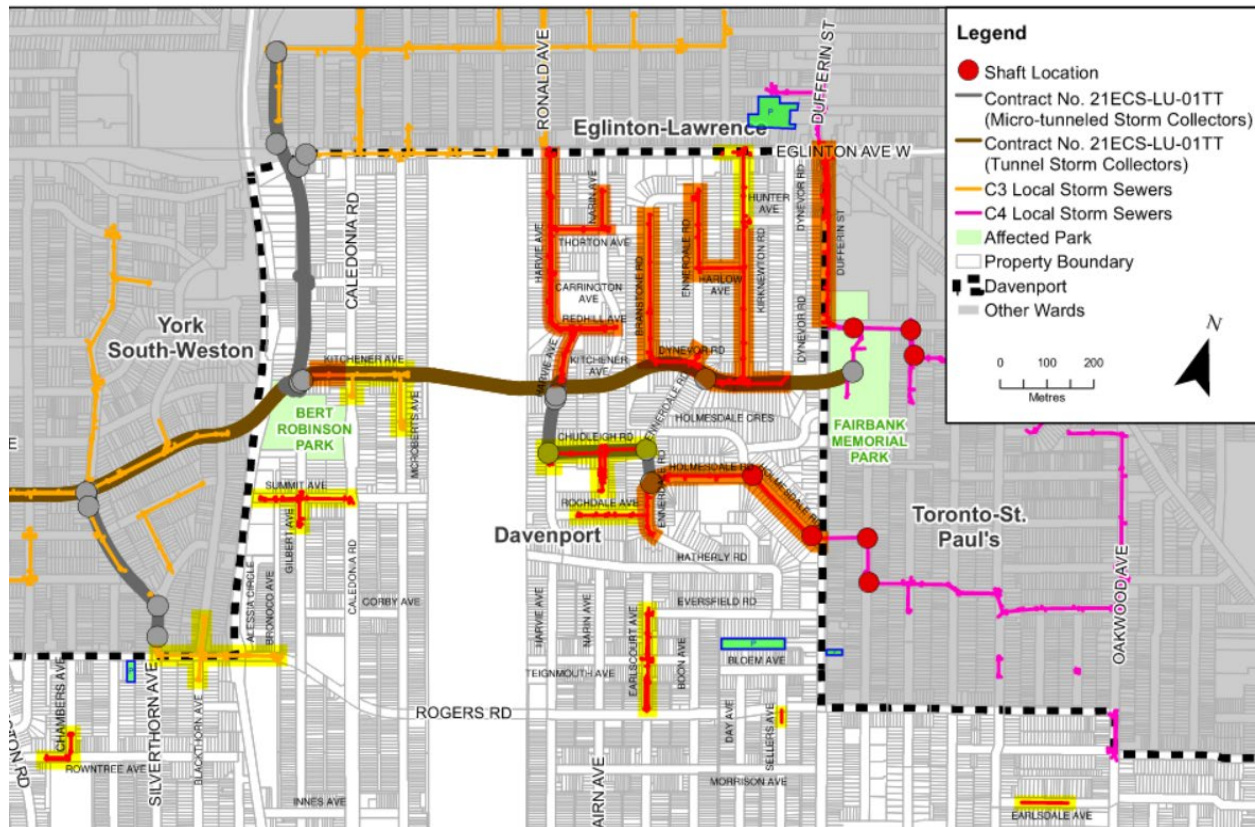

- Due to construction, driveways will be blocked for an extended period, displacing cars from their homes
- The analysis included the reviewing of permit parking available in the area to classify the various construction areas as shown below:

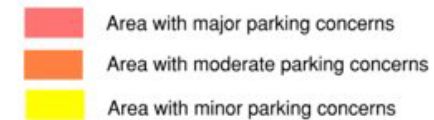

- For the areas with major parking concerns, additional parking lots where residents would be compensated for parking fees:
- Temporary parking permits will be provided where applicable
- Parking tickets assistance will be provided as necessary. Impacted resident's tickets will be submitted for cancellation.

Ward 9 Right-of-Way Impacts

- Proposed works are located on the City's ROW, however, residents' functioning front yards/driveways may encroach onto the ROW
- Front yards will be fully restored after the work
- On-street parking permits will be provided to owners whose driveways are impacted or obstructed
- Encroachments will not remain in place for full duration of construction.
- Additional information will be provided through Property Impact Notices and Construction Notices as work takes place.

Street	Driveway Only	Yard Only	Driveway and Yard
Blackthorn Avenue		1	
McRoberts Avenue	1	1	
Harvie Avenue		11	1
Redhill Avenue		1	
Thornton Avenue		1	
Branstone Avenue		14	
Dynevour Road	1	2	5
Kirknewton Road		1	1
Eglinton Avenue West	1		
Ennerdale Road		3	5
Dufferin Street	3	2	
Harvie Avenue			4
Chudleigh Road		2	3
Nairn Avenue		4	2
Holmesdale Road	1	2	34

Dufferin St/Holmesdale Rd MTS-16

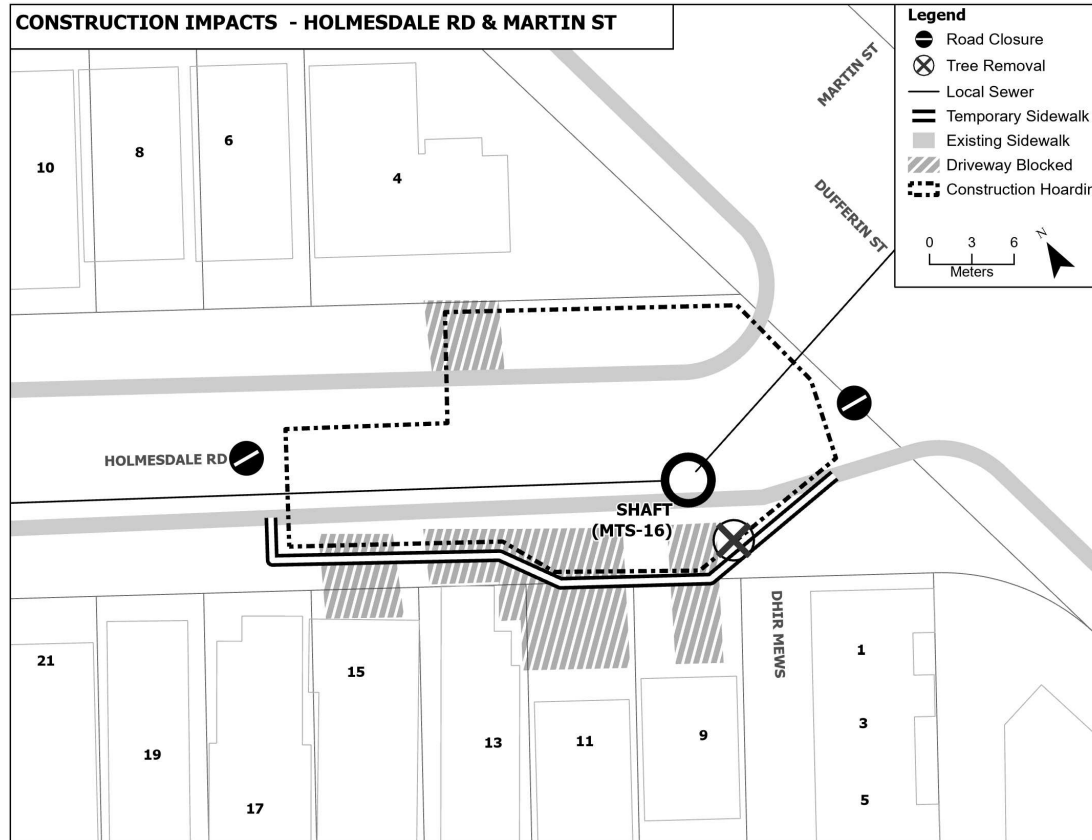

Estimated Construction Duration: 8 months

- Shaft MTS-16 at Holmesdale Road/Dufferin Street
- Trenchless local storm sewer construction at the intersection of Holmesdale Road/Dufferin Street

Resident Impacts:

Traffic:

- Holmesdale Crescent from #4 to #15 and Holmesdale Road will be closed due to the MTS-16 shaft compound.

Access:

- Restricted driveway access for #4, 9, 11, 13, 15 Holmesdale Road
- Access to Dhir Mews will be maintained via temporary works

Parking:

- Additional on-street parking will be managed through Permit Parking

Trees:

- Tree removals at #9 Holmesdale Road

Holmesdale Cres/Holmesdale Rd MTS-24

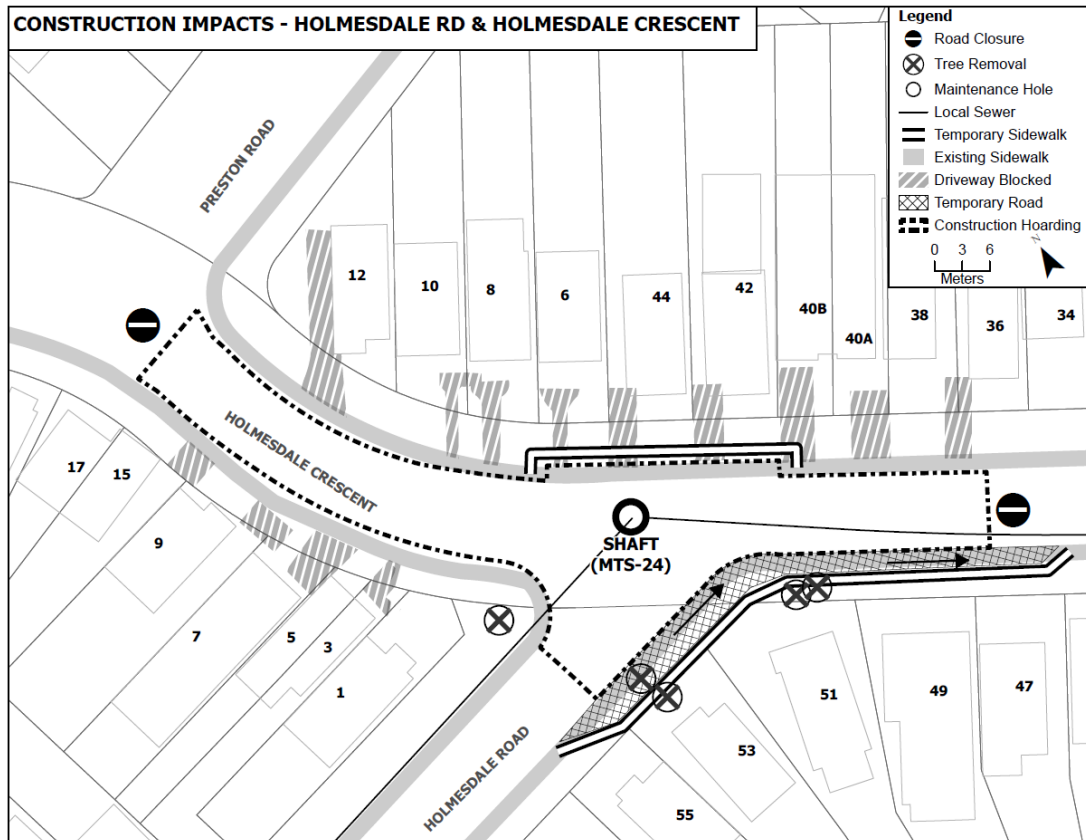

Estimated Construction Duration: 8 months

- Shaft MTS-24 at the intersection of Holmesdale Road/Holmesdale Crescent
- Trenchless local storm sewer construction at the intersection of Holmesdale Road/Holmesdale Crescent

Resident Impacts:

Traffic:

- Holmesdale Crescent from #1 to #15 and Holmesdale Road from #36 to #44 will be closed due to the MTS-24 shaft compound.

Access:

- Restricted driveway access for #38 to #44 Holmesdale Road and #3 to #15 Holmesdale Crescent

Parking:

- Additional on-street parking will be managed through Permit Parking

Trees:

- Tree removals at #51, 53 Holmesdale Road and #1 Holmesdale Crescent