

Appendix A

**Stage 1 Archaeological Assessment Report
(Part 2 of 4)**

7.0 MAPS



 STUDY AREA

Service Layer Credits: Projection: NAD 1983 UTM Zone 17N
World Imagery: Source: Esri, DigitalGlobe, GeoEye, Earthstar Geographics, CNES/Airbus DS, USDA, USGS, AeroGRID, IGN, and the GIS User Community
Scale: 1:25,000
Page Size: 11 x 17

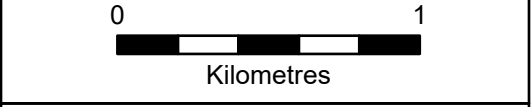

ASI PROJECT NO.: 19EA_216
DATE: 2020-05-21
DRAWN BY: ESB
FILE: 19EA_216_fig_1

 Providing Archaeological & Cultural Heritage Services
528 Bathurst Street Toronto, ONTARIO M5S 2P9
T 416-966-1069 F 416-966-9723 asiheritage.ca

Figure 1: Yellow Creek Study Area

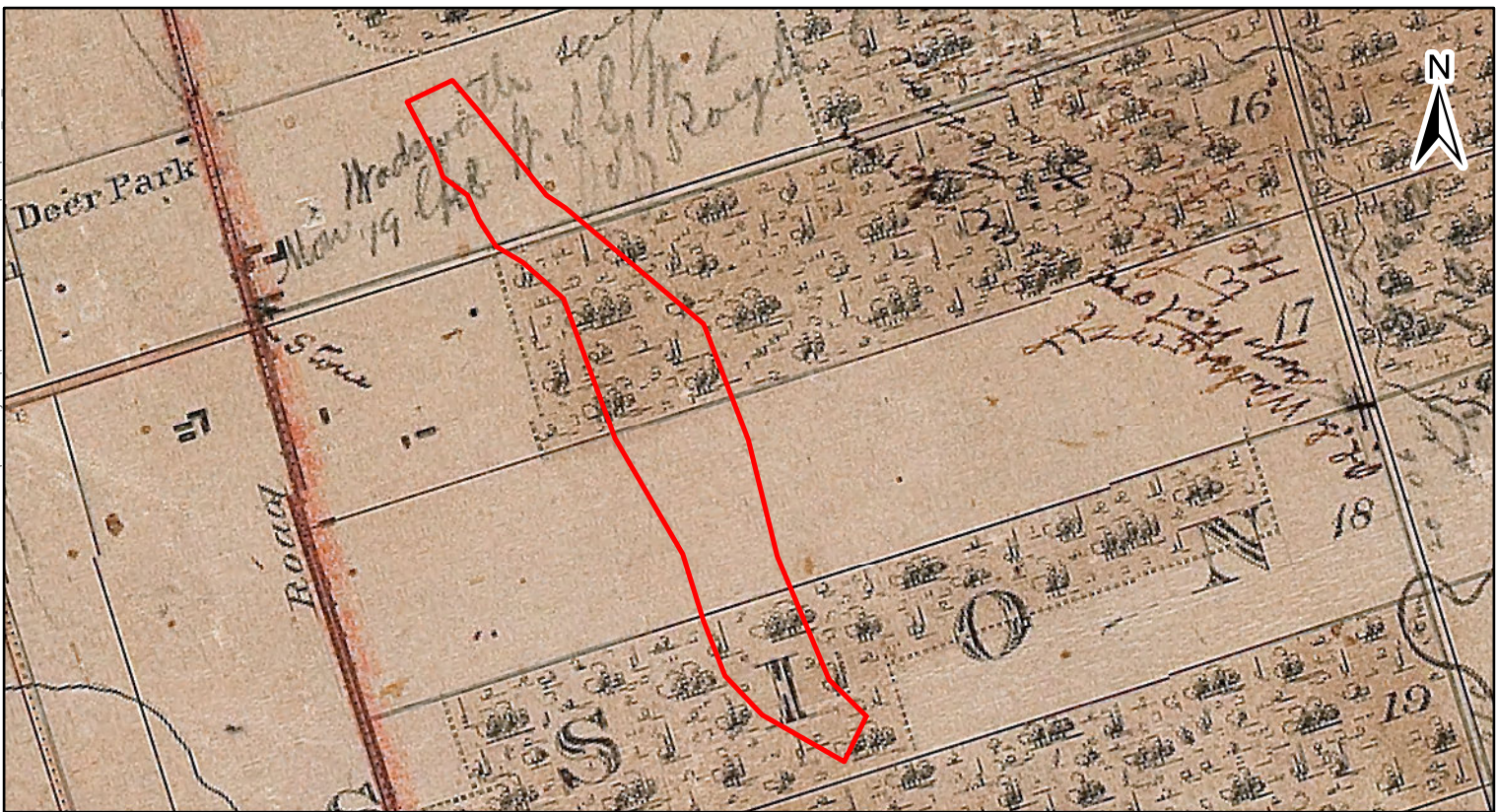

Figure 2: Study Area (Approximate Location) Overlaid on the 1851 Map of the Township of York

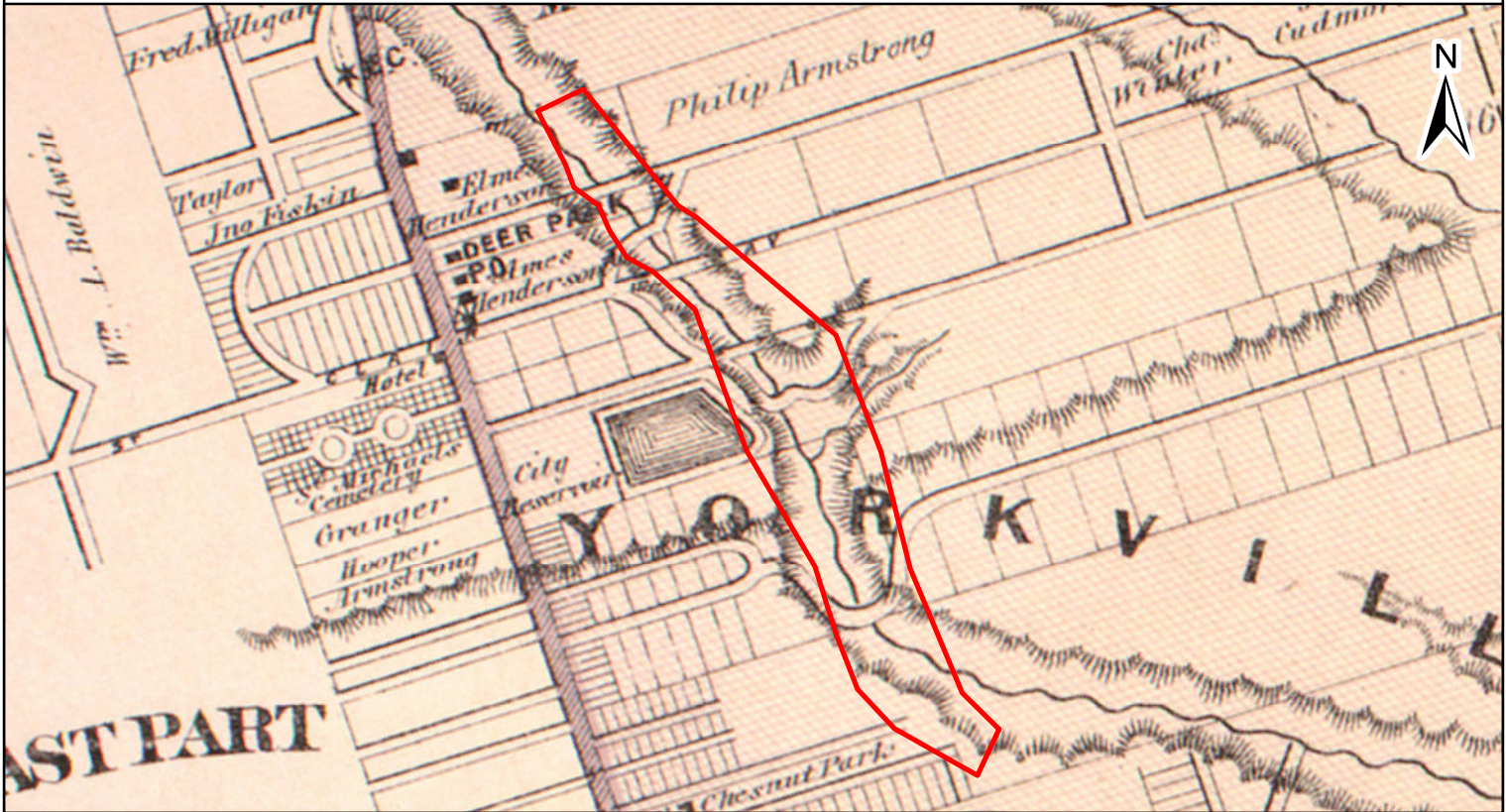

Figure 3: Study Area (Approximate Location) Overlaid on the 1878 Illustrated Historical Atlas of the County of York

	 <p>STUDY AREA</p>	<p>Fig. 4: Fire Insurance Plan of Toronto. 1899; Fig. 5: National Topographic System, Toronto Sheet. 1942</p> <p>Projection: NAD 1983 UTM Zone 17N Scale: 15,000 Page Size: 8.5 x 11</p>	 <p>0 500 Metres</p>
		<p>ASI PROJECT NO.: 19PL_216 DRAWN BY: ESB DATE: 2020-05-28 FILE: 19EA_216_Historic</p>	



Figure 6: Study Area (Approximate Location) Overlaid on the 1974 NTS West Toronto Sheet



Figure 7: Study Area (Approximate Location) Overlaid on the 1991 Aerial Photography

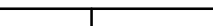
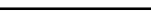
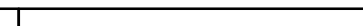
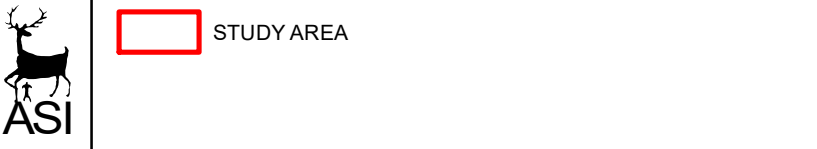



 STUDY AREA

Fig. 6: National Topographic System, West Toronto Sheet, 1974; Fig. 7: City of Toronto Archives, Aerial Photographs, 1991.

Projection: NAD 1983 UTM Zone 17N
Scale: 15,000
Page Size: 8.5 x 11

0 500

Metres

ASI PROJECT NO.: 19PL_216 DRAWN BY: ESB
DATE: 2020-05-27 FILE: 19EA_216_Historic

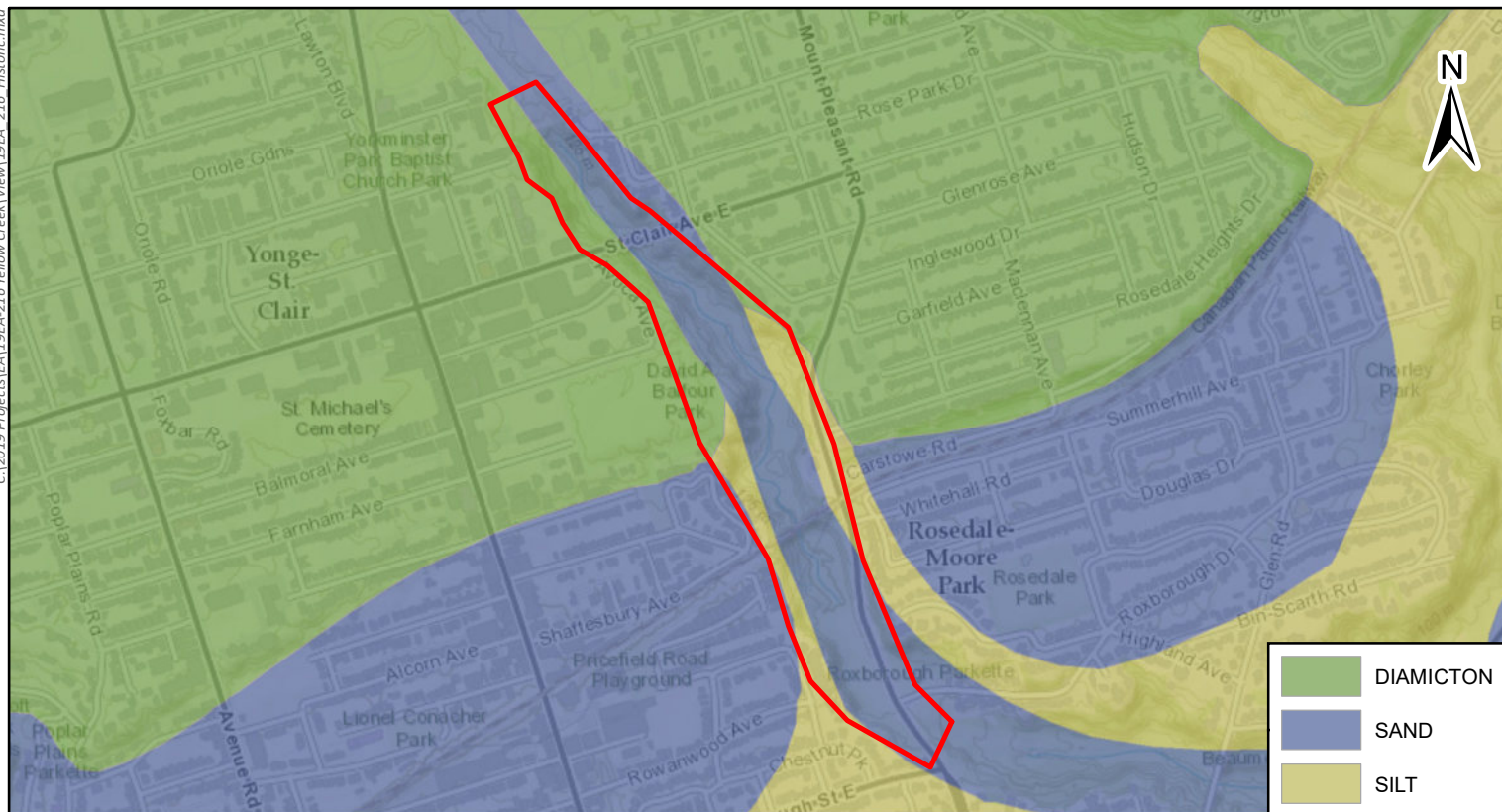

Figure 8: Study Area - Surficial Geology

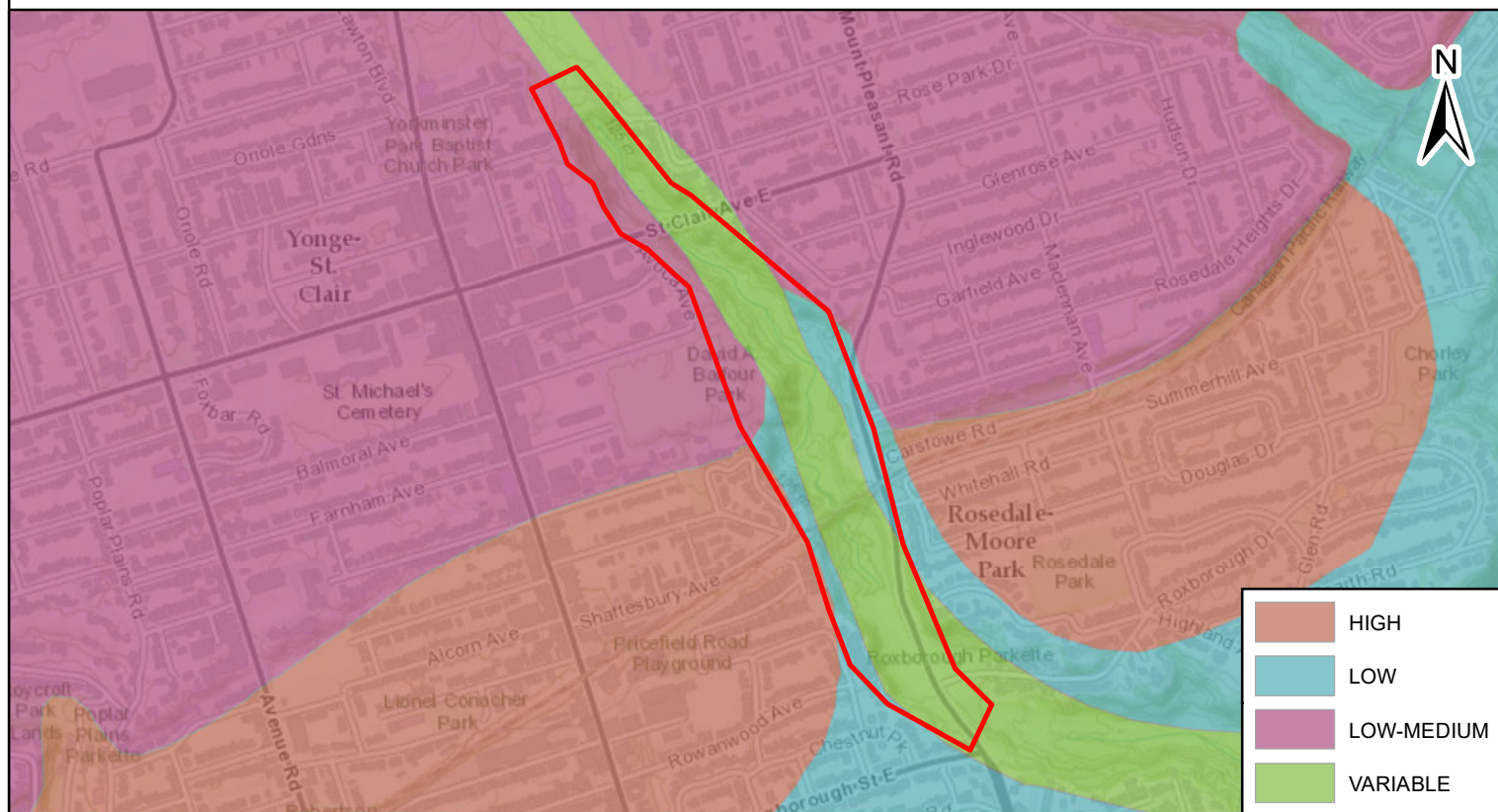



Figure 9: Study Area - Soil Drainage



 STUDY AREA

Sources: Esri, HERE, Garmin, Intermap, increment P Corp., GEBCO, USGS, FAO, NPS, NRCAN, GeoBase, IGN, Kadaster NL, Ordnance Survey, Esri Japan, METI, Esri China (Hong

Projection: NAD 1983 UTM Zone 17N
Scale: 15,000
Page Size: 8.5 x 11

0 500
Metres

ASI PROJECT NO.: 19PL_216 DRAWN BY: ESB
DATE: 2020-05-27 FILE: 19EA_216_Historic

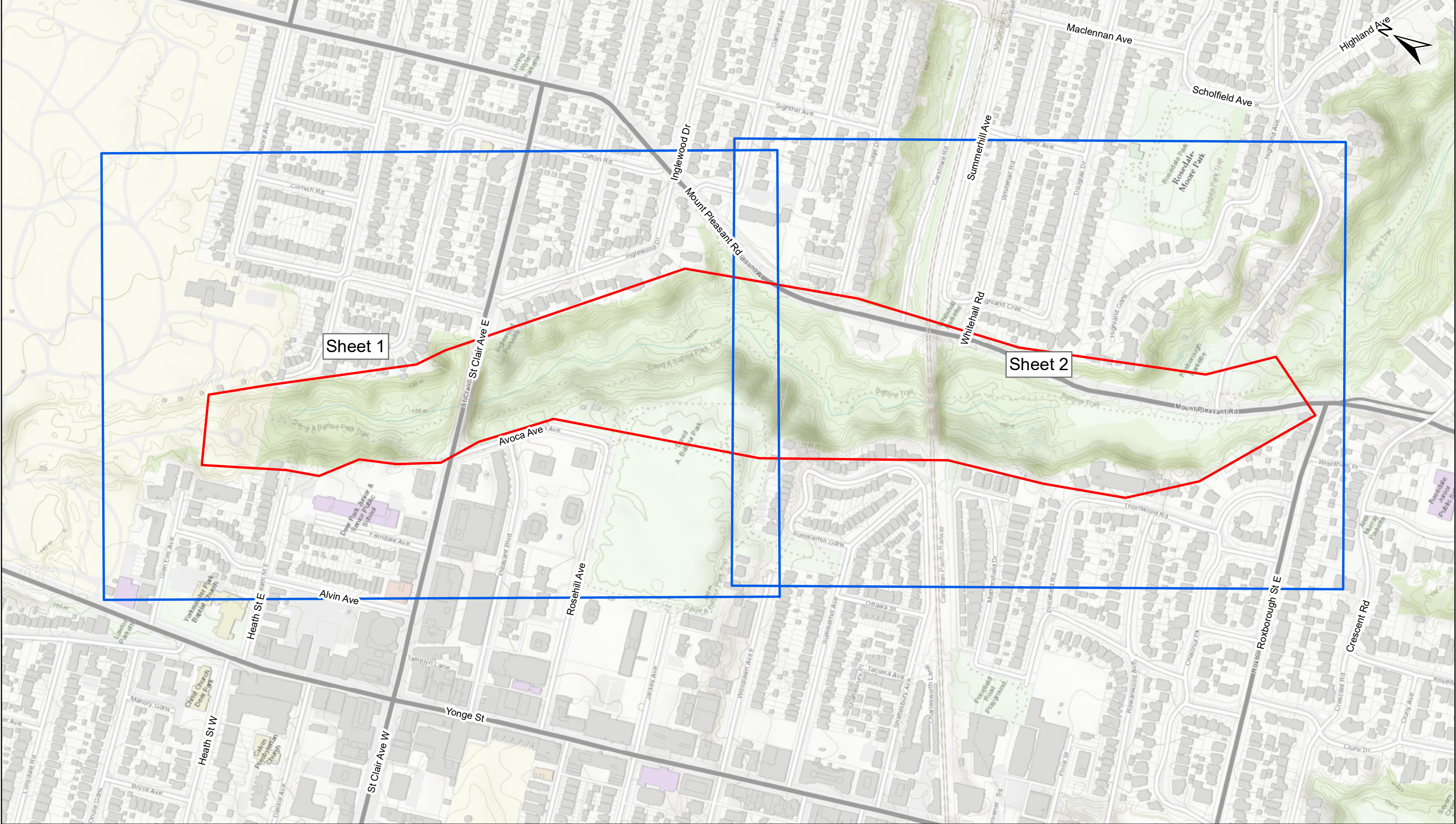

	 STUDY AREA	<p>Sources: Esri, HERE, Garmin, Intermap, increment P Corp., GEBCO, USGS, FAO, NPS, NRCAN, GeoBase, IGN, Kadaster NL, Ordnance Survey, Esri Japan, METI, Esri China (Hong Kong), (c) OpenStreetMap contributors, and the GIS User Community</p> <p>Projection: NAD 1983 UTM Zone 17N Scale: 1:5,000 Page Size: 11 x 17</p>	<p>0 250</p> <p></p> <p>Metres</p> <p>ASI PROJECT NO.: 19EA_216 DATE: 2020-06-09</p> <p>DRAWN BY: ESB FILE: 19EA_216_Results</p>
	 MAP KEY		

Figure 10: Yellow Creek - Results of Stage 1 (Key Map)

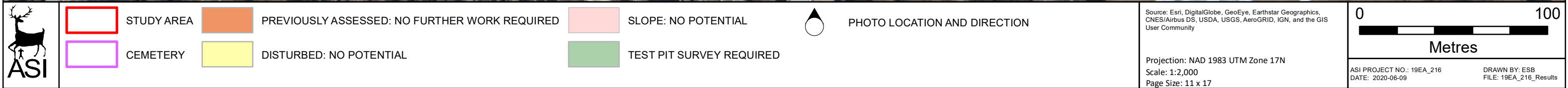

Figure 11: Yellow Creek - Results of Stage 1 (Sheet 1)



		STUDY AREA		DISTURBED: NO POTENTIAL		TEST PIT SURVEY REQUIRED
		PREVIOUSLY ASSESSED: NO FURTHER WORK REQUIRED		SLOPE: NO POTENTIAL		PHOTO LOCATION AND DIRECTION

Source: Esri, Maxar, GeoEye, Earthstar Geographics, CNES/Airbus DS, USDA, USGS, AeroGRID, IGN, and the GIS User Community

Projection: NAD 1983 UTM Zone 17N
Scale: 1:2,000
Page Size: 11 x 17

0 100

Metres

ASI PROJECT NO.: 19EA_216
DATE: 2020-06-17

DRAWN BY: ESB
FILE: 19EA_216_Results

Figure 12: Yellow Creek - Results of Stage 1 (Sheet 2)