

# Elm Street Streetscape Vision

Initial Conceptual Designs



# Study Area

- The study area includes part of the Elm Street stretching from the Bay Street to Yonge Street and it is adjacent to Downtown Yonge Business Improvement Area (BIA) in Toronto. Administratively, the study area belongs to the University Rosedale Ward 11, and it is adjacent to Toronto Centre Ward.

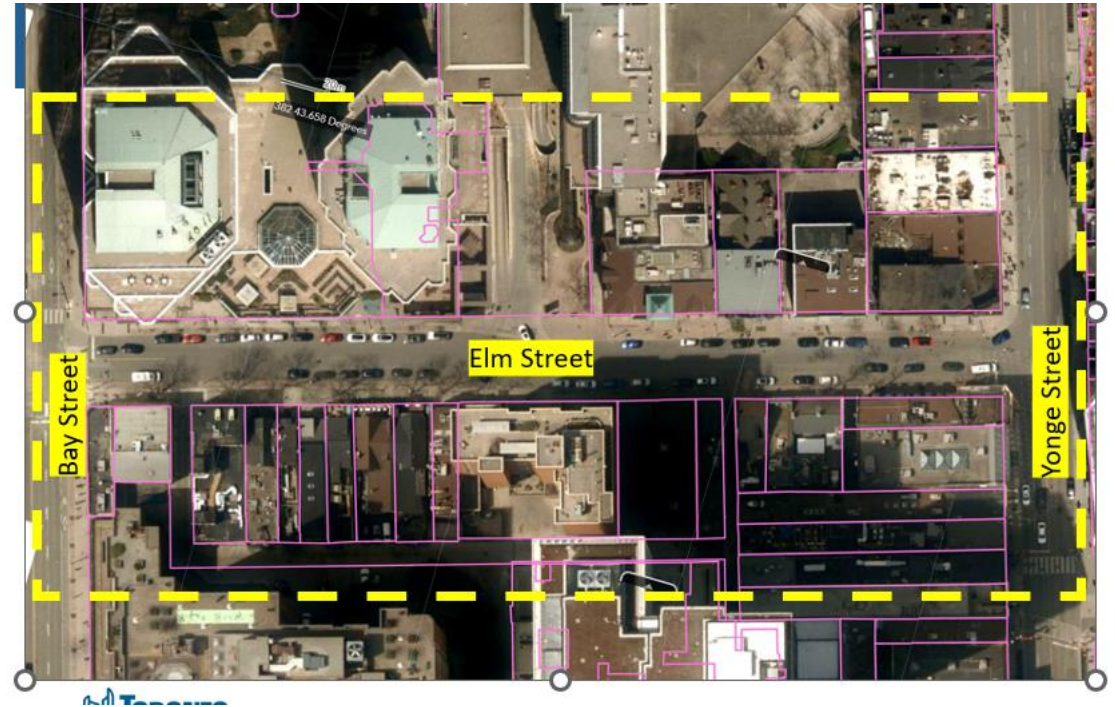

# Existing Context



# Elm Street



# Elm Street



# Existing Conditions

- 11.0m -11.5m paved roadway
- On-street parking to the north and south side of the street
- 2.4m to 5.4 m sidewalk width
- 14 pedestrian streetlights
- Heritage signage at the front of 8 Elm Street
- 14 Bike racks
- Heritage listed buildings to the south
- 31 on street parking spaces



# Initial Concepts



# Design – Option 1

Improving pedestrian experience by providing short curb extensions placed strategically at the front of restaurants and commercial uses for seating and for greening opportunities at the front of the residential buildings

- Two-way street
- 6.3m and 8.6m paved roadway
- On-street parking to the north and south side of the street
- 3.3m to 7.8 m sidewalk width
- Tabletop crossing for mid-block connection
- Providing short bump-outs at the intersections to the east and west and at the curb side along the street
- Parking spaces (17) to the north and south of the Elm Street

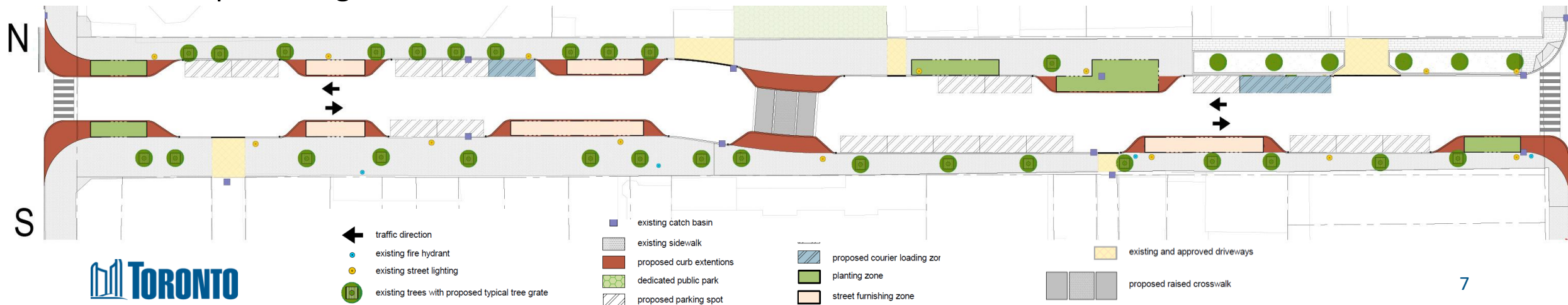



# Design – Option 1

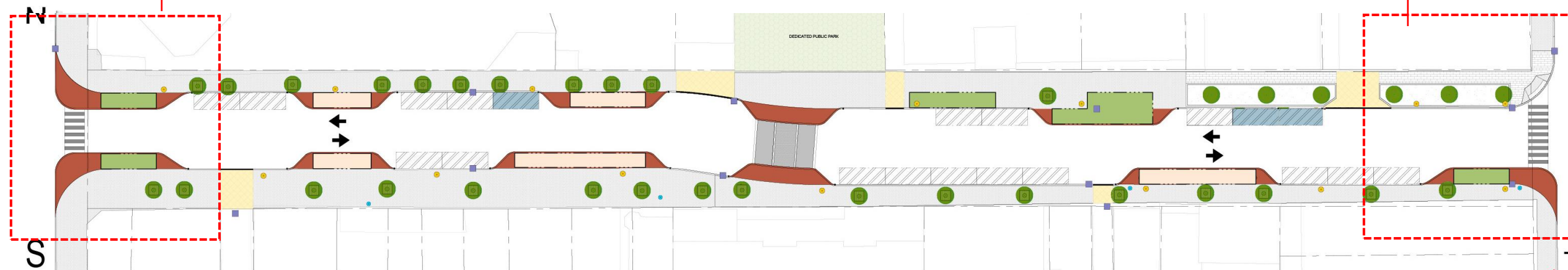
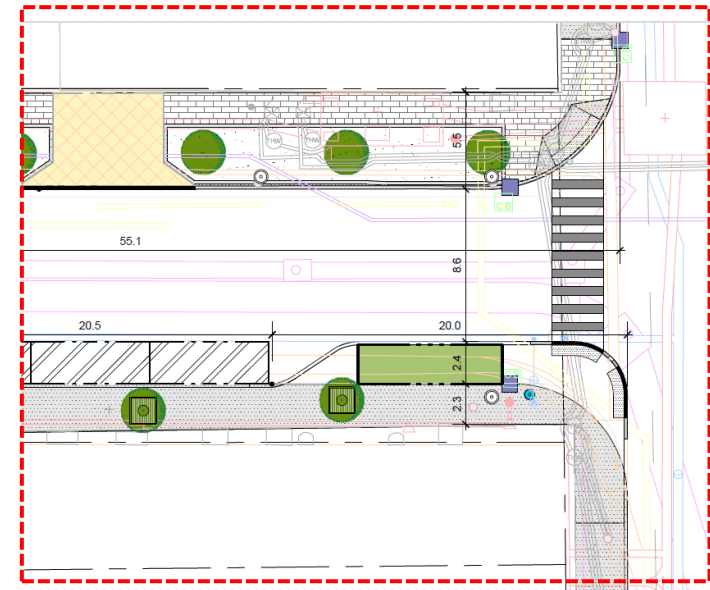
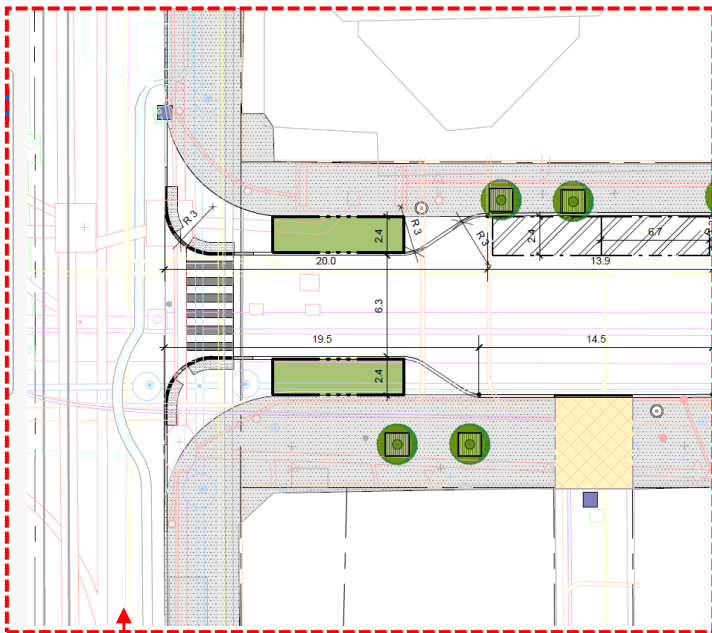

# Design – Option 1

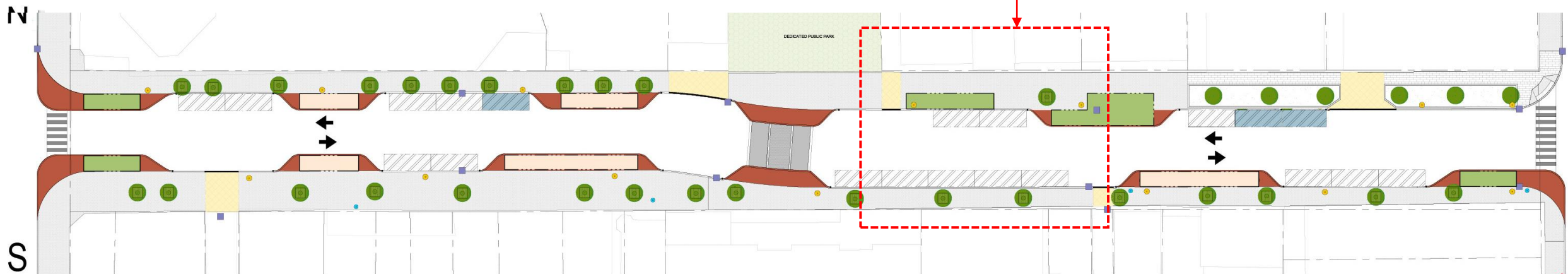
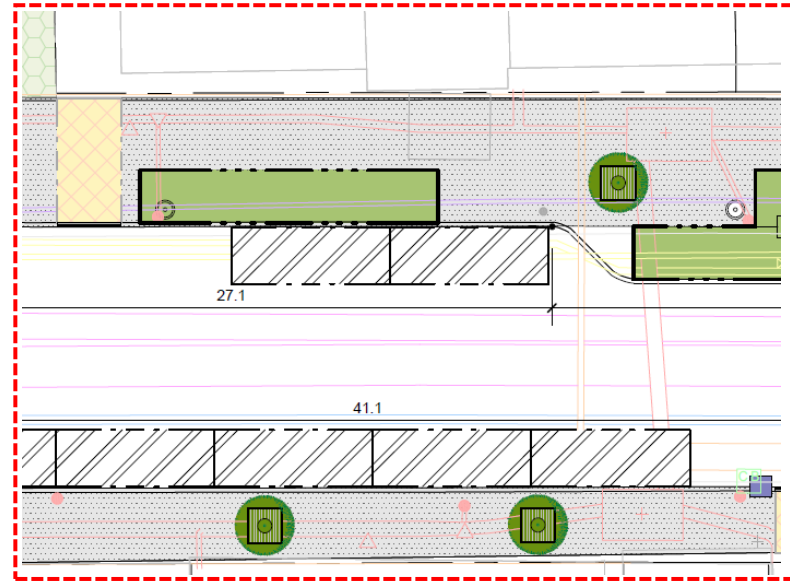

# Design – Option 2

Improving pedestrian experience by providing a few but longer curb extensions that will accommodate areas for seating and greening opportunities

- Two-way street
- 6.3m, 8.6m paved roadway
- On-street parking to the north and south side of the street
- 3.1m to 8.5m sidewalk width
- Providing longer bump-outs at the intersections to the east and consolidating small bump outs at the curb side along the street,
- Parking spaces (20) to the north and south of the Elm Street

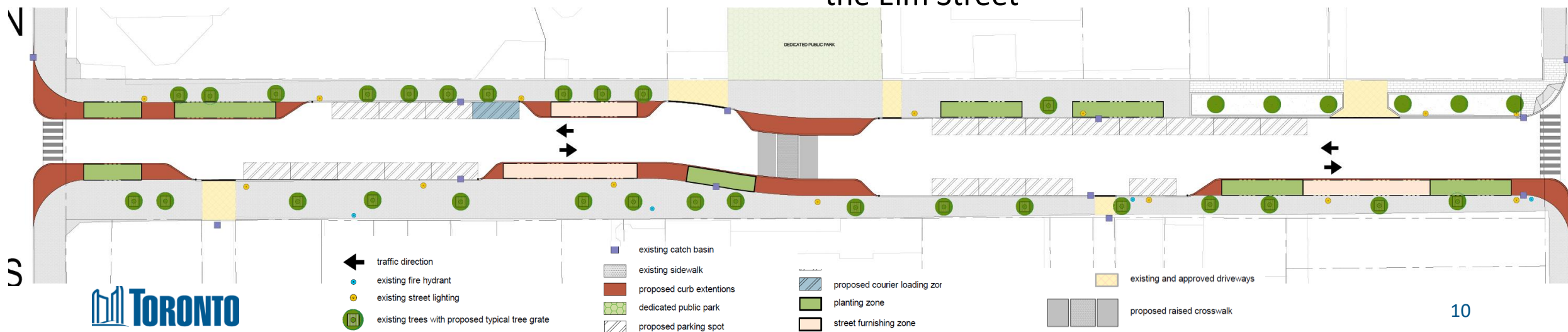

# Design – Option 2

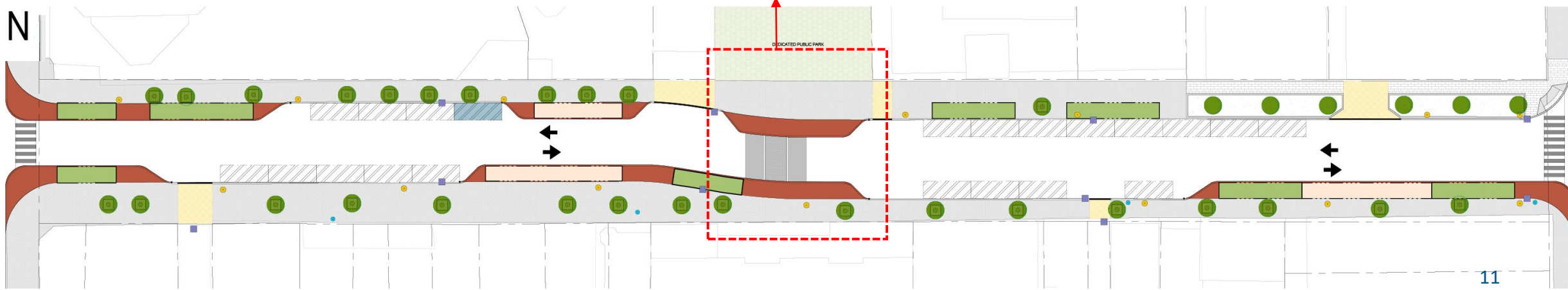
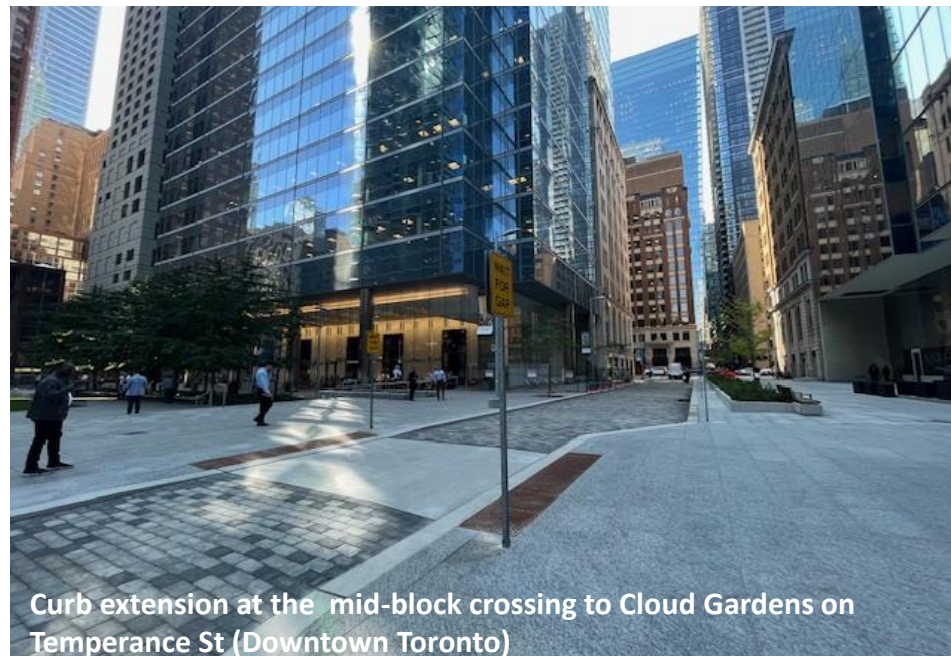
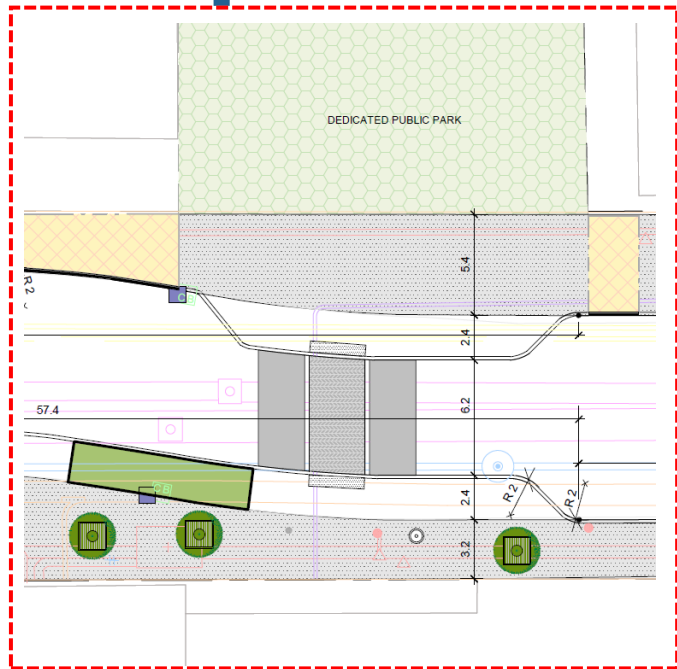

# Design – Option 2



Curb extensions with tree planters and parallel parking  
Grenville St, Downtown Toronto

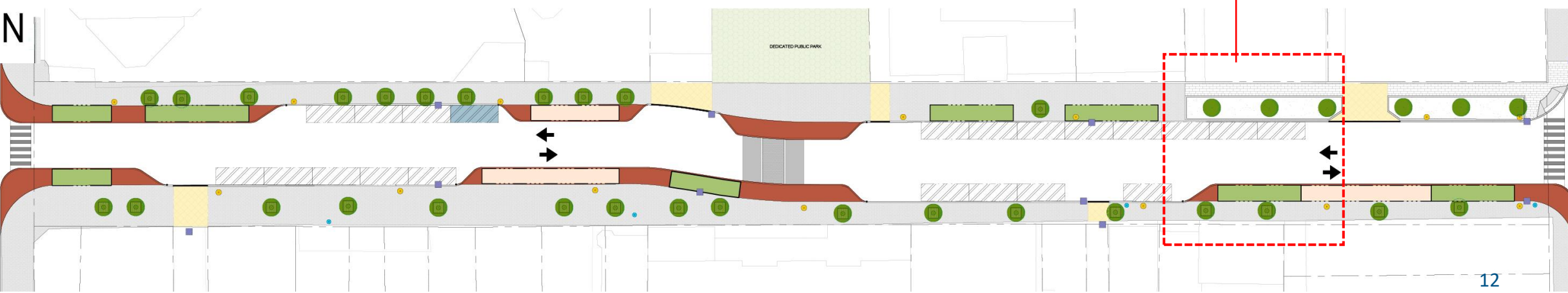
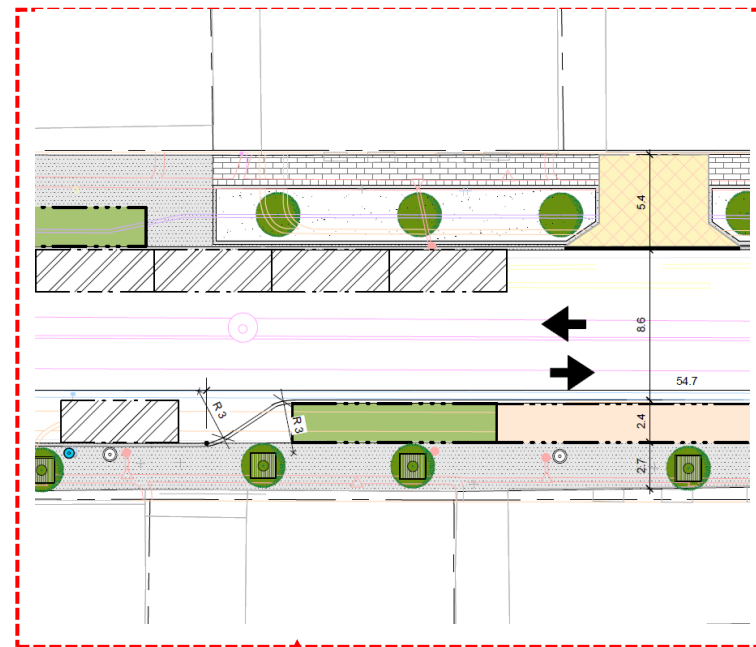

# Design – Option 3

- Two-way street
- Min 6m paved roadway for fire services access
- Major widening of the sidewalks to the north to improve microclimate for pedestrians and plants
- 2.9m to 9.5m sidewalk width
- Table-top crossing for mid-block connection
- Remaining Parking spaces (17) to the south of the Elm Street
- Providing bump-outs at the intersections to the south.

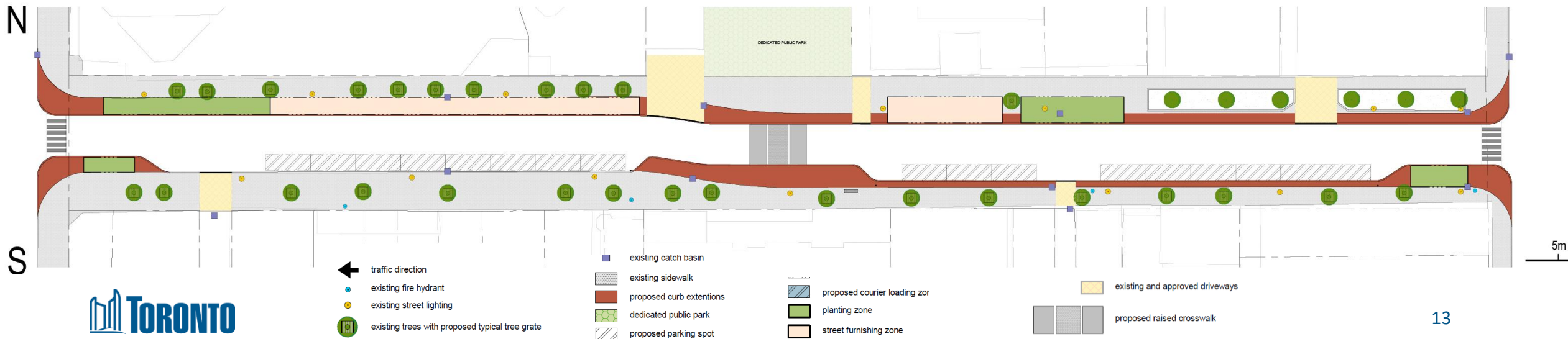

# Design – Option 3

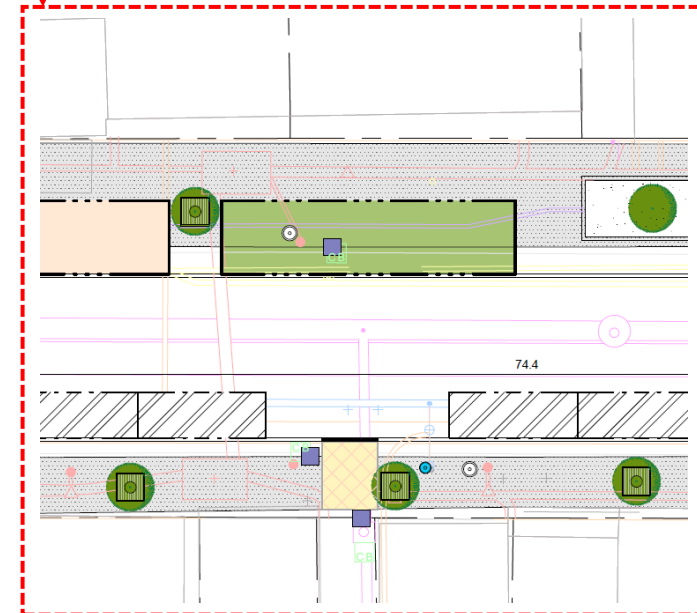
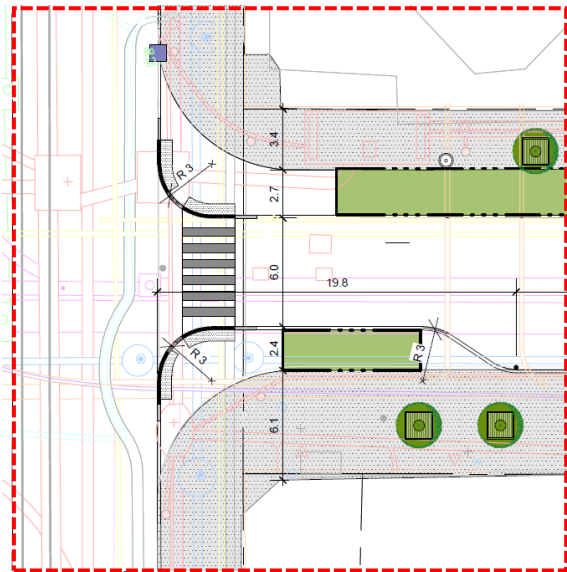
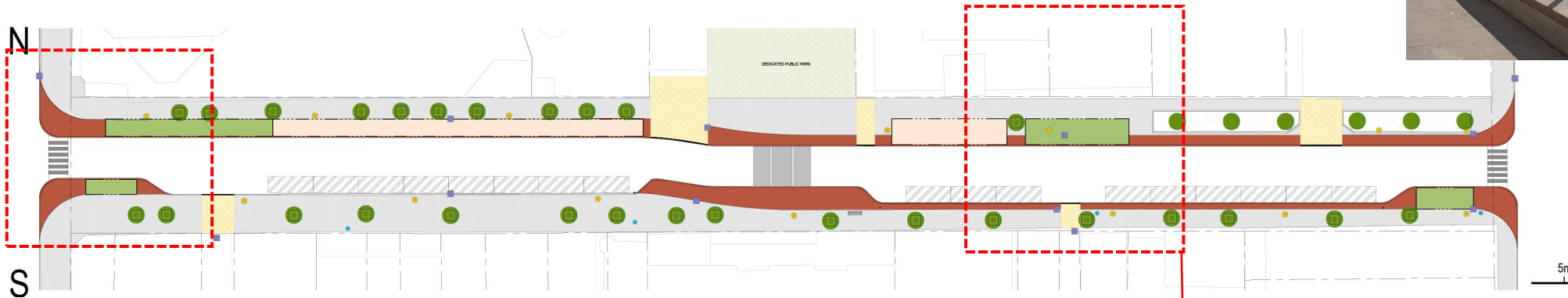

# Design – Option 3

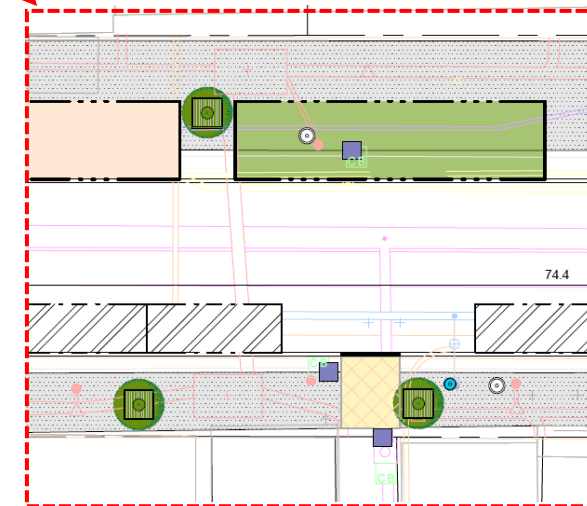
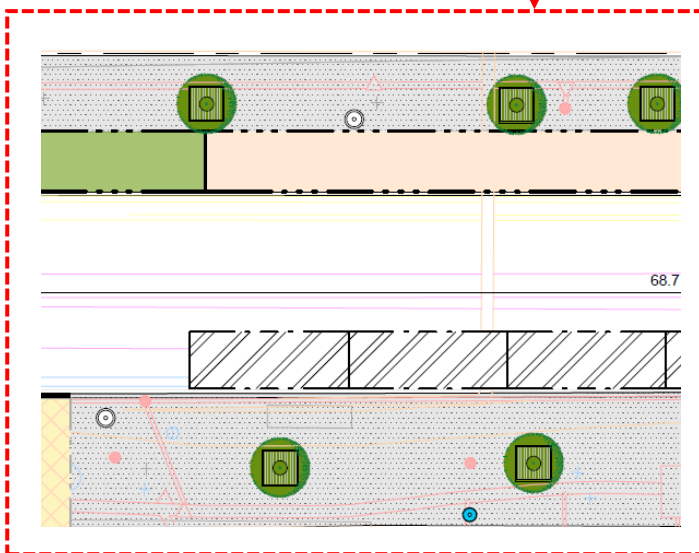
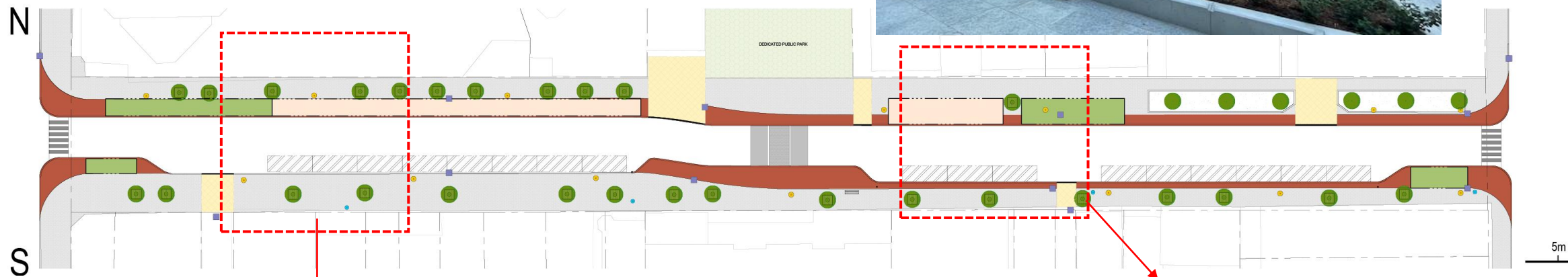



# Design – Options 1-3



View looking east from south side of Elm Street



# Next Steps

- Community Meeting scheduled for April 29<sup>th</sup> 2025
- Any questions, please contact – [Joanna.Chludzinska@toronto.ca](mailto:Joanna.Chludzinska@toronto.ca)