

## After construction is complete, here's what you can expect when travelling on Scarborough Golf Club Road. New Signs and Road Markings to Watch For:

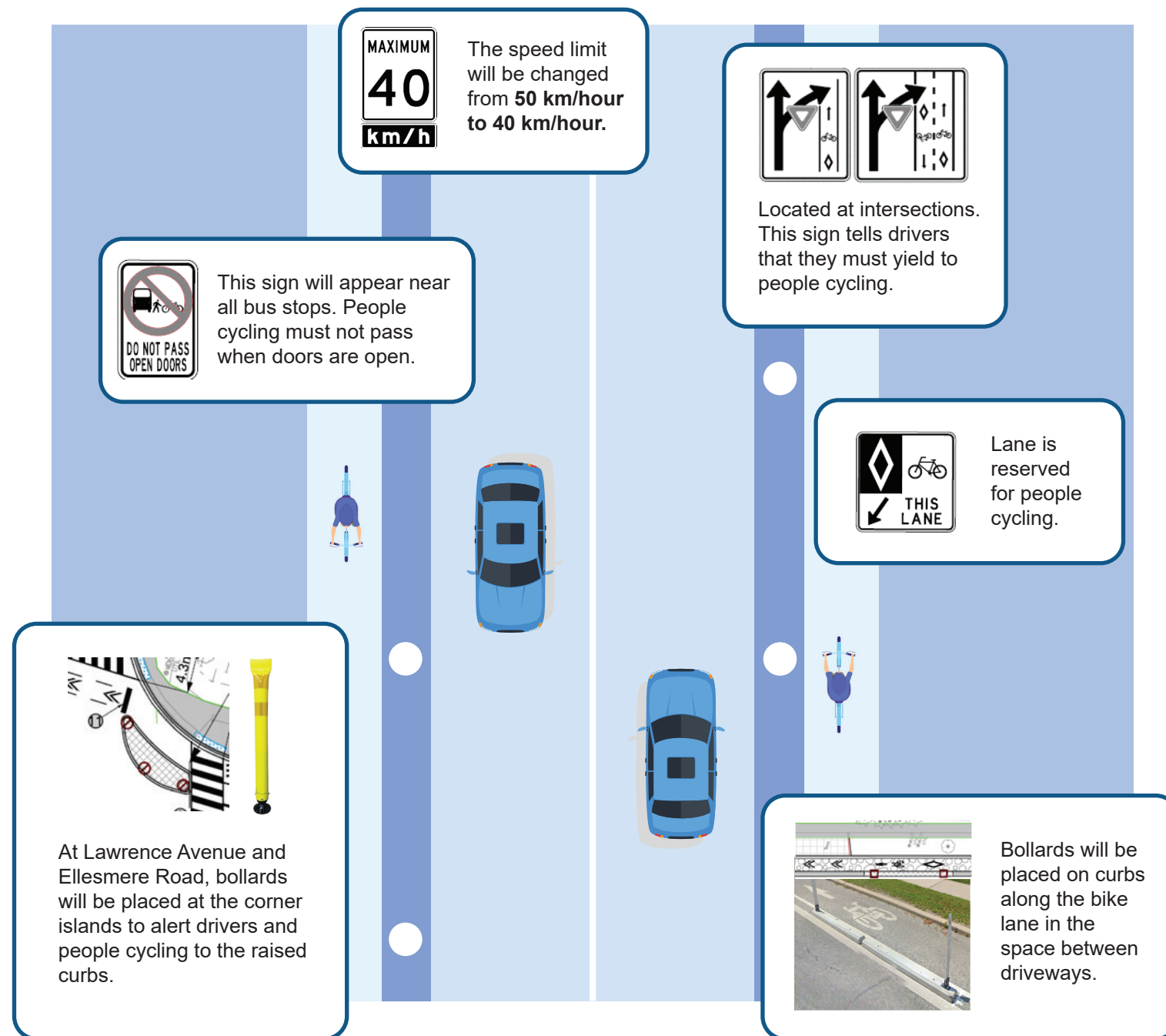

For more information, email [roadconstruction@toronto.ca](mailto:roadconstruction@toronto.ca).



[toronto.ca/sgrroadsafety](https://toronto.ca/sgrroadsafety)

## Road Safety and Accessibility Improvements Coming to Scarborough Golf Club Road

August 2025



An artist's rendering of road safety improvements on Scarborough Golf Club Road at Greenrock Avenue looking north, including a protected cycle track.

The City reconstructs roads every 50-100 years providing an important opportunity to make changes to improve operations and safety. Scarborough Golf Club Road was last reconstructed in 1956. Scarborough Golf Club Road will soon feature improvements focused on road safety and accessibility.

As part of the City's commitment to Vision Zero Road Safety Plan, these types of improvements can help to eliminate traffic-related fatalities and serious injuries by making our roads safer for everyone, especially seniors, school children, and people walking and cycling. In the past ten years, eight (8) people have been seriously injured and one (1) person lost their life using Scarborough Golf Club Road.

### New road safety and accessibility improvements will include:

- Separated bike lanes on both sides of the road
- Protected intersections with separation for cars and trucks from pedestrians and people cycling
- Wider sidewalks
- Raised crosswalks
- Accessible raised bus stop platforms
- Green infrastructure to help manage stormwater

The road will have one northbound and southbound travel lane for vehicles and will include parking on the westside. Left-turn lanes will be maintained at Slan Avenue/Bankwell Avenue, Brimorton Drive and Lawrence Avenue East.

By adding these new features along Scarborough Golf Club Road, we can make it safer for everyone of all ages to travel. Driveway access for properties along the road will not change and emergency services and garbage trucks will continue to be able to operate.



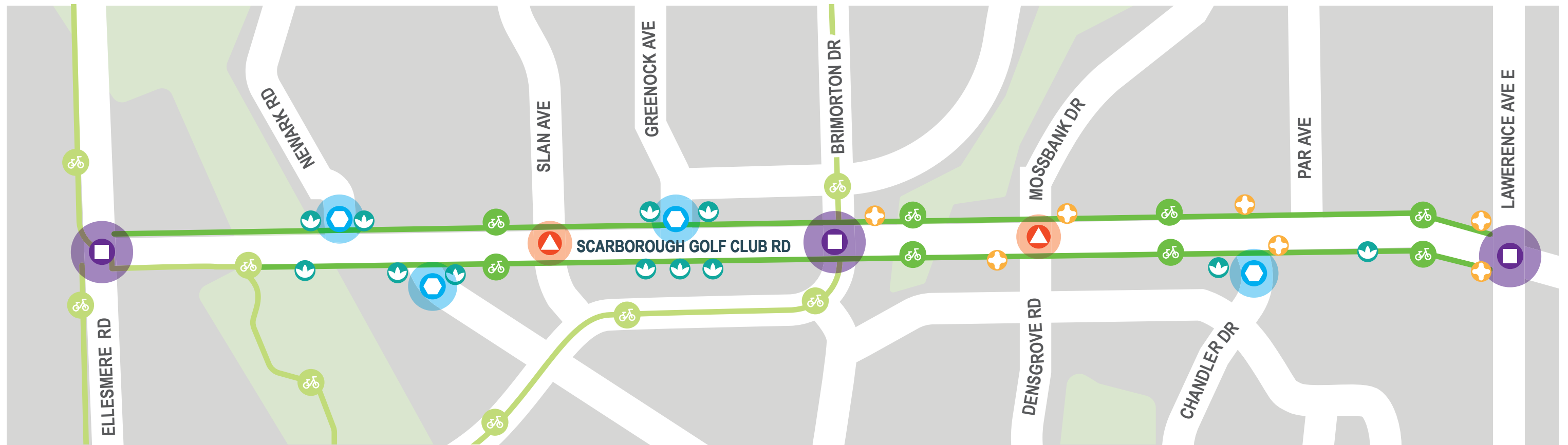

### Protected intersections

are designed to keep vehicles separated from bicycles and pedestrians with the addition of physical barriers. They provide improved visibility for everyone. People walking have shorter and safer crossing, while people cycling are given a dedicated path through the intersection.

The crossing for pedestrians and people cycling are set back from the intersection to improve visibility. Concrete barriers are used to physically protect people cycling and reduce the speed of turning vehicles.

People cycling will be able to turn left in two stages and use the corner island space to wait for dedicated traffic lights for when to cross the intersection.



### Existing Bikeways New Bikeways

**Bike lanes** will be separated from motor vehicles by a curb or concrete/planted median. This will create a safer environment for people to cycle.



**Truck aprons** will provide space for larger turning vehicles while maintaining traffic calming effects.

Pedestrians should avoid standing in the truck apron.



**The crosswalk** will be raised above the grade of the road to improve visibility of pedestrians and slow down vehicle speeds.



### Accessible raised bus stop platforms

At TTC bus stops, the bike lane will rise to curb level. Shared zones will provide accessible boarding for bus riders and maintain a clear path for people cycling.

Bus riders should avoid standing in the marked bike lane area until the bus pulls up to the stop. People cycling should be prepared to stop when a bus is at the stop and wait for passengers to load/unload before moving forward.



**Bioretention planters** are shallow, vegetated areas designed to manage stormwater runoff. They receive water from the roadway through curb inlets, as well as from sidewalks and paved areas.

To help manage stormwater, **green gutters** will be placed between the bike lane and road to allow rainwater to be filtered and absorbed by the vegetation.